

## DAILY STATUS REPORT

Prepared By: Kyle S Godfrey

WEATHER	Snow	Rain	<b>X</b>	Overcast	Partly Cloudy	Bright Sun
TEMP.	< 32	32-50		50-70	70-85	<b>X</b> >85

Langan Project No:	100688803	Project:	12074 Flatlands Avenue p/o Lot 1	Date:	08/21/2024
NYSDEC BCP Site No:	C224353			Time:	06:30 – 18:00

<b>Consultant:</b> Langan Engineering, Environmental, Surveying, Landscape Architecture and Geology, D.P.C.	<b>PERSONNEL ON SITE:</b> <b>Langan:</b> Daniel Horvath (Environmental) <b>Monadnock:</b> Michael Sullivan <b>United Concrete:</b> Claudio Cappiello, Miguel Flores and laborers <b>American Dewatering Grouting (ADG):</b> Patty and crew
--	--

**EQUIPMENT ON SITE:** Bobcat T76 Skid Steer, Komatsu PC 490 LC Excavator, Comacchio MC8D Drill Rig

<p><b><u>Site Activities</u></b></p> <ul style="list-style-type: none"> <li>United Concrete (United) imported two truckloads of 1.5-inch clean stone from Tilcon New York Inc. in Mount Hope, NJ.</li> <li>United placed 2-inches of imported clean stone over previously installed stone for maintenance of the temporary stabilized roadway in the logistical zone within the eastern portion of the Site.</li> </ul> <p><b><u>Samples Collected</u></b></p> <ul style="list-style-type: none"> <li>None</li> </ul> <p><b><u>Community Air Monitoring Program (CAMP)</u></b></p> <ul style="list-style-type: none"> <li>As no ground intrusive work or soil disturbance was conducted, the CAMP was not implemented as per the 4 April 2024 Site Logistics Letter.</li> </ul> <p><b><u>Problems Encountered</u></b></p> <ul style="list-style-type: none"> <li>None</li> </ul> <p><b><u>Activities Scheduled for Next Day</u></b></p> <ul style="list-style-type: none"> <li>Trucks will traverse through the logistical zone of the Site to the adjacent Site to the east (BCP Site No. C224290) for the installation of SOE and the installation of the deep foundation piles and dewatering wells.</li> </ul>
--

## **Two Week Outlook**

- Trucks will continue to traverse through the logistical zone of the Site to the adjacent Site to the east (BCP Site No. C224290) for the loading and export of material, the installation of SOE, and the installation of the deep foundation piles and dewatering wells.

Truck Count Log of Imported Material										
Facility/Material:	Tilcon New York Inc., Mount Hope Quarry <i>(1.5-inch Clean Stone)</i>		Tilcon New York Inc., Mount Hope Quarry <i>(0.75-inch Clean Stone)</i>		Braen Stone of Sparta Lafayette, New Jersey <i>(1.5-inch Clean Stone)</i>		Braen Stone of Sparta Lafayette, New Jersey <i>(0.75-inch Clean Stone)</i>		---	
Volume:	Trucks	Cu. Yds.	Trucks	Cu. Yds.	Trucks	Cu. Yards	Trucks	Cu. Yards	Trucks	Cu. Yards
<b>Today:</b>	2	40	0	0	0	0	0	0	---	---
<b>Total:</b>	2	40	0	0	25	500	0	0	---	---
<b>Approved Quantity:</b>	---	500	---	500	---	500	---	500	---	---
Facility/Material:	---		---		---		---		---	
Volume:	Trucks	Cu. Yds.	Trucks	Cu. Yds.	Trucks	Cu. Yards	Trucks	Cu. Yards	Trucks	Cu. Yards
<b>Today:</b>	---	---	---	---	---	---	---	---	---	---
<b>Total:</b>	---	---	---	---	---	---	---	---	---	---
<b>Approved Quantity:</b>	---	---	---	---	---	---	---	---	---	---

Note: 20 cubic yards assumed per truckload

Truck Count Log of Exported Material											
Facility/Material:	Clean Earth Philadelphia Philadelphia, Pennsylvania Approval # 243100026 (7,000 tons)		Clean Earth Carteret Carteret, New Jersey Approval #243070587 (4,000 tons)		---		---		---		
	Volume:	Trucks	Cu. Yds.	Trucks	Cu. Yds.	Trucks	Cu. Yds.	Trucks	Cu. Yds.	Trucks	Cu. Yds.
<b>Today:</b>	0	0	0	0	---	---	---	---	---	---	
<b>Total:</b>	70	1,400	20	400	---	---	---	---	---	---	

Note: 20 cubic yards assumed per truckload

## Photo Log

Photo 1 – United placing clean stone for the roadway in the southeastern portion of the Site, facing south.



# DAILY SITE MAP

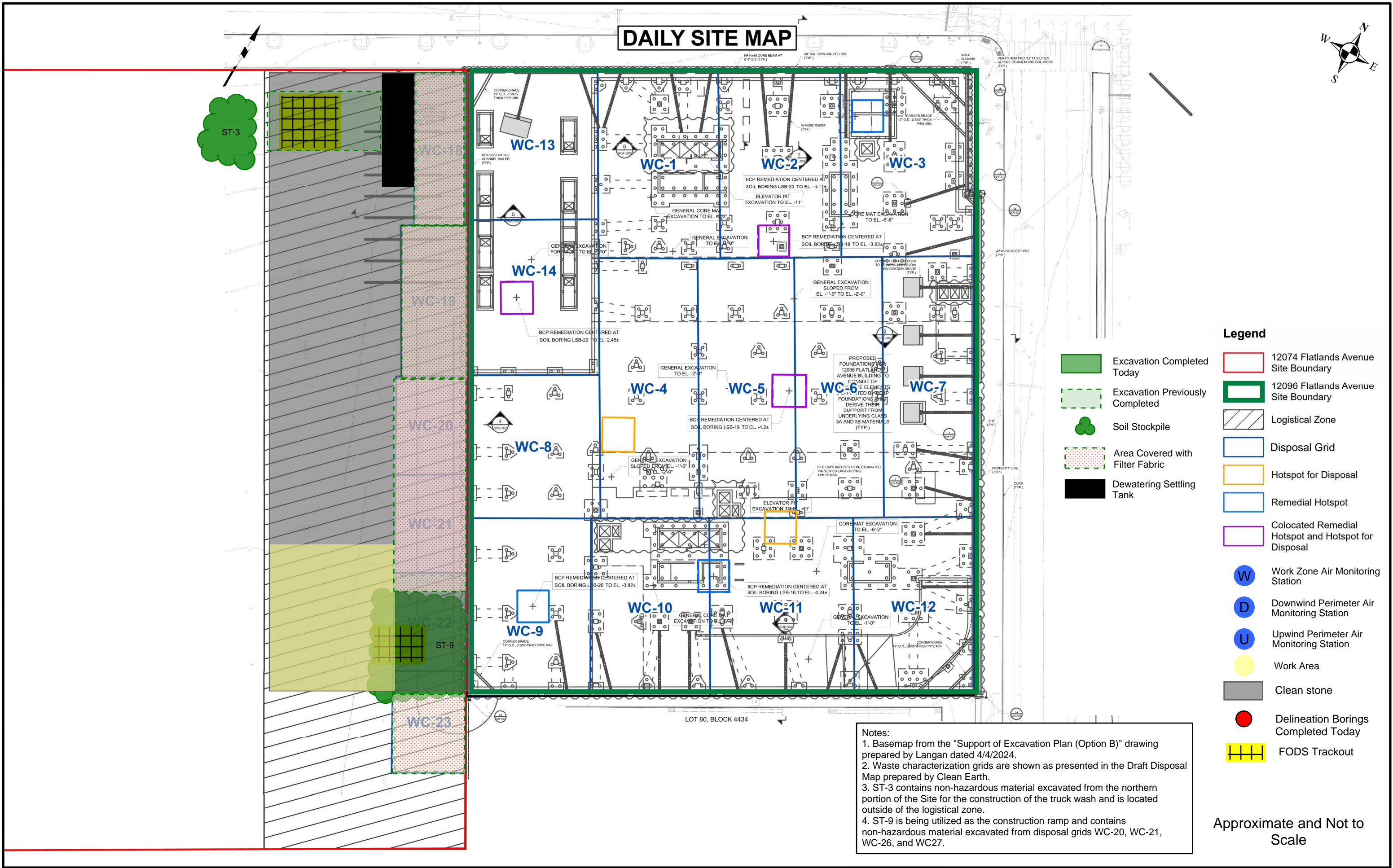
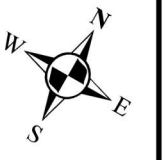

- ### Legend
- Excavation Completed Today
  - Excavation Previously Completed
  - Soil Stockpile
  - Area Covered with Filter Fabric
  - Dewatering Settling Tank
  - 12074 Flatlands Avenue Site Boundary
  - 12096 Flatlands Avenue Site Boundary
  - Logistical Zone
  - Disposal Grid
  - Hotspot for Disposal
  - Remedial Hotspot
  - Colocated Remedial Hotspot and Hotspot for Disposal
  - W Work Zone Air Monitoring Station
  - D Downwind Perimeter Air Monitoring Station
  - U Upwind Perimeter Air Monitoring Station
  - Work Area
  - Clean stone
  - Delineation Borings Completed Today
  - FODS Trackout

**Notes:**

1. Basemap from the "Support of Excavation Plan (Option B)" drawing prepared by Langan dated 4/4/2024.
2. Waste characterization grids are shown as presented in the Draft Disposal Map prepared by Clean Earth.
3. ST-3 contains non-hazardous material excavated from the northern portion of the Site for the construction of the truck wash and is located outside of the logistical zone.
4. ST-9 is being utilized as the construction ramp and contains non-hazardous material excavated from disposal grids WC-20, WC-21, WC-26, and WC-27.

Approximate and Not to Scale