

DAILY STATUS REPORT

Prepared By: Daniel Horvath

WEATHER	Snow		Rain		Overcast		Partly Cloudy	x	Bright Sun	x
TEMP.	< 32		32-50		50-70		70-85	x	>85	

Langan Project No:	100688803	Project:	12074 Flatlands Avenue p/o Lot 1	Date:	10/03/2024
NYSDEC BCP Site No:	C224353			Time:	06:30 – 14:30

Consultant:

Langan Engineering, Environmental, Surveying, Landscape Architecture and Geology, D.P.C.

PERSONNEL ON SITE:

Langan: Daniel Horvath (Environmental)

Monadnock: Michael Sullivan

United Concrete: Claudio Cappiello, Miguel Flores and laborers

EQUIPMENT ON SITE: Bobcat T76 Skid Steer, PVE 90DR Drill Rig, Skyjack SJ66T Boom Lift, JLG Skytrak 10054 Telehandler, Xtreme XR3034 Telehandler, Takeuchi TB240 Compact Excavator, and Liebherr THS 110 D-K Concrete Pump

Site Activities

- United Concrete (United) imported 2 truckloads of 1.5-inch stone from Tilcon New York Inc. in Mount Hope, NJ.
- United placed 2-inches of imported clean stone over previously installed stone for maintenance of the temporary stabilized roadway in the logistical zone within the eastern portion of the Site.

Samples Collected

- None

Community Air Monitoring Program (CAMP)

- As no ground intrusive work or soil disturbance was conducted, the CAMP was not implemented as per the 4 April 2024 Site Logistics Letter.

Problems Encountered

- None

Activities Scheduled for Next Day

- Trucks will traverse through the logistical zone of the Site to the adjacent Site to the east (BCP Site No. C224290) for the loading and export of material, the installation of SOE and the installation of the deep foundation piles and dewatering wells.

Two Week Outlook

- Trucks will continue to traverse through the logistical zone of the Site to the adjacent Site to the east (BCP Site No. C224290) for the loading and export of material, the installation of SOE, and the installation of the deep foundation piles and dewatering wells.

Truck Count Log of Imported Material										
Facility/Material:	Tilcon New York Inc., Mount Hope Quarry (1.5-inch Clean Stone)		Tilcon New York Inc., Mount Hope Quarry (0.75-inch Clean Stone)		Braen Stone of Sparta Lafayette, New Jersey (1.5-inch Clean Stone)		Braen Stone of Sparta Lafayette, New Jersey (0.75-inch Clean Stone)		----	
Volume:	Trucks	Cu. Yds.	Trucks	Cu. Yds.	Trucks	Cu. Yards	Trucks	Cu. Yards	Trucks	Cu. Yards
Today:	2	40	0	0	0	0	0	0	---	---
Total:	4	80	0	0	25	500	0	0	---	---
Approved Quantity:	---	500	---	500	---	500	---	500	---	---
Facility/Material:	---		---		---		---		---	
Volume:	Trucks	Cu. Yds.	Trucks	Cu. Yds.	Trucks	Cu. Yards	Trucks	Cu. Yards	Trucks	Cu. Yards
Today:	---	---	---	---	---	---	---	---	---	---
Total:	---	---	---	---	---	---	---	---	---	---
Approved Quantity:	---	---	---	---	---	---	---	---	---	---

Note: 20 cubic yards assumed per truckload

Truck Count Log of Exported Material										
Facility/Material:	Clean Earth Philadelphia Philadelphia, Pennsylvania Approval # 243100026 (7,000 tons)		Clean Earth Carteret Carteret, New Jersey Approval #243070587 (4,000 tons)		---		---		---	
Volume:	Trucks	Cu. Yds.	Trucks	Cu. Yds.	Trucks	Cu. Yds.	Trucks	Cu. Yds.	Trucks	Cu. Yds.
Today:	0	0	0	0	---	---	---	---	---	---
Total:	70	1,400	20	400	---	---	---	---	---	---

Note: 20 cubic yards assumed per truckload

Photo Log

Photo 1 –
United
importing 1.5-
inch stone,
facing west.



Photo 2 –
United
spreading stone over
the logistical zone,
facing south.



DAILY SITE MAP

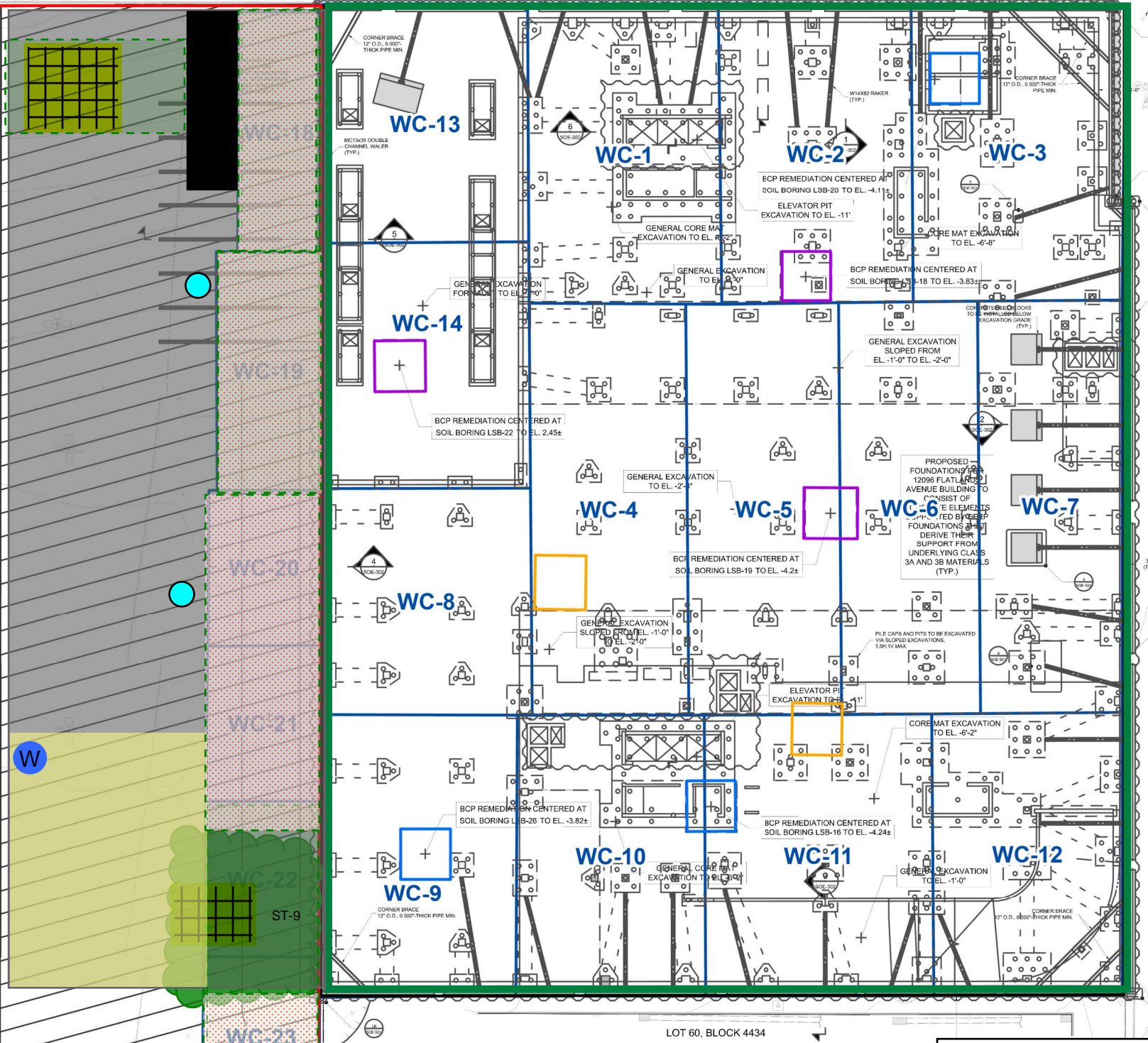

Legend

- Excavation Completed Today
- Excavation Previously Completed
- Soil Stockpile
- Area Covered with Filter Fabric
- Dewatering Settling Tank
- Dewatering Monitoring Well
- 12074 Flatlands Avenue Site Boundary
- 12096 Flatlands Avenue Site Boundary
- Logistical Zone
- Disposal Grid
- Hotspot for Disposal
- Remedial Hotspot
- Colocated Remedial Hotspot and Hotspot for Disposal
- Work Zone Air Monitoring Station
- Downwind Perimeter Air Monitoring Station
- Upwind Perimeter Air Monitoring Station
- Work Area
- Clean stone
- Delineation Borings Completed Today
- FODS Trackout

Notes:
1. Basemap from the "Support of Excavation Plan (Option B)" drawing prepared by Langan dated 4/4/2024.
2. Waste characterization grids are shown as presented in the Draft Disposal Map prepared by Clean Earth.
3. ST-3 contains non-hazardous material excavated from the northern portion of the Site for the construction of the truck wash and is located outside of the logistical zone.
4. ST-9 is being utilized as the construction ramp and contains non-hazardous material excavated from disposal grids WC-20, WC-21, WC-26, and WC-27.

Approximate and Not to Scale