



DAILY STATUS REPORT

Prepared By:

Gwen Lynn

WEATHER	Snow	Rain	X	Overcast	Partly Cloudy	X	Bright Sun	X	Wind
TEMP.	< 32	32-50		50-70	X	70-85	>85		SW-10 MPH

IEC Project No:	13928	NYSDEC BCP Site No:	C224367	Date:	11/8/23
Project:	251 Douglass Street, Brooklyn, NY				

<p>Consultant: Impact Environmental Engineering and Geology, PLLC (IEEG)</p> <p>Time On: 06:45 Time Out: 16:00</p>	<p>Personnel On Site: IEEG (Environmental) – Gwen Lynn Cascade Remediation Services – Jon Simpson Broadway Construction Group - Tom Caporale</p> <p>Equipment On Site: Minirae 3000 PID, DustTrak II</p>
---	--

Scope of Work: Cascade completed two ISS Pilot Test treatment columns on the Site. Refer to Figures for ISS Pilot Test column locations.

Site Activities:

- Deploy CAMP at the start of the workday;
- BCG begins 4’ cut in northern-most portion of the Site with excavator, material is stockpiled for off-Site disposal to Bayshore;
- BCG performing general Site clean-up in preparation for soil loadout/trucking; and
- The pocket penetrometer data is being collected by Cascade and their summary table is attached.

Community Air Monitoring Program (CAMP) - _CAMP action level for dust (0.1 mg/m³) and VOCs (5 ppm)

- PID remained at nominal levels throughout the day;
- No sustained dust exceedances were observed over a 1-min period during monitoring;
- Prestart Upwind Conditions – PID = _0.0_ ppm, Dust = _0.02_ mg/m³ @ 07:31.
- High Conditions (Upwind) – PID = _0.9_ ppm @ 15:21, Dust = _0.163_ mg/m³ @ 12:14.
- High Conditions (Downwind 1) – PID = _0.1_ ppm @ 15:57, Dust = _0.080_ mg/m³ @ 07:43.
- High Conditions (Downwind 2) – PID = _0.7_ ppm @16:05, Dust = _0.126_ mg/m³ @ 08:10

*BCG actively spraying water during all excavation work for dust suppression purposes.

Notable Site Conditions:

- None

Planned for the Next Day/Week:

- Trucking for off-Site disposal to Bayhore to begin tomorrow (11/9/23); and
- As part of the ISS pilot test, QA/QC core samples will be collected on 11/15 and continue through 11/17 as needed.

PHOTO LOG

251 DOUGLASS STREET, BROOKLYN, NY



Photo 1-
Representative photo of excavation work in the northern portion of the Site (formerly Lot 15).



Photo 2 –
Representative photo of of the Site facing northwest towards Nevins Street.



SITE PLANS

251 DOUGLASS STREET, BROOKLYN, NY



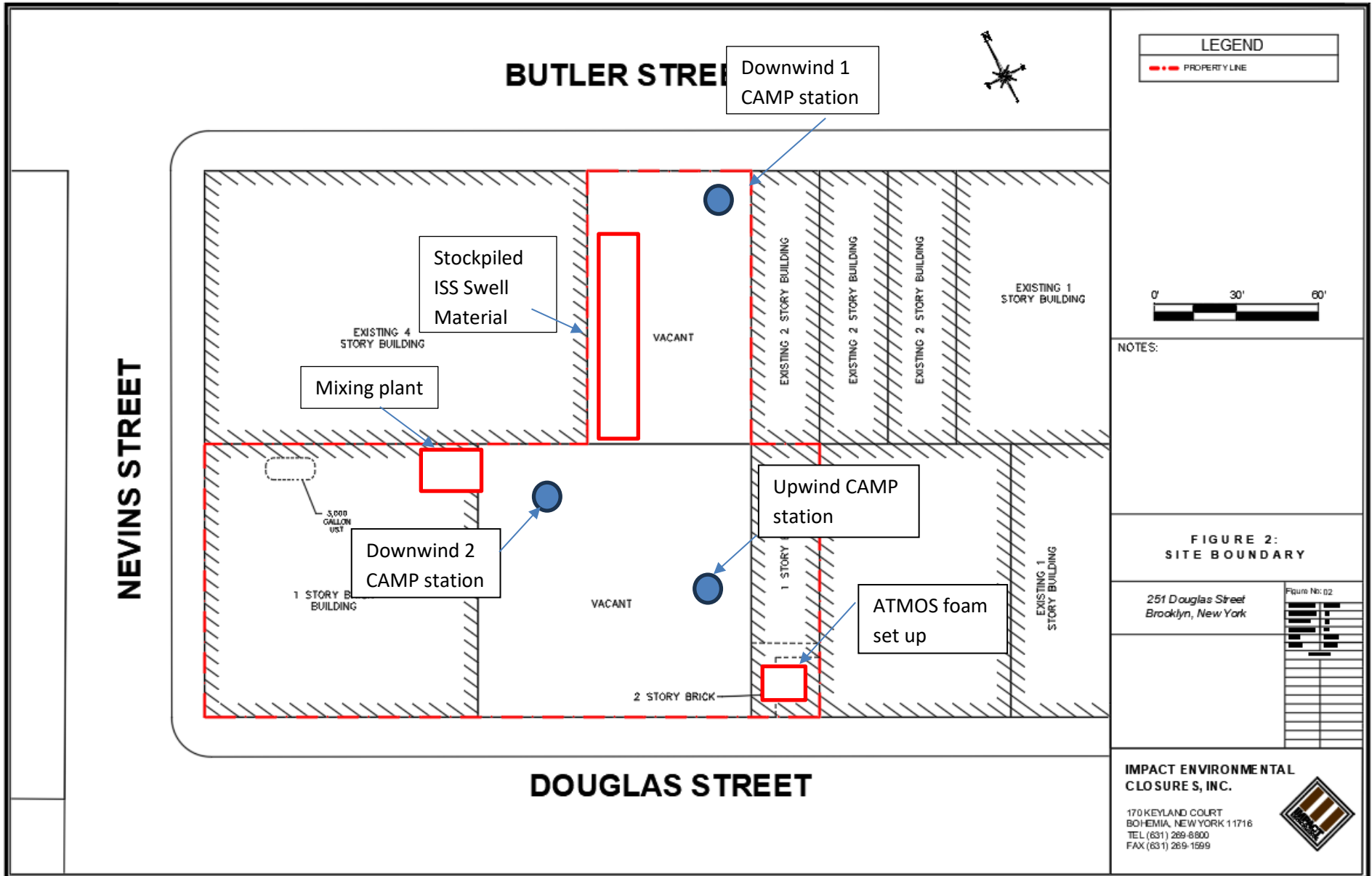

QA/QC SAMPLE POCKET PENETROMETER MEASUREMENT SUMMARY TABLE

251 DOUGLASS STREET, BROOKLYN, NY





TABLE 1
IN-SITU STABILIZATION TREATABILITY STUDY MATRIX

Mix ID		Total Reagent Addition (%)	Water to Reagent Ratio (by Wt)	Penetrometer (TSP)					Sample Log								
				1-Day	2-Day	3-Day	5-Day	7-Day									
Cascade Evaluation																	
Col ID	Date Install																
PIA-155	10/30/2023	8.0	1.25:1	<1.0	<1.0	2.25	2.5	2.75									
PIB-366	10/30/2023	9.0	1.25:1	<1.0	<1.0	2.5	3.25	4.5									
PIA-154	10/30/2023	8.0	1.25:1	<1.0	<1.0	3.5	4.0	>4.5									
PIA-102	11/1/2023	8.0	1.25:1	0.5	1.25	1.5	3.5	4.25 (5 Day) >4.5 (7 Day)									
P2C-25	11/1/2023	10.0	1:1	0.5	1.75	3.0	3.0	4.0 (5 Day) >4.5 (7 Day)									
P2C-24	11/2/2023	10.0	1:1	1.0	1.75	3.25	4.0-4.25										
P2C-23	11/2/2023	10.0	1:1	1.0	1.5	2.75	>4.5										
PIB-304	11/3/2023	9.0	1:1	1.25	1.5	2.5	4.25										
PIB-337	11/6/2023	9.0	1:1	1-1.25	3.0												
PIB-302	11/6/2023	9.0	1:1	1.0	2.75												

UPWIND CAMP READINGS

251 DOUGLASS STREET, BROOKLYN, NY



Instrument Name	DustTrak II
Model Number	8530
Serial Number	8530173225
Firmware Version	3.1
Calibration Date	11/30/2022
Test Name	MANUAL_027
Test Start Time	7:30:57 AM
Test Start Date	11/8/2023
Test Length [D:H:M]	0:06:51
Test Interval [M:S]	1:00
Mass Average [mg/m3]	0.014
Mass Minimum [mg/m3]	0.001
Mass Maximum [mg/m3]	0.163
Mass TWA [mg/m3]	0.013
Photometric User Cal	1
Flow User Cal	0
Errors	
Number of Samples	411

Elapsed Time [s]	TIME	Mass [mg/m3]	Alarms	Errors
0	7:30:57 AM			
60	7:31:57 AM	0.02		
120	7:32:57 AM	0.032		
180	7:33:57 AM	0.018		
240	7:34:57 AM	0.027		
300	7:35:57 AM	0.021		
360	7:36:57 AM	0.02		
420	7:37:57 AM	0.017		
480	7:38:57 AM	0.019		
540	7:39:57 AM	0.017		
600	7:40:57 AM	0.013		
660	7:41:57 AM	0.026		
720	7:42:57 AM	0.019		
780	7:43:57 AM	0.017		
840	7:44:57 AM	0.029		
900	7:45:57 AM	0.012		
960	7:46:57 AM	0.095		
1020	7:47:57 AM	0.01		
1080	7:48:57 AM	0.043		
1140	7:49:57 AM	0.021		
1200	7:50:57 AM	0.033		
1260	7:51:57 AM	0.044		
1320	7:52:57 AM	0.016		
1380	7:53:57 AM	0.014		
1440	7:54:57 AM	0.115		
1500	7:55:57 AM	0.03		
1560	7:56:57 AM	0.006		

1620	7:57:57 AM	0.032
1680	7:58:57 AM	0.033
1740	7:59:57 AM	0.086
1800	8:00:57 AM	0.012
1860	8:01:57 AM	0.012
1920	8:02:57 AM	0.016
1980	8:03:57 AM	0.005
2040	8:04:57 AM	0.023
2100	8:05:57 AM	0.003
2160	8:06:57 AM	0.137
2220	8:07:57 AM	0.027
2280	8:08:57 AM	0.013
2340	8:09:57 AM	0.021
2400	8:10:57 AM	0.017
2460	8:11:57 AM	0.026
2520	8:12:57 AM	0.013
2580	8:13:57 AM	0.124
2640	8:14:57 AM	0.015
2700	8:15:57 AM	0.005
2760	8:16:57 AM	0.006
2820	8:17:57 AM	0.035
2880	8:18:57 AM	0.026
2940	8:19:57 AM	0.116
3000	8:20:57 AM	0.034
3060	8:21:57 AM	0.011
3120	8:22:57 AM	0.014
3180	8:23:57 AM	0.038
3240	8:24:57 AM	0.007
3300	8:25:57 AM	0.008
3360	8:26:57 AM	0.04
3420	8:27:57 AM	0.042
3480	8:28:57 AM	0.015
3540	8:29:57 AM	0.032
3600	8:30:57 AM	0.008
3660	8:31:57 AM	0.095
3720	8:32:57 AM	0.018
3780	8:33:57 AM	0.017
3840	8:34:57 AM	0.011
3900	8:35:57 AM	0.01
3960	8:36:57 AM	0.01
4020	8:37:57 AM	0.008
4080	8:38:57 AM	0.015
4140	8:39:57 AM	0.013
4200	8:40:57 AM	0.012
4260	8:41:57 AM	0.013
4320	8:42:57 AM	0.008
4380	8:43:57 AM	0.01

4440	8:44:57 AM	0.004
4500	8:45:57 AM	0.002
4560	8:46:57 AM	0.007
4620	8:47:57 AM	0.006
4680	8:48:57 AM	0.007
4740	8:49:57 AM	0.009
4800	8:50:57 AM	0.004
4860	8:51:57 AM	0.001
4920	8:52:57 AM	0.002
4980	8:53:57 AM	0.008
5040	8:54:57 AM	0.009
5100	8:55:57 AM	0.006
5160	8:56:57 AM	0.004
5220	8:57:57 AM	0.01
5280	8:58:57 AM	0.008
5340	8:59:57 AM	0.006
5400	9:00:57 AM	0.009
5460	9:01:57 AM	0.023
5520	9:02:57 AM	0.002
5580	9:03:57 AM	0.002
5640	9:04:57 AM	0.004
5700	9:05:57 AM	0.003
5760	9:06:57 AM	0.001
5820	9:07:57 AM	0.004
5880	9:08:57 AM	0.027
5940	9:09:57 AM	0.02
6000	9:10:57 AM	0.022
6060	9:11:57 AM	0.005
6120	9:12:57 AM	0.007
6180	9:13:57 AM	0.022
6240	9:14:57 AM	0.014
6300	9:15:57 AM	0.014
6360	9:16:57 AM	0.009
6420	9:17:57 AM	0.014
6480	9:18:57 AM	0.002
6540	9:19:57 AM	0.001
6600	9:20:57 AM	0.001
6660	9:21:57 AM	0.001
6720	9:22:57 AM	0.001
6780	9:23:57 AM	0.002
6840	9:24:57 AM	0.003
6900	9:25:57 AM	0.001
6960	9:26:57 AM	0.001
7020	9:27:57 AM	0.001
7080	9:28:57 AM	0.003
7140	9:29:57 AM	0.003
7200	9:30:57 AM	0.003

7260	9:31:57 AM	0.018
7320	9:32:57 AM	0.007
7380	9:33:57 AM	0.001
7440	9:34:57 AM	0.001
7500	9:35:57 AM	0.001
7560	9:36:57 AM	0.003
7620	9:37:57 AM	0.003
7680	9:38:57 AM	0.007
7740	9:39:57 AM	0.002
7800	9:40:57 AM	0.003
7860	9:41:57 AM	0.012
7920	9:42:57 AM	0.062
7980	9:43:57 AM	0.01
8040	9:44:57 AM	0.001
8100	9:45:57 AM	0.008
8160	9:46:57 AM	0.003
8220	9:47:57 AM	0.004
8280	9:48:57 AM	0.001
8340	9:49:57 AM	0.001
8400	9:50:57 AM	0.001
8460	9:51:57 AM	0.001
8520	9:52:57 AM	0.001
8580	9:53:57 AM	0.001
8640	9:54:57 AM	0.001
8700	9:55:57 AM	0.002
8760	9:56:57 AM	0.022
8820	9:57:57 AM	0.019
8880	9:58:57 AM	0.004
8940	9:59:57 AM	0.006
9000	10:00:57 AM	0.018
9060	10:01:57 AM	0.007
9120	10:02:57 AM	0.016
9180	10:03:57 AM	0.009
9240	10:04:57 AM	0.001
9300	10:05:57 AM	0.001
9360	10:06:57 AM	0.002
9420	10:07:57 AM	0.001
9480	10:08:57 AM	0.001
9540	10:09:57 AM	0.001
9600	10:10:57 AM	0.001
9660	10:11:57 AM	0.001
9720	10:12:57 AM	0.001
9780	10:13:57 AM	0.001
9840	10:14:57 AM	0.001
9900	10:15:57 AM	0.001
9960	10:16:57 AM	0.001
10020	10:17:57 AM	0.001

10080	10:18:57 AM	0.001
10140	10:19:57 AM	0.001
10200	10:20:57 AM	0.001
10260	10:21:57 AM	0.001
10320	10:22:57 AM	0.001
10380	10:23:57 AM	0.001
10440	10:24:57 AM	0.024
10500	10:25:57 AM	0.002
10560	10:26:57 AM	0.002
10620	10:27:57 AM	0.002
10680	10:28:57 AM	0.002
10740	10:29:57 AM	0.002
10800	10:30:57 AM	0.001
10860	10:31:57 AM	0.015
10920	10:32:57 AM	0.002
10980	10:33:57 AM	0.002
11040	10:34:57 AM	0.002
11100	10:35:57 AM	0.001
11160	10:36:57 AM	0.001
11220	10:37:57 AM	0.002
11280	10:38:57 AM	0.004
11340	10:39:57 AM	0.006
11400	10:40:57 AM	0.005
11460	10:41:57 AM	0.006
11520	10:42:57 AM	0.006
11580	10:43:57 AM	0.006
11640	10:44:57 AM	0.008
11700	10:45:57 AM	0.012
11760	10:46:57 AM	0.022
11820	10:47:57 AM	0.009
11880	10:48:57 AM	0.005
11940	10:49:57 AM	0.007
12000	10:50:57 AM	0.005
12060	10:51:57 AM	0.006
12120	10:52:57 AM	0.007
12180	10:53:57 AM	0.017
12240	10:54:57 AM	0.023
12300	10:55:57 AM	0.008
12360	10:56:57 AM	0.01
12420	10:57:57 AM	0.005
12480	10:58:57 AM	0.009
12540	10:59:57 AM	0.007
12600	11:00:57 AM	0.008
12660	11:01:57 AM	0.007
12720	11:02:57 AM	0.142
12780	11:03:57 AM	0.014
12840	11:04:57 AM	0.019

12900	11:05:57 AM	0.018
12960	11:06:57 AM	0.005
13020	11:07:57 AM	0.004
13080	11:08:57 AM	0.009
13140	11:09:57 AM	0.009
13200	11:10:57 AM	0.003
13260	11:11:57 AM	0.009
13320	11:12:57 AM	0.001
13380	11:13:57 AM	0.001
13440	11:14:57 AM	0.002
13500	11:15:57 AM	0.001
13560	11:16:57 AM	0.001
13620	11:17:57 AM	0.003
13680	11:18:57 AM	0.002
13740	11:19:57 AM	0.002
13800	11:20:57 AM	0.001
13860	11:21:57 AM	0.001
13920	11:22:57 AM	0.001
13980	11:23:57 AM	0.011
14040	11:24:57 AM	0.005
14100	11:25:57 AM	0.002
14160	11:26:57 AM	0.003
14220	11:27:57 AM	0.03
14280	11:28:57 AM	0.014
14340	11:29:57 AM	0.005
14400	11:30:57 AM	0.005
14460	11:31:57 AM	0.004
14520	11:32:57 AM	0.006
14580	11:33:57 AM	0.007
14640	11:34:57 AM	0.035
14700	11:35:57 AM	0.043
14760	11:36:57 AM	0.004
14820	11:37:57 AM	0.003
14880	11:38:57 AM	0.005
14940	11:39:57 AM	0.005
15000	11:40:57 AM	0.015
15060	11:41:57 AM	0.019
15120	11:42:57 AM	0.013
15180	11:43:57 AM	0.011
15240	11:44:57 AM	0.026
15300	11:45:57 AM	0.025
15360	11:46:57 AM	0.028
15420	11:47:57 AM	0.006
15480	11:48:57 AM	0.007
15540	11:49:57 AM	0.005
15600	11:50:57 AM	0.006
15660	11:51:57 AM	0.007

15720	11:52:57 AM	0.009
15780	11:53:57 AM	0.028
15840	11:54:57 AM	0.013
15900	11:55:57 AM	0.032
15960	11:56:57 AM	0.004
16020	11:57:57 AM	0.005
16080	11:58:57 AM	0.006
16140	11:59:57 AM	0.002
16200	12:00:57 PM	0.002
16260	12:01:57 PM	0.001
16320	12:02:57 PM	0.011
16380	12:03:57 PM	0.02
16440	12:04:57 PM	0.013
16500	12:05:57 PM	0.064
16560	12:06:57 PM	0.016
16620	12:07:57 PM	0.004
16680	12:08:57 PM	0.005
16740	12:09:57 PM	0.004
16800	12:10:57 PM	0.006
16860	12:11:57 PM	0.004
16920	12:12:57 PM	0.005
16980	12:13:57 PM	0.003
17040	12:14:57 PM	0.163
17100	12:15:57 PM	0.002
17160	12:16:57 PM	0.023
17220	12:17:57 PM	0.012
17280	12:18:57 PM	0.007
17340	12:19:57 PM	0.001
17400	12:20:57 PM	0.001
17460	12:21:57 PM	0.001
17520	12:22:57 PM	0.001
17580	12:23:57 PM	0.001
17640	12:24:57 PM	0.001
17700	12:25:57 PM	0.001
17760	12:26:57 PM	0.002
17820	12:27:57 PM	0.001
17880	12:28:57 PM	0.001
17940	12:29:57 PM	0.001
18000	12:30:57 PM	0.001
18060	12:31:57 PM	0.004
18120	12:32:57 PM	0.002
18180	12:33:57 PM	0.021
18240	12:34:57 PM	0.001
18300	12:35:57 PM	0.002
18360	12:36:57 PM	0.001
18420	12:37:57 PM	0.002
18480	12:38:57 PM	0.003

18540	12:39:57 PM	0.009
18600	12:40:57 PM	0.011
18660	12:41:57 PM	0.002
18720	12:42:57 PM	0.063
18780	12:43:57 PM	0.001
18840	12:44:57 PM	0.001
18900	12:45:57 PM	0.002
18960	12:46:57 PM	0.003
19020	12:47:57 PM	0.002
19080	12:48:57 PM	0.002
19140	12:49:57 PM	0.002
19200	12:50:57 PM	0.002
19260	12:51:57 PM	0.01
19320	12:52:57 PM	0.002
19380	12:53:57 PM	0.004
19440	12:54:57 PM	0.072
19500	12:55:57 PM	0.022
19560	12:56:57 PM	0.012
19620	12:57:57 PM	0.006
19680	12:58:57 PM	0.006
19740	12:59:57 PM	0.001
19800	1:00:57 PM	0.001
19860	1:01:57 PM	0.001
19920	1:02:57 PM	0.003
19980	1:03:57 PM	0.003
20040	1:04:57 PM	0.003
20100	1:05:57 PM	0.02
20160	1:06:57 PM	0.014
20220	1:07:57 PM	0.023
20280	1:08:57 PM	0.019
20340	1:09:57 PM	0.009
20400	1:10:57 PM	0.052
20460	1:11:57 PM	0.026
20520	1:12:57 PM	0.003
20580	1:13:57 PM	0.008
20640	1:14:57 PM	0.007
20700	1:15:57 PM	0.14
20760	1:16:57 PM	0.003
20820	1:17:57 PM	0.002
20880	1:18:57 PM	0.004
20940	1:19:57 PM	0.001
21000	1:20:57 PM	0.001
21060	1:21:57 PM	0.014
21120	1:22:57 PM	0.004
21180	1:23:57 PM	0.009
21240	1:24:57 PM	0.003
21300	1:25:57 PM	0.003

21360	1:26:57 PM	0.003
21420	1:27:57 PM	0.003
21480	1:28:57 PM	0.001
21540	1:29:57 PM	0.001
21600	1:30:57 PM	0.001
21660	1:31:57 PM	0.001
21720	1:32:57 PM	0.001
21780	1:33:57 PM	0.001
21840	1:34:57 PM	0.001
21900	1:35:57 PM	0.001
21960	1:36:57 PM	0.002
22020	1:37:57 PM	0.001
22080	1:38:57 PM	0.004
22140	1:39:57 PM	0.004
22200	1:40:57 PM	0.001
22260	1:41:57 PM	0.001
22320	1:42:57 PM	0.003
22380	1:43:57 PM	0.002
22440	1:44:57 PM	0.001
22500	1:45:57 PM	0.018
22560	1:46:57 PM	0.004
22620	1:47:57 PM	0.001
22680	1:48:57 PM	0.001
22740	1:49:57 PM	0.002
22800	1:50:57 PM	0.004
22860	1:51:57 PM	0.003
22920	1:52:57 PM	0.021
22980	1:53:57 PM	0.008
23040	1:54:57 PM	0.005
23100	1:55:57 PM	0.003
23160	1:56:57 PM	0.001
23220	1:57:57 PM	0.001
23280	1:58:57 PM	0.058
23340	1:59:57 PM	0.069
23400	2:00:57 PM	0.058
23460	2:01:57 PM	0.021
23520	2:02:57 PM	0.009
23580	2:03:57 PM	0.007
23640	2:04:57 PM	0.021
23700	2:05:57 PM	0.007
23760	2:06:57 PM	0.014
23820	2:07:57 PM	0.016
23880	2:08:57 PM	0.014
23940	2:09:57 PM	0.01
24000	2:10:57 PM	0.018
24060	2:11:57 PM	0.03
24120	2:12:57 PM	0.036

24180	2:13:57 PM	0.077
24240	2:14:57 PM	0.031
24300	2:15:57 PM	0.013
24360	2:16:57 PM	0.012
24420	2:17:57 PM	0.012
24480	2:18:57 PM	0.012
24540	2:19:57 PM	0.019
24600	2:20:57 PM	0.009
24660	2:21:57 PM	0.01

Device Serial No	Log Time	Log Type	Sensor 1 Type	Sensor 1 Serial Number	Sensor 1 Status	Sensor 1 Gas Reading
592-602816	11/8/2023 15:21	Readings	PID	SC23030324C7	Normal	0.9
592-602816	11/8/2023 15:20	Readings	PID	SC23030324C7	Normal	0.7
592-602816	11/8/2023 15:19	Readings	PID	SC23030324C7	Normal	0.6
592-602816	11/8/2023 15:18	Readings	PID	SC23030324C7	Normal	0.5
592-602816	11/8/2023 15:17	Readings	PID	SC23030324C7	Normal	0.5
592-602816	11/8/2023 15:16	Readings	PID	SC23030324C7	Normal	0.5
592-602816	11/8/2023 15:15	Readings	PID	SC23030324C7	Normal	0.4
592-602816	11/8/2023 15:14	Readings	PID	SC23030324C7	Normal	0.4
592-602816	11/8/2023 15:13	Readings	PID	SC23030324C7	Normal	0.3
592-602816	11/8/2023 15:12	Readings	PID	SC23030324C7	Normal	0.3
592-602816	11/8/2023 15:11	Readings	PID	SC23030324C7	Normal	0.1
592-602816	11/8/2023 15:10	Readings	PID	SC23030324C7	Normal	0.1
592-602816	11/8/2023 15:09	Readings	PID	SC23030324C7	Normal	0.1
592-602816	11/8/2023 15:08	Readings	PID	SC23030324C7	Normal	0.1
592-602816	11/8/2023 15:07	Readings	PID	SC23030324C7	Normal	0.1
592-602816	11/8/2023 15:06	Readings	PID	SC23030324C7	Normal	0.1
592-602816	11/8/2023 15:05	Readings	PID	SC23030324C7	Normal	0.1
592-602816	11/8/2023 15:04	Readings	PID	SC23030324C7	Normal	0.1
592-602816	11/8/2023 15:03	Readings	PID	SC23030324C7	Normal	0.2
592-602816	11/8/2023 15:02	Readings	PID	SC23030324C7	Normal	0.2
592-602816	11/8/2023 15:01	Readings	PID	SC23030324C7	Normal	0.2
592-602816	11/8/2023 15:00	Readings	PID	SC23030324C7	Normal	0.2
592-602816	11/8/2023 14:59	Readings	PID	SC23030324C7	Normal	0.2
592-602816	11/8/2023 14:58	Readings	PID	SC23030324C7	Normal	0.2
592-602816	11/8/2023 14:57	Readings	PID	SC23030324C7	Normal	0.2
592-602816	11/8/2023 14:56	Readings	PID	SC23030324C7	Normal	0.3
592-602816	11/8/2023 14:55	Readings	PID	SC23030324C7	Normal	0.2
592-602816	11/8/2023 14:54	Readings	PID	SC23030324C7	Normal	0.2
592-602816	11/8/2023 14:53	Readings	PID	SC23030324C7	Normal	0.3
592-602816	11/8/2023 14:52	Readings	PID	SC23030324C7	Normal	0.3
592-602816	11/8/2023 14:51	Readings	PID	SC23030324C7	Normal	0.3
592-602816	11/8/2023 14:50	Readings	PID	SC23030324C7	Normal	0.2
592-602816	11/8/2023 14:49	Readings	PID	SC23030324C7	Normal	0.2
592-602816	11/8/2023 14:48	Readings	PID	SC23030324C7	Normal	0.2

592-602816	11/8/2023 10:07	Readings	PID	SC23030324C7	Normal	0.3
592-602816	11/8/2023 10:06	Readings	PID	SC23030324C7	Normal	0.4
592-602816	11/8/2023 10:05	Readings	PID	SC23030324C7	Normal	0.4
592-602816	11/8/2023 10:04	Readings	PID	SC23030324C7	Normal	0.4
592-602816	11/8/2023 10:03	Readings	PID	SC23030324C7	Normal	0.5
592-602816	11/8/2023 10:02	Readings	PID	SC23030324C7	Normal	0.3
592-602816	11/8/2023 10:01	Readings	PID	SC23030324C7	Normal	0.3
592-602816	11/8/2023 10:00	Readings	PID	SC23030324C7	Normal	0.3
592-602816	11/8/2023 9:59	Readings	PID	SC23030324C7	Normal	0.4
592-602816	11/8/2023 9:58	Readings	PID	SC23030324C7	Normal	0.4
592-602816	11/8/2023 9:57	Readings	PID	SC23030324C7	Normal	0.4
592-602816	11/8/2023 9:56	Readings	PID	SC23030324C7	Normal	0.3
592-602816	11/8/2023 9:55	Readings	PID	SC23030324C7	Normal	0.3
592-602816	11/8/2023 9:54	Readings	PID	SC23030324C7	Normal	0.3
592-602816	11/8/2023 9:53	Readings	PID	SC23030324C7	Normal	0.3
592-602816	11/8/2023 9:52	Readings	PID	SC23030324C7	Normal	0.4
592-602816	11/8/2023 9:51	Readings	PID	SC23030324C7	Normal	0.3
592-602816	11/8/2023 9:50	Readings	PID	SC23030324C7	Normal	0.3
592-602816	11/8/2023 9:49	Readings	PID	SC23030324C7	Normal	0.3
592-602816	11/8/2023 9:48	Readings	PID	SC23030324C7	Normal	0.3
592-602816	11/8/2023 9:47	Readings	PID	SC23030324C7	Normal	0.3
592-602816	11/8/2023 9:46	Readings	PID	SC23030324C7	Normal	0.3
592-602816	11/8/2023 9:45	Readings	PID	SC23030324C7	Normal	0.3
592-602816	11/8/2023 9:44	Readings	PID	SC23030324C7	Normal	0.4
592-602816	11/8/2023 9:43	Readings	PID	SC23030324C7	Normal	0.3
592-602816	11/8/2023 9:42	Readings	PID	SC23030324C7	Normal	0.4
592-602816	11/8/2023 9:41	Readings	PID	SC23030324C7	Normal	0.3
592-602816	11/8/2023 9:40	Readings	PID	SC23030324C7	Normal	0.4
592-602816	11/8/2023 9:39	Readings	PID	SC23030324C7	Normal	0.3
592-602816	11/8/2023 9:38	Readings	PID	SC23030324C7	Normal	0.3
592-602816	11/8/2023 9:37	Readings	PID	SC23030324C7	Normal	0.3
592-602816	11/8/2023 9:36	Readings	PID	SC23030324C7	Normal	0.3
592-602816	11/8/2023 9:35	Readings	PID	SC23030324C7	Normal	0.3
592-602816	11/8/2023 9:34	Readings	PID	SC23030324C7	Normal	0.3
592-602816	11/8/2023 9:33	Readings	PID	SC23030324C7	Normal	0.3

592-602816	11/8/2023 8:57	Readings	PID	SC23030324C7	Normal	0.2
592-602816	11/8/2023 8:56	Readings	PID	SC23030324C7	Normal	0.2
592-602816	11/8/2023 8:55	Readings	PID	SC23030324C7	Normal	0.2
592-602816	11/8/2023 8:54	Readings	PID	SC23030324C7	Normal	0.2
592-602816	11/8/2023 8:53	Readings	PID	SC23030324C7	Normal	0.2
592-602816	11/8/2023 8:52	Readings	PID	SC23030324C7	Normal	0.2
592-602816	11/8/2023 8:51	Readings	PID	SC23030324C7	Normal	0.2
592-602816	11/8/2023 8:50	Readings	PID	SC23030324C7	Normal	0.2
592-602816	11/8/2023 8:49	Readings	PID	SC23030324C7	Normal	0.2
592-602816	11/8/2023 8:48	Readings	PID	SC23030324C7	Normal	0.2
592-602816	11/8/2023 8:47	Readings	PID	SC23030324C7	Normal	0.2
592-602816	11/8/2023 8:46	Readings	PID	SC23030324C7	Normal	0.1
592-602816	11/8/2023 8:45	Readings	PID	SC23030324C7	Normal	0.1
592-602816	11/8/2023 8:44	Readings	PID	SC23030324C7	Normal	0.1
592-602816	11/8/2023 8:43	Readings	PID	SC23030324C7	Normal	0.1
592-602816	11/8/2023 8:42	Readings	PID	SC23030324C7	Normal	0.1
592-602816	11/8/2023 8:41	Readings	PID	SC23030324C7	Normal	0.1
592-602816	11/8/2023 8:40	Readings	PID	SC23030324C7	Normal	0.1
592-602816	11/8/2023 8:39	Readings	PID	SC23030324C7	Normal	0.1
592-602816	11/8/2023 8:38	Readings	PID	SC23030324C7	Normal	0.1
592-602816	11/8/2023 8:37	Readings	PID	SC23030324C7	Normal	0
592-602816	11/8/2023 8:36	Readings	PID	SC23030324C7	Normal	0
592-602816	11/8/2023 8:35	Readings	PID	SC23030324C7	Normal	0
592-602816	11/8/2023 8:34	Readings	PID	SC23030324C7	Normal	0
592-602816	11/8/2023 8:33	Readings	PID	SC23030324C7	Normal	0
592-602816	11/8/2023 8:32	Readings	PID	SC23030324C7	Normal	0
592-602816	11/8/2023 8:31	CONFIG	PID	SC23030324C7		

DOWNWIND CAMP READINGS

251 DOUGLASS STREET, BROOKLYN, NY



Instrument Name	DustTrak II
Model Number	8530
Serial Number	8530113005
Firmware Version	3.1
Calibration Date	2/11/2023
Test Name	MANUAL_009
Test Start Time	7:24:13 AM
Test Start Date	11/8/2023
Test Length [D:H:M]	0:07:28
Test Interval [M:S]	1:00
Mass Average [mg/m3]	0.017
Mass Minimum [mg/m3]	0.006
Mass Maximum [mg/m3]	0.08
Mass TWA [mg/m3]	0.017
Photometric User Cal	1
Flow User Cal	0
Errors	
Number of Samples	454

Elapsed Time [s]	TIME	Mass [mg/m3]	Alarms	Errors
0	7:24:13 AM			
60	7:25:13 AM	0.041		
120	7:26:13 AM	0.055		
180	7:27:13 AM	0.05		
240	7:28:13 AM	0.071		
300	7:29:13 AM	0.063		
360	7:30:13 AM	0.045		
420	7:31:13 AM	0.042		
480	7:32:13 AM	0.033		
540	7:33:13 AM	0.035		
600	7:34:13 AM	0.032		
660	7:35:13 AM	0.027		
720	7:36:13 AM	0.028		
780	7:37:13 AM	0.027		
840	7:38:13 AM	0.025		
900	7:39:13 AM	0.066		
960	7:40:13 AM	0.043		
1020	7:41:13 AM	0.028		
1080	7:42:13 AM	0.023		
1140	7:43:13 AM	0.08		
1200	7:44:13 AM	0.025		
1260	7:45:13 AM	0.02		
1320	7:46:13 AM	0.022		
1380	7:47:13 AM	0.023		
1440	7:48:13 AM	0.02		
1500	7:49:13 AM	0.036		
1560	7:50:13 AM	0.05		

1620	7:51:13 AM	0.026
1680	7:52:13 AM	0.023
1740	7:53:13 AM	0.019
1800	7:54:13 AM	0.022
1860	7:55:13 AM	0.024
1920	7:56:13 AM	0.022
1980	7:57:13 AM	0.022
2040	7:58:13 AM	0.021
2100	7:59:13 AM	0.022
2160	8:00:13 AM	0.018
2220	8:01:13 AM	0.018
2280	8:02:13 AM	0.02
2340	8:03:13 AM	0.018
2400	8:04:13 AM	0.022
2460	8:05:13 AM	0.018
2520	8:06:13 AM	0.018
2580	8:07:13 AM	0.017
2640	8:08:13 AM	0.019
2700	8:09:13 AM	0.019
2760	8:10:13 AM	0.017
2820	8:11:13 AM	0.017
2880	8:12:13 AM	0.015
2940	8:13:13 AM	0.016
3000	8:14:13 AM	0.016
3060	8:15:13 AM	0.017
3120	8:16:13 AM	0.021
3180	8:17:13 AM	0.022
3240	8:18:13 AM	0.02
3300	8:19:13 AM	0.017
3360	8:20:13 AM	0.015
3420	8:21:13 AM	0.016
3480	8:22:13 AM	0.019
3540	8:23:13 AM	0.014
3600	8:24:13 AM	0.014
3660	8:25:13 AM	0.016
3720	8:26:13 AM	0.015
3780	8:27:13 AM	0.015
3840	8:28:13 AM	0.017
3900	8:29:13 AM	0.014
3960	8:30:13 AM	0.014
4020	8:31:13 AM	0.014
4080	8:32:13 AM	0.015
4140	8:33:13 AM	0.015
4200	8:34:13 AM	0.017
4260	8:35:13 AM	0.016
4320	8:36:13 AM	0.016
4380	8:37:13 AM	0.021

4440	8:38:13 AM	0.017
4500	8:39:13 AM	0.02
4560	8:40:13 AM	0.021
4620	8:41:13 AM	0.019
4680	8:42:13 AM	0.024
4740	8:43:13 AM	0.021
4800	8:44:13 AM	0.022
4860	8:45:13 AM	0.017
4920	8:46:13 AM	0.016
4980	8:47:13 AM	0.017
5040	8:48:13 AM	0.015
5100	8:49:13 AM	0.015
5160	8:50:13 AM	0.027
5220	8:51:13 AM	0.023
5280	8:52:13 AM	0.019
5340	8:53:13 AM	0.02
5400	8:54:13 AM	0.018
5460	8:55:13 AM	0.018
5520	8:56:13 AM	0.016
5580	8:57:13 AM	0.014
5640	8:58:13 AM	0.01
5700	8:59:13 AM	0.013
5760	9:00:13 AM	0.01
5820	9:01:13 AM	0.011
5880	9:02:13 AM	0.012
5940	9:03:13 AM	0.009
6000	9:04:13 AM	0.012
6060	9:05:13 AM	0.012
6120	9:06:13 AM	0.01
6180	9:07:13 AM	0.01
6240	9:08:13 AM	0.012
6300	9:09:13 AM	0.01
6360	9:10:13 AM	0.014
6420	9:11:13 AM	0.012
6480	9:12:13 AM	0.009
6540	9:13:13 AM	0.009
6600	9:14:13 AM	0.011
6660	9:15:13 AM	0.012
6720	9:16:13 AM	0.009
6780	9:17:13 AM	0.008
6840	9:18:13 AM	0.009
6900	9:19:13 AM	0.009
6960	9:20:13 AM	0.02
7020	9:21:13 AM	0.012
7080	9:22:13 AM	0.009
7140	9:23:13 AM	0.008
7200	9:24:13 AM	0.009

7260	9:25:13 AM	0.01
7320	9:26:13 AM	0.01
7380	9:27:13 AM	0.01
7440	9:28:13 AM	0.01
7500	9:29:13 AM	0.01
7560	9:30:13 AM	0.012
7620	9:31:13 AM	0.01
7680	9:32:13 AM	0.01
7740	9:33:13 AM	0.01
7800	9:34:13 AM	0.014
7860	9:35:13 AM	0.009
7920	9:36:13 AM	0.01
7980	9:37:13 AM	0.009
8040	9:38:13 AM	0.007
8100	9:39:13 AM	0.009
8160	9:40:13 AM	0.028
8220	9:41:13 AM	0.041
8280	9:42:13 AM	0.027
8340	9:43:13 AM	0.016
8400	9:44:13 AM	0.038
8460	9:45:13 AM	0.018
8520	9:46:13 AM	0.012
8580	9:47:13 AM	0.017
8640	9:48:13 AM	0.028
8700	9:49:13 AM	0.018
8760	9:50:13 AM	0.011
8820	9:51:13 AM	0.016
8880	9:52:13 AM	0.011
8940	9:53:13 AM	0.012
9000	9:54:13 AM	0.013
9060	9:55:13 AM	0.012
9120	9:56:13 AM	0.01
9180	9:57:13 AM	0.009
9240	9:58:13 AM	0.01
9300	9:59:13 AM	0.012
9360	10:00:13 AM	0.014
9420	10:01:13 AM	0.011
9480	10:02:13 AM	0.015
9540	10:03:13 AM	0.011
9600	10:04:13 AM	0.017
9660	10:05:13 AM	0.011
9720	10:06:13 AM	0.013
9780	10:07:13 AM	0.009
9840	10:08:13 AM	0.009
9900	10:09:13 AM	0.008
9960	10:10:13 AM	0.009
10020	10:11:13 AM	0.008

10080	10:12:13 AM	0.01
10140	10:13:13 AM	0.012
10200	10:14:13 AM	0.012
10260	10:15:13 AM	0.011
10320	10:16:13 AM	0.009
10380	10:17:13 AM	0.008
10440	10:18:13 AM	0.008
10500	10:19:13 AM	0.008
10560	10:20:13 AM	0.008
10620	10:21:13 AM	0.009
10680	10:22:13 AM	0.008
10740	10:23:13 AM	0.009
10800	10:24:13 AM	0.009
10860	10:25:13 AM	0.009
10920	10:26:13 AM	0.008
10980	10:27:13 AM	0.008
11040	10:28:13 AM	0.008
11100	10:29:13 AM	0.011
11160	10:30:13 AM	0.008
11220	10:31:13 AM	0.011
11280	10:32:13 AM	0.01
11340	10:33:13 AM	0.01
11400	10:34:13 AM	0.01
11460	10:35:13 AM	0.01
11520	10:36:13 AM	0.009
11580	10:37:13 AM	0.01
11640	10:38:13 AM	0.011
11700	10:39:13 AM	0.01
11760	10:40:13 AM	0.01
11820	10:41:13 AM	0.011
11880	10:42:13 AM	0.011
11940	10:43:13 AM	0.011
12000	10:44:13 AM	0.014
12060	10:45:13 AM	0.016
12120	10:46:13 AM	0.015
12180	10:47:13 AM	0.016
12240	10:48:13 AM	0.016
12300	10:49:13 AM	0.021
12360	10:50:13 AM	0.02
12420	10:51:13 AM	0.017
12480	10:52:13 AM	0.025
12540	10:53:13 AM	0.02
12600	10:54:13 AM	0.014
12660	10:55:13 AM	0.018
12720	10:56:13 AM	0.014
12780	10:57:13 AM	0.015
12840	10:58:13 AM	0.018

12900	10:59:13 AM	0.015
12960	11:00:13 AM	0.02
13020	11:01:13 AM	0.017
13080	11:02:13 AM	0.016
13140	11:03:13 AM	0.021
13200	11:04:13 AM	0.026
13260	11:05:13 AM	0.026
13320	11:06:13 AM	0.023
13380	11:07:13 AM	0.015
13440	11:08:13 AM	0.015
13500	11:09:13 AM	0.02
13560	11:10:13 AM	0.014
13620	11:11:13 AM	0.023
13680	11:12:13 AM	0.018
13740	11:13:13 AM	0.028
13800	11:14:13 AM	0.022
13860	11:15:13 AM	0.018
13920	11:16:13 AM	0.014
13980	11:17:13 AM	0.019
14040	11:18:13 AM	0.014
14100	11:19:13 AM	0.011
14160	11:20:13 AM	0.01
14220	11:21:13 AM	0.01
14280	11:22:13 AM	0.011
14340	11:23:13 AM	0.01
14400	11:24:13 AM	0.012
14460	11:25:13 AM	0.011
14520	11:26:13 AM	0.011
14580	11:27:13 AM	0.011
14640	11:28:13 AM	0.01
14700	11:29:13 AM	0.009
14760	11:30:13 AM	0.009
14820	11:31:13 AM	0.012
14880	11:32:13 AM	0.012
14940	11:33:13 AM	0.012
15000	11:34:13 AM	0.016
15060	11:35:13 AM	0.024
15120	11:36:13 AM	0.015
15180	11:37:13 AM	0.017
15240	11:38:13 AM	0.014
15300	11:39:13 AM	0.016
15360	11:40:13 AM	0.023
15420	11:41:13 AM	0.018
15480	11:42:13 AM	0.014
15540	11:43:13 AM	0.014
15600	11:44:13 AM	0.013
15660	11:45:13 AM	0.021

15720	11:46:13 AM	0.018
15780	11:47:13 AM	0.014
15840	11:48:13 AM	0.016
15900	11:49:13 AM	0.017
15960	11:50:13 AM	0.019
16020	11:51:13 AM	0.015
16080	11:52:13 AM	0.018
16140	11:53:13 AM	0.014
16200	11:54:13 AM	0.013
16260	11:55:13 AM	0.013
16320	11:56:13 AM	0.016
16380	11:57:13 AM	0.024
16440	11:58:13 AM	0.016
16500	11:59:13 AM	0.018
16560	12:00:13 PM	0.025
16620	12:01:13 PM	0.012
16680	12:02:13 PM	0.013
16740	12:03:13 PM	0.015
16800	12:04:13 PM	0.016
16860	12:05:13 PM	0.018
16920	12:06:13 PM	0.02
16980	12:07:13 PM	0.02
17040	12:08:13 PM	0.014
17100	12:09:13 PM	0.015
17160	12:10:13 PM	0.012
17220	12:11:13 PM	0.016
17280	12:12:13 PM	0.013
17340	12:13:13 PM	0.013
17400	12:14:13 PM	0.014
17460	12:15:13 PM	0.012
17520	12:16:13 PM	0.01
17580	12:17:13 PM	0.009
17640	12:18:13 PM	0.009
17700	12:19:13 PM	0.011
17760	12:20:13 PM	0.011
17820	12:21:13 PM	0.011
17880	12:22:13 PM	0.012
17940	12:23:13 PM	0.01
18000	12:24:13 PM	0.011
18060	12:25:13 PM	0.01
18120	12:26:13 PM	0.008
18180	12:27:13 PM	0.009
18240	12:28:13 PM	0.009
18300	12:29:13 PM	0.01
18360	12:30:13 PM	0.009
18420	12:31:13 PM	0.008
18480	12:32:13 PM	0.008

18540	12:33:13 PM	0.01
18600	12:34:13 PM	0.016
18660	12:35:13 PM	0.01
18720	12:36:13 PM	0.01
18780	12:37:13 PM	0.009
18840	12:38:13 PM	0.01
18900	12:39:13 PM	0.009
18960	12:40:13 PM	0.013
19020	12:41:13 PM	0.009
19080	12:42:13 PM	0.009
19140	12:43:13 PM	0.009
19200	12:44:13 PM	0.008
19260	12:45:13 PM	0.012
19320	12:46:13 PM	0.01
19380	12:47:13 PM	0.007
19440	12:48:13 PM	0.008
19500	12:49:13 PM	0.016
19560	12:50:13 PM	0.011
19620	12:51:13 PM	0.007
19680	12:52:13 PM	0.011
19740	12:53:13 PM	0.007
19800	12:54:13 PM	0.006
19860	12:55:13 PM	0.009
19920	12:56:13 PM	0.009
19980	12:57:13 PM	0.008
20040	12:58:13 PM	0.011
20100	12:59:13 PM	0.011
20160	1:00:13 PM	0.009
20220	1:01:13 PM	0.009
20280	1:02:13 PM	0.007
20340	1:03:13 PM	0.017
20400	1:04:13 PM	0.02
20460	1:05:13 PM	0.012
20520	1:06:13 PM	0.006
20580	1:07:13 PM	0.009
20640	1:08:13 PM	0.011
20700	1:09:13 PM	0.009
20760	1:10:13 PM	0.01
20820	1:11:13 PM	0.01
20880	1:12:13 PM	0.009
20940	1:13:13 PM	0.012
21000	1:14:13 PM	0.012
21060	1:15:13 PM	0.011
21120	1:16:13 PM	0.011
21180	1:17:13 PM	0.011
21240	1:18:13 PM	0.01
21300	1:19:13 PM	0.008

21360	1:20:13 PM	0.007
21420	1:21:13 PM	0.008
21480	1:22:13 PM	0.008
21540	1:23:13 PM	0.018
21600	1:24:13 PM	0.008
21660	1:25:13 PM	0.008
21720	1:26:13 PM	0.008
21780	1:27:13 PM	0.009
21840	1:28:13 PM	0.01
21900	1:29:13 PM	0.008
21960	1:30:13 PM	0.008
22020	1:31:13 PM	0.016
22080	1:32:13 PM	0.019
22140	1:33:13 PM	0.006
22200	1:34:13 PM	0.007
22260	1:35:13 PM	0.008
22320	1:36:13 PM	0.006
22380	1:37:13 PM	0.006
22440	1:38:13 PM	0.013
22500	1:39:13 PM	0.011
22560	1:40:13 PM	0.01
22620	1:41:13 PM	0.009
22680	1:42:13 PM	0.009
22740	1:43:13 PM	0.009
22800	1:44:13 PM	0.008
22860	1:45:13 PM	0.015
22920	1:46:13 PM	0.012
22980	1:47:13 PM	0.014
23040	1:48:13 PM	0.01
23100	1:49:13 PM	0.007
23160	1:50:13 PM	0.007
23220	1:51:13 PM	0.006
23280	1:52:13 PM	0.007
23340	1:53:13 PM	0.006
23400	1:54:13 PM	0.007
23460	1:55:13 PM	0.007
23520	1:56:13 PM	0.007
23580	1:57:13 PM	0.01
23640	1:58:13 PM	0.01
23700	1:59:13 PM	0.011
23760	2:00:13 PM	0.014
23820	2:01:13 PM	0.011
23880	2:02:13 PM	0.011
23940	2:03:13 PM	0.011
24000	2:04:13 PM	0.018
24060	2:05:13 PM	0.016
24120	2:06:13 PM	0.015

24180	2:07:13 PM	0.016
24240	2:08:13 PM	0.015
24300	2:09:13 PM	0.011
24360	2:10:13 PM	0.014
24420	2:11:13 PM	0.013
24480	2:12:13 PM	0.014
24540	2:13:13 PM	0.016
24600	2:14:13 PM	0.027
24660	2:15:13 PM	0.029
24720	2:16:13 PM	0.022
24780	2:17:13 PM	0.019
24840	2:18:13 PM	0.021
24900	2:19:13 PM	0.02
24960	2:20:13 PM	0.02
25020	2:21:13 PM	0.02
25080	2:22:13 PM	0.018
25140	2:23:13 PM	0.02
25200	2:24:13 PM	0.019
25260	2:25:13 PM	0.018
25320	2:26:13 PM	0.018
25380	2:27:13 PM	0.019
25440	2:28:13 PM	0.018
25500	2:29:13 PM	0.02
25560	2:30:13 PM	0.017
25620	2:31:13 PM	0.016
25680	2:32:13 PM	0.017
25740	2:33:13 PM	0.018
25800	2:34:13 PM	0.025
25860	2:35:13 PM	0.019
25920	2:36:13 PM	0.019
25980	2:37:13 PM	0.017
26040	2:38:13 PM	0.017
26100	2:39:13 PM	0.016
26160	2:40:13 PM	0.012
26220	2:41:13 PM	0.012
26280	2:42:13 PM	0.013
26340	2:43:13 PM	0.012
26400	2:44:13 PM	0.014
26460	2:45:13 PM	0.018
26520	2:46:13 PM	0.019
26580	2:47:13 PM	0.023
26640	2:48:13 PM	0.018
26700	2:49:13 PM	0.02
26760	2:50:13 PM	0.018
26820	2:51:13 PM	0.022
26880	2:52:13 PM	0.018
26940	2:53:13 PM	0.021

27000	2:54:13 PM	0.013
27060	2:55:13 PM	0.015
27120	2:56:13 PM	0.017
27180	2:57:13 PM	0.02
27240	2:58:13 PM	0.024

Device Serial No	Log Time	Log Type	Sensor 1 Type	Sensor 1 Serial Number	Sensor 1 St	Sensor 1 Gas Reading
592-600871	11/8/2023 15:58	Readings	PID	SC23030408A8	Normal	0.1
592-600871	11/8/2023 15:57	Readings	PID	SC23030408A8	Normal	0.1
592-600871	11/8/2023 15:56	Readings	PID	SC23030408A8	Normal	0
592-600871	11/8/2023 15:55	Readings	PID	SC23030408A8	Normal	0
592-600871	11/8/2023 15:54	Readings	PID	SC23030408A8	Normal	0
592-600871	11/8/2023 15:53	Readings	PID	SC23030408A8	Normal	0
592-600871	11/8/2023 15:52	Readings	PID	SC23030408A8	Normal	0
592-600871	11/8/2023 15:51	Readings	PID	SC23030408A8	Normal	0
592-600871	11/8/2023 15:50	Readings	PID	SC23030408A8	Normal	0
592-600871	11/8/2023 15:49	Readings	PID	SC23030408A8	Normal	0
592-600871	11/8/2023 15:48	Readings	PID	SC23030408A8	Normal	0
592-600871	11/8/2023 15:47	Readings	PID	SC23030408A8	Normal	0
592-600871	11/8/2023 15:46	Readings	PID	SC23030408A8	Normal	0
592-600871	11/8/2023 15:45	Readings	PID	SC23030408A8	Normal	0
592-600871	11/8/2023 15:44	Readings	PID	SC23030408A8	Normal	0
592-600871	11/8/2023 15:43	Readings	PID	SC23030408A8	Normal	0
592-600871	11/8/2023 15:42	Readings	PID	SC23030408A8	Normal	0
592-600871	11/8/2023 15:41	Readings	PID	SC23030408A8	Normal	0
592-600871	11/8/2023 15:40	Readings	PID	SC23030408A8	Normal	0
592-600871	11/8/2023 15:39	Readings	PID	SC23030408A8	Normal	0
592-600871	11/8/2023 15:38	Readings	PID	SC23030408A8	Normal	0
592-600871	11/8/2023 15:37	Readings	PID	SC23030408A8	Normal	0
592-600871	11/8/2023 15:36	Readings	PID	SC23030408A8	Normal	0
592-600871	11/8/2023 15:35	Readings	PID	SC23030408A8	Normal	0
592-600871	11/8/2023 15:34	Readings	PID	SC23030408A8	Normal	0
592-600871	11/8/2023 15:33	Readings	PID	SC23030408A8	Normal	0
592-600871	11/8/2023 15:32	Readings	PID	SC23030408A8	Normal	0
592-600871	11/8/2023 15:31	Readings	PID	SC23030408A8	Normal	0
592-600871	11/8/2023 15:30	Readings	PID	SC23030408A8	Normal	0
592-600871	11/8/2023 15:29	Readings	PID	SC23030408A8	Normal	0
592-600871	11/8/2023 15:28	Readings	PID	SC23030408A8	Normal	0
592-600871	11/8/2023 15:27	Readings	PID	SC23030408A8	Normal	0
592-600871	11/8/2023 15:26	Readings	PID	SC23030408A8	Normal	0
592-600871	11/8/2023 15:25	Readings	PID	SC23030408A8	Normal	0

592-600871	11/8/2023 11:19	Readings	PID	SC23030408A8	Normal	0
592-600871	11/8/2023 11:18	Readings	PID	SC23030408A8	Normal	0
592-600871	11/8/2023 11:17	Readings	PID	SC23030408A8	Normal	0
592-600871	11/8/2023 11:16	Readings	PID	SC23030408A8	Normal	0
592-600871	11/8/2023 11:15	Readings	PID	SC23030408A8	Normal	0
592-600871	11/8/2023 11:14	Readings	PID	SC23030408A8	Normal	0
592-600871	11/8/2023 11:13	Readings	PID	SC23030408A8	Normal	0
592-600871	11/8/2023 11:12	Readings	PID	SC23030408A8	Normal	0
592-600871	11/8/2023 11:11	Readings	PID	SC23030408A8	Normal	0
592-600871	11/8/2023 11:10	Readings	PID	SC23030408A8	Normal	0
592-600871	11/8/2023 11:09	Readings	PID	SC23030408A8	Normal	0
592-600871	11/8/2023 11:08	Readings	PID	SC23030408A8	Normal	0
592-600871	11/8/2023 11:07	Readings	PID	SC23030408A8	Normal	0
592-600871	11/8/2023 11:06	Readings	PID	SC23030408A8	Normal	0
592-600871	11/8/2023 11:05	Readings	PID	SC23030408A8	Normal	0
592-600871	11/8/2023 11:04	Readings	PID	SC23030408A8	Normal	0
592-600871	11/8/2023 11:03	CONFIG	PID	SC23030408A8		
592-600871	11/8/2023 10:55	Readings	PID	SC23030408A8	Normal	0
592-600871	11/8/2023 10:54	Readings	PID	SC23030408A8	Normal	0
592-600871	11/8/2023 10:53	Readings	PID	SC23030408A8	Normal	0
592-600871	11/8/2023 10:52	Readings	PID	SC23030408A8	Normal	0
592-600871	11/8/2023 10:51	Readings	PID	SC23030408A8	Normal	0
592-600871	11/8/2023 10:50	Readings	PID	SC23030408A8	Normal	0
592-600871	11/8/2023 10:49	Readings	PID	SC23030408A8	Normal	0
592-600871	11/8/2023 10:48	Readings	PID	SC23030408A8	Normal	0
592-600871	11/8/2023 10:47	Readings	PID	SC23030408A8	Normal	0
592-600871	11/8/2023 10:46	Readings	PID	SC23030408A8	Normal	0
592-600871	11/8/2023 10:45	Readings	PID	SC23030408A8	Normal	0
592-600871	11/8/2023 10:44	Readings	PID	SC23030408A8	Normal	0
592-600871	11/8/2023 10:43	Readings	PID	SC23030408A8	Normal	0
592-600871	11/8/2023 10:42	CONFIG	PID	SC23030408A8		
592-600871	11/8/2023 10:38	Readings	PID	SC23030408A8	Normal	0
592-600871	11/8/2023 10:37	Readings	PID	SC23030408A8	Normal	0
592-600871	11/8/2023 10:36	Readings	PID	SC23030408A8	Normal	0
592-600871	11/8/2023 10:35	Readings	PID	SC23030408A8	Normal	0

592-600871	11/8/2023 8:49	Readings	PID	SC23030408A8	Normal	0
592-600871	11/8/2023 8:48	Readings	PID	SC23030408A8	Normal	0
592-600871	11/8/2023 8:47	Readings	PID	SC23030408A8	Normal	0
592-600871	11/8/2023 8:46	Readings	PID	SC23030408A8	Normal	0
592-600871	11/8/2023 8:45	Readings	PID	SC23030408A8	Normal	0
592-600871	11/8/2023 8:44	Readings	PID	SC23030408A8	Normal	0
592-600871	11/8/2023 8:43	Readings	PID	SC23030408A8	Normal	0
592-600871	11/8/2023 8:42	Readings	PID	SC23030408A8	Normal	0
592-600871	11/8/2023 8:41	Readings	PID	SC23030408A8	Normal	0
592-600871	11/8/2023 8:40	Readings	PID	SC23030408A8	Normal	0
592-600871	11/8/2023 8:39	Readings	PID	SC23030408A8	Normal	0
592-600871	11/8/2023 8:38	Readings	PID	SC23030408A8	Normal	0
592-600871	11/8/2023 8:37	Readings	PID	SC23030408A8	Normal	0
592-600871	11/8/2023 8:36	Readings	PID	SC23030408A8	Normal	0
592-600871	11/8/2023 8:35	Readings	PID	SC23030408A8	Normal	0
592-600871	11/8/2023 8:34	Readings	PID	SC23030408A8	Normal	0
592-600871	11/8/2023 8:33	Readings	PID	SC23030408A8	Normal	0
592-600871	11/8/2023 8:32	Readings	PID	SC23030408A8	Normal	0
592-600871	11/8/2023 8:31	Readings	PID	SC23030408A8	Normal	0
592-600871	11/8/2023 8:30	Readings	PID	SC23030408A8	Normal	0
592-600871	11/8/2023 8:29	Readings	PID	SC23030408A8	Normal	0
592-600871	11/8/2023 8:28	Readings	PID	SC23030408A8	Normal	0
592-600871	11/8/2023 8:27	Readings	PID	SC23030408A8	Normal	0
592-600871	11/8/2023 8:26	Readings	PID	SC23030408A8	Normal	0
592-600871	11/8/2023 8:25	CONFIG	PID	SC23030408A8		

Instrument Name	DustTrak II
Model Number	8530
Serial Number	8530100909
Firmware Version	3.1
Calibration Date	7/24/2023
Test Name	MANUAL_018
Test Start Time	7:18:38 AM
Test Start Date	11/8/2023
Test Length [D:H:M]	0:06:46
Test Interval [M:S]	1:00
Mass Average [mg/m3]	0.018
Mass Minimum [mg/m3]	0.008
Mass Maximum [mg/m3]	0.126
Mass TWA [mg/m3]	0.018
Photometric User Cal	1
Flow User Cal	0
Errors	
Number of Samples	467

Elapsed Time [s]	TIME	Mass [mg/m3]	Alarms	Errors
0	7:18:38 AM			
60	7:19:38 AM	0.031		
120	7:20:38 AM	0.029		
180	7:21:38 AM	0.029		
240	7:22:38 AM	0.027		
300	7:23:38 AM	0.027		
360	7:24:38 AM	0.029		
420	7:25:38 AM	0.026		
480	7:26:38 AM	0.028		
540	7:27:38 AM	0.031		
600	7:28:38 AM	0.028		
660	7:29:38 AM	0.028		
720	7:30:38 AM	0.032		
780	7:31:38 AM	0.027		
840	7:32:38 AM	0.025		
900	7:33:38 AM	0.025		
960	7:34:38 AM	0.024		
1020	7:35:38 AM	0.027		
1080	7:36:38 AM	0.031		
1140	7:37:38 AM	0.031		
1200	7:38:38 AM	0.03		
1260	7:39:38 AM	0.025		
1320	7:40:38 AM	0.025		
1380	7:41:38 AM	0.026		
1440	7:42:38 AM	0.027		
1500	7:43:38 AM	0.028		
1560	7:44:38 AM	0.029		

1620	7:45:38 AM	0.028
1680	7:46:38 AM	0.029
1740	7:47:38 AM	0.027
1800	7:48:38 AM	0.029
1860	7:49:38 AM	0.03
1920	7:50:38 AM	0.028
1980	7:51:38 AM	0.027
2040	7:52:38 AM	0.038
2100	7:53:38 AM	0.029
2160	7:54:38 AM	0.047
2220	7:55:38 AM	0.039
2280	7:56:38 AM	0.038
2340	7:57:38 AM	0.038
2400	7:58:38 AM	0.049
2460	7:59:38 AM	0.034
2520	8:00:38 AM	0.027
2580	8:01:38 AM	0.024
2640	8:02:38 AM	0.024
2700	8:03:38 AM	0.032
2760	8:04:38 AM	0.032
2820	8:05:38 AM	0.036
2880	8:06:38 AM	0.037
2940	8:07:38 AM	0.027
3000	8:08:38 AM	0.03
3060	8:09:38 AM	0.034
3120	8:10:38 AM	0.126
3180	8:11:38 AM	0.041
3240	8:12:38 AM	0.036
3300	8:13:38 AM	0.037
3360	8:14:38 AM	0.033
3420	8:15:38 AM	0.027
3480	8:16:38 AM	0.025
3540	8:17:38 AM	0.024
3600	8:18:38 AM	0.023
3660	8:19:38 AM	0.023
3720	8:20:38 AM	0.023
3780	8:21:38 AM	0.025
3840	8:22:38 AM	0.037
3900	8:23:38 AM	0.041
3960	8:24:38 AM	0.033
4020	8:25:38 AM	0.027
4080	8:26:38 AM	0.027
4140	8:27:38 AM	0.027
4200	8:28:38 AM	0.03
4260	8:29:38 AM	0.036
4320	8:30:38 AM	0.037
4380	8:31:38 AM	0.028

4440	8:32:38 AM	0.033
4500	8:33:38 AM	0.041
4560	8:34:38 AM	0.043
4620	8:35:38 AM	0.051
4680	8:36:38 AM	0.047
4740	8:37:38 AM	0.032
4800	8:38:38 AM	0.033
4860	8:39:38 AM	0.033
4920	8:40:38 AM	0.032
4980	8:41:38 AM	0.026
5040	8:42:38 AM	0.029
5100	8:43:38 AM	0.028
5160	8:44:38 AM	0.026
5220	8:45:38 AM	0.023
5280	8:46:38 AM	0.027
5340	8:47:38 AM	0.025
5400	8:48:38 AM	0.025
5460	8:49:38 AM	0.029
5520	8:50:38 AM	0.026
5580	8:51:38 AM	0.032
5640	8:52:38 AM	0.037
5700	8:53:38 AM	0.026
5760	8:54:38 AM	0.026
5820	8:55:38 AM	0.026
5880	8:56:38 AM	0.026
5940	8:57:38 AM	0.03
6000	8:58:38 AM	0.023
6060	8:59:38 AM	0.022
6120	9:00:38 AM	0.021
6180	9:01:38 AM	0.021
6240	9:02:38 AM	0.022
6300	9:03:38 AM	0.021
6360	9:04:38 AM	0.02
6420	9:05:38 AM	0.022
6480	9:06:38 AM	0.022
6540	9:07:38 AM	0.021
6600	9:08:38 AM	0.021
6660	9:09:38 AM	0.02
6720	9:10:38 AM	0.02
6780	9:11:38 AM	0.021
6840	9:12:38 AM	0.021
6900	9:13:38 AM	0.021
6960	9:14:38 AM	0.021
7020	9:15:38 AM	0.021
7080	9:16:38 AM	0.021
7140	9:17:38 AM	0.022
7200	9:18:38 AM	0.022

7260	9:19:38 AM	0.022
7320	9:20:38 AM	0.022
7380	9:21:38 AM	0.022
7440	9:22:38 AM	0.021
7500	9:23:38 AM	0.022
7560	9:24:38 AM	0.022
7620	9:25:38 AM	0.023
7680	9:26:38 AM	0.024
7740	9:27:38 AM	0.022
7800	9:28:38 AM	0.024
7860	9:29:38 AM	0.024
7920	9:30:38 AM	0.023
7980	9:31:38 AM	0.023
8040	9:32:38 AM	0.023
8100	9:33:38 AM	0.023
8160	9:34:38 AM	0.023
8220	9:35:38 AM	0.024
8280	9:36:38 AM	0.023
8340	9:37:38 AM	0.023
8400	9:38:38 AM	0.025
8460	9:39:38 AM	0.025
8520	9:40:38 AM	0.023
8580	9:41:38 AM	0.023
8640	9:42:38 AM	0.024
8700	9:43:38 AM	0.023
8760	9:44:38 AM	0.023
8820	9:45:38 AM	0.023
8880	9:46:38 AM	0.026
8940	9:47:38 AM	0.026
9000	9:48:38 AM	0.028
9060	9:49:38 AM	0.024
9120	9:50:38 AM	0.021
9180	9:51:38 AM	0.022
9240	9:52:38 AM	0.019
9300	9:53:38 AM	0.019
9360	9:54:38 AM	0.02
9420	9:55:38 AM	0.019
9480	9:56:38 AM	0.022
9540	9:57:38 AM	0.019
9600	9:58:38 AM	0.021
9660	9:59:38 AM	0.021
9720	10:00:38 AM	0.022
9780	10:01:38 AM	0.022
9840	10:02:38 AM	0.022
9900	10:03:38 AM	0.02
9960	10:04:38 AM	0.02
10020	10:05:38 AM	0.02

10080	10:06:38 AM	0.02
10140	10:07:38 AM	0.02
10200	10:08:38 AM	0.018
10260	10:09:38 AM	0.017
10320	10:10:38 AM	0.017
10380	10:11:38 AM	0.016
10440	10:12:38 AM	0.014
10500	10:13:38 AM	0.015
10560	10:14:38 AM	0.014
10620	10:15:38 AM	0.013
10680	10:16:38 AM	0.013
10740	10:17:38 AM	0.013
10800	10:18:38 AM	0.012
10860	10:19:38 AM	0.013
10920	10:20:38 AM	0.014
10980	10:21:38 AM	0.014
11040	10:22:38 AM	0.016
11100	10:23:38 AM	0.013
11160	10:24:38 AM	0.01
11220	10:25:38 AM	0.01
11280	10:26:38 AM	0.01
11340	10:27:38 AM	0.01
11400	10:28:38 AM	0.01
11460	10:29:38 AM	0.009
11520	10:30:38 AM	0.012
11580	10:31:38 AM	0.013
11640	10:32:38 AM	0.009
11700	10:33:38 AM	0.01
11760	10:34:38 AM	0.009
11820	10:35:38 AM	0.01
11880	10:36:38 AM	0.01
11940	10:37:38 AM	0.01
12000	10:38:38 AM	0.01
12060	10:39:38 AM	0.009
12120	10:40:38 AM	0.01
12180	10:41:38 AM	0.009
12240	10:42:38 AM	0.011
12300	10:43:38 AM	0.008
12360	10:44:38 AM	0.008
12420	10:45:38 AM	0.009
12480	10:46:38 AM	0.009
12540	10:47:38 AM	0.013
12600	10:48:38 AM	0.01
12660	10:49:38 AM	0.01
12720	10:50:38 AM	0.01
12780	10:51:38 AM	0.011
12840	10:52:38 AM	0.009

12900	10:53:38 AM	0.013
12960	10:54:38 AM	0.014
13020	10:55:38 AM	0.014
13080	10:56:38 AM	0.01
13140	10:57:38 AM	0.01
13200	10:58:38 AM	0.012
13260	10:59:38 AM	0.01
13320	11:00:38 AM	0.011
13380	11:01:38 AM	0.01
13440	11:02:38 AM	0.01
13500	11:03:38 AM	0.013
13560	11:04:38 AM	0.014
13620	11:05:38 AM	0.014
13680	11:06:38 AM	0.014
13740	11:07:38 AM	0.016
13800	11:08:38 AM	0.013
13860	11:09:38 AM	0.013
13920	11:10:38 AM	0.014
13980	11:11:38 AM	0.012
14040	11:12:38 AM	0.011
14100	11:13:38 AM	0.012
14160	11:14:38 AM	0.011
14220	11:15:38 AM	0.012
14280	11:16:38 AM	0.013
14340	11:17:38 AM	0.012
14400	11:18:38 AM	0.014
14460	11:19:38 AM	0.014
14520	11:20:38 AM	0.012
14580	11:21:38 AM	0.019
14640	11:22:38 AM	0.011
14700	11:23:38 AM	0.012
14760	11:24:38 AM	0.011
14820	11:25:38 AM	0.012
14880	11:26:38 AM	0.013
14940	11:27:38 AM	0.013
15000	11:28:38 AM	0.015
15060	11:29:38 AM	0.016
15120	11:30:38 AM	0.012
15180	11:31:38 AM	0.013
15240	11:32:38 AM	0.015
15300	11:33:38 AM	0.016
15360	11:34:38 AM	0.014
15420	11:35:38 AM	0.013
15480	11:36:38 AM	0.012
15540	11:37:38 AM	0.025
15600	11:38:38 AM	0.014
15660	11:39:38 AM	0.014

15720	11:40:38 AM	0.013
15780	11:41:38 AM	0.012
15840	11:42:38 AM	0.013
15900	11:43:38 AM	0.014
15960	11:44:38 AM	0.015
16020	11:45:38 AM	0.016
16080	11:46:38 AM	0.013
16140	11:47:38 AM	0.013
16200	11:48:38 AM	0.019
16260	11:49:38 AM	0.015
16320	11:50:38 AM	0.012
16380	11:51:38 AM	0.013
16440	11:52:38 AM	0.015
16500	11:53:38 AM	0.013
16560	11:54:38 AM	0.013
16620	11:55:38 AM	0.014
16680	11:56:38 AM	0.019
16740	11:57:38 AM	0.014
16800	11:58:38 AM	0.016
16860	11:59:38 AM	0.022
16920	12:00:38 PM	0.014
16980	12:01:38 PM	0.023
17040	12:02:38 PM	0.019
17100	12:03:38 PM	0.013
17160	12:04:38 PM	0.013
17220	12:05:38 PM	0.013
17280	12:06:38 PM	0.013
17340	12:07:38 PM	0.012
17400	12:08:38 PM	0.014
17460	12:09:38 PM	0.015
17520	12:10:38 PM	0.018
17580	12:11:38 PM	0.014
17640	12:12:38 PM	0.016
17700	12:13:38 PM	0.016
17760	12:14:38 PM	0.013
17820	12:15:38 PM	0.012
17880	12:16:38 PM	0.012
17940	12:17:38 PM	0.011
18000	12:18:38 PM	0.012
18060	12:19:38 PM	0.011
18120	12:20:38 PM	0.012
18180	12:21:38 PM	0.012
18240	12:22:38 PM	0.012
18300	12:23:38 PM	0.011
18360	12:24:38 PM	0.012
18420	12:25:38 PM	0.012
18480	12:26:38 PM	0.011

18540	12:27:38 PM	0.012
18600	12:28:38 PM	0.012
18660	12:29:38 PM	0.013
18720	12:30:38 PM	0.013
18780	12:31:38 PM	0.013
18840	12:32:38 PM	0.012
18900	12:33:38 PM	0.013
18960	12:34:38 PM	0.012
19020	12:35:38 PM	0.011
19080	12:36:38 PM	0.011
19140	12:37:38 PM	0.011
19200	12:38:38 PM	0.012
19260	12:39:38 PM	0.012
19320	12:40:38 PM	0.012
19380	12:41:38 PM	0.012
19440	12:42:38 PM	0.011
19500	12:43:38 PM	0.012
19560	12:44:38 PM	0.013
19620	12:45:38 PM	0.013
19680	12:46:38 PM	0.013
19740	12:47:38 PM	0.012
19800	12:48:38 PM	0.012
19860	12:49:38 PM	0.011
19920	12:50:38 PM	0.013
19980	12:51:38 PM	0.013
20040	12:52:38 PM	0.011
20100	12:53:38 PM	0.011
20160	12:54:38 PM	0.012
20220	12:55:38 PM	0.012
20280	12:56:38 PM	0.012
20340	12:57:38 PM	0.011
20400	12:58:38 PM	0.012
20460	12:59:38 PM	0.012
20520	1:00:38 PM	0.013
20580	1:01:38 PM	0.01
20640	1:02:38 PM	0.01
20700	1:03:38 PM	0.01
20760	1:04:38 PM	0.01
20820	1:05:38 PM	0.011
20880	1:06:38 PM	0.01
20940	1:07:38 PM	0.01
21000	1:08:38 PM	0.01
21060	1:09:38 PM	0.011
21120	1:10:38 PM	0.016
21180	1:11:38 PM	0.012
21240	1:12:38 PM	0.013
21300	1:13:38 PM	0.012

21360	1:14:38 PM	0.011
21420	1:15:38 PM	0.011
21480	1:16:38 PM	0.011
21540	1:17:38 PM	0.012
21600	1:18:38 PM	0.013
21660	1:19:38 PM	0.011
21720	1:20:38 PM	0.012
21780	1:21:38 PM	0.011
21840	1:22:38 PM	0.012
21900	1:23:38 PM	0.012
21960	1:24:38 PM	0.011
22020	1:25:38 PM	0.011
22080	1:26:38 PM	0.011
22140	1:27:38 PM	0.011
22200	1:28:38 PM	0.011
22260	1:29:38 PM	0.012
22320	1:30:38 PM	0.011
22380	1:31:38 PM	0.011
22440	1:32:38 PM	0.011
22500	1:33:38 PM	0.011
22560	1:34:38 PM	0.012
22620	1:35:38 PM	0.012
22680	1:36:38 PM	0.011
22740	1:37:38 PM	0.011
22800	1:38:38 PM	0.011
22860	1:39:38 PM	0.011
22920	1:40:38 PM	0.011
22980	1:41:38 PM	0.011
23040	1:42:38 PM	0.01
23100	1:43:38 PM	0.011
23160	1:44:38 PM	0.011
23220	1:45:38 PM	0.013
23280	1:46:38 PM	0.013
23340	1:47:38 PM	0.012
23400	1:48:38 PM	0.012
23460	1:49:38 PM	0.011
23520	1:50:38 PM	0.011
23580	1:51:38 PM	0.011
23640	1:52:38 PM	0.011
23700	1:53:38 PM	0.013
23760	1:54:38 PM	0.013
23820	1:55:38 PM	0.012
23880	1:56:38 PM	0.012
23940	1:57:38 PM	0.012
24000	1:58:38 PM	0.013
24060	1:59:38 PM	0.012
24120	2:00:38 PM	0.014

24180	2:01:38 PM	0.013
24240	2:02:38 PM	0.012
24300	2:03:38 PM	0.015
24360	2:04:38 PM	0.013
24420	2:05:38 PM	0.019
24480	2:06:38 PM	0.013
24540	2:07:38 PM	0.011
24600	2:08:38 PM	0.016
24660	2:09:38 PM	0.013
24720	2:10:38 PM	0.012
24780	2:11:38 PM	0.013
24840	2:12:38 PM	0.011
24900	2:13:38 PM	0.011
24960	2:14:38 PM	0.012
25020	2:15:38 PM	0.011
25080	2:16:38 PM	0.013
25140	2:17:38 PM	0.013
25200	2:18:38 PM	0.011
25260	2:19:38 PM	0.011
25320	2:20:38 PM	0.012
25380	2:21:38 PM	0.018
25440	2:22:38 PM	0.013
25500	2:23:38 PM	0.012
25560	2:24:38 PM	0.012
25620	2:25:38 PM	0.012
25680	2:26:38 PM	0.013
25740	2:27:38 PM	0.013
25800	2:28:38 PM	0.012
25860	2:29:38 PM	0.012
25920	2:30:38 PM	0.012
25980	2:31:38 PM	0.012
26040	2:32:38 PM	0.012
26100	2:33:38 PM	0.012
26160	2:34:38 PM	0.011
26220	2:35:38 PM	0.012
26280	2:36:38 PM	0.013
26340	2:37:38 PM	0.013
26400	2:38:38 PM	0.013
26460	2:39:38 PM	0.014
26520	2:40:38 PM	0.013
26580	2:41:38 PM	0.013
26640	2:42:38 PM	0.012
26700	2:43:38 PM	0.017
26760	2:44:38 PM	0.021
26820	2:45:38 PM	0.014
26880	2:46:38 PM	0.015
26940	2:47:38 PM	0.016

27000	2:48:38 PM	0.018
27060	2:49:38 PM	0.015
27120	2:50:38 PM	0.013
27180	2:51:38 PM	0.015
27240	2:52:38 PM	0.014
27300	2:53:38 PM	0.015
27360	2:54:38 PM	0.016
27420	2:55:38 PM	0.018
27480	2:56:38 PM	0.014
27540	2:57:38 PM	0.012
27600	2:58:38 PM	0.013
27660	2:59:38 PM	0.014
27720	3:00:38 PM	0.014
27780	3:01:38 PM	0.013
27840	3:02:38 PM	0.014
27900	3:03:38 PM	0.013
27960	3:04:38 PM	0.013
28020	3:05:38 PM	0.013

Device Serial No	Log Time	Log Type	Sensor 1 Type	Sensor 1 Serial Number	Sensor 1 Status	Sensor 1 Gas Reading
592-929156	11/8/2023 16:05	Readings	PID	SC23030065D3	Normal	0.7
592-929156	11/8/2023 16:04	Readings	PID	SC23030065D3	Normal	0.6
592-929156	11/8/2023 16:03	Readings	PID	SC23030065D3	Normal	0.6
592-929156	11/8/2023 16:02	Readings	PID	SC23030065D3	Normal	0.7
592-929156	11/8/2023 16:01	Readings	PID	SC23030065D3	Normal	0.5
592-929156	11/8/2023 16:00	Readings	PID	SC23030065D3	Normal	0.5
592-929156	11/8/2023 15:59	Readings	PID	SC23030065D3	Normal	0.5
592-929156	11/8/2023 15:58	Readings	PID	SC23030065D3	Normal	0.4
592-929156	11/8/2023 15:57	Readings	PID	SC23030065D3	Normal	0.3
592-929156	11/8/2023 15:56	Readings	PID	SC23030065D3	Normal	0.2
592-929156	11/8/2023 15:55	Readings	PID	SC23030065D3	Normal	0.2
592-929156	11/8/2023 15:54	Readings	PID	SC23030065D3	Normal	0.2
592-929156	11/8/2023 15:53	Readings	PID	SC23030065D3	Normal	0.2
592-929156	11/8/2023 15:52	Readings	PID	SC23030065D3	Normal	0.2
592-929156	11/8/2023 15:51	Readings	PID	SC23030065D3	Normal	0.2
592-929156	11/8/2023 15:50	Readings	PID	SC23030065D3	Normal	0.2
592-929156	11/8/2023 15:49	Readings	PID	SC23030065D3	Normal	0.2
592-929156	11/8/2023 15:48	Readings	PID	SC23030065D3	Normal	0.3
592-929156	11/8/2023 15:47	Readings	PID	SC23030065D3	Normal	0.2
592-929156	11/8/2023 15:46	Readings	PID	SC23030065D3	Normal	0.2
592-929156	11/8/2023 15:45	Readings	PID	SC23030065D3	Normal	0.2
592-929156	11/8/2023 15:44	Readings	PID	SC23030065D3	Normal	0.5
592-929156	11/8/2023 15:43	Readings	PID	SC23030065D3	Normal	0.2
592-929156	11/8/2023 15:42	Readings	PID	SC23030065D3	Normal	0.2
592-929156	11/8/2023 15:41	Readings	PID	SC23030065D3	Normal	0.2
592-929156	11/8/2023 15:40	Readings	PID	SC23030065D3	Normal	0.2
592-929156	11/8/2023 15:39	Readings	PID	SC23030065D3	Normal	0.2
592-929156	11/8/2023 15:38	Readings	PID	SC23030065D3	Normal	0.2
592-929156	11/8/2023 15:37	Readings	PID	SC23030065D3	Normal	0.2
592-929156	11/8/2023 15:36	Readings	PID	SC23030065D3	Normal	0.2
592-929156	11/8/2023 15:35	Readings	PID	SC23030065D3	Normal	0.2
592-929156	11/8/2023 15:34	Readings	PID	SC23030065D3	Normal	0.2
592-929156	11/8/2023 15:33	Readings	PID	SC23030065D3	Normal	0.2
592-929156	11/8/2023 15:32	Readings	PID	SC23030065D3	Normal	0.2

592-929156	11/8/2023 8:31 Readings	PID	SC23030065D3	Normal	0.1
592-929156	11/8/2023 8:30 Readings	PID	SC23030065D3	Normal	0.1
592-929156	11/8/2023 8:29 Readings	PID	SC23030065D3	Normal	0.1
592-929156	11/8/2023 8:28 Readings	PID	SC23030065D3	Normal	0.1
592-929156	11/8/2023 8:27 Readings	PID	SC23030065D3	Normal	0.1
592-929156	11/8/2023 8:26 Readings	PID	SC23030065D3	Normal	0.1
592-929156	11/8/2023 8:25 Readings	PID	SC23030065D3	Normal	0
592-929156	11/8/2023 8:24 Readings	PID	SC23030065D3	Normal	0
592-929156	11/8/2023 8:23 Readings	PID	SC23030065D3	Normal	0
592-929156	11/8/2023 8:22 Readings	PID	SC23030065D3	Normal	0
592-929156	11/8/2023 8:21 Readings	PID	SC23030065D3	Normal	0
592-929156	11/8/2023 8:20 Readings	PID	SC23030065D3	Normal	0
592-929156	11/8/2023 8:19 CONFIG	PID	SC23030065D3		