



DAILY STATUS REPORT

Prepared By:

Victor Barraza

WEATHER	Snow	Rain	Overcast	Partly Cloudy	Bright Sun	x	Wind
TEMP.	< 32	32-50	50-70	x 70-85	>85		S-7 MPH

IEC Project No:	13928	NYSDEC BCP Site No:	C224367	Date: 11/17/23
Project:	251 Douglass Street, Brooklyn, NY			

<p>Consultant: Impact Environmental Engineering and Geology, PLLC (IEEG)</p> <p>Time On: 06:45 Time Out: 15:25</p>	<p>Personnel On Site: IEEG (Environmental) – Gwen Lynn and Victor Barraza Cascade Remediation Services – Jon Simpson ADT– Drilling Contractor Broadway Construction Group - Tom Caporale GES- Leo</p> <p>Equipment On Site: Minirae 3000 PID, DustTrak II</p>
---	---

Scope of Work: NYSDEC ISS QA/QC Core Sampling for Visual Inspection.

Site Activities:

- Deploy CAMP at the start of the workday;
- ADT completes the advancement of 2c-25;
- ADT moves to 2c-23 and advances to 54.5'-feet bgs; and
- At 12:30 ADT mobilized to Columns 23 and 24 to core the overlap and advanced down to 20-feet bgs.

Community Air Monitoring Program (CAMP) - _CAMP action level for dust (0.1 mg/m³) and VOCs (5 ppm)

- PID remained at nominal levels throughout the day;
- No sustained dust exceedances were observed over a 1-min period during monitoring;
- Prestart Upwind Conditions – PID = _0.1_ ppm @ 08:10, Dust = _0.042_ mg/m³ @ 07:57.
- High Conditions (Upwind) – PID = _0.4_ ppm @ 09:41, Dust = _0.111_ mg/m³ @ 09:02.
- High Conditions (Downwind 1) – PID = _4.7_ ppm @ 11:26, Dust = _0.177_ mg/m³ @ 08:33.
- High Conditions (Downwind 2) – PID = _0.0_ ppm, Dust = _0.669_ mg/m³ @ 08:30

Notable Site Conditions:

- Jerry Prachett (NYSDEC) remarked that samples from Column 25 where of good condition.
- Drillers completed 2c-23 and 2c-25 and began overlap core at Columns 23 and 24.

Planned for the Next Day/Week:

- Continue NYSDEC ISS QA/QC core sampling for Mix C on Columns 23, 24 (overlap) and move to Mix B.

PHOTO LOG

251 DOUGLASS STREET, BROOKLYN, NY



Photo 1-
Representative photo of core sample from Pile 25 (Mix C) from the 5 to 10-foot interval.



Photo 2 –
Representative view of the southeast side of the Site where drilling is getting done (Mix C- Column 25).



Photo 3 –
Representative photo of sample from pile 23, 24 from the 10-15-foot interval. This sample had poor recovery.



Photo 4 –
Representative view of the eastern portion of the Site with active drilling at column 25.



SITE PLANS

251 DOUGLASS STREET, BROOKLYN, NY



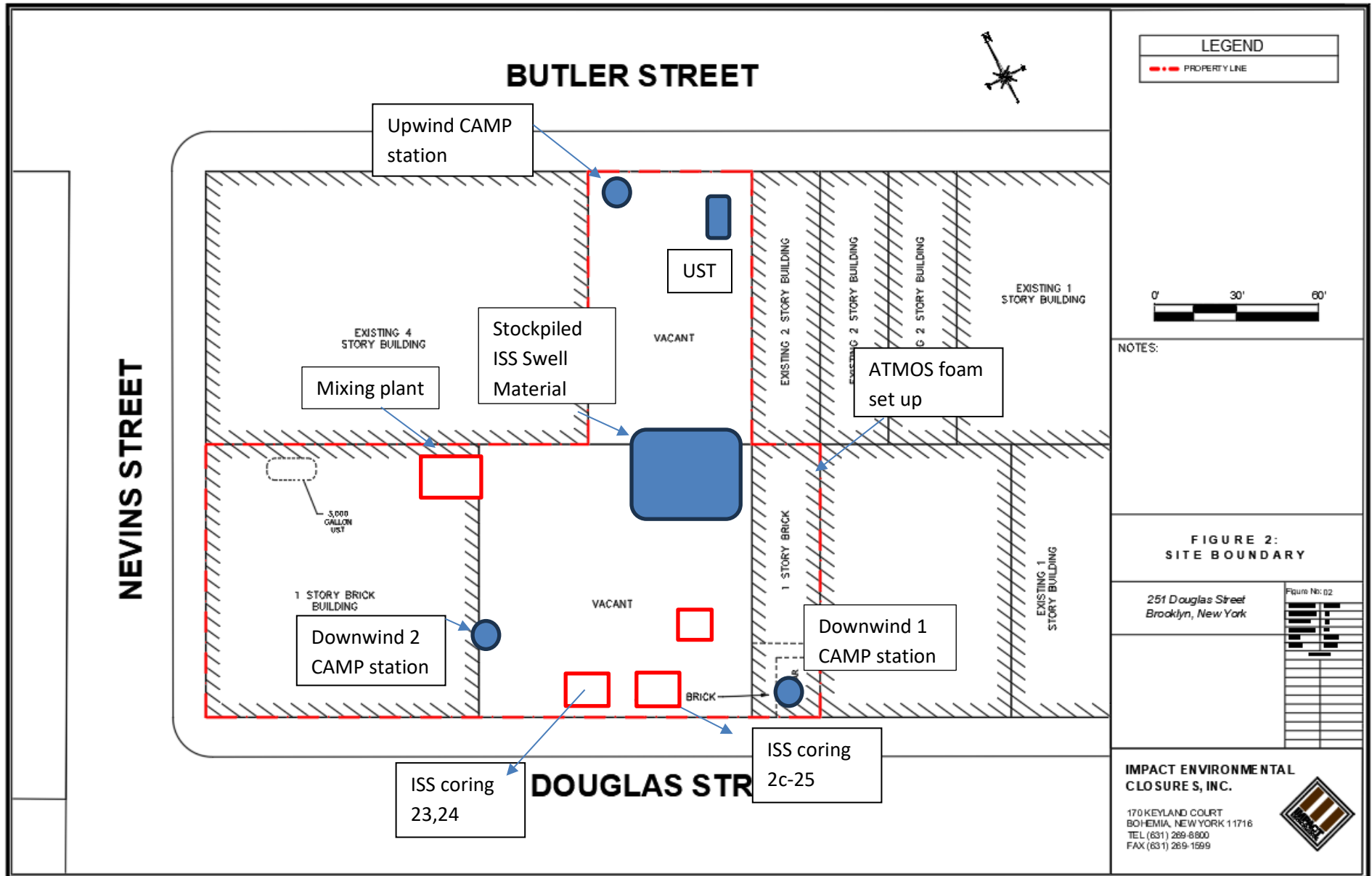

NEVINS STREET

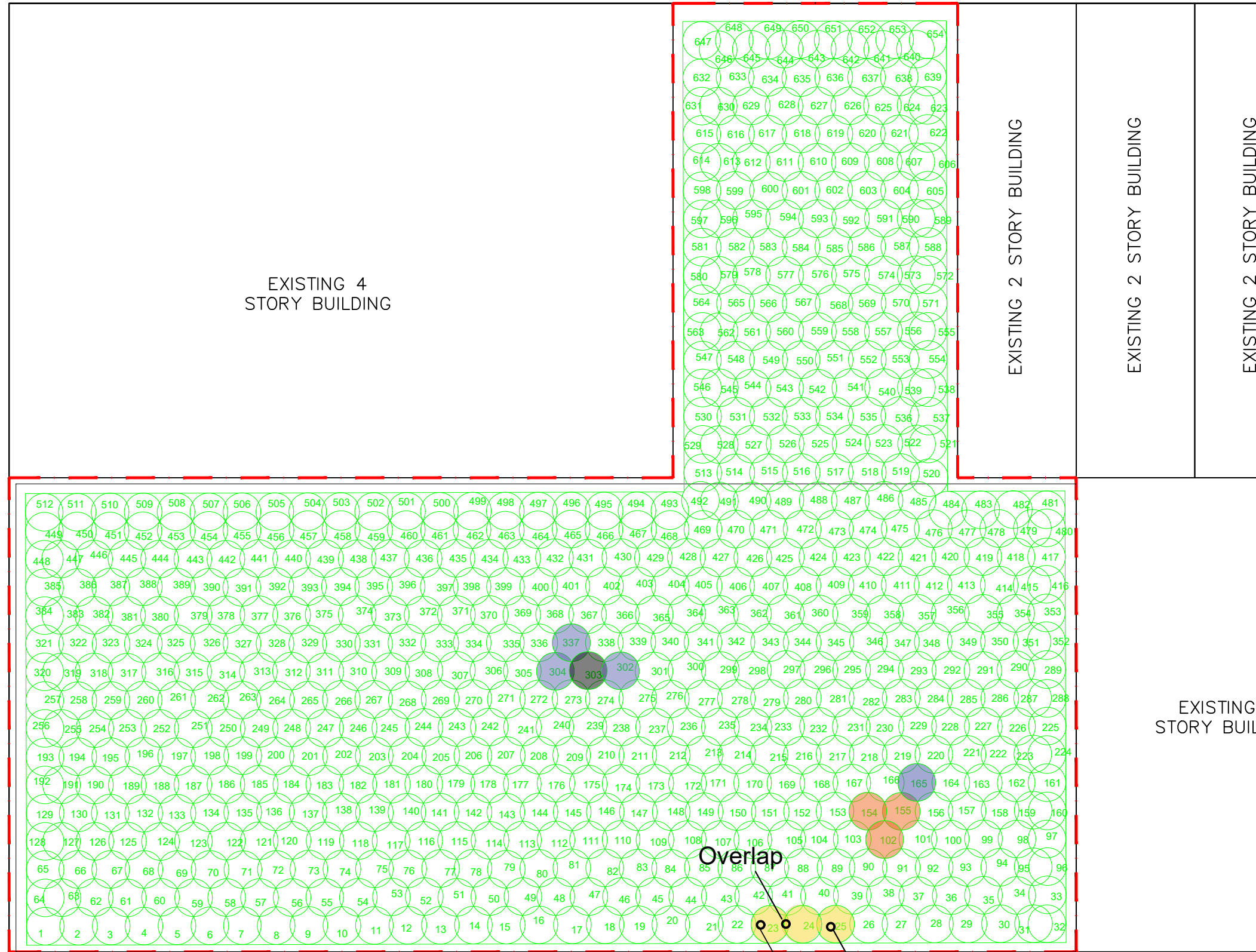

LEGEND

- Mix "A"
- Mix "B"
- Mix "B" *Only to 10 Feet Due to Obstruction
- Mix "C"

Pilot Test Locations

251 Douglass Street
Brooklyn, New York

Figure No: 03

PROJECT NO:	13028-01
DESIGNED BY:	AB
DRAWN BY:	AB
CHECKED BY:	DP
DATE:	1/10/2023
SCALE:	1" = 30'
REVISIONS	

Overlap

Core 2C-23
Core 2C-25

DOUGLASS STREET

IMPACT ENVIRONMENTAL

170 KEYLAND COURT
BOHEMIA, NEW YORK 11716
TEL (631) 269-8800
FAX (631) 269-1599





IMPACT ENVIRONMENTAL

welcome to solid ground...

170 Keyland Court | Bohemia | NY | 11716 | 631.269.8800

www.impactenvironmental.com

UPWIND CAMP READINGS

251 DOUGLASS STREET, BROOKLYN, NY

Instrument Name	DustTrak II
Model Number	8530
Serial Number	8530173225
Firmware Version	3.1
Calibration Date	11/30/2022
Test Name	MANUAL_005
Test Start Time	7:56:13 AM
Test Start Date	11/17/2023
Test Length [D:H:M]	0:07:42
Test Interval [M:S]	1:00
Mass Average [mg/m3]	0.015
Mass Minimum [mg/m3]	0.001
Mass Maximum [mg/m3]	0.111
Mass TWA [mg/m3]	0.014
Photometric User Cal	1
Flow User Cal	0
Errors	
Number of Samples	462

Elapsed Time [s]		Mass [mg/m3]	Alarms	Errors
0	7:56:13 AM			
60	7:57:13 AM	0.042		
120	7:58:13 AM	0.028		
180	7:59:13 AM	0.021		
240	8:00:13 AM	0.016		
300	8:01:13 AM	0.053		
360	8:02:13 AM	0.055		
420	8:03:13 AM	0.039		
480	8:04:13 AM	0.025		
540	8:05:13 AM	0.019		
600	8:06:13 AM	0.014		
660	8:07:13 AM	0.011		
720	8:08:13 AM	0.008		
780	8:09:13 AM	0.007		
840	8:10:13 AM	0.006		
900	8:11:13 AM	0.004		
960	8:12:13 AM	0.004		
1020	8:13:13 AM	0.003		
1080	8:14:13 AM	0.003		
1140	8:15:13 AM	0.003		
1200	8:16:13 AM	0.002		
1260	8:17:13 AM	0.002		
1320	8:18:13 AM	0.002		
1380	8:19:13 AM	0.002		
1440	8:20:13 AM	0.002		
1500	8:21:13 AM	0.002		
1560	8:22:13 AM	0.002		

1620	8:23:13 AM	0.002
1680	8:24:13 AM	0.001
1740	8:25:13 AM	0.001
1800	8:26:13 AM	0.002
1860	8:27:13 AM	0.002
1920	8:28:13 AM	0.002
1980	8:29:13 AM	0.002
2040	8:30:13 AM	0.002
2100	8:31:13 AM	0.002
2160	8:32:13 AM	0.003
2220	8:33:13 AM	0.004
2280	8:34:13 AM	0.004
2340	8:35:13 AM	0.004
2400	8:36:13 AM	0.004
2460	8:37:13 AM	0.004
2520	8:38:13 AM	0.004
2580	8:39:13 AM	0.003
2640	8:40:13 AM	0.003
2700	8:41:13 AM	0.003
2760	8:42:13 AM	0.003
2820	8:43:13 AM	0.003
2880	8:44:13 AM	0.003
2940	8:45:13 AM	0.003
3000	8:46:13 AM	0.003
3060	8:47:13 AM	0.003
3120	8:48:13 AM	0.003
3180	8:49:13 AM	0.003
3240	8:50:13 AM	0.003
3300	8:51:13 AM	0.003
3360	8:52:13 AM	0.003
3420	8:53:13 AM	0.003
3480	8:54:13 AM	0.003
3540	8:55:13 AM	0.003
3600	8:56:13 AM	0.003
3660	8:57:13 AM	0.003
3720	8:58:13 AM	0.003
3780	8:59:13 AM	0.003
3840	9:00:13 AM	0.037
3900	9:01:13 AM	0.104
3960	9:02:13 AM	0.111
4020	9:03:13 AM	0.067
4080	9:04:13 AM	0.052
4140	9:05:13 AM	0.053
4200	9:06:13 AM	0.055
4260	9:07:13 AM	0.049
4320	9:08:13 AM	0.048
4380	9:09:13 AM	0.052

4440	9:10:13 AM	0.052
4500	9:11:13 AM	0.045
4560	9:12:13 AM	0.046
4620	9:13:13 AM	0.044
4680	9:14:13 AM	0.045
4740	9:15:13 AM	0.044
4800	9:16:13 AM	0.045
4860	9:17:13 AM	0.045
4920	9:18:13 AM	0.041
4980	9:19:13 AM	0.047
5040	9:20:13 AM	0.044
5100	9:21:13 AM	0.043
5160	9:22:13 AM	0.037
5220	9:23:13 AM	0.038
5280	9:24:13 AM	0.038
5340	9:25:13 AM	0.039
5400	9:26:13 AM	0.039
5460	9:27:13 AM	0.04
5520	9:28:13 AM	0.036
5580	9:29:13 AM	0.038
5640	9:30:13 AM	0.041
5700	9:31:13 AM	0.036
5760	9:32:13 AM	0.035
5820	9:33:13 AM	0.037
5880	9:34:13 AM	0.039
5940	9:35:13 AM	0.039
6000	9:36:13 AM	0.035
6060	9:37:13 AM	0.03
6120	9:38:13 AM	0.03
6180	9:39:13 AM	0.029
6240	9:40:13 AM	0.032
6300	9:41:13 AM	0.032
6360	9:42:13 AM	0.031
6420	9:43:13 AM	0.033
6480	9:44:13 AM	0.037
6540	9:45:13 AM	0.033
6600	9:46:13 AM	0.032
6660	9:47:13 AM	0.033
6720	9:48:13 AM	0.029
6780	9:49:13 AM	0.031
6840	9:50:13 AM	0.03
6900	9:51:13 AM	0.029
6960	9:52:13 AM	0.03
7020	9:53:13 AM	0.03
7080	9:54:13 AM	0.027
7140	9:55:13 AM	0.027
7200	9:56:13 AM	0.027

7260	9:57:13 AM	0.027
7320	9:58:13 AM	0.027
7380	9:59:13 AM	0.029
7440	10:00:13 AM	0.027
7500	10:01:13 AM	0.028
7560	10:02:13 AM	0.028
7620	10:03:13 AM	0.025
7680	10:04:13 AM	0.026
7740	10:05:13 AM	0.027
7800	10:06:13 AM	0.025
7860	10:07:13 AM	0.026
7920	10:08:13 AM	0.023
7980	10:09:13 AM	0.024
8040	10:10:13 AM	0.024
8100	10:11:13 AM	0.024
8160	10:12:13 AM	0.023
8220	10:13:13 AM	0.023
8280	10:14:13 AM	0.023
8340	10:15:13 AM	0.024
8400	10:16:13 AM	0.024
8460	10:17:13 AM	0.021
8520	10:18:13 AM	0.023
8580	10:19:13 AM	0.022
8640	10:20:13 AM	0.021
8700	10:21:13 AM	0.02
8760	10:22:13 AM	0.02
8820	10:23:13 AM	0.02
8880	10:24:13 AM	0.021
8940	10:25:13 AM	0.021
9000	10:26:13 AM	0.02
9060	10:27:13 AM	0.019
9120	10:28:13 AM	0.019
9180	10:29:13 AM	0.025
9240	10:30:13 AM	0.023
9300	10:31:13 AM	0.024
9360	10:32:13 AM	0.024
9420	10:33:13 AM	0.021
9480	10:34:13 AM	0.019
9540	10:35:13 AM	0.018
9600	10:36:13 AM	0.018
9660	10:37:13 AM	0.019
9720	10:38:13 AM	0.018
9780	10:39:13 AM	0.018
9840	10:40:13 AM	0.018
9900	10:41:13 AM	0.019
9960	10:42:13 AM	0.017
10020	10:43:13 AM	0.018

10080	10:44:13 AM	0.017
10140	10:45:13 AM	0.018
10200	10:46:13 AM	0.018
10260	10:47:13 AM	0.017
10320	10:48:13 AM	0.017
10380	10:49:13 AM	0.017
10440	10:50:13 AM	0.017
10500	10:51:13 AM	0.016
10560	10:52:13 AM	0.016
10620	10:53:13 AM	0.017
10680	10:54:13 AM	0.017
10740	10:55:13 AM	0.017
10800	10:56:13 AM	0.017
10860	10:57:13 AM	0.016
10920	10:58:13 AM	0.015
10980	10:59:13 AM	0.016
11040	11:00:13 AM	0.016
11100	11:01:13 AM	0.017
11160	11:02:13 AM	0.017
11220	11:03:13 AM	0.018
11280	11:04:13 AM	0.018
11340	11:05:13 AM	0.017
11400	11:06:13 AM	0.017
11460	11:07:13 AM	0.017
11520	11:08:13 AM	0.015
11580	11:09:13 AM	0.016
11640	11:10:13 AM	0.014
11700	11:11:13 AM	0.015
11760	11:12:13 AM	0.015
11820	11:13:13 AM	0.014
11880	11:14:13 AM	0.013
11940	11:15:13 AM	0.013
12000	11:16:13 AM	0.014
12060	11:17:13 AM	0.013
12120	11:18:13 AM	0.012
12180	11:19:13 AM	0.013
12240	11:20:13 AM	0.013
12300	11:21:13 AM	0.012
12360	11:22:13 AM	0.011
12420	11:23:13 AM	0.012
12480	11:24:13 AM	0.013
12540	11:25:13 AM	0.015
12600	11:26:13 AM	0.015
12660	11:27:13 AM	0.012
12720	11:28:13 AM	0.012
12780	11:29:13 AM	0.013
12840	11:30:13 AM	0.012

12900	11:31:13 AM	0.012
12960	11:32:13 AM	0.012
13020	11:33:13 AM	0.014
13080	11:34:13 AM	0.011
13140	11:35:13 AM	0.011
13200	11:36:13 AM	0.012
13260	11:37:13 AM	0.012
13320	11:38:13 AM	0.011
13380	11:39:13 AM	0.012
13440	11:40:13 AM	0.012
13500	11:41:13 AM	0.012
13560	11:42:13 AM	0.012
13620	11:43:13 AM	0.012
13680	11:44:13 AM	0.01
13740	11:45:13 AM	0.011
13800	11:46:13 AM	0.011
13860	11:47:13 AM	0.011
13920	11:48:13 AM	0.009
13980	11:49:13 AM	0.011
14040	11:50:13 AM	0.011
14100	11:51:13 AM	0.012
14160	11:52:13 AM	0.011
14220	11:53:13 AM	0.011
14280	11:54:13 AM	0.01
14340	11:55:13 AM	0.009
14400	11:56:13 AM	0.011
14460	11:57:13 AM	0.01
14520	11:58:13 AM	0.009
14580	11:59:13 AM	0.01
14640	12:00:13 PM	0.011
14700	12:01:13 PM	0.009
14760	12:02:13 PM	0.011
14820	12:03:13 PM	0.012
14880	12:04:13 PM	0.01
14940	12:05:13 PM	0.011
15000	12:06:13 PM	0.011
15060	12:07:13 PM	0.012
15120	12:08:13 PM	0.012
15180	12:09:13 PM	0.01
15240	12:10:13 PM	0.009
15300	12:11:13 PM	0.011
15360	12:12:13 PM	0.01
15420	12:13:13 PM	0.011
15480	12:14:13 PM	0.012
15540	12:15:13 PM	0.011
15600	12:16:13 PM	0.01
15660	12:17:13 PM	0.01

15720	12:18:13 PM	0.01
15780	12:19:13 PM	0.008
15840	12:20:13 PM	0.009
15900	12:21:13 PM	0.008
15960	12:22:13 PM	0.009
16020	12:23:13 PM	0.011
16080	12:24:13 PM	0.008
16140	12:25:13 PM	0.008
16200	12:26:13 PM	0.01
16260	12:27:13 PM	0.01
16320	12:28:13 PM	0.007
16380	12:29:13 PM	0.008
16440	12:30:13 PM	0.007
16500	12:31:13 PM	0.007
16560	12:32:13 PM	0.008
16620	12:33:13 PM	0.007
16680	12:34:13 PM	0.007
16740	12:35:13 PM	0.009
16800	12:36:13 PM	0.007
16860	12:37:13 PM	0.009
16920	12:38:13 PM	0.009
16980	12:39:13 PM	0.008
17040	12:40:13 PM	0.008
17100	12:41:13 PM	0.008
17160	12:42:13 PM	0.007
17220	12:43:13 PM	0.007
17280	12:44:13 PM	0.006
17340	12:45:13 PM	0.008
17400	12:46:13 PM	0.01
17460	12:47:13 PM	0.008
17520	12:48:13 PM	0.006
17580	12:49:13 PM	0.007
17640	12:50:13 PM	0.006
17700	12:51:13 PM	0.007
17760	12:52:13 PM	0.008
17820	12:53:13 PM	0.011
17880	12:54:13 PM	0.009
17940	12:55:13 PM	0.008
18000	12:56:13 PM	0.007
18060	12:57:13 PM	0.007
18120	12:58:13 PM	0.007
18180	12:59:13 PM	0.006
18240	1:00:13 PM	0.007
18300	1:01:13 PM	0.007
18360	1:02:13 PM	0.006
18420	1:03:13 PM	0.007
18480	1:04:13 PM	0.008

18540	1:05:13 PM	0.008
18600	1:06:13 PM	0.008
18660	1:07:13 PM	0.009
18720	1:08:13 PM	0.009
18780	1:09:13 PM	0.008
18840	1:10:13 PM	0.008
18900	1:11:13 PM	0.006
18960	1:12:13 PM	0.005
19020	1:13:13 PM	0.006
19080	1:14:13 PM	0.007
19140	1:15:13 PM	0.007
19200	1:16:13 PM	0.007
19260	1:17:13 PM	0.007
19320	1:18:13 PM	0.006
19380	1:19:13 PM	0.005
19440	1:20:13 PM	0.005
19500	1:21:13 PM	0.006
19560	1:22:13 PM	0.007
19620	1:23:13 PM	0.006
19680	1:24:13 PM	0.009
19740	1:25:13 PM	0.01
19800	1:26:13 PM	0.011
19860	1:27:13 PM	0.008
19920	1:28:13 PM	0.007
19980	1:29:13 PM	0.007
20040	1:30:13 PM	0.009
20100	1:31:13 PM	0.008
20160	1:32:13 PM	0.007
20220	1:33:13 PM	0.008
20280	1:34:13 PM	0.008
20340	1:35:13 PM	0.007
20400	1:36:13 PM	0.007
20460	1:37:13 PM	0.006
20520	1:38:13 PM	0.007
20580	1:39:13 PM	0.006
20640	1:40:13 PM	0.006
20700	1:41:13 PM	0.006
20760	1:42:13 PM	0.006
20820	1:43:13 PM	0.007
20880	1:44:13 PM	0.009
20940	1:45:13 PM	0.008
21000	1:46:13 PM	0.009
21060	1:47:13 PM	0.01
21120	1:48:13 PM	0.009
21180	1:49:13 PM	0.009
21240	1:50:13 PM	0.009
21300	1:51:13 PM	0.007

21360	1:52:13 PM	0.007
21420	1:53:13 PM	0.01
21480	1:54:13 PM	0.009
21540	1:55:13 PM	0.009
21600	1:56:13 PM	0.01
21660	1:57:13 PM	0.009
21720	1:58:13 PM	0.009
21780	1:59:13 PM	0.009
21840	2:00:13 PM	0.006
21900	2:01:13 PM	0.006
21960	2:02:13 PM	0.006
22020	2:03:13 PM	0.005
22080	2:04:13 PM	0.006
22140	2:05:13 PM	0.008
22200	2:06:13 PM	0.009
22260	2:07:13 PM	0.008
22320	2:08:13 PM	0.006
22380	2:09:13 PM	0.006
22440	2:10:13 PM	0.007
22500	2:11:13 PM	0.007
22560	2:12:13 PM	0.009
22620	2:13:13 PM	0.009
22680	2:14:13 PM	0.008
22740	2:15:13 PM	0.007
22800	2:16:13 PM	0.008
22860	2:17:13 PM	0.009
22920	2:18:13 PM	0.008
22980	2:19:13 PM	0.007
23040	2:20:13 PM	0.009
23100	2:21:13 PM	0.007
23160	2:22:13 PM	0.006
23220	2:23:13 PM	0.008
23280	2:24:13 PM	0.009
23340	2:25:13 PM	0.006
23400	2:26:13 PM	0.006
23460	2:27:13 PM	0.007
23520	2:28:13 PM	0.007
23580	2:29:13 PM	0.006
23640	2:30:13 PM	0.011
23700	2:31:13 PM	0.009
23760	2:32:13 PM	0.009
23820	2:33:13 PM	0.008
23880	2:34:13 PM	0.008
23940	2:35:13 PM	0.008
24000	2:36:13 PM	0.007
24060	2:37:13 PM	0.006
24120	2:38:13 PM	0.006

24180	2:39:13 PM	0.007
24240	2:40:13 PM	0.007
24300	2:41:13 PM	0.006
24360	2:42:13 PM	0.006
24420	2:43:13 PM	0.007
24480	2:44:13 PM	0.007
24540	2:45:13 PM	0.009
24600	2:46:13 PM	0.008
24660	2:47:13 PM	0.008
24720	2:48:13 PM	0.01
24780	2:49:13 PM	0.011
24840	2:50:13 PM	0.015
24900	2:51:13 PM	0.01
24960	2:52:13 PM	0.009
25020	2:53:13 PM	0.008
25080	2:54:13 PM	0.008
25140	2:55:13 PM	0.008
25200	2:56:13 PM	0.007
25260	2:57:13 PM	0.009
25320	2:58:13 PM	0.008
25380	2:59:13 PM	0.007
25440	3:00:13 PM	0.008
25500	3:01:13 PM	0.007
25560	3:02:13 PM	0.007
25620	3:03:13 PM	0.007
25680	3:04:13 PM	0.007
25740	3:05:13 PM	0.008
25800	3:06:13 PM	0.007
25860	3:07:13 PM	0.008
25920	3:08:13 PM	0.009
25980	3:09:13 PM	0.008
26040	3:10:13 PM	0.007
26100	3:11:13 PM	0.006
26160	3:12:13 PM	0.006
26220	3:13:13 PM	0.007
26280	3:14:13 PM	0.008
26340	3:15:13 PM	0.008
26400	3:16:13 PM	0.008
26460	3:17:13 PM	0.008
26520	3:18:13 PM	0.007
26580	3:19:13 PM	0.009
26640	3:20:13 PM	0.007
26700	3:21:13 PM	0.008
26760	3:22:13 PM	0.009
26820	3:23:13 PM	0.01
26880	3:24:13 PM	0.009
26940	3:25:13 PM	0.011

27000	3:26:13 PM	0.009
27060	3:27:13 PM	0.009
27120	3:28:13 PM	0.008
27180	3:29:13 PM	0.01
27240	3:30:13 PM	0.01
27300	3:31:13 PM	0.01
27360	3:32:13 PM	0.019
27420	3:33:13 PM	0.013
27480	3:34:13 PM	0.01
27540	3:35:13 PM	0.011
27600	3:36:13 PM	0.012
27660	3:37:13 PM	0.011
27720	3:38:13 PM	0.024

592-929156	11/17/2023 8:36:07 AM	Readings	PID	SC23030065D3	Normal	0.2
592-929156	11/17/2023 8:35:07 AM	Readings	PID	SC23030065D3	Normal	0.2
592-929156	11/17/2023 8:34:07 AM	Readings	PID	SC23030065D3	Normal	0.2
592-929156	11/17/2023 8:33:07 AM	Readings	PID	SC23030065D3	Normal	0.2
592-929156	11/17/2023 8:32:07 AM	Readings	PID	SC23030065D3	Normal	0.2
592-929156	11/17/2023 8:31:07 AM	Readings	PID	SC23030065D3	Normal	0.2
592-929156	11/17/2023 8:30:07 AM	Readings	PID	SC23030065D3	Normal	0.2
592-929156	11/17/2023 8:29:07 AM	Readings	PID	SC23030065D3	Normal	0.2
592-929156	11/17/2023 8:28:07 AM	Readings	PID	SC23030065D3	Normal	0.2
592-929156	11/17/2023 8:27:07 AM	Readings	PID	SC23030065D3	Normal	0.2
592-929156	11/17/2023 8:26:07 AM	Readings	PID	SC23030065D3	Normal	0.2
592-929156	11/17/2023 8:25:07 AM	Readings	PID	SC23030065D3	Normal	0.1
592-929156	11/17/2023 8:24:07 AM	Readings	PID	SC23030065D3	Normal	0.1
592-929156	11/17/2023 8:23:07 AM	Readings	PID	SC23030065D3	Normal	0.1
592-929156	11/17/2023 8:22:07 AM	Readings	PID	SC23030065D3	Normal	0.1
592-929156	11/17/2023 8:21:07 AM	Readings	PID	SC23030065D3	Normal	0.1
592-929156	11/17/2023 8:20:07 AM	Readings	PID	SC23030065D3	Normal	0.1
592-929156	11/17/2023 8:19:07 AM	Readings	PID	SC23030065D3	Normal	0.1
592-929156	11/17/2023 8:18:07 AM	Readings	PID	SC23030065D3	Normal	0.1
592-929156	11/17/2023 8:17:07 AM	Readings	PID	SC23030065D3	Normal	0.1
592-929156	11/17/2023 8:16:07 AM	Readings	PID	SC23030065D3	Normal	0.1
592-929156	11/17/2023 8:15:07 AM	Readings	PID	SC23030065D3	Normal	0.1
592-929156	11/17/2023 8:14:07 AM	Readings	PID	SC23030065D3	Normal	0.1
592-929156	11/17/2023 8:13:07 AM	Readings	PID	SC23030065D3	Normal	0.1
592-929156	11/17/2023 8:12:07 AM	Readings	PID	SC23030065D3	Normal	0.1
592-929156	11/17/2023 8:11:07 AM	Readings	PID	SC23030065D3	Normal	0.1
592-929156	11/17/2023 8:10:07 AM	Readings	PID	SC23030065D3	Normal	0.1
592-929156	11/17/2023 8:09:07 AM	CONFIG	PID	SC23030065D3		

DOWNWIND CAMP READINGS

251 DOUGLASS STREET, BROOKLYN, NY



Instrument Name	DustTrak II
Model Number	8530
Serial Number	8530100909
Firmware Version	3.1
Calibration Date	7/24/2023
Test Name	MANUAL_005
Test Start Time	7:59:36 AM
Test Start Date	11/17/2023
Test Length [D:H:M]	0:07:42
Test Interval [M:S]	1:00
Mass Average [mg/m3]	0
Mass Minimum [mg/m3]	-0.01
Mass Maximum [mg/m3]	0.177
Mass TWA [mg/m3]	0
Photometric User Cal	1
Flow User Cal	0
Errors	
Number of Samples	462

Elapsed Time [s]		Mass [mg/m3]	Alarms	Errors
0	7:59:36 AM			
60	8:00:36 AM	0.028		
120	8:01:36 AM	0.162		
180	8:02:36 AM	0.037		
240	8:03:36 AM	0.02		
300	8:04:36 AM	0.018		
360	8:05:36 AM	0.018		
420	8:06:36 AM	0.021		
480	8:07:36 AM	0.017		
540	8:08:36 AM	0.019		
600	8:09:36 AM	0.015		
660	8:10:36 AM	0.014		
720	8:11:36 AM	0.014		
780	8:12:36 AM	0.012		
840	8:13:36 AM	0.013		
900	8:14:36 AM	0.012		
960	8:15:36 AM	0.01		
1020	8:16:36 AM	0.009		
1080	8:17:36 AM	0.01		
1140	8:18:36 AM	0.008		
1200	8:19:36 AM	0.009		
1260	8:20:36 AM	0.009		
1320	8:21:36 AM	0.009		
1380	8:22:36 AM	0.006		
1440	8:23:36 AM	0.007		
1500	8:24:36 AM	0.007		
1560	8:25:36 AM	0.012		

1620	8:26:36 AM	0.024
1680	8:27:36 AM	0.029
1740	8:28:36 AM	0.049
1800	8:29:36 AM	0.095
1860	8:30:36 AM	0.019
1920	8:31:36 AM	0.091
1980	8:32:36 AM	0.169
2040	8:33:36 AM	0.177
2100	8:34:36 AM	0.075
2160	8:35:36 AM	0.055
2220	8:36:36 AM	0.012
2280	8:37:36 AM	0.029
2340	8:38:36 AM	0.027
2400	8:39:36 AM	0.025
2460	8:40:36 AM	0.008
2520	8:41:36 AM	0.013
2580	8:42:36 AM	0.005
2640	8:43:36 AM	0.004
2700	8:44:36 AM	0.009
2760	8:45:36 AM	0.002
2820	8:46:36 AM	0.009
2880	8:47:36 AM	0.012
2940	8:48:36 AM	0.009
3000	8:49:36 AM	0.006
3060	8:50:36 AM	0.008
3120	8:51:36 AM	0.008
3180	8:52:36 AM	0.006
3240	8:53:36 AM	0.004
3300	8:54:36 AM	0.005
3360	8:55:36 AM	0.004
3420	8:56:36 AM	0.004
3480	8:57:36 AM	0.007
3540	8:58:36 AM	0.01
3600	8:59:36 AM	0.011
3660	9:00:36 AM	0.014
3720	9:01:36 AM	0.013
3780	9:02:36 AM	0.015
3840	9:03:36 AM	0.018
3900	9:04:36 AM	0.02
3960	9:05:36 AM	0.022
4020	9:06:36 AM	0.022
4080	9:07:36 AM	0.019
4140	9:08:36 AM	0.021
4200	9:09:36 AM	0.023
4260	9:10:36 AM	0.017
4320	9:11:36 AM	0.015
4380	9:12:36 AM	0.014

4440	9:13:36 AM	0.015
4500	9:14:36 AM	0.013
4560	9:15:36 AM	0.011
4620	9:16:36 AM	0.011
4680	9:17:36 AM	0.018
4740	9:18:36 AM	0.011
4800	9:19:36 AM	0.011
4860	9:20:36 AM	0.011
4920	9:21:36 AM	0.012
4980	9:22:36 AM	0.007
5040	9:23:36 AM	0.007
5100	9:24:36 AM	0.006
5160	9:25:36 AM	0.007
5220	9:26:36 AM	0.007
5280	9:27:36 AM	0.006
5340	9:28:36 AM	0.005
5400	9:29:36 AM	0.005
5460	9:30:36 AM	0.004
5520	9:31:36 AM	0.004
5580	9:32:36 AM	0.006
5640	9:33:36 AM	0.005
5700	9:34:36 AM	0.005
5760	9:35:36 AM	0.003
5820	9:36:36 AM	0.001
5880	9:37:36 AM	0.001
5940	9:38:36 AM	0.001
6000	9:39:36 AM	0.002
6060	9:40:36 AM	0.003
6120	9:41:36 AM	0.001
6180	9:42:36 AM	0.001
6240	9:43:36 AM	0.001
6300	9:44:36 AM	0.001
6360	9:45:36 AM	0.001
6420	9:46:36 AM	0.001
6480	9:47:36 AM	0.001
6540	9:48:36 AM	0.001
6600	9:49:36 AM	0.001
6660	9:50:36 AM	0.001
6720	9:51:36 AM	0.001
6780	9:52:36 AM	0.001
6840	9:53:36 AM	0.001
6900	9:54:36 AM	0.001
6960	9:55:36 AM	0.001
7020	9:56:36 AM	0.001
7080	9:57:36 AM	0.001
7140	9:58:36 AM	0.001
7200	9:59:36 AM	0.001

7260	10:00:36 AM	0.001
7320	10:01:36 AM	0.001
7380	10:02:36 AM	0.001
7440	10:03:36 AM	0.001
7500	10:04:36 AM	0.001
7560	10:05:36 AM	0.001
7620	10:06:36 AM	0.001
7680	10:07:36 AM	0.001
7740	10:08:36 AM	0.001
7800	10:09:36 AM	0.001
7860	10:10:36 AM	0
7920	10:11:36 AM	0
7980	10:12:36 AM	-0.001
8040	10:13:36 AM	0
8100	10:14:36 AM	-0.001
8160	10:15:36 AM	-0.001
8220	10:16:36 AM	-0.001
8280	10:17:36 AM	-0.002
8340	10:18:36 AM	-0.002
8400	10:19:36 AM	-0.002
8460	10:20:36 AM	-0.004
8520	10:21:36 AM	-0.004
8580	10:22:36 AM	-0.005
8640	10:23:36 AM	-0.005
8700	10:24:36 AM	-0.005
8760	10:25:36 AM	0
8820	10:26:36 AM	-0.003
8880	10:27:36 AM	-0.003
8940	10:28:36 AM	0.008
9000	10:29:36 AM	0.001
9060	10:30:36 AM	-0.002
9120	10:31:36 AM	-0.003
9180	10:32:36 AM	-0.004
9240	10:33:36 AM	-0.005
9300	10:34:36 AM	-0.005
9360	10:35:36 AM	-0.005
9420	10:36:36 AM	-0.005
9480	10:37:36 AM	-0.004
9540	10:38:36 AM	-0.002
9600	10:39:36 AM	-0.004
9660	10:40:36 AM	-0.004
9720	10:41:36 AM	-0.002
9780	10:42:36 AM	-0.004
9840	10:43:36 AM	-0.003
9900	10:44:36 AM	-0.004
9960	10:45:36 AM	-0.004
10020	10:46:36 AM	-0.004

10080	10:47:36 AM	-0.004
10140	10:48:36 AM	-0.005
10200	10:49:36 AM	-0.005
10260	10:50:36 AM	-0.006
10320	10:51:36 AM	-0.005
10380	10:52:36 AM	-0.001
10440	10:53:36 AM	0
10500	10:54:36 AM	-0.001
10560	10:55:36 AM	-0.005
10620	10:56:36 AM	-0.003
10680	10:57:36 AM	-0.003
10740	10:58:36 AM	-0.003
10800	10:59:36 AM	-0.002
10860	11:00:36 AM	-0.003
10920	11:01:36 AM	-0.003
10980	11:02:36 AM	-0.005
11040	11:03:36 AM	-0.004
11100	11:04:36 AM	-0.004
11160	11:05:36 AM	-0.004
11220	11:06:36 AM	-0.002
11280	11:07:36 AM	-0.003
11340	11:08:36 AM	-0.004
11400	11:09:36 AM	-0.005
11460	11:10:36 AM	-0.006
11520	11:11:36 AM	-0.006
11580	11:12:36 AM	-0.005
11640	11:13:36 AM	-0.007
11700	11:14:36 AM	-0.004
11760	11:15:36 AM	-0.005
11820	11:16:36 AM	-0.007
11880	11:17:36 AM	-0.008
11940	11:18:36 AM	-0.005
12000	11:19:36 AM	-0.006
12060	11:20:36 AM	-0.007
12120	11:21:36 AM	-0.008
12180	11:22:36 AM	-0.005
12240	11:23:36 AM	-0.006
12300	11:24:36 AM	-0.006
12360	11:25:36 AM	-0.004
12420	11:26:36 AM	-0.008
12480	11:27:36 AM	-0.005
12540	11:28:36 AM	-0.005
12600	11:29:36 AM	-0.007
12660	11:30:36 AM	-0.008
12720	11:31:36 AM	-0.008
12780	11:32:36 AM	-0.007
12840	11:33:36 AM	-0.007

12900	11:34:36 AM	-0.005
12960	11:35:36 AM	-0.007
13020	11:36:36 AM	-0.008
13080	11:37:36 AM	-0.009
13140	11:38:36 AM	-0.008
13200	11:39:36 AM	-0.007
13260	11:40:36 AM	-0.005
13320	11:41:36 AM	-0.006
13380	11:42:36 AM	-0.006
13440	11:43:36 AM	-0.009
13500	11:44:36 AM	-0.008
13560	11:45:36 AM	-0.008
13620	11:46:36 AM	-0.006
13680	11:47:36 AM	-0.007
13740	11:48:36 AM	-0.009
13800	11:49:36 AM	-0.008
13860	11:50:36 AM	-0.008
13920	11:51:36 AM	-0.008
13980	11:52:36 AM	-0.008
14040	11:53:36 AM	-0.007
14100	11:54:36 AM	-0.009
14160	11:55:36 AM	-0.007
14220	11:56:36 AM	-0.006
14280	11:57:36 AM	-0.01
14340	11:58:36 AM	-0.01
14400	11:59:36 AM	-0.01
14460	12:00:36 PM	-0.009
14520	12:01:36 PM	-0.007
14580	12:02:36 PM	-0.007
14640	12:03:36 PM	-0.008
14700	12:04:36 PM	-0.008
14760	12:05:36 PM	-0.007
14820	12:06:36 PM	-0.008
14880	12:07:36 PM	-0.008
14940	12:08:36 PM	-0.009
15000	12:09:36 PM	-0.009
15060	12:10:36 PM	-0.008
15120	12:11:36 PM	-0.009
15180	12:12:36 PM	-0.008
15240	12:13:36 PM	-0.007
15300	12:14:36 PM	-0.007
15360	12:15:36 PM	-0.007
15420	12:16:36 PM	-0.008
15480	12:17:36 PM	-0.007
15540	12:18:36 PM	-0.007
15600	12:19:36 PM	-0.008
15660	12:20:36 PM	-0.008

15720	12:21:36 PM	-0.009
15780	12:22:36 PM	-0.007
15840	12:23:36 PM	-0.007
15900	12:24:36 PM	-0.008
15960	12:25:36 PM	-0.008
16020	12:26:36 PM	-0.008
16080	12:27:36 PM	-0.007
16140	12:28:36 PM	-0.008
16200	12:29:36 PM	-0.007
16260	12:30:36 PM	-0.006
16320	12:31:36 PM	-0.008
16380	12:32:36 PM	-0.007
16440	12:33:36 PM	-0.009
16500	12:34:36 PM	-0.007
16560	12:35:36 PM	-0.008
16620	12:36:36 PM	-0.007
16680	12:37:36 PM	-0.006
16740	12:38:36 PM	-0.007
16800	12:39:36 PM	-0.007
16860	12:40:36 PM	-0.008
16920	12:41:36 PM	-0.006
16980	12:42:36 PM	-0.008
17040	12:43:36 PM	-0.006
17100	12:44:36 PM	-0.007
17160	12:45:36 PM	0
17220	12:46:36 PM	-0.002
17280	12:47:36 PM	-0.003
17340	12:48:36 PM	0.001
17400	12:49:36 PM	0.106
17460	12:50:36 PM	0.005
17520	12:51:36 PM	-0.007
17580	12:52:36 PM	-0.006
17640	12:53:36 PM	-0.004
17700	12:54:36 PM	-0.003
17760	12:55:36 PM	-0.005
17820	12:56:36 PM	-0.006
17880	12:57:36 PM	-0.007
17940	12:58:36 PM	-0.007
18000	12:59:36 PM	-0.007
18060	1:00:36 PM	-0.008
18120	1:01:36 PM	-0.008
18180	1:02:36 PM	-0.006
18240	1:03:36 PM	-0.006
18300	1:04:36 PM	-0.002
18360	1:05:36 PM	-0.006
18420	1:06:36 PM	-0.005
18480	1:07:36 PM	-0.005

18540	1:08:36 PM	-0.006
18600	1:09:36 PM	-0.007
18660	1:10:36 PM	-0.007
18720	1:11:36 PM	-0.009
18780	1:12:36 PM	-0.009
18840	1:13:36 PM	-0.008
18900	1:14:36 PM	-0.008
18960	1:15:36 PM	-0.008
19020	1:16:36 PM	-0.008
19080	1:17:36 PM	-0.008
19140	1:18:36 PM	-0.009
19200	1:19:36 PM	-0.008
19260	1:20:36 PM	-0.008
19320	1:21:36 PM	-0.008
19380	1:22:36 PM	-0.005
19440	1:23:36 PM	-0.005
19500	1:24:36 PM	-0.006
19560	1:25:36 PM	-0.005
19620	1:26:36 PM	-0.003
19680	1:27:36 PM	-0.008
19740	1:28:36 PM	-0.008
19800	1:29:36 PM	-0.006
19860	1:30:36 PM	-0.007
19920	1:31:36 PM	-0.007
19980	1:32:36 PM	-0.007
20040	1:33:36 PM	-0.007
20100	1:34:36 PM	-0.006
20160	1:35:36 PM	-0.006
20220	1:36:36 PM	-0.005
20280	1:37:36 PM	-0.002
20340	1:38:36 PM	-0.006
20400	1:39:36 PM	-0.007
20460	1:40:36 PM	-0.008
20520	1:41:36 PM	-0.007
20580	1:42:36 PM	-0.008
20640	1:43:36 PM	-0.007
20700	1:44:36 PM	-0.008
20760	1:45:36 PM	-0.006
20820	1:46:36 PM	-0.006
20880	1:47:36 PM	-0.005
20940	1:48:36 PM	-0.007
21000	1:49:36 PM	-0.006
21060	1:50:36 PM	-0.007
21120	1:51:36 PM	-0.007
21180	1:52:36 PM	-0.006
21240	1:53:36 PM	-0.007
21300	1:54:36 PM	-0.006

21360	1:55:36 PM	-0.006
21420	1:56:36 PM	-0.006
21480	1:57:36 PM	-0.007
21540	1:58:36 PM	-0.006
21600	1:59:36 PM	-0.007
21660	2:00:36 PM	-0.007
21720	2:01:36 PM	-0.007
21780	2:02:36 PM	-0.007
21840	2:03:36 PM	-0.008
21900	2:04:36 PM	-0.006
21960	2:05:36 PM	-0.005
22020	2:06:36 PM	-0.006
22080	2:07:36 PM	-0.006
22140	2:08:36 PM	-0.007
22200	2:09:36 PM	-0.007
22260	2:10:36 PM	-0.007
22320	2:11:36 PM	-0.006
22380	2:12:36 PM	-0.005
22440	2:13:36 PM	-0.007
22500	2:14:36 PM	-0.005
22560	2:15:36 PM	-0.005
22620	2:16:36 PM	-0.006
22680	2:17:36 PM	-0.006
22740	2:18:36 PM	-0.007
22800	2:19:36 PM	-0.008
22860	2:20:36 PM	-0.008
22920	2:21:36 PM	-0.008
22980	2:22:36 PM	-0.008
23040	2:23:36 PM	-0.004
23100	2:24:36 PM	-0.006
23160	2:25:36 PM	-0.004
23220	2:26:36 PM	-0.008
23280	2:27:36 PM	-0.009
23340	2:28:36 PM	-0.007
23400	2:29:36 PM	-0.005
23460	2:30:36 PM	-0.008
23520	2:31:36 PM	-0.008
23580	2:32:36 PM	-0.008
23640	2:33:36 PM	-0.009
23700	2:34:36 PM	-0.003
23760	2:35:36 PM	-0.001
23820	2:36:36 PM	-0.007
23880	2:37:36 PM	-0.006
23940	2:38:36 PM	-0.008
24000	2:39:36 PM	-0.008
24060	2:40:36 PM	-0.009
24120	2:41:36 PM	-0.009

24180	2:42:36 PM	-0.01
24240	2:43:36 PM	-0.009
24300	2:44:36 PM	-0.008
24360	2:45:36 PM	-0.006
24420	2:46:36 PM	-0.006
24480	2:47:36 PM	-0.003
24540	2:48:36 PM	-0.001
24600	2:49:36 PM	-0.006
24660	2:50:36 PM	-0.005
24720	2:51:36 PM	-0.008
24780	2:52:36 PM	-0.008
24840	2:53:36 PM	-0.007
24900	2:54:36 PM	-0.008
24960	2:55:36 PM	-0.009
25020	2:56:36 PM	-0.01
25080	2:57:36 PM	-0.008
25140	2:58:36 PM	-0.007
25200	2:59:36 PM	-0.008
25260	3:00:36 PM	-0.009
25320	3:01:36 PM	-0.01
25380	3:02:36 PM	-0.01
25440	3:03:36 PM	-0.009
25500	3:04:36 PM	-0.007
25560	3:05:36 PM	-0.009
25620	3:06:36 PM	-0.009
25680	3:07:36 PM	-0.008
25740	3:08:36 PM	-0.008
25800	3:09:36 PM	-0.009
25860	3:10:36 PM	-0.01
25920	3:11:36 PM	-0.01
25980	3:12:36 PM	-0.009
26040	3:13:36 PM	-0.007
26100	3:14:36 PM	-0.007
26160	3:15:36 PM	-0.009
26220	3:16:36 PM	-0.009
26280	3:17:36 PM	-0.009
26340	3:18:36 PM	-0.008
26400	3:19:36 PM	-0.007
26460	3:20:36 PM	-0.008
26520	3:21:36 PM	-0.007
26580	3:22:36 PM	-0.006
26640	3:23:36 PM	-0.006
26700	3:24:36 PM	-0.001
26760	3:25:36 PM	-0.003
26820	3:26:36 PM	-0.005
26880	3:27:36 PM	-0.007
26940	3:28:36 PM	-0.005

27000	3:29:36 PM	-0.005
27060	3:30:36 PM	-0.005
27120	3:31:36 PM	-0.008
27180	3:32:36 PM	-0.007
27240	3:33:36 PM	-0.007
27300	3:34:36 PM	-0.007
27360	3:35:36 PM	0
27420	3:36:36 PM	-0.005
27480	3:37:36 PM	-0.007
27540	3:38:36 PM	-0.006
27600	3:39:36 PM	-0.007
27660	3:40:36 PM	-0.007
27720	3:41:36 PM	-0.004

Device Serial No	Log Time	Log Type	Sensor 1 Type	Sensor 1 Serial Number	Sensor 1 Status	Sensor 1 Gas Reading
592-602816	11/17/2023 3:52:05 PM	Readings	PID	SC23030324C7	Normal	1.8
592-602816	11/17/2023 3:51:05 PM	Readings	PID	SC23030324C7	Normal	1.8
592-602816	11/17/2023 3:50:05 PM	Readings	PID	SC23030324C7	Normal	1.8
592-602816	11/17/2023 3:49:05 PM	Readings	PID	SC23030324C7	Normal	1.9
592-602816	11/17/2023 3:48:05 PM	Readings	PID	SC23030324C7	Normal	2.0
592-602816	11/17/2023 3:47:05 PM	Readings	PID	SC23030324C7	Normal	2.0
592-602816	11/17/2023 3:46:05 PM	Readings	PID	SC23030324C7	Normal	1.9
592-602816	11/17/2023 3:45:05 PM	Readings	PID	SC23030324C7	Normal	2.0
592-602816	11/17/2023 3:44:05 PM	Readings	PID	SC23030324C7	Normal	2.4
592-602816	11/17/2023 3:43:05 PM	Readings	PID	SC23030324C7	Normal	2.1
592-602816	11/17/2023 3:42:05 PM	Readings	PID	SC23030324C7	Normal	2.6
592-602816	11/17/2023 3:41:05 PM	Readings	PID	SC23030324C7	Normal	2.1
592-602816	11/17/2023 3:40:05 PM	Readings	PID	SC23030324C7	Normal	1.9
592-602816	11/17/2023 3:39:05 PM	Readings	PID	SC23030324C7	Normal	2.0
592-602816	11/17/2023 3:38:05 PM	Readings	PID	SC23030324C7	Normal	2.4
592-602816	11/17/2023 3:37:05 PM	Readings	PID	SC23030324C7	Normal	2.1
592-602816	11/17/2023 3:36:05 PM	Readings	PID	SC23030324C7	Normal	2.5
592-602816	11/17/2023 3:35:05 PM	Readings	PID	SC23030324C7	Normal	2.0
592-602816	11/17/2023 3:34:05 PM	Readings	PID	SC23030324C7	Normal	2.2
592-602816	11/17/2023 3:33:05 PM	Readings	PID	SC23030324C7	Normal	2.3
592-602816	11/17/2023 3:32:05 PM	Readings	PID	SC23030324C7	Normal	2.2
592-602816	11/17/2023 3:31:05 PM	Readings	PID	SC23030324C7	Normal	1.9
592-602816	11/17/2023 3:30:05 PM	Readings	PID	SC23030324C7	Normal	2.3
592-602816	11/17/2023 3:29:05 PM	Readings	PID	SC23030324C7	Normal	1.9
592-602816	11/17/2023 3:28:05 PM	Readings	PID	SC23030324C7	Normal	1.9
592-602816	11/17/2023 3:27:05 PM	Readings	PID	SC23030324C7	Normal	1.9
592-602816	11/17/2023 3:26:05 PM	Readings	PID	SC23030324C7	Normal	2.3
592-602816	11/17/2023 3:25:05 PM	Readings	PID	SC23030324C7	Normal	2.2
592-602816	11/17/2023 3:24:05 PM	Readings	PID	SC23030324C7	Normal	2.2
592-602816	11/17/2023 3:23:05 PM	Readings	PID	SC23030324C7	Normal	1.9
592-602816	11/17/2023 3:22:05 PM	Readings	PID	SC23030324C7	Normal	1.8
592-602816	11/17/2023 3:21:05 PM	Readings	PID	SC23030324C7	Normal	1.9
592-602816	11/17/2023 3:20:05 PM	Readings	PID	SC23030324C7	Normal	1.9
592-602816	11/17/2023 3:19:05 PM	Readings	PID	SC23030324C7	Normal	1.8
592-602816	11/17/2023 3:18:05 PM	Readings	PID	SC23030324C7	Normal	2.0
592-602816	11/17/2023 3:17:05 PM	Readings	PID	SC23030324C7	Normal	1.9

592-602816	11/17/2023 2:37:05 PM	Readings	PID	SC23030324C7	Normal	2.1
592-602816	11/17/2023 2:36:05 PM	Readings	PID	SC23030324C7	Normal	2.0
592-602816	11/17/2023 2:35:05 PM	Readings	PID	SC23030324C7	Normal	3.0
592-602816	11/17/2023 2:34:05 PM	Readings	PID	SC23030324C7	Normal	3.3
592-602816	11/17/2023 2:33:05 PM	Readings	PID	SC23030324C7	Normal	2.5
592-602816	11/17/2023 2:32:05 PM	Readings	PID	SC23030324C7	Normal	1.9
592-602816	11/17/2023 2:31:05 PM	Readings	PID	SC23030324C7	Normal	2.1
592-602816	11/17/2023 2:30:05 PM	Readings	PID	SC23030324C7	Normal	2.1
592-602816	11/17/2023 2:29:05 PM	Readings	PID	SC23030324C7	Normal	2.4
592-602816	11/17/2023 2:28:05 PM	Readings	PID	SC23030324C7	Normal	1.9
592-602816	11/17/2023 2:27:05 PM	Readings	PID	SC23030324C7	Normal	2.1
592-602816	11/17/2023 2:26:05 PM	Readings	PID	SC23030324C7	Normal	2.2
592-602816	11/17/2023 2:25:05 PM	Readings	PID	SC23030324C7	Normal	2.2
592-602816	11/17/2023 2:24:05 PM	Readings	PID	SC23030324C7	Normal	2.5
592-602816	11/17/2023 2:23:05 PM	Readings	PID	SC23030324C7	Normal	2.5
592-602816	11/17/2023 2:22:05 PM	Readings	PID	SC23030324C7	Normal	2.3
592-602816	11/17/2023 2:21:05 PM	Readings	PID	SC23030324C7	Normal	2.7
592-602816	11/17/2023 2:20:05 PM	Readings	PID	SC23030324C7	Normal	3.0
592-602816	11/17/2023 2:19:05 PM	Readings	PID	SC23030324C7	Normal	2.7
592-602816	11/17/2023 2:18:05 PM	Readings	PID	SC23030324C7	Normal	2.8
592-602816	11/17/2023 2:17:05 PM	Readings	PID	SC23030324C7	Normal	3.1
592-602816	11/17/2023 2:16:05 PM	Readings	PID	SC23030324C7	Normal	2.3
592-602816	11/17/2023 2:15:05 PM	Readings	PID	SC23030324C7	Normal	2.4
592-602816	11/17/2023 2:14:05 PM	Readings	PID	SC23030324C7	Normal	1.9
592-602816	11/17/2023 2:13:05 PM	Readings	PID	SC23030324C7	Normal	2.1
592-602816	11/17/2023 2:12:05 PM	Readings	PID	SC23030324C7	Normal	2.1
592-602816	11/17/2023 2:11:05 PM	Readings	PID	SC23030324C7	Normal	2.2
592-602816	11/17/2023 2:10:05 PM	Readings	PID	SC23030324C7	Normal	2.2
592-602816	11/17/2023 2:09:05 PM	Readings	PID	SC23030324C7	Normal	1.9
592-602816	11/17/2023 2:08:05 PM	Readings	PID	SC23030324C7	Normal	2.0
592-602816	11/17/2023 2:07:05 PM	Readings	PID	SC23030324C7	Normal	1.9
592-602816	11/17/2023 2:06:05 PM	Readings	PID	SC23030324C7	Normal	1.9
592-602816	11/17/2023 2:05:05 PM	Readings	PID	SC23030324C7	Normal	1.9
592-602816	11/17/2023 2:04:05 PM	Readings	PID	SC23030324C7	Normal	1.9
592-602816	11/17/2023 2:03:05 PM	Readings	PID	SC23030324C7	Normal	1.9
592-602816	11/17/2023 2:02:05 PM	Readings	PID	SC23030324C7	Normal	1.9
592-602816	11/17/2023 2:01:05 PM	Readings	PID	SC23030324C7	Normal	1.9
592-602816	11/17/2023 2:00:05 PM	Readings	PID	SC23030324C7	Normal	1.9
592-602816	11/17/2023 1:59:05 PM	Readings	PID	SC23030324C7	Normal	2.1

592-602816	11/17/2023 1:58:05 PM	Readings	PID	SC23030324C7	Normal	2.2
592-602816	11/17/2023 1:57:05 PM	Readings	PID	SC23030324C7	Normal	2.1
592-602816	11/17/2023 1:56:05 PM	Readings	PID	SC23030324C7	Normal	2.5
592-602816	11/17/2023 1:55:05 PM	Readings	PID	SC23030324C7	Normal	2.1
592-602816	11/17/2023 1:54:05 PM	Readings	PID	SC23030324C7	Normal	2.7
592-602816	11/17/2023 1:53:05 PM	Readings	PID	SC23030324C7	Normal	2.4
592-602816	11/17/2023 1:52:05 PM	Readings	PID	SC23030324C7	Normal	1.9
592-602816	11/17/2023 1:51:05 PM	Readings	PID	SC23030324C7	Normal	2.1
592-602816	11/17/2023 1:50:05 PM	Readings	PID	SC23030324C7	Normal	2.9
592-602816	11/17/2023 1:49:05 PM	Readings	PID	SC23030324C7	Normal	3.5
592-602816	11/17/2023 1:48:05 PM	Readings	PID	SC23030324C7	Normal	2.2
592-602816	11/17/2023 1:47:05 PM	Readings	PID	SC23030324C7	Normal	2.0
592-602816	11/17/2023 1:46:05 PM	Readings	PID	SC23030324C7	Normal	2.2
592-602816	11/17/2023 1:45:05 PM	Readings	PID	SC23030324C7	Normal	2.3
592-602816	11/17/2023 1:44:05 PM	Readings	PID	SC23030324C7	Normal	1.9
592-602816	11/17/2023 1:43:05 PM	Readings	PID	SC23030324C7	Normal	2.1
592-602816	11/17/2023 1:42:05 PM	Readings	PID	SC23030324C7	Normal	1.9
592-602816	11/17/2023 1:41:05 PM	Readings	PID	SC23030324C7	Normal	1.9
592-602816	11/17/2023 1:40:05 PM	Readings	PID	SC23030324C7	Normal	1.9
592-602816	11/17/2023 1:39:05 PM	Readings	PID	SC23030324C7	Normal	1.9
592-602816	11/17/2023 1:38:05 PM	Readings	PID	SC23030324C7	Normal	2.0
592-602816	11/17/2023 1:37:05 PM	Readings	PID	SC23030324C7	Normal	2.1
592-602816	11/17/2023 1:36:05 PM	Readings	PID	SC23030324C7	Normal	1.9
592-602816	11/17/2023 1:35:05 PM	Readings	PID	SC23030324C7	Normal	2.1
592-602816	11/17/2023 1:34:05 PM	Readings	PID	SC23030324C7	Normal	2.3
592-602816	11/17/2023 1:33:05 PM	Readings	PID	SC23030324C7	Normal	2.2
592-602816	11/17/2023 1:32:05 PM	Readings	PID	SC23030324C7	Normal	2.0
592-602816	11/17/2023 1:31:05 PM	Readings	PID	SC23030324C7	Normal	2.1
592-602816	11/17/2023 1:30:05 PM	Readings	PID	SC23030324C7	Normal	2.0
592-602816	11/17/2023 1:29:05 PM	Readings	PID	SC23030324C7	Normal	2.0
592-602816	11/17/2023 1:28:05 PM	Readings	PID	SC23030324C7	Normal	1.9
592-602816	11/17/2023 1:27:05 PM	Readings	PID	SC23030324C7	Normal	2.1
592-602816	11/17/2023 1:26:05 PM	Readings	PID	SC23030324C7	Normal	1.9
592-602816	11/17/2023 1:25:05 PM	Readings	PID	SC23030324C7	Normal	2.2
592-602816	11/17/2023 1:24:05 PM	Readings	PID	SC23030324C7	Normal	2.2
592-602816	11/17/2023 1:23:05 PM	Readings	PID	SC23030324C7	Normal	1.9
592-602816	11/17/2023 1:22:05 PM	Readings	PID	SC23030324C7	Normal	2.1
592-602816	11/17/2023 1:21:05 PM	Readings	PID	SC23030324C7	Normal	2.4
592-602816	11/17/2023 1:20:05 PM	Readings	PID	SC23030324C7	Normal	2.0

592-602816	11/17/2023 1:19:05 PM	Readings	PID	SC23030324C7	Normal	1.9
592-602816	11/17/2023 1:18:05 PM	Readings	PID	SC23030324C7	Normal	2.1
592-602816	11/17/2023 1:17:05 PM	Readings	PID	SC23030324C7	Normal	2.1
592-602816	11/17/2023 1:16:05 PM	Readings	PID	SC23030324C7	Normal	2.1
592-602816	11/17/2023 1:15:05 PM	Readings	PID	SC23030324C7	Normal	2.0
592-602816	11/17/2023 1:14:05 PM	Readings	PID	SC23030324C7	Normal	2.0
592-602816	11/17/2023 1:13:05 PM	Readings	PID	SC23030324C7	Normal	2.0
592-602816	11/17/2023 1:12:05 PM	Readings	PID	SC23030324C7	Normal	1.9
592-602816	11/17/2023 1:11:05 PM	Readings	PID	SC23030324C7	Normal	2.0
592-602816	11/17/2023 1:10:05 PM	Readings	PID	SC23030324C7	Normal	2.1
592-602816	11/17/2023 1:09:05 PM	Readings	PID	SC23030324C7	Normal	1.9
592-602816	11/17/2023 1:08:05 PM	Readings	PID	SC23030324C7	Normal	1.9
592-602816	11/17/2023 1:07:05 PM	Readings	PID	SC23030324C7	Normal	2.2
592-602816	11/17/2023 1:06:05 PM	Readings	PID	SC23030324C7	Normal	2.4
592-602816	11/17/2023 1:05:05 PM	Readings	PID	SC23030324C7	Normal	2.1
592-602816	11/17/2023 1:04:05 PM	Readings	PID	SC23030324C7	Normal	2.1
592-602816	11/17/2023 1:03:05 PM	Readings	PID	SC23030324C7	Normal	1.9
592-602816	11/17/2023 1:02:05 PM	Readings	PID	SC23030324C7	Normal	1.9
592-602816	11/17/2023 1:01:05 PM	Readings	PID	SC23030324C7	Normal	2.1
592-602816	11/17/2023 1:00:05 PM	Readings	PID	SC23030324C7	Normal	2.1
592-602816	11/17/2023 12:59:05 PM	Readings	PID	SC23030324C7	Normal	2.1
592-602816	11/17/2023 12:58:05 PM	Readings	PID	SC23030324C7	Normal	2.2
592-602816	11/17/2023 12:57:05 PM	Readings	PID	SC23030324C7	Normal	1.9
592-602816	11/17/2023 12:56:05 PM	Readings	PID	SC23030324C7	Normal	1.9
592-602816	11/17/2023 12:55:05 PM	Readings	PID	SC23030324C7	Normal	2.0
592-602816	11/17/2023 12:54:05 PM	Readings	PID	SC23030324C7	Normal	2.2
592-602816	11/17/2023 12:53:05 PM	Readings	PID	SC23030324C7	Normal	1.9
592-602816	11/17/2023 12:52:05 PM	Readings	PID	SC23030324C7	Normal	1.9
592-602816	11/17/2023 12:51:05 PM	Readings	PID	SC23030324C7	Normal	2.0
592-602816	11/17/2023 12:50:05 PM	Readings	PID	SC23030324C7	Normal	2.0
592-602816	11/17/2023 12:49:05 PM	Readings	PID	SC23030324C7	Normal	2.1
592-602816	11/17/2023 12:48:05 PM	Readings	PID	SC23030324C7	Normal	2.1
592-602816	11/17/2023 12:47:05 PM	Readings	PID	SC23030324C7	Normal	2.1
592-602816	11/17/2023 12:46:05 PM	Readings	PID	SC23030324C7	Normal	2.1
592-602816	11/17/2023 12:45:05 PM	Readings	PID	SC23030324C7	Normal	2.0
592-602816	11/17/2023 12:44:05 PM	Readings	PID	SC23030324C7	Normal	2.0
592-602816	11/17/2023 12:43:05 PM	Readings	PID	SC23030324C7	Normal	2.1
592-602816	11/17/2023 12:42:05 PM	Readings	PID	SC23030324C7	Normal	2.2
592-602816	11/17/2023 12:41:05 PM	Readings	PID	SC23030324C7	Normal	2.4

592-602816	11/17/2023 10:04:05 AM	Readings	PID	SC23030324C7	Normal	2.3
592-602816	11/17/2023 10:03:05 AM	Readings	PID	SC23030324C7	Normal	1.8
592-602816	11/17/2023 10:02:05 AM	Readings	PID	SC23030324C7	Normal	1.9
592-602816	11/17/2023 10:01:05 AM	Readings	PID	SC23030324C7	Normal	1.8
592-602816	11/17/2023 10:00:05 AM	Readings	PID	SC23030324C7	Normal	1.8
592-602816	11/17/2023 9:59:05 AM	Readings	PID	SC23030324C7	Normal	1.8
592-602816	11/17/2023 9:58:05 AM	Readings	PID	SC23030324C7	Normal	1.9
592-602816	11/17/2023 9:57:05 AM	Readings	PID	SC23030324C7	Normal	1.8
592-602816	11/17/2023 9:56:05 AM	Readings	PID	SC23030324C7	Normal	2.1
592-602816	11/17/2023 9:55:05 AM	Readings	PID	SC23030324C7	Normal	2.1
592-602816	11/17/2023 9:54:05 AM	Readings	PID	SC23030324C7	Normal	1.9
592-602816	11/17/2023 9:53:05 AM	Readings	PID	SC23030324C7	Normal	2.2
592-602816	11/17/2023 9:52:05 AM	Readings	PID	SC23030324C7	Normal	2.0
592-602816	11/17/2023 9:51:05 AM	Readings	PID	SC23030324C7	Normal	2.2
592-602816	11/17/2023 9:50:05 AM	Readings	PID	SC23030324C7	Normal	2.8
592-602816	11/17/2023 9:49:05 AM	Readings	PID	SC23030324C7	Normal	2.5
592-602816	11/17/2023 9:48:05 AM	Readings	PID	SC23030324C7	Normal	2.3
592-602816	11/17/2023 9:47:05 AM	Readings	PID	SC23030324C7	Normal	2.0
592-602816	11/17/2023 9:46:05 AM	Readings	PID	SC23030324C7	Normal	2.6
592-602816	11/17/2023 9:45:05 AM	Readings	PID	SC23030324C7	Normal	4.5
592-602816	11/17/2023 9:44:05 AM	Readings	PID	SC23030324C7	Normal	3.2
592-602816	11/17/2023 9:43:05 AM	Readings	PID	SC23030324C7	Normal	2.1
592-602816	11/17/2023 9:42:05 AM	Readings	PID	SC23030324C7	Normal	2.4
592-602816	11/17/2023 9:41:05 AM	Readings	PID	SC23030324C7	Normal	1.8
592-602816	11/17/2023 9:40:05 AM	Readings	PID	SC23030324C7	Normal	1.8
592-602816	11/17/2023 9:39:05 AM	Readings	PID	SC23030324C7	Normal	1.8
592-602816	11/17/2023 9:38:05 AM	Readings	PID	SC23030324C7	Normal	1.8
592-602816	11/17/2023 9:37:05 AM	Readings	PID	SC23030324C7	Normal	1.8
592-602816	11/17/2023 9:36:05 AM	Readings	PID	SC23030324C7	Normal	1.9
592-602816	11/17/2023 9:35:05 AM	Readings	PID	SC23030324C7	Normal	2.0
592-602816	11/17/2023 9:34:05 AM	Readings	PID	SC23030324C7	Normal	1.8
592-602816	11/17/2023 9:33:05 AM	Readings	PID	SC23030324C7	Normal	1.8
592-602816	11/17/2023 9:32:05 AM	Readings	PID	SC23030324C7	Normal	2.0
592-602816	11/17/2023 9:31:05 AM	Readings	PID	SC23030324C7	Normal	2.0
592-602816	11/17/2023 9:30:05 AM	Readings	PID	SC23030324C7	Normal	1.8
592-602816	11/17/2023 9:29:05 AM	Readings	PID	SC23030324C7	Normal	1.8
592-602816	11/17/2023 9:28:05 AM	Readings	PID	SC23030324C7	Normal	1.8
592-602816	11/17/2023 9:27:05 AM	Readings	PID	SC23030324C7	Normal	1.8
592-602816	11/17/2023 9:26:05 AM	Readings	PID	SC23030324C7	Normal	1.7

592-602816	11/17/2023 8:46:05 AM	Readings	PID	SC23030324C7	Normal	1.2
592-602816	11/17/2023 8:45:05 AM	Readings	PID	SC23030324C7	Normal	1.7
592-602816	11/17/2023 8:44:05 AM	Readings	PID	SC23030324C7	Normal	1.6
592-602816	11/17/2023 8:43:05 AM	Readings	PID	SC23030324C7	Normal	1.0
592-602816	11/17/2023 8:42:05 AM	Readings	PID	SC23030324C7	Normal	1.1
592-602816	11/17/2023 8:41:05 AM	Readings	PID	SC23030324C7	Normal	1.1
592-602816	11/17/2023 8:40:05 AM	Readings	PID	SC23030324C7	Normal	1.2
592-602816	11/17/2023 8:39:05 AM	Readings	PID	SC23030324C7	Normal	1.1
592-602816	11/17/2023 8:38:05 AM	Readings	PID	SC23030324C7	Normal	1.0
592-602816	11/17/2023 8:37:05 AM	Readings	PID	SC23030324C7	Normal	0.9
592-602816	11/17/2023 8:36:05 AM	Readings	PID	SC23030324C7	Normal	0.9
592-602816	11/17/2023 8:35:05 AM	Readings	PID	SC23030324C7	Normal	0.8
592-602816	11/17/2023 8:34:05 AM	Readings	PID	SC23030324C7	Normal	0.8
592-602816	11/17/2023 8:33:05 AM	Readings	PID	SC23030324C7	Normal	0.8
592-602816	11/17/2023 8:32:05 AM	Readings	PID	SC23030324C7	Normal	0.8
592-602816	11/17/2023 8:31:05 AM	Readings	PID	SC23030324C7	Normal	0.8
592-602816	11/17/2023 8:30:05 AM	Readings	PID	SC23030324C7	Normal	0.8
592-602816	11/17/2023 8:29:05 AM	Readings	PID	SC23030324C7	Normal	0.8
592-602816	11/17/2023 8:28:05 AM	Readings	PID	SC23030324C7	Normal	0.6
592-602816	11/17/2023 8:27:05 AM	Readings	PID	SC23030324C7	Normal	0.6
592-602816	11/17/2023 8:26:05 AM	Readings	PID	SC23030324C7	Normal	0.6
592-602816	11/17/2023 8:25:05 AM	Readings	PID	SC23030324C7	Normal	0.6
592-602816	11/17/2023 8:24:05 AM	Readings	PID	SC23030324C7	Normal	0.5
592-602816	11/17/2023 8:23:05 AM	Readings	PID	SC23030324C7	Normal	0.5
592-602816	11/17/2023 8:22:05 AM	Readings	PID	SC23030324C7	Normal	0.4
592-602816	11/17/2023 8:21:05 AM	Readings	PID	SC23030324C7	Normal	0.4
592-602816	11/17/2023 8:20:05 AM	Readings	PID	SC23030324C7	Normal	0.4
592-602816	11/17/2023 8:19:05 AM	Readings	PID	SC23030324C7	Normal	0.4
592-602816	11/17/2023 8:18:05 AM	Readings	PID	SC23030324C7	Normal	0.4
592-602816	11/17/2023 8:17:05 AM	Readings	PID	SC23030324C7	Normal	0.3
592-602816	11/17/2023 8:16:05 AM	Readings	PID	SC23030324C7	Normal	0.2
592-602816	11/17/2023 8:15:05 AM	Readings	PID	SC23030324C7	Normal	0.2
592-602816	11/17/2023 8:14:05 AM	Readings	PID	SC23030324C7	Normal	0.4
592-602816	11/17/2023 8:13:05 AM	Readings	PID	SC23030324C7	Normal	0.4
592-602816	11/17/2023 8:12:05 AM	Readings	PID	SC23030324C7	Normal	0.1
592-602816	11/17/2023 8:11:05 AM	CONFIG	PID	SC23030324C7		

Instrument Name	DustTrak II
Model Number	8530
Serial Number	8530113005
Firmware Version	3.1
Calibration Date	2/11/2023
Test Name	MANUAL_005
Test Start Time	7:48:10 AM
Test Start Date	11/17/2023
Test Length [D:H:M]	0:07:45
Test Interval [M:S]	1:00
Mass Average [mg/m3]	0.028
Mass Minimum [mg/m3]	0.014
Mass Maximum [mg/m3]	0.669
Mass TWA [mg/m3]	0.027
Photometric User Cal	1
Flow User Cal	0
Errors	
Number of Samples	465

Elapsed Time [s]		Mass [mg/m3]	Alarms	Errors
0	7:48:10 AM			
60	7:49:10 AM	0.051		
120	7:50:10 AM	0.074		
180	7:51:10 AM	0.085		
240	7:52:10 AM	0.022		
300	7:53:10 AM	0.02		
360	7:54:10 AM	0.032		
420	7:55:10 AM	0.032		
480	7:56:10 AM	0.033		
540	7:57:10 AM	0.035		
600	7:58:10 AM	0.035		
660	7:59:10 AM	0.037		
720	8:00:10 AM	0.041		
780	8:01:10 AM	0.039		
840	8:02:10 AM	0.035		
900	8:03:10 AM	0.037		
960	8:04:10 AM	0.039		
1020	8:05:10 AM	0.045		
1080	8:06:10 AM	0.039		
1140	8:07:10 AM	0.041		
1200	8:08:10 AM	0.042		
1260	8:09:10 AM	0.04		
1320	8:10:10 AM	0.039		
1380	8:11:10 AM	0.037		
1440	8:12:10 AM	0.038		
1500	8:13:10 AM	0.039		
1560	8:14:10 AM	0.037		

1620	8:15:10 AM	0.033
1680	8:16:10 AM	0.035
1740	8:17:10 AM	0.037
1800	8:18:10 AM	0.035
1860	8:19:10 AM	0.033
1920	8:20:10 AM	0.032
1980	8:21:10 AM	0.033
2040	8:22:10 AM	0.033
2100	8:23:10 AM	0.164
2160	8:24:10 AM	0.133
2220	8:25:10 AM	0.052
2280	8:26:10 AM	0.075
2340	8:27:10 AM	0.234
2400	8:28:10 AM	0.22
2460	8:29:10 AM	0.475
2520	8:30:10 AM	0.669
2580	8:31:10 AM	0.145
2640	8:32:10 AM	0.11
2700	8:33:10 AM	0.032
2760	8:34:10 AM	0.043
2820	8:35:10 AM	0.036
2880	8:36:10 AM	0.031
2940	8:37:10 AM	0.029
3000	8:38:10 AM	0.03
3060	8:39:10 AM	0.029
3120	8:40:10 AM	0.031
3180	8:41:10 AM	0.042
3240	8:42:10 AM	0.034
3300	8:43:10 AM	0.034
3360	8:44:10 AM	0.035
3420	8:45:10 AM	0.034
3480	8:46:10 AM	0.031
3540	8:47:10 AM	0.033
3600	8:48:10 AM	0.04
3660	8:49:10 AM	0.039
3720	8:50:10 AM	0.034
3780	8:51:10 AM	0.034
3840	8:52:10 AM	0.036
3900	8:53:10 AM	0.034
3960	8:54:10 AM	0.035
4020	8:55:10 AM	0.04
4080	8:56:10 AM	0.042
4140	8:57:10 AM	0.042
4200	8:58:10 AM	0.043
4260	8:59:10 AM	0.046
4320	9:00:10 AM	0.046
4380	9:01:10 AM	0.048

4440	9:02:10 AM	0.047
4500	9:03:10 AM	0.049
4560	9:04:10 AM	0.044
4620	9:05:10 AM	0.047
4680	9:06:10 AM	0.051
4740	9:07:10 AM	0.048
4800	9:08:10 AM	0.045
4860	9:09:10 AM	0.044
4920	9:10:10 AM	0.043
4980	9:11:10 AM	0.043
5040	9:12:10 AM	0.041
5100	9:13:10 AM	0.043
5160	9:14:10 AM	0.041
5220	9:15:10 AM	0.043
5280	9:16:10 AM	0.048
5340	9:17:10 AM	0.043
5400	9:18:10 AM	0.04
5460	9:19:10 AM	0.036
5520	9:20:10 AM	0.036
5580	9:21:10 AM	0.038
5640	9:22:10 AM	0.037
5700	9:23:10 AM	0.037
5760	9:24:10 AM	0.042
5820	9:25:10 AM	0.038
5880	9:26:10 AM	0.041
5940	9:27:10 AM	0.038
6000	9:28:10 AM	0.033
6060	9:29:10 AM	0.035
6120	9:30:10 AM	0.036
6180	9:31:10 AM	0.038
6240	9:32:10 AM	0.035
6300	9:33:10 AM	0.035
6360	9:34:10 AM	0.029
6420	9:35:10 AM	0.029
6480	9:36:10 AM	0.028
6540	9:37:10 AM	0.031
6600	9:38:10 AM	0.032
6660	9:39:10 AM	0.03
6720	9:40:10 AM	0.034
6780	9:41:10 AM	0.032
6840	9:42:10 AM	0.03
6900	9:43:10 AM	0.028
6960	9:44:10 AM	0.029
7020	9:45:10 AM	0.029
7080	9:46:10 AM	0.028
7140	9:47:10 AM	0.029
7200	9:48:10 AM	0.027

7260	9:49:10 AM	0.029
7320	9:50:10 AM	0.026
7380	9:51:10 AM	0.026
7440	9:52:10 AM	0.026
7500	9:53:10 AM	0.026
7560	9:54:10 AM	0.026
7620	9:55:10 AM	0.027
7680	9:56:10 AM	0.027
7740	9:57:10 AM	0.027
7800	9:58:10 AM	0.026
7860	9:59:10 AM	0.023
7920	10:00:10 AM	0.025
7980	10:01:10 AM	0.025
8040	10:02:10 AM	0.027
8100	10:03:10 AM	0.025
8160	10:04:10 AM	0.024
8220	10:05:10 AM	0.023
8280	10:06:10 AM	0.027
8340	10:07:10 AM	0.024
8400	10:08:10 AM	0.023
8460	10:09:10 AM	0.026
8520	10:10:10 AM	0.023
8580	10:11:10 AM	0.023
8640	10:12:10 AM	0.022
8700	10:13:10 AM	0.023
8760	10:14:10 AM	0.023
8820	10:15:10 AM	0.023
8880	10:16:10 AM	0.021
8940	10:17:10 AM	0.021
9000	10:18:10 AM	0.02
9060	10:19:10 AM	0.02
9120	10:20:10 AM	0.022
9180	10:21:10 AM	0.021
9240	10:22:10 AM	0.021
9300	10:23:10 AM	0.019
9360	10:24:10 AM	0.019
9420	10:25:10 AM	0.036
9480	10:26:10 AM	0.025
9540	10:27:10 AM	0.027
9600	10:28:10 AM	0.026
9660	10:29:10 AM	0.025
9720	10:30:10 AM	0.023
9780	10:31:10 AM	0.021
9840	10:32:10 AM	0.019
9900	10:33:10 AM	0.019
9960	10:34:10 AM	0.023
10020	10:35:10 AM	0.02

10080	10:36:10 AM	0.019
10140	10:37:10 AM	0.019
10200	10:38:10 AM	0.021
10260	10:39:10 AM	0.019
10320	10:40:10 AM	0.018
10380	10:41:10 AM	0.017
10440	10:42:10 AM	0.019
10500	10:43:10 AM	0.02
10560	10:44:10 AM	0.019
10620	10:45:10 AM	0.019
10680	10:46:10 AM	0.019
10740	10:47:10 AM	0.019
10800	10:48:10 AM	0.02
10860	10:49:10 AM	0.019
10920	10:50:10 AM	0.019
10980	10:51:10 AM	0.018
11040	10:52:10 AM	0.02
11100	10:53:10 AM	0.018
11160	10:54:10 AM	0.018
11220	10:55:10 AM	0.017
11280	10:56:10 AM	0.018
11340	10:57:10 AM	0.018
11400	10:58:10 AM	0.019
11460	10:59:10 AM	0.02
11520	11:00:10 AM	0.02
11580	11:01:10 AM	0.021
11640	11:02:10 AM	0.018
11700	11:03:10 AM	0.02
11760	11:04:10 AM	0.018
11820	11:05:10 AM	0.017
11880	11:06:10 AM	0.019
11940	11:07:10 AM	0.017
12000	11:08:10 AM	0.017
12060	11:09:10 AM	0.017
12120	11:10:10 AM	0.016
12180	11:11:10 AM	0.016
12240	11:12:10 AM	0.017
12300	11:13:10 AM	0.016
12360	11:14:10 AM	0.015
12420	11:15:10 AM	0.015
12480	11:16:10 AM	0.017
12540	11:17:10 AM	0.018
12600	11:18:10 AM	0.015
12660	11:19:10 AM	0.015
12720	11:20:10 AM	0.016
12780	11:21:10 AM	0.02
12840	11:22:10 AM	0.02

12900	11:23:10 AM	0.017
12960	11:24:10 AM	0.017
13020	11:25:10 AM	0.017
13080	11:26:10 AM	0.016
13140	11:27:10 AM	0.016
13200	11:28:10 AM	0.015
13260	11:29:10 AM	0.017
13320	11:30:10 AM	0.017
13380	11:31:10 AM	0.016
13440	11:32:10 AM	0.016
13500	11:33:10 AM	0.016
13560	11:34:10 AM	0.015
13620	11:35:10 AM	0.016
13680	11:36:10 AM	0.019
13740	11:37:10 AM	0.017
13800	11:38:10 AM	0.015
13860	11:39:10 AM	0.016
13920	11:40:10 AM	0.016
13980	11:41:10 AM	0.015
14040	11:42:10 AM	0.015
14100	11:43:10 AM	0.015
14160	11:44:10 AM	0.014
14220	11:45:10 AM	0.014
14280	11:46:10 AM	0.015
14340	11:47:10 AM	0.015
14400	11:48:10 AM	0.017
14460	11:49:10 AM	0.015
14520	11:50:10 AM	0.018
14580	11:51:10 AM	0.014
14640	11:52:10 AM	0.014
14700	11:53:10 AM	0.016
14760	11:54:10 AM	0.016
14820	11:55:10 AM	0.014
14880	11:56:10 AM	0.014
14940	11:57:10 AM	0.014
15000	11:58:10 AM	0.014
15060	11:59:10 AM	0.017
15120	12:00:10 PM	0.016
15180	12:01:10 PM	0.015
15240	12:02:10 PM	0.016
15300	12:03:10 PM	0.017
15360	12:04:10 PM	0.017
15420	12:05:10 PM	0.018
15480	12:06:10 PM	0.015
15540	12:07:10 PM	0.016
15600	12:08:10 PM	0.017
15660	12:09:10 PM	0.017

15720	12:10:10 PM	0.018
15780	12:11:10 PM	0.019
15840	12:12:10 PM	0.017
15900	12:13:10 PM	0.017
15960	12:14:10 PM	0.016
16020	12:15:10 PM	0.015
16080	12:16:10 PM	0.015
16140	12:17:10 PM	0.015
16200	12:18:10 PM	0.016
16260	12:19:10 PM	0.018
16320	12:20:10 PM	0.016
16380	12:21:10 PM	0.014
16440	12:22:10 PM	0.018
16500	12:23:10 PM	0.019
16560	12:24:10 PM	0.018
16620	12:25:10 PM	0.015
16680	12:26:10 PM	0.015
16740	12:27:10 PM	0.016
16800	12:28:10 PM	0.015
16860	12:29:10 PM	0.015
16920	12:30:10 PM	0.015
16980	12:31:10 PM	0.017
17040	12:32:10 PM	0.016
17100	12:33:10 PM	0.015
17160	12:34:10 PM	0.016
17220	12:35:10 PM	0.015
17280	12:36:10 PM	0.014
17340	12:37:10 PM	0.015
17400	12:38:10 PM	0.015
17460	12:39:10 PM	0.015
17520	12:40:10 PM	0.015
17580	12:41:10 PM	0.014
17640	12:42:10 PM	0.02
17700	12:43:10 PM	0.019
17760	12:44:10 PM	0.017
17820	12:45:10 PM	0.014
17880	12:46:10 PM	0.014
17940	12:47:10 PM	0.015
18000	12:48:10 PM	0.017
18060	12:49:10 PM	0.019
18120	12:50:10 PM	0.023
18180	12:51:10 PM	0.019
18240	12:52:10 PM	0.017
18300	12:53:10 PM	0.015
18360	12:54:10 PM	0.016
18420	12:55:10 PM	0.017
18480	12:56:10 PM	0.016

18540	12:57:10 PM	0.018
18600	12:58:10 PM	0.016
18660	12:59:10 PM	0.015
18720	1:00:10 PM	0.017
18780	1:01:10 PM	0.017
18840	1:02:10 PM	0.019
18900	1:03:10 PM	0.016
18960	1:04:10 PM	0.018
19020	1:05:10 PM	0.018
19080	1:06:10 PM	0.025
19140	1:07:10 PM	0.022
19200	1:08:10 PM	0.016
19260	1:09:10 PM	0.015
19320	1:10:10 PM	0.015
19380	1:11:10 PM	0.019
19440	1:12:10 PM	0.018
19500	1:13:10 PM	0.019
19560	1:14:10 PM	0.017
19620	1:15:10 PM	0.016
19680	1:16:10 PM	0.017
19740	1:17:10 PM	0.016
19800	1:18:10 PM	0.017
19860	1:19:10 PM	0.018
19920	1:20:10 PM	0.02
19980	1:21:10 PM	0.019
20040	1:22:10 PM	0.02
20100	1:23:10 PM	0.021
20160	1:24:10 PM	0.02
20220	1:25:10 PM	0.019
20280	1:26:10 PM	0.017
20340	1:27:10 PM	0.019
20400	1:28:10 PM	0.019
20460	1:29:10 PM	0.018
20520	1:30:10 PM	0.099
20580	1:31:10 PM	0.018
20640	1:32:10 PM	0.017
20700	1:33:10 PM	0.018
20760	1:34:10 PM	0.017
20820	1:35:10 PM	0.016
20880	1:36:10 PM	0.016
20940	1:37:10 PM	0.015
21000	1:38:10 PM	0.017
21060	1:39:10 PM	0.021
21120	1:40:10 PM	0.019
21180	1:41:10 PM	0.02
21240	1:42:10 PM	0.019
21300	1:43:10 PM	0.02

21360	1:44:10 PM	0.021
21420	1:45:10 PM	0.019
21480	1:46:10 PM	0.019
21540	1:47:10 PM	0.022
21600	1:48:10 PM	0.019
21660	1:49:10 PM	0.019
21720	1:50:10 PM	0.02
21780	1:51:10 PM	0.018
21840	1:52:10 PM	0.019
21900	1:53:10 PM	0.018
21960	1:54:10 PM	0.019
22020	1:55:10 PM	0.018
22080	1:56:10 PM	0.02
22140	1:57:10 PM	0.015
22200	1:58:10 PM	0.016
22260	1:59:10 PM	0.016
22320	2:00:10 PM	0.015
22380	2:01:10 PM	0.017
22440	2:02:10 PM	0.016
22500	2:03:10 PM	0.017
22560	2:04:10 PM	0.016
22620	2:05:10 PM	0.016
22680	2:06:10 PM	0.016
22740	2:07:10 PM	0.016
22800	2:08:10 PM	0.017
22860	2:09:10 PM	0.018
22920	2:10:10 PM	0.017
22980	2:11:10 PM	0.017
23040	2:12:10 PM	0.017
23100	2:13:10 PM	0.018
23160	2:14:10 PM	0.018
23220	2:15:10 PM	0.016
23280	2:16:10 PM	0.016
23340	2:17:10 PM	0.023
23400	2:18:10 PM	0.018
23460	2:19:10 PM	0.017
23520	2:20:10 PM	0.019
23580	2:21:10 PM	0.019
23640	2:22:10 PM	0.016
23700	2:23:10 PM	0.015
23760	2:24:10 PM	0.015
23820	2:25:10 PM	0.016
23880	2:26:10 PM	0.016
23940	2:27:10 PM	0.018
24000	2:28:10 PM	0.019
24060	2:29:10 PM	0.018
24120	2:30:10 PM	0.023

24180	2:31:10 PM	0.022
24240	2:32:10 PM	0.017
24300	2:33:10 PM	0.019
24360	2:34:10 PM	0.016
24420	2:35:10 PM	0.015
24480	2:36:10 PM	0.016
24540	2:37:10 PM	0.017
24600	2:38:10 PM	0.016
24660	2:39:10 PM	0.017
24720	2:40:10 PM	0.016
24780	2:41:10 PM	0.017
24840	2:42:10 PM	0.018
24900	2:43:10 PM	0.019
24960	2:44:10 PM	0.017
25020	2:45:10 PM	0.021
25080	2:46:10 PM	0.021
25140	2:47:10 PM	0.02
25200	2:48:10 PM	0.019
25260	2:49:10 PM	0.017
25320	2:50:10 PM	0.018
25380	2:51:10 PM	0.019
25440	2:52:10 PM	0.017
25500	2:53:10 PM	0.019
25560	2:54:10 PM	0.018
25620	2:55:10 PM	0.018
25680	2:56:10 PM	0.018
25740	2:57:10 PM	0.019
25800	2:58:10 PM	0.016
25860	2:59:10 PM	0.015
25920	3:00:10 PM	0.017
25980	3:01:10 PM	0.017
26040	3:02:10 PM	0.017
26100	3:03:10 PM	0.019
26160	3:04:10 PM	0.018
26220	3:05:10 PM	0.017
26280	3:06:10 PM	0.015
26340	3:07:10 PM	0.015
26400	3:08:10 PM	0.016
26460	3:09:10 PM	0.016
26520	3:10:10 PM	0.017
26580	3:11:10 PM	0.018
26640	3:12:10 PM	0.018
26700	3:13:10 PM	0.019
26760	3:14:10 PM	0.016
26820	3:15:10 PM	0.017
26880	3:16:10 PM	0.018
26940	3:17:10 PM	0.017

27000	3:18:10 PM	0.017
27060	3:19:10 PM	0.022
27120	3:20:10 PM	0.02
27180	3:21:10 PM	0.026
27240	3:22:10 PM	0.023
27300	3:23:10 PM	0.018
27360	3:24:10 PM	0.017
27420	3:25:10 PM	0.02
27480	3:26:10 PM	0.02
27540	3:27:10 PM	0.021
27600	3:28:10 PM	0.021
27660	3:29:10 PM	0.02
27720	3:30:10 PM	0.019
27780	3:31:10 PM	0.02
27840	3:32:10 PM	0.021
27900	3:33:10 PM	0.029

Device Serial No	Log Time	Log Type	Sensor 1 Type	Sensor 1 Serial Number	Sensor 1 Status	Sensor 1 Gas Reading
592-600871	11/17/2023 15:56	Readings	PID	SC23030408A8	Normal	0
592-600871	11/17/2023 15:55	Readings	PID	SC23030408A8	Normal	0
592-600871	11/17/2023 15:54	Readings	PID	SC23030408A8	Normal	0
592-600871	11/17/2023 15:53	Readings	PID	SC23030408A8	Normal	0
592-600871	11/17/2023 15:52	Readings	PID	SC23030408A8	Normal	0
592-600871	11/17/2023 15:51	Readings	PID	SC23030408A8	Normal	0
592-600871	11/17/2023 15:50	Readings	PID	SC23030408A8	Normal	0
592-600871	11/17/2023 15:49	Readings	PID	SC23030408A8	Normal	0
592-600871	11/17/2023 15:48	Readings	PID	SC23030408A8	Normal	0
592-600871	11/17/2023 15:47	Readings	PID	SC23030408A8	Normal	0
592-600871	11/17/2023 15:46	Readings	PID	SC23030408A8	Normal	0
592-600871	11/17/2023 15:45	Readings	PID	SC23030408A8	Normal	0
592-600871	11/17/2023 15:44	Readings	PID	SC23030408A8	Normal	0
592-600871	11/17/2023 15:43	Readings	PID	SC23030408A8	Normal	0
592-600871	11/17/2023 15:42	Readings	PID	SC23030408A8	Normal	0
592-600871	11/17/2023 15:41	Readings	PID	SC23030408A8	Normal	0
592-600871	11/17/2023 15:40	Readings	PID	SC23030408A8	Normal	0
592-600871	11/17/2023 15:39	Readings	PID	SC23030408A8	Normal	0
592-600871	11/17/2023 15:38	Readings	PID	SC23030408A8	Normal	0
592-600871	11/17/2023 15:37	Readings	PID	SC23030408A8	Normal	0
592-600871	11/17/2023 15:36	Readings	PID	SC23030408A8	Normal	0
592-600871	11/17/2023 15:35	Readings	PID	SC23030408A8	Normal	0
592-600871	11/17/2023 15:34	Readings	PID	SC23030408A8	Normal	0
592-600871	11/17/2023 15:33	Readings	PID	SC23030408A8	Normal	0
592-600871	11/17/2023 15:32	Readings	PID	SC23030408A8	Normal	0
592-600871	11/17/2023 15:31	Readings	PID	SC23030408A8	Normal	0
592-600871	11/17/2023 15:30	Readings	PID	SC23030408A8	Normal	0
592-600871	11/17/2023 15:29	Readings	PID	SC23030408A8	Normal	0
592-600871	11/17/2023 15:28	Readings	PID	SC23030408A8	Normal	0
592-600871	11/17/2023 15:27	Readings	PID	SC23030408A8	Normal	0
592-600871	11/17/2023 15:26	Readings	PID	SC23030408A8	Normal	0
592-600871	11/17/2023 15:25	Readings	PID	SC23030408A8	Normal	0
592-600871	11/17/2023 15:24	Readings	PID	SC23030408A8	Normal	0
592-600871	11/17/2023 15:23	Readings	PID	SC23030408A8	Normal	0

592-600871	11/17/2023 8:22	Readings	PID	SC23030408A8	Normal	0
592-600871	11/17/2023 8:21	Readings	PID	SC23030408A8	Normal	0
592-600871	11/17/2023 8:20	Readings	PID	SC23030408A8	Normal	0
592-600871	11/17/2023 8:19	Readings	PID	SC23030408A8	Normal	0
592-600871	11/17/2023 8:18	Readings	PID	SC23030408A8	Normal	0
592-600871	11/17/2023 8:17	Readings	PID	SC23030408A8	Normal	0
592-600871	11/17/2023 8:16	Readings	PID	SC23030408A8	Normal	0
592-600871	11/17/2023 8:15	Readings	PID	SC23030408A8	Normal	0
592-600871	11/17/2023 8:14	Readings	PID	SC23030408A8	Normal	0
592-600871	11/17/2023 8:13	Readings	PID	SC23030408A8	Normal	0
592-600871	11/17/2023 8:12	Readings	PID	SC23030408A8	Normal	0
592-600871	11/17/2023 8:11	Readings	PID	SC23030408A8	Normal	0
592-600871	11/17/2023 8:10	Readings	PID	SC23030408A8	Normal	0
592-600871	11/17/2023 8:09	Readings	PID	SC23030408A8	Normal	0
592-600871	11/17/2023 8:08	Readings	PID	SC23030408A8	Normal	0
592-600871	11/17/2023 8:07	Readings	PID	SC23030408A8	Normal	0
592-600871	11/17/2023 8:06	Readings	PID	SC23030408A8	Normal	0
592-600871	11/17/2023 8:05	Readings	PID	SC23030408A8	Normal	0
592-600871	11/17/2023 8:04	CONFIG	PID	SC23030408A8		