



DAILY STATUS REPORT

Prepared By:
Bill Chaky

WEATHER	Snow	Rain	Overcast	Partly Cloudy	Bright Sun	X	Wind	
TEMP.	< 32	32-50	50-70	X	70-85	X	>85	WNW – 4 mph

IEEG Project No:	13928	NYSDEC BCP Site No:	C224367	Date: 08/23/24
Project:	251 Douglass Street, Brooklyn, NY			

<p>Consultant: Impact Environmental Engineering and Geology, PLLC (IEEG)</p> <p>Time On: 06:35 Time Out: 20:45</p>	<p>Personnel On Site: IEEG (Environmental) – Bill Chaky Broadway Construction Group – Shannon Dowling / Tom Caporale WSP – Charlie Lambert Cascade – John Vollmer Concrete Courses</p> <p>Equipment On Site: (3) MiniRAE 3000 PID, (3) DustTrak II</p>
---	--

Scope of Work: IEEG to deploy CAMP stations according to wind direction; Cascade to load out swell material onto dump-trucks for offsite disposal at Conestoga; Cascade to continue over-drill of pilot columns at southeast corner of site with 6’ auger; and Concrete Courses to pour concrete and remove lumber forms in the Butler corridor.

- Site Activities:**
- IEEG deployed three (3) CAMP stations prior to the start of work activities;
 - Concrete Courses poured concrete and removed lumber forms in the Butler Corridor;
 - Cascade loaded nine (9) trucks with swell material for offsite disposal to the Conestoga facility;
 - Cascade graded the Site and consolidated the swell material stockpile;
 - IEEG applied ISS spray-foam to swell stockpile at the end of work activities;
 - Cascade over-drilled the following ISS pilot Columns with 6’ auger to break the column apart:
 - **Column 25**, which was drilled 53’ deep;
 - **Column 102**, which was drilled 38’ deep;
 - **Column 166**, which was drilled 38’ deep;
- *It should be noted that the over-drilled pilot columns will be re-installed with the 8’ auger. Cascade will use the same mix ratios and follow all the same ISS Column requirements.

Community Air Monitoring Program (CAMP) - CAMP action level for dust (0.1 mg/m³) and VOCs (5 ppm)

- PID remained at nominal levels throughout the day
- No sustained dust exceedances were observed over a 15-min period during monitoring.
- Startup Upwind Conditions – PID = _0.0_ ppm, Dust = _0.141_ mg/m³ @ 07:11
- High Conditions (Upwind) – PID = _0.0_ ppm, Dust = _0.263_ mg/m³ @ 14:27
- High Conditions (Downwind 1) – PID = _0.0_ ppm, Dust = _0.570_ mg/m³ @ 16:38
- High Conditions (Downwind 2) – PID = _5.7_ ppm, Dust = _0.163_ mg/m³ @ 13:07

Notable Site Conditions:

- None.

Planned for the Next Day/Week:

- Cascade to perform maintenance on ISS equipment.



PHOTO LOG

251 DOUGLASS STREET, BROOKLYN, NY



Photo 1-
Representative
photo of ISS pilot
column over-drill
with 6' auger.



Photo 2-
Representative
photo of
completed over-
drilled columns
23 and 25.



Photo 3-
Representative
photo of
remaining
consolidated
swell material
stockpile applied
with ISS spray-
foam.



SITE PLANS

251 DOUGLASS STREET, BROOKLYN, NY



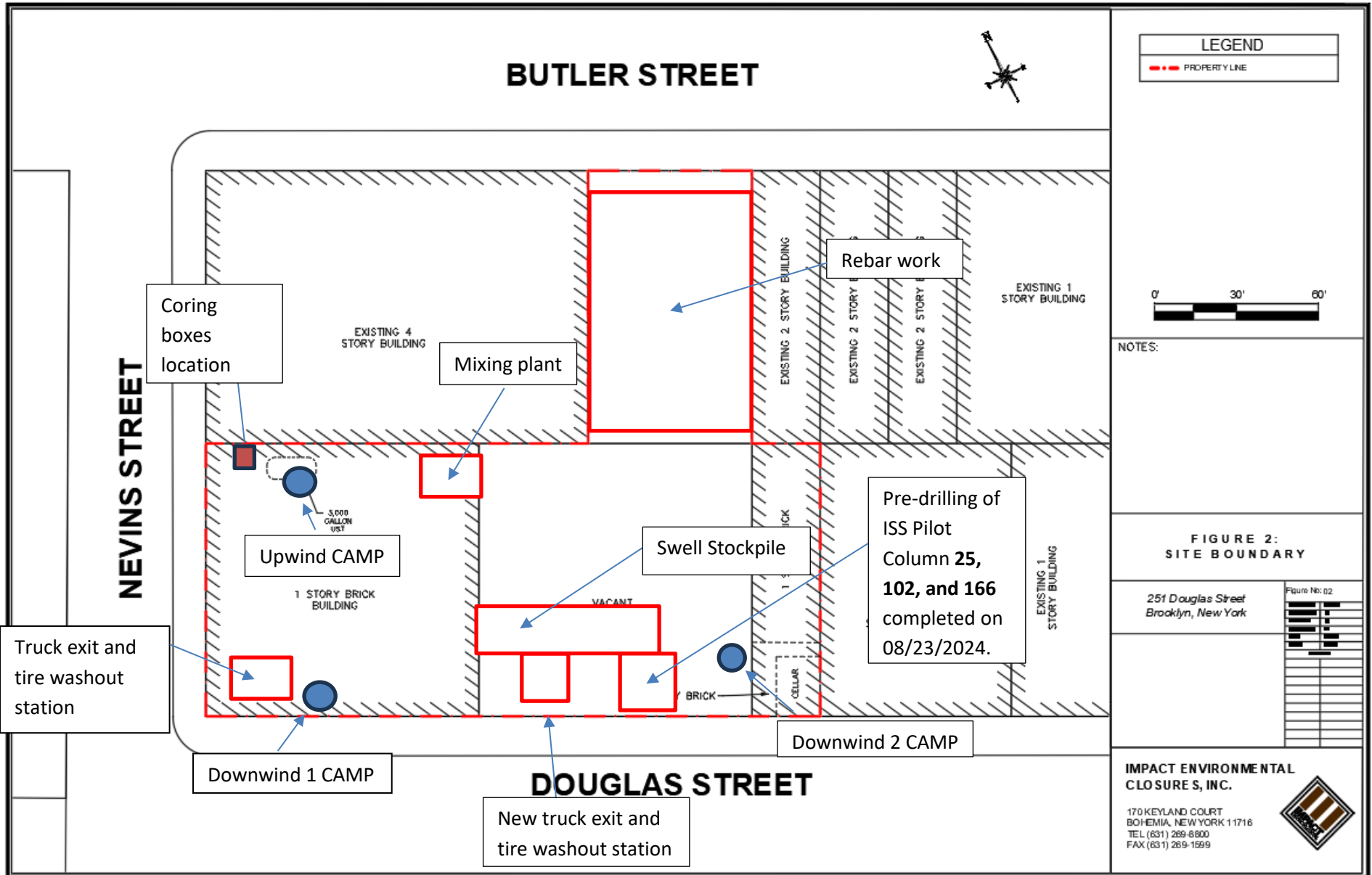



UPWIND CAMP READINGS

251 DOUGLASS STREET, BROOKLYN, NY

Instrument Name	DustTrak II
Model Number	8530
Serial Number	8530224603
Firmware Version	3.1
Calibration Date	4/3/2024
Test Name	MANUAL_006
Test Start Time	7:11:38 AM
Test Start Date	8/23/2024
Test Length [D:H:M]	0:12:35
Test Interval [M:S]	1:00
Mass Average [mg/m3]	0.025
Mass Minimum [mg/m3]	0.018
Mass Maximum [mg/m3]	0.263
Mass TWA [mg/m3]	0.025
Photometric User Cal	1
Flow User Cal	0
Errors	
Number of Samples	755

Elapsed Time [s]	Mass [mg/m3]	Alarms	Errors
60	0.141		
120	0.021		
180	0.021		
240	0.02		
300	0.019		
360	0.022		
420	0.018		
480	0.019		
540	0.019		
600	0.02		
660	0.019		
720	0.018		
780	0.019		
840	0.018		
900	0.021		
960	0.019		
1020	0.018		
1080	0.019		
1140	0.021		
1200	0.021		
1260	0.021		
1320	0.022		
1380	0.026		
1440	0.021		

1500	0.023
1560	0.023
1620	0.023
1680	0.022
1740	0.022
1800	0.023
1860	0.021
1920	0.02
1980	0.02
2040	0.021
2100	0.025
2160	0.022
2220	0.021
2280	0.021
2340	0.031
2400	0.09
2460	0.022
2520	0.022
2580	0.02
2640	0.02
2700	0.021
2760	0.02
2820	0.02
2880	0.02
2940	0.022
3000	0.02
3060	0.02
3120	0.02
3180	0.02
3240	0.022
3300	0.022
3360	0.022
3420	0.022
3480	0.025
3540	0.024
3600	0.048
3660	0.024
3720	0.025
3780	0.024
3840	0.025
3900	0.024
3960	0.024
4020	0.023
4080	0.021

4140	0.026
4200	0.026
4260	0.025
4320	0.028
4380	0.026
4440	0.026
4500	0.028
4560	0.026
4620	0.026
4680	0.031
4740	0.026
4800	0.024
4860	0.025
4920	0.025
4980	0.026
5040	0.026
5100	0.026
5160	0.028
5220	0.026
5280	0.026
5340	0.026
5400	0.027
5460	0.026
5520	0.027
5580	0.026
5640	0.025
5700	0.026
5760	0.025
5820	0.024
5880	0.025
5940	0.024
6000	0.024
6060	0.025
6120	0.025
6180	0.025
6240	0.023
6300	0.024
6360	0.025
6420	0.023
6480	0.023
6540	0.022
6600	0.025
6660	0.022
6720	0.023

6780	0.025
6840	0.025
6900	0.026
6960	0.023
7020	0.032
7080	0.029
7140	0.026
7200	0.025
7260	0.027
7320	0.036
7380	0.035
7440	0.025
7500	0.024
7560	0.024
7620	0.023
7680	0.024
7740	0.023
7800	0.024
7860	0.025
7920	0.024
7980	0.024
8040	0.025
8100	0.023
8160	0.024
8220	0.023
8280	0.025
8340	0.028
8400	0.031
8460	0.026
8520	0.026
8580	0.032
8640	0.041
8700	0.027
8760	0.026
8820	0.026
8880	0.027
8940	0.027
9000	0.031
9060	0.029
9120	0.031
9180	0.031
9240	0.026
9300	0.029
9360	0.033

9420	0.026
9480	0.025
9540	0.024
9600	0.027
9660	0.024
9720	0.024
9780	0.027
9840	0.025
9900	0.025
9960	0.025
10020	0.028
10080	0.03
10140	0.029
10200	0.026
10260	0.025
10320	0.027
10380	0.028
10440	0.026
10500	0.026
10560	0.027
10620	0.023
10680	0.023
10740	0.024
10800	0.024
10860	0.024
10920	0.024
10980	0.022
11040	0.023
11100	0.034
11160	0.022
11220	0.024
11280	0.023
11340	0.023
11400	0.023
11460	0.023
11520	0.024
11580	0.021
11640	0.022
11700	0.021
11760	0.02
11820	0.021
11880	0.021
11940	0.022
12000	0.026

12060	0.025
12120	0.043
12180	0.02
12240	0.023
12300	0.026
12360	0.021
12420	0.023
12480	0.021
12540	0.02
12600	0.021
12660	0.021
12720	0.021
12780	0.022
12840	0.025
12900	0.021
12960	0.043
13020	0.02
13080	0.02
13140	0.019
13200	0.025
13260	0.021
13320	0.02
13380	0.026
13440	0.022
13500	0.022
13560	0.028
13620	0.021
13680	0.02
13740	0.024
13800	0.02
13860	0.021
13920	0.023
13980	0.019
14040	0.019
14100	0.02
14160	0.021
14220	0.02
14280	0.02
14340	0.02
14400	0.02
14460	0.019
14520	0.022
14580	0.026
14640	0.027

14700	0.027
14760	0.028
14820	0.023
14880	0.02
14940	0.02
15000	0.019
15060	0.024
15120	0.022
15180	0.027
15240	0.024
15300	0.027
15360	0.026
15420	0.021
15480	0.019
15540	0.02
15600	0.021
15660	0.023
15720	0.044
15780	0.024
15840	0.022
15900	0.025
15960	0.023
16020	0.024
16080	0.022
16140	0.021
16200	0.019
16260	0.019
16320	0.022
16380	0.023
16440	0.02
16500	0.02
16560	0.019
16620	0.02
16680	0.019
16740	0.019
16800	0.018
16860	0.02
16920	0.032
16980	0.041
17040	0.033
17100	0.05
17160	0.035
17220	0.03
17280	0.021

17340	0.02
17400	0.019
17460	0.02
17520	0.02
17580	0.018
17640	0.02
17700	0.019
17760	0.018
17820	0.02
17880	0.022
17940	0.02
18000	0.02
18060	0.019
18120	0.02
18180	0.019
18240	0.019
18300	0.019
18360	0.02
18420	0.024
18480	0.023
18540	0.027
18600	0.023
18660	0.02
18720	0.023
18780	0.022
18840	0.022
18900	0.021
18960	0.021
19020	0.029
19080	0.041
19140	0.021
19200	0.02
19260	0.021
19320	0.021
19380	0.021
19440	0.022
19500	0.021
19560	0.022
19620	0.026
19680	0.022
19740	0.023
19800	0.025
19860	0.023
19920	0.026

19980	0.026
20040	0.028
20100	0.026
20160	0.023
20220	0.022
20280	0.024
20340	0.023
20400	0.025
20460	0.023
20520	0.022
20580	0.023
20640	0.026
20700	0.027
20760	0.028
20820	0.025
20880	0.021
20940	0.027
21000	0.027
21060	0.021
21120	0.029
21180	0.025
21240	0.027
21300	0.023
21360	0.027
21420	0.039
21480	0.02
21540	0.024
21600	0.025
21660	0.023
21720	0.033
21780	0.026
21840	0.028
21900	0.033
21960	0.027
22020	0.047
22080	0.023
22140	0.024
22200	0.024
22260	0.025
22320	0.028
22380	0.027
22440	0.03
22500	0.022
22560	0.033

22620	0.025
22680	0.022
22740	0.021
22800	0.031
22860	0.022
22920	0.021
22980	0.022
23040	0.02
23100	0.02
23160	0.019
23220	0.02
23280	0.019
23340	0.02
23400	0.021
23460	0.024
23520	0.022
23580	0.027
23640	0.021
23700	0.02
23760	0.022
23820	0.03
23880	0.031
23940	0.044
24000	0.042
24060	0.026
24120	0.021
24180	0.021
24240	0.022
24300	0.02
24360	0.034
24420	0.027
24480	0.021
24540	0.022
24600	0.025
24660	0.021
24720	0.021
24780	0.022
24840	0.021
24900	0.022
24960	0.036
25020	0.02
25080	0.021
25140	0.022
25200	0.025

25260	0.034
25320	0.023
25380	0.022
25440	0.023
25500	0.024
25560	0.023
25620	0.024
25680	0.024
25740	0.022
25800	0.263
25860	0.049
25920	0.023
25980	0.022
26040	0.022
26100	0.023
26160	0.023
26220	0.022
26280	0.028
26340	0.026
26400	0.021
26460	0.022
26520	0.02
26580	0.027
26640	0.029
26700	0.02
26760	0.02
26820	0.021
26880	0.02
26940	0.02
27000	0.02
27060	0.02
27120	0.021
27180	0.026
27240	0.027
27300	0.023
27360	0.022
27420	0.022
27480	0.023
27540	0.025
27600	0.023
27660	0.024
27720	0.025
27780	0.027
27840	0.024

27900	0.024
27960	0.024
28020	0.022
28080	0.023
28140	0.025
28200	0.025
28260	0.026
28320	0.024
28380	0.024
28440	0.025
28500	0.027
28560	0.028
28620	0.025
28680	0.025
28740	0.023
28800	0.023
28860	0.022
28920	0.022
28980	0.022
29040	0.022
29100	0.022
29160	0.022
29220	0.023
29280	0.023
29340	0.023
29400	0.025
29460	0.024
29520	0.023
29580	0.024
29640	0.023
29700	0.023
29760	0.023
29820	0.023
29880	0.023
29940	0.023
30000	0.023
30060	0.022
30120	0.022
30180	0.022
30240	0.022
30300	0.023
30360	0.023
30420	0.023
30480	0.023

30540	0.023
30600	0.026
30660	0.028
30720	0.029
30780	0.022
30840	0.023
30900	0.031
30960	0.027
31020	0.023
31080	0.022
31140	0.022
31200	0.022
31260	0.023
31320	0.022
31380	0.022
31440	0.023
31500	0.022
31560	0.022
31620	0.022
31680	0.022
31740	0.022
31800	0.023
31860	0.022
31920	0.023
31980	0.022
32040	0.021
32100	0.022
32160	0.022
32220	0.023
32280	0.023
32340	0.023
32400	0.073
32460	0.024
32520	0.023
32580	0.025
32640	0.024
32700	0.023
32760	0.024
32820	0.025
32880	0.024
32940	0.023
33000	0.024
33060	0.025
33120	0.025

33180	0.025
33240	0.024
33300	0.025
33360	0.024
33420	0.023
33480	0.023
33540	0.023
33600	0.024
33660	0.026
33720	0.024
33780	0.024
33840	0.024
33900	0.024
33960	0.024
34020	0.023
34080	0.023
34140	0.024
34200	0.023
34260	0.024
34320	0.026
34380	0.03
34440	0.025
34500	0.024
34560	0.023
34620	0.024
34680	0.024
34740	0.025
34800	0.027
34860	0.025
34920	0.025
34980	0.024
35040	0.024
35100	0.024
35160	0.024
35220	0.025
35280	0.029
35340	0.035
35400	0.027
35460	0.022
35520	0.029
35580	0.029
35640	0.024
35700	0.026
35760	0.026

35820	0.024
35880	0.025
35940	0.094
36000	0.029
36060	0.022
36120	0.026
36180	0.027
36240	0.023
36300	0.023
36360	0.022
36420	0.022
36480	0.022
36540	0.021
36600	0.023
36660	0.027
36720	0.022
36780	0.022
36840	0.027
36900	0.023
36960	0.022
37020	0.023
37080	0.025
37140	0.023
37200	0.027
37260	0.021
37320	0.021
37380	0.021
37440	0.024
37500	0.021
37560	0.023
37620	0.022
37680	0.021
37740	0.02
37800	0.021
37860	0.023
37920	0.026
37980	0.021
38040	0.023
38100	0.022
38160	0.022
38220	0.021
38280	0.022
38340	0.021
38400	0.021

38460	0.022
38520	0.022
38580	0.022
38640	0.022
38700	0.021
38760	0.023
38820	0.022
38880	0.026
38940	0.023
39000	0.023
39060	0.024
39120	0.024
39180	0.026
39240	0.022
39300	0.022
39360	0.021
39420	0.023
39480	0.04
39540	0.024
39600	0.025
39660	0.023
39720	0.022
39780	0.026
39840	0.044
39900	0.028
39960	0.027
40020	0.028
40080	0.025
40140	0.028
40200	0.024
40260	0.027
40320	0.023
40380	0.022
40440	0.022
40500	0.024
40560	0.022
40620	0.026
40680	0.023
40740	0.029
40800	0.113
40860	0.027
40920	0.029
40980	0.025
41040	0.025

41100	0.024
41160	0.027
41220	0.025
41280	0.026
41340	0.026
41400	0.026
41460	0.027
41520	0.036
41580	0.023
41640	0.025
41700	0.03
41760	0.028
41820	0.026
41880	0.047
41940	0.025
42000	0.021
42060	0.071
42120	0.033
42180	0.027
42240	0.028
42300	0.022
42360	0.024
42420	0.023
42480	0.025
42540	0.025
42600	0.024
42660	0.022
42720	0.023
42780	0.023
42840	0.021
42900	0.025
42960	0.024
43020	0.025
43080	0.022
43140	0.023
43200	0.027
43260	0.026
43320	0.028
43380	0.023
43440	0.024
43500	0.023
43560	0.023
43620	0.022
43680	0.022

43740	0.032
43800	0.023
43860	0.049
43920	0.026
43980	0.021
44040	0.021
44100	0.021
44160	0.025
44220	0.03
44280	0.026
44340	0.026
44400	0.03
44460	0.029
44520	0.024
44580	0.023
44640	0.023
44700	0.024
44760	0.022
44820	0.023
44880	0.024
44940	0.022
45000	0.022
45060	0.022
45120	0.022
45180	0.022
45240	0.022
45300	0.024

Device Serial No	Log Time	Log Type	Sensor 1 Type	Sensor 1 Serial Number	Sensor 1 Status	Sensor 1 Gas Reading
592-906020	8/23/2024 20:44	Readings	PID	SC23030396CB	Normal	0
592-906020	8/23/2024 20:43	Readings	PID	SC23030396CB	Normal	0
592-906020	8/23/2024 20:42	Readings	PID	SC23030396CB	Normal	0
592-906020	8/23/2024 20:41	Readings	PID	SC23030396CB	Normal	0
592-906020	8/23/2024 20:40	Readings	PID	SC23030396CB	Normal	0
592-906020	8/23/2024 20:39	Readings	PID	SC23030396CB	Normal	0
592-906020	8/23/2024 20:38	Readings	PID	SC23030396CB	Normal	0
592-906020	8/23/2024 20:37	Readings	PID	SC23030396CB	Normal	0
592-906020	8/23/2024 20:36	Readings	PID	SC23030396CB	Normal	0
592-906020	8/23/2024 20:35	Readings	PID	SC23030396CB	Normal	0
592-906020	8/23/2024 20:34	Readings	PID	SC23030396CB	Normal	0
592-906020	8/23/2024 20:33	Readings	PID	SC23030396CB	Normal	0
592-906020	8/23/2024 20:32	Readings	PID	SC23030396CB	Normal	0
592-906020	8/23/2024 20:31	Readings	PID	SC23030396CB	Normal	0
592-906020	8/23/2024 20:30	Readings	PID	SC23030396CB	Normal	0
592-906020	8/23/2024 20:29	Readings	PID	SC23030396CB	Normal	0
592-906020	8/23/2024 20:28	Readings	PID	SC23030396CB	Normal	0
592-906020	8/23/2024 20:27	Readings	PID	SC23030396CB	Normal	0
592-906020	8/23/2024 20:26	Readings	PID	SC23030396CB	Normal	0
592-906020	8/23/2024 20:25	Readings	PID	SC23030396CB	Normal	0
592-906020	8/23/2024 20:24	Readings	PID	SC23030396CB	Normal	0
592-906020	8/23/2024 20:23	Readings	PID	SC23030396CB	Normal	0
592-906020	8/23/2024 20:22	Readings	PID	SC23030396CB	Normal	0
592-906020	8/23/2024 20:21	Readings	PID	SC23030396CB	Normal	0
592-906020	8/23/2024 20:20	Readings	PID	SC23030396CB	Normal	0
592-906020	8/23/2024 20:19	Readings	PID	SC23030396CB	Normal	0
592-906020	8/23/2024 20:18	Readings	PID	SC23030396CB	Normal	0
592-906020	8/23/2024 20:17	Readings	PID	SC23030396CB	Normal	0
592-906020	8/23/2024 20:16	Readings	PID	SC23030396CB	Normal	0
592-906020	8/23/2024 20:15	Readings	PID	SC23030396CB	Normal	0
592-906020	8/23/2024 20:14	Readings	PID	SC23030396CB	Normal	0
592-906020	8/23/2024 20:13	Readings	PID	SC23030396CB	Normal	0

592-906020	8/23/2024 19:39	Readings	PID	SC23030396CB	Normal	0
592-906020	8/23/2024 19:38	Readings	PID	SC23030396CB	Normal	0
592-906020	8/23/2024 19:37	Readings	PID	SC23030396CB	Normal	0
592-906020	8/23/2024 19:36	Readings	PID	SC23030396CB	Normal	0
592-906020	8/23/2024 19:35	Readings	PID	SC23030396CB	Normal	0
592-906020	8/23/2024 19:34	Readings	PID	SC23030396CB	Normal	0
592-906020	8/23/2024 19:33	Readings	PID	SC23030396CB	Normal	0
592-906020	8/23/2024 19:32	Readings	PID	SC23030396CB	Normal	0
592-906020	8/23/2024 19:31	Readings	PID	SC23030396CB	Normal	0
592-906020	8/23/2024 19:30	Readings	PID	SC23030396CB	Normal	0
592-906020	8/23/2024 19:29	Readings	PID	SC23030396CB	Normal	0
592-906020	8/23/2024 19:28	CONFIG	PID	SC23030396CB		
592-906020	8/23/2024 19:26	Readings	PID	SC23030396CB	Normal	0
592-906020	8/23/2024 19:25	Readings	PID	SC23030396CB	Normal	0
592-906020	8/23/2024 19:24	Readings	PID	SC23030396CB	Normal	0
592-906020	8/23/2024 19:23	Readings	PID	SC23030396CB	Normal	0
592-906020	8/23/2024 19:22	Readings	PID	SC23030396CB	Normal	0
592-906020	8/23/2024 19:21	Readings	PID	SC23030396CB	Normal	0
592-906020	8/23/2024 19:20	Readings	PID	SC23030396CB	Normal	0
592-906020	8/23/2024 19:19	Readings	PID	SC23030396CB	Normal	0
592-906020	8/23/2024 19:18	Readings	PID	SC23030396CB	Normal	0
592-906020	8/23/2024 19:17	Readings	PID	SC23030396CB	Normal	0
592-906020	8/23/2024 19:16	Readings	PID	SC23030396CB	Normal	0
592-906020	8/23/2024 19:15	Readings	PID	SC23030396CB	Normal	0
592-906020	8/23/2024 19:14	Readings	PID	SC23030396CB	Normal	0
592-906020	8/23/2024 19:13	Readings	PID	SC23030396CB	Normal	0
592-906020	8/23/2024 19:12	Readings	PID	SC23030396CB	Normal	0
592-906020	8/23/2024 19:11	Readings	PID	SC23030396CB	Normal	0
592-906020	8/23/2024 19:10	Readings	PID	SC23030396CB	Normal	0
592-906020	8/23/2024 19:09	Readings	PID	SC23030396CB	Normal	0
592-906020	8/23/2024 19:08	Readings	PID	SC23030396CB	Normal	0
592-906020	8/23/2024 19:07	Readings	PID	SC23030396CB	Normal	0
592-906020	8/23/2024 19:06	Readings	PID	SC23030396CB	Normal	0

592-906020	8/23/2024 15:47	Readings	PID	SC23030396CB	Normal	0
592-906020	8/23/2024 15:46	Readings	PID	SC23030396CB	Normal	0
592-906020	8/23/2024 15:45	Readings	PID	SC23030396CB	Normal	0
592-906020	8/23/2024 15:44	Readings	PID	SC23030396CB	Normal	0
592-906020	8/23/2024 15:43	Readings	PID	SC23030396CB	Normal	0
592-906020	8/23/2024 15:42	Readings	PID	SC23030396CB	Normal	0
592-906020	8/23/2024 15:41	Readings	PID	SC23030396CB	Normal	0
592-906020	8/23/2024 15:40	Readings	PID	SC23030396CB	Normal	0
592-906020	8/23/2024 15:39	Readings	PID	SC23030396CB	Normal	0
592-906020	8/23/2024 15:38	Readings	PID	SC23030396CB	Normal	0
592-906020	8/23/2024 15:37	Readings	PID	SC23030396CB	Normal	0
592-906020	8/23/2024 15:36	Readings	PID	SC23030396CB	Normal	0
592-906020	8/23/2024 15:35	Readings	PID	SC23030396CB	Normal	0
592-906020	8/23/2024 15:34	Readings	PID	SC23030396CB	Normal	0
592-906020	8/23/2024 15:33	Readings	PID	SC23030396CB	Normal	0
592-906020	8/23/2024 15:32	Readings	PID	SC23030396CB	Normal	0
592-906020	8/23/2024 15:31	Readings	PID	SC23030396CB	Normal	0
592-906020	8/23/2024 15:30	Readings	PID	SC23030396CB	Normal	0
592-906020	8/23/2024 15:29	Readings	PID	SC23030396CB	Normal	0
592-906020	8/23/2024 15:28	Readings	PID	SC23030396CB	Normal	0
592-906020	8/23/2024 15:27	CONFIG	PID	SC23030396CB		

DOWNWIND CAMP READINGS

251 DOUGLASS STREET, BROOKLYN, NY



Instrument Name	DustTrak DRX
Model Number	8533
Serial Number	8533181207
Firmware Version	3.1
Calibration Date	7/11/2024
Test Name	MANUAL_006
Test Start Time	7:09:33 AM
Test Start Date	8/23/2024
Test Length [D:H:M]	0:12:42
Test Interval [M:S]	1:00
PM1 Average [mg/m3]	0.025
PM1 Minimum [mg/m3]	0.012
PM1 Maximum [mg/m3]	0.57
PM1 TWA [mg/m3]	0.028
Photometric User Cal	1
Size Correction User Cal	1
Flow User Cal	0
Errors	
Number of Samples	762

Elapsed Time [s]	PM1 [mg/m3]	Alarms	Errors
60	0.045		
120	0.013		
180	0.014		
240	0.014		
300	0.012		
360	0.018		
420	0.025		
480	0.02		
540	0.044		
600	0.041		
660	0.04		
720	0.022		
780	0.054		
840	0.018		
900	0.015		
960	0.029		
1020	0.046		
1080	0.015		
1140	0.05		
1200	0.193		
1260	0.04		
1320	0.175		
1380	0.195		

1440	0.204
1500	0.054
1560	0.02
1620	0.015
1680	0.12
1740	0.025
1800	0.109
1860	0.071
1920	0.051
1980	0.073
2040	0.022
2100	0.015
2160	0.015
2220	0.019
2280	0.017
2340	0.041
2400	0.022
2460	0.016
2520	0.048
2580	0.022
2640	0.024
2700	0.024
2760	0.024
2820	0.019
2880	0.016
2940	0.015
3000	0.015
3060	0.014
3120	0.016
3180	0.015
3240	0.014
3300	0.016
3360	0.02
3420	0.015
3480	0.016
3540	0.017
3600	0.02
3660	0.017
3720	0.016
3780	0.018
3840	0.017
3900	0.016
3960	0.017
4020	0.017

4080	0.017
4140	0.018
4200	0.018
4260	0.017
4320	0.017
4380	0.017
4440	0.018
4500	0.021
4560	0.018
4620	0.018
4680	0.018
4740	0.017
4800	0.018
4860	0.017
4920	0.017
4980	0.017
5040	0.019
5100	0.017
5160	0.018
5220	0.02
5280	0.019
5340	0.02
5400	0.017
5460	0.018
5520	0.018
5580	0.019
5640	0.019
5700	0.018
5760	0.028
5820	0.021
5880	0.019
5940	0.019
6000	0.027
6060	0.021
6120	0.019
6180	0.021
6240	0.031
6300	0.023
6360	0.02
6420	0.02
6480	0.018
6540	0.018
6600	0.02
6660	0.019

6720	0.018
6780	0.018
6840	0.017
6900	0.017
6960	0.018
7020	0.022
7080	0.019
7140	0.046
7200	0.08
7260	0.019
7320	0.025
7380	0.019
7440	0.049
7500	0.021
7560	0.019
7620	0.019
7680	0.018
7740	0.018
7800	0.018
7860	0.018
7920	0.018
7980	0.018
8040	0.019
8100	0.024
8160	0.024
8220	0.021
8280	0.022
8340	0.021
8400	0.02
8460	0.02
8520	0.023
8580	0.076
8640	0.05
8700	0.034
8760	0.057
8820	0.035
8880	0.034
8940	0.027
9000	0.028
9060	0.02
9120	0.02
9180	0.041
9240	0.057
9300	0.019

9360	0.021
9420	0.02
9480	0.019
9540	0.019
9600	0.02
9660	0.018
9720	0.017
9780	0.017
9840	0.016
9900	0.019
9960	0.019
10020	0.021
10080	0.022
10140	0.019
10200	0.02
10260	0.019
10320	0.019
10380	0.018
10440	0.019
10500	0.031
10560	0.02
10620	0.018
10680	0.021
10740	0.017
10800	0.017
10860	0.016
10920	0.017
10980	0.017
11040	0.019
11100	0.018
11160	0.016
11220	0.015
11280	0.015
11340	0.014
11400	0.016
11460	0.024
11520	0.022
11580	0.017
11640	0.024
11700	0.037
11760	0.031
11820	0.02
11880	0.019
11940	0.017

12000	0.018
12060	0.018
12120	0.021
12180	0.023
12240	0.015
12300	0.015
12360	0.016
12420	0.021
12480	0.018
12540	0.015
12600	0.016
12660	0.017
12720	0.016
12780	0.018
12840	0.015
12900	0.017
12960	0.017
13020	0.018
13080	0.017
13140	0.021
13200	0.019
13260	0.016
13320	0.077
13380	0.02
13440	0.017
13500	0.032
13560	0.021
13620	0.025
13680	0.026
13740	0.019
13800	0.019
13860	0.018
13920	0.019
13980	0.022
14040	0.019
14100	0.017
14160	0.017
14220	0.019
14280	0.019
14340	0.231
14400	0.038
14460	0.021
14520	0.019
14580	0.019

14640	0.021
14700	0.019
14760	0.026
14820	0.023
14880	0.019
14940	0.02
15000	0.017
15060	0.018
15120	0.017
15180	0.018
15240	0.024
15300	0.031
15360	0.018
15420	0.019
15480	0.016
15540	0.022
15600	0.018
15660	0.02
15720	0.065
15780	0.021
15840	0.02
15900	0.023
15960	0.021
16020	0.017
16080	0.018
16140	0.024
16200	0.019
16260	0.017
16320	0.02
16380	0.019
16440	0.018
16500	0.019
16560	0.02
16620	0.017
16680	0.019
16740	0.018
16800	0.017
16860	0.017
16920	0.017
16980	0.028
17040	0.018
17100	0.018
17160	0.018
17220	0.018

17280	0.018
17340	0.021
17400	0.026
17460	0.017
17520	0.017
17580	0.02
17640	0.018
17700	0.018
17760	0.017
17820	0.018
17880	0.018
17940	0.018
18000	0.017
18060	0.018
18120	0.018
18180	0.018
18240	0.018
18300	0.018
18360	0.019
18420	0.022
18480	0.018
18540	0.019
18600	0.021
18660	0.022
18720	0.021
18780	0.02
18840	0.02
18900	0.021
18960	0.022
19020	0.021
19080	0.021
19140	0.021
19200	0.035
19260	0.021
19320	0.02
19380	0.019
19440	0.02
19500	0.02
19560	0.022
19620	0.036
19680	0.57
19740	0.042
19800	0.039
19860	0.022

19920	0.042
19980	0.053
20040	0.036
20100	0.037
20160	0.026
20220	0.029
20280	0.027
20340	0.149
20400	0.021
20460	0.051
20520	0.025
20580	0.021
20640	0.022
20700	0.02
20760	0.022
20820	0.027
20880	0.021
20940	0.022
21000	0.031
21060	0.026
21120	0.024
21180	0.022
21240	0.021
21300	0.027
21360	0.027
21420	0.038
21480	0.027
21540	0.043
21600	0.025
21660	0.028
21720	0.029
21780	0.023
21840	0.027
21900	0.03
21960	0.058
22020	0.036
22080	0.026
22140	0.025
22200	0.035
22260	0.054
22320	0.094
22380	0.024
22440	0.025
22500	0.024

22560	0.022
22620	0.024
22680	0.027
22740	0.032
22800	0.024
22860	0.023
22920	0.028
22980	0.025
23040	0.021
23100	0.022
23160	0.028
23220	0.028
23280	0.027
23340	0.02
23400	0.027
23460	0.024
23520	0.024
23580	0.023
23640	0.026
23700	0.025
23760	0.029
23820	0.029
23880	0.025
23940	0.028
24000	0.03
24060	0.025
24120	0.024
24180	0.028
24240	0.028
24300	0.026
24360	0.027
24420	0.021
24480	0.033
24540	0.03
24600	0.03
24660	0.036
24720	0.037
24780	0.028
24840	0.025
24900	0.025
24960	0.026
25020	0.044
25080	0.043
25140	0.025

25200	0.027
25260	0.032
25320	0.023
25380	0.023
25440	0.023
25500	0.029
25560	0.03
25620	0.026
25680	0.03
25740	0.024
25800	0.064
25860	0.035
25920	0.025
25980	0.024
26040	0.029
26100	0.028
26160	0.028
26220	0.023
26280	0.023
26340	0.033
26400	0.031
26460	0.037
26520	0.043
26580	0.103
26640	0.033
26700	0.076
26760	0.022
26820	0.021
26880	0.045
26940	0.064
27000	0.026
27060	0.02
27120	0.02
27180	0.02
27240	0.022
27300	0.029
27360	0.027
27420	0.022
27480	0.021
27540	0.02
27600	0.022
27660	0.024
27720	0.021
27780	0.021

27840	0.023
27900	0.026
27960	0.023
28020	0.024
28080	0.023
28140	0.021
28200	0.032
28260	0.022
28320	0.023
28380	0.024
28440	0.023
28500	0.023
28560	0.023
28620	0.029
28680	0.025
28740	0.022
28800	0.022
28860	0.023
28920	0.021
28980	0.021
29040	0.02
29100	0.02
29160	0.02
29220	0.02
29280	0.02
29340	0.02
29400	0.021
29460	0.021
29520	0.022
29580	0.022
29640	0.025
29700	0.022
29760	0.021
29820	0.02
29880	0.021
29940	0.021
30000	0.021
30060	0.022
30120	0.021
30180	0.021
30240	0.02
30300	0.02
30360	0.021
30420	0.025

30480	0.022
30540	0.021
30600	0.022
30660	0.022
30720	0.022
30780	0.022
30840	0.022
30900	0.023
30960	0.023
31020	0.022
31080	0.021
31140	0.021
31200	0.02
31260	0.02
31320	0.02
31380	0.02
31440	0.021
31500	0.021
31560	0.02
31620	0.019
31680	0.023
31740	0.041
31800	0.02
31860	0.021
31920	0.02
31980	0.022
32040	0.02
32100	0.021
32160	0.019
32220	0.02
32280	0.024
32340	0.034
32400	0.021
32460	0.021
32520	0.02
32580	0.02
32640	0.023
32700	0.021
32760	0.02
32820	0.021
32880	0.021
32940	0.023
33000	0.021
33060	0.02

33120	0.022
33180	0.023
33240	0.022
33300	0.021
33360	0.023
33420	0.023
33480	0.021
33540	0.021
33600	0.022
33660	0.029
33720	0.027
33780	0.021
33840	0.021
33900	0.02
33960	0.02
34020	0.02
34080	0.02
34140	0.02
34200	0.021
34260	0.022
34320	0.021
34380	0.021
34440	0.023
34500	0.023
34560	0.022
34620	0.02
34680	0.02
34740	0.02
34800	0.02
34860	0.021
34920	0.023
34980	0.021
35040	0.025
35100	0.023
35160	0.021
35220	0.02
35280	0.02
35340	0.02
35400	0.023
35460	0.022
35520	0.028
35580	0.02
35640	0.029
35700	0.021

35760	0.019
35820	0.019
35880	0.027
35940	0.02
36000	0.02
36060	0.023
36120	0.026
36180	0.02
36240	0.021
36300	0.02
36360	0.018
36420	0.018
36480	0.018
36540	0.019
36600	0.019
36660	0.017
36720	0.026
36780	0.025
36840	0.018
36900	0.018
36960	0.022
37020	0.018
37080	0.017
37140	0.027
37200	0.018
37260	0.019
37320	0.019
37380	0.017
37440	0.018
37500	0.017
37560	0.021
37620	0.017
37680	0.017
37740	0.017
37800	0.018
37860	0.016
37920	0.017
37980	0.016
38040	0.017
38100	0.027
38160	0.017
38220	0.017
38280	0.02
38340	0.016

38400	0.017
38460	0.017
38520	0.016
38580	0.017
38640	0.018
38700	0.018
38760	0.022
38820	0.031
38880	0.023
38940	0.026
39000	0.018
39060	0.018
39120	0.018
39180	0.018
39240	0.018
39300	0.025
39360	0.021
39420	0.017
39480	0.016
39540	0.018
39600	0.024
39660	0.017
39720	0.019
39780	0.017
39840	0.022
39900	0.019
39960	0.021
40020	0.018
40080	0.017
40140	0.018
40200	0.027
40260	0.019
40320	0.02
40380	0.018
40440	0.017
40500	0.017
40560	0.017
40620	0.017
40680	0.017
40740	0.017
40800	0.023
40860	0.018
40920	0.017
40980	0.021

41040	0.026
41100	0.018
41160	0.019
41220	0.022
41280	0.022
41340	0.019
41400	0.019
41460	0.019
41520	0.024
41580	0.018
41640	0.02
41700	0.019
41760	0.021
41820	0.018
41880	0.021
41940	0.016
42000	0.018
42060	0.017
42120	0.016
42180	0.022
42240	0.021
42300	0.022
42360	0.018
42420	0.017
42480	0.016
42540	0.016
42600	0.016
42660	0.016
42720	0.016
42780	0.015
42840	0.016
42900	0.018
42960	0.023
43020	0.021
43080	0.016
43140	0.015
43200	0.019
43260	0.016
43320	0.019
43380	0.019
43440	0.017
43500	0.016
43560	0.024
43620	0.017

43680	0.016
43740	0.018
43800	0.021
43860	0.034
43920	0.022
43980	0.028
44040	0.024
44100	0.016
44160	0.02
44220	0.018
44280	0.022
44340	0.029
44400	0.022
44460	0.032
44520	0.025
44580	0.021
44640	0.026
44700	0.021
44760	0.025
44820	0.017
44880	0.028
44940	0.027
45000	0.145
45060	0.059
45120	0.021
45180	0.016
45240	0.017
45300	0.015
45360	0.016
45420	0.016
45480	0.018
45540	0.017
45600	0.016
45660	0.016
45720	0.019

Device Serial No	Log Time	Log Type	Sensor 1 Type	Sensor 1 Serial Number	Sensor 1 Status	Sensor 1 Gas Reading
592-601225	8/23/2024 13:38	Readings	PID	SC23030037D3	Normal	0
592-601225	8/23/2024 13:37	Readings	PID	SC23030037D3	Normal	0
592-601225	8/23/2024 13:36	Readings	PID	SC23030037D3	Normal	0
592-601225	8/23/2024 13:35	Readings	PID	SC23030037D3	Normal	0
592-601225	8/23/2024 13:34	Readings	PID	SC23030037D3	Normal	0
592-601225	8/23/2024 13:33	Readings	PID	SC23030037D3	Normal	0
592-601225	8/23/2024 13:32	Readings	PID	SC23030037D3	Normal	0
592-601225	8/23/2024 13:31	Readings	PID	SC23030037D3	Normal	0
592-601225	8/23/2024 13:30	Readings	PID	SC23030037D3	Normal	0
592-601225	8/23/2024 13:29	Readings	PID	SC23030037D3	Normal	0
592-601225	8/23/2024 13:28	Readings	PID	SC23030037D3	Normal	0
592-601225	8/23/2024 13:27	Readings	PID	SC23030037D3	Normal	0
592-601225	8/23/2024 13:26	Readings	PID	SC23030037D3	Normal	0
592-601225	8/23/2024 13:25	Readings	PID	SC23030037D3	Normal	0
592-601225	8/23/2024 13:24	Readings	PID	SC23030037D3	Normal	0
592-601225	8/23/2024 13:23	Readings	PID	SC23030037D3	Normal	0
592-601225	8/23/2024 13:22	Readings	PID	SC23030037D3	Normal	0
592-601225	8/23/2024 13:21	Readings	PID	SC23030037D3	Normal	0
592-601225	8/23/2024 13:20	Readings	PID	SC23030037D3	Normal	0
592-601225	8/23/2024 13:19	Readings	PID	SC23030037D3	Normal	0
592-601225	8/23/2024 13:18	Readings	PID	SC23030037D3	Normal	0
592-601225	8/23/2024 13:17	Readings	PID	SC23030037D3	Normal	0
592-601225	8/23/2024 13:16	Readings	PID	SC23030037D3	Normal	0
592-601225	8/23/2024 13:15	Readings	PID	SC23030037D3	Normal	0
592-601225	8/23/2024 13:14	Readings	PID	SC23030037D3	Normal	0
592-601225	8/23/2024 13:13	Readings	PID	SC23030037D3	Normal	0
592-601225	8/23/2024 13:12	Readings	PID	SC23030037D3	Normal	0
592-601225	8/23/2024 13:11	Readings	PID	SC23030037D3	Normal	0
592-601225	8/23/2024 13:10	Readings	PID	SC23030037D3	Normal	0
592-601225	8/23/2024 13:09	Readings	PID	SC23030037D3	Normal	0
592-601225	8/23/2024 13:08	Readings	PID	SC23030037D3	Normal	0
592-601225	8/23/2024 13:07	Readings	PID	SC23030037D3	Normal	0

592-601225	8/23/2024 10:21	Readings	PID	SC23030037D3	Normal	0
592-601225	8/23/2024 10:20	Readings	PID	SC23030037D3	Normal	0
592-601225	8/23/2024 10:19	Readings	PID	SC23030037D3	Normal	0
592-601225	8/23/2024 10:18	Readings	PID	SC23030037D3	Normal	0
592-601225	8/23/2024 10:17	Readings	PID	SC23030037D3	Normal	0
592-601225	8/23/2024 10:16	Readings	PID	SC23030037D3	Normal	0
592-601225	8/23/2024 10:15	Readings	PID	SC23030037D3	Normal	0
592-601225	8/23/2024 10:14	Readings	PID	SC23030037D3	Normal	0
592-601225	8/23/2024 10:13	Readings	PID	SC23030037D3	Normal	0
592-601225	8/23/2024 10:12	Readings	PID	SC23030037D3	Normal	0
592-601225	8/23/2024 10:11	Readings	PID	SC23030037D3	Normal	0
592-601225	8/23/2024 10:10	Readings	PID	SC23030037D3	Normal	0
592-601225	8/23/2024 10:09	Readings	PID	SC23030037D3	Normal	0
592-601225	8/23/2024 10:08	Readings	PID	SC23030037D3	Normal	0
592-601225	8/23/2024 10:07	Readings	PID	SC23030037D3	Normal	0
592-601225	8/23/2024 10:06	Readings	PID	SC23030037D3	Normal	0
592-601225	8/23/2024 10:05	Readings	PID	SC23030037D3	Normal	0
592-601225	8/23/2024 10:04	Readings	PID	SC23030037D3	Normal	0
592-601225	8/23/2024 10:03	Readings	PID	SC23030037D3	Normal	0
592-601225	8/23/2024 10:02	Readings	PID	SC23030037D3	Normal	0
592-601225	8/23/2024 10:01	Readings	PID	SC23030037D3	Normal	0
592-601225	8/23/2024 10:00	Readings	PID	SC23030037D3	Normal	0
592-601225	8/23/2024 9:59	Readings	PID	SC23030037D3	Normal	0
592-601225	8/23/2024 9:58	Readings	PID	SC23030037D3	Normal	0
592-601225	8/23/2024 9:57	Readings	PID	SC23030037D3	Normal	0
592-601225	8/23/2024 9:56	Readings	PID	SC23030037D3	Normal	0
592-601225	8/23/2024 9:55	Readings	PID	SC23030037D3	Normal	0
592-601225	8/23/2024 9:54	Readings	PID	SC23030037D3	Normal	0
592-601225	8/23/2024 9:53	Readings	PID	SC23030037D3	Normal	0
592-601225	8/23/2024 9:52	Readings	PID	SC23030037D3	Normal	0
592-601225	8/23/2024 9:51	Readings	PID	SC23030037D3	Normal	0
592-601225	8/23/2024 9:50	Readings	PID	SC23030037D3	Normal	0
592-601225	8/23/2024 9:49	Readings	PID	SC23030037D3	Normal	0

592-601225	8/23/2024 8:09 Readings	PID	SC23030037D3	Normal	0
592-601225	8/23/2024 8:08 Readings	PID	SC23030037D3	Normal	0
592-601225	8/23/2024 8:07 Readings	PID	SC23030037D3	Normal	0
592-601225	8/23/2024 8:06 Readings	PID	SC23030037D3	Normal	0
592-601225	8/23/2024 8:05 Readings	PID	SC23030037D3	Normal	0
592-601225	8/23/2024 8:04 Readings	PID	SC23030037D3	Normal	0
592-601225	8/23/2024 8:03 Readings	PID	SC23030037D3	Normal	0
592-601225	8/23/2024 8:02 Readings	PID	SC23030037D3	Normal	0
592-601225	8/23/2024 8:01 Readings	PID	SC23030037D3	Normal	0
592-601225	8/23/2024 8:00 Readings	PID	SC23030037D3	Normal	0
592-601225	8/23/2024 7:59 Readings	PID	SC23030037D3	Normal	0
592-601225	8/23/2024 7:58 Readings	PID	SC23030037D3	Normal	0
592-601225	8/23/2024 7:57 Readings	PID	SC23030037D3	Normal	0
592-601225	8/23/2024 7:56 Readings	PID	SC23030037D3	Normal	0
592-601225	8/23/2024 7:55 Readings	PID	SC23030037D3	Normal	0
592-601225	8/23/2024 7:54 Readings	PID	SC23030037D3	Normal	0
592-601225	8/23/2024 7:53 CONFIG	PID	SC23030037D3		

Instrument Name	DustTrak II
Model Number	8530
Serial Number	8530154916
Firmware Version	3.1
Calibration Date	8/2/2024
Test Name	MANUAL_032
Test Start Time	7:05:02 AM
Test Start Date	8/23/2024
Test Length [D:H:M]	0:12:50
Test Interval [M:S]	1:00
Mass Average [mg/m3]	0.038
Mass Minimum [mg/m3]	0.026
Mass Maximum [mg/m3]	0.163
Mass TWA [mg/m3]	0.04
Photometric User Cal	1
Flow User Cal	0
Errors	
Number of Samples	770

Elapsed Time [s]	Mass [mg/m3]	Alarms	Errors
60	0.09		
120	0.034		
180	0.033		
240	0.027		
300	0.026		
360	0.026		
420	0.026		
480	0.026		
540	0.03		
600	0.027		
660	0.026		
720	0.027		
780	0.028		
840	0.028		
900	0.029		
960	0.036		
1020	0.03		
1080	0.035		
1140	0.034		
1200	0.034		
1260	0.042		
1320	0.049		
1380	0.032		
1440	0.03		

1500	0.04
1560	0.04
1620	0.058
1680	0.142
1740	0.061
1800	0.068
1860	0.057
1920	0.072
1980	0.048
2040	0.039
2100	0.033
2160	0.038
2220	0.032
2280	0.032
2340	0.063
2400	0.061
2460	0.066
2520	0.041
2580	0.044
2640	0.046
2700	0.041
2760	0.043
2820	0.043
2880	0.044
2940	0.04
3000	0.058
3060	0.035
3120	0.035
3180	0.037
3240	0.033
3300	0.032
3360	0.036
3420	0.045
3480	0.05
3540	0.035
3600	0.033
3660	0.038
3720	0.034
3780	0.033
3840	0.047
3900	0.047
3960	0.035
4020	0.034
4080	0.044

4140	0.054
4200	0.036
4260	0.034
4320	0.039
4380	0.034
4440	0.037
4500	0.039
4560	0.037
4620	0.038
4680	0.037
4740	0.04
4800	0.037
4860	0.038
4920	0.037
4980	0.037
5040	0.077
5100	0.04
5160	0.036
5220	0.034
5280	0.036
5340	0.035
5400	0.035
5460	0.037
5520	0.038
5580	0.036
5640	0.038
5700	0.037
5760	0.036
5820	0.036
5880	0.036
5940	0.047
6000	0.041
6060	0.036
6120	0.037
6180	0.039
6240	0.034
6300	0.04
6360	0.041
6420	0.039
6480	0.036
6540	0.044
6600	0.042
6660	0.039
6720	0.042

6780	0.038
6840	0.041
6900	0.036
6960	0.035
7020	0.037
7080	0.037
7140	0.035
7200	0.035
7260	0.04
7320	0.043
7380	0.053
7440	0.057
7500	0.061
7560	0.036
7620	0.04
7680	0.036
7740	0.036
7800	0.036
7860	0.036
7920	0.038
7980	0.037
8040	0.049
8100	0.036
8160	0.032
8220	0.034
8280	0.038
8340	0.035
8400	0.038
8460	0.036
8520	0.033
8580	0.046
8640	0.046
8700	0.037
8760	0.041
8820	0.039
8880	0.037
8940	0.061
9000	0.059
9060	0.044
9120	0.053
9180	0.06
9240	0.038
9300	0.037
9360	0.036

9420	0.038
9480	0.042
9540	0.059
9600	0.037
9660	0.048
9720	0.046
9780	0.04
9840	0.043
9900	0.043
9960	0.034
10020	0.034
10080	0.037
10140	0.041
10200	0.121
10260	0.079
10320	0.038
10380	0.037
10440	0.041
10500	0.042
10560	0.033
10620	0.035
10680	0.035
10740	0.039
10800	0.04
10860	0.04
10920	0.034
10980	0.036
11040	0.031
11100	0.04
11160	0.031
11220	0.031
11280	0.032
11340	0.039
11400	0.03
11460	0.03
11520	0.029
11580	0.027
11640	0.027
11700	0.029
11760	0.034
11820	0.037
11880	0.035
11940	0.038
12000	0.054

12060	0.034
12120	0.034
12180	0.032
12240	0.037
12300	0.036
12360	0.043
12420	0.047
12480	0.086
12540	0.035
12600	0.029
12660	0.047
12720	0.067
12780	0.064
12840	0.057
12900	0.065
12960	0.038
13020	0.029
13080	0.034
13140	0.026
13200	0.026
13260	0.031
13320	0.032
13380	0.036
13440	0.029
13500	0.046
13560	0.028
13620	0.05
13680	0.04
13740	0.033
13800	0.036
13860	0.031
13920	0.034
13980	0.038
14040	0.033
14100	0.032
14160	0.035
14220	0.038
14280	0.038
14340	0.033
14400	0.031
14460	0.028
14520	0.031
14580	0.034
14640	0.054

14700	0.041
14760	0.04
14820	0.041
14880	0.032
14940	0.057
15000	0.032
15060	0.036
15120	0.037
15180	0.036
15240	0.034
15300	0.028
15360	0.033
15420	0.043
15480	0.03
15540	0.029
15600	0.026
15660	0.026
15720	0.03
15780	0.036
15840	0.033
15900	0.031
15960	0.033
16020	0.048
16080	0.071
16140	0.03
16200	0.034
16260	0.047
16320	0.029
16380	0.032
16440	0.05
16500	0.033
16560	0.066
16620	0.038
16680	0.041
16740	0.031
16800	0.032
16860	0.036
16920	0.031
16980	0.034
17040	0.033
17100	0.048
17160	0.035
17220	0.042
17280	0.036

17340	0.029
17400	0.027
17460	0.032
17520	0.038
17580	0.044
17640	0.035
17700	0.036
17760	0.028
17820	0.032
17880	0.029
17940	0.033
18000	0.057
18060	0.062
18120	0.028
18180	0.028
18240	0.031
18300	0.031
18360	0.031
18420	0.029
18480	0.028
18540	0.031
18600	0.039
18660	0.029
18720	0.03
18780	0.028
18840	0.03
18900	0.038
18960	0.041
19020	0.065
19080	0.054
19140	0.031
19200	0.04
19260	0.031
19320	0.055
19380	0.038
19440	0.044
19500	0.083
19560	0.051
19620	0.032
19680	0.042
19740	0.034
19800	0.034
19860	0.035
19920	0.033

19980	0.045
20040	0.04
20100	0.043
20160	0.036
20220	0.042
20280	0.038
20340	0.04
20400	0.037
20460	0.037
20520	0.035
20580	0.036
20640	0.04
20700	0.079
20760	0.076
20820	0.063
20880	0.037
20940	0.034
21000	0.037
21060	0.04
21120	0.039
21180	0.041
21240	0.053
21300	0.039
21360	0.034
21420	0.033
21480	0.031
21540	0.033
21600	0.04
21660	0.163
21720	0.119
21780	0.066
21840	0.057
21900	0.087
21960	0.042
22020	0.038
22080	0.039
22140	0.045
22200	0.039
22260	0.043
22320	0.034
22380	0.034
22440	0.034
22500	0.039
22560	0.037

22620	0.035
22680	0.032
22740	0.035
22800	0.03
22860	0.031
22920	0.036
22980	0.033
23040	0.033
23100	0.031
23160	0.033
23220	0.036
23280	0.036
23340	0.033
23400	0.034
23460	0.031
23520	0.03
23580	0.028
23640	0.028
23700	0.029
23760	0.033
23820	0.035
23880	0.036
23940	0.041
24000	0.04
24060	0.033
24120	0.035
24180	0.033
24240	0.04
24300	0.042
24360	0.037
24420	0.037
24480	0.057
24540	0.036
24600	0.029
24660	0.029
24720	0.029
24780	0.037
24840	0.047
24900	0.06
24960	0.031
25020	0.03
25080	0.042
25140	0.033
25200	0.033

25260	0.039
25320	0.044
25380	0.054
25440	0.043
25500	0.045
25560	0.065
25620	0.036
25680	0.03
25740	0.05
25800	0.036
25860	0.045
25920	0.039
25980	0.038
26040	0.036
26100	0.045
26160	0.101
26220	0.048
26280	0.044
26340	0.039
26400	0.043
26460	0.036
26520	0.032
26580	0.034
26640	0.037
26700	0.04
26760	0.056
26820	0.044
26880	0.037
26940	0.031
27000	0.034
27060	0.036
27120	0.035
27180	0.03
27240	0.028
27300	0.028
27360	0.029
27420	0.032
27480	0.03
27540	0.03
27600	0.03
27660	0.03
27720	0.035
27780	0.047
27840	0.03

27900	0.039
27960	0.035
28020	0.04
28080	0.052
28140	0.036
28200	0.039
28260	0.038
28320	0.039
28380	0.036
28440	0.041
28500	0.034
28560	0.036
28620	0.042
28680	0.037
28740	0.043
28800	0.054
28860	0.069
28920	0.064
28980	0.048
29040	0.041
29100	0.037
29160	0.061
29220	0.059
29280	0.041
29340	0.033
29400	0.03
29460	0.042
29520	0.037
29580	0.035
29640	0.032
29700	0.035
29760	0.034
29820	0.044
29880	0.043
29940	0.038
30000	0.033
30060	0.035
30120	0.041
30180	0.039
30240	0.035
30300	0.038
30360	0.035
30420	0.054
30480	0.047

30540	0.043
30600	0.045
30660	0.035
30720	0.031
30780	0.045
30840	0.04
30900	0.041
30960	0.039
31020	0.04
31080	0.037
31140	0.032
31200	0.035
31260	0.035
31320	0.031
31380	0.035
31440	0.041
31500	0.03
31560	0.031
31620	0.029
31680	0.03
31740	0.031
31800	0.035
31860	0.034
31920	0.034
31980	0.033
32040	0.035
32100	0.031
32160	0.04
32220	0.034
32280	0.034
32340	0.045
32400	0.038
32460	0.031
32520	0.034
32580	0.034
32640	0.033
32700	0.037
32760	0.033
32820	0.038
32880	0.033
32940	0.035
33000	0.036
33060	0.032
33120	0.036

33180	0.038
33240	0.04
33300	0.033
33360	0.036
33420	0.034
33480	0.033
33540	0.036
33600	0.076
33660	0.034
33720	0.038
33780	0.036
33840	0.038
33900	0.032
33960	0.03
34020	0.032
34080	0.035
34140	0.035
34200	0.031
34260	0.032
34320	0.032
34380	0.032
34440	0.033
34500	0.034
34560	0.034
34620	0.033
34680	0.036
34740	0.038
34800	0.034
34860	0.035
34920	0.033
34980	0.033
35040	0.034
35100	0.032
35160	0.033
35220	0.033
35280	0.036
35340	0.034
35400	0.033
35460	0.033
35520	0.032
35580	0.034
35640	0.037
35700	0.032
35760	0.035

35820	0.032
35880	0.085
35940	0.086
36000	0.034
36060	0.032
36120	0.031
36180	0.03
36240	0.03
36300	0.029
36360	0.035
36420	0.03
36480	0.03
36540	0.032
36600	0.031
36660	0.035
36720	0.03
36780	0.033
36840	0.031
36900	0.03
36960	0.038
37020	0.032
37080	0.032
37140	0.028
37200	0.032
37260	0.031
37320	0.03
37380	0.03
37440	0.032
37500	0.033
37560	0.032
37620	0.03
37680	0.031
37740	0.031
37800	0.034
37860	0.04
37920	0.035
37980	0.028
38040	0.03
38100	0.03
38160	0.027
38220	0.029
38280	0.028
38340	0.028
38400	0.028

38460	0.029
38520	0.027
38580	0.027
38640	0.028
38700	0.031
38760	0.027
38820	0.026
38880	0.027
38940	0.029
39000	0.029
39060	0.031
39120	0.028
39180	0.033
39240	0.033
39300	0.028
39360	0.032
39420	0.028
39480	0.031
39540	0.028
39600	0.028
39660	0.032
39720	0.031
39780	0.031
39840	0.028
39900	0.03
39960	0.029
40020	0.029
40080	0.026
40140	0.026
40200	0.032
40260	0.03
40320	0.029
40380	0.028
40440	0.027
40500	0.029
40560	0.027
40620	0.026
40680	0.027
40740	0.026
40800	0.028
40860	0.105
40920	0.054
40980	0.096
41040	0.088

41100	0.06
41160	0.043
41220	0.093
41280	0.061
41340	0.093
41400	0.058
41460	0.062
41520	0.067
41580	0.04
41640	0.033
41700	0.045
41760	0.077
41820	0.077
41880	0.076
41940	0.038
42000	0.031
42060	0.029
42120	0.029
42180	0.041
42240	0.041
42300	0.04
42360	0.03
42420	0.034
42480	0.03
42540	0.03
42600	0.028
42660	0.047
42720	0.036
42780	0.032
42840	0.032
42900	0.033
42960	0.037
43020	0.033
43080	0.031
43140	0.034
43200	0.029
43260	0.028
43320	0.028
43380	0.026
43440	0.026
43500	0.026
43560	0.028
43620	0.03
43680	0.033

43740	0.032
43800	0.029
43860	0.033
43920	0.054
43980	0.037
44040	0.035
44100	0.035
44160	0.028
44220	0.027
44280	0.026
44340	0.026
44400	0.026
44460	0.027
44520	0.03
44580	0.035
44640	0.044
44700	0.036
44760	0.033
44820	0.035
44880	0.033
44940	0.029
45000	0.03
45060	0.031
45120	0.032
45180	0.028
45240	0.028
45300	0.029
45360	0.029
45420	0.027
45480	0.028
45540	0.028
45600	0.028
45660	0.029
45720	0.03
45780	0.03
45840	0.031
45900	0.029
45960	0.028
46020	0.027
46080	0.028
46140	0.028
46200	0.031

Device Serial No	Log Time	Log Type	Sensor 1 Type	Sensor 1 Serial Number	Sensor 1 Status	Sensor 1 Gas Reading
592-923428	8/23/2024 20:08	Readings	PID	SC23030029V2	Normal	0
592-923428	8/23/2024 20:07	Readings	PID	SC23030029V2	Normal	0
592-923428	8/23/2024 20:06	Readings	PID	SC23030029V2	Normal	0
592-923428	8/23/2024 20:05	Readings	PID	SC23030029V2	Normal	0
592-923428	8/23/2024 20:04	Readings	PID	SC23030029V2	Normal	0
592-923428	8/23/2024 20:03	Readings	PID	SC23030029V2	Normal	0
592-923428	8/23/2024 20:02	Readings	PID	SC23030029V2	Normal	0
592-923428	8/23/2024 20:01	Readings	PID	SC23030029V2	Normal	0
592-923428	8/23/2024 20:00	Readings	PID	SC23030029V2	Normal	0
592-923428	8/23/2024 19:59	Readings	PID	SC23030029V2	Normal	0
592-923428	8/23/2024 19:58	Readings	PID	SC23030029V2	Normal	0
592-923428	8/23/2024 19:57	Readings	PID	SC23030029V2	Normal	0
592-923428	8/23/2024 19:56	Readings	PID	SC23030029V2	Normal	0
592-923428	8/23/2024 19:55	Readings	PID	SC23030029V2	Normal	0
592-923428	8/23/2024 19:54	Readings	PID	SC23030029V2	Normal	0
592-923428	8/23/2024 19:53	Readings	PID	SC23030029V2	Normal	0
592-923428	8/23/2024 19:52	Readings	PID	SC23030029V2	Normal	0
592-923428	8/23/2024 19:51	Readings	PID	SC23030029V2	Normal	0
592-923428	8/23/2024 19:50	Readings	PID	SC23030029V2	Normal	0
592-923428	8/23/2024 19:49	Readings	PID	SC23030029V2	Normal	0
592-923428	8/23/2024 19:48	Readings	PID	SC23030029V2	Normal	0
592-923428	8/23/2024 19:47	Readings	PID	SC23030029V2	Normal	0
592-923428	8/23/2024 19:46	Readings	PID	SC23030029V2	Normal	0
592-923428	8/23/2024 19:45	Readings	PID	SC23030029V2	Normal	0
592-923428	8/23/2024 19:44	Readings	PID	SC23030029V2	Normal	0
592-923428	8/23/2024 19:43	Readings	PID	SC23030029V2	Normal	0
592-923428	8/23/2024 19:42	Readings	PID	SC23030029V2	Normal	0
592-923428	8/23/2024 19:41	Readings	PID	SC23030029V2	Normal	0
592-923428	8/23/2024 19:40	Readings	PID	SC23030029V2	Normal	0
592-923428	8/23/2024 19:39	Readings	PID	SC23030029V2	Normal	0
592-923428	8/23/2024 19:38	Readings	PID	SC23030029V2	Normal	0
592-923428	8/23/2024 19:37	Readings	PID	SC23030029V2	Normal	0

592-923428	8/23/2024 10:15	Readings	PID	SC23030029V2	Normal	0
592-923428	8/23/2024 10:14	Readings	PID	SC23030029V2	Normal	0
592-923428	8/23/2024 10:13	Readings	PID	SC23030029V2	Normal	0
592-923428	8/23/2024 10:12	Readings	PID	SC23030029V2	Normal	0
592-923428	8/23/2024 10:11	Readings	PID	SC23030029V2	Normal	0
592-923428	8/23/2024 10:10	Readings	PID	SC23030029V2	Normal	0
592-923428	8/23/2024 10:09	Readings	PID	SC23030029V2	Normal	0
592-923428	8/23/2024 10:08	Readings	PID	SC23030029V2	Normal	0
592-923428	8/23/2024 10:07	Readings	PID	SC23030029V2	Normal	0
592-923428	8/23/2024 10:06	Readings	PID	SC23030029V2	Normal	0
592-923428	8/23/2024 10:05	Readings	PID	SC23030029V2	Normal	0
592-923428	8/23/2024 10:04	Readings	PID	SC23030029V2	Normal	0
592-923428	8/23/2024 10:03	Readings	PID	SC23030029V2	Normal	0
592-923428	8/23/2024 10:02	Readings	PID	SC23030029V2	Normal	0
592-923428	8/23/2024 10:01	Readings	PID	SC23030029V2	Normal	0
592-923428	8/23/2024 10:00	Readings	PID	SC23030029V2	Normal	0
592-923428	8/23/2024 9:59	Readings	PID	SC23030029V2	Normal	0
592-923428	8/23/2024 9:58	Readings	PID	SC23030029V2	Normal	0
592-923428	8/23/2024 9:57	Readings	PID	SC23030029V2	Normal	0
592-923428	8/23/2024 9:56	Readings	PID	SC23030029V2	Normal	0
592-923428	8/23/2024 9:55	Readings	PID	SC23030029V2	Normal	0
592-923428	8/23/2024 9:54	Readings	PID	SC23030029V2	Normal	0
592-923428	8/23/2024 9:53	Readings	PID	SC23030029V2	Normal	0
592-923428	8/23/2024 9:52	Readings	PID	SC23030029V2	Normal	0
592-923428	8/23/2024 9:51	Readings	PID	SC23030029V2	Normal	0
592-923428	8/23/2024 9:50	Readings	PID	SC23030029V2	Normal	0
592-923428	8/23/2024 9:49	Readings	PID	SC23030029V2	Normal	0
592-923428	8/23/2024 9:48	Readings	PID	SC23030029V2	Normal	0
592-923428	8/23/2024 9:47	Readings	PID	SC23030029V2	Normal	0
592-923428	8/23/2024 9:46	Readings	PID	SC23030029V2	Normal	0
592-923428	8/23/2024 9:45	Readings	PID	SC23030029V2	Normal	0
592-923428	8/23/2024 9:44	Readings	PID	SC23030029V2	Normal	0
592-923428	8/23/2024 9:43	Readings	PID	SC23030029V2	Normal	0

592-923428	8/23/2024 8:36	Readings	PID	SC23030029V2	Normal	0
592-923428	8/23/2024 8:35	Readings	PID	SC23030029V2	Normal	0
592-923428	8/23/2024 8:34	Readings	PID	SC23030029V2	Normal	0
592-923428	8/23/2024 8:33	Readings	PID	SC23030029V2	Normal	0
592-923428	8/23/2024 8:32	Readings	PID	SC23030029V2	Normal	0
592-923428	8/23/2024 8:31	Readings	PID	SC23030029V2	Normal	0
592-923428	8/23/2024 8:30	Readings	PID	SC23030029V2	Normal	0
592-923428	8/23/2024 8:29	Readings	PID	SC23030029V2	Normal	0
592-923428	8/23/2024 8:28	Readings	PID	SC23030029V2	Normal	0
592-923428	8/23/2024 8:27	Readings	PID	SC23030029V2	Normal	0
592-923428	8/23/2024 8:26	Readings	PID	SC23030029V2	Normal	0
592-923428	8/23/2024 8:25	Readings	PID	SC23030029V2	Normal	0
592-923428	8/23/2024 8:24	Readings	PID	SC23030029V2	Normal	0
592-923428	8/23/2024 8:23	Readings	PID	SC23030029V2	Normal	0
592-923428	8/23/2024 8:22	Readings	PID	SC23030029V2	Normal	5.7
592-923428	8/23/2024 8:21	Readings	PID	SC23030029V2	Normal	0
592-923428	8/23/2024 8:20	Readings	PID	SC23030029V2	Normal	0
592-923428	8/23/2024 8:19	Readings	PID	SC23030029V2	Normal	0
592-923428	8/23/2024 8:18	Readings	PID	SC23030029V2	Normal	0
592-923428	8/23/2024 8:17	Readings	PID	SC23030029V2	Normal	0
592-923428	8/23/2024 8:16	Readings	PID	SC23030029V2	Normal	0
592-923428	8/23/2024 8:15	Readings	PID	SC23030029V2	Normal	0
592-923428	8/23/2024 8:14	Readings	PID	SC23030029V2	Normal	0
592-923428	8/23/2024 8:13	Readings	PID	SC23030029V2	Normal	0
592-923428	8/23/2024 8:12	Readings	PID	SC23030029V2	Normal	0
592-923428	8/23/2024 8:11	Readings	PID	SC23030029V2	Normal	0
592-923428	8/23/2024 8:10	Readings	PID	SC23030029V2	Normal	0
592-923428	8/23/2024 8:09	Readings	PID	SC23030029V2	Normal	0
592-923428	8/23/2024 8:08	Readings	PID	SC23030029V2	Normal	0
592-923428	8/23/2024 8:07	Readings	PID	SC23030029V2	Normal	0
592-923428	8/23/2024 8:06	Readings	PID	SC23030029V2	Normal	4.5
592-923428	8/23/2024 8:05	Readings	PID	SC23030029V2	Normal	0
592-923428	8/23/2024 8:04	Readings	PID	SC23030029V2	Normal	0

592-923428	8/23/2024 8:03 Readings	PID	SC23030029V2	Normal	3
592-923428	8/23/2024 8:02 Readings	PID	SC23030029V2	Normal	0
592-923428	8/23/2024 8:01 Readings	PID	SC23030029V2	Normal	0
592-923428	8/23/2024 8:00 CONFIG	PID	SC23030029V2		