



DAILY STATUS REPORT

Prepared By:
Victor Barraza

WEATHER	Snow	Rain	x	Overcast	x	Partly Cloudy		Bright Sun	x	Wind
TEMP.	< 32	32-50		50-70	x	70-85	x	>85		ENE – 11mph

IEEG Project No:	13928	NYSDEC BCP Site No:	C224367	Date:	09/28/24
Project:	251 Douglass Street, Brooklyn, NY				

<p>Consultant: Impact Environmental Engineering and Geology, PLLC (IEEG)</p> <p>Time On: 06:15 Time Out: 13:30</p>	<p>Personnel On Site: IEEG (Environmental) – Victor Barraza Broadway Construction Group –Rick Cascade – Nicholas Vollrath</p> <p>Equipment On Site: (3) MiniRAE 3000 PID, (3) DustTrak II</p>
---	---

Scope of Work: IEEG to deploy CAMP stations according to wind direction; swell material load out. Rig auger maintenance;

Site Activities:

- IEEG deployed three (3) CAMP stations prior to the start of work activities;
- Cascade conducted batch plant maintenance and consolidated swell stockpile material; and
- Cascade crew performing Rig Auger maintenance ;
- Ten (10) truckloads of swell material were loaded off Site to the Pure Soil facility;
- Atmos foam was sprayed while trucks were loaded and over the remaining swell stockpile at the end of the workday. Additionally, the stockpile was covered with poly at the end of the day.

Community Air Monitoring Program (CAMP) - CAMP action level for dust (0.1 mg/m³) and VOCs (5 ppm)

- PID remained at nominal levels throughout the day
- No sustained dust exceedances were observed over a 15-min period during monitoring.
- Startup Upwind Conditions – PID = _0.0_ ppm, Dust = _0.048_ mg/m³ @ 07:23
- High Conditions (Upwind) – PID = _0.9_ ppm @ 07:26, Dust = _0.217_ mg/m³ @ 10:11
- High Conditions (Downwind 1) – PID = _3.8_ ppm @ 07:58, Dust = _0.764_ mg/m³ @ 08:55
- High Conditions (Downwind 2) – PID = _0.0_ ppm, Dust = _0.399_ mg/m³ @ 10:59

Notable Site Conditions:

- None.

Planned for the Next Day/Week:

- Continue ISS Column Installation.

PHOTO LOG

251 DOUGLASS STREET, BROOKLYN, NY



Photo 1-
Representative
view of truck
being load.



Photo 2-
Representative
view of truck
tires being wash
before exiting
site.



Photo 3-

Representative view of tarp bring strapped down.



Photo 4-

Representative view of cascade crew performing auger maintenance.



SITE PLANS

251 DOUGLASS STREET, BROOKLYN, NY



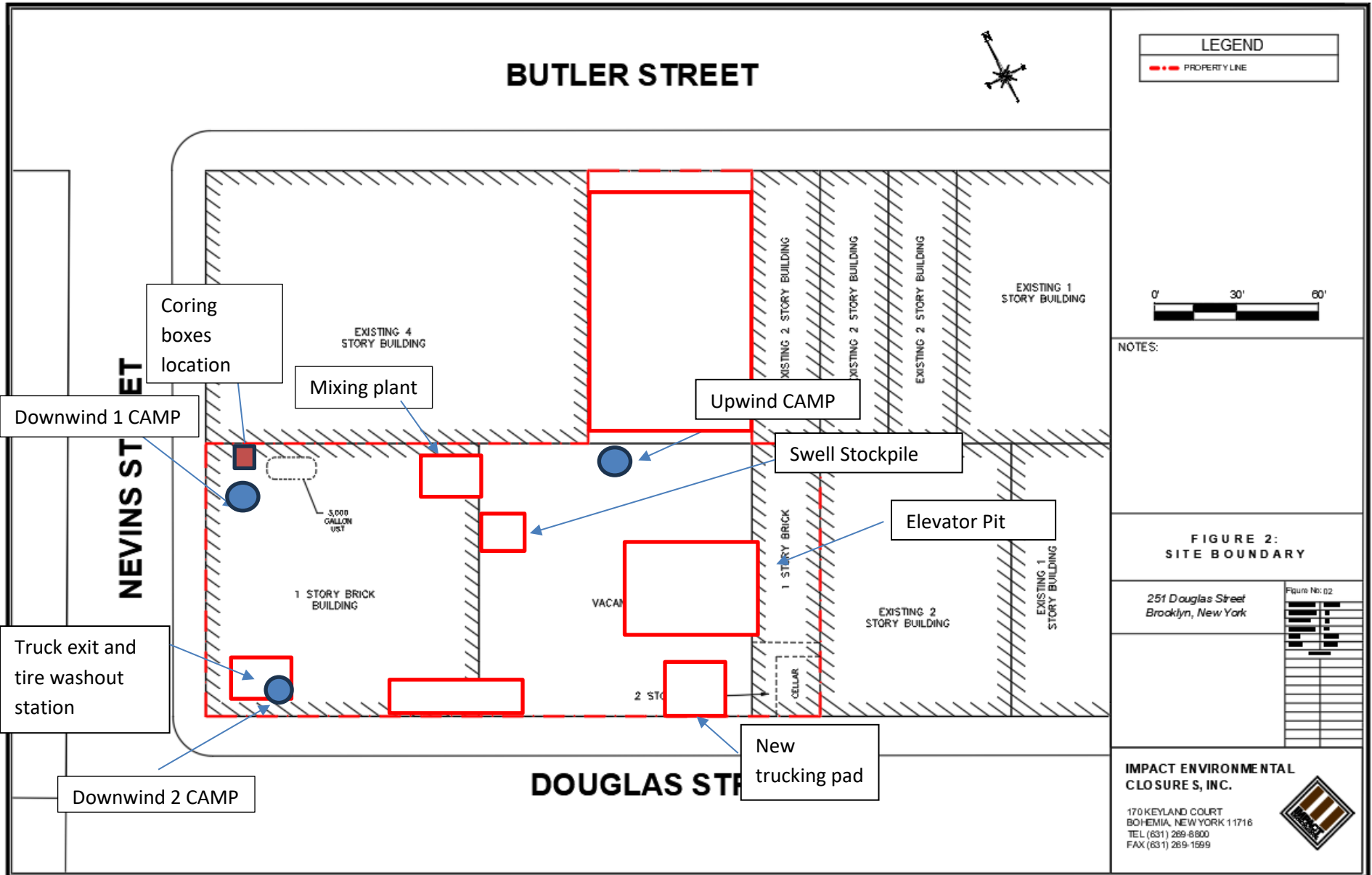



UPWIND CAMP READINGS

251 DOUGLASS STREET, BROOKLYN, NY

Instrument Name	DustTrak II
Model Number	8530
Serial Number	8530224601
Firmware Version	3.1
Calibration Date	11/9/2022
Test Name	MANUAL_018
Test Start Time	7:23:33 AM
Test Start Date	9/28/2024
Test Length [D:H:M]	0:05:33
Test Interval [M:S]	1:00
Mass Average [mg/m3]	0.039
Mass Minimum [mg/m3]	0.015
Mass Maximum [mg/m3]	0.217
Mass TWA [mg/m3]	0.036
Photometric User Cal	1
Flow User Cal	0
Errors	
Number of Samples	320

Elapsed Time [s]	Mass [mg/m3]	Alarms	Errors
7:23	0.048		
7:24	0.038		
7:25	0.038		
7:26	0.041		
7:27	0.04		
7:28	0.036		
7:29	0.036		
7:30	0.035		
7:31	0.034		
7:32	0.061		
7:33	0.04		
7:34	0.038		
7:35	0.039		
7:36	0.038		
7:37	0.043		
7:38	0.061		
7:39	0.045		
7:40	0.046		
7:41	0.041		
7:42	0.047		
7:43	0.044		
7:44	0.04		
7:45	0.047		
7:46	0.057		

7:47	0.04
7:48	0.051
7:49	0.045
7:50	0.044
7:51	0.044
7:52	0.058
7:53	0.048
7:54	0.042
7:55	0.039
7:56	0.043
7:57	0.053
7:58	0.054
7:59	0.045
8:00	0.041
8:01	0.044
8:02	0.043
8:03	0.039
8:04	0.04
8:05	0.039
8:06	0.038
8:07	0.037
8:08	0.038
8:09	0.039
8:10	0.037
8:11	0.038
8:12	0.036
8:13	0.037
8:14	0.041
8:15	0.039
8:16	0.037
8:17	0.035
8:18	0.038
8:19	0.049
8:20	0.041
8:21	0.039
8:22	0.042
8:23	0.064
8:24	0.037
8:25	0.035
8:26	0.032
8:27	0.035
8:28	0.037
8:29	0.034
8:30	0.035

8:31	0.036
8:32	0.034
8:33	0.035
8:34	0.036
8:35	0.037
8:36	0.037
8:37	0.037
8:38	0.036
8:39	0.036
8:40	0.036
8:41	0.037
8:42	0.039
8:43	0.041
8:44	0.035
8:45	0.032
8:46	0.033
8:47	0.033
8:48	0.031
8:49	0.031
8:50	0.032
8:51	0.032
8:52	0.032
8:53	0.032
8:54	0.033
8:55	0.034
8:56	0.033
8:57	0.033
8:58	0.031
8:59	0.032
9:00	0.032
9:01	0.031
9:02	0.031
9:03	0.033
9:04	0.033
9:05	0.033
9:06	0.034
9:07	0.034
9:08	0.034
9:09	0.033
9:10	0.033
9:11	0.033
9:12	0.031
9:13	0.029
9:14	0.03

9:15	0.03
9:16	0.025
9:17	0.032
9:18	0.035
9:19	0.03
9:20	0.029
9:21	0.031
9:22	0.031
9:23	0.029
9:24	0.028
9:25	0.029
9:26	0.029
9:27	0.029
9:28	0.029
9:29	0.035
9:30	0.027
9:31	0.025
9:32	0.045
9:33	0.047
9:34	0.018
9:35	0.018
9:36	0.021
9:37	0.019
9:38	0.021
9:39	0.019
9:40	0.016
9:41	0.017
9:42	0.021
9:43	0.019
9:44	0.017
9:45	0.019
9:46	0.018
9:47	0.019
9:48	0.016
9:49	0.016
9:50	0.017
9:51	0.016
9:52	0.017
9:53	0.017
9:54	0.019
9:55	0.018
9:56	0.018
9:57	0.017
9:58	0.017

9:59	0.017
10:00	0.016
10:01	0.017
10:02	0.017
10:03	0.017
10:04	0.017
10:05	0.016
10:06	0.019
10:07	0.019
10:08	0.017
10:09	0.017
10:10	0.017
10:11	0.217
10:12	0.032
10:13	0.039
10:14	0.033
10:15	0.02
10:16	0.015
10:17	0.017
10:18	0.016
10:19	0.017
10:20	0.016
10:21	0.025
10:22	0.015
10:23	0.017
10:24	0.04
10:25	0.04
10:26	0.034
10:27	0.02
10:28	0.024
10:29	0.034
10:30	0.038
10:31	0.018
10:32	0.017
10:33	0.02
10:34	0.02
10:35	0.019
10:36	0.017
10:37	0.017
10:38	0.018
10:39	0.018
10:40	0.019
10:41	0.021
10:42	0.018

10:43	0.02
10:44	0.024
10:45	0.02
10:46	0.018
10:47	0.017
10:48	0.02
10:49	0.021
10:50	0.023
10:51	0.045
10:52	0.063
10:53	0.071
10:54	0.057
10:55	0.037
10:56	0.024
10:57	0.032
10:58	0.046
10:59	0.044
11:00	0.044
11:01	0.044
11:02	0.059
11:03	0.028
11:04	0.025
11:05	0.023
11:06	0.023
11:07	0.024
11:08	0.021
11:09	0.021
11:10	0.022
11:11	0.025
11:12	0.025
11:13	0.026
11:14	0.031
11:15	0.027
11:16	0.024
11:17	0.026
11:18	0.024
11:19	0.024
11:20	0.026
11:21	0.029
11:22	0.029
11:23	0.031
11:24	0.033
11:25	0.044
11:26	0.044

11:27	0.037
11:28	0.036
11:29	0.036
11:30	0.036
11:31	0.037
11:32	0.036
11:33	0.035
11:34	0.037
11:35	0.038
11:36	0.035
11:37	0.036
11:38	0.036
11:39	0.037
11:40	0.05
11:41	0.036
11:42	0.041
11:43	0.039
11:44	0.038
11:45	0.035
11:46	0.034
11:47	0.033
11:48	0.034
11:49	0.039
11:50	0.037
11:51	0.035
11:52	0.035
11:53	0.035
11:54	0.041
11:55	0.036
11:56	0.034
11:57	0.034
11:58	0.035
11:59	0.04
12:00	0.038
12:01	0.037
12:02	0.04
12:03	0.038
12:04	0.041
12:05	0.072
12:06	0.039
12:07	0.041
12:08	0.04
12:09	0.043
12:10	0.038

12:11	0.041
12:12	0.04
12:13	0.038
12:14	0.037
12:15	0.042
12:16	0.037
12:17	0.037
12:18	0.037
12:19	0.034
12:20	0.035
12:21	0.037
12:22	0.031
12:23	0.03
12:24	0.033
12:25	0.032
12:26	0.035
12:27	0.035
12:28	0.033
12:29	0.032
12:30	0.03
12:31	0.029
12:32	0.031
12:33	0.034
12:34	0.042
12:35	0.029
12:36	0.031
12:37	0.033
12:38	0.044
12:39	0.042
12:40	0.052

Device Serial No	Log Time	Log Type	Sensor 1 Type	Sensor 1 Serial Number	Sensor 1 Status	Sensor 1 Gas Reading
592-927198	9/28/2024 12:39	Readings	PID	SC23030235W3	Normal	0
592-927198	9/28/2024 12:38	Readings	PID	SC23030235W3	Normal	0
592-927198	9/28/2024 12:37	Readings	PID	SC23030235W3	Normal	0
592-927198	9/28/2024 12:36	Readings	PID	SC23030235W3	Normal	0
592-927198	9/28/2024 12:35	Readings	PID	SC23030235W3	Normal	0
592-927198	9/28/2024 12:34	Readings	PID	SC23030235W3	Normal	0
592-927198	9/28/2024 12:33	Readings	PID	SC23030235W3	Normal	0
592-927198	9/28/2024 12:32	Readings	PID	SC23030235W3	Normal	0
592-927198	9/28/2024 12:31	Readings	PID	SC23030235W3	Normal	0
592-927198	9/28/2024 12:30	Readings	PID	SC23030235W3	Normal	0
592-927198	9/28/2024 12:29	Readings	PID	SC23030235W3	Normal	0
592-927198	9/28/2024 12:28	Readings	PID	SC23030235W3	Normal	0
592-927198	9/28/2024 12:27	Readings	PID	SC23030235W3	Normal	0
592-927198	9/28/2024 12:26	Readings	PID	SC23030235W3	Normal	0
592-927198	9/28/2024 12:25	Readings	PID	SC23030235W3	Normal	0
592-927198	9/28/2024 12:24	Readings	PID	SC23030235W3	Normal	0
592-927198	9/28/2024 12:23	Readings	PID	SC23030235W3	Normal	0
592-927198	9/28/2024 12:22	Readings	PID	SC23030235W3	Normal	0
592-927198	9/28/2024 12:21	Readings	PID	SC23030235W3	Normal	0
592-927198	9/28/2024 12:20	Readings	PID	SC23030235W3	Normal	0
592-927198	9/28/2024 12:19	Readings	PID	SC23030235W3	Normal	0
592-927198	9/28/2024 12:18	Readings	PID	SC23030235W3	Normal	0
592-927198	9/28/2024 12:17	Readings	PID	SC23030235W3	Normal	0
592-927198	9/28/2024 12:16	Readings	PID	SC23030235W3	Normal	0
592-927198	9/28/2024 12:15	Readings	PID	SC23030235W3	Normal	0
592-927198	9/28/2024 12:14	Readings	PID	SC23030235W3	Normal	0
592-927198	9/28/2024 12:13	Readings	PID	SC23030235W3	Normal	0
592-927198	9/28/2024 12:12	Readings	PID	SC23030235W3	Normal	0
592-927198	9/28/2024 12:11	Readings	PID	SC23030235W3	Normal	0
592-927198	9/28/2024 12:10	Readings	PID	SC23030235W3	Normal	0
592-927198	9/28/2024 12:09	Readings	PID	SC23030235W3	Normal	0
592-927198	9/28/2024 12:08	Readings	PID	SC23030235W3	Normal	0

592-927198	9/28/2024 7:43 Readings	PID	SC23030235W3	Normal	0
592-927198	9/28/2024 7:42 Readings	PID	SC23030235W3	Normal	0
592-927198	9/28/2024 7:41 Readings	PID	SC23030235W3	Normal	0
592-927198	9/28/2024 7:40 Readings	PID	SC23030235W3	Normal	0
592-927198	9/28/2024 7:39 Readings	PID	SC23030235W3	Normal	0
592-927198	9/28/2024 7:38 Readings	PID	SC23030235W3	Normal	0
592-927198	9/28/2024 7:37 Readings	PID	SC23030235W3	Normal	0
592-927198	9/28/2024 7:36 Readings	PID	SC23030235W3	Normal	0
592-927198	9/28/2024 7:35 Readings	PID	SC23030235W3	Normal	0
592-927198	9/28/2024 7:34 Readings	PID	SC23030235W3	Normal	0
592-927198	9/28/2024 7:33 Readings	PID	SC23030235W3	Normal	0
592-927198	9/28/2024 7:32 Readings	PID	SC23030235W3	Normal	0
592-927198	9/28/2024 7:31 Readings	PID	SC23030235W3	Normal	0
592-927198	9/28/2024 7:30 Readings	PID	SC23030235W3	Normal	0
592-927198	9/28/2024 7:29 Readings	PID	SC23030235W3	Normal	0.2
592-927198	9/28/2024 7:28 Readings	PID	SC23030235W3	Normal	0.7
592-927198	9/28/2024 7:27 Readings	PID	SC23030235W3	Normal	0.8
592-927198	9/28/2024 7:26 Readings	PID	SC23030235W3	Normal	0.9
592-927198	9/28/2024 7:25 Readings	PID	SC23030235W3	Normal	0
592-927198	9/28/2024 7:24 CONFIG	PID	SC23030235W3		

DOWNWIND CAMP READINGS

251 DOUGLASS STREET, BROOKLYN, NY



Instrument Name	DustTrak DRX
Model Number	8533
Serial Number	8533181207
Firmware Version	3.1
Calibration Date	7/11/2024
Test Name	MANUAL_001
Test Start Time	6:46:28 AM
Test Start Date	9/28/2024
Test Length [D:H:M]	0:05:09
Test Interval [M:S]	1:00
PM10 Average [mg/m3]	0.011
PM10 Minimum [mg/m3]	0.004
PM10 Maximum [mg/m3]	0.764
PM10 TWA [mg/m3]	0.007
Photometric User Cal	1
Size Correction User Cal	1
Flow User Cal	0
Errors	
Number of Samples	309

Elapsed Time [s]	PM10 [mg/m3]	Alarms	Errors
6:46:28 AM	0.061		
6:47:28 AM	0.005		
6:48:28 AM	0.008		
6:49:28 AM	0.009		
6:50:28 AM	0.005		
6:51:28 AM	0.006		
6:52:28 AM	0.006		
6:53:28 AM	0.005		
6:54:28 AM	0.005		
6:55:28 AM	0.005		
6:56:28 AM	0.005		
6:57:28 AM	0.007		
6:58:28 AM	0.005		
6:59:28 AM	0.009		
7:00:28 AM	0.007		
7:01:28 AM	0.005		
7:02:28 AM	0.006		
7:03:28 AM	0.006		
7:04:28 AM	0.005		
7:05:28 AM	0.006		
7:06:28 AM	0.006		
7:07:28 AM	0.007		
7:08:28 AM	0.006		

7:09:28 AM	0.008
7:10:28 AM	0.006
7:11:28 AM	0.008
7:12:28 AM	0.005
7:13:28 AM	0.005
7:14:28 AM	0.005
7:15:28 AM	0.005
7:16:28 AM	0.005
7:17:28 AM	0.005
7:18:28 AM	0.006
7:19:28 AM	0.048
7:20:28 AM	0.007
7:21:28 AM	0.006
7:22:28 AM	0.006
7:23:28 AM	0.009
7:24:28 AM	0.008
7:25:28 AM	0.01
7:26:28 AM	0.007
7:27:28 AM	0.024
7:28:28 AM	0.016
7:29:28 AM	0.008
7:30:28 AM	0.006
7:31:28 AM	0.007
7:32:28 AM	0.006
7:33:28 AM	0.009
7:34:28 AM	0.007
7:35:28 AM	0.012
7:36:28 AM	0.017
7:37:28 AM	0.008
7:38:28 AM	0.008
7:39:28 AM	0.006
7:40:28 AM	0.007
7:41:28 AM	0.006
7:42:28 AM	0.006
7:43:28 AM	0.764
7:44:28 AM	0.027
7:45:28 AM	0.01
7:46:28 AM	0.009
7:47:28 AM	0.006
7:48:28 AM	0.01
7:49:28 AM	0.008
7:50:28 AM	0.007
7:51:28 AM	0.009
7:52:28 AM	0.006

7:53:28 AM	0.006
7:54:28 AM	0.008
7:55:28 AM	0.007
7:56:28 AM	0.009
7:57:28 AM	0.006
7:58:28 AM	0.007
7:59:28 AM	0.007
8:00:28 AM	0.007
8:01:28 AM	0.006
8:02:28 AM	0.008
8:03:28 AM	0.013
8:04:28 AM	0.01
8:05:28 AM	0.007
8:06:28 AM	0.005
8:07:28 AM	0.006
8:08:28 AM	0.008
8:09:28 AM	0.007
8:10:28 AM	0.008
8:11:28 AM	0.011
8:12:28 AM	0.011
8:13:28 AM	0.007
8:14:28 AM	0.006
8:15:28 AM	0.005
8:16:28 AM	0.005
8:17:28 AM	0.005
8:18:28 AM	0.005
8:19:28 AM	0.006
8:20:28 AM	0.009
8:21:28 AM	0.006
8:22:28 AM	0.005
8:23:28 AM	0.004
8:24:28 AM	0.005
8:25:28 AM	0.005
8:26:28 AM	0.006
8:27:28 AM	0.005
8:28:28 AM	0.004
8:29:28 AM	0.005
8:30:28 AM	0.005
8:31:28 AM	0.006
8:32:28 AM	0.005
8:33:28 AM	0.006
8:34:28 AM	0.005
8:35:28 AM	0.005
8:36:28 AM	0.006

8:37:28 AM	0.005
8:38:28 AM	0.005
8:39:28 AM	0.006
8:40:28 AM	0.006
8:41:28 AM	0.006
8:42:28 AM	0.006
8:43:28 AM	0.008
8:44:28 AM	0.007
8:45:28 AM	0.006
8:46:28 AM	0.006
8:47:28 AM	0.006
8:48:28 AM	0.006
8:49:28 AM	0.005
8:50:28 AM	0.006
8:51:28 AM	0.005
8:52:28 AM	0.006
8:53:28 AM	0.006
8:54:28 AM	0.005
8:55:28 AM	0.005
8:56:28 AM	0.005
8:57:28 AM	0.005
8:58:28 AM	0.006
8:59:28 AM	0.005
9:00:28 AM	0.007
9:01:28 AM	0.007
9:02:28 AM	0.006
9:03:28 AM	0.005
9:04:28 AM	0.006
9:05:28 AM	0.005
9:06:28 AM	0.006
9:07:28 AM	0.005
9:08:28 AM	0.013
9:09:28 AM	0.006
9:10:28 AM	0.006
9:11:28 AM	0.005
9:12:28 AM	0.006
9:13:28 AM	0.007
9:14:28 AM	0.006
9:15:28 AM	0.005
9:16:28 AM	0.005
9:17:28 AM	0.005
9:18:28 AM	0.006
9:19:28 AM	0.006
9:20:28 AM	0.005

9:21:28 AM	0.005
9:22:28 AM	0.005
9:23:28 AM	0.005
9:24:28 AM	0.006
9:25:28 AM	0.009
9:26:28 AM	0.007
9:27:28 AM	0.006
9:28:28 AM	0.006
9:29:28 AM	0.008
9:30:28 AM	0.006
9:31:28 AM	0.007
9:32:28 AM	0.006
9:33:28 AM	0.007
9:34:28 AM	0.007
9:35:28 AM	0.007
9:36:28 AM	0.006
9:37:28 AM	0.007
9:38:28 AM	0.007
9:39:28 AM	0.007
9:40:28 AM	0.007
9:41:28 AM	0.007
9:42:28 AM	0.008
9:43:28 AM	0.017
9:44:28 AM	0.006
9:45:28 AM	0.007
9:46:28 AM	0.009
9:47:28 AM	0.007
9:48:28 AM	0.007
9:49:28 AM	0.007
9:50:28 AM	0.006
9:51:28 AM	0.007
9:52:28 AM	0.006
9:53:28 AM	0.01
9:54:28 AM	0.007
9:55:28 AM	0.007
9:56:28 AM	0.007
9:57:28 AM	0.007
9:58:28 AM	0.007
9:59:28 AM	0.007
10:00:28 AM	0.008
10:01:28 AM	0.007
10:02:28 AM	0.007
10:03:28 AM	0.007
10:04:28 AM	0.007

10:05:28 AM	0.007
10:06:28 AM	0.007
10:07:28 AM	0.007
10:08:28 AM	0.008
10:09:28 AM	0.008
10:10:28 AM	0.008
10:11:28 AM	0.007
10:12:28 AM	0.008
10:13:28 AM	0.007
10:14:28 AM	0.007
10:15:28 AM	0.007
10:16:28 AM	0.008
10:17:28 AM	0.008
10:18:28 AM	0.008
10:19:28 AM	0.009
10:20:28 AM	0.008
10:21:28 AM	0.008
10:22:28 AM	0.008
10:23:28 AM	0.008
10:24:28 AM	0.009
10:25:28 AM	0.008
10:26:28 AM	0.008
10:27:28 AM	0.009
10:28:28 AM	0.008
10:29:28 AM	0.009
10:30:28 AM	0.008
10:31:28 AM	0.008
10:32:28 AM	0.008
10:33:28 AM	0.008
10:34:28 AM	0.009
10:35:28 AM	0.014
10:36:28 AM	0.015
10:37:28 AM	0.01
10:38:28 AM	0.009
10:39:28 AM	0.009
10:40:28 AM	0.009
10:41:28 AM	0.009
10:42:28 AM	0.009
10:43:28 AM	0.009
10:44:28 AM	0.009
10:45:28 AM	0.009
10:46:28 AM	0.009
10:47:28 AM	0.008
10:48:28 AM	0.009

10:49:28 AM	0.01
10:50:28 AM	0.008
10:51:28 AM	0.01
10:52:28 AM	0.009
10:53:28 AM	0.009
10:54:28 AM	0.009
10:55:28 AM	0.01
10:56:28 AM	0.01
10:57:28 AM	0.01
10:58:28 AM	0.01
10:59:28 AM	0.011
11:00:28 AM	0.01
11:01:28 AM	0.009
11:02:28 AM	0.008
11:03:28 AM	0.009
11:04:28 AM	0.008
11:05:28 AM	0.009
11:06:28 AM	0.011
11:07:28 AM	0.013
11:08:28 AM	0.011
11:09:28 AM	0.012
11:10:28 AM	0.045
11:11:28 AM	0.01
11:12:28 AM	0.009
11:13:28 AM	0.01
11:14:28 AM	0.01
11:15:28 AM	0.01
11:16:28 AM	0.009
11:17:28 AM	0.01
11:18:28 AM	0.009
11:19:28 AM	0.01
11:20:28 AM	0.01
11:21:28 AM	0.01
11:22:28 AM	0.011
11:23:28 AM	0.01
11:24:28 AM	0.009
11:25:28 AM	0.009
11:26:28 AM	0.009
11:27:28 AM	0.014
11:28:28 AM	0.01
11:29:28 AM	0.009
11:30:28 AM	0.009
11:31:28 AM	0.009
11:32:28 AM	0.01

11:33:28 AM	0.009
11:34:28 AM	0.01
11:35:28 AM	0.009
11:36:28 AM	0.009
11:37:28 AM	0.01
11:38:28 AM	0.01
11:39:28 AM	0.01
11:40:28 AM	0.009
11:41:28 AM	0.01
11:42:28 AM	0.009
11:43:28 AM	0.011
11:44:28 AM	0.011
11:45:28 AM	0.01
11:46:28 AM	0.01
11:47:28 AM	0.01
11:48:28 AM	0.01
11:49:28 AM	0.01
11:50:28 AM	0.01
11:51:28 AM	0.01
11:52:28 AM	0.009
11:53:28 AM	0.011
11:54:28 AM	0.011

Device Serial No	Log Time	Log Type	Sensor 1 Type	Sensor 1 Serial Number	Sensor 1 Status	Sensor 1 Gas Reading
592-906376	9/28/2024 12:01	Readings	PID	SC23030159V4	Normal	0.3
592-906376	9/28/2024 12:00	Readings	PID	SC23030159V4	Normal	0.3
592-906376	9/28/2024 11:59	Readings	PID	SC23030159V4	Normal	0.3
592-906376	9/28/2024 11:58	Readings	PID	SC23030159V4	Normal	0.3
592-906376	9/28/2024 11:57	Readings	PID	SC23030159V4	Normal	0.3
592-906376	9/28/2024 11:56	Readings	PID	SC23030159V4	Normal	0.3
592-906376	9/28/2024 11:55	Readings	PID	SC23030159V4	Normal	0.4
592-906376	9/28/2024 11:54	Readings	PID	SC23030159V4	Normal	0.3
592-906376	9/28/2024 11:53	Readings	PID	SC23030159V4	Normal	0.3
592-906376	9/28/2024 11:52	Readings	PID	SC23030159V4	Normal	0.3
592-906376	9/28/2024 11:51	Readings	PID	SC23030159V4	Normal	0.3
592-906376	9/28/2024 11:50	Readings	PID	SC23030159V4	Normal	0.3
592-906376	9/28/2024 11:49	Readings	PID	SC23030159V4	Normal	0.3
592-906376	9/28/2024 11:48	Readings	PID	SC23030159V4	Normal	0.3
592-906376	9/28/2024 11:47	Readings	PID	SC23030159V4	Normal	0.4
592-906376	9/28/2024 11:46	Readings	PID	SC23030159V4	Normal	0.4
592-906376	9/28/2024 11:45	Readings	PID	SC23030159V4	Normal	0.3
592-906376	9/28/2024 11:44	Readings	PID	SC23030159V4	Normal	0.3
592-906376	9/28/2024 11:43	Readings	PID	SC23030159V4	Normal	0.3
592-906376	9/28/2024 11:42	Readings	PID	SC23030159V4	Normal	0.3
592-906376	9/28/2024 11:41	Readings	PID	SC23030159V4	Normal	0.3
592-906376	9/28/2024 11:40	Readings	PID	SC23030159V4	Normal	0.3
592-906376	9/28/2024 11:39	Readings	PID	SC23030159V4	Normal	0.3
592-906376	9/28/2024 11:38	Readings	PID	SC23030159V4	Normal	0.3
592-906376	9/28/2024 11:37	Readings	PID	SC23030159V4	Normal	0.3
592-906376	9/28/2024 11:36	Readings	PID	SC23030159V4	Normal	0.3
592-906376	9/28/2024 11:35	Readings	PID	SC23030159V4	Normal	0.3
592-906376	9/28/2024 11:34	Readings	PID	SC23030159V4	Normal	0.3
592-906376	9/28/2024 11:33	Readings	PID	SC23030159V4	Normal	0.3
592-906376	9/28/2024 11:32	Readings	PID	SC23030159V4	Normal	0.3
592-906376	9/28/2024 11:31	Readings	PID	SC23030159V4	Normal	0.3
592-906376	9/28/2024 11:30	Readings	PID	SC23030159V4	Normal	0.4

592-906376	9/28/2024 11:29	Readings	PID	SC23030159V4	Normal	0.3
592-906376	9/28/2024 11:28	Readings	PID	SC23030159V4	Normal	0.3
592-906376	9/28/2024 11:27	Readings	PID	SC23030159V4	Normal	0.4
592-906376	9/28/2024 11:26	Readings	PID	SC23030159V4	Normal	0.3
592-906376	9/28/2024 11:25	Readings	PID	SC23030159V4	Normal	0.3
592-906376	9/28/2024 11:24	Readings	PID	SC23030159V4	Normal	0.4
592-906376	9/28/2024 11:23	Readings	PID	SC23030159V4	Normal	0.3
592-906376	9/28/2024 11:22	Readings	PID	SC23030159V4	Normal	0.3
592-906376	9/28/2024 11:21	Readings	PID	SC23030159V4	Normal	0.3
592-906376	9/28/2024 11:20	Readings	PID	SC23030159V4	Normal	0.4
592-906376	9/28/2024 11:19	Readings	PID	SC23030159V4	Normal	0.3
592-906376	9/28/2024 11:18	Readings	PID	SC23030159V4	Normal	0.3
592-906376	9/28/2024 11:17	Readings	PID	SC23030159V4	Normal	0.3
592-906376	9/28/2024 11:16	Readings	PID	SC23030159V4	Normal	0.3
592-906376	9/28/2024 11:15	Readings	PID	SC23030159V4	Normal	0.3
592-906376	9/28/2024 11:14	Readings	PID	SC23030159V4	Normal	0.5
592-906376	9/28/2024 11:13	Readings	PID	SC23030159V4	Normal	0.3
592-906376	9/28/2024 11:12	Readings	PID	SC23030159V4	Normal	0.3
592-906376	9/28/2024 11:11	Readings	PID	SC23030159V4	Normal	0.4
592-906376	9/28/2024 11:10	Readings	PID	SC23030159V4	Normal	0.3
592-906376	9/28/2024 11:09	Readings	PID	SC23030159V4	Normal	0.3
592-906376	9/28/2024 11:08	Readings	PID	SC23030159V4	Normal	0.4
592-906376	9/28/2024 11:07	Readings	PID	SC23030159V4	Normal	0.4
592-906376	9/28/2024 11:06	Readings	PID	SC23030159V4	Normal	0.3
592-906376	9/28/2024 11:05	Readings	PID	SC23030159V4	Normal	0.3
592-906376	9/28/2024 11:04	Readings	PID	SC23030159V4	Normal	0.3
592-906376	9/28/2024 11:03	Readings	PID	SC23030159V4	Normal	0.4
592-906376	9/28/2024 11:02	Readings	PID	SC23030159V4	Normal	0.4
592-906376	9/28/2024 11:01	Readings	PID	SC23030159V4	Normal	0.3
592-906376	9/28/2024 11:00	Readings	PID	SC23030159V4	Normal	0.4
592-906376	9/28/2024 10:59	Readings	PID	SC23030159V4	Normal	0.3
592-906376	9/28/2024 10:58	Readings	PID	SC23030159V4	Normal	0.3
592-906376	9/28/2024 10:57	Readings	PID	SC23030159V4	Normal	0.3

592-906376	9/28/2024 10:56	Readings	PID	SC23030159V4	Normal	0.3
592-906376	9/28/2024 10:55	Readings	PID	SC23030159V4	Normal	0.3
592-906376	9/28/2024 10:54	Readings	PID	SC23030159V4	Normal	0.3
592-906376	9/28/2024 10:53	Readings	PID	SC23030159V4	Normal	0.4
592-906376	9/28/2024 10:52	Readings	PID	SC23030159V4	Normal	0.3
592-906376	9/28/2024 10:51	Readings	PID	SC23030159V4	Normal	0.3
592-906376	9/28/2024 10:50	Readings	PID	SC23030159V4	Normal	0.4
592-906376	9/28/2024 10:49	Readings	PID	SC23030159V4	Normal	0.4
592-906376	9/28/2024 10:48	Readings	PID	SC23030159V4	Normal	0.4
592-906376	9/28/2024 10:47	Readings	PID	SC23030159V4	Normal	0.4
592-906376	9/28/2024 10:46	Readings	PID	SC23030159V4	Normal	0.3
592-906376	9/28/2024 10:45	Readings	PID	SC23030159V4	Normal	0.4
592-906376	9/28/2024 10:44	Readings	PID	SC23030159V4	Normal	0.4
592-906376	9/28/2024 10:43	Readings	PID	SC23030159V4	Normal	0.3
592-906376	9/28/2024 10:42	Readings	PID	SC23030159V4	Normal	0.3
592-906376	9/28/2024 10:41	Readings	PID	SC23030159V4	Normal	0.3
592-906376	9/28/2024 10:40	Readings	PID	SC23030159V4	Normal	0.3
592-906376	9/28/2024 10:39	Readings	PID	SC23030159V4	Normal	0.3
592-906376	9/28/2024 10:38	Readings	PID	SC23030159V4	Normal	0.4
592-906376	9/28/2024 10:37	Readings	PID	SC23030159V4	Normal	0.3
592-906376	9/28/2024 10:36	Readings	PID	SC23030159V4	Normal	0.4
592-906376	9/28/2024 10:35	Readings	PID	SC23030159V4	Normal	0.3
592-906376	9/28/2024 10:34	Readings	PID	SC23030159V4	Normal	0.3
592-906376	9/28/2024 10:33	Readings	PID	SC23030159V4	Normal	0.3
592-906376	9/28/2024 10:32	Readings	PID	SC23030159V4	Normal	0.3
592-906376	9/28/2024 10:31	Readings	PID	SC23030159V4	Normal	0.4
592-906376	9/28/2024 10:30	Readings	PID	SC23030159V4	Normal	0.3
592-906376	9/28/2024 10:29	Readings	PID	SC23030159V4	Normal	0.4
592-906376	9/28/2024 10:28	Readings	PID	SC23030159V4	Normal	0.4
592-906376	9/28/2024 10:27	Readings	PID	SC23030159V4	Normal	0.4
592-906376	9/28/2024 10:26	Readings	PID	SC23030159V4	Normal	0.3
592-906376	9/28/2024 10:25	Readings	PID	SC23030159V4	Normal	0.3
592-906376	9/28/2024 10:24	Readings	PID	SC23030159V4	Normal	0.3

592-906376	9/28/2024 10:23	Readings	PID	SC23030159V4	Normal	0.3
592-906376	9/28/2024 10:22	Readings	PID	SC23030159V4	Normal	0.3
592-906376	9/28/2024 10:21	Readings	PID	SC23030159V4	Normal	0.4
592-906376	9/28/2024 10:20	Readings	PID	SC23030159V4	Normal	0.2
592-906376	9/28/2024 10:19	Readings	PID	SC23030159V4	Normal	0.3
592-906376	9/28/2024 10:18	Readings	PID	SC23030159V4	Normal	0.3
592-906376	9/28/2024 10:17	Readings	PID	SC23030159V4	Normal	0.3
592-906376	9/28/2024 10:16	Readings	PID	SC23030159V4	Normal	0.3
592-906376	9/28/2024 10:15	Readings	PID	SC23030159V4	Normal	0.5
592-906376	9/28/2024 10:14	Readings	PID	SC23030159V4	Normal	0.3
592-906376	9/28/2024 10:13	Readings	PID	SC23030159V4	Normal	0.4
592-906376	9/28/2024 10:12	Readings	PID	SC23030159V4	Normal	0.3
592-906376	9/28/2024 10:11	Readings	PID	SC23030159V4	Normal	0.3
592-906376	9/28/2024 10:10	Readings	PID	SC23030159V4	Normal	0.3
592-906376	9/28/2024 10:09	Readings	PID	SC23030159V4	Normal	0.2
592-906376	9/28/2024 10:08	Readings	PID	SC23030159V4	Normal	0.3
592-906376	9/28/2024 10:07	Readings	PID	SC23030159V4	Normal	0.4
592-906376	9/28/2024 10:06	Readings	PID	SC23030159V4	Normal	0.3
592-906376	9/28/2024 10:05	Readings	PID	SC23030159V4	Normal	0.3
592-906376	9/28/2024 10:04	Readings	PID	SC23030159V4	Normal	0.3
592-906376	9/28/2024 10:03	Readings	PID	SC23030159V4	Normal	0.3
592-906376	9/28/2024 10:02	Readings	PID	SC23030159V4	Normal	0.3
592-906376	9/28/2024 10:01	Readings	PID	SC23030159V4	Normal	0.3
592-906376	9/28/2024 10:00	Readings	PID	SC23030159V4	Normal	0.2
592-906376	9/28/2024 9:59	Readings	PID	SC23030159V4	Normal	0.3
592-906376	9/28/2024 9:58	Readings	PID	SC23030159V4	Normal	0.3
592-906376	9/28/2024 9:57	Readings	PID	SC23030159V4	Normal	0.3
592-906376	9/28/2024 9:56	Readings	PID	SC23030159V4	Normal	0.2
592-906376	9/28/2024 9:55	Readings	PID	SC23030159V4	Normal	0.3
592-906376	9/28/2024 9:54	Readings	PID	SC23030159V4	Normal	0.3
592-906376	9/28/2024 9:53	Readings	PID	SC23030159V4	Normal	0.6
592-906376	9/28/2024 9:52	Readings	PID	SC23030159V4	Normal	0.2
592-906376	9/28/2024 9:51	Readings	PID	SC23030159V4	Normal	0.2

592-906376	9/28/2024 9:50	Readings	PID	SC23030159V4	Normal	0.2
592-906376	9/28/2024 9:49	Readings	PID	SC23030159V4	Normal	0.5
592-906376	9/28/2024 9:48	Readings	PID	SC23030159V4	Normal	0.3
592-906376	9/28/2024 9:47	Readings	PID	SC23030159V4	Normal	0.3
592-906376	9/28/2024 9:46	Readings	PID	SC23030159V4	Normal	0.4
592-906376	9/28/2024 9:45	Readings	PID	SC23030159V4	Normal	0.3
592-906376	9/28/2024 9:44	Readings	PID	SC23030159V4	Normal	0.3
592-906376	9/28/2024 9:43	Readings	PID	SC23030159V4	Normal	0.4
592-906376	9/28/2024 9:42	Readings	PID	SC23030159V4	Normal	0.3
592-906376	9/28/2024 9:41	Readings	PID	SC23030159V4	Normal	0.3
592-906376	9/28/2024 9:40	Readings	PID	SC23030159V4	Normal	0.4
592-906376	9/28/2024 9:39	Readings	PID	SC23030159V4	Normal	0.4
592-906376	9/28/2024 9:38	Readings	PID	SC23030159V4	Normal	0.4
592-906376	9/28/2024 9:37	Readings	PID	SC23030159V4	Normal	0.2
592-906376	9/28/2024 9:36	Readings	PID	SC23030159V4	Normal	0.3
592-906376	9/28/2024 9:35	Readings	PID	SC23030159V4	Normal	0.3
592-906376	9/28/2024 9:34	Readings	PID	SC23030159V4	Normal	0.2
592-906376	9/28/2024 9:33	Readings	PID	SC23030159V4	Normal	0.3
592-906376	9/28/2024 9:32	Readings	PID	SC23030159V4	Normal	0.4
592-906376	9/28/2024 9:31	Readings	PID	SC23030159V4	Normal	0.5
592-906376	9/28/2024 9:30	Readings	PID	SC23030159V4	Normal	0.3
592-906376	9/28/2024 9:29	Readings	PID	SC23030159V4	Normal	0.2
592-906376	9/28/2024 9:28	Readings	PID	SC23030159V4	Normal	0.2
592-906376	9/28/2024 9:27	Readings	PID	SC23030159V4	Normal	0.3
592-906376	9/28/2024 9:26	Readings	PID	SC23030159V4	Normal	0.4
592-906376	9/28/2024 9:25	Readings	PID	SC23030159V4	Normal	0.2
592-906376	9/28/2024 9:24	Readings	PID	SC23030159V4	Normal	0.2
592-906376	9/28/2024 9:23	Readings	PID	SC23030159V4	Normal	0.3
592-906376	9/28/2024 9:22	Readings	PID	SC23030159V4	Normal	0.4
592-906376	9/28/2024 9:21	Readings	PID	SC23030159V4	Normal	0.4
592-906376	9/28/2024 9:20	Readings	PID	SC23030159V4	Normal	0.4
592-906376	9/28/2024 9:19	Readings	PID	SC23030159V4	Normal	0.3
592-906376	9/28/2024 9:18	Readings	PID	SC23030159V4	Normal	0.4

592-906376	9/28/2024 9:17	Readings	PID	SC23030159V4	Normal	0.3
592-906376	9/28/2024 9:16	Readings	PID	SC23030159V4	Normal	0.4
592-906376	9/28/2024 9:15	Readings	PID	SC23030159V4	Normal	0.2
592-906376	9/28/2024 9:14	Readings	PID	SC23030159V4	Normal	0.3
592-906376	9/28/2024 9:13	Readings	PID	SC23030159V4	Normal	0.5
592-906376	9/28/2024 9:12	Readings	PID	SC23030159V4	Normal	0.4
592-906376	9/28/2024 9:11	Readings	PID	SC23030159V4	Normal	0.3
592-906376	9/28/2024 9:10	Readings	PID	SC23030159V4	Normal	0.4
592-906376	9/28/2024 9:09	Readings	PID	SC23030159V4	Normal	0.6
592-906376	9/28/2024 9:08	Readings	PID	SC23030159V4	Normal	0.3
592-906376	9/28/2024 9:07	Readings	PID	SC23030159V4	Normal	0.4
592-906376	9/28/2024 9:06	Readings	PID	SC23030159V4	Normal	0.8
592-906376	9/28/2024 9:05	Readings	PID	SC23030159V4	Normal	0.5
592-906376	9/28/2024 9:04	Readings	PID	SC23030159V4	Normal	0.4
592-906376	9/28/2024 9:03	Readings	PID	SC23030159V4	Normal	0.4
592-906376	9/28/2024 9:02	Readings	PID	SC23030159V4	Normal	0.4
592-906376	9/28/2024 9:01	Readings	PID	SC23030159V4	Normal	0.4
592-906376	9/28/2024 9:00	Readings	PID	SC23030159V4	Normal	0.3
592-906376	9/28/2024 8:59	Readings	PID	SC23030159V4	Normal	0.9
592-906376	9/28/2024 8:58	Readings	PID	SC23030159V4	Normal	0.6
592-906376	9/28/2024 8:57	Readings	PID	SC23030159V4	Normal	0.4
592-906376	9/28/2024 8:56	Readings	PID	SC23030159V4	Normal	0.8
592-906376	9/28/2024 8:55	Readings	PID	SC23030159V4	Normal	0.3
592-906376	9/28/2024 8:54	Readings	PID	SC23030159V4	Normal	0.5
592-906376	9/28/2024 8:53	Readings	PID	SC23030159V4	Normal	0.3
592-906376	9/28/2024 8:52	Readings	PID	SC23030159V4	Normal	0.7
592-906376	9/28/2024 8:51	Readings	PID	SC23030159V4	Normal	0.5
592-906376	9/28/2024 8:50	Readings	PID	SC23030159V4	Normal	1.4
592-906376	9/28/2024 8:49	Readings	PID	SC23030159V4	Normal	1.3
592-906376	9/28/2024 8:48	Readings	PID	SC23030159V4	Normal	0.6
592-906376	9/28/2024 8:47	Readings	PID	SC23030159V4	Normal	0.8
592-906376	9/28/2024 8:46	Readings	PID	SC23030159V4	Normal	0.9
592-906376	9/28/2024 8:45	Readings	PID	SC23030159V4	Normal	0.3

592-906376	9/28/2024 8:44	Readings	PID	SC23030159V4	Normal	0.3
592-906376	9/28/2024 8:43	Readings	PID	SC23030159V4	Normal	0.6
592-906376	9/28/2024 8:42	Readings	PID	SC23030159V4	Normal	0.4
592-906376	9/28/2024 8:41	Readings	PID	SC23030159V4	Normal	0.4
592-906376	9/28/2024 8:40	Readings	PID	SC23030159V4	Normal	2.2
592-906376	9/28/2024 8:39	Readings	PID	SC23030159V4	Normal	0.3
592-906376	9/28/2024 8:38	Readings	PID	SC23030159V4	Normal	0.5
592-906376	9/28/2024 8:37	Readings	PID	SC23030159V4	Normal	0.5
592-906376	9/28/2024 8:36	Readings	PID	SC23030159V4	Normal	0.4
592-906376	9/28/2024 8:35	Readings	PID	SC23030159V4	Normal	0.7
592-906376	9/28/2024 8:34	Readings	PID	SC23030159V4	Normal	0.6
592-906376	9/28/2024 8:33	Readings	PID	SC23030159V4	Normal	0.4
592-906376	9/28/2024 8:32	Readings	PID	SC23030159V4	Normal	0.3
592-906376	9/28/2024 8:31	Readings	PID	SC23030159V4	Normal	0.8
592-906376	9/28/2024 8:30	Readings	PID	SC23030159V4	Normal	0.8
592-906376	9/28/2024 8:29	Readings	PID	SC23030159V4	Normal	0.3
592-906376	9/28/2024 8:28	Readings	PID	SC23030159V4	Normal	0.4
592-906376	9/28/2024 8:27	Readings	PID	SC23030159V4	Normal	0.8
592-906376	9/28/2024 8:26	Readings	PID	SC23030159V4	Normal	0.7
592-906376	9/28/2024 8:25	Readings	PID	SC23030159V4	Normal	0.5
592-906376	9/28/2024 8:24	Readings	PID	SC23030159V4	Normal	1.1
592-906376	9/28/2024 8:23	Readings	PID	SC23030159V4	Normal	1.4
592-906376	9/28/2024 8:22	Readings	PID	SC23030159V4	Normal	0.8
592-906376	9/28/2024 8:21	Readings	PID	SC23030159V4	Normal	0.6
592-906376	9/28/2024 8:20	Readings	PID	SC23030159V4	Normal	3.3
592-906376	9/28/2024 8:19	Readings	PID	SC23030159V4	Normal	1.3
592-906376	9/28/2024 8:18	Readings	PID	SC23030159V4	Normal	0.6
592-906376	9/28/2024 8:17	Readings	PID	SC23030159V4	Normal	0.7
592-906376	9/28/2024 8:16	Readings	PID	SC23030159V4	Normal	0.4
592-906376	9/28/2024 8:15	Readings	PID	SC23030159V4	Normal	1.2
592-906376	9/28/2024 8:14	Readings	PID	SC23030159V4	Normal	0.6
592-906376	9/28/2024 8:13	Readings	PID	SC23030159V4	Normal	1.3
592-906376	9/28/2024 8:12	Readings	PID	SC23030159V4	Normal	1.3

592-906376	9/28/2024 8:11	Readings	PID	SC23030159V4	Normal	0.8
592-906376	9/28/2024 8:10	Readings	PID	SC23030159V4	Normal	0.8
592-906376	9/28/2024 8:09	Readings	PID	SC23030159V4	Normal	2.3
592-906376	9/28/2024 8:08	Readings	PID	SC23030159V4	Normal	1
592-906376	9/28/2024 8:07	Readings	PID	SC23030159V4	Normal	2
592-906376	9/28/2024 8:06	Readings	PID	SC23030159V4	Normal	1.2
592-906376	9/28/2024 8:05	Readings	PID	SC23030159V4	Normal	2.2
592-906376	9/28/2024 8:04	Readings	PID	SC23030159V4	Normal	0.3
592-906376	9/28/2024 8:03	Readings	PID	SC23030159V4	Normal	1.1
592-906376	9/28/2024 8:02	Readings	PID	SC23030159V4	Normal	0.7
592-906376	9/28/2024 8:01	Readings	PID	SC23030159V4	Normal	1.9
592-906376	9/28/2024 8:00	Readings	PID	SC23030159V4	Normal	0.7
592-906376	9/28/2024 7:59	Readings	PID	SC23030159V4	Normal	0.7
592-906376	9/28/2024 7:58	Readings	PID	SC23030159V4	Normal	3.8
592-906376	9/28/2024 7:57	Readings	PID	SC23030159V4	Normal	0.6
592-906376	9/28/2024 7:56	Readings	PID	SC23030159V4	Normal	2.1
592-906376	9/28/2024 7:55	Readings	PID	SC23030159V4	Normal	1.9
592-906376	9/28/2024 7:54	Readings	PID	SC23030159V4	Normal	2.4
592-906376	9/28/2024 7:53	Readings	PID	SC23030159V4	Normal	0.8
592-906376	9/28/2024 7:52	Readings	PID	SC23030159V4	Normal	0.4
592-906376	9/28/2024 7:51	Readings	PID	SC23030159V4	Normal	3
592-906376	9/28/2024 7:50	Readings	PID	SC23030159V4	Normal	1.3
592-906376	9/28/2024 7:49	Readings	PID	SC23030159V4	Normal	0.4
592-906376	9/28/2024 7:48	Readings	PID	SC23030159V4	Normal	1
592-906376	9/28/2024 7:47	Readings	PID	SC23030159V4	Normal	0.4
592-906376	9/28/2024 7:46	Readings	PID	SC23030159V4	Normal	0.3
592-906376	9/28/2024 7:45	Readings	PID	SC23030159V4	Normal	0.4
592-906376	9/28/2024 7:44	Readings	PID	SC23030159V4	Normal	0.5
592-906376	9/28/2024 7:43	Readings	PID	SC23030159V4	Normal	0.5
592-906376	9/28/2024 7:42	Readings	PID	SC23030159V4	Normal	0.8
592-906376	9/28/2024 7:41	Readings	PID	SC23030159V4	Normal	0.6
592-906376	9/28/2024 7:40	Readings	PID	SC23030159V4	Normal	0.7
592-906376	9/28/2024 7:39	Readings	PID	SC23030159V4	Normal	0.2

592-906376	9/28/2024 7:38	Readings	PID	SC23030159V4	Normal	0.9
592-906376	9/28/2024 7:37	Readings	PID	SC23030159V4	Normal	0.3
592-906376	9/28/2024 7:36	Readings	PID	SC23030159V4	Normal	0.3
592-906376	9/28/2024 7:35	Readings	PID	SC23030159V4	Normal	0.7
592-906376	9/28/2024 7:34	Readings	PID	SC23030159V4	Normal	0.3
592-906376	9/28/2024 7:33	Readings	PID	SC23030159V4	Normal	0.2
592-906376	9/28/2024 7:32	Readings	PID	SC23030159V4	Normal	0.3
592-906376	9/28/2024 7:31	Readings	PID	SC23030159V4	Normal	0.5
592-906376	9/28/2024 7:30	Readings	PID	SC23030159V4	Normal	0.4
592-906376	9/28/2024 7:29	Readings	PID	SC23030159V4	Normal	1.2
592-906376	9/28/2024 7:28	Readings	PID	SC23030159V4	Normal	0.3
592-906376	9/28/2024 7:27	Readings	PID	SC23030159V4	Normal	0.2
592-906376	9/28/2024 7:26	Readings	PID	SC23030159V4	Normal	1.8
592-906376	9/28/2024 7:25	Readings	PID	SC23030159V4	Normal	0.2
592-906376	9/28/2024 7:24	Readings	PID	SC23030159V4	Normal	0.1
592-906376	9/28/2024 7:23	Readings	PID	SC23030159V4	Normal	0.1
592-906376	9/28/2024 7:22	Readings	PID	SC23030159V4	Normal	0.8
592-906376	9/28/2024 7:21	Readings	PID	SC23030159V4	Normal	0.3
592-906376	9/28/2024 7:20	Readings	PID	SC23030159V4	Normal	0.1
592-906376	9/28/2024 7:19	Readings	PID	SC23030159V4	Normal	0.1
592-906376	9/28/2024 7:18	Readings	PID	SC23030159V4	Normal	0.1
592-906376	9/28/2024 7:17	Readings	PID	SC23030159V4	Normal	0.1
592-906376	9/28/2024 7:16	Readings	PID	SC23030159V4	Normal	0.2
592-906376	9/28/2024 7:15	Readings	PID	SC23030159V4	Normal	0.6
592-906376	9/28/2024 7:14	Readings	PID	SC23030159V4	Normal	0.3
592-906376	9/28/2024 7:13	Readings	PID	SC23030159V4	Normal	0.4
592-906376	9/28/2024 7:12	Readings	PID	SC23030159V4	Normal	1
592-906376	9/28/2024 7:11	Readings	PID	SC23030159V4	Normal	0.5
592-906376	9/28/2024 7:10	Readings	PID	SC23030159V4	Normal	0.1
592-906376	9/28/2024 7:09	Readings	PID	SC23030159V4	Normal	0.1
592-906376	9/28/2024 7:08	Readings	PID	SC23030159V4	Normal	0.1
592-906376	9/28/2024 7:07	Readings	PID	SC23030159V4	Normal	0
592-906376	9/28/2024 7:06	Readings	PID	SC23030159V4	Normal	0.2

592-906376	9/28/2024 7:05 Readings	PID	SC23030159V4	Normal	0
592-906376	9/28/2024 7:04 Readings	PID	SC23030159V4	Normal	0.1
592-906376	9/28/2024 7:03 Readings	PID	SC23030159V4	Normal	0.1
592-906376	9/28/2024 7:02 Readings	PID	SC23030159V4	Normal	0.1
592-906376	9/28/2024 7:01 Readings	PID	SC23030159V4	Normal	0
592-906376	9/28/2024 7:00 Readings	PID	SC23030159V4	Normal	0.4
592-906376	9/28/2024 6:59 Readings	PID	SC23030159V4	Normal	0.1
592-906376	9/28/2024 6:58 Readings	PID	SC23030159V4	Normal	0.1
592-906376	9/28/2024 6:57 Readings	PID	SC23030159V4	Normal	0.2
592-906376	9/28/2024 6:56 Readings	PID	SC23030159V4	Normal	0
592-906376	9/28/2024 6:55 Readings	PID	SC23030159V4	Normal	0
592-906376	9/28/2024 6:54 Readings	PID	SC23030159V4	Normal	0.2
592-906376	9/28/2024 6:53 Readings	PID	SC23030159V4	Normal	0
592-906376	9/28/2024 6:52 Readings	PID	SC23030159V4	Normal	0
592-906376	9/28/2024 6:51 Readings	PID	SC23030159V4	Normal	0.2
592-906376	9/28/2024 6:50 Readings	PID	SC23030159V4	Normal	0.2
592-906376	9/28/2024 6:49 Readings	PID	SC23030159V4	Normal	0.1
592-906376	9/28/2024 6:48 Readings	PID	SC23030159V4	Normal	0.1
592-906376	9/28/2024 6:47 Readings	PID	SC23030159V4	Normal	0.1
592-906376	9/28/2024 6:46 Readings	PID	SC23030159V4	Normal	0.1
592-906376	9/28/2024 6:45 Readings	PID	SC23030159V4	Normal	0.1
592-906376	9/28/2024 6:44 Readings	PID	SC23030159V4	Normal	0.1
592-906376	9/28/2024 6:43 Readings	PID	SC23030159V4	Normal	0
592-906376	9/28/2024 6:42 CONFIG	PID	SC23030159V4		
592-906376	9/28/2024 6:40 Readings	PID	SC23030159V4	Normal	0
592-906376	9/28/2024 6:39 CONFIG	PID	SC23030159V4		

Instrument Name	DustTrak II
Model Number	8530
Serial Number	8530154916
Firmware Version	3.1
Calibration Date	8/2/2024
Test Name	MANUAL_001
Test Start Time	6:43:50 AM
Test Start Date	9/28/2024
Test Length [D:H:M]	0:05:12
Test Interval [M:S]	1:00
Mass Average [mg/m3]	0.019
Mass Minimum [mg/m3]	0.008
Mass Maximum [mg/m3]	0.399
Mass TWA [mg/m3]	0.012
Photometric User Cal	1
Flow User Cal	0
Errors	
Number of Samples	312

Elapsed Time [s]	Mass [mg/m3]	Alarms	Errors
6:43:50 AM	0.152		
6:44:50 AM	0.009		
6:45:50 AM	0.01		
6:46:50 AM	0.011		
6:47:50 AM	0.015		
6:48:50 AM	0.011		
6:49:50 AM	0.01		
6:50:50 AM	0.009		
6:51:50 AM	0.01		
6:52:50 AM	0.009		
6:53:50 AM	0.018		
6:54:50 AM	0.017		
6:55:50 AM	0.01		
6:56:50 AM	0.009		
6:57:50 AM	0.008		
6:58:50 AM	0.008		
6:59:50 AM	0.016		
7:00:50 AM	0.009		
7:01:50 AM	0.009		
7:02:50 AM	0.021		
7:03:50 AM	0.022		
7:04:50 AM	0.018		
7:05:50 AM	0.018		
7:06:50 AM	0.014		

7:07:50 AM	0.02
7:08:50 AM	0.019
7:09:50 AM	0.013
7:10:50 AM	0.014
7:11:50 AM	0.028
7:12:50 AM	0.023
7:13:50 AM	0.018
7:14:50 AM	0.015
7:15:50 AM	0.014
7:16:50 AM	0.016
7:17:50 AM	0.025
7:18:50 AM	0.016
7:19:50 AM	0.011
7:20:50 AM	0.014
7:21:50 AM	0.013
7:22:50 AM	0.018
7:23:50 AM	0.013
7:24:50 AM	0.019
7:25:50 AM	0.009
7:26:50 AM	0.014
7:27:50 AM	0.04
7:28:50 AM	0.022
7:29:50 AM	0.013
7:30:50 AM	0.014
7:31:50 AM	0.011
7:32:50 AM	0.01
7:33:50 AM	0.013
7:34:50 AM	0.021
7:35:50 AM	0.028
7:36:50 AM	0.012
7:37:50 AM	0.013
7:38:50 AM	0.017
7:39:50 AM	0.016
7:40:50 AM	0.017
7:41:50 AM	0.013
7:42:50 AM	0.015
7:43:50 AM	0.025
7:44:50 AM	0.024
7:45:50 AM	0.015
7:46:50 AM	0.016
7:47:50 AM	0.016
7:48:50 AM	0.018
7:49:50 AM	0.013
7:50:50 AM	0.037

7:51:50 AM	0.025
7:52:50 AM	0.026
7:53:50 AM	0.026
7:54:50 AM	0.013
7:55:50 AM	0.012
7:56:50 AM	0.016
7:57:50 AM	0.018
7:58:50 AM	0.019
7:59:50 AM	0.02
8:00:50 AM	0.014
8:01:50 AM	0.019
8:02:50 AM	0.035
8:03:50 AM	0.017
8:04:50 AM	0.022
8:05:50 AM	0.02
8:06:50 AM	0.013
8:07:50 AM	0.012
8:08:50 AM	0.012
8:09:50 AM	0.013
8:10:50 AM	0.024
8:11:50 AM	0.013
8:12:50 AM	0.034
8:13:50 AM	0.027
8:14:50 AM	0.022
8:15:50 AM	0.014
8:16:50 AM	0.013
8:17:50 AM	0.013
8:18:50 AM	0.011
8:19:50 AM	0.014
8:20:50 AM	0.01
8:21:50 AM	0.01
8:22:50 AM	0.009
8:23:50 AM	0.012
8:24:50 AM	0.014
8:25:50 AM	0.012
8:26:50 AM	0.011
8:27:50 AM	0.01
8:28:50 AM	0.012
8:29:50 AM	0.01
8:30:50 AM	0.016
8:31:50 AM	0.01
8:32:50 AM	0.009
8:33:50 AM	0.012
8:34:50 AM	0.011

8:35:50 AM	0.009
8:36:50 AM	0.011
8:37:50 AM	0.009
8:38:50 AM	0.009
8:39:50 AM	0.012
8:40:50 AM	0.01
8:41:50 AM	0.011
8:42:50 AM	0.011
8:43:50 AM	0.01
8:44:50 AM	0.01
8:45:50 AM	0.011
8:46:50 AM	0.011
8:47:50 AM	0.011
8:48:50 AM	0.011
8:49:50 AM	0.012
8:50:50 AM	0.012
8:51:50 AM	0.014
8:52:50 AM	0.015
8:53:50 AM	0.011
8:54:50 AM	0.015
8:55:50 AM	0.019
8:56:50 AM	0.013
8:57:50 AM	0.014
8:58:50 AM	0.015
8:59:50 AM	0.013
9:00:50 AM	0.011
9:01:50 AM	0.021
9:02:50 AM	0.022
9:03:50 AM	0.015
9:04:50 AM	0.019
9:05:50 AM	0.021
9:06:50 AM	0.015
9:07:50 AM	0.018
9:08:50 AM	0.019
9:09:50 AM	0.012
9:10:50 AM	0.014
9:11:50 AM	0.012
9:12:50 AM	0.013
9:13:50 AM	0.011
9:14:50 AM	0.011
9:15:50 AM	0.01
9:16:50 AM	0.01
9:17:50 AM	0.01
9:18:50 AM	0.01

9:19:50 AM	0.01
9:20:50 AM	0.011
9:21:50 AM	0.01
9:22:50 AM	0.01
9:23:50 AM	0.011
9:24:50 AM	0.011
9:25:50 AM	0.012
9:26:50 AM	0.012
9:27:50 AM	0.011
9:28:50 AM	0.012
9:29:50 AM	0.012
9:30:50 AM	0.013
9:31:50 AM	0.017
9:32:50 AM	0.02
9:33:50 AM	0.017
9:34:50 AM	0.014
9:35:50 AM	0.013
9:36:50 AM	0.013
9:37:50 AM	0.012
9:38:50 AM	0.013
9:39:50 AM	0.017
9:40:50 AM	0.015
9:41:50 AM	0.014
9:42:50 AM	0.015
9:43:50 AM	0.013
9:44:50 AM	0.012
9:45:50 AM	0.012
9:46:50 AM	0.02
9:47:50 AM	0.014
9:48:50 AM	0.015
9:49:50 AM	0.014
9:50:50 AM	0.013
9:51:50 AM	0.012
9:52:50 AM	0.012
9:53:50 AM	0.016
9:54:50 AM	0.013
9:55:50 AM	0.013
9:56:50 AM	0.012
9:57:50 AM	0.013
9:58:50 AM	0.014
9:59:50 AM	0.014
10:00:50 AM	0.014
10:01:50 AM	0.013
10:02:50 AM	0.013

10:03:50 AM	0.013
10:04:50 AM	0.013
10:05:50 AM	0.013
10:06:50 AM	0.014
10:07:50 AM	0.013
10:08:50 AM	0.014
10:09:50 AM	0.014
10:10:50 AM	0.014
10:11:50 AM	0.014
10:12:50 AM	0.014
10:13:50 AM	0.013
10:14:50 AM	0.014
10:15:50 AM	0.014
10:16:50 AM	0.014
10:17:50 AM	0.014
10:18:50 AM	0.014
10:19:50 AM	0.015
10:20:50 AM	0.015
10:21:50 AM	0.015
10:22:50 AM	0.015
10:23:50 AM	0.014
10:24:50 AM	0.016
10:25:50 AM	0.015
10:26:50 AM	0.015
10:27:50 AM	0.015
10:28:50 AM	0.015
10:29:50 AM	0.015
10:30:50 AM	0.015
10:31:50 AM	0.015
10:32:50 AM	0.015
10:33:50 AM	0.017
10:34:50 AM	0.016
10:35:50 AM	0.024
10:36:50 AM	0.023
10:37:50 AM	0.017
10:38:50 AM	0.018
10:39:50 AM	0.016
10:40:50 AM	0.015
10:41:50 AM	0.016
10:42:50 AM	0.016
10:43:50 AM	0.016
10:44:50 AM	0.015
10:45:50 AM	0.015
10:46:50 AM	0.016

10:47:50 AM	0.016
10:48:50 AM	0.016
10:49:50 AM	0.017
10:50:50 AM	0.016
10:51:50 AM	0.018
10:52:50 AM	0.016
10:53:50 AM	0.016
10:54:50 AM	0.02
10:55:50 AM	0.032
10:56:50 AM	0.023
10:57:50 AM	0.02
10:58:50 AM	0.02
10:59:50 AM	0.399
11:00:50 AM	0.019
11:01:50 AM	0.016
11:02:50 AM	0.015
11:03:50 AM	0.016
11:04:50 AM	0.016
11:05:50 AM	0.02
11:06:50 AM	0.018
11:07:50 AM	0.019
11:08:50 AM	0.019
11:09:50 AM	0.028
11:10:50 AM	0.02
11:11:50 AM	0.017
11:12:50 AM	0.041
11:13:50 AM	0.018
11:14:50 AM	0.018
11:15:50 AM	0.018
11:16:50 AM	0.016
11:17:50 AM	0.018
11:18:50 AM	0.017
11:19:50 AM	0.02
11:20:50 AM	0.06
11:21:50 AM	0.029
11:22:50 AM	0.019
11:23:50 AM	0.017
11:24:50 AM	0.017
11:25:50 AM	0.016
11:26:50 AM	0.017
11:27:50 AM	0.017
11:28:50 AM	0.016
11:29:50 AM	0.016
11:30:50 AM	0.016

11:31:50 AM	0.016
11:32:50 AM	0.017
11:33:50 AM	0.016
11:34:50 AM	0.016
11:35:50 AM	0.017
11:36:50 AM	0.017
11:37:50 AM	0.017
11:38:50 AM	0.017
11:39:50 AM	0.018
11:40:50 AM	0.016
11:41:50 AM	0.017
11:42:50 AM	0.016
11:43:50 AM	0.018
11:44:50 AM	0.02
11:45:50 AM	0.017
11:46:50 AM	0.017
11:47:50 AM	0.017
11:48:50 AM	0.017
11:49:50 AM	0.02
11:50:50 AM	0.165
11:51:50 AM	0.172
11:52:50 AM	0.204
11:53:50 AM	0.022
11:54:50 AM	0.033

Device Serial No	Log Time	Log Type	Sensor 1 Type	Sensor 1 Serial Number	Sensor 1 Status	Sensor 1 Gas Reading
592-906020	9/28/2024 12:02	Readings	PID	SC23030396CB	Normal	0
592-906020	9/28/2024 12:01	Readings	PID	SC23030396CB	Normal	0
592-906020	9/28/2024 12:00	Readings	PID	SC23030396CB	Normal	0
592-906020	9/28/2024 11:59	Readings	PID	SC23030396CB	Normal	0
592-906020	9/28/2024 11:58	Readings	PID	SC23030396CB	Normal	0
592-906020	9/28/2024 11:57	Readings	PID	SC23030396CB	Normal	0
592-906020	9/28/2024 11:56	Readings	PID	SC23030396CB	Normal	0
592-906020	9/28/2024 11:55	Readings	PID	SC23030396CB	Normal	0
592-906020	9/28/2024 11:54	Readings	PID	SC23030396CB	Normal	0
592-906020	9/28/2024 11:53	Readings	PID	SC23030396CB	Normal	0
592-906020	9/28/2024 11:52	Readings	PID	SC23030396CB	Normal	0
592-906020	9/28/2024 11:51	Readings	PID	SC23030396CB	Normal	0
592-906020	9/28/2024 11:50	Readings	PID	SC23030396CB	Normal	0
592-906020	9/28/2024 11:49	Readings	PID	SC23030396CB	Normal	0
592-906020	9/28/2024 11:48	Readings	PID	SC23030396CB	Normal	0
592-906020	9/28/2024 11:47	Readings	PID	SC23030396CB	Normal	0
592-906020	9/28/2024 11:46	Readings	PID	SC23030396CB	Normal	0
592-906020	9/28/2024 11:45	Readings	PID	SC23030396CB	Normal	0
592-906020	9/28/2024 11:44	Readings	PID	SC23030396CB	Normal	0
592-906020	9/28/2024 11:43	Readings	PID	SC23030396CB	Normal	0
592-906020	9/28/2024 11:42	Readings	PID	SC23030396CB	Normal	0
592-906020	9/28/2024 11:41	Readings	PID	SC23030396CB	Normal	0
592-906020	9/28/2024 11:40	Readings	PID	SC23030396CB	Normal	0
592-906020	9/28/2024 11:39	Readings	PID	SC23030396CB	Normal	0
592-906020	9/28/2024 11:38	Readings	PID	SC23030396CB	Normal	0
592-906020	9/28/2024 11:37	Readings	PID	SC23030396CB	Normal	0
592-906020	9/28/2024 11:36	Readings	PID	SC23030396CB	Normal	0
592-906020	9/28/2024 11:35	Readings	PID	SC23030396CB	Normal	0
592-906020	9/28/2024 11:34	Readings	PID	SC23030396CB	Normal	0
592-906020	9/28/2024 11:33	Readings	PID	SC23030396CB	Normal	0
592-906020	9/28/2024 11:32	Readings	PID	SC23030396CB	Normal	0
592-906020	9/28/2024 11:31	Readings	PID	SC23030396CB	Normal	0

592-906020	9/28/2024 7:06 Readings	PID	SC23030396CB	Normal	0
592-906020	9/28/2024 7:05 Readings	PID	SC23030396CB	Normal	0
592-906020	9/28/2024 7:04 Readings	PID	SC23030396CB	Normal	0
592-906020	9/28/2024 7:03 Readings	PID	SC23030396CB	Normal	0
592-906020	9/28/2024 7:02 Readings	PID	SC23030396CB	Normal	0
592-906020	9/28/2024 7:01 Readings	PID	SC23030396CB	Normal	0
592-906020	9/28/2024 7:00 Readings	PID	SC23030396CB	Normal	0
592-906020	9/28/2024 6:59 Readings	PID	SC23030396CB	Normal	0
592-906020	9/28/2024 6:58 Readings	PID	SC23030396CB	Normal	0
592-906020	9/28/2024 6:57 Readings	PID	SC23030396CB	Normal	0
592-906020	9/28/2024 6:56 Readings	PID	SC23030396CB	Normal	0
592-906020	9/28/2024 6:55 Readings	PID	SC23030396CB	Normal	0
592-906020	9/28/2024 6:54 Readings	PID	SC23030396CB	Normal	0
592-906020	9/28/2024 6:53 Readings	PID	SC23030396CB	Normal	0
592-906020	9/28/2024 6:52 Readings	PID	SC23030396CB	Normal	0
592-906020	9/28/2024 6:51 Readings	PID	SC23030396CB	Normal	0
592-906020	9/28/2024 6:50 Readings	PID	SC23030396CB	Normal	0
592-906020	9/28/2024 6:49 CONFIG	PID	SC23030396CB		