



**DAILY STATUS REPORT**

**Prepared By:**  
Thomas Jensen

WEATHER	Snow	Rain		Overcast		Partly Cloudy		Bright Sun	X	Wind
TEMP.	< 32	32-50	X	50-70	X	70-85		>85		SSE – 3 mph

<b>IEEG Project No:</b>	13928	<b>NYSDEC BCP Site No:</b>	C224367	<b>Date:</b> 10/22/24
<b>Project:</b>	251 Douglass Street, Brooklyn, NY			

<p><b>Consultant:</b> Impact Environmental Engineering and Geology, PLLC (IEEG)</p> <p>Time On: 06:30 Time Out: 15:30</p>	<p><b>Personnel On Site:</b> IEEG (Environmental) –Thomas Jensen Broadway Construction Group – Shannon Dowling Cascade – John Emers WSP – Charlie Lambert Concrete Courses</p> <p><b>Equipment On Site:</b> (3) MiniRAE 3000 PID, (3) DustTrak II</p>
---	---

**Scope of Work:** IEEG to deploy CAMP stations according to wind direction; Cascade to set up for ISS equipment relocation; and Concrete Courses to continue with super structure and scaffolding work.

**Site Activities:**

- IEEG deployed three (3) CAMP stations prior to the start of work activities;
- Concrete Courses continued with phase 2 super structure work; and
- Cascade received a crane to assist in moving their equipment.

**Community Air Monitoring Program (CAMP) - CAMP** action level for dust (0.1 mg/m<sup>3</sup>) and VOCs (5 ppm)

- PID remained at nominal levels throughout the day
- No sustained dust exceedances were observed over a 15-min period during monitoring.
- Startup Upwind Conditions – PID = \_0.0\_ ppm, Dust = \_0.102\_ mg/m<sup>3</sup> @ 06:55
- High Conditions (Upwind) – PID = \_0.0\_ ppm @, Dust = 0.906\_ mg/m<sup>3</sup> @ 10:02
- High Conditions (Downwind 1) – PID = \_0.3\_ ppm @11:29, Dust = \_0.585\_ mg/m<sup>3</sup> @ 07:56
- High Conditions (Downwind 2) – PID = \_0.0\_ ppm, Dust = \_0.28\_ mg/m<sup>3</sup> @ 11:31

**Notable Site Conditions:**

- None.

**Planned for the Next Day/Week:**

- Cascade to set up equipment to continue ISS column installation; and
- Concrete Courses to continue super structure and rebar activities.

**PHOTO LOG**

251 DOUGLASS STREET, BROOKLYN, NY



**Photo 1-**  
Representative  
photo of ISS  
equipment being  
moved.



**Photo 2-**  
Representative  
photo of  
superstructure  
work in phase 2.





**Photo 3-**  
Representative  
photo of site  
house keeping.



**SITE PLANS**

251 DOUGLASS STREET, BROOKLYN, NY



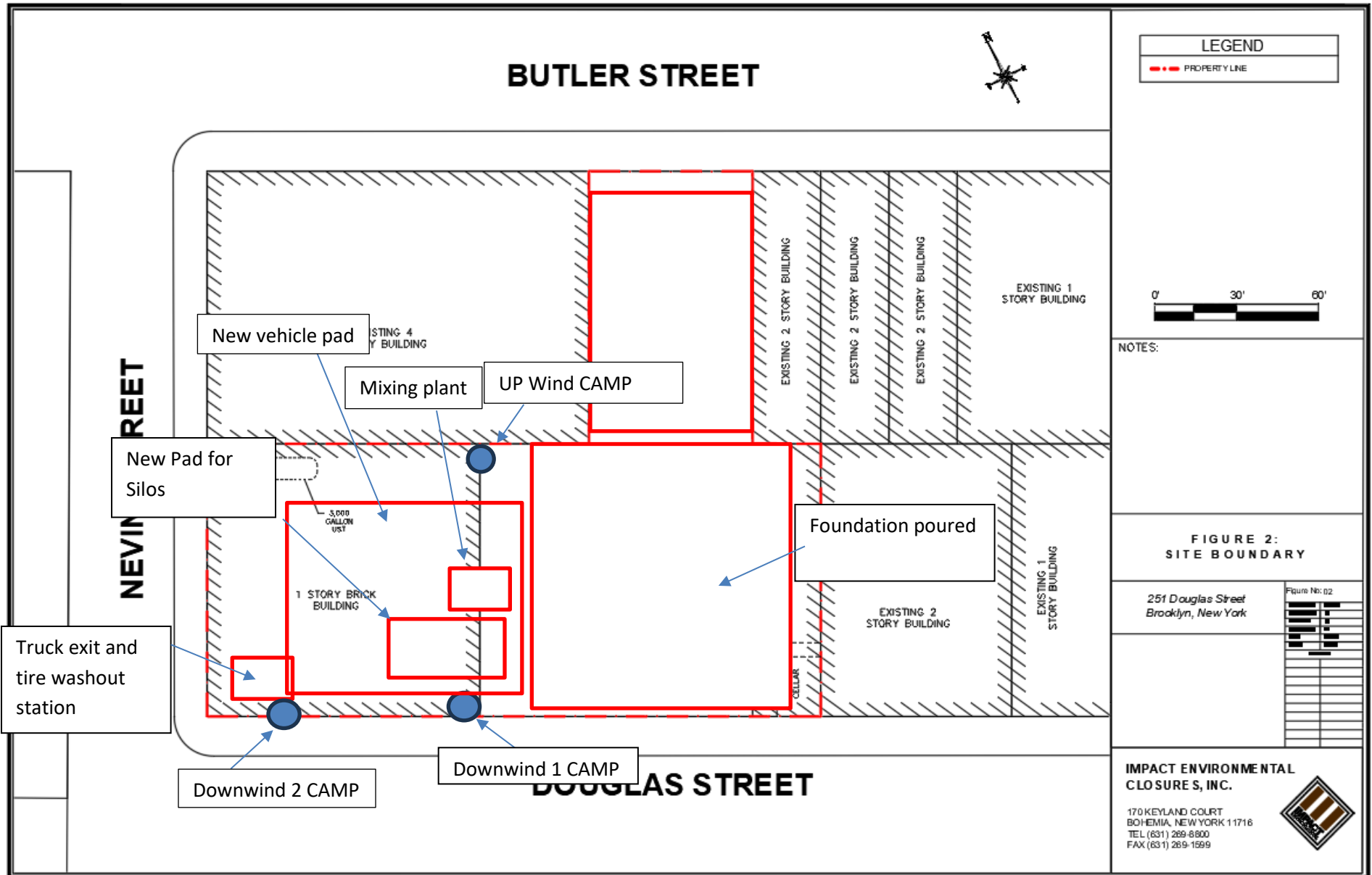



**IMPACT ENVIRONMENTAL**

170 Keyland Court | Bohemia | NY | 11716 | 631.269.8800

welcome to solid ground...

[www.impactenvironmental.com](http://www.impactenvironmental.com)

---

**UPWIND CAMP READINGS**

251 DOUGLASS STREET, BROOKLYN, NY

Instrument Name	DustTrak DRX
Model Number	8533
Serial Number	8533181207
Firmware Version	3.1
Calibration Date	7/11/2024
Test Name	MANUAL_005
Test Start Time	6:55:53 AM
Test Start Date	10/22/2024
Test Length [D:H:M]	0:08:19
Test Interval [M:S]	1:00
PM1 Average [mg/m3]	0.051
PM1 Minimum [mg/m3]	0.018
PM1 Maximum [mg/m3]	0.906
PM1 TWA [mg/m3]	0.053
Photometric User Cal	1
Size Correction User Cal	1
Flow User Cal	0
Errors	
Number of Samples	499

Elapsed Time [s]	PM1 [mg/m3]	Alarms	Errors
6:55	0.102		
6:56	0.126		
6:57	0.045		
6:58	0.054		
6:59	0.048		
7:00	0.043		
7:01	0.044		
7:02	0.041		
7:03	0.048		
7:04	0.04		
7:05	0.045		
7:06	0.042		
7:07	0.041		
7:08	0.041		
7:09	0.04		
7:10	0.039		
7:11	0.046		
7:12	0.041		
7:13	0.036		
7:14	0.036		
7:15	0.034		
7:16	0.034		
7:17	0.035		



7:18	0.035
7:19	0.036
7:20	0.035
7:21	0.041
7:22	0.043
7:23	0.061
7:24	0.051
7:25	0.04
7:26	0.04
7:27	0.035
7:28	0.035
7:29	0.035
7:30	0.046
7:31	0.055
7:32	0.054
7:33	0.053
7:34	0.055
7:35	0.049
7:36	0.047
7:37	0.044
7:38	0.044
7:39	0.042
7:40	0.041
7:41	0.043
7:42	0.043
7:43	0.044
7:44	0.047
7:45	0.066
7:46	0.057
7:47	0.047
7:48	0.05
7:49	0.048
7:50	0.052
7:51	0.078
7:52	0.083
7:53	0.066
7:54	0.063
7:55	0.062
7:56	0.067
7:57	0.068
7:58	0.054
7:59	0.061
8:00	0.061
8:01	0.081

8:02	0.066
8:03	0.087
8:04	0.142
8:05	0.146
8:06	0.107
8:07	0.084
8:08	0.062
8:09	0.059
8:10	0.067
8:11	0.058
8:12	0.113
8:13	0.119
8:14	0.102
8:15	0.088
8:16	0.06
8:17	0.05
8:18	0.049
8:19	0.055
8:20	0.061
8:21	0.064
8:22	0.054
8:23	0.05
8:24	0.055
8:25	0.053
8:26	0.056
8:27	0.056
8:28	0.053
8:29	0.097
8:30	0.701
8:31	0.092
8:32	0.062
8:33	0.061
8:34	0.075
8:35	0.076
8:36	0.067
8:37	0.059
8:38	0.051
8:39	0.048
8:40	0.049
8:41	0.054
8:42	0.054
8:43	0.052
8:44	0.055
8:45	0.057

8:46	0.06
8:47	0.059
8:48	0.054
8:49	0.051
8:50	0.049
8:51	0.049
8:52	0.055
8:53	0.061
8:54	0.106
8:55	0.159
8:56	0.177
8:57	0.087
8:58	0.165
8:59	0.508
9:00	0.128
9:01	0.18
9:02	0.079
9:03	0.07
9:04	0.133
9:05	0.07
9:06	0.064
9:07	0.118
9:08	0.085
9:09	0.072
9:10	0.066
9:11	0.066
9:12	0.072
9:13	0.067
9:14	0.056
9:15	0.054
9:16	0.059
9:17	0.057
9:18	0.064
9:19	0.056
9:20	0.065
9:21	0.06
9:22	0.08
9:23	0.078
9:24	0.088
9:25	0.084
9:26	0.09
9:27	0.093
9:28	0.137
9:29	0.105

9:30	0.105
9:31	0.07
9:32	0.06
9:33	0.081
9:34	0.065
9:35	0.061
9:36	0.061
9:37	0.061
9:38	0.057
9:39	0.086
9:40	0.066
9:41	0.056
9:42	0.057
9:43	0.058
9:44	0.059
9:45	0.052
9:46	0.055
9:47	0.052
9:48	0.056
9:49	0.056
9:50	0.057
9:51	0.057
9:52	0.055
9:53	0.056
9:54	0.057
9:55	0.057
9:56	0.058
9:57	0.054
9:58	0.055
9:59	0.06
10:00	0.076
10:01	0.328
10:02	0.906
10:03	0.329
10:04	0.228
10:05	0.132
10:06	0.087
10:07	0.066
10:08	0.053
10:09	0.09
10:10	0.058
10:11	0.052
10:12	0.076
10:13	0.086

10:14	0.06
10:15	0.055
10:16	0.054
10:17	0.048
10:18	0.049
10:19	0.048
10:20	0.053
10:21	0.053
10:22	0.05
10:23	0.051
10:24	0.051
10:25	0.051
10:26	0.054
10:27	0.054
10:28	0.061
10:29	0.053
10:30	0.052
10:31	0.088
10:32	0.061
10:33	0.061
10:34	0.048
10:35	0.043
10:36	0.044
10:37	0.041
10:38	0.084
10:39	0.216
10:40	0.041
10:41	0.052
10:42	0.042
10:43	0.044
10:44	0.027
10:45	0.028
10:46	0.025
10:47	0.035
10:48	0.037
10:49	0.036
10:50	0.058
10:51	0.047
10:52	0.069
10:53	0.04
10:54	0.081
10:55	0.051
10:56	0.074
10:57	0.054

10:58	0.072
10:59	0.087
11:00	0.098
11:01	0.076
11:02	0.089
11:03	0.124
11:04	0.084
11:05	0.087
11:06	0.043
11:07	0.027
11:08	0.023
11:09	0.028
11:10	0.037
11:11	0.028
11:12	0.019
11:13	0.028
11:14	0.026
11:15	0.025
11:16	0.042
11:17	0.031
11:18	0.036
11:19	0.031
11:20	0.029
11:21	0.084
11:22	0.061
11:23	0.048
11:24	0.047
11:25	0.052
11:26	0.045
11:27	0.04
11:28	0.032
11:29	0.022
11:30	0.043
11:31	0.041
11:32	0.036
11:33	0.026
11:34	0.029
11:35	0.062
11:36	0.033
11:37	0.025
11:38	0.022
11:39	0.022
11:40	0.027
11:41	0.057



11:42	0.03
11:43	0.038
11:44	0.025
11:45	0.02
11:46	0.026
11:47	0.024
11:48	0.021
11:49	0.023
11:50	0.031
11:51	0.042
11:52	0.026
11:53	0.021
11:54	0.021
11:55	0.022
11:56	0.034
11:57	0.045
11:58	0.053
11:59	0.041
12:00	0.025
12:01	0.02
12:02	0.019
12:03	0.02
12:04	0.019
12:05	0.02
12:06	0.019
12:07	0.021
12:08	0.023
12:09	0.02
12:10	0.02
12:11	0.02
12:12	0.02
12:13	0.023
12:14	0.063
12:15	0.028
12:16	0.02
12:17	0.068
12:18	0.051
12:19	0.02
12:20	0.019
12:21	0.019
12:22	0.019
12:23	0.019
12:24	0.019
12:25	0.019

12:26	0.018
12:27	0.02
12:28	0.018
12:29	0.019
12:30	0.022
12:31	0.018
12:32	0.019
12:33	0.021
12:34	0.023
12:35	0.023
12:36	0.022
12:37	0.018
12:38	0.031
12:39	0.02
12:40	0.019
12:41	0.035
12:42	0.023
12:43	0.022
12:44	0.024
12:45	0.034
12:46	0.037
12:47	0.043
12:48	0.032
12:49	0.03
12:50	0.02
12:51	0.021
12:52	0.02
12:53	0.022
12:54	0.019
12:55	0.028
12:56	0.028
12:57	0.022
12:58	0.047
12:59	0.02
13:00	0.02
13:01	0.075
13:02	0.021
13:03	0.02
13:04	0.02
13:05	0.021
13:06	0.033
13:07	0.027
13:08	0.074
13:09	0.046

13:10	0.034
13:11	0.021
13:12	0.023
13:13	0.022
13:14	0.022
13:15	0.026
13:16	0.021
13:17	0.021
13:18	0.021
13:19	0.021
13:20	0.022
13:21	0.021
13:22	0.023
13:23	0.022
13:24	0.024
13:25	0.051
13:26	0.05
13:27	0.06
13:28	0.05
13:29	0.051
13:30	0.028
13:31	0.022
13:32	0.024
13:33	0.026
13:34	0.039
13:35	0.021
13:36	0.021
13:37	0.022
13:38	0.021
13:39	0.022
13:40	0.022
13:41	0.021
13:42	0.022
13:43	0.025
13:44	0.022
13:45	0.022
13:46	0.023
13:47	0.027
13:48	0.028
13:49	0.025
13:50	0.022
13:51	0.022
13:52	0.022
13:53	0.023

13:54	0.037
13:55	0.03
13:56	0.026
13:57	0.052
13:58	0.037
13:59	0.024
14:00	0.022
14:01	0.024
14:02	0.025
14:03	0.022
14:04	0.023
14:05	0.023
14:06	0.023
14:07	0.023
14:08	0.023
14:09	0.023
14:10	0.023
14:11	0.022
14:12	0.022
14:13	0.022
14:14	0.054
14:15	0.061
14:16	0.023
14:17	0.023
14:18	0.021
14:19	0.022
14:20	0.022
14:21	0.031
14:22	0.03
14:23	0.037
14:24	0.023
14:25	0.027
14:26	0.041
14:27	0.023
14:28	0.021
14:29	0.02
14:30	0.024
14:31	0.021
14:32	0.022
14:33	0.023
14:34	0.039
14:35	0.021
14:36	0.021
14:37	0.024

14:38	0.024
14:39	0.02
14:40	0.021
14:41	0.02
14:42	0.022
14:43	0.029
14:44	0.027
14:45	0.02
14:46	0.021
14:47	0.022
14:48	0.024
14:49	0.031
14:50	0.02
14:51	0.022
14:52	0.02
14:53	0.019
14:54	0.02
14:55	0.02
14:56	0.02
14:57	0.02
14:58	0.02
14:59	0.021
15:00	0.02
15:01	0.02
15:02	0.021
15:03	0.021
15:04	0.022
15:05	0.019
15:06	0.019
15:07	0.019
15:08	0.019
15:09	0.021
15:10	0.019
15:11	0.02
15:12	0.019
15:13	0.021

Device Serial No	Log Time	Log Type	Sensor 1 Type	Sensor 1 Serial Number	Sensor 1 Status	Sensor 1 Gas Reading
592-906376	10/22/2024 15:25	Readings	PID	SC23030159V4	Normal	0
592-906376	10/22/2024 15:24	Readings	PID	SC23030159V4	Normal	0
592-906376	10/22/2024 15:23	Readings	PID	SC23030159V4	Normal	0
592-906376	10/22/2024 15:22	Readings	PID	SC23030159V4	Normal	0
592-906376	10/22/2024 15:21	Readings	PID	SC23030159V4	Normal	0
592-906376	10/22/2024 15:20	Readings	PID	SC23030159V4	Normal	0
592-906376	10/22/2024 15:19	Readings	PID	SC23030159V4	Normal	0
592-906376	10/22/2024 15:18	Readings	PID	SC23030159V4	Normal	0
592-906376	10/22/2024 15:17	Readings	PID	SC23030159V4	Normal	0
592-906376	10/22/2024 15:16	Readings	PID	SC23030159V4	Normal	0
592-906376	10/22/2024 15:15	Readings	PID	SC23030159V4	Normal	0
592-906376	10/22/2024 15:14	Readings	PID	SC23030159V4	Normal	0
592-906376	10/22/2024 15:13	Readings	PID	SC23030159V4	Normal	0
592-906376	10/22/2024 15:12	Readings	PID	SC23030159V4	Normal	0
592-906376	10/22/2024 15:11	Readings	PID	SC23030159V4	Normal	0
592-906376	10/22/2024 15:10	Readings	PID	SC23030159V4	Normal	0
592-906376	10/22/2024 15:09	Readings	PID	SC23030159V4	Normal	0
592-906376	10/22/2024 15:08	Readings	PID	SC23030159V4	Normal	0
592-906376	10/22/2024 15:07	Readings	PID	SC23030159V4	Normal	0
592-906376	10/22/2024 15:06	Readings	PID	SC23030159V4	Normal	0
592-906376	10/22/2024 15:05	Readings	PID	SC23030159V4	Normal	0
592-906376	10/22/2024 15:04	Readings	PID	SC23030159V4	Normal	0
592-906376	10/22/2024 15:03	Readings	PID	SC23030159V4	Normal	0
592-906376	10/22/2024 15:02	Readings	PID	SC23030159V4	Normal	0
592-906376	10/22/2024 15:01	Readings	PID	SC23030159V4	Normal	0
592-906376	10/22/2024 15:00	Readings	PID	SC23030159V4	Normal	0
592-906376	10/22/2024 14:59	Readings	PID	SC23030159V4	Normal	0
592-906376	10/22/2024 14:58	Readings	PID	SC23030159V4	Normal	0
592-906376	10/22/2024 14:57	Readings	PID	SC23030159V4	Normal	0
592-906376	10/22/2024 14:56	Readings	PID	SC23030159V4	Normal	0
592-906376	10/22/2024 14:55	Readings	PID	SC23030159V4	Normal	0
592-906376	10/22/2024 14:54	Readings	PID	SC23030159V4	Normal	0



































592-906376	10/22/2024 7:11 Readings	PID	SC23030159V4	Normal	0
592-906376	10/22/2024 7:10 Readings	PID	SC23030159V4	Normal	0
592-906376	10/22/2024 7:09 Readings	PID	SC23030159V4	Normal	0
592-906376	10/22/2024 7:08 Readings	PID	SC23030159V4	Normal	0
592-906376	10/22/2024 7:07 CONFIG	PID	SC23030159V4		

**DOWNWIND CAMP READINGS**

251 DOUGLASS STREET, BROOKLYN, NY



Instrument Name	DustTrak II
Model Number	8530
Serial Number	8530224603
Firmware Version	3.1
Calibration Date	4/3/2024
Test Name	MANUAL_005
Test Start Time	7:02:24 AM
Test Start Date	10/22/2024
Test Length [D:H:M]	0:08:10
Test Interval [M:S]	1:00
Mass Average [mg/m3]	0.058
Mass Minimum [mg/m3]	0.024
Mass Maximum [mg/m3]	0.585
Mass TWA [mg/m3]	0.058
Photometric User Cal	1
Flow User Cal	0
Errors	
Number of Samples	490

Elapsed Time [s]	Mass [mg/m3]	Alarms	Errors
7:02	0.145		
7:03	0.097		
7:04	0.068		
7:05	0.054		
7:06	0.061		
7:07	0.06		
7:08	0.058		
7:09	0.056		
7:10	0.088		
7:11	0.083		
7:12	0.068		
7:13	0.072		
7:14	0.074		
7:15	0.134		
7:16	0.247		
7:17	0.192		
7:18	0.126		
7:19	0.072		
7:20	0.066		
7:21	0.069		
7:22	0.065		
7:23	0.068		
7:24	0.068		
7:25	0.071		

7:26	0.067
7:27	0.075
7:28	0.07
7:29	0.055
7:30	0.062
7:31	0.064
7:32	0.057
7:33	0.054
7:34	0.1
7:35	0.064
7:36	0.05
7:37	0.084
7:38	0.088
7:39	0.085
7:40	0.079
7:41	0.079
7:42	0.066
7:43	0.059
7:44	0.068
7:45	0.083
7:46	0.066
7:47	0.058
7:48	0.066
7:49	0.07
7:50	0.069
7:51	0.069
7:52	0.074
7:53	0.069
7:54	0.076
7:55	0.09
7:56	0.585
7:57	0.113
7:58	0.069
7:59	0.063
8:00	0.062
8:01	0.061
8:02	0.06
8:03	0.061
8:04	0.061
8:05	0.061
8:06	0.061
8:07	0.061
8:08	0.06
8:09	0.062

8:10	0.064
8:11	0.113
8:12	0.146
8:13	0.132
8:14	0.121
8:15	0.142
8:16	0.083
8:17	0.084
8:18	0.081
8:19	0.084
8:20	0.089
8:21	0.086
8:22	0.087
8:23	0.085
8:24	0.087
8:25	0.086
8:26	0.084
8:27	0.086
8:28	0.104
8:29	0.107
8:30	0.095
8:31	0.085
8:32	0.08
8:33	0.072
8:34	0.069
8:35	0.075
8:36	0.075
8:37	0.074
8:38	0.073
8:39	0.075
8:40	0.071
8:41	0.07
8:42	0.099
8:43	0.098
8:44	0.093
8:45	0.086
8:46	0.084
8:47	0.084
8:48	0.079
8:49	0.074
8:50	0.08
8:51	0.083
8:52	0.083
8:53	0.081

8:54	0.079
8:55	0.076
8:56	0.074
8:57	0.072
8:58	0.072
8:59	0.075
9:00	0.076
9:01	0.075
9:02	0.074
9:03	0.074
9:04	0.073
9:05	0.079
9:06	0.076
9:07	0.076
9:08	0.072
9:09	0.071
9:10	0.069
9:11	0.069
9:12	0.071
9:13	0.072
9:14	0.069
9:15	0.07
9:16	0.069
9:17	0.069
9:18	0.071
9:19	0.069
9:20	0.071
9:21	0.074
9:22	0.074
9:23	0.072
9:24	0.073
9:25	0.071
9:26	0.074
9:27	0.16
9:28	0.153
9:29	0.101
9:30	0.076
9:31	0.083
9:32	0.102
9:33	0.093
9:34	0.084
9:35	0.093
9:36	0.086
9:37	0.073

9:38	0.079
9:39	0.075
9:40	0.075
9:41	0.075
9:42	0.078
9:43	0.077
9:44	0.075
9:45	0.074
9:46	0.077
9:47	0.073
9:48	0.076
9:49	0.076
9:50	0.08
9:51	0.084
9:52	0.078
9:53	0.076
9:54	0.074
9:55	0.071
9:56	0.07
9:57	0.071
9:58	0.075
9:59	0.098
10:00	0.08
10:01	0.074
10:02	0.073
10:03	0.077
10:04	0.076
10:05	0.076
10:06	0.082
10:07	0.087
10:08	0.072
10:09	0.079
10:10	0.07
10:11	0.073
10:12	0.08
10:13	0.083
10:14	0.081
10:15	0.074
10:16	0.071
10:17	0.065
10:18	0.063
10:19	0.063
10:20	0.064
10:21	0.064

10:22	0.066
10:23	0.065
10:24	0.065
10:25	0.069
10:26	0.069
10:27	0.067
10:28	0.065
10:29	0.064
10:30	0.069
10:31	0.068
10:32	0.093
10:33	0.066
10:34	0.059
10:35	0.06
10:36	0.054
10:37	0.049
10:38	0.052
10:39	0.069
10:40	0.047
10:41	0.058
10:42	0.053
10:43	0.051
10:44	0.034
10:45	0.03
10:46	0.03
10:47	0.043
10:48	0.033
10:49	0.032
10:50	0.03
10:51	0.038
10:52	0.035
10:53	0.033
10:54	0.033
10:55	0.029
10:56	0.038
10:57	0.033
10:58	0.035
10:59	0.059
11:00	0.045
11:01	0.05
11:02	0.045
11:03	0.033
11:04	0.031
11:05	0.03



11:06	0.031
11:07	0.038
11:08	0.264
11:09	0.224
11:10	0.07
11:11	0.032
11:12	0.031
11:13	0.032
11:14	0.033
11:15	0.029
11:16	0.032
11:17	0.032
11:18	0.027
11:19	0.028
11:20	0.041
11:21	0.036
11:22	0.043
11:23	0.054
11:24	0.065
11:25	0.072
11:26	0.069
11:27	0.07
11:28	0.047
11:29	0.036
11:30	0.038
11:31	0.053
11:32	0.406
11:33	0.074
11:34	0.052
11:35	0.035
11:36	0.033
11:37	0.031
11:38	0.03
11:39	0.03
11:40	0.052
11:41	0.033
11:42	0.029
11:43	0.033
11:44	0.03
11:45	0.04
11:46	0.035
11:47	0.029
11:48	0.028
11:49	0.029

11:50	0.049
11:51	0.05
11:52	0.035
11:53	0.029
11:54	0.028
11:55	0.028
11:56	0.028
11:57	0.029
11:58	0.031
11:59	0.065
12:00	0.032
12:01	0.031
12:02	0.046
12:03	0.03
12:04	0.029
12:05	0.03
12:06	0.029
12:07	0.028
12:08	0.058
12:09	0.03
12:10	0.029
12:11	0.042
12:12	0.029
12:13	0.029
12:14	0.028
12:15	0.03
12:16	0.031
12:17	0.029
12:18	0.028
12:19	0.043
12:20	0.031
12:21	0.03
12:22	0.029
12:23	0.029
12:24	0.027
12:25	0.027
12:26	0.028
12:27	0.027
12:28	0.027
12:29	0.027
12:30	0.032
12:31	0.031
12:32	0.027
12:33	0.028

12:34	0.029
12:35	0.027
12:36	0.027
12:37	0.067
12:38	0.049
12:39	0.029
12:40	0.028
12:41	0.028
12:42	0.029
12:43	0.026
12:44	0.027
12:45	0.027
12:46	0.038
12:47	0.028
12:48	0.028
12:49	0.028
12:50	0.093
12:51	0.03
12:52	0.029
12:53	0.03
12:54	0.033
12:55	0.034
12:56	0.035
12:57	0.031
12:58	0.036
12:59	0.047
13:00	0.036
13:01	0.031
13:02	0.031
13:03	0.036
13:04	0.029
13:05	0.028
13:06	0.028
13:07	0.03
13:08	0.033
13:09	0.028
13:10	0.029
13:11	0.029
13:12	0.028
13:13	0.031
13:14	0.052
13:15	0.029
13:16	0.028
13:17	0.031

13:18	0.045
13:19	0.032
13:20	0.033
13:21	0.032
13:22	0.052
13:23	0.047
13:24	0.039
13:25	0.031
13:26	0.031
13:27	0.033
13:28	0.039
13:29	0.031
13:30	0.029
13:31	0.03
13:32	0.033
13:33	0.033
13:34	0.039
13:35	0.04
13:36	0.064
13:37	0.067
13:38	0.036
13:39	0.037
13:40	0.032
13:41	0.033
13:42	0.031
13:43	0.032
13:44	0.042
13:45	0.041
13:46	0.036
13:47	0.03
13:48	0.034
13:49	0.033
13:50	0.028
13:51	0.03
13:52	0.031
13:53	0.029
13:54	0.029
13:55	0.062
13:56	0.108
13:57	0.031
13:58	0.051
13:59	0.033
14:00	0.032
14:01	0.037

14:02	0.037
14:03	0.035
14:04	0.029
14:05	0.031
14:06	0.037
14:07	0.033
14:08	0.044
14:09	0.03
14:10	0.029
14:11	0.031
14:12	0.04
14:13	0.03
14:14	0.029
14:15	0.045
14:16	0.035
14:17	0.033
14:18	0.03
14:19	0.027
14:20	0.03
14:21	0.028
14:22	0.029
14:23	0.029
14:24	0.057
14:25	0.051
14:26	0.031
14:27	0.03
14:28	0.038
14:29	0.052
14:30	0.033
14:31	0.037
14:32	0.062
14:33	0.048
14:34	0.031
14:35	0.043
14:36	0.03
14:37	0.026
14:38	0.03
14:39	0.047
14:40	0.041
14:41	0.029
14:42	0.03
14:43	0.025
14:44	0.027
14:45	0.031

14:46	0.03
14:47	0.028
14:48	0.026
14:49	0.036
14:50	0.03
14:51	0.025
14:52	0.024
14:53	0.025
14:54	0.025
14:55	0.028
14:56	0.025
14:57	0.025
14:58	0.025
14:59	0.024
15:00	0.23
15:01	0.048
15:02	0.027
15:03	0.029
15:04	0.026
15:05	0.026
15:06	0.035
15:07	0.047
15:08	0.033
15:09	0.031
15:10	0.025
15:11	0.026

Device Serial No	Log Time	Log Type	Log Interval	Sensor 1 Type	Sensor 1 Serial Number	Sensor 1 Status	Sensor 1 Gas Reading
592-927198	10/22/2024 15:51	Readings		PID	SC23030235W3	Normal	0.3
592-927198	10/22/2024 15:50	Readings		PID	SC23030235W3	Normal	0.3
592-927198	10/22/2024 15:49	Readings		PID	SC23030235W3	Normal	0.3
592-927198	10/22/2024 15:48	Readings		PID	SC23030235W3	Normal	0.3
592-927198	10/22/2024 15:47	Readings		PID	SC23030235W3	Normal	0.3
592-927198	10/22/2024 15:46	Readings		PID	SC23030235W3	Normal	0.3
592-927198	10/22/2024 15:45	Readings		PID	SC23030235W3	Normal	0.3
592-927198	10/22/2024 15:44	Readings		PID	SC23030235W3	Normal	0.3
592-927198	10/22/2024 15:43	Readings		PID	SC23030235W3	Normal	0.3
592-927198	10/22/2024 15:42	Readings		PID	SC23030235W3	Normal	0.3
592-927198	10/22/2024 15:41	Readings		PID	SC23030235W3	Normal	0.3
592-927198	10/22/2024 15:40	Readings		PID	SC23030235W3	Normal	0.3
592-927198	10/22/2024 15:39	Readings		PID	SC23030235W3	Normal	0.3
592-927198	10/22/2024 15:38	Readings		PID	SC23030235W3	Normal	0.3
592-927198	10/22/2024 15:37	Readings		PID	SC23030235W3	Normal	0.3
592-927198	10/22/2024 15:36	Readings		PID	SC23030235W3	Normal	0.3
592-927198	10/22/2024 15:35	Readings		PID	SC23030235W3	Normal	0.3
592-927198	10/22/2024 15:34	Readings		PID	SC23030235W3	Normal	0.3
592-927198	10/22/2024 15:33	Readings		PID	SC23030235W3	Normal	0.3
592-927198	10/22/2024 15:32	Readings		PID	SC23030235W3	Normal	0.3
592-927198	10/22/2024 15:31	Readings		PID	SC23030235W3	Normal	0.3
592-927198	10/22/2024 15:30	Readings		PID	SC23030235W3	Normal	0.3
592-927198	10/22/2024 15:29	Readings		PID	SC23030235W3	Normal	0.3
592-927198	10/22/2024 15:28	Readings		PID	SC23030235W3	Normal	0.3
592-927198	10/22/2024 15:27	Readings		PID	SC23030235W3	Normal	0.3
592-927198	10/22/2024 15:26	Readings		PID	SC23030235W3	Normal	0.3
592-927198	10/22/2024 15:25	Readings		PID	SC23030235W3	Normal	0.2
592-927198	10/22/2024 15:24	Readings		PID	SC23030235W3	Normal	0.2
592-927198	10/22/2024 15:23	Readings		PID	SC23030235W3	Normal	0.2
592-927198	10/22/2024 15:22	Readings		PID	SC23030235W3	Normal	0.3
592-927198	10/22/2024 15:21	Readings		PID	SC23030235W3	Normal	0.3
592-927198	10/22/2024 15:20	Readings		PID	SC23030235W3	Normal	0.2































592-927198	10/22/2024 8:10 Readings	PID	SC23030235W3	Normal	0
592-927198	10/22/2024 8:09 Readings	PID	SC23030235W3	Normal	0
592-927198	10/22/2024 8:08 Readings	PID	SC23030235W3	Normal	0
592-927198	10/22/2024 8:07 Readings	PID	SC23030235W3	Normal	0
592-927198	10/22/2024 8:06 Readings	PID	SC23030235W3	Normal	0
592-927198	10/22/2024 8:05 Readings	PID	SC23030235W3	Normal	0
592-927198	10/22/2024 8:04 Readings	PID	SC23030235W3	Normal	0
592-927198	10/22/2024 8:03 Readings	PID	SC23030235W3	Normal	0
592-927198	10/22/2024 8:02 Readings	PID	SC23030235W3	Normal	0
592-927198	10/22/2024 8:01 Readings	PID	SC23030235W3	Normal	0
592-927198	10/22/2024 8:00 Readings	PID	SC23030235W3	Normal	0
592-927198	10/22/2024 7:59 Readings	PID	SC23030235W3	Normal	0
592-927198	10/22/2024 7:58 Readings	PID	SC23030235W3	Normal	0
592-927198	10/22/2024 7:57 Readings	PID	SC23030235W3	Normal	0
592-927198	10/22/2024 7:56 Readings	PID	SC23030235W3	Normal	0
592-927198	10/22/2024 7:55 Readings	PID	SC23030235W3	Normal	0
592-927198	10/22/2024 7:54 Readings	PID	SC23030235W3	Normal	0
592-927198	10/22/2024 7:53 Readings	PID	SC23030235W3	Normal	0
592-927198	10/22/2024 7:52 Readings	PID	SC23030235W3	Normal	0
592-927198	10/22/2024 7:51 Readings	PID	SC23030235W3	Normal	0
592-927198	10/22/2024 7:50 Readings	PID	SC23030235W3	Normal	0
592-927198	10/22/2024 7:49 Readings	PID	SC23030235W3	Normal	0
592-927198	10/22/2024 7:48 Readings	PID	SC23030235W3	Normal	0
592-927198	10/22/2024 7:47 Readings	PID	SC23030235W3	Normal	0
592-927198	10/22/2024 7:46 Readings	PID	SC23030235W3	Normal	0
592-927198	10/22/2024 7:45 Readings	PID	SC23030235W3	Normal	0
592-927198	10/22/2024 7:44 Readings	PID	SC23030235W3	Normal	0
592-927198	10/22/2024 7:43 Readings	PID	SC23030235W3	Normal	0
592-927198	10/22/2024 7:42 Readings	PID	SC23030235W3	Normal	0
592-927198	10/22/2024 7:41 CONFIG	60 PID	SC23030235W3		

Instrument Name	f0.2
Model Number	8530
Serial Number	8530154916
Firmware Version	3.1
Calibration Date	8/2/2024
Test Name	MANUAL_005
Test Start Time	6:59:33 AM
Test Start Date	10/22/2024
Test Length [D:H:M]	0:08:11
Test Interval [M:S]	1:00
Mass Average [mg/m3]	0.056
Mass Minimum [mg/m3]	0.018
Mass Maximum [mg/m3]	0.28
Mass TWA [mg/m3]	0.057
Photometric User Cal	1
Flow User Cal	0
Errors	
Number of Samples	491

Elapsed Time [s]	Mass [mg/m3]	Alarms	Errors
6:59	0.193		
7:00	0.074		
7:01	0.062		
7:02	0.063		
7:03	0.069		
7:04	0.07		
7:05	0.066		
7:06	0.059		
7:07	0.053		
7:08	0.054		
7:09	0.058		
7:10	0.072		
7:11	0.068		
7:12	0.066		
7:13	0.062		
7:14	0.058		
7:15	0.056		
7:16	0.051		
7:17	0.095		
7:18	0.054		
7:19	0.053		
7:20	0.052		
7:21	0.051		
7:22	0.053		

7:23	0.055
7:24	0.051
7:25	0.054
7:26	0.053
7:27	0.052
7:28	0.053
7:29	0.054
7:30	0.057
7:31	0.058
7:32	0.056
7:33	0.064
7:34	0.067
7:35	0.065
7:36	0.235
7:37	0.154
7:38	0.085
7:39	0.067
7:40	0.06
7:41	0.064
7:42	0.062
7:43	0.059
7:44	0.063
7:45	0.061
7:46	0.064
7:47	0.074
7:48	0.068
7:49	0.07
7:50	0.075
7:51	0.076
7:52	0.072
7:53	0.07
7:54	0.07
7:55	0.069
7:56	0.076
7:57	0.088
7:58	0.077
7:59	0.075
8:00	0.075
8:01	0.069
8:02	0.071
8:03	0.073
8:04	0.072
8:05	0.068
8:06	0.068

8:07	0.072
8:08	0.068
8:09	0.07
8:10	0.067
8:11	0.069
8:12	0.068
8:13	0.082
8:14	0.115
8:15	0.115
8:16	0.106
8:17	0.101
8:18	0.1
8:19	0.095
8:20	0.094
8:21	0.091
8:22	0.091
8:23	0.089
8:24	0.088
8:25	0.089
8:26	0.089
8:27	0.087
8:28	0.087
8:29	0.095
8:30	0.098
8:31	0.101
8:32	0.102
8:33	0.098
8:34	0.092
8:35	0.085
8:36	0.091
8:37	0.089
8:38	0.09
8:39	0.088
8:40	0.085
8:41	0.083
8:42	0.082
8:43	0.087
8:44	0.099
8:45	0.102
8:46	0.086
8:47	0.086
8:48	0.091
8:49	0.089
8:50	0.085



8:51	0.084
8:52	0.085
8:53	0.086
8:54	0.086
8:55	0.083
8:56	0.082
8:57	0.079
8:58	0.08
8:59	0.079
9:00	0.08
9:01	0.085
9:02	0.082
9:03	0.079
9:04	0.079
9:05	0.078
9:06	0.11
9:07	0.078
9:08	0.086
9:09	0.077
9:10	0.077
9:11	0.078
9:12	0.075
9:13	0.076
9:14	0.076
9:15	0.075
9:16	0.077
9:17	0.09
9:18	0.078
9:19	0.079
9:20	0.075
9:21	0.079
9:22	0.08
9:23	0.081
9:24	0.078
9:25	0.076
9:26	0.078
9:27	0.089
9:28	0.111
9:29	0.121
9:30	0.102
9:31	0.102
9:32	0.1
9:33	0.096
9:34	0.088

9:35	0.087
9:36	0.09
9:37	0.083
9:38	0.078
9:39	0.084
9:40	0.086
9:41	0.084
9:42	0.094
9:43	0.092
9:44	0.078
9:45	0.073
9:46	0.076
9:47	0.075
9:48	0.073
9:49	0.073
9:50	0.073
9:51	0.076
9:52	0.079
9:53	0.083
9:54	0.078
9:55	0.077
9:56	0.079
9:57	0.076
9:58	0.075
9:59	0.085
10:00	0.079
10:01	0.077
10:02	0.077
10:03	0.076
10:04	0.075
10:05	0.072
10:06	0.073
10:07	0.074
10:08	0.075
10:09	0.077
10:10	0.07
10:11	0.07
10:12	0.071
10:13	0.078
10:14	0.093
10:15	0.082
10:16	0.074
10:17	0.069
10:18	0.066

10:19	0.066
10:20	0.064
10:21	0.063
10:22	0.065
10:23	0.065
10:24	0.066
10:25	0.067
10:26	0.075
10:27	0.069
10:28	0.068
10:29	0.065
10:30	0.066
10:31	0.065
10:32	0.08
10:33	0.077
10:34	0.078
10:35	0.062
10:36	0.058
10:37	0.054
10:38	0.051
10:39	0.051
10:40	0.049
10:41	0.054
10:42	0.055
10:43	0.048
10:44	0.037
10:45	0.037
10:46	0.032
10:47	0.034
10:48	0.041
10:49	0.043
10:50	0.039
10:51	0.084
10:52	0.045
10:53	0.034
10:54	0.032
10:55	0.037
10:56	0.048
10:57	0.046
10:58	0.042
10:59	0.045
11:00	0.159
11:01	0.091
11:02	0.055

11:03	0.036
11:04	0.037
11:05	0.074
11:06	0.1
11:07	0.061
11:08	0.198
11:09	0.203
11:10	0.132
11:11	0.041
11:12	0.055
11:13	0.034
11:14	0.036
11:15	0.035
11:16	0.098
11:17	0.088
11:18	0.128
11:19	0.034
11:20	0.074
11:21	0.06
11:22	0.065
11:23	0.053
11:24	0.057
11:25	0.064
11:26	0.078
11:27	0.165
11:28	0.05
11:29	0.038
11:30	0.187
11:31	0.28
11:32	0.104
11:33	0.059
11:34	0.102
11:35	0.041
11:36	0.069
11:37	0.033
11:38	0.039
11:39	0.039
11:40	0.039
11:41	0.047
11:42	0.064
11:43	0.035
11:44	0.034
11:45	0.035
11:46	0.028

11:47	0.028
11:48	0.027
11:49	0.03
11:50	0.064
11:51	0.048
11:52	0.032
11:53	0.037
11:54	0.031
11:55	0.026
11:56	0.025
11:57	0.028
11:58	0.031
11:59	0.028
12:00	0.028
12:01	0.028
12:02	0.029
12:03	0.026
12:04	0.025
12:05	0.026
12:06	0.026
12:07	0.025
12:08	0.026
12:09	0.026
12:10	0.026
12:11	0.025
12:12	0.025
12:13	0.027
12:14	0.025
12:15	0.028
12:16	0.035
12:17	0.035
12:18	0.035
12:19	0.029
12:20	0.028
12:21	0.025
12:22	0.025
12:23	0.024
12:24	0.024
12:25	0.025
12:26	0.023
12:27	0.022
12:28	0.023
12:29	0.022
12:30	0.028

12:31	0.028
12:32	0.023
12:33	0.023
12:34	0.024
12:35	0.022
12:36	0.027
12:37	0.024
12:38	0.029
12:39	0.027
12:40	0.023
12:41	0.022
12:42	0.025
12:43	0.024
12:44	0.025
12:45	0.025
12:46	0.023
12:47	0.035
12:48	0.024
12:49	0.033
12:50	0.032
12:51	0.025
12:52	0.026
12:53	0.023
12:54	0.026
12:55	0.026
12:56	0.024
12:57	0.023
12:58	0.023
12:59	0.027
13:00	0.035
13:01	0.024
13:02	0.03
13:03	0.027
13:04	0.024
13:05	0.023
13:06	0.023
13:07	0.026
13:08	0.025
13:09	0.025
13:10	0.024
13:11	0.024
13:12	0.023
13:13	0.026
13:14	0.029

13:15	0.025
13:16	0.023
13:17	0.024
13:18	0.038
13:19	0.032
13:20	0.033
13:21	0.022
13:22	0.024
13:23	0.033
13:24	0.024
13:25	0.026
13:26	0.022
13:27	0.028
13:28	0.035
13:29	0.031
13:30	0.025
13:31	0.027
13:32	0.03
13:33	0.074
13:34	0.084
13:35	0.04
13:36	0.045
13:37	0.039
13:38	0.03
13:39	0.024
13:40	0.033
13:41	0.032
13:42	0.025
13:43	0.04
13:44	0.032
13:45	0.024
13:46	0.027
13:47	0.03
13:48	0.042
13:49	0.032
13:50	0.024
13:51	0.036
13:52	0.025
13:53	0.025
13:54	0.031
13:55	0.026
13:56	0.024
13:57	0.023
13:58	0.137

13:59	0.031
14:00	0.024
14:01	0.03
14:02	0.025
14:03	0.023
14:04	0.024
14:05	0.026
14:06	0.025
14:07	0.026
14:08	0.026
14:09	0.024
14:10	0.024
14:11	0.024
14:12	0.024
14:13	0.027
14:14	0.032
14:15	0.026
14:16	0.024
14:17	0.024
14:18	0.022
14:19	0.022
14:20	0.025
14:21	0.022
14:22	0.026
14:23	0.025
14:24	0.029
14:25	0.036
14:26	0.029
14:27	0.028
14:28	0.027
14:29	0.021
14:30	0.021
14:31	0.056
14:32	0.03
14:33	0.022
14:34	0.022
14:35	0.023
14:36	0.024
14:37	0.021
14:38	0.022
14:39	0.031
14:40	0.027
14:41	0.022
14:42	0.02



14:43	0.02
14:44	0.02
14:45	0.021
14:46	0.022
14:47	0.022
14:48	0.022
14:49	0.031
14:50	0.021
14:51	0.023
14:52	0.02
14:53	0.023
14:54	0.021
14:55	0.018
14:56	0.019
14:57	0.019
14:58	0.018
14:59	0.019
15:00	0.019
15:01	0.022
15:02	0.02
15:03	0.021
15:04	0.02
15:05	0.023
15:06	0.024
15:07	0.023
15:08	0.02
15:09	0.023

Device Serial No	Log Time	Log Type	Sensor 1 Type	Sensor 1 Serial Number	Sensor 1 Status	Sensor 1 Gas Reading
592-906020	10/22/2024 15:20	Readings	PID	SC23030396CB	Normal	0
592-906020	10/22/2024 15:19	Readings	PID	SC23030396CB	Normal	0
592-906020	10/22/2024 15:18	Readings	PID	SC23030396CB	Normal	0
592-906020	10/22/2024 15:17	Readings	PID	SC23030396CB	Normal	0
592-906020	10/22/2024 15:16	Readings	PID	SC23030396CB	Normal	0
592-906020	10/22/2024 15:15	Readings	PID	SC23030396CB	Normal	0
592-906020	10/22/2024 15:14	Readings	PID	SC23030396CB	Normal	0
592-906020	10/22/2024 15:13	Readings	PID	SC23030396CB	Normal	0
592-906020	10/22/2024 15:12	Readings	PID	SC23030396CB	Normal	0
592-906020	10/22/2024 15:11	Readings	PID	SC23030396CB	Normal	0
592-906020	10/22/2024 15:10	Readings	PID	SC23030396CB	Normal	0
592-906020	10/22/2024 15:09	Readings	PID	SC23030396CB	Normal	0
592-906020	10/22/2024 15:08	Readings	PID	SC23030396CB	Normal	0
592-906020	10/22/2024 15:07	Readings	PID	SC23030396CB	Normal	0
592-906020	10/22/2024 15:06	Readings	PID	SC23030396CB	Normal	0
592-906020	10/22/2024 15:05	Readings	PID	SC23030396CB	Normal	0
592-906020	10/22/2024 15:04	Readings	PID	SC23030396CB	Normal	0
592-906020	10/22/2024 15:03	Readings	PID	SC23030396CB	Normal	0
592-906020	10/22/2024 15:02	Readings	PID	SC23030396CB	Normal	0
592-906020	10/22/2024 15:01	Readings	PID	SC23030396CB	Normal	0
592-906020	10/22/2024 15:00	Readings	PID	SC23030396CB	Normal	0
592-906020	10/22/2024 14:59	Readings	PID	SC23030396CB	Normal	0
592-906020	10/22/2024 14:58	Readings	PID	SC23030396CB	Normal	0
592-906020	10/22/2024 14:57	Readings	PID	SC23030396CB	Normal	0
592-906020	10/22/2024 14:56	Readings	PID	SC23030396CB	Normal	0
592-906020	10/22/2024 14:55	Readings	PID	SC23030396CB	Normal	0
592-906020	10/22/2024 14:54	Readings	PID	SC23030396CB	Normal	0
592-906020	10/22/2024 14:53	Readings	PID	SC23030396CB	Normal	0
592-906020	10/22/2024 14:52	Readings	PID	SC23030396CB	Normal	0
592-906020	10/22/2024 14:51	Readings	PID	SC23030396CB	Normal	0
592-906020	10/22/2024 14:50	Readings	PID	SC23030396CB	Normal	0
592-906020	10/22/2024 14:49	Readings	PID	SC23030396CB	Normal	0





























592-906020	10/22/2024 7:39	Readings	PID	SC23030396CB	Normal	0
592-906020	10/22/2024 7:38	Readings	PID	SC23030396CB	Normal	0
592-906020	10/22/2024 7:37	Readings	PID	SC23030396CB	Normal	0
592-906020	10/22/2024 7:36	Readings	PID	SC23030396CB	Normal	0
592-906020	10/22/2024 7:35	Readings	PID	SC23030396CB	Normal	0
592-906020	10/22/2024 7:34	Readings	PID	SC23030396CB	Normal	0
592-906020	10/22/2024 7:33	Readings	PID	SC23030396CB	Normal	0
592-906020	10/22/2024 7:32	Readings	PID	SC23030396CB	Normal	0
592-906020	10/22/2024 7:31	Readings	PID	SC23030396CB	Normal	0
592-906020	10/22/2024 7:30	Readings	PID	SC23030396CB	Normal	0
592-906020	10/22/2024 7:29	Readings	PID	SC23030396CB	Normal	0
592-906020	10/22/2024 7:28	Readings	PID	SC23030396CB	Normal	0
592-906020	10/22/2024 7:27	Readings	PID	SC23030396CB	Normal	0
592-906020	10/22/2024 7:26	Readings	PID	SC23030396CB	Normal	0
592-906020	10/22/2024 7:25	Readings	PID	SC23030396CB	Normal	0
592-906020	10/22/2024 7:24	Readings	PID	SC23030396CB	Normal	0
592-906020	10/22/2024 7:23	Readings	PID	SC23030396CB	Normal	0
592-906020	10/22/2024 7:22	Readings	PID	SC23030396CB	Normal	0
592-906020	10/22/2024 7:21	Readings	PID	SC23030396CB	Normal	0
592-906020	10/22/2024 7:20	Readings	PID	SC23030396CB	Normal	0
592-906020	10/22/2024 7:19	Readings	PID	SC23030396CB	Normal	0
592-906020	10/22/2024 7:18	Readings	PID	SC23030396CB	Normal	0
592-906020	10/22/2024 7:17	Readings	PID	SC23030396CB	Normal	0
592-906020	10/22/2024 7:16	Readings	PID	SC23030396CB	Normal	0
592-906020	10/22/2024 7:15	Readings	PID	SC23030396CB	Normal	0
592-906020	10/22/2024 7:14	Readings	PID	SC23030396CB	Normal	0
592-906020	10/22/2024 7:13	Readings	PID	SC23030396CB	Normal	0
592-906020	10/22/2024 7:12	Readings	PID	SC23030396CB	Normal	0
592-906020	10/22/2024 7:11	Readings	PID	SC23030396CB	Normal	0
592-906020	10/22/2024 7:10	CONFIG	PID	SC23030396CB		