

## MONITORING REPORT

**February 27<sup>th</sup>, 2024**

**Site Location:**

BP Service Station  
4001-4011 4<sup>th</sup> Avenue  
Brooklyn, New York  
Spill #1811146

**Client:**

The Macchia Group, Inc.  
Mr. Joseph Macchia  
556 Central Avenue  
Bethpage, NY 11714

**Bailing Schedule:**

Last Performed:

**Monthly**

01/15/2023

**Reporting Schedule:**

Last Performed:

**Quarterly**

11/20/2023

**Objective:**

Monitor site well for depth to groundwater and the presence of free phase product on a monthly basis . Bail product as necessary. Wells monitored from the north side of the well casing with a Sonic Interface Probe. Check regularly for any spills by pump islands, tanks and drains.

**Recovery System:**

Bailing of product until well is dry. On average recharge rate approximately 1.0-1.5 gallons every half hour, although recharge rate varies drastically per event. The varying recharge rate per event effects the amount of product/water mixture recovered.

**Comments:**

Floating product was detected during this monitoring period. Site monitored and product bailed on December 18<sup>th</sup>, 2023, January 15<sup>th</sup>, 2024 and February 27<sup>th</sup>, 2024. Next monitoring and bailing of product scheduled for **March 2024**.

**Reported By:** \_\_\_\_\_ February 29, 2024

Steven Polen/Technician

**Reviewed By:** \_\_\_\_\_ February 29, 2024

Justin Halpin/Project Scientist

## MONITORING WELL MEASUREMENTS

### Site Location:

BP Service Station  
4001-4011 4<sup>th</sup> Avenue  
Brooklyn, New York

### Client:

The Macchia Group, Inc.  
556 Central Avenue  
Bethpage, NY 11714

### Abbreviation Key

<b>DTW</b> - Depth to Water from Casing (ft)	<b>D</b> - Dry	<b>V</b> - Disabled Vehicle over Well
<b>DTP</b> - Depth to Product from Casing (ft)	<b>C</b> - Cannot Locate	<b>R</b> - Recovery Pump in Well
<b>PT</b> - Product Thickness (ft)	<b>G</b> - Gone / Destroyed	
<b>T</b> - Trace Product	<b>D.O.</b> - Dissolved Oxygen	

**December 18<sup>th</sup>, 2023**

<b>Wells</b>	<b>DTW</b>	<b>DTP</b>	<b>PT</b>	<b>VEFR</b>	<b>D.O. (mg/L)</b>
<b>MW-1</b>	<b>21.37'</b>	<b>20.87'</b>	<b>0.5'</b>	<b>23 gal</b>	<b>-</b>

### **Notes:**

Pump truck (VEFR event) to pump water/product (~23 gallons) and on-site drum (~45 gallons)

2" pipe volume=0.16 gallons/foot

monitoring well specs: 2" PVC; 50' to bottom with 25' of screen (25'-50')

2" PVC riser pipe from grade surface to 25' (0-25').

### Abbreviation Key

<b>DTW</b> - Depth to Water from Casing (ft)	<b>D</b> - Dry	<b>V</b> - Disabled Vehicle over Well
<b>DTP</b> - Depth to Product from Casing (ft)	<b>C</b> - Cannot Locate	<b>R</b> - Recovery Pump in Well
<b>PT</b> - Product Thickness (ft)	<b>G</b> - Gone / Destroyed	
<b>T</b> - Trace Product	<b>n/d</b> - non-detect	

## MONITORING WELL MEASUREMENTS

### Site Location:

BP Service Station  
4001-4011 4<sup>th</sup> Avenue  
Brooklyn, New York

### Client:

The Macchia Group, Inc.  
556 Central Avenue  
Bethpage, NY 11714

### Abbreviation Key

<b>DTW</b> - Depth to Water from Casing (ft)	<b>D</b> - Dry	<b>V</b> - Disabled Vehicle over Well
<b>DTP</b> - Depth to Product from Casing (ft)	<b>C</b> - Cannot Locate	<b>R</b> - Recovery Pump in Well
<b>PT</b> - Product Thickness (ft)	<b>G</b> - Gone / Destroyed	
<b>T</b> - Trace Product	<b>D.O.</b> - Dissolved Oxygen	

**January 15<sup>th</sup>, 2024**

<b>Wells</b>	<b>DTW</b>	<b>DTP</b>	<b>PT</b>	<b>Bailed</b>	<b>D.O. (mg/L)</b>
<b>MW-1</b>	<b>24.10'</b>	<b>22.80'</b>	<b>1.3'</b>	<b>15 gal</b>	<b>-</b>

### **Notes:**

well exhibited sufficient recharge

2" pipe volume=0.16 gallons/foot

monitoring well specs: 2" PVC; 50' to bottom with 25' of screen (25'-50')

2" PVC riser pipe from grade surface to 25' (0-25').

### Abbreviation Key

<b>DTW</b> - Depth to Water from Casing (ft)	<b>D</b> - Dry	<b>V</b> - Disabled Vehicle over Well
<b>DTP</b> - Depth to Product from Casing (ft)	<b>C</b> - Cannot Locate	<b>R</b> - Recovery Pump in Well
<b>PT</b> - Product Thickness (ft)	<b>G</b> - Gone / Destroyed	
<b>T</b> - Trace Product	<b>n/d</b> - non-detect	

## MONITORING WELL MEASUREMENTS

**Site Location:**

BP Service Station  
4001-4011 4<sup>th</sup> Avenue  
Brooklyn, New York

**Client:**

The Macchia Group, Inc.  
556 Central Avenue  
Bethpage, NY 11714

**Abbreviation Key**

<b>DTW</b> - Depth to Water from Casing (ft)	<b>D</b> - Dry	<b>V</b> - Disabled Vehicle over Well
<b>DTP</b> - Depth to Product from Casing (ft)	<b>C</b> - Cannot Locate	<b>R</b> - Recovery Pump in Well
<b>PT</b> - Product Thickness (ft)	<b>G</b> - Gone / Destroyed	
<b>T</b> - Trace Product	<b>D.O.</b> - Dissolved Oxygen	

**February 27<sup>th</sup>, 2024**

<b>Wells</b>	<b>DTW</b>	<b>DTP</b>	<b>PT</b>	<b>Bailed</b>	<b>D.O. (mg/L)</b>
<b>MW-1</b>	<b>33.4'</b>	<b>21.08'</b>	<b>12'</b>	<b>5 gal</b>	<b>-</b>

**Notes:**

11 bails of product/water mixture and well went dry.

2" pipe volume=0.16 gallons/foot

monitoring well specs: 2" PVC; 50' to bottom with 25' of screen (25'-50')

2" PVC riser pipe from grade surface to 25' (0-25').

**Abbreviation Key**

<b>DTW</b> - Depth to Water from Casing (ft)	<b>D</b> - Dry	<b>V</b> - Disabled Vehicle over Well
<b>DTP</b> - Depth to Product from Casing (ft)	<b>C</b> - Cannot Locate	<b>R</b> - Recovery Pump in Well
<b>PT</b> - Product Thickness (ft)	<b>G</b> - Gone / Destroyed	
<b>T</b> - Trace Product	<b>n/d</b> - non-detect	

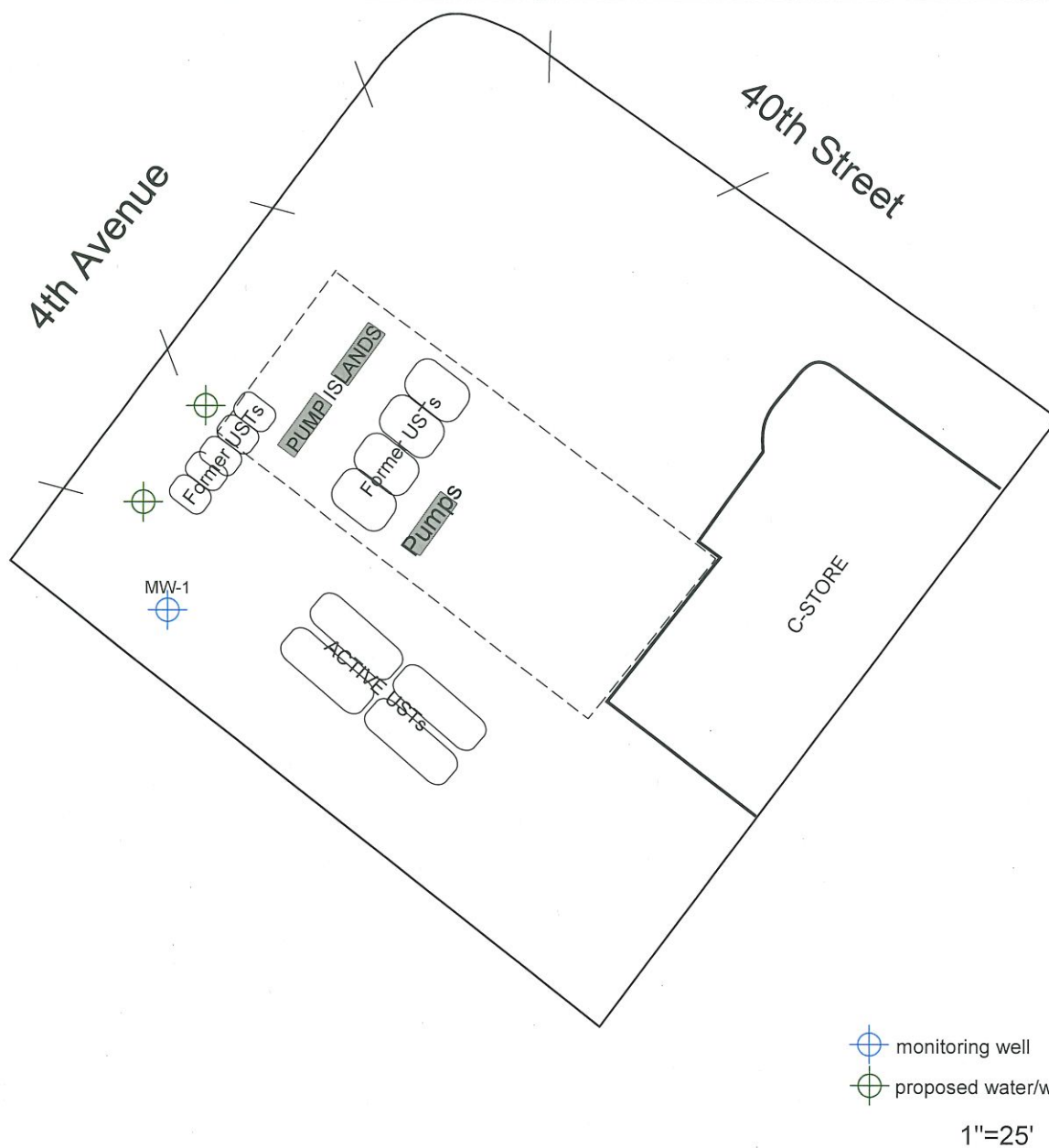

Site Map  
Proposed Sampling Locations  
Figure-1

BP Service Station  
4001-4010 4th Avenue  
Brooklyn, NY

**BEi** Berninger  
Environmental  
groundwater consultants, geologists and scientists  
A WRS Environmental Services Company  
Phone: 631 589 6521  
17 Old Dock Road Yaphank, NY 11980