

SITE OBSERVATION REPORT

PROJECT No.: 170381202 PROJECT: 250 Water Street LOCATION: New York, NY BCP SITE ID: C231127	CLIENT: 250 Seaport District, LLC c/o The Howard Hughes Corporation	DATE: Sunday, July 24, 2022 WEATHER: Sunny, 85.0 – 90.0 °F Wind: WSW @ 0.0 – 12.0 mph TIME: 8:45 AM – 11:30 AM MONITOR: Farielle Brazier
---	--	--

EQUIPMENT: MiniRAE 3000 PID Jerome J505® Sullair 185	PRESENT AT SITE: Langan (Environmental/Geotechnical) – Farielle Brazier Civetta Cousins JV, LLC (CCJV) (Foundation Contractor)	Day 47
--	---	---------------

OBSERVATIONS, DISCUSSIONS, TEST RESULTS, ETC.:

Langan was present to document remediation activities in accordance with the NYSDEC-approved November 2021 Remedial Action Work Plan (RAWP) at the 250 Water Street site (NYSDEC Brownfield Cleanup Program [BCP] Site No. C231127).

Site Activities

- CCJV covered all exposed soil/fill and construction and demolition (C&D) debris with polyethylene sheeting and/or Atmos® AC-645 dust/vapor suppressing foam to create a temporary overnight cover prior to resuming work on Monday, July 25, 2022.

Cc:	M. Raygorodetsky, P. McMahon, M. Au	By:	Farielle Brazier
			LANGAN

SITE OBSERVATION REPORT

Material Tracking

- No material was imported to the site.
- No material was exported from the site.

Material Import Summary						
Facility Name Location Type of Material	Stone Industries, Inc. Haledon, NJ 1.5/2.5-inch Virgin Stone		Stone Industries, Inc. Haledon, NJ 0.75-inch Virgin Stone		Impact Reuse & Recovery or Impact Materials Jersey City, Lyndhurst/Jersey City, NJ 1.5 inch Clean Bluestone	
Quantities	No. of Loads	Approx. Volume (Tons)	No. of Loads	Approx. Volume (Tons)	No. of Loads	Approx. Volume (Tons)
Today	0	0	0	0	0	0
Total	7	161.51	0	0	2	41.23
NYSDEC Approved:	1,000 CY				400 CY	

Material Export Summary						
Facility Name Location Type of Material	Allocco Recycling Brooklyn, NY Construction & Demolition (C&D) Debris		IRRC Lyndhurst, NJ Construction & Demolition (C&D) Debris		Clean Earth of North Jersey Kearny, NJ Hazardous Lead-Impacted Soil/Fill	
Quantities	No. of Loads	Approx. Volume (CY)	No. of Loads	Approx. Volume (CY)	No. of Loads	Approx. Volume (CY)
Today	0	0	0	0	0	0
Total	5	85	6	120	14	280

Sampling Activities

- No samples were collected.

Cc: M. Raygorodetsky, P. McMahon, M. Au

By: Farielle Brazier

LANGAN

SITE OBSERVATION REPORT

CAMP Activities

Community Air Monitoring Plan (CAMP) was not implemented, as there were no ground-intrusive activities ongoing at the site. Langan performed ambient air monitoring across the site using a handheld photoionization detector (PID) and handheld Jerome® J505 mercury vapor analyzer during reinstallation of the temporary overnight cover.

Ambient Air (Handheld Jerome® J505 and Handheld PID)

- The dedicated mobile monitor (Langan) used a handheld Jerome® J505 mercury vapor analyzer to monitor ambient air conditions at various heights throughout the site. Instantaneous mercury vapor concentrations throughout the site ranged from 0.00 µg/m³ to 0.13 µg/m³.
- The dedicated mobile monitor (Langan) used a handheld PID to monitor VOC concentrations throughout the site. VOC concentrations were at or below background concentrations throughout the work day.

Anticipated Activities

- UBS will begin relocation of the perimeter construction fence along the northern sidewalk of Water Street.
- CCJV will continue excavating test pits to identify potential subsurface utilities and/or obstructions prior to SOE soldier pile installation along the southern boundary of the site.
- CCJV will continue installation of SOE soldier piles along the eastern boundary of the site.
- CCJV will continue installation of T-brackets along the edges of soldier piles to accommodate timber lagging installation.
- CCJV will continue installation of timber lagging between soldier piles.
- CCJV will excavate soil/fill in the mercury-impacted area for off-site disposal to the Clean Earth of North Jersey (CENJ) facility, located in Kearny, NJ.

Cc:	M. Raygorodetsky, P. McMahan, M. Au	By:	Farielle Brazier
			LANGAN

SITE OBSERVATION REPORT

Site Map

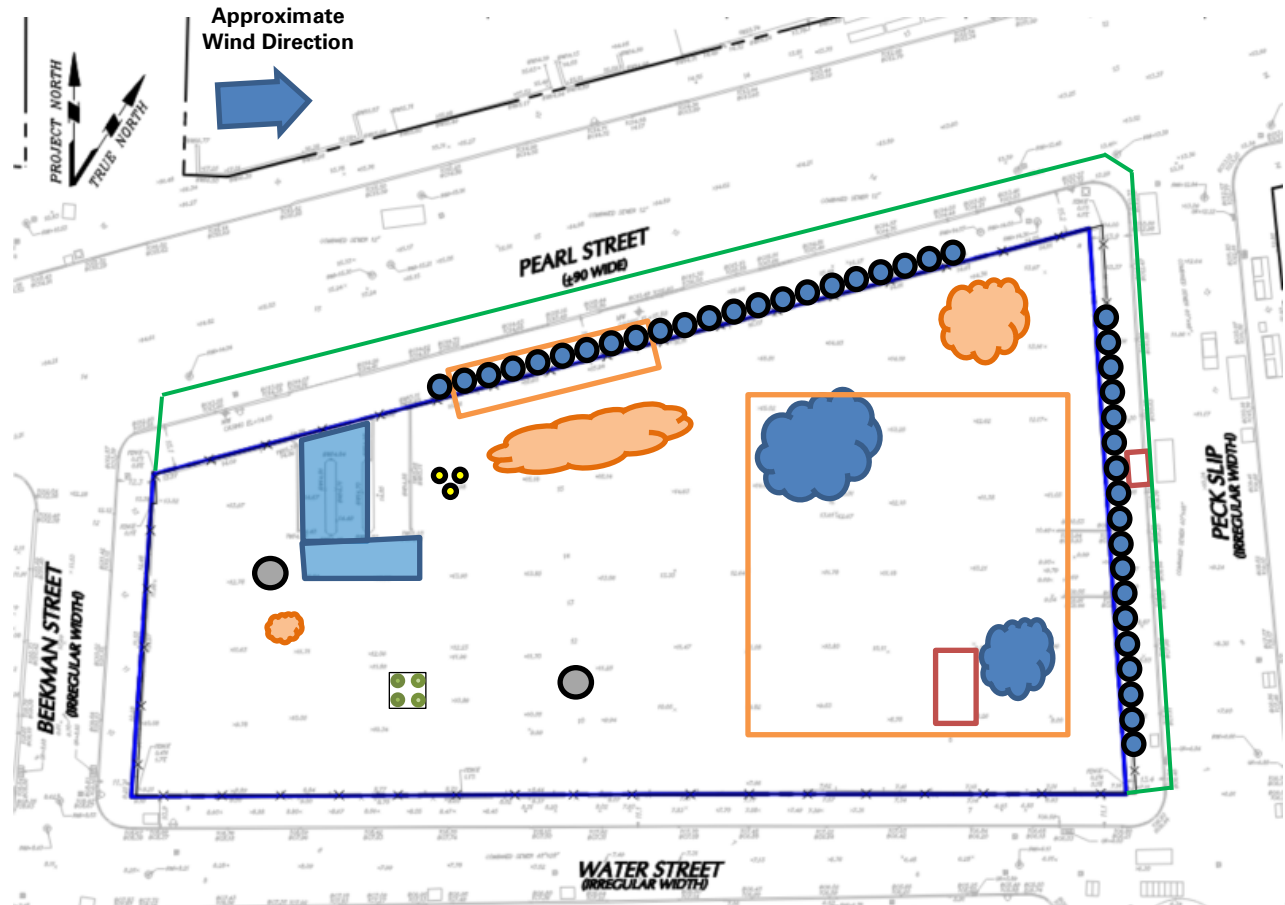

Notes:

1) Locations of air monitoring stations are approximate.

Legend:

- Approximate Location of Air Monitoring Station
- Approximate Work Area
- Approximate Location of Installed Pile Cap
- Approximate Location of Foundation Piles Completed
- Approximate Location of Truck Tracking Pad
- Approximate Location of C&D Stockpile
- Approximate Location of Soil/Fill Container
- Approximate Location of Soil/Fill Stockpile
- Approximate location of USTs

- Approximate Location of Stockpiled Virgin Stone
- Approximate Location of 55-gallon drum
- Approximate Location of Test Pile
- Approximate Location of Soldier Pile
- Approximate Perimeter Construction Fence Location
- Approximate Fence Relocation Area
- Approximate Excavation Area

Cc: M. Raygorodetsky, P. McMahon, M. Au

By: Farielle Brazier

LANGAN

SITE OBSERVATION REPORT

Select Site Photographs:



Photo 1: Atmos® AC-645 dust/vapor suppressing foam re-applied to exposed soil/fill along the northern boundary of the site (facing northwest).

Cc:	M. Raygorodetsky, P. McMahan, M. Au	By:	Farielle Brazier LANGAN
-----	-------------------------------------	-----	-----------------------------------