

## SITE OBSERVATION REPORT

<b>PROJECT No.:</b> 170381202	<b>CLIENT:</b> 250 Seaport District, LLC c/o The Howard Hughes Corporation	<b>DATE:</b> Thursday, August 3, 2023
<b>PROJECT:</b> 250 Water Street		<b>WEATHER:</b> Sunny, 71 – 81° F Wind: NW @ 0.3 – 2.8 mph
<b>LOCATION:</b> New York, NY		<b>TIME:</b> 5:45am – 5:00pm
<b>BCP SITE ID:</b> C231127		<b>MONITOR</b> Jack Millman

<b>EQUIPMENT:</b> CAT 335 Excavator Komatsu PC138 Excavator ABI Mobilram Drill Rig Jerome J505 Mercury Vapor Analyzer RKI GX-6000 Photoionization Detector (PID) Aeroqual ASQ1 Air Monitoring Station	<b>PRESENT AT SITE:</b> <b>Day 174</b> <b>Langan</b> (Environmental/Geotechnical) Jack Millman, Aron Farber, Tom Keane <b>Suffolk Construction (Suffolk)</b> (General Contractor) Anthony Galu <b>East Coast Drilling, Inc. (ECD)</b> (Foundation Contractor) Ryan Nugent <b>New York State Department of Environmental Conservation (NYSDEC)</b> Jared Donaldson <b>TRC Companies Inc. (TRC)</b> (NYSDEC Consultant)
---	--

**OBSERVATIONS, DISCUSSIONS, TEST RESULTS, ETC.:**

Langan was present to document remediation activities in accordance with the NYSDEC-approved November 2021 Remedial Action Work Plan (RAWP) at the 250 Water Street site (NYSDEC Brownfield Cleanup Program [BCP] Site No C231127).

**Site Activities**

- ECD graded an about 15-foot-long by 50-foot-wide area to facilitate support of excavation (SOE) installation in the southwestern part of the site (along Water Street).
  - Graded soil/fill was screened for odors, staining, organic vapors, and mercury vapor using a handheld PID and handheld Jerome® J505 mercury vapor analyzer, respectively. No evidence of impacts was observed.
- ECD used an ABI Mobilram drill rig to install four soil mix columns to about 35 feet below grade surface (bgs) for SOE installation in the southwestern part of the site (Water Street). ECD’s drill rig advanced steel rods with a soil mixing paddle at the bottom of the rods, while concurrently injecting grout through the top of the paddle and spinning and advancing the paddle downward.
  - No drilling spoils were generated during installation of the soil mix columns.
  - Excess grout was contained within a temporary trench adjacent to the drilling area and will be managed as construction and demolition (C&D) debris at a later date.
- TRC continued implementation of the off-site investigation administered by the NYSDEC.

<b>Cc:</b>	M. Raygorodetsky, P. McMahon, M. Au, J. Frey, S. Simpson	<b>By:</b>	Jack Millman <b>LANGAN</b>
------------	--	------------	-------------------------------

## SITE OBSERVATION REPORT

### Material Tracking

- No material was exported from the site.
- No material was imported to the site.

#### Material Import Summary

Facility Name Location Type of Material	Stone Industries, Inc. Haledon, NJ 1.5/2.5-inch Virgin Stone		Stone Industries, Inc. Haledon, NJ 0.75-inch Virgin Stone		Impact Reuse & Recovery Center or Impact Materials Jersey City, Lyndhurst/Jersey City, NJ 1.5-inch Clean Bluestone		Impact Reuse & Recovery Center, Lyndhurst, NJ General Fill	
Quantities	No. of Loads	Approx. Volume (Tons)	No. of Loads	Approx. Volume (Tons)	No. of Loads	Approx. Volume (Tons)	No. of Loads	Approx. Volume (Tons)
Today	0	0	0	0	0	0	0	0
Project Total	8	184.42	0	0	15	339.65	374	9,157.85
NYSDEC Approved:	1,800 tons*			720 tons*		19,500 tons*		

\*0.75-inch, 1.5-inch, and 2.5-inch virgin stone from the Stone Industries, Inc. facility and 1.5-inch clean bluestone from the Impact Reuse & Recovery Center (IRRC) facility were approved for import of 1,000 cubic yards (CY) and 400 CY, respectively. Assuming a conversion factor of 1.8, each quantity was converted to tons in order to accurately compare with import weight tickets. General fill from the IRRC facility was approved for import of 13,000 CY and a conversion factor of 1.5 is applied.

#### Material Export Summary (1 of 3)

Facility Name Location Type of Material	Allocco Recycling Brooklyn, NY Construction & Demolition (C&D) Debris		IRRC Lyndhurst, NJ C&D Debris		Earth Efficient MSM East Stroudsburg, PA C&D Debris		Clean Earth of North Jersey Kearny, NJ Hazardous Lead-Impacted Soil/Fill	
Quantities	No. of Loads	Approx. Volume (CY)	No. of Loads	Approx. Volume (CY)	No. of Loads	Approx. Volume (CY)	No. of Loads	Approx. Volume (CY)
Today	0	0	0	0	0	0	0	0
Project Total	5	85	42	840	14	280	95	1,900

#### Material Export Summary (2 of 3)

Facility Name Location Type of Material	Middlesex County Landfill East Brunswick, NJ Non-hazardous Soil/Fill		Bayshore Soil Management Keasbey, NJ Petroleum-Impacted Soil/Fill		Clean Earth of Carteret, NJ Carteret, NJ Non-hazardous Soil/Fill	
Quantities	No. of Loads	Approx. Volume (CY)	No. of Loads	Approx. Volume (CY)	No. of Loads	Approx. Volume (CY)
Today	0	0	0	0	0	0
Project Total	263	5,260	267	5,340	66	1,320

Cc:	M. Raygorodetsky, P. McMahon, M. Au, J. Frey, S. Simpson	By:	Jack Millman <b>LANGAN</b>
-----	---	-----	-------------------------------

## SITE OBSERVATION REPORT

Material Export Summary (3 of 3)		
Facility Name Location Type of Material	Clean Earth of North Jersey Kearny, NJ Non-hazardous Soil/Fill	
Quantities	No. of Loads	Approx. Volume (CY)
Today	0	0
Project Total	216	4,320

### Sampling

- No samples were collected.

Cc:	M. Raygorodetsky, P. McMahon, M. Au, J. Frey, S. Simpson	By:	Jack Millman <b>LANGAN</b>
-----	---	-----	-------------------------------

## SITE OBSERVATION REPORT

### CAMP Activities

Langan performed air monitoring at the perimeter of the site, at the northern sidewalk of Pearl Street, at the western sidewalk of Beekman Street, at the eastern sidewalk of Peck Slip, and at the southern sidewalk of Water Street at eight total locations for mercury vapor, volatile organic compounds (VOCs), and particulate matter less than 10 microns in diameter (PM10) from about 6:45am to 3:40pm. There were no fifteen-minute average concentrations for mercury vapor, VOCs or PM10 that approached or exceeded the action levels established by the CAMP (1.00  $\mu\text{g}/\text{m}^3$ , 5.0 ppm, or 0.100  $\text{mg}/\text{m}^3$ , respectively).

### Background Concentrations

Prior to implementation of CAMP, instantaneous background concentrations of mercury vapor and VOCs were recorded using a handheld Jerome<sup>®</sup> J505 mercury vapor analyzer and a handheld PID, respectively.

- Background concentrations of mercury vapor at each CAMP station were recorded at 0.00  $\text{g}/\text{m}^3$ .
- Background concentrations of VOCs at each CAMP station were recorded at 0.0 ppm.

### Perimeter and Work Zone Concentrations

#### Daily Average Concentrations

Station ID	Particulate ( $\text{mg}/\text{m}^3$ )	Organic Vapor (ppm)	Mercury Vapor ( $\mu\text{g}/\text{m}^3$ )
PM-1	0.004	0.00	0.01
PM-2	0.003	0.00	0.00
PM-3	0.003	0.00	0.00
PM-4	0.003	0.00	0.01
WZ-1	0.003	0.00	0.00
WZ-2	0.003	0.00	0.00
WZ-3	0.002	0.00	0.01
WZ-4	0.003	0.00	0.01

#### Maximum 15-Minute-Average Concentrations

Station ID	Particulate ( $\text{mg}/\text{m}^3$ )	Organic Vapor (ppm)	Mercury Vapor ( $\mu\text{g}/\text{m}^3$ )
PM-1	0.010	0.00	0.02
PM-2	0.005	0.06	0.02
PM-3	0.003	0.00	0.00
PM-4	0.006	0.00	0.03
WZ-1	0.006	0.00	0.00
WZ-2	0.009	0.01	0.01
WZ-3	0.003	0.00	0.02
WZ-4	0.004	0.00	0.04

• $\text{mg}/\text{m}^3$  = milligrams per cubic meter    •ppm = parts per million    • $\mu\text{g}/\text{m}^3$  = micrograms per cubic meter

Cc:	M. Raygorodetsky, P. McMahon, M. Au, J. Frey, S. Simpson	By:	Jack Millman
	<b>LANGAN</b>		

## SITE OBSERVATION REPORT

### Equipment Troubleshooting

- PM10, VOC, and mercury vapor concentrations were not recorded at perimeter CAMP stations PM-2 and PM-3 from 10:32am to 10:42am and from 11:40am to 11:50am, respectively, due to depleted batteries requiring replacement. Data logging for perimeter CAMP stations PM-2 and PM-3 resumed at 10:43am and 11:51am, respectively, after replacement of the batteries. Off-site CAMP stations WZ-2 and WZ-3, located on the Water Street and Peck Slip sidewalks, respectively, did not detect PM10, VOCs, or mercury vapor above daily background concentrations during these periods.

### Ambient Air (Handheld Jerome® J505 and Handheld PID)

- The dedicated mobile monitor (Langan) used a handheld Jerome® J505 mercury vapor analyzer to monitor ambient air conditions at various heights throughout the site. Instantaneous mercury vapor concentrations throughout the site ranged from 0.00  $\mu\text{g}/\text{m}^3$  to 0.15  $\mu\text{g}/\text{m}^3$ .
- The dedicated mobile monitor (Langan) used a handheld PID to monitor VOC concentrations throughout the site. Instantaneous VOC concentrations were not detected above background concentrations throughout the workday.

### Off-site CAMP Stations

- CAMP station WZ-1 was placed on the western sidewalk of Beekman Street from 6:19am to 3:54pm.
- CAMP station WZ-2 was placed on the southern sidewalk of Water Street from 6:22am to 4:00pm.
- CAMP station WZ-3 was placed on the eastern sidewalk of Peck Slip from 6:27am to 4:17pm.
- CAMP station WZ-4 was placed on the northern sidewalk of Pearl Street from 6:32am to 4:28pm.

### Prior to CAMP Shutdown

Prior to discontinuing CAMP, mercury vapor and VOC concentrations were confirmed to return to background conditions at each perimeter station using the handheld Jerome® J505 mercury vapor analyzer and handheld PID, respectively. Perimeter CAMP stations were discontinued sequentially between 3:40pm and 3:49pm.

- Background concentrations of mercury vapor at each CAMP station were recorded at 0.00  $\mu\text{g}/\text{m}^3$ .
- Background concentrations of VOCs at each CAMP station were recorded at 0.0 ppm.

### Anticipated Activities

- ECD will continue exporting C&D and soil/fill from the western part of the site for off-site disposal.
- ECD will continue constructing wooden formwork in preparation for concrete guide wall installation in the eastern part of the site.
- ECD will continue installing soil mixing columns for SOE installation along Water Street.

Cc:	M. Raygorodetsky, P. McMahon, M. Au, J. Frey, S. Simpson	By:	Jack Millman <b>LANGAN</b>
-----	--	-----	-------------------------------

## SITE OBSERVATION REPORT

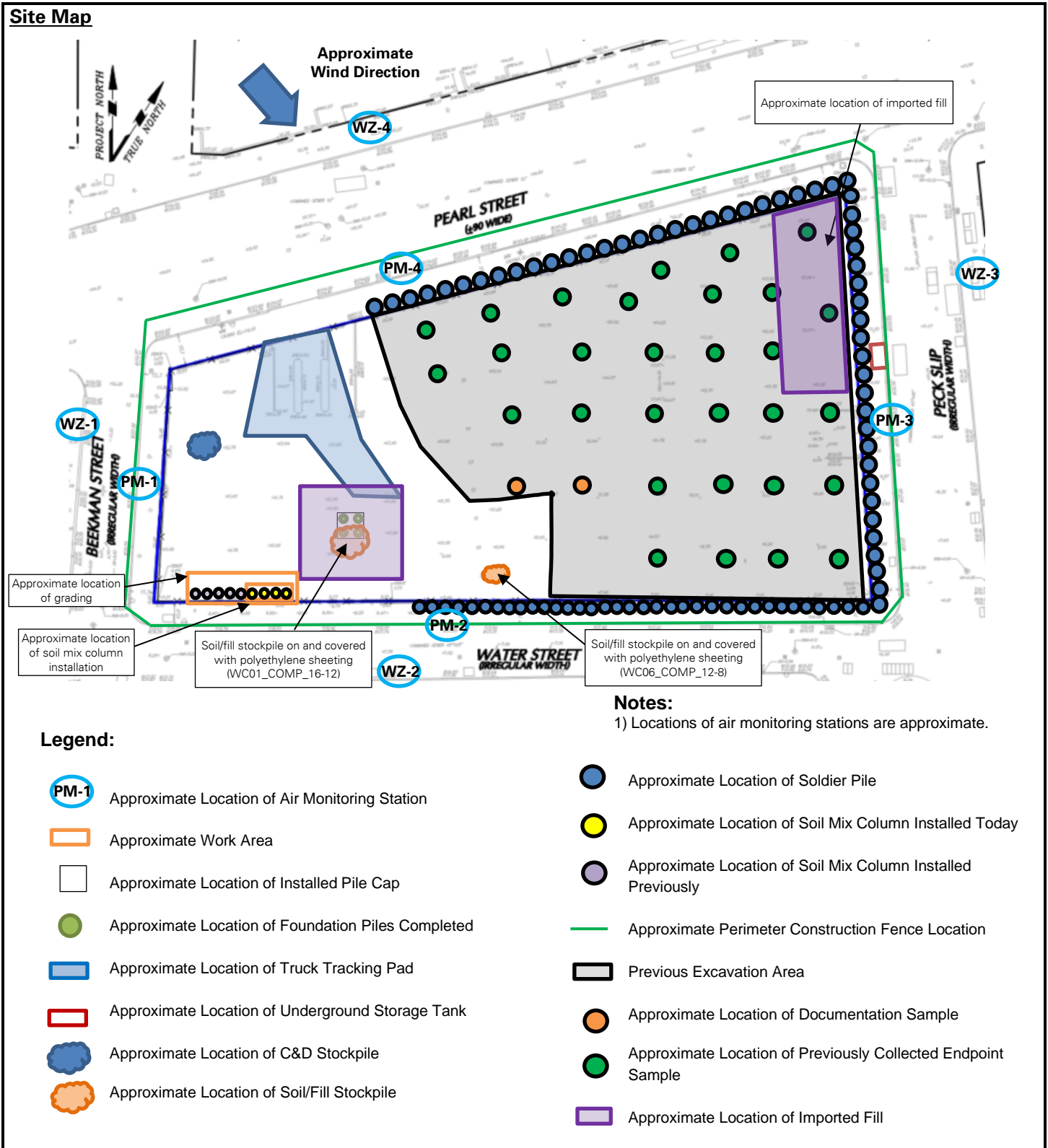

Cc:	M. Raygorodetsky, P. McMahon, M. Au, J. Frey, S. Simpson	By:	Jack Millman <b>LANGAN</b>
-----	--	-----	-------------------------------

## SITE OBSERVATION REPORT

### Select Site Photographs:



**Photo 1:** ECD advancing a soil mix column in the southwestern part of the site (facing southwest)



**Photo 2:** ECD grading soil/fill in the southwestern part of the site (facing southeast)

Cc:	M. Raygorodetsky, P. McMahon, M. Au, J. Frey, S. Simpson	By:	Jack Millman <b>LANGAN</b>
-----	--	-----	-------------------------------