

## SITE OBSERVATION REPORT

<p><b>PROJECT No.:</b> 170381202</p> <p><b>PROJECT:</b> 250 Water Street</p> <p><b>LOCATION:</b> New York, NY</p> <p><b>BCP SITE ID:</b> C231127</p>	<p><b>CLIENT:</b> 250 Seaport District, LLC c/o The Howard Hughes Corporation</p>	<p><b>DATE:</b> Wednesday, September 20, 2023</p> <p><b>WEATHER:</b> Sunny, 58 – 74° F Wind: NE @ 0.1 – 2.0 mph</p> <p><b>TIME:</b> 5:45am – 9:45pm</p> <p><b>MONITOR</b> Jack Millman</p>
<p><b>EQUIPMENT:</b> CAT 335 Excavator CAT 328 Excavator Komatsu PC138 Excavator Delmag Drill Rig Bauer RTG RG 27S Bauer BG45 Drill Rig Jerome J505 Mercury Vapor Analyzer RKI GX-6000 Photoionization Detector (PID) Aeroqual ASQ1 Air Monitoring Station</p>	<p><b>PRESENT AT SITE:</b> <b>Day 207</b> <b>Langan</b> (Environmental/Geotechnical) Jack Millman, Michael Cole, Olivia O'Donnell, Pradeep Pandey <b>Suffolk Construction (Suffolk)</b> (General Contractor) Anthony Galu, Wyatt Favia <b>East Coast Drilling, Inc. (ECD)</b> (Foundation Contractor) Danny Rodgers <b>New York State Department of Environmental Conservation (NYSDEC)</b> Marnie Chancey <b>AKRF, Inc.</b> (Archaeologist) Theresa Imbriolo</p>	
<p><b>OBSERVATIONS, DISCUSSIONS, TEST RESULTS, ETC.:</b></p>		
<p>Langan was present to document remediation activities in accordance with the NYSDEC-approved November 2021 Remedial Action Work Plan (RAWP) at the 250 Water Street site (NYSDEC Brownfield Cleanup Program [BCP] Site No C231127).</p>		
<p><b>Site Activities</b></p>		
<ul style="list-style-type: none"> <li>• ECD excavated an about 15-foot-long by 30-foot-wide area to a maximum depth of about 8 feet below grade surface (bgs) in the southwest part of the site (waste characterization cell WC03) to facilitate installation of tiebacks as part of the support-of-excavation (SOE) system.             <ul style="list-style-type: none"> <li>○ Excavated soil/fill was screened for odors, staining, organic vapors, and mercury vapor using a handheld photoionization detector (PID) and handheld Jerome® J505 mercury vapor analyzer, respectively. Evidence of impacts was not observed and the excavated soil/fill was live-loaded into securely covered tri-axle dump trucks for off-site disposal.</li> </ul> </li> <li>• ECD excavated an about 25-foot-long by 25-foot-wide area to a maximum depth of about 8 feet bgs in the southwest part of the site (waste characterization cell WC03) to locate the suspected underground storage tank (UST) identified during a prior geophysical survey.             <ul style="list-style-type: none"> <li>○ A UST was not identified within the excavation area. Additional exploratory excavation will be completed following removal and off-site disposal of soil/fill at a later date.</li> <li>○ Excavated soil/fill was screened for odors, staining, organic vapors, and mercury vapor using a handheld photoionization detector (PID) and handheld Jerome® J505 mercury vapor analyzer, respectively. Evidence of impacts was not observed and the excavated soil/fill was temporarily backfilled into the original location for future off-site disposal.</li> </ul> </li> <li>• ECD attempted to install one deep soil mix column for SOE installation in the southeast part of the site (along Water Street). ECD's drill rig advanced a steel rod with two cutter blades at the bottom of the rod, while concurrently injecting grout through the cutting head and spinning and advancing the blades downward. The</li> </ul>		
<p>Cc:</p>	<p>M. Raygorodetsky, P. McMahon, M. Au, J. Frey, S. Simpson</p>	<p>By: Jack Millman <b>LANGAN</b></p>

## SITE OBSERVATION REPORT

soil mix column was partially drilled to a depth of about 60 feet bgs before the drill head became lodged in the borehole due to an apparent obstruction.

- o No drilling spoils were generated during installation of the soil mix column.
- o Excess grout was contained within a temporary containment area in the eastern part of the site and will be managed as construction and demolition (C&D) debris at a later date.
- o Hydrant water was continuously pumped through the cutting head and additional boreholes were advanced adjacent to the soil mix column to dislodge the drill rig.

### Material Tracking

- ECD exported two truckloads (about 40 cubic yards [CY]) of non-hazardous soil/fill for off-site disposal at the Middlesex County Landfill, located in East Brunswick, NJ.
- ECD exported six truckloads (about 120 CY) of C&D debris for off-site disposal at the Earth Efficient MSM facility located in East Stroudsburg, PA.
- No material was imported to the site.

Material Import Summary								
Facility Name Location Type of Material	Stone Industries, Inc. Haledon, NJ 1.5/2.5-inch Virgin Stone		Stone Industries, Inc. Haledon, NJ 0.75-inch Virgin Stone		Impact Reuse & Recovery Center or Impact Materials Jersey City, Lyndhurst/Jersey City, NJ 1.5-inch Clean Bluestone		Impact Reuse & Recovery Center, Lyndhurst, NJ General Fill	
Quantities	No. of Loads	Approx. Volume (Tons)	No. of Loads	Approx. Volume (Tons)	No. of Loads	Approx. Volume (Tons)	No. of Loads	Approx. Volume (Tons)
Today	0	0	0	0	0	0	0	0
Project Total	12	283.91	0	0	15	339.65	374	9,157.85
NYSDEC Approved:	1,800 tons*				720 tons*		19,500 tons*	

\*0.75-inch, 1.5-inch, and 2.5-inch virgin stone from the Stone Industries, Inc. facility and 1.5-inch clean bluestone from the Impact Reuse & Recovery Center (IRRC) facility were approved for import of 1,000 cubic yards (CY) and 400 CY, respectively. Assuming a conversion factor of 1.8, each quantity was converted to tons in order to accurately compare with import weight tickets. General fill from the IRRC facility was approved for import of 13,000 CY and a conversion factor of 1.5 is applied.

Material Export Summary (1 of 3)								
Facility Name Location Type of Material	Allocco Recycling Brooklyn, NY Construction & Demolition (C&D) Debris		IRRC Lyndhurst, NJ C&D Debris		Earth Efficient MSM East Stroudsburg, PA C&D Debris		Clean Earth of North Jersey Kearny, NJ Hazardous Lead-Impacted Soil/Fill	
Quantities	No. of Loads	Approx. Volume (CY)	No. of Loads	Approx. Volume (CY)	No. of Loads	Approx. Volume (CY)	No. of Loads	Approx. Volume (CY)
Today	0	0	0	0	6	120	0	0
Project Total	5	85	42	840	59	1,180	95	1,900

Cc:	M. Raygorodetsky, P. McMahon, M. Au, J. Frey, S. Simpson	By:	Jack Millman <b>LANGAN</b>
-----	---	-----	-------------------------------

## SITE OBSERVATION REPORT

### Material Export Summary (2 of 3)

Facility Name Location Type of Material	Middlesex County Landfill East Brunswick, NJ Non-hazardous Soil/Fill		Bayshore Soil Management Keasbey, NJ Petroleum-Impacted Soil/Fill		Clean Earth of Carteret, NJ Carteret, NJ Non-hazardous Soil/Fill	
Quantities	No. of Loads	Approx. Volume (CY)	No. of Loads	Approx. Volume (CY)	No. of Loads	Approx. Volume (CY)
Today	2	40	0	0	0	0
Project Total	284	5,680	267	5,340	66	1,320

### Material Export Summary (3 of 3)

Facility Name Location Type of Material	Clean Earth of North Jersey Kearny, NJ Non-hazardous Soil/Fill		Cycle Chem, Inc. Elizabeth, NJ Hazardous Lead - Impacted Soil/Fill	
Quantities	No. of Loads	Approx. Volume (CY)	No. of Loads	Approx. Volume (CY)
Today	0	0	0	0
Project Total	201	4,020	10	200

### Sampling

- No samples were collected.

Cc:	M. Raygorodetsky, P. McMahon, M. Au, J. Frey, S. Simpson	By:	Jack Millman <b>LANGAN</b>
-----	--	-----	-------------------------------

## SITE OBSERVATION REPORT

### CAMP Activities

Langan performed air monitoring at the perimeter of the site, at the northern sidewalk of Pearl Street, at the western sidewalk of Beekman Street, at the eastern sidewalk of Peck Slip, and at the southern sidewalk of Water Street at eight total locations for mercury vapor, volatile organic compounds (VOCs), and particulate matter less than 10 microns in diameter (PM10) from about 7:05am to 9:11pm. There were no fifteen-minute average concentrations for mercury vapor, VOCs or PM10 that approached or exceeded the action levels established by the CAMP (1.00  $\mu\text{g}/\text{m}^3$ , 5.0 ppm, or 0.100  $\text{mg}/\text{m}^3$ , respectively).

### Background Concentrations

Prior to implementation of CAMP, instantaneous background concentrations of mercury vapor and VOCs were recorded using a handheld Jerome® J505 mercury vapor analyzer and a handheld PID, respectively.

- Background concentrations of mercury vapor at each CAMP station were recorded at 0.00  $\mu\text{g}/\text{m}^3$ .
- Background concentrations of VOCs at each CAMP station were recorded at 0.0 ppm.

### Perimeter and Work Zone Concentrations

#### Daily Average Concentrations

Station ID	Particulate ( $\text{mg}/\text{m}^3$ )	Organic Vapor (ppm)	Mercury Vapor ( $\mu\text{g}/\text{m}^3$ )
PM-1	0.005	0.00	0.02
PM-2	0.005	0.00	0.01
PM-3	0.006	0.00	0.00
PM-4	0.005	0.00	0.01
WZ-1	0.005	0.00	0.00
WZ-2	0.005	0.00	0.00
WZ-3	0.004	0.00	0.00
WZ-4	0.005	0.00	0.01

#### Maximum 15-Minute-Average Concentrations

Station ID	Particulate ( $\text{mg}/\text{m}^3$ )	Organic Vapor (ppm)	Mercury Vapor ( $\mu\text{g}/\text{m}^3$ )
PM-1	0.011	0.01	0.04
PM-2	0.011	0.00	0.02
PM-3	0.012	0.16	0.00
PM-4	0.012	0.06	0.03
WZ-1	0.012	0.00	0.01
WZ-2	0.011	0.00	0.01
WZ-3	0.010	0.01	0.02
WZ-4	0.013	0.00	0.02

• $\text{mg}/\text{m}^3$  = milligrams per cubic meter    •ppm = parts per million    • $\mu\text{g}/\text{m}^3$  = micrograms per cubic meter

Cc:	M. Raygorodetsky, P. McMahon, M. Au, J. Frey, S. Simpson	By:	Jack Millman
			<b>LANGAN</b>

## SITE OBSERVATION REPORT

### CAMP Implementation

- CAMP implementation continued at all eight perimeter and off-site stations until about 7:15pm. Following concurrence with NYSDEC's on-site personnel, select CAMP stations were discontinued to conserve battery power and focus on the work area during removal of the drill head. Perimeter/off-site CAMP stations PM-2, PM-3, WZ-2, and WZ-3 continued collecting data between about 7:15pm and 9:07pm, with brief pauses required to swap the depleted batteries. PM10, VOC and mercury vapor concentrations were not recorded above background conditions during this time.

### Ambient Air (Handheld Jerome® J505 and Handheld PID)

- The dedicated mobile monitor (Langan) used a handheld Jerome® J505 mercury vapor analyzer to monitor ambient air conditions at various heights throughout the site. Instantaneous mercury vapor concentrations throughout the site ranged from 0.00  $\mu\text{g}/\text{m}^3$  to 0.09  $\mu\text{g}/\text{m}^3$ .
- The dedicated mobile monitor (Langan) used a handheld PID to monitor VOC concentrations throughout the site. Instantaneous VOC concentrations were not detected above background concentrations throughout the workday.

### Off-site CAMP Stations

- CAMP station WZ-1 was placed on the western sidewalk of Beekman Street from about 6:44am to 7:15pm.
- CAMP station WZ-2 was placed on the southern sidewalk of Water Street from about 6:45am to 9:18pm.
- CAMP station WZ-3 was placed on the eastern sidewalk of Peck Slip from about 6:47am to 9:25pm.
- CAMP station WZ-4 was placed on the northern sidewalk of Pearl Street from about 6:50am to 7:25pm.

### Prior to CAMP Shutdown

Prior to discontinuing CAMP, mercury vapor and VOC concentrations were confirmed to return to background conditions at each perimeter station using the handheld Jerome® J505 mercury vapor analyzer and handheld PID, respectively. Perimeter CAMP stations PM-1 and PM-4 were discontinued between 7:49pm and 7:59pm and stations PM-2 and PM-3 were discontinued between 9:08pm and 9:11pm.

- Background concentrations of mercury vapor at each CAMP station were recorded at 0.00  $\mu\text{g}/\text{m}^3$ .
- Background concentrations of VOCs at each CAMP station were recorded at 0.0 ppm.

### Anticipated Activities

- ECD will continue exporting C&D and soil/fill from the western part of the site for off-site disposal.
- ECD will continue installing soil mix columns and/or soldier piles for SOE installation along Pearl Street, Water Street, and Peck Slip.

Cc:	M. Raygorodetsky, P. McMahon, M. Au, J. Frey, S. Simpson	By:	Jack Millman <b>LANGAN</b>
-----	---	-----	-------------------------------

## SITE OBSERVATION REPORT

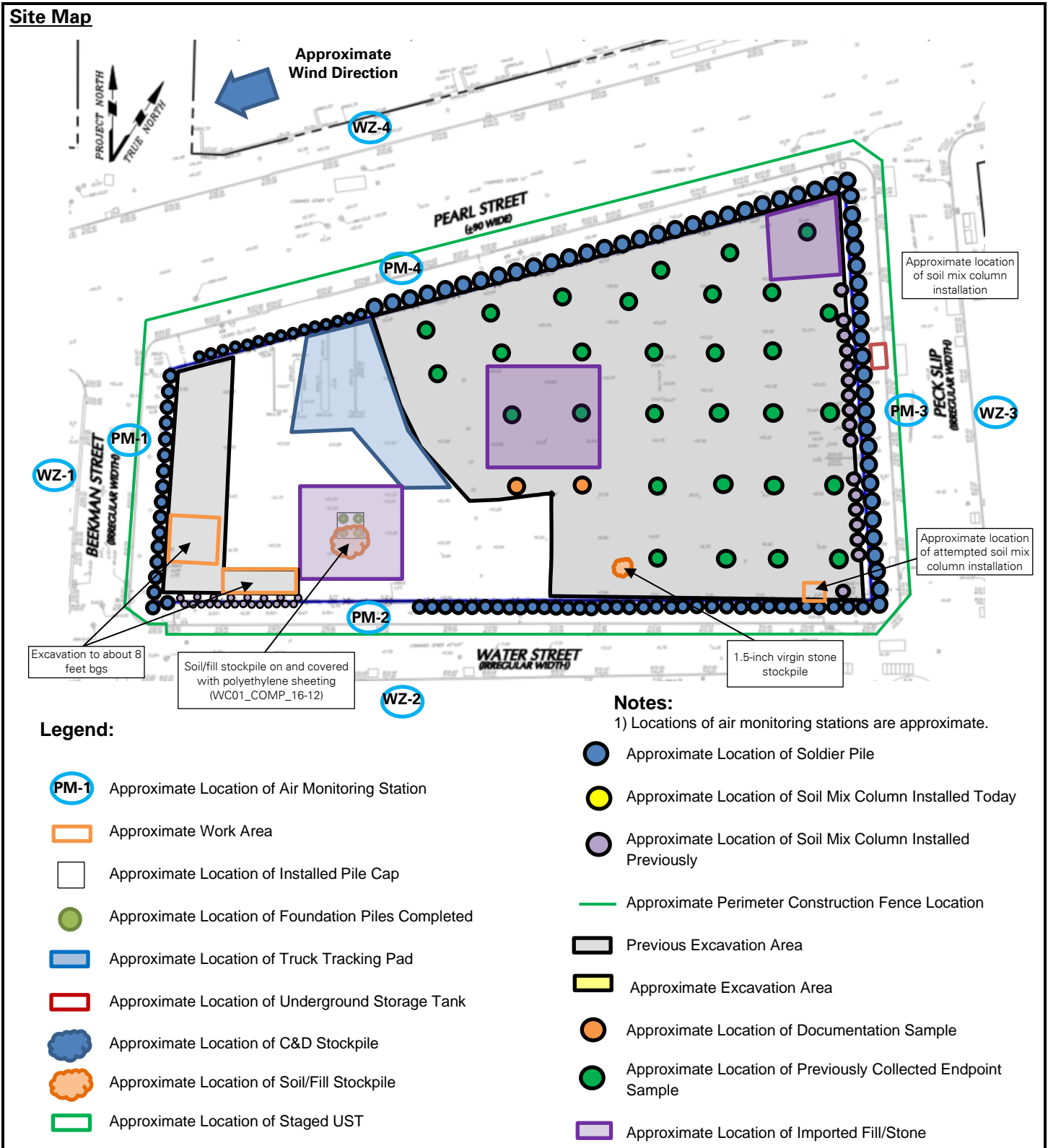

Cc:	M. Raygorodetsky, P. McMahon, M. Au, J. Frey, S. Simpson	By:	Jack Millman <b>LANGAN</b>
-----	--	-----	-------------------------------

## SITE OBSERVATION REPORT

### Select Site Photographs:



**Photo 1:** ECD attempting to install a soil mix column in the southeast part of the site (facing east)



**Photo 2:** ECD excavating soil/fill in the southwest part of the site (facing south)

Cc:	M. Raygorodetsky, P. McMahon, M. Au, J. Frey, S. Simpson	By:	Jack Millman <b>LANGAN</b>
-----	--	-----	-------------------------------