

**DAILY FIELD REPORT 168**

Prepared By: LANGAN

<b>WEATHER</b>	Snow	X	Rain		Overcast		Partly Cloudy		Sunny	
<b>TEMP.</b>	< 32	X	32-50		50-70		70-85		>85	

<b>BCP Project No:</b>	C231153	<b>Date:</b>	January 16, 2024
------------------------	---------	--------------	------------------

<b>Project Name:</b>	Kasser Scrap Metal and Rector Cleaners Site	<b>Time:</b>	6:45 am to 3:30 pm
----------------------	---	--------------	--------------------

<b>Consultant:</b> Langan Engineering, Environmental, Surveying, Landscape Architecture and Geology, D.P.C. (Langan)	<b>Langan Field Personnel:</b> Caitlyn Dempsey (Environmental) Carli Piretra (Environmental) Xianglei Zheng (Geotechnical)
<b>Construction Manager:</b> Consigli Construction Co., Inc. (Consigli)	
<b>Foundation Contractor:</b> Urban Foundation/Engineering (Urban)	

**Work Activities Performed:**

- Urban excavated an about 5-foot-long by 5-foot-wide area to a depth of about 5 feet below grade surface (bgs) in the southern part of grid WC04\_0-5. Excavated soil/fill was stockpiled in the western part of WC02, pending off-site disposal.
- Urban relocated a portion of the stockpile in the western part of grid WC02 to the north-central part of grid WC02 to prepare for equipment mobilization.
- Urban replaced a portion of the WC05\_0-5 stockpile in grid WC05 into a previously excavated area of about 5-feet-long by 3-feet-wide to surface grade to prepare for equipment mobilization. Urban relocated the remainder of the stockpile to the southern part of grid WC02, pending off-site disposal.
- Urban graded an about 20-foot-long by 8-foot-wide area in the central part of grid WC05 to prepare for equipment mobilization.
- Excavated and graded soil/fill consisted of non-native soil; odors, staining, elevated photoionization detector (PID) readings, or other evidence of a petroleum or chemical release were not observed.
- Urban used an excavator with a jackhammer attachment to remove concrete from historical foundational elements in the southern part of the site to prepare for subsurface activities.
- Urban continued the installation of one caisson casing in the southern part of grid WC04. A creosote-like odor was observed during the installation of the caisson casing. Elevated PID readings were not observed.

**Material Tracking:**

- No soil/fill was exported from the site.
- No material was imported to the site.

Materials Export Summary								
Facility Name	Bayshore Soil Management, LLC		Clean Earth of Carteret, LLC		PPark NJ		Faztec Solutions	
Location	Keasbey, NJ		Carteret, NJ		Prospect Park, NJ		Staten Island, NY	
Type of Waste	Non-hazardous Soil		Non-hazardous Soil		Non-hazardous Soil		C&D	
Today	Number of Loads	Approx. Volume (CY)	Number of Loads	Approx. Volume (CY)	Number of Loads	Approx. Volume (CY)	Number of Loads	Approximate Volume (CY)
		0	-	0	-	0	-	0
Total	Number of Loads	Approx. Volume (CY)	Number of Loads	Approx. Volume (CY)	Number of Loads	Approx. Volume (CY)	Number of Loads	Approximate Volume (CY)
	139	2,780	252	5,040	0	-	15	300

Materials Export Summary		
Facility Name	Dale Transfer Corp.	
Location	West Babylon, NY	
Type of Waste	Concrete	
Today	Number of Loads	Approx. Volume (CY)
		0
Total	Number of Loads	Approx. Volume (CY)
	2	40

Materials Import Summary						
Facility Name	Greenpoint Quarry / North Shore Terminal		Stavola Bound Brook / North Shore Terminal		North American Aggregate Mining Operations	
Location	Staten Island, NY		Staten Island, NY		Perth Amboy, NJ	
Type of Material	ASTM #57 0.75-inch Stone		ASTM #2 2.5-inch Stone		Pipe Sand Backfill	
Today	Number of Loads	Approx. Volume (CY)	Number of Loads	Approx. Volume (CY)	Number of Loads	Approx. Volume (CY)
		0	-	0	0	0
Total	Number of Loads	Approx. Volume (CY)	Number of Loads	Approx. Volume (CY)	Number of Loads	Approx. Volume (CY)
	6	120	3	60	0	-
Approved Quantity	-	500	-	200	-	300

**Samples Collected:**

- No samples were collected.

**Air Monitoring:**

- The Community Air Monitoring Program (CAMP) was not implemented due to sustained precipitation throughout the day.

**Planned Activities:**

- Urban will continue to excavate and grade site soil/fill in support of foundation installation.
- Urban will continue to advance caissons and soldier piles.

**SITE PLAN**

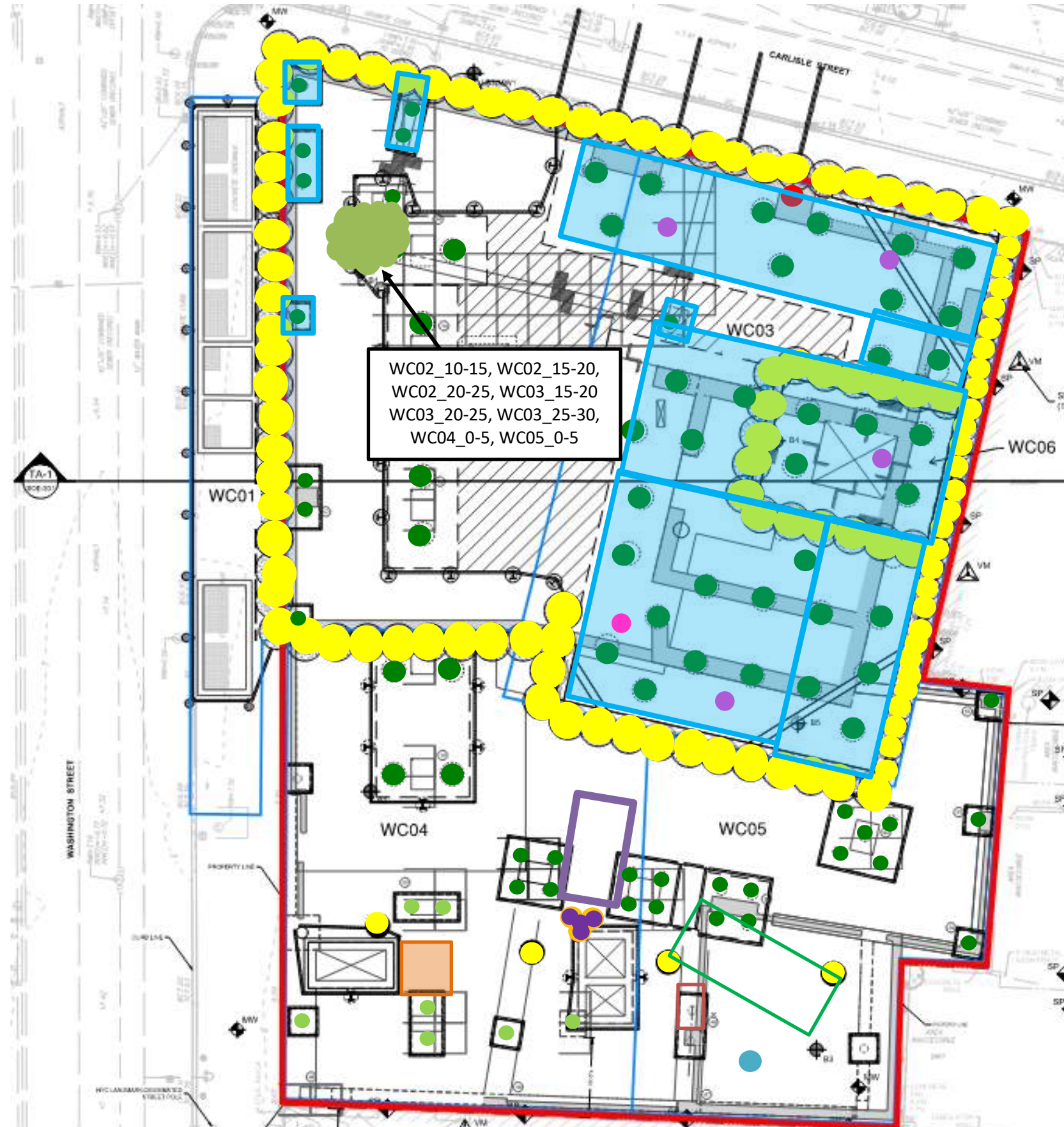

- Site Boundary**
- Waste Characterization Grid Boundary**
- **CAMP station 1**
- **CAMP station 2**
- **Stockpile – Soil (no impacts)**
- **Stockpile – C&D**
- **Stockpile – Timber Piles**
- Approximate Location of Excavation**
- Approximate Area of Grading**
- Approximate Backfill Location**
- **Completed Soil-Mix Column**
- **Completed Caisson Casing**
- **Completed Caisson**
- **Reinstalled Soil-Mix Column as part of the In-Situ Stabilization of NAPL-contaminated Soil**
- **Soil-Mix Core Advanced**
- **Documentation Endpoint Sample**
- Completed Waterproofing Installation**
- Approximate Location of the Former UST**

**Note:** Waste characterization grid areas were developed by PT Consultants and Urban and is shown on this site plan for reference only.

**Photo Log**

**Photo 1:** Urban removing concrete in the southern part of the site (facing southwest).



**Photo 2:** Urban grading soil/fill in WC05 (facing southwest).

