

**SPEEDWAY LLC
UPDATE REPORT**

Site Address: 3904 Northern Boulevard Long Island City, NY	Regulatory Agency: NYSDEC – Region 2 Regulatory Contact: Ainura Doronova Spill #: 95-00846 Consultant: EnviroTrac Ltd. Project Manager: Ed Russo
Speedway Contact: John Engdahl	

Report Date: May 2018

Spill Incident Cause: Impacted soils encountered during an underground storage tank upgrade project in April 1995. Removed four (4) 4,000-gallon, two (2) 2,000-gallon, and thirty-eight (38) 550-gallon steel gasoline and one (1) 1,000-gallon steel fuel-oil underground storage tanks (USTs). During this project, 846 tons of impacted soils were removed off site for disposal.

Current Site Status: Active station

Monitoring Period: January 2018 – March 2018

Work Performed: February 27 and March 2, 2018 – Conducted a Short Term Remediation Event (STRE) on MW-9 with air sparge well AS-3.

March 8, 2018 – Gauged and sampled eight (8) monitoring wells (MWs) and one (1) cluster well (CW).

Groundwater Monitoring:

Wells Gauged:	MW-1 through MW-4, MW-6 through MW-9, & CW-3
Wells Containing LPH:	None
Groundwater Depth:	16.85 – 19.93 feet
Groundwater Flow:	West-Southwesterly
Wells Sampled:	MW-1 through MW-4, MW-6 through MW-9, & CW-3
Maximum Benzene Concentration:	486 µg/L (MW-2)
Maximum MTBE Concentration:	ND (non-detect all wells)

Current Plans/Proposals: Continue with quarterly monitoring and monthly STREs, with the next sampling event scheduled for June 2018. An Update Report summarizing these activities will be submitted to NYSDEC in August 2018.

List of Attachments:

Tables:	Table 1 – Well Gauging and Groundwater Analytical Data Table 2 – Short Term Remediation Event (STRE) Data
Figures:	Figure 1 – Aerial Photograph Figure 2 – Water Table Elevation on March 8, 2018 and Total BTEX/MTBE Concentrations Map Figure 3 – Hydrograph of MW-1 Figure 4 – Hydrograph of MW-2 Figure 5 – Hydrograph of MW-3 Figure 6 – Hydrograph of MW-6 Figure 7 – Hydrograph of MW-7 Figure 8 – Hydrograph of MW-8 Figure 9 – Hydrograph of MW-9
Attachments:	Laboratory Analytical Reports

TABLE 1
Well Gauging and Groundwater Analytical Data
3904 Northern Boulevard
Long Island City, NY

Well ID (Screen Zone)	Date	Gauge Point Elevation (feet)	Depth to Water (fbg)	Depth to Product (fbg)	Product Thickness (feet)	Relative GW Elevation (feet)	Benzene (ug/L)	Toluene (ug/L)	Ethylbenzene (ug/L)	Xylenes (ug/L)	BTEX (ug/L)	MTBE (ug/L)
MW-1 (13-28')	06/19/17	34.69	17.76			16.93	ND	ND	ND	ND	ND	ND
	09/29/17	34.69	18.34			16.35	ND	ND	ND	ND	ND	ND
	12/28/17	34.69	18.52			16.17	ND	ND	ND	ND	ND	ND
	*1/25/18	34.69	18.41			16.28	ND	ND	ND	ND	ND	ND
	03/08/18	34.69	17.51			17.18	ND	ND	ND	ND	ND	ND
MW-2 (11-26')	06/19/17	35.38	18.50			16.88	160	32.0	26.7	74.9	293.6	ND
	09/29/17	35.38	19.40			15.98	242	60.8	38.4	118	459.2	ND
	12/28/17	35.38	19.25			16.13	577	64.1	73.8	122	936.9	1.9
	*1/25/18	35.38	19.23			16.15	ND	2.2	67.9	30.5	100.6	ND
	03/08/18	35.38	18.28			17.10	486	27.9	12.5	59.2	585.6	ND
MW-3 (9-24')	06/19/17	34.84	17.19			17.65	ND	ND	ND	ND	ND	ND
	09/29/17	34.84	17.81			17.03	ND	ND	3.6	ND	3.6	ND
	12/28/17	34.84	17.94			16.90	ND	2.9	101	39.6	143.5	ND
	*1/25/18	34.84	17.78			17.06	1,110	57.6	49.1	105	1,321.7	1.5
	03/08/18	34.84	17.01			17.83	ND	ND	8.9	ND	8.9	ND
MW-4 (9-25')	06/19/17	35.06	17.74			17.32	ND	ND	ND	ND	ND	ND
	09/29/17	35.06	18.43			16.63	ND	ND	ND	ND	ND	ND
	12/28/17	35.06	18.48			16.58	ND	24.3	516	1,860	2,400.3	ND
	*1/25/18	35.06	18.41			16.65	ND	ND	ND	ND	ND	ND
	03/08/18	35.06	17.56			17.58	ND	ND	ND	ND	ND	ND
MW-6 (11-26')	06/19/17	33.96	17.03			16.93	1.3	10.4	1.7	11.0	24.4	ND
	09/29/17	33.96	17.54			16.42	ND	ND	ND	ND	ND	ND
	12/28/17	33.96	17.74			16.22	ND	ND	ND	ND	ND	ND
	*1/25/18	33.96	17.63			16.33	ND	ND	ND	2.8	2.8	ND
	03/08/18	33.96	16.85			17.11	ND	ND	ND	ND	ND	ND
MW-7 (10-25')	06/19/17	35.53	18.66			16.87	ND	ND	7.0	10.1	17.1	ND
	09/29/17	35.53	19.25			16.28	ND	ND	5.1	2.2	13.3	ND
	12/28/17	35.53	19.54			15.99	ND	ND	82.4	37.4	119.8	ND
	*1/25/18	35.53	19.39			16.11	ND	4.1	1,080	1,290	2,374.1	ND
	03/08/18	35.53	18.42			17.11	1.3	8.2	320	397	726.5	ND
MW-8 (13-28')	06/19/17	37.04	20.18			16.86	ND	8.7	11.6	5.5	25.8	ND
	09/29/17	37.04	20.80			16.24	ND	8.1	20.4	3.1	31.6	ND
	12/28/17	37.04	20.91			16.13	ND	4.6	1,430	4,570	6,004.6	ND
	*1/25/18	37.04	20.91			16.13	ND	5.3	14.0	3.8	23.1	ND
	03/08/18	37.04	19.93			17.11	4.3	12.7	30.7	16.4	64.1	ND
MW-9 (11-26')	06/19/17	34.95	17.88			17.07	ND	43.5	2,200	4,070	6,313.5	ND
	09/29/17	34.95	18.53			16.42	ND	36.3	2,920	6,010	8,966.3	ND
	12/28/17	34.95	18.72			16.23	ND	19.6	2,300	3,400	5,719.6	ND
	*1/25/18	34.95	18.61			16.34	ND	15.3	2,320	2,730	5,065.3	ND
	03/08/18	34.95	17.69			17.26	ND	10.2	1,070	1,420	2,500.2	ND
CW-3	06/19/17	35.23	18.08			17.15	ND	ND	ND	ND	ND	ND
	09/29/17	35.23	18.66			16.57	ND	ND	ND	ND	ND	ND
	12/28/17	35.23	18.85			16.38	ND	ND	1.1	ND	1.1	ND
	*1/25/18	35.23	18.67			16.56	ND	ND	ND	ND	ND	ND
	03/08/18	35.23	17.91			17.32	ND	ND	ND	ND	ND	ND

Notes

ND - Not Detected

* Resampling event to confirm December 28, 2017 data.

Table 2
Short Term Remediation Event (STRE) Data
3904 Northern Boulevard
Long Island City, NY

Date	Extraction Well	Sparge Well	Event Hours	SVE Vacuum ("H2O)	SVE Flow (cfm)	AS Pressure (psi)	AS Flow (cfm)	SVE Effluent PID (ppm)
12/21/16	MW-9	AS-3	8	32	90	8.0	15	3,192
01/16/17	MW-9	AS-3	8	32	90	8.0	15	570.1
02/22/17	MW-9	AS-3	8	32	90	8.0	15	274.3
03/02/17	MW-9	AS-3	8	32	90	8.0	15	323.7
05/17/17	MW-9	AS-3	8	40	95	6.0	15	216.8
05/30/17	MW-9	AS-3	8	38	90	8.0	16	292.4
06/01/17	MW-9	AS-3	8	34	90	8.0	16	410.1
07/26/17	MW-9	AS-3	8	30	70	7.0	16	400.1
08/07/17	MW-9	AS-3	8	31	70	8.0	16	374.5
09/19/17	MW-9	AS-3	8	12	40	7.5	13	155.4
11/10/17	MW-9	AS-3	8	45	95	8.0	13	162.1
11/28/17	MW-9	AS-3	8	41	100	7.0	15	95.4
12/07/17	MW-9	AS-3	8	42	95	5.0	15	109.7
02/27/18	MW-9	AS-3	8	40	95	6.0	18	14.8
03/02/18	MW-9	AS-3	8	45	95	7.0	18	226.4

Notes:

cfm - cubic feet per minute
psi - pounds per square inch
ppm - parts per million
NM - Not Measured

Confidentially provided to
James Foran
Goodman
168.149.151.40
10/22/2021 1:39 PM

AERIAL PHOTOGRAPH

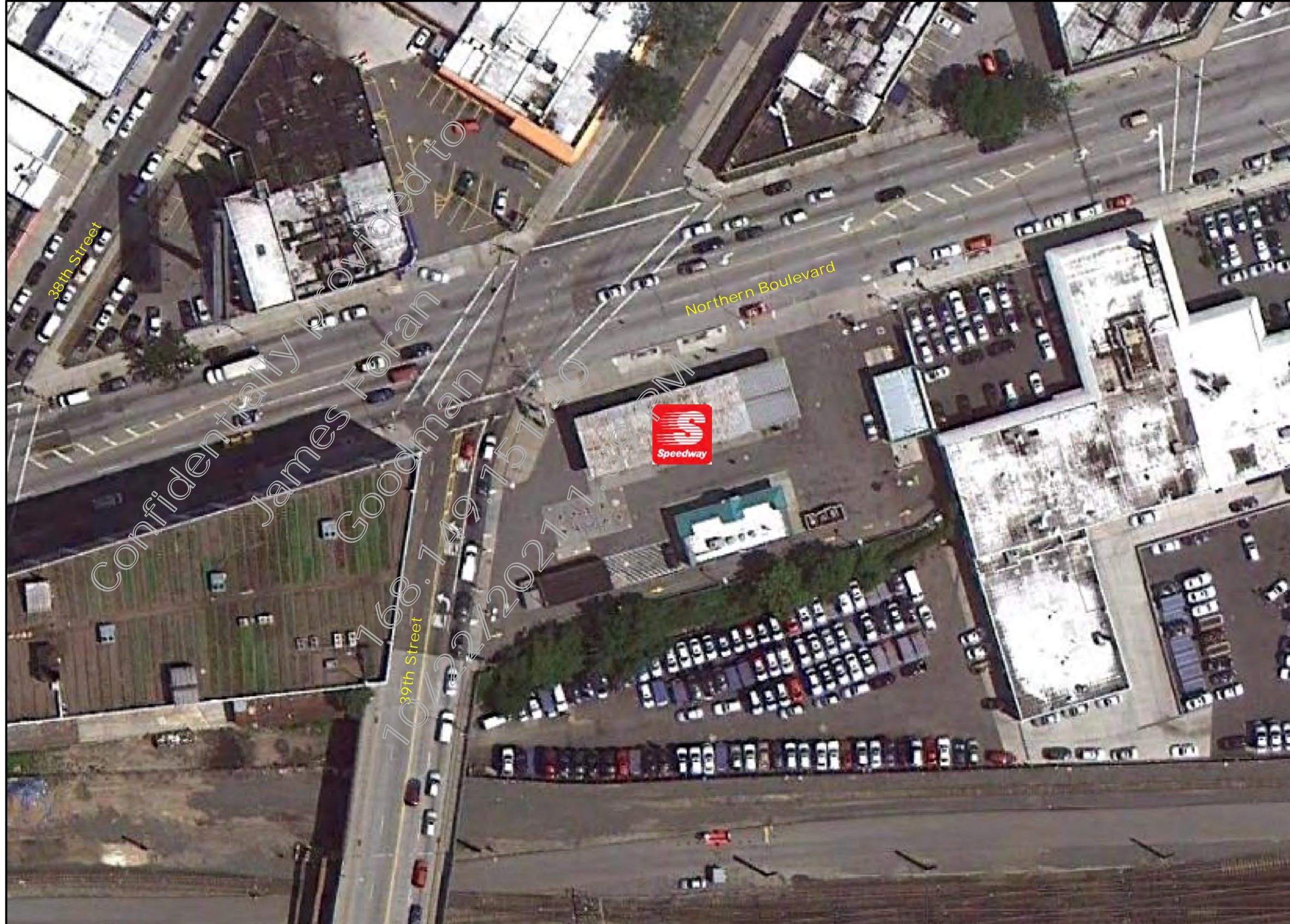
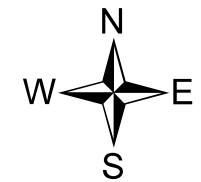

Figure 1
Aerial Photograph

Speedway # 7830
39-04 Northern Boulevard
Long Island City, NY

Digital Imagery taken in 2010



EnviroTrac

Environmental Services

5 Old Dock Road

Yaphank, NY 11980

P: 631-924-3001 F: 631-924-5001

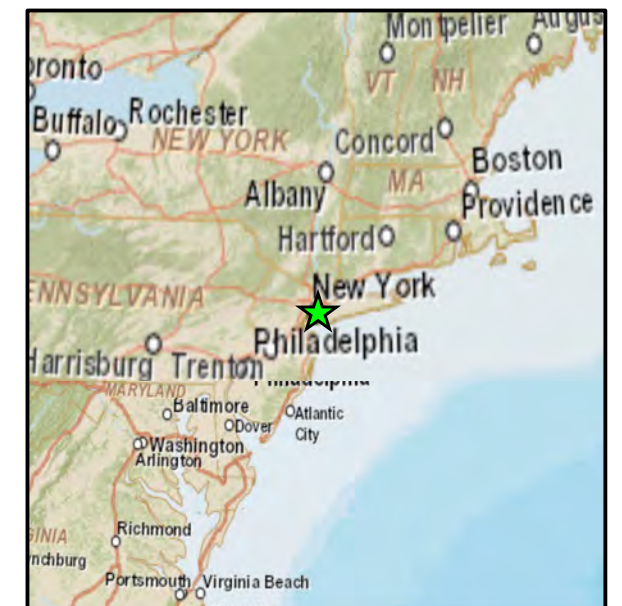



NORTHERN BOULEVARD

39th STREET

LEGEND:

- PROPERTY LINE
- MONITORING WELL
- AIR SPARGE WELL
- ⊙ SOIL VAPOR EXTRACTION WELL
- ⊕ MONITORING WELL AND VAPOR EXTRACTION WELL
- ⊗ DESTROYED WELL
- GREY FORMER SITE FEATURE
- SMP = STANDARD MOTOR PRODUCTS
- NM = NOT MEASURED
- NI = NOT INSTALLED
- ND = NOT DETECTED
- <MDL = LESS THAN METHOD OF DETECTION LIMIT
- J = ESTIMATED VALUE
- NSD = NO SURVEY DATA
- NS = NOT SAMPLED
- * = WELL RESAMPLED ON 01/25/18 DUE TO UNUSUALLY HIGH BTEX CONCENTRATION.
- ← = HISTORIC GROUNDWATER FLOW DIRECTION

SAMPLE WELL:

- MW-2 = MONITORING WELL ID
- 17.10 = WATER-TABLE ELEVATION
- 293.6/ND = JUNE 19, 2017
- 459.2/ND = SEPTEMBER 29, 2017
- 936.9/1.9 = DECEMBER 28, 2017
- *100.6/ND = JANUARY 25, 2018
- 585.6/ND = MARCH 8, 2018

TOTAL BTEX/MTBE CONCENTRATIONS IN ug/L

Confidentially provided to James Foran
168.749.157.40
10/22/2021 1:39 PM

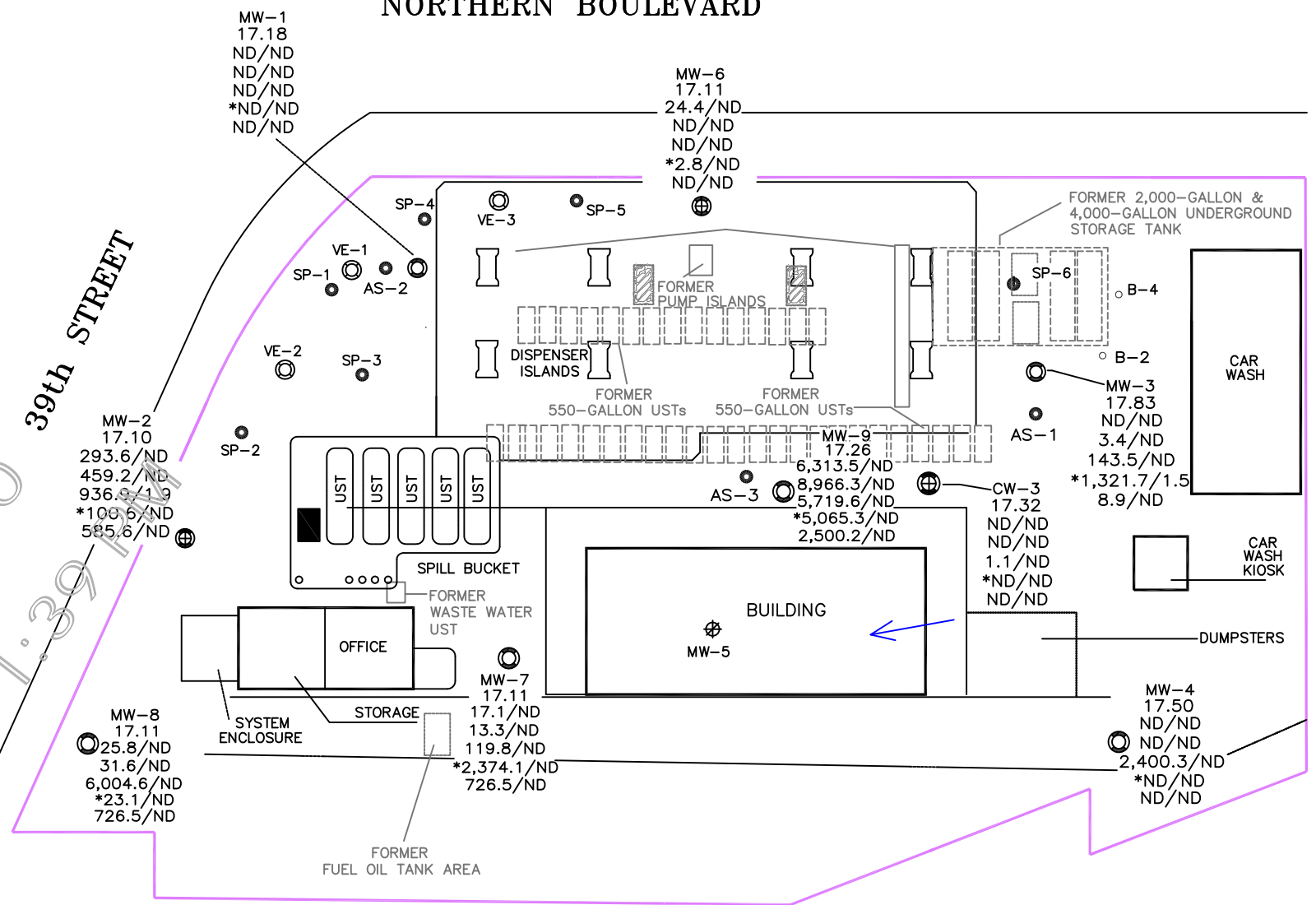

- FORMER 550-GALLON STEEL UNDERGROUND STORAGE TANK
- FORMER 4,000-GALLON STEEL UNDERGROUND STORAGE TANK
- FORMER 2,000-GALLON STEEL UNDERGROUND STORAGE TANK
- FORMER 1,000-GALLON STEEL UNDERGROUND STORAGE TANK
- 550-GALLON TANK ABANDONED IN PLACE WITH CONCRETE
- 600-GALLON WASTE WATER DOUBLE WALL FIBERGLASS UNDERGROUND STORAGE TANK
- 4,000-GALLON WASTE WATER DOUBLE WALL FIBERGLASS UNDERGROUND STORAGE TANK

Base map taken from DELTA map dated 1/24/08

5 OLD DOCK ROAD, YAPHANK, NEW YORK 11980
PHONE: (631)924-3001 FAX: (631)924-5001

REVISION DATE: MAY 8, 2018

SCALE: 1" = 30 FEET

REVISED BY: TB

SPEEDWAY #7830
39-04 NORTHERN BOULEVARD
LONG ISLAND CITY, NEW YORK

WATER TABLE ELEVATION ON MARCH 8, 2018
AND TOTAL BTEX/MTBE CONCENTRATIONS MAP

FIGURE 3
Hydrograph of MW-1
3904 Northern Boulevard
Long Island City, NY

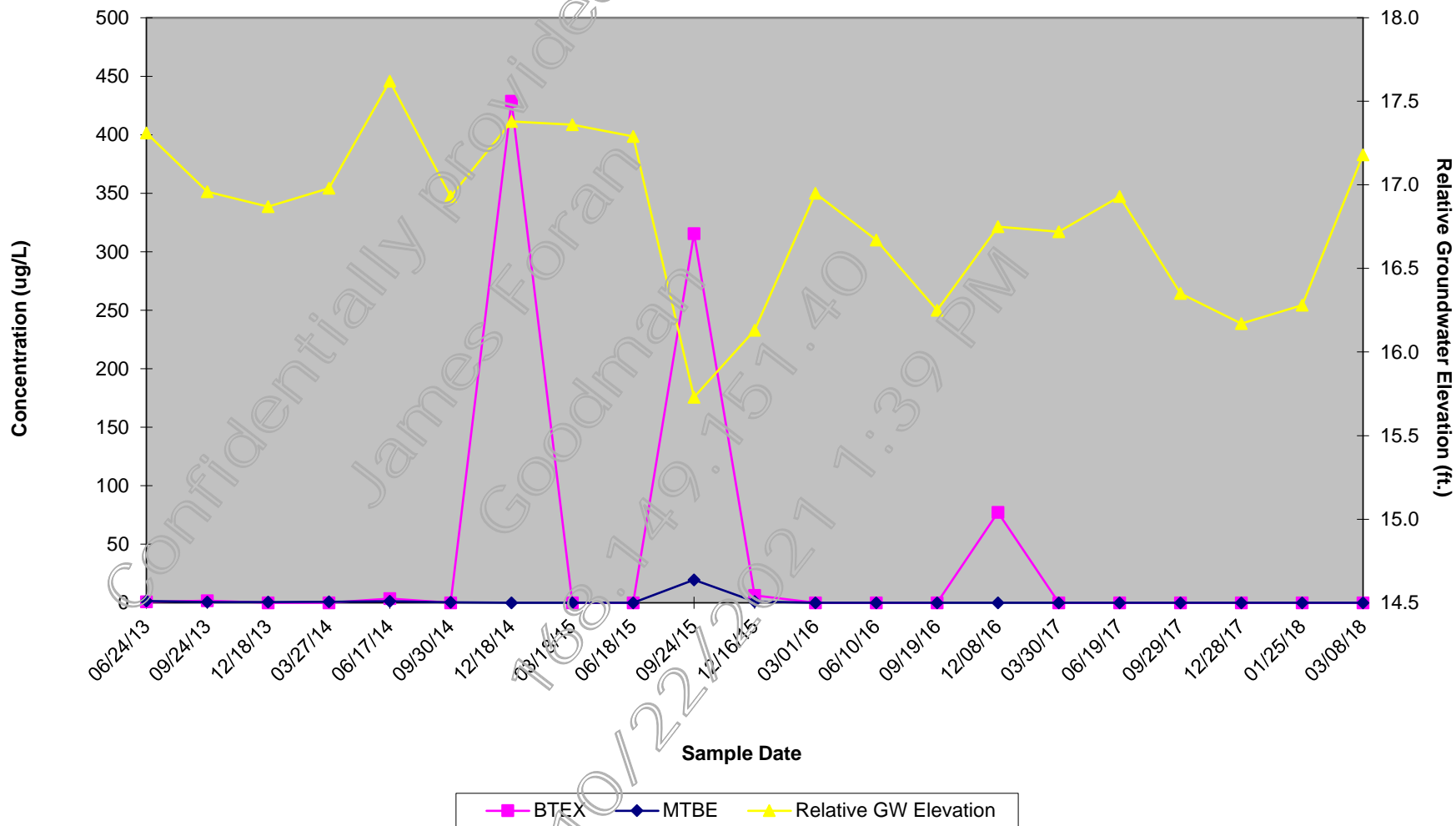

FIGURE 4
Hydrograph of MW-2
3324 Northern Boulevard
Long Island City, NY

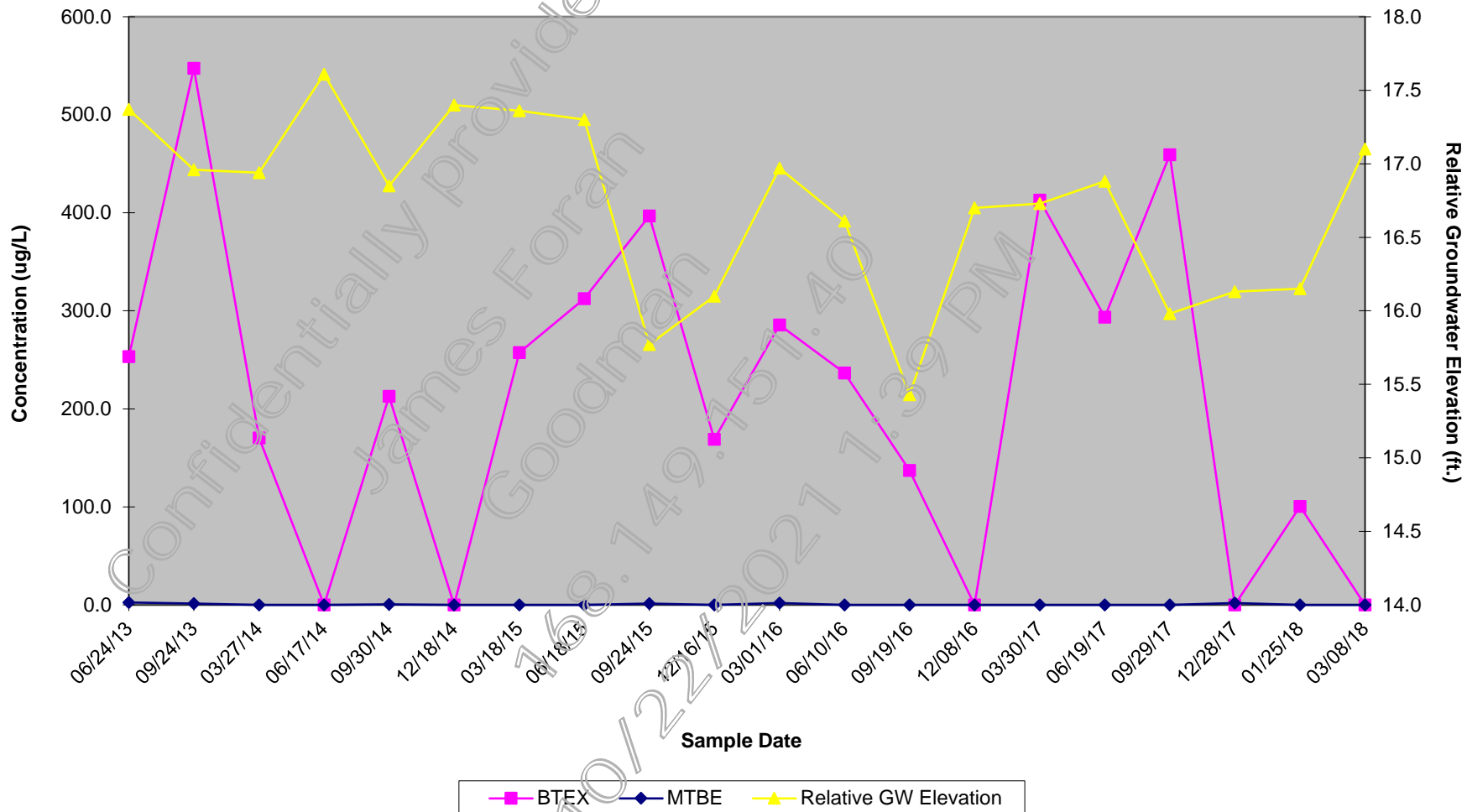

FIGURE 5
Hydrograph of MW-3
3904 Northern Boulevard
Long Island City, NY

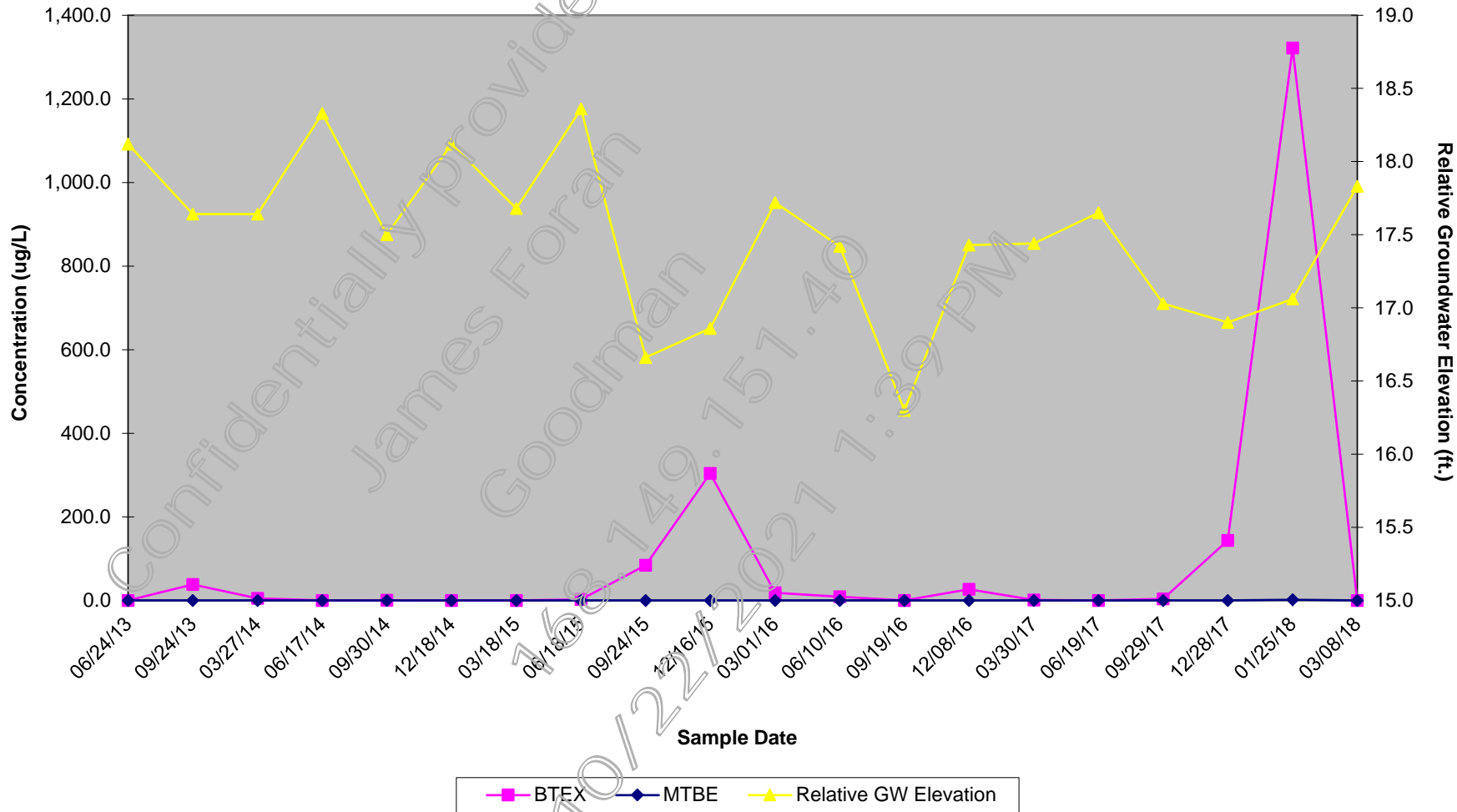

FIGURE 6
Hydrograph of MW-6
3304 Northern Boulevard
Long Island City, NY

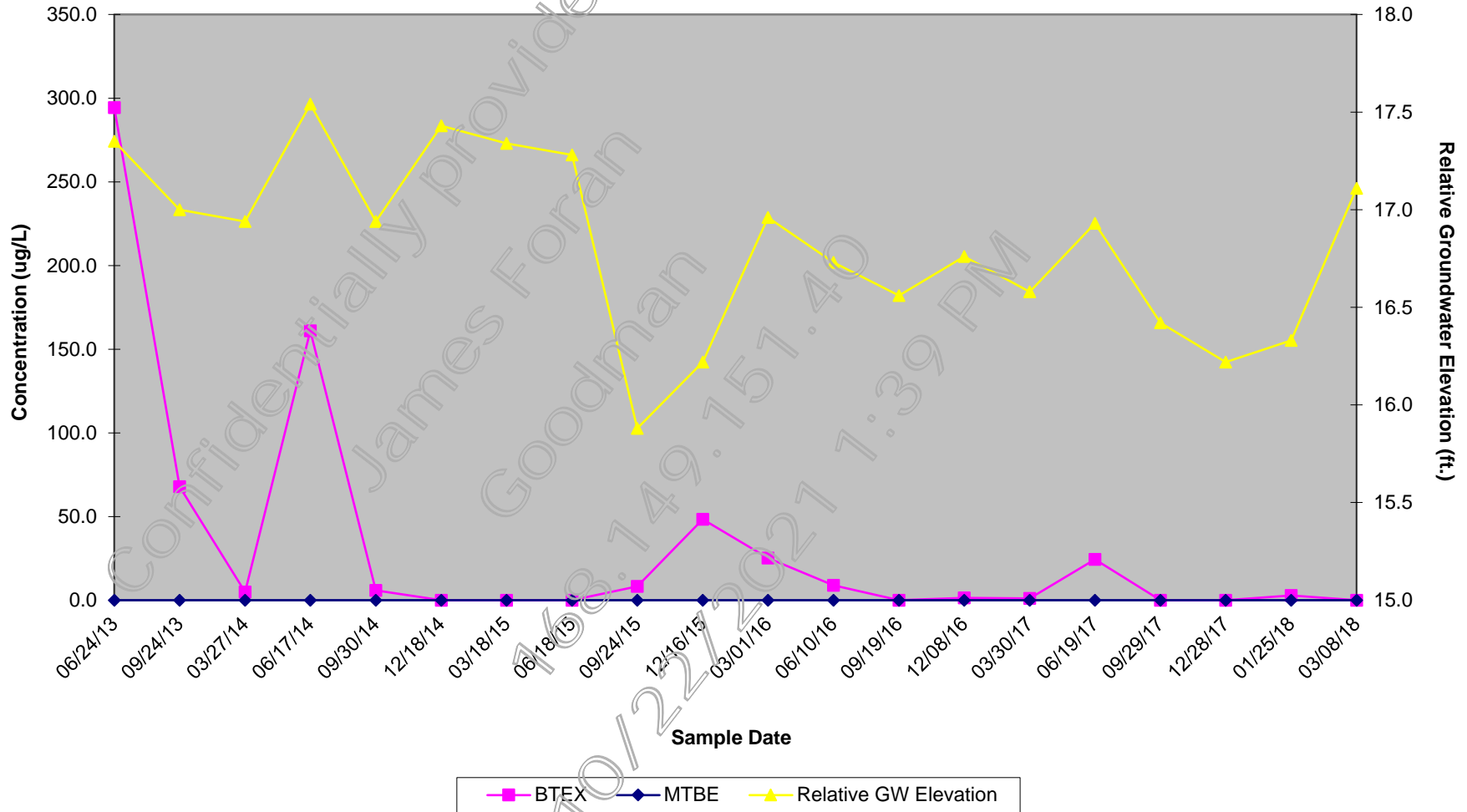

FIGURE 7
Hydrograph of MW-7
3904 Northern Boulevard
Long Island City, NY

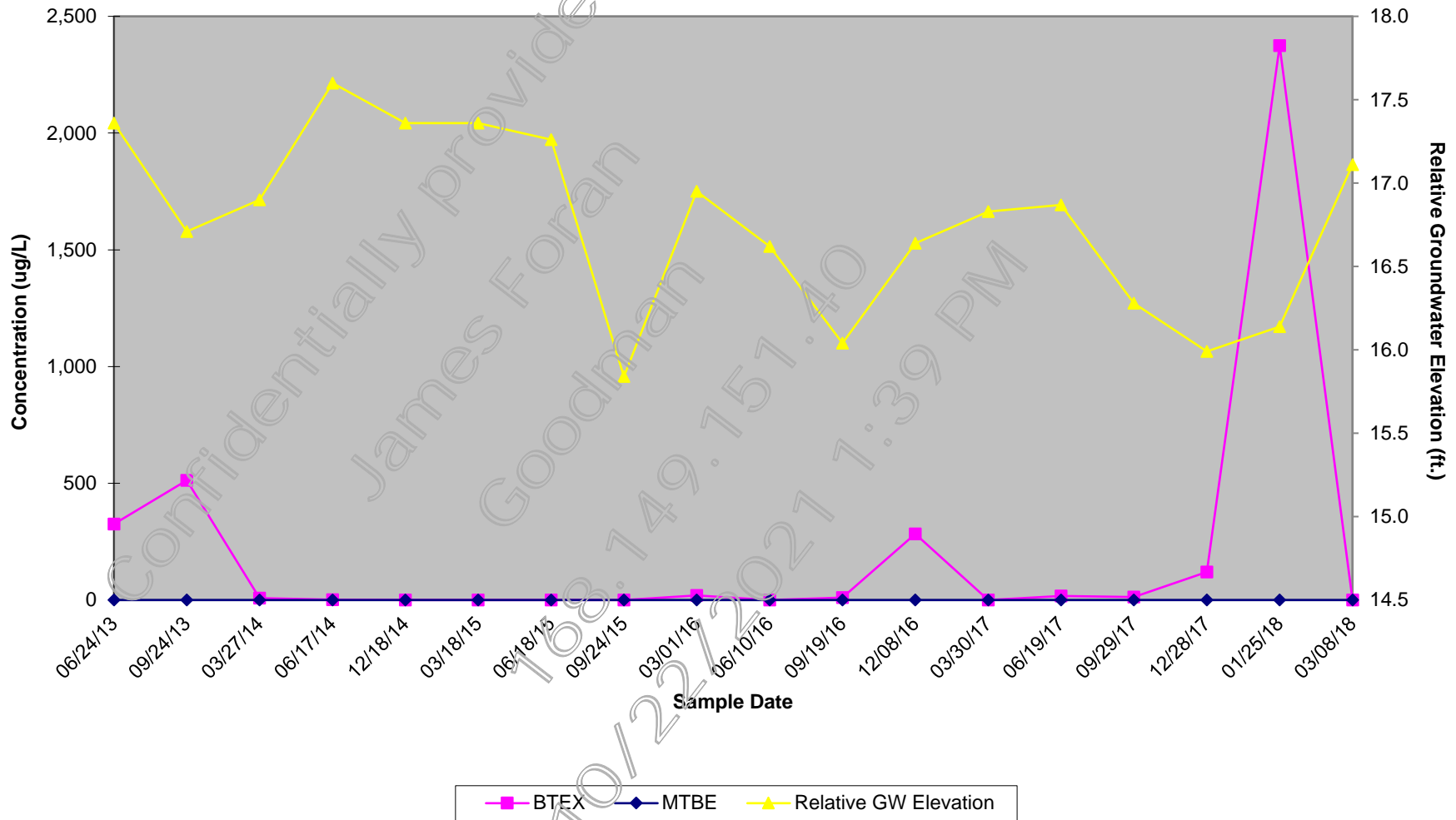

FIGURE 8
Hydrograph of MW-8
3904 Northern Boulevard
Long Island City, NY

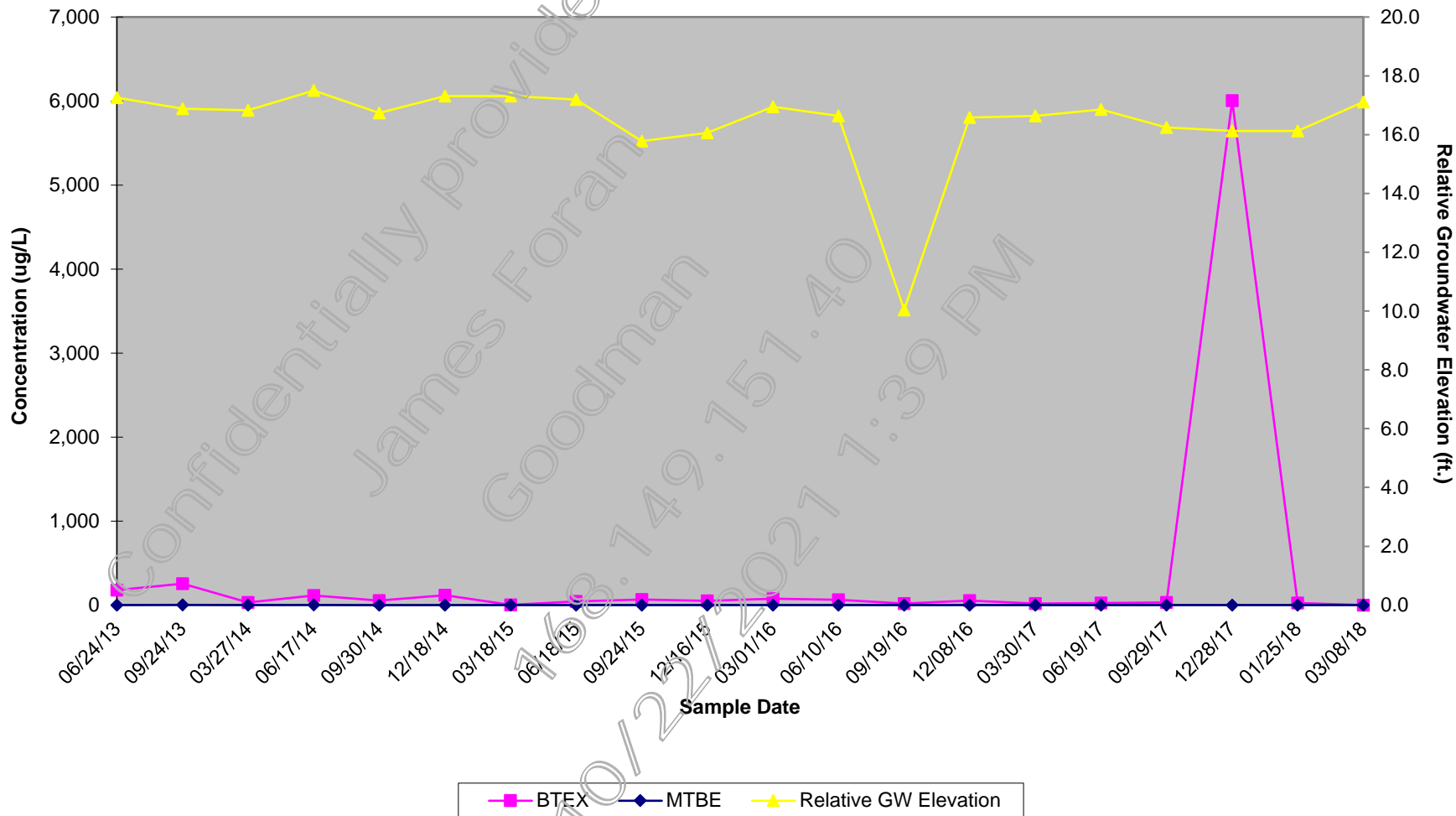

FIGURE 9
Hydrograph of MW-9
3904 Northern Boulevard
Long Island City, NY

