



Daily Activity Report

Magnolia Gardens
39-03 College Point Boulevard, Queens, NY
BCP Site No. C241273

General Site Information

Date:	Tuesday, April 30, 2024
Weather:	54-63°F, Cloudy
Wind Direction/Speed (towards):	NE @ 11-17 mph
AKRF Personnel on Site:	H. Westly
AKRF Equipment on Site:	Mini RAE 3000 Photoionization Detectors [(PID) x3] and DustTrak Aerosol Monitors (x3)
Visitors:	None

Contractor Information

Subcontractor	Role
Archstone Builders LLC	General Contractor (GC)
Capstone Contracting Corp.	Foundation Contractor

Description and Location of Work Activities Performed

Contractor drilled and grouted SOE piles in Grids WC-3 and WC-4.
Minor excavation and grading occurred in Grid WC-3.
Installed lagging for SOE in Grid WC-5.

Material Disposal Tracking Information

Destination Facility/Material Type	Daily Trucks	Total Trucks	Daily Approx. Cubic Yds	Total Approx. Cubic Yds	Total Site Loads	Total Approximate Cubic Yards
Clean Earth of North Jersey (CENJ)/(haz lead soil)	0	7	0	140	113	2,260
Clean Earth of North Jersey (CENJ)/(haz TCE soil)	0	6	0	120		
Bayshore Soil Management, LLC (Bayshore)	0	87	0	1,740		
River Front Recycling (C&D)	0	13	0	260		

Import Material Tracking Information

Origin Facility	Daily Trucks	Total Trucks	Daily Tonnage	Total Tonnage	Total Site Loads	Total Quantity (tons)
Vulcan, Wantage or Hamburg Quarry	0	5	0.00	112.09	5	112.09

CAMP Air Monitoring Results

CAMP Station	UPWIND	DOWNWIND
Odors:	None	None
VOC Action Level Exceedance(s):	None	None
Particulate Action Level Exceedance(s):	None	None
Maximum VOC Level (ppm) 15-min avg:	0.4451	0.0000
Maximum Particulate Level (mg/m ³) 15-min avg:	0.1028	0.1073

Camp Response Actions: None.

Additional Information

Planned Work Activity for Next Day/Week:	Continue SOE installation in Grids WC-3 & WC-7.
Comments:	

Soil Waste Classification Grid Plan

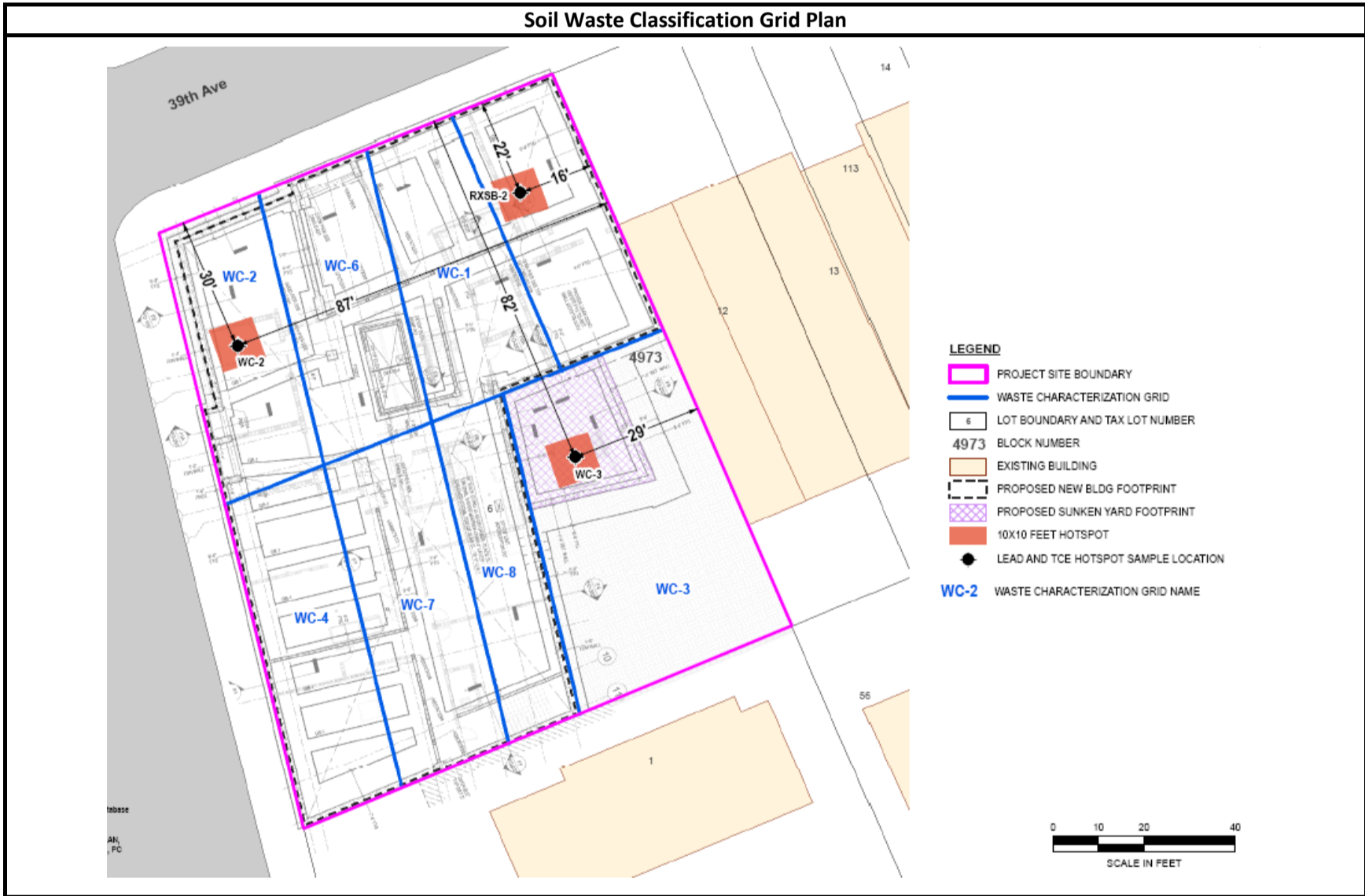

Upwind CAMP Station Data

04/30/2024 0:00:10 – 05/01/2024 0:00:00
(GMT-05:00) Eastern Time (US & Canada)

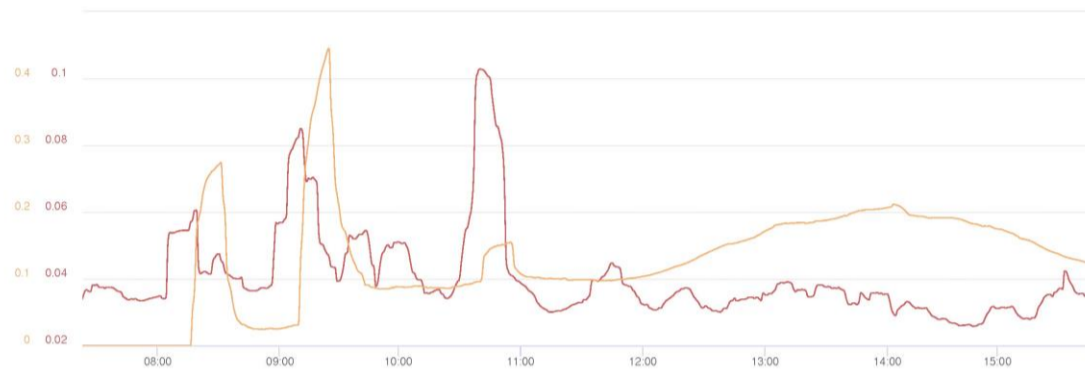

Mass Conc. Total mg/m³ AVG 15m
mg/m³
DustTrak-8530
85222(C)

MIN	AVG	MAX
0.0258	0.0403	0.1028

VOC ppm AVG 15m ppm
miniRAE 3000
85222(A)

MIN	AVG	MAX
0	0.1281	0.4451

Name College Pt. Upwind
S/N 2B341306
Description FA06010
Location 13314 39th Ave,
Flushing, NY 11354,
USA

© Neutronix 2024

Downwind CAMP Station Data

04/30/2024 0:00:20 – 05/01/2024 0:00:00
(GMT-05:00) Eastern Time (US & Canada)



Mass Conc. Total mg/m³ AVG 15m
mg/m³
DustTrak-8530
85222(C)

MIN	AVG	MAX
0.0258	0.0474	0.1073

VOC ppm AVG 15m ppm
miniRAE 3000
85222(A)

MIN	AVG	MAX
0	0	0

Name College Pt. Downwind
S/N 2B346173
Description FA06008
Location 13314 39th Ave,
Flushing, NY 11354,
USA

© Neutronix 2024

Site Photographs

Photograph 1 -
Drilling piles in WC-3.
View facing
southeast.



Photograph 2 -
Site overview. View
facing southeast.



Photograph 3 -
Washing truck tires
before leaving the
site, view facing east.

