



## Daily Activity Report

Magnolia Gardens  
39-03 College Point Boulevard, Queens, NY  
BCP Site No. C241273

### General Site Information

Date:	Wednesday, May 29, 2024
Weather:	60-71°F, Sunny
Wind Direction/Speed (towards):	NW @ 6 mph
AKRF Personnel on Site:	Isabella Legovich
AKRF Equipment on Site:	Mini RAE 3000 Photoionization Detectors [(PID) x3] and DustTrak Aerosol Monitors (x3)
Visitors:	None

### Contractor Information

Subcontractor	
Archstone Builders LLC	General Contractor (GC)
Capstone Contracting Corp.	Foundation Contractor

### Description and Location of Work Activities Performed

Excavation and grading occurred in Grids WC-1, WC-3, WC-5. As part of the SOE, installed lagging and tiebacks in Grids WC-1 and WC-5. No soil stockpiles were generated.

Contractor installed rebar in the southwestern portion of the Site as part of the foundation construction.

Approximately 160 cubic yards of soil/fill were excavated and export off-site for disposal at the Clean Earth of Carteret (CEC) facility located in Carteret, NJ. The trucks were staged on the trucking pad gravel and truck tires did not need to be washed.

### Material Disposal Tracking Information

Destination Facility/Material Type	Daily Trucks	Total Trucks	Daily Approx. Cubic Yds	Total Approx. Cubic Yds	Total Site Loads	Total Approximate Cubic Yards
Clean Earth of North Jersey (CENJ)/(haz lead soil)	0	7	0	140	327	6,540
Clean Earth of North Jersey (CENJ)/(haz TCE soil)	0	6	0	120		
Bayshore Soil Management, LLC (Bayshore)	0	277	0	5,540		
River Front Recycling (C&D)	0	13	0	260		
Clean Earth of Carteret (CEC)	8	24	160	480		

### Import Material Tracking Information

Origin Facility	Daily Trucks	Total Trucks	Daily Tonnage	Total Tonnage	Total Site Loads	Total Quantity (tons)
Vulcan, Wantage or Hamburg Quarry	0	9	0.00	203.07	9	203.07

### CAMP Air Monitoring Results

CAMP Station	UPWIND	DOWNWIND
Odors:	None	None
VOC Action Level Exceedance(s):	None	None
Particulate Action Level Exceedance(s):	None	None
Maximum VOC Level (ppm) 15-min avg:	0.3747	0.0000
Maximum Particulate Level (mg/m <sup>3</sup> ) 15-min avg:	0.1741	0.0398

CAMP Response Actions: None.

### Additional Information

Planned Work Activity for Next Day/Week:	Continued SOE work and begin SSDS installation.
Comments:	None.

**Soil Waste Classification Grid Plan**

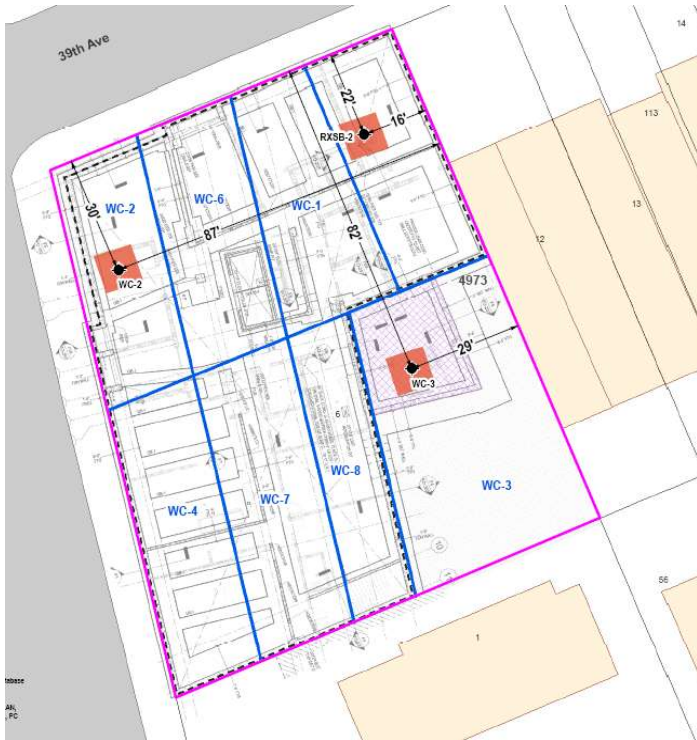

- LEGEND**
- PROJECT SITE BOUNDARY
  - WASTE CHARACTERIZATION GRID
  - LOT BOUNDARY AND TAX LOT NUMBER
  - 4973 BLOCK NUMBER
  - EXISTING BUILDING
  - PROPOSED NEW BLDG FOOTPRINT
  - PROPOSED SUNKEN YARD FOOTPRINT
  - 10X10 FEET HOTSPOT
  - LEAD AND TCE HOTSPOT SAMPLE LOCATION
  - WC-2 WASTE CHARACTERIZATION GRID NAME



### Upwind CAMP Station Data

Wed, 29th of May 2024, 0:00:00 – 17:13:19  
(GMT-05:00) Eastern Time (US & Canada)

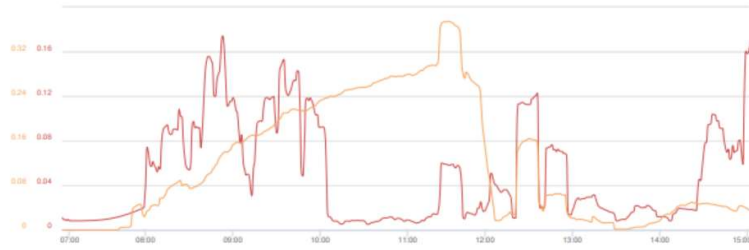

Mass Conc. Total mg/m³ AVG 15m			VOC ppm AVG 15m		
DustTrak 8530			miniRAE 3000		
MIN	AVG	MAX	MIN	AVG	MAX
0.0051	0.054	0.1741	0	0.1189	0.3747

Name College Pt. Upwind  
S/N 28341306  
Description FA06010  
Location 13314 39th Ave,  
Flushing, NY 11354,  
USA

© Netronix 2024

### Downwind CAMP Station Data

Wed, 29th of May 2024, 0:00:00 – 17:16:31  
(GMT-05:00) Eastern Time (US & Canada)



Mass Conc. Total mg/m³ AVG 15m			VOC ppm AVG 15m		
DustTrak 8530			miniRAE 3000		
MIN	AVG	MAX	MIN	AVG	MAX
0.002	0.0155	0.0398	0	0	0

Name College Pt. Downwind  
S/N 28346173  
Description FA06008  
Location 13314 39th Ave,  
Flushing, NY 11354,  
USA

© Netronix 2024

Site Photographs

Photograph 1 -  
SOE related  
excavation in WC-1/5.



Photograph 2 -  
Contractor installed  
rebar in the  
southwestern portion  
of the Site as part of  
the foundation  
construction.



Photograph 3 -  
Loading soil on to  
trucks for off-site  
disposal.

