

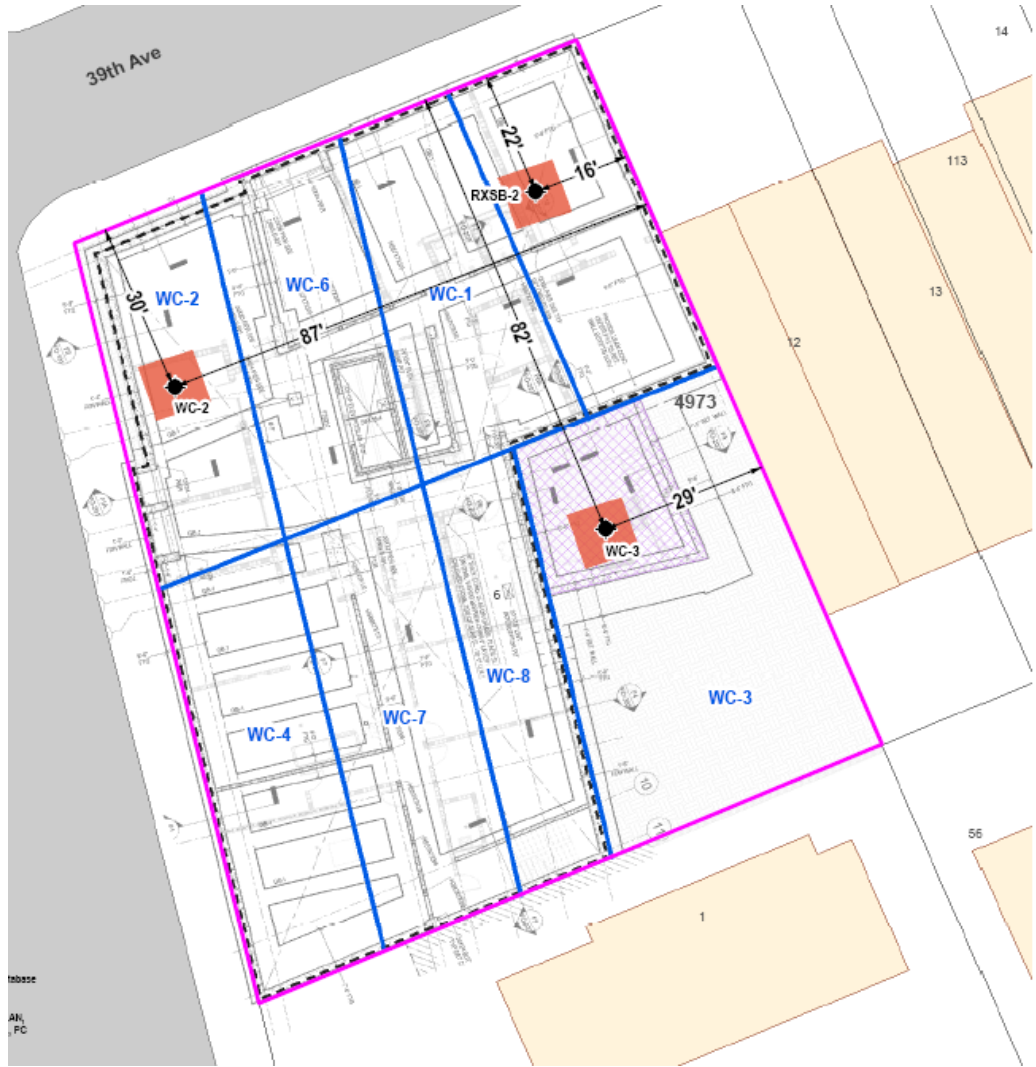

	Daily Activity Report					
	Magnolia Gardens					
	39-03 College Point Boulevard, Queens, NY					
	BCP Site No. C241273					
General Site Information						
Date:	Wednesday, July 3, 2024					
Weather:	64-82°F, Mostly Sunny					
Wind Direction/Speed (towards):	W @ 5-9 mph					
AKRF Personnel on Site:	Marcela Sanchez, Isabella Legovich					
AKRF Equipment on Site:	Mini RAE 3000 Photoionization Detectors [(PID) x3] and DustTrak Aerosol Monitors (x3)					
Visitors:	None					
Contractor Information						
Subcontractor						
Archstone Builders LLC			General Contractor (GC)			
Capstone Contracting Corp.			Foundation Contractor			
Description and Location of Work Activities Performed						
Excavated and exported approximately 200 cubic yards of soil from Grid WC-2 (8'-16') to the Clean Earth of Carteret facility located in Carteret, New Jersey. The trucks backed in to the edge of the property line and were carefully loaded. No stockpiles were generated.						
Poured concrete in Grid WC-6 and WC-8.						
Material Disposal Tracking Information						
Destination Facility/Material Type	Daily Trucks	Total Trucks	Daily Approx. Cubic Yds	Total Approx. Cubic Yds	Total Site Loads	Total Approximate Cubic Yards
Clean Earth of North Jersey (CENJ)/(haz lead soil)	0	10	0	200	420	8,400
Clean Earth of North Jersey (CENJ)/(haz TCE soil)	0	6	0	120		
Bayshore Soil Management, LLC (Bayshore)	0	318	0	6,360		
River Front Recycling (C&D)	0	15	0	300		
Clean Earth of Carteret (CEC)	10	71	200	1,420		
Import Material Tracking Information						
Origin Facility	Daily Trucks	Total Trucks	Daily Tonnage	Total Tonnage	Total Site Loads	Total Quantity (tons or cy)
Aero Aggregate	0	1	0	88.4 CY	1 (26 bags on flatbed)	88.4 CY
Tilcon, Goshen or West Nyack Quarry	0	24	0	551.55	24	551.55 tons
Vulcan, Wantage or Hamburg Quarry	0	9	0.00	203.07	9	203.07 tons
CAMP Air Monitoring Results						
CAMP Station	UPWIND				DOWNWIND	
Odors:	None				None	
VOC Action Level Exceedance(s):	None				None	
Particulate Action Level Exceedance(s):	None				None	
Maximum VOC Level (ppm) 15-min avg:	0.3105				0.0000	
Maximum Particulate Level (mg/m³) 15-min avg:	0.0675				0.1352	
CAMP Response Actions: None.						
Additional Information						
Planned Work Activity for Next Day/Week:	Foundation construction to continue. SSDS work to continue.					
Comments:	None					

Soil Waste Classification Grid Plan

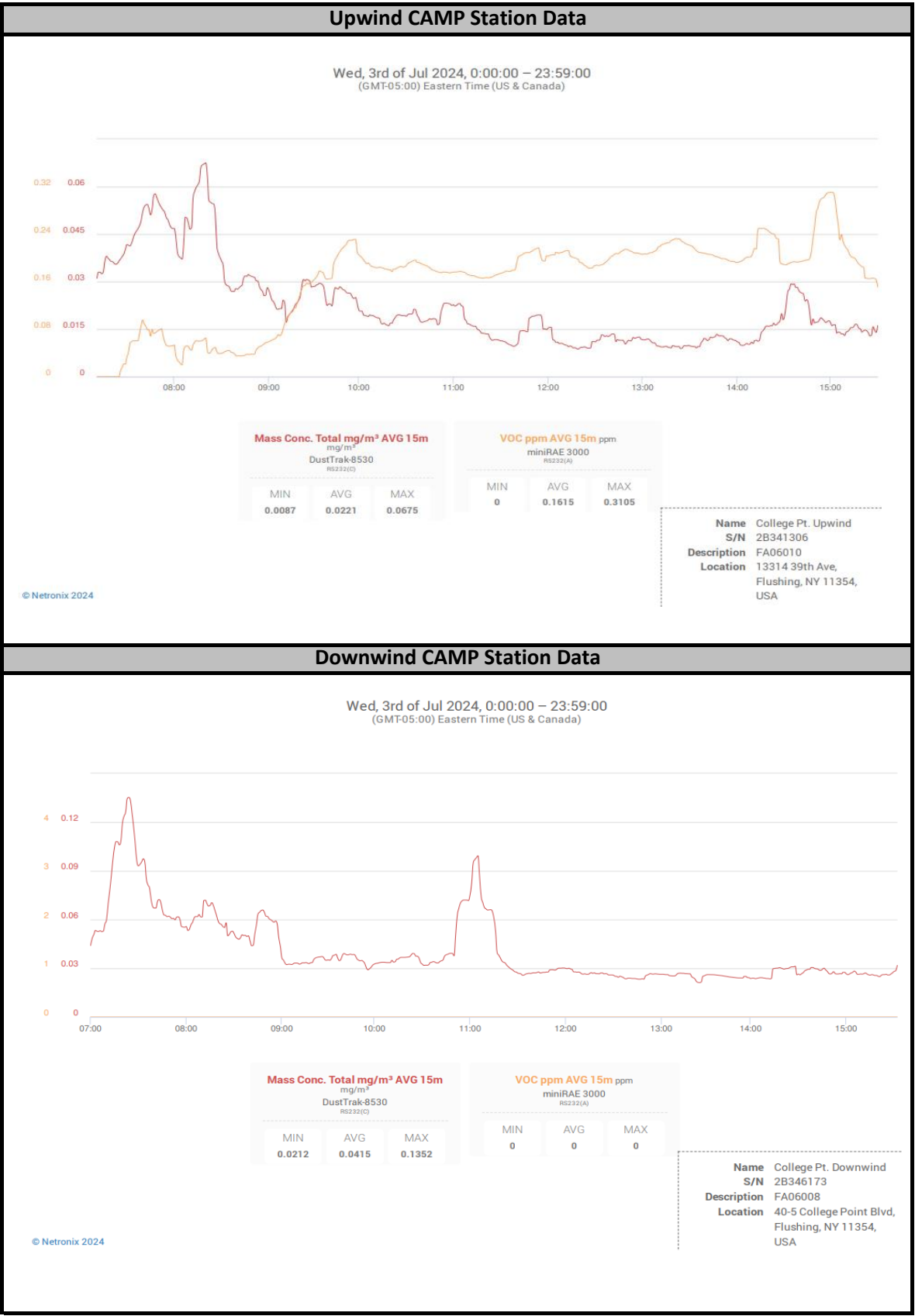

- LEGEND**
- PROJECT SITE BOUNDARY
 - WASTE CHARACTERIZATION GRID
 - LOT BOUNDARY AND TAX LOT NUMBER
 - 4973 BLOCK NUMBER
 - EXISTING BUILDING
 - PROPOSED NEW BLDG FOOTPRINT
 - PROPOSED SUNKEN YARD FOOTPRINT
 - 10X10 FEET HOTSPOT
 - LEAD AND TCE HOTSPOT SAMPLE LOCATION
 - WC-2 WASTE CHARACTERIZATION GRID NAME

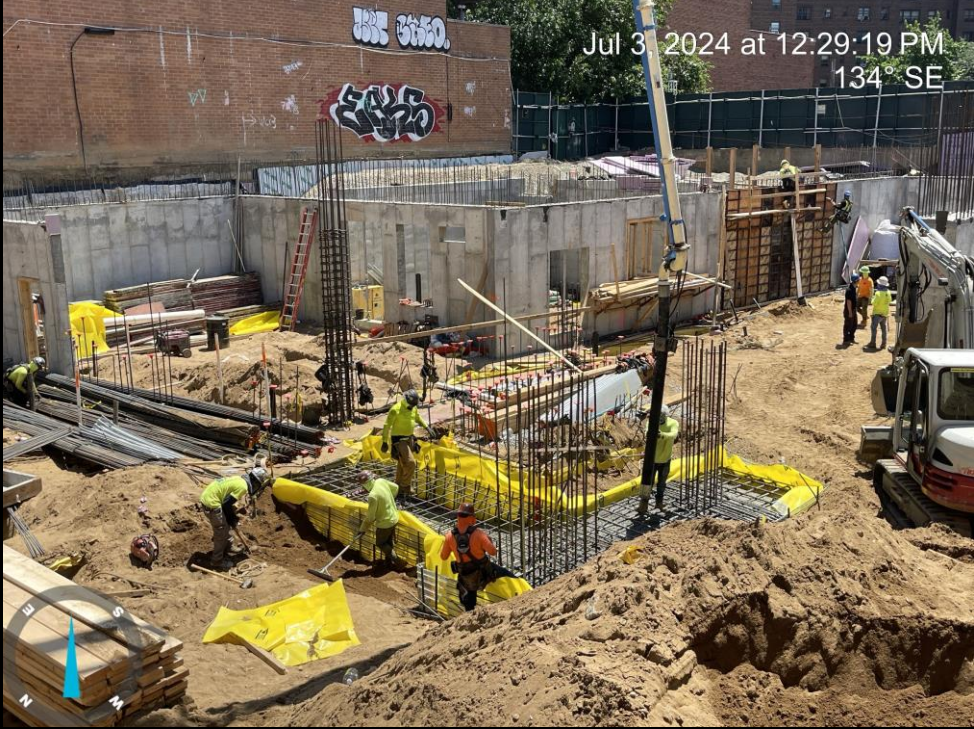
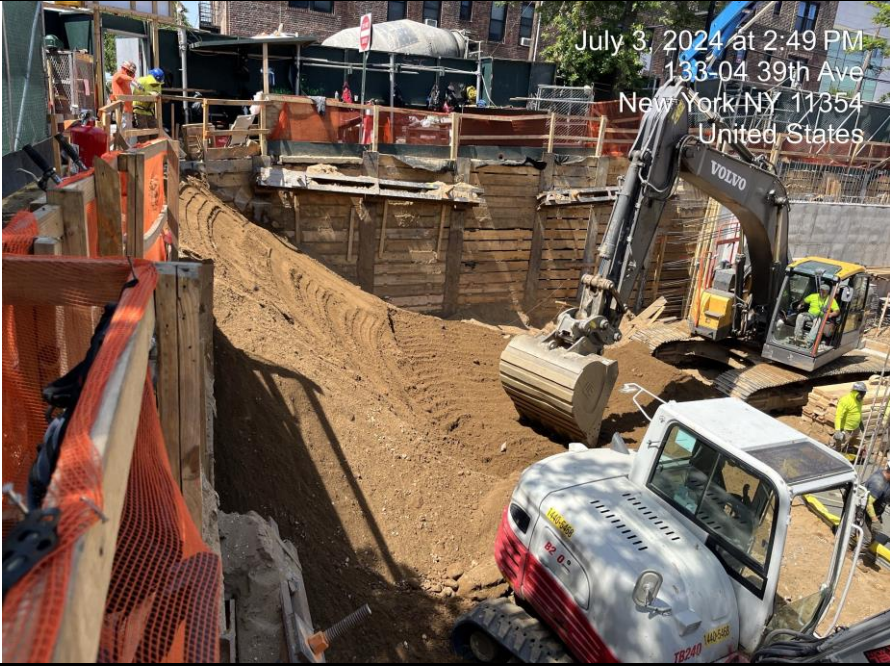

Site Photographs	
Photograph 1 - Pouring concrete and general site conditions, facing northeast.	 <p>Jul 3, 2024 at 12:13:10 PM 46° NE</p>
Photograph 2 - Pouring concrete for a footing, facing southeast.	 <p>Jul 3, 2024 at 12:29:19 PM 134° SE</p>
Photograph 3 - Grading access ramp in Grid WC-2, facing north.	 <p>July 3, 2024 at 2:49 PM 133-04 39th Ave New York NY 11354 United States</p>