	Daily Activity Report					
	Magnolia Gardens					
	39-03 College Point Boulevard, Queens, NY					
	BCP Site No. C241273					
General Site Information						
Date:	Saturday, July 6, 2024					
Weather:	73-93°F, Mostly Sunny					
Wind Direction/Speed (towards):	S @ 6-11 mph					
AKRF Personnel on Site:	Isabella Legovich					
AKRF Equipment on Site:	Mini RAE 3000 Photoionization Detectors [(PID) x3] and DustTrak Aerosol Monitors (x3)					
Visitors:	None					
Contractor Information						
Subcontractor						
Archstone Builders LLC			General Contractor (GC)			
Capstone Contracting Corp.			Foundation Contractor			
Description and Location of Work Activities Performed						
Excavation and grading related to SOE work occurred in Grids WC-2 and 6.						
Contractor installed vapor barrier in the northwestern portion of the site (WC-6).						
Contractor continued to install sub-slab components of the SSDS system- geotextile fabric and slotted PVC piping.						
Material Disposal Tracking Information						
Destination Facility/Material Type	Daily Trucks	Total Trucks	Daily Approx. Cubic Yds	Total Approx. Cubic Yds	Total Site Loads	Total Approximate Cubic Yards
Clean Earth of North Jersey (CENJ)/(haz lead soil)	0	10	0	200	420	8,400
Clean Earth of North Jersey (CENJ)/(haz TCE soil)	0	6	0	120		
Bayshore Soil Management, LLC (Bayshore)	0	318	0	6,360		
River Front Recycling (C&D)	0	15	0	300		
Clean Earth of Carteret (CEC)	0	71	0	1,420		
Import Material Tracking Information						
Origin Facility	Daily Trucks	Total Trucks	Daily Tonnage	Total Tonnage	Total Site Loads	Total Quantity (tons)
Aero Aggregate	0	1	0	88.4 CY	1 (26 bags on flatbed)	88.4 CY
Tilcon, Goshen or West Nyack Quarry	0	24	0	551.55	24	551.55 tons
Vulcan, Wantage or Hamburg Quarry	0	9	0.00	203.07	9	203.07 tons
CAMP Air Monitoring Results						
CAMP Station	UPWIND				DOWNWIND	
Odors:	None				None	
VOC Action Level Exceedance(s):	None				None	
Particulate Action Level Exceedance(s):	None				None	
Maximum VOC Level (ppm) 15-min avg:	0.0169				0.0000	
Maximum Particulate Level (mg/m³) 15-min avg:	0.0915				0.1213	
CAMP Response Actions: None.						
Additional Information						
Planned Work Activity for Next Day/Week:	Foundation construction to continue. Export soil for off site disposal. SSDS work to continue.					
Comments:	None					

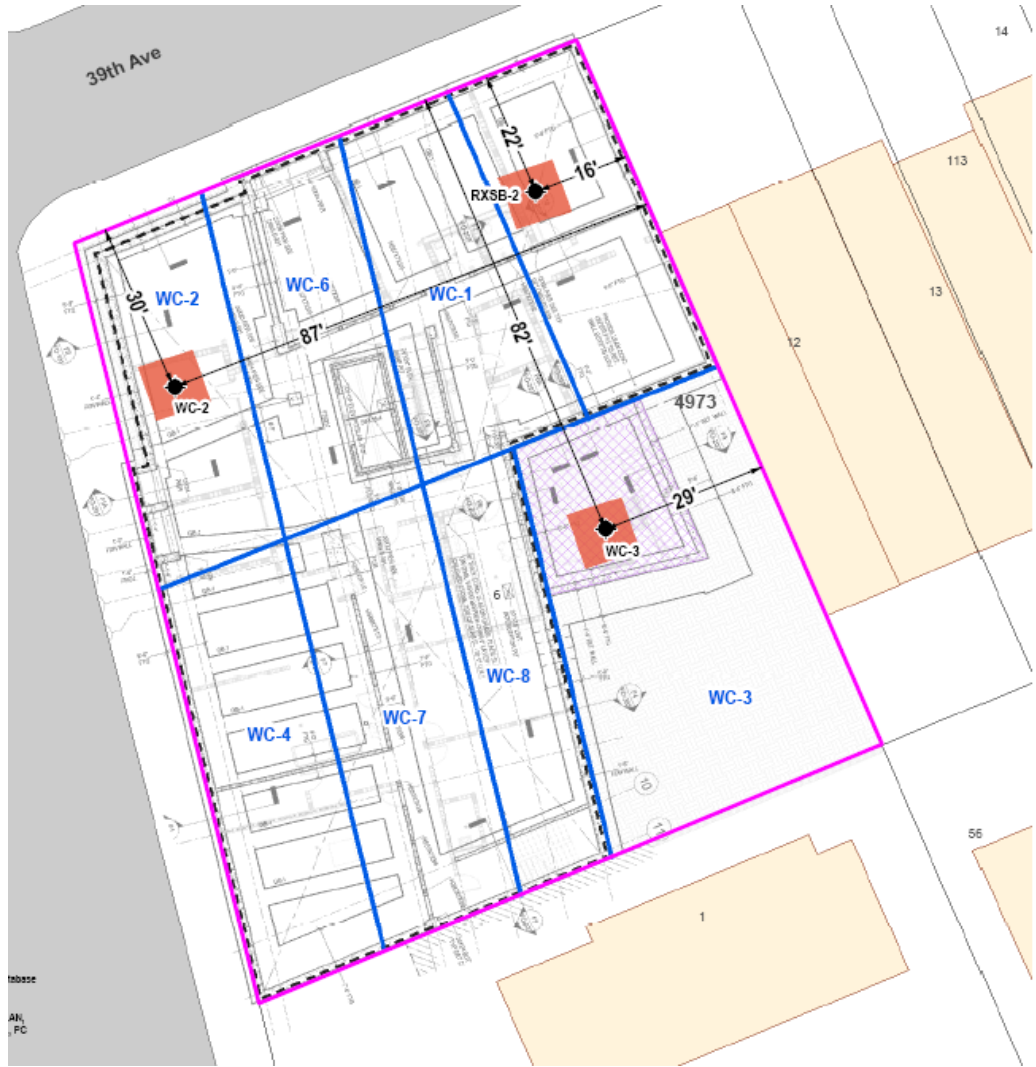

Soil Waste Classification Grid Plan

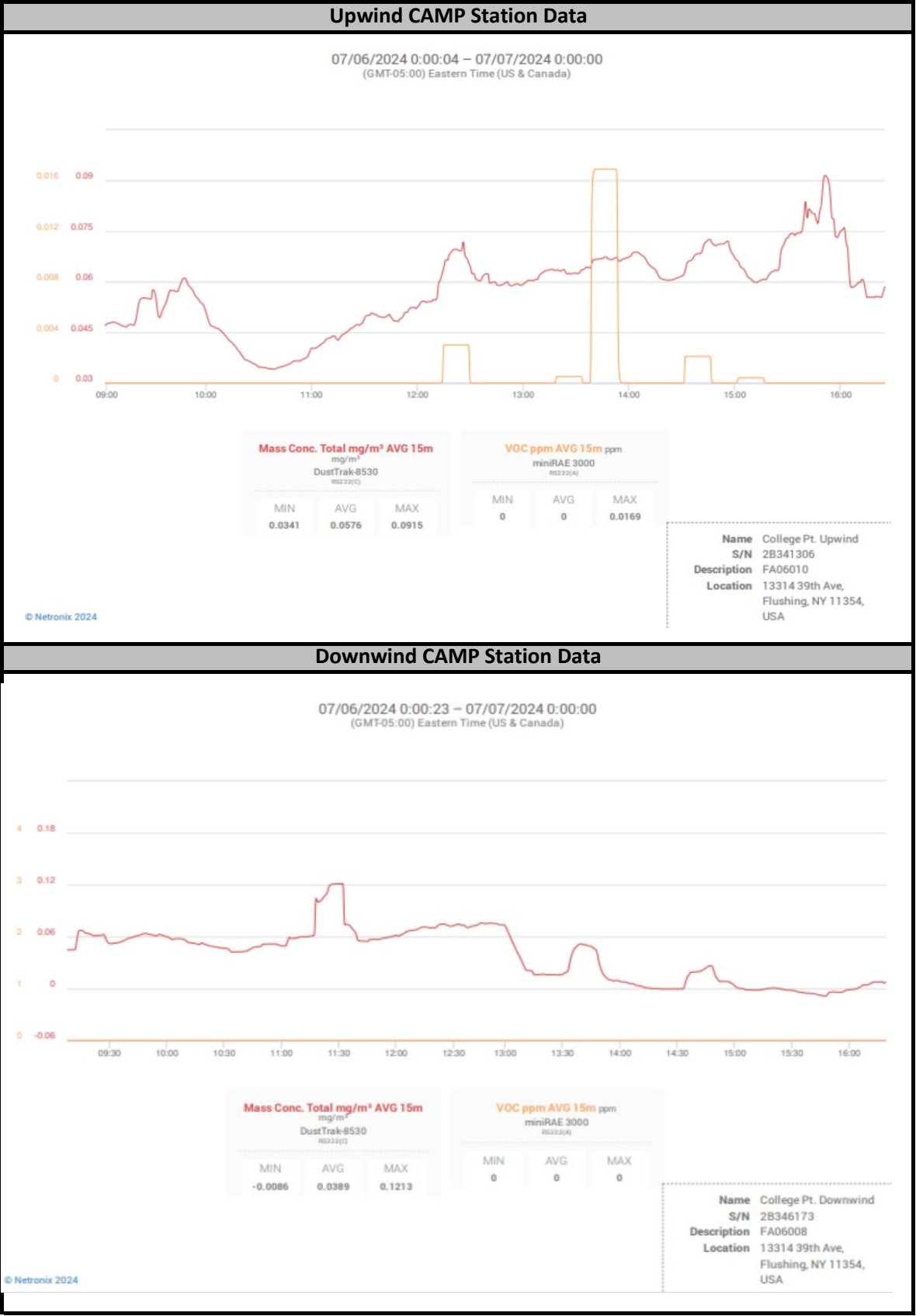

- LEGEND**
- PROJECT SITE BOUNDARY
 - WASTE CHARACTERIZATION GRID
 - LOT BOUNDARY AND TAX LOT NUMBER
 - 4973 BLOCK NUMBER
 - EXISTING BUILDING
 - PROPOSED NEW BLDG FOOTPRINT
 - PROPOSED SUNKEN YARD FOOTPRINT
 - 10X10 FEET HOTSPOT
 - LEAD AND TCE HOTSPOT SAMPLE LOCATION
 - WC-2 WASTE CHARACTERIZATION GRID NAME





Site Photographs	
Photograph 1 - Vapor barrier installation in the northwestern portion of site, facing north.	
Photograph 2 - Excavation and grading for SOE work in WC-06, facing north.	
Photograph 3 - SSDS pipe trench installation, facing west.	