	Daily Activity Report					
	Magnolia Gardens					
	39-03 College Point Boulevard, Queens, NY					
	BCP Site No. C241273					
General Site Information						
Date:	Monday, July 8, 2024					
Weather:	74-90°F, Mostly Sunny					
Wind Direction/Speed (towards):	NE @ 4-8 mph					
AKRF Personnel on Site:	Isabella Legovich					
AKRF Equipment on Site:	Mini RAE 3000 Photoionization Detectors [(PID) x3] and DustTrak Aerosol Monitors (x3)					
Visitors:	None					
Contractor Information						
Subcontractor						
Archstone Builders LLC				General Contractor (GC)		
Capstone Contracting Corp.				Foundation Contractor		
Description and Location of Work Activities Performed						
Excavated and exported approximately 240 cubic yards of soil from Grid WC-2 (8-16') to the Clean Earth of Carteret facility located in Carteret, New Jersey.						
Contractor installed vapor barrier in the northwestern portion of the site (WC-6), installed a pipe sleeve for the SSDS system, and poured concrete in the area.						
AKRF collected the post-excavation soil endpoint sample EP-01 at 15' below grade (Track 2 area), and associated QA/QC samples in accordance with the NYSDEC-approved RAWP. AKRF also collected a soil sample and a water sample from the investigative derived waste drums generated during the monitoring well and injection well installations.						
Material Disposal Tracking Information						
Destination Facility/Material Type	Daily Trucks	Total Trucks	Daily Approx. Cubic Yds	Total Approx. Cubic Yds	Total Site Loads	Total Approximate Cubic Yards
Clean Earth of North Jersey (CENJ)/(haz lead soil)	0	10	0	200	432	8,640
Clean Earth of North Jersey (CENJ)/(haz TCE soil)	0	6	0	120		
Bayshore Soil Management, LLC (Bayshore)	0	318	0	6,360		
River Front Recycling (C&D)	0	15	0	300		
Clean Earth of Carteret (CEC)	12	83	240	1,660		
Import Material Tracking Information						
Origin Facility	Daily Trucks	Total Trucks	Daily Tonnage	Total Tonnage	Total Site Loads	Total Quantity (tons)
Aero Aggregate	0	1	0	88.4 CY	1 (26 bags on flatbed)	88.4 CY
Tilcon, Goshen or West Nyack Quarry	0	24	0	551.55	24	551.55 tons
Vulcan, Wantage or Hamburg Quarry	0	9	0.00	203.07	9	203.07 tons
CAMP Air Monitoring Results						
CAMP Station	UPWIND				DOWNWIND	
Odors:	None				None	
VOC Action Level Exceedance(s):	None				None	
Particulate Action Level Exceedance(s):	None				None	
Maximum VOC Level (ppm) 15-min avg:	0.0658				0.0090	
Maximum Particulate Level (mg/m³) 15-min avg:	0.1139				0.0943	
CAMP Response Actions: The UW CAMP station experienced equipment issues due to overheating. Supplemental readings were documented with roving equipment and no issues were noted.						
Additional Information						
Planned Work Activity for Next Day/Week:	Foundation construction to continue. SSDS work to continue.					
Comments:	None					

Soil Waste Classification Grid Plan

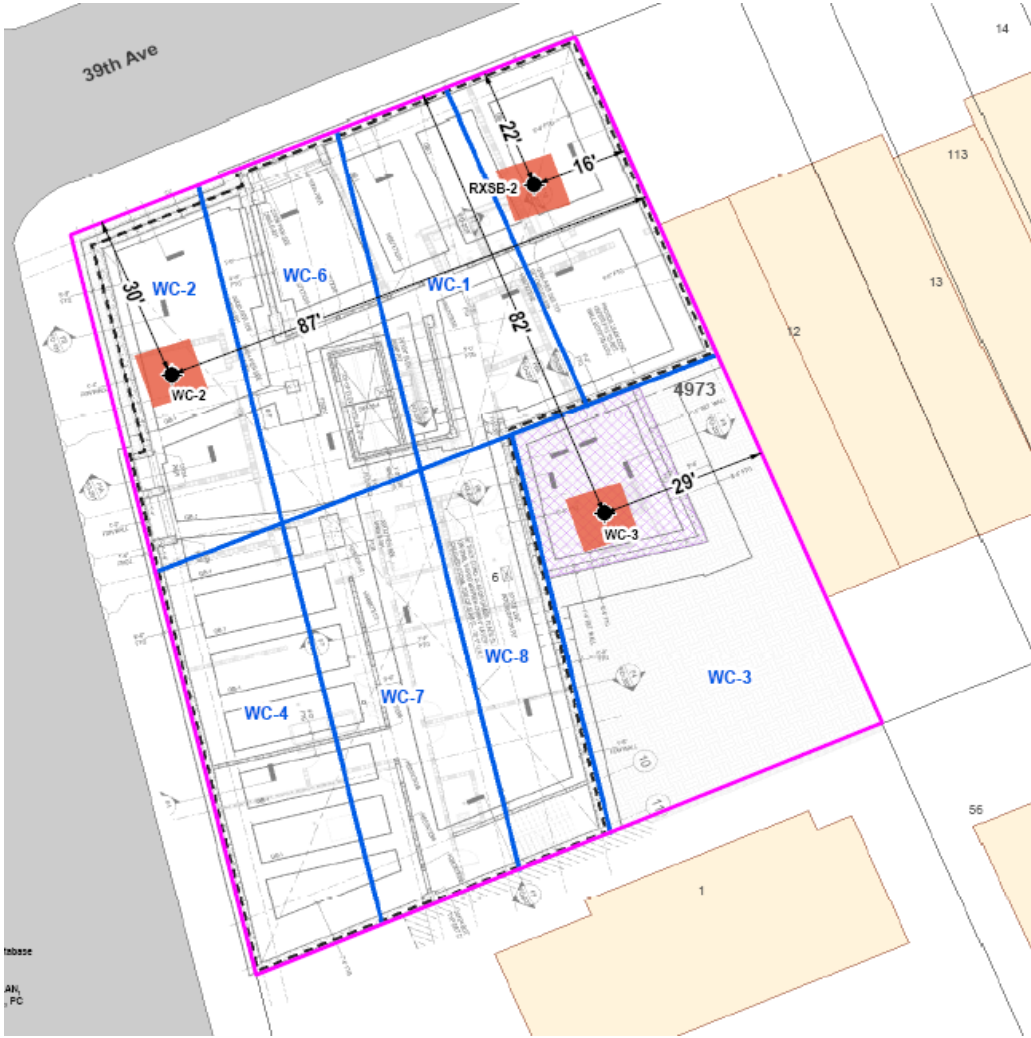

- LEGEND**
- PROJECT SITE BOUNDARY
 - WASTE CHARACTERIZATION GRID
 - LOT BOUNDARY AND TAX LOT NUMBER
 - 4973 BLOCK NUMBER
 - EXISTING BUILDING
 - PROPOSED NEW BLDG FOOTPRINT
 - PROPOSED SUNKEN YARD FOOTPRINT
 - 10X10 FEET HOTSPOT
 - LEAD AND TCE HOTSPOT SAMPLE LOCATION
 - WC-2 WASTE CHARACTERIZATION GRID NAME

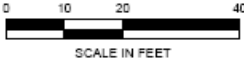

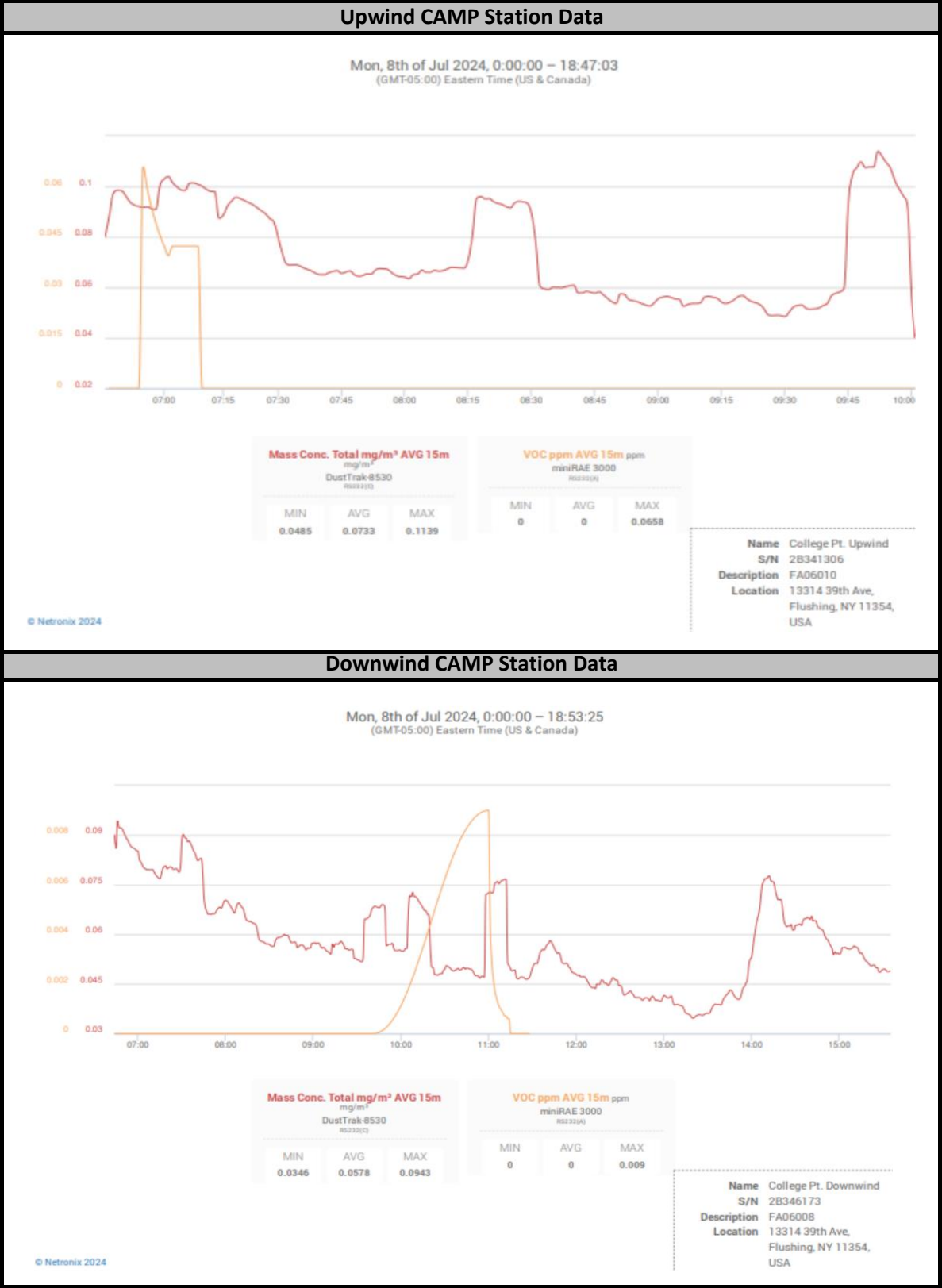

Site Photographs	
Photograph 1 - Vapor barrier installation in the northwestern portion of site, facing north.	
Photograph 2 - Pipe sleeve installation as part of SSDS.	
Photograph 3 - General site conditions, post-soil removal, facing north.	