

DSR 002: DAILY STATUS REPORT, 10-16 Beach 19th Street (C241276)
Work Activities for October 30, 2025

From: Caroline Clark, Gallagher Bassett Technical Services (GBTS) caroline_clark@gbtpa.com

To: Erick Bower, NYSDEC erick.bower@dec.ny.gov
Jane O'Connell, NYSDEC jane.oconnell@dec.ny.gov
Scott Deyette, NYSDEC scott.deyette@dec.ny.gov
William Bennett, NYSDEC william.bennett@dec.ny.gov
Michele Dolan, NYSDOH michele.dolan@health.ny.gov
Scarlett McLaughlin, NYSDOH scarlett.mclaughlin@health.ny.gov

CC: Richard Hooker, GBTS richard_hooker@gbtpa.com
Erick Salazar, GBTS erick_salazar@gbtpa.com
Jeff Fox, Foxy Development LLC jfox@foxymanagement.com
Joanna Choinska, Foxy Development LLC joanna@foxymanagement.com
Tristan Nadal, Points Five LLC tnadal@pointsfive.com
Dale Desnoyer, Allen & Desnoyers LLP dale@allendesnoyers.com

RE: Daily Status Report for the 10-16 Beach 19th Street BCP Site,
10-16 Beach 19th Street, Far Rockaway, Queens, New York

Fieldwork activities have been performed in conformance with the Remedial Investigation Work Plan (November 2024) and Supplemental Remedial Investigation Work Plan (SRIWP, October 2025) under the supervision of qualified personnel from Gallagher Bassett Technical Services (GBTS).

A) Overview of Remedial Services Completed During Reporting Period

Remedial investigation services completed by GBTS included the collection of twenty (20) soil samples, and documentation of groundwater elevation measurements from on-site monitoring wells to evaluate potential tidal impacts, in accordance with the SRIWP. A Supplemental Fieldwork Map showing grids is attached.

B) Locations of Work and Quantities of Material Imported and Exported

Lakewood Environmental Services Corp. utilized a mechanized Geoprobe (7822DT) to extend eight borings to 5 feet below grade (2SB-02, 2SB-03, 2SB-8 -2SB-10, 2SB-13, 2SB-18 and 2SB-27) and one boring to 10 feet (2SB-23). Soil samples were collected at the following locations and depths:

Sample	Depth	Grid	Sample	Depth	Grid
2SB-02	0-2.5	B1	2SB-10	4-5	E2
2SB-02	2.5-5	B1	2SB-13	0-3.5	A2, B2
2SB-03	0-2.5	C1	2SB-13	4-5	A2, B2
2SB-03	2.5-5	C1	2SB-13	9-10	A2, B2
2SB-08	0-1	G2	2SB-18	0-2.5	D3
2SB-08	4-5	G2	2SB-18	2.5-5	D3
2SB-09	0-1	F2	2SB-23	0-2.5	E4
2SB-09	1-3	F2	2SB-23	2.5-5	E4
2SB-09	3-5	F2	2SB-27	0-2.5	B4
2SB-10	0-1	E2	2SB-27	2.5-5	B4

GBTS tied submersible data loggers (Heron “dipperLog”) to the j-plugs of monitoring wells MW-04 (Grid A1), MW-06 (Grid D1), and MW-09 (Grid A3), each data logger was then lowered into the water column and secured between the anticipated depth of groundwater and the terminus of each well. The data loggers recorded temperature and pressure measurements from the water column in 15 minute intervals over a period of 3 hours (1000 – 1300 EST). These datasets were utilized to calculate groundwater depth in each well over time. The results were then compared to tidal data from the same period to assess whether tidal influence was impacting the groundwater table on-site. Findings will be reported in the Revised Remedial Investigation Report (RIR).

No material was imported or exported.

C) Sampling Events

Twenty (20) soil samples were collected in accordance with the SRIWP (see table, above).

D) General Compliance with RAWP/Encountered Problems

There were no significant deviations from the RIWP, SRIWP, or problems encountered. No complaints were received. CAMP monitoring was not performed for dust due to continuous rainfall during the reporting period. VOCs were monitored was conducted periodically using a hand-held PID.

E) Upcoming Work

Upcoming work includes submission of the Revised RIR (anticipated submission November 2025).

F) Photographs

Representative photographs from the reporting period are shown below.



Typical boring setup (Grids A2 and B2)



Typical dipperLog setup (MW-06, Grid G1)

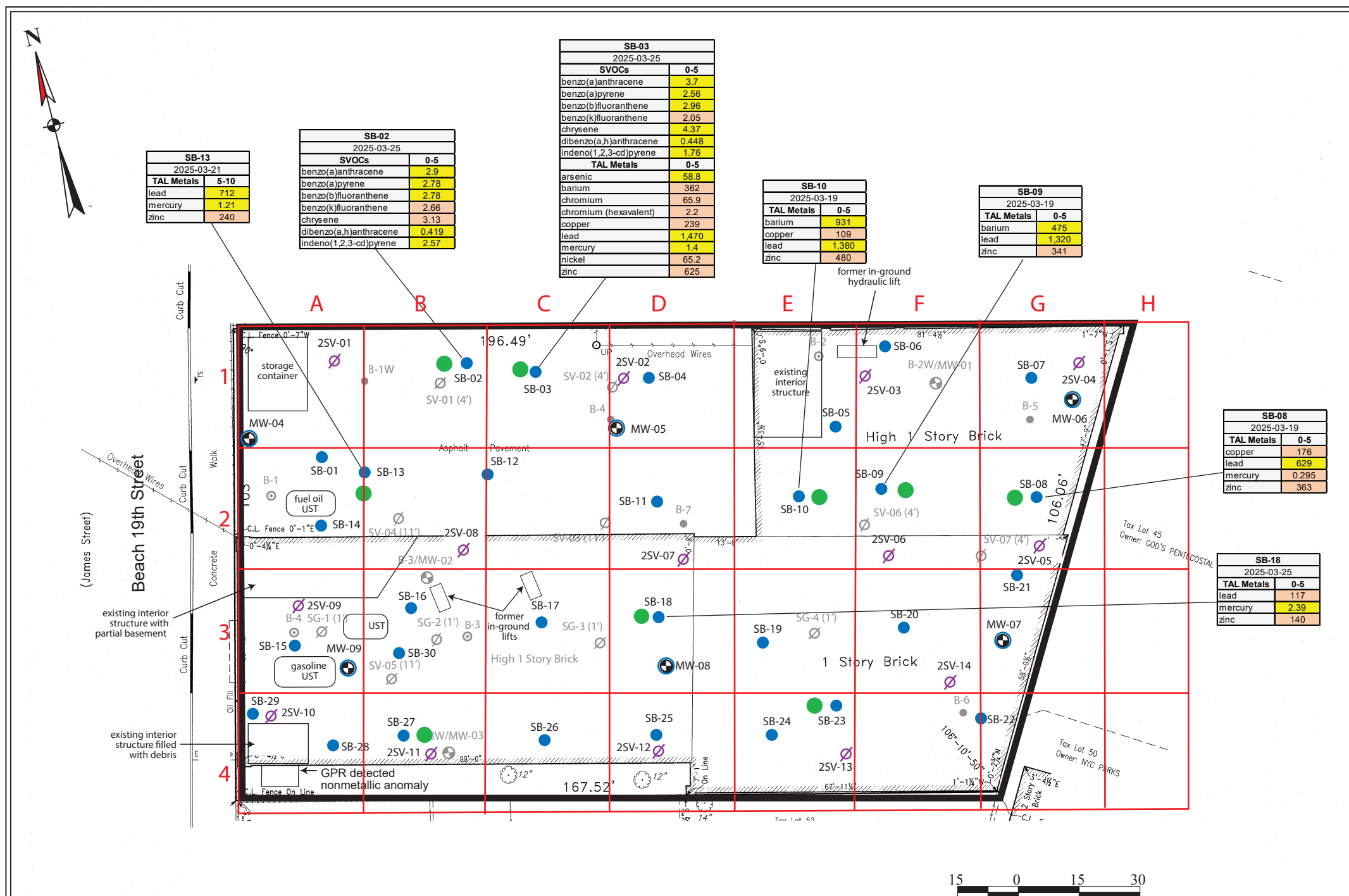

All feature locations are approximate. This map is intended as a schematic to be used in conjunction with the associated report, and it should not be relied upon as a survey for planning or other activities.

Supplemental Fieldwork Map

BCP ID: C241276
10-16 Beach 19th Street
Borough of Queens, New York

Legend:

- subject property border
- previous soil/groundwater sample location
- previous soil/groundwater monitoring well location
- previous soil boring location
- previous soil vapor location

- RI soil boring location
- RI soil vapor location
- RI monitoring well location
- *Note: All fieldwork conducted prior to building demolition
- supplemental soil boring location

All data in mg/Kg (ppm)
Analyte Above UU SCO
Analyte Above RRU SCO

File: 21003-0004

November 2025

Scale as shown

Attachment