

- LEGEND**
- PROPERTY BOUNDARY
  - ◆ VW-2 MONITORING WELL LOCATION AND IDENTIFICATION
  - ◆ GZ-1 BORING LOCATION AND IDENTIFICATION
  - ◆ GZ-25S MONITORING WELL LOCATION AND IDENTIFICATION
  - 13 SOIL GAS SAMPLE

- NOTES:**
1. BASE MAP WAS DEVELOPED FROM A PLAN PROVIDED BY ALTA ENVIRONMENTAL CORP. ENTITLED "WATER TABLE CONTOUR PLAN, 17 DECEMBER 2002", DATED JANUARY 2003, SCALE: 1"=40', FIGURE 1H.
  2. THE LOCATION OF THE SAMPLING EXPLORATIONS WERE APPROXIMATELY DETERMINED BY TAPE MEASUREMENTS. THIS DATA SHOULD BE CONSIDERED ACCURATE ONLY TO THE DEGREE IMPLIED BY THE METHOD USED.
  3. SAMPLES COLLECTED BY GZA PERSONNEL BETWEEN 11/21/05 AND 11/22/05.

<b>FORMER ARGUESO FACILITY</b> <b>442 WAVERLY AVENUE</b> MAMARONECK, NEW YORK		<b>SOIL GAS SURVEY</b> <b>NOVEMBER 2005</b>	
Project Mgr: DJR Designed By: JMS Reviewed By: MJS Drawn By: MJS	Date: 12/2/05	1"=10' 0 5' 10' 20'	<b>GeoEnvironmental, Inc.</b> 27 Naak Road Vernon, Connecticut 06066 Phone (860)975-7655 Fax (860)972-2416
<b>JOB NO.</b> <b>43401</b>		<b>FIGURE NO.</b> <b>5</b>	
		REV. NO.	DESCRIPTION
		BY	DATE

**LEGEND**

- PROPERTY BOUNDARY
- ▲ VW-2 MONITORING WELL LOCATION AND IDENTIFICATION
- ◆ GZ-1 BORING LOCATION AND IDENTIFICATION
- ◆ GZ-25D MONITORING WELL LOCATION AND IDENTIFICATION
- ◆ 91.2 DEEP OVERBURDEN GROUNDWATER ELEVATION (FEET)
- TOTAL VOC CONCENTRATION (ug/L)  
PCE, TCE, AND ASSOCIATED DAUGHTER PRODUCTS CONCENTRATIONS (ug/L)

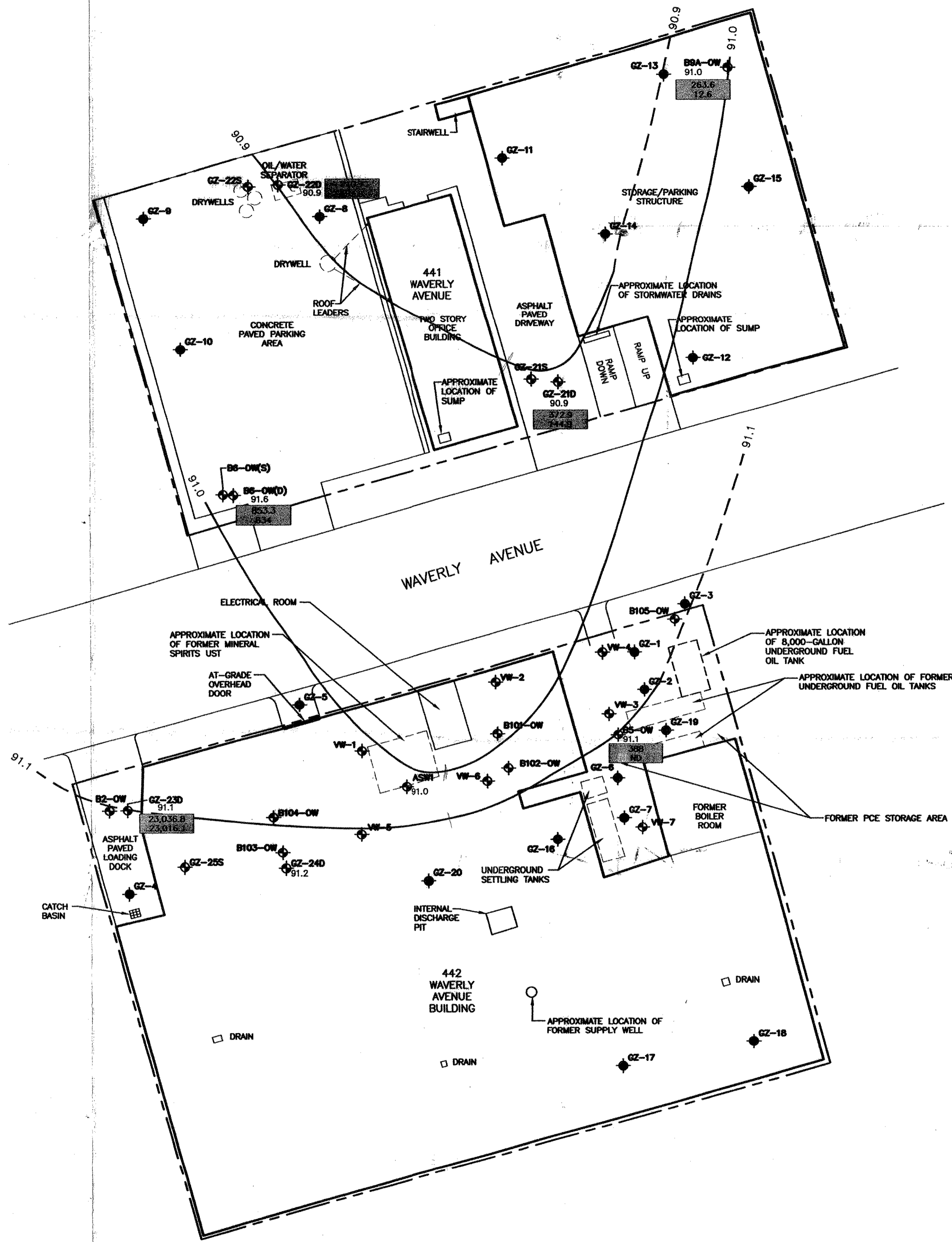

**NOTES:**

1. BASE MAP WAS DEVELOPED FROM A PLAN PROVIDED BY ALTA ENVIRONMENTAL CORP., ENTITLED "WATER TABLE CONTOUR PLAN, 17 DECEMBER 2002", DATED JANUARY 2003, SCALE: 1"=40', FIGURE 1H.
2. BORING EXPLORATIONS GZ-1 THROUGH GZ-20 WERE PERFORMED BY AEA TEST BORING OF SOUTH WINDSOR, CT BETWEEN SEPTEMBER 27, 2005 AND OCTOBER 6, 2005 UNDER THE OBSERVATION OF GZA PERSONNEL.
3. MONITORING WELLS GZ-21S/D, GZ-22S/D, GZ-23D, GZ-24D, AND GZ-25S WERE INSTALLED BY AEA TEST BORING OF SOUTH WINDSOR, CT BETWEEN SEPTEMBER 27, 2005 AND OCTOBER 6, 2005 UNDER THE OBSERVATION OF GZA PERSONNEL.
4. THE LOCATION OF THE BORINGS AND MONITORING WELLS WERE APPROXIMATELY DETERMINED BY TAPE MEASUREMENTS FROM EXISTING SITE FEATURES. THIS DATA SHOULD BE CONSIDERED ACCURATE ONLY TO THE DEGREE IMPLIED BY THE METHOD USED.
5. WATER LEVEL READINGS WERE MADE IN THE MONITORING WELLS ON 10/23/05. THIS DATA HAS BEEN REVIEWED AND INTERPRETATIONS MADE IN THE TEXT OF THIS REPORT. FLUCTUATIONS IN GROUNDWATER LEVEL OCCUR DUE TO VARIATIONS IN RAINFALL AND OTHER FACTORS.
6. CONTOURS ARE EXTRAPOLATED FROM WELL POINT DATA USING PROFESSIONAL JUDGMENT.
7. GROUNDWATER ELEVATION ARE BASED ON A SITE SPECIFIC ELEVATION DATUM.
8. REFER TO FIGURE NUMBER FOR ADDITIONAL NOTES AND LEGEND.
9. ND=NOT DETECTED

REV. NO.	DESCRIPTION	BY	DATE

1"=20'  
0 10' 20' 40'

**GeoEnvironmental, Inc.**  
27 Naak Road  
Vernon, Connecticut 06066  
Phone (860)75-7655 Fax (860)75-2416

Project Mgr: DJR  
Designed By: DJR  
Reviewed By: MUS  
Drawn By: MUS  
Date: 11/8/05

**FORMER ARGUESO FACILITY  
441 TO 442 WAVERLY AVENUE  
MAMARONECK, NEW YORK**

**DEEP OVERBURDEN  
GROUNDWATER CONTOURS**

JOB NO.  
**43401**

FIGURE NO.  
**4**

LEGEND

- PROPERTY BOUNDARY
- ▼ VW-2 90.8 MONITORING WELL LOCATION AND IDENTIFICATION  
SHALLOW OVERBURDEN GROUNDWATER ELEVATION (FEET)
- ◆ GZ-1 BORING LOCATION AND IDENTIFICATION
- ◆ GZ-22S 91.2 MONITORING WELL LOCATION AND IDENTIFICATION  
SHALLOW OVERBURDEN GROUNDWATER ELEVATION (FEET)
- 27.7 24.6 TOTAL VOC CONCENTRATION (ug/L)  
PCE, TCE, AND ASSOCIATED DAUGHTER PRODUCTS CONCENTRATIONS (ug/L)

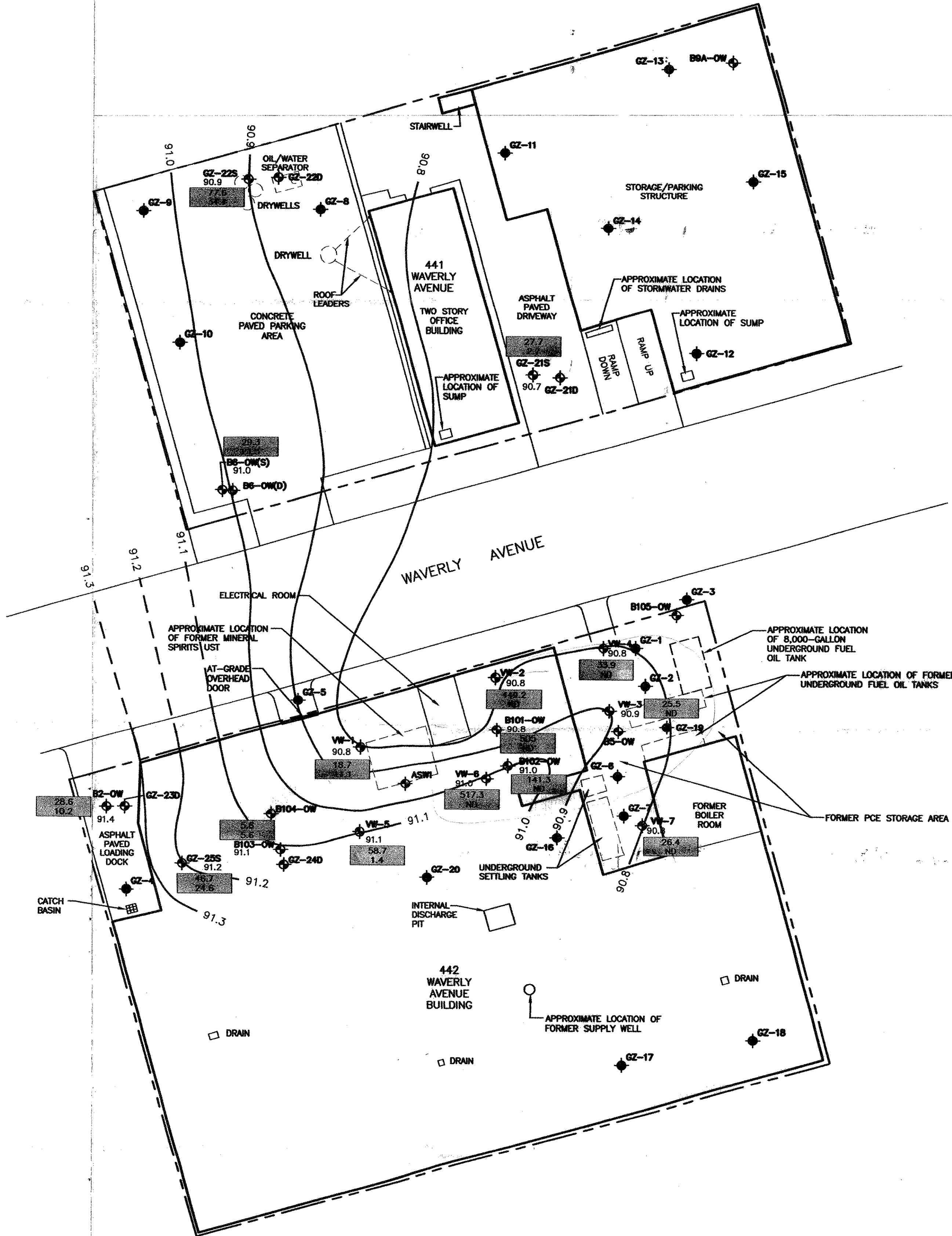

NOTES:

1. BASE MAP WAS DEVELOPED FROM A PLAN PROVIDED BY ALTA ENVIRONMENTAL CORP. ENTITLED "WATER TABLE CONTOUR PLAN, 17 DECEMBER 2002", DATED JANUARY 2003, SCALE: 1"=40', FIGURE 1H.
2. BORING EXPLORATIONS GZ-1 THROUGH GZ-20 WERE PERFORMED BY A&A TEST BORING OF SOUTH WINDSOR, CT BETWEEN SEPTEMBER 27, 2005 AND OCTOBER 6, 2005 UNDER THE OBSERVATION OF GZA PERSONNEL.
3. MONITORING WELLS GZ-21S/D, GZ-22S/D, GZ-23D, GZ-24D, AND GZ-25S WERE INSTALLED BY A&A TEST BORING OF SOUTH WINDSOR, CT BETWEEN SEPTEMBER 27, 2005 AND OCTOBER 6, 2005 UNDER THE OBSERVATION OF GZA PERSONNEL.
4. THE LOCATION OF THE BORINGS AND MONITORING WELLS WERE APPROXIMATELY DETERMINED BY TAPE MEASUREMENTS FROM EXISTING SITE FEATURES. THIS DATA SHOULD BE CONSIDERED ACCURATE ONLY TO THE DEGREE IMPLIED BY THE METHOD USED.
5. WATER LEVEL READINGS WERE MADE IN THE MONITORING WELLS ON 10/23/05. THIS DATA HAS BEEN REVIEWED AND INTERPRETATIONS MADE IN THE TEXT OF THIS REPORT. FLUCTUATIONS IN GROUNDWATER LEVEL OCCUR DUE TO VARIATIONS IN RAINFALL AND OTHER FACTORS.
6. CONTOURS ARE EXTRAPOLATED FROM WELL POINT DATA USING PROFESSIONAL JUDGMENT.
7. GROUNDWATER ELEVATION ARE BASED ON A SITE SPECIFIC ELEVATION DATUM.
8. REFER TO FIGURE NUMBER FOR ADDITIONAL NOTES AND LEGEND.
9. ND=NONE DETECTED

© 2005 - GZA GeoEnvironmental, Inc.

REV. NO.	DESCRIPTION	BY	DATE

Scale: 1"=20'  
0 10' 20' 40'

**GeoEnvironmental, Inc.**  
27 Nash Road  
Vernon, Connecticut 06066  
Phone (860)975-7665 Fax (860)972-2416

Project Mgr: DJR	MUS
Designed By: DJR	MUS
Reviewed By:	
Drawn By:	
Date: 11/8/05	

**FORMER ARGUESO FACILITY  
441 TO 442 WAVERLY AVENUE  
MAMARONECK, NEW YORK**

**SHALLOW OVERBURDEN  
GROUNDWATER CONTOURS**

JOB NO.  
**43401**

FIGURE NO.  
**3**

**LEGEND**

- PROPERTY BOUNDARY
- ◆ VW-2 MONITORING WELL LOCATION AND IDENTIFICATION
- ② AREA OF CONCERN LOCATION AND IDENTIFICATION
- ◆ GZ-1 BORING LOCATION AND IDENTIFICATION
- ◆ GZ-2SS MONITORING WELL LOCATION AND IDENTIFICATION

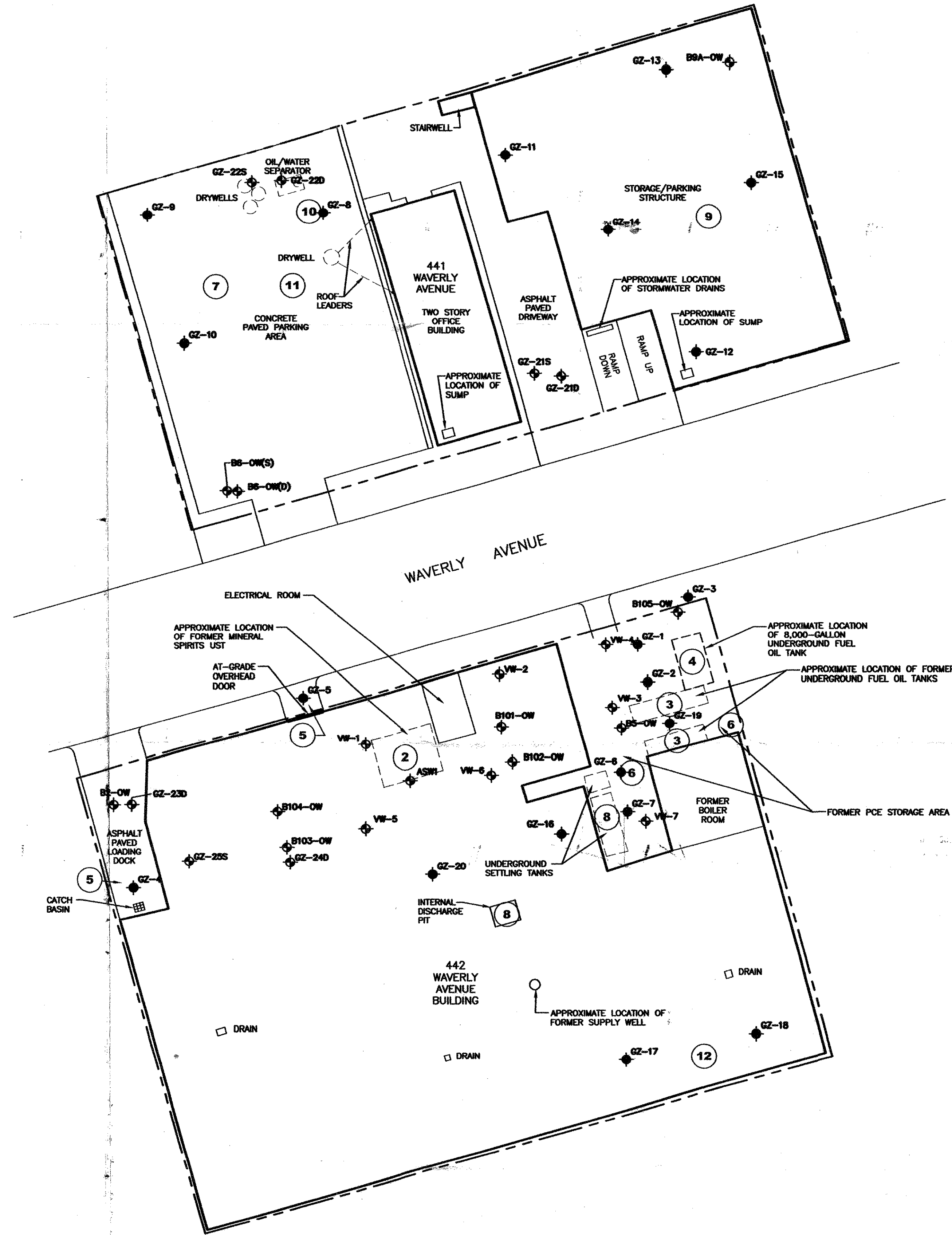

**AREAS OF CONCERN**

- AOC-1 CHLORINATED SOLVENT GROUNDWATER PLUME
- AOC-2 FORMER MINERAL SPIRITS UST
- AOC-3 FORMER FUEL OIL USTs
- AOC-4 CURRENT FUEL OIL UST
- AOC-5 LOADING DOCKS
- AOC-6 FORMER POE STORAGE AREA
- AOC-7 FORMER DRUM STORAGE IN CONCRETE PAVED PARKING AREA
- AOC-8 UNDERGROUND SETTLING TANKS AND FLOOR TRENCH SYSTEM
- AOC-9 BELOW-GRADE STORAGE AREA (NORTHWEST SIDE OF WAVERLY AVENUE)
- AOC-10 OIL/WATER SEPARATOR AND ASSOCIATED DRYWELLS
- AOC-11 DRYWELL UST
- AOC-12 FORMER ASW

**NOTES:**

1. BASE MAP WAS DEVELOPED FROM A PLAN PROVIDED BY ALTA ENVIRONMENTAL CORP. ENTITLED "WATER TABLE CONTOUR PLAN, 17 DECEMBER 2002", DATED JANUARY 2003, SCALE: 1"=40', FIGURE 1H.
2. BORING EXPLORATIONS GZ-1 THROUGH GZ-20 WERE PERFORMED BY AEA TEST BORING OF SOUTH WINDSOR, CT BETWEEN SEPTEMBER 27, 2005 AND OCTOBER 6, 2005 UNDER THE OBSERVATION OF GZA PERSONNEL.
3. MONITORING WELLS GZ-21S/D, GZ-22S/D, GZ-23D, GZ-24D, AND GZ-25S WERE INSTALLED BY AEA TEST BORING OF SOUTH WINDSOR, CT BETWEEN SEPTEMBER 27, 2005 AND OCTOBER 6, 2005 UNDER THE OBSERVATION OF GZA PERSONNEL.

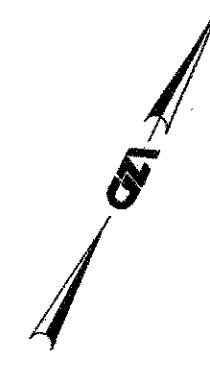

REV. NO.	DESCRIPTION	BY	DATE

1"=20'  
0 10' 20' 40'

**GeoEnvironmental, Inc.**  
27 Nisk Road  
Warren, CT 06898  
Phone (860)872-7855 Fax (860)872-2416

Project Mgr: DJR  
Designed By: DJR  
Reviewed By: MJS  
Drawn By: MJS  
Date: 9/16/05

**FORMER ARGUESO FACILITY  
441 TO 442 WAVERLY AVENUE  
MAMARONECK, NEW YORK  
SITE PLAN**

JOB NO.  
**43401**

FIGURE NO.  
**2**