



Note:

In March 2016, CE performed a Phase II ESA at the Subject Property. The soil samples showed several target VOC/SVOCs at levels above the Unrestricted Use Soil Cleanup Objectives. Elevated PID readings and strong petroleum odors were noted during soil sampling.

In February 2017, CE performed a Supplemental Subsurface Investigation (SSI) at the Subject Property. The SSI detected a 2-foot layer of urban fill material throughout the site. Lead (maximum 4,330 mg/Kg) was detected at levels exceeding the RRSCO (400 mg/Kg) within the urban fill layer at multiple locations. Mercury was detected at level (1.26 mg/Kg) exceeding the RRSCO (0.81 mg/Kg) at one (1) location (SB-21 [0'-2']). PCB was detected at level (3,000 ug/Kg) exceeding the RRSCO (1,000 ug/Kg) at one (1) location (SB-2B [5'-7']).

Parameters	RRSCO	SB-21 0'-2' 02/15/2017
Metals Total		mg/Kg
Lead, Pb	400	4330
Mercury	0.81	1.26

Parameters	Units	UUSCO	RRSCO	SB-1 3/3/2016
VOCs				
n-Propylbenzene	ug/Kg	3900	100,000a	4,100

Parameters	RRSCO	SB-2B 5'-7' 02/14/2017
PCBs		ug/Kg
Aroclor 1254	1000	3000

Parameters	RRSCO	SB-20 0'-2' 02/14/2017
Metals Total		mg/Kg
Lead, Pb	400	1820
SVOCs		ug/Kg
Benzo-a-Pyrene	1,000f	1100
Indeno(1,2,3-cd)Pyrene	500f	870

Parameters	RRSCO	SB-19 0'-2' 02/15/2017
Metals Total		mg/Kg
Lead, Pb	400	495

Parameters	RRSCO	SB-16 0'-2' 02/14/2017
Metals Total		mg/Kg
Lead, Pb	400	440
SVOCs		ug/Kg
Benzo-a-Anthracene	1,000f	5800
Benzo-a-Pyrene	1,000f	5800
Benzo-b-Fluoranthene	1,000f	5600
Benzo-k-Fluoranthene	3900	5400
Chrysene	3900	5800
Dibenzo-a,h-Anthracene	330e	720
Indeno(1,2,3-cd)Pyrene	500f	3500

Parameters	RRSCO	SB-14 0'-2' 02/14/2017
Metals Total		mg/Kg
Lead, Pb	400	3210

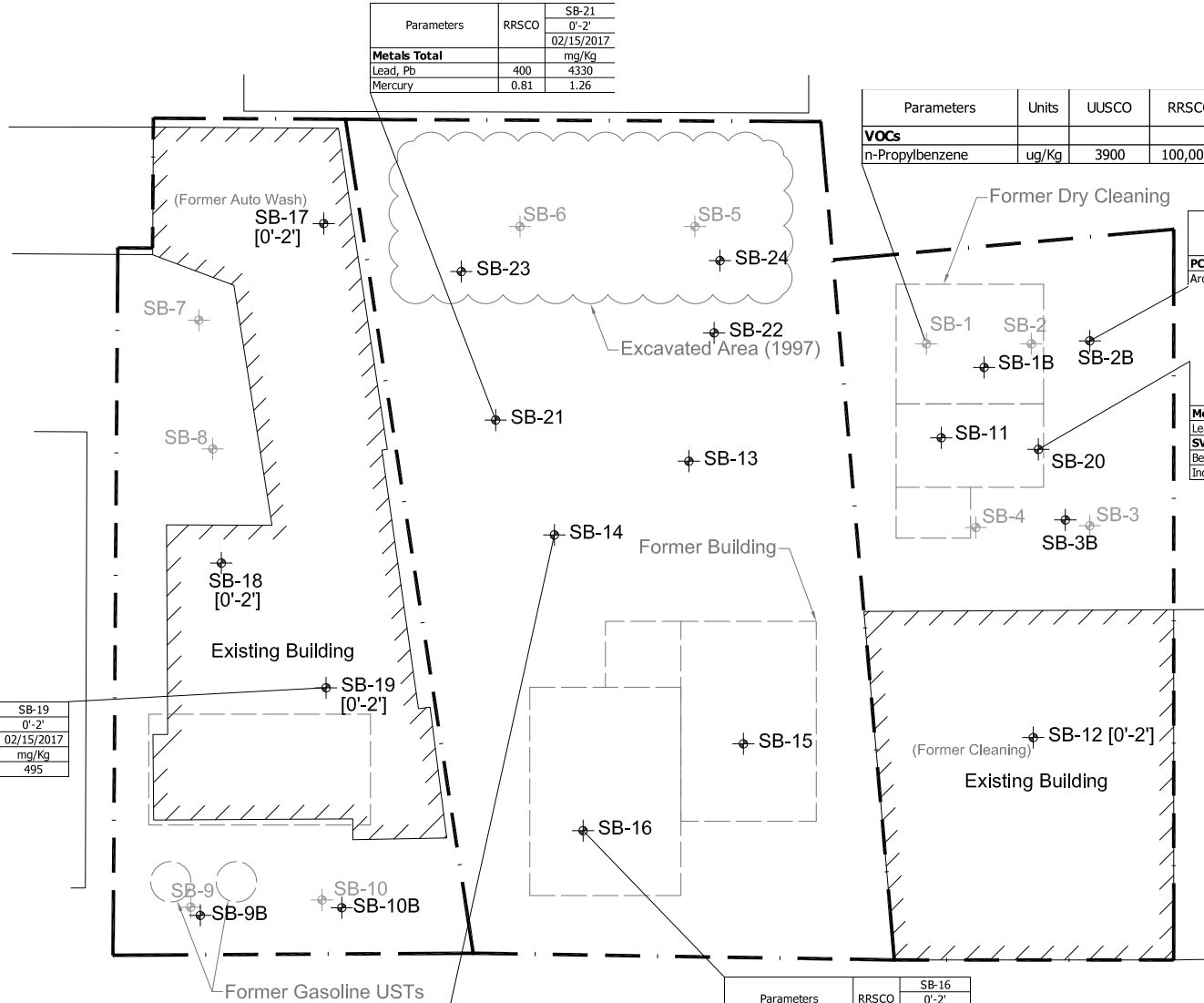

Huguenot Street

Legend

- ▲ SSI Groundwater Temporary Well
- SSI Soil Sampling Point
- ▲ Phase II Groundwater Temporary Well
- Phase II Soil Sampling Point
- Phase II Soil Gas Sampling Point

The information included on this graphic representation has been compiled from a variety of sources and is subject to change without notice. Cider Environmental makes no representations or warranties, express or implied, as to accuracy, completeness, timeliness, or rights to the use of such information. This document is not intended for use as a land survey product nor is it designed or intended as a construction design document. The use or misuse of the information contained on this graphic representation is at the sole risk of the party using or misusing the information.

TITLE: Summary of Exceedances- Soil			
381-393 Huguenot Street, New Rochelle, New York			
DRAWN BY:	WF	REVISED BY:	
CHECKED BY:	JC	REVISED DATE:	
DATE:	2-23-2017	APPROVED BY:	
SCALE:	1" = 25'	FILE NAME:	
PROJECT No. 2015-188		FIGURE No. 04	

