

Site Assessment and Inspection Report (SPDES GP-0-15-002, Part IV.C.4)



Name of Facility: Starbuck Island	Permit Number: NYR11D911
Location: Village of Green Island, New York	
Date of Inspection: October 23, 2018	Time of Inspection: 11:30 am
Weather: Cloudy - 46 Degrees	Rainfall Since Last Inspection: 0.08"
Purpose of Inspection: Bi-Weekly Inspection	Inspector: KPB

Report E-Mail Distribution List:

1.	Recipient: Owner's Representative	Josh Meppen	E-mail: jmeppen@luizziconstructionservices.com
2.	Recipient: Site Superintendent	Bill Jewett	E-mail: wjewett@luizziconstructionservices.com
3.	Recipient: Town Official	Maggie Alix	E-mail: maggie.alix@villageofgreenisland.com
4.	Recipient: Owner	Pete Luizzi	E-mail: pluizzi@luizzibros.com
5.	Recipient: Site Contractor	Mike Alix	E-mail: malix@luizzibros.com
6.	Recipient: NYSDEC	Mary Barrie	E-mail: mary.barrie@dec.ny.gov
7.	Recipient: NYSDEC	Michael Komoroske	E-mail: michael.komoroske@dec.ny.gov
8.	Recipient: NYSDEC	Alicia Barraza	E-mail: alicia.barraza@dec.ny.gov
9.	Recipient: Choose an item.	Gianna Aiezza	E-mail: gaiezza@envirospeceng.com
10.	Recipient: Choose an item.	Rachel Farnum	E-mail: rfarnum@envirospeceng.com

Kenneth P. Barber, PE
Qualified Professional

Site Conditions**Soil Conditions:**

- ☒ Dry
☐ Wet
☐ Saturated
☐ Frozen
☐ Snow Covered

Offsite Sediment Tracking:

- ☒ None
☐ Light
☐ Moderate
☐ Heavy

Discharge:

- ☒ None
☐ Light
☐ Moderate
☐ Heavy

Condition of Discharge:

- ☒ N/A
☐ Clean
☐ Evidence of Turbidity

Contrast to receiving water?

- ☐ Yes ☐ No ☒ N/A

Additional Comments: Contractor is maintaining existing pavement as additional buffer to prevent offsite sediment tracking. Continue sweeping of existing pavement.

General Clearing & Grading: 1**Clearing:**

- ☒ Vegetation cleared
☒ Soils disturbed

Grading:

- ☐ Exporting material
☐ Importing material
☐ Soils stockpiled

ESC Devices:

- ☒ Stabilized entrance
☒ Perimeter protection
☒ Temporary stabilization

Recommendations:

- ☐ Install stabilized entrance
☐ Repair/maintain stabilized entrance
☐ Enlarge stabilized entrance
☐ Restrict traffic to entrance
☐ Install perimeter protection
☐ Repair/stabilize perimeter protection
☐ Install outlet for perimeter protection
☐ Stabilize exposed soils
☐ Repair eroded soils and stabilize
☒ Continue to monitor exposed soils

Additional Comments: Monitor slope for erosion and repair, as needed.

General Clearing & Grading: 2**Clearing:**

- ☒ Vegetation cleared
☒ Soils disturbed

Grading:

- ☐ Exporting material
☐ Importing material
☐ Soils stockpiled

ESC Devices:

- ☒ Stabilized entrance
☐ Perimeter protection
☐ Temporary stabilization

Recommendations:

- ☐ Install stabilized entrance
☐ Repair/maintain stabilized entrance
☐ Enlarge stabilized entrance
☐ Restrict traffic to entrance
☐ Install perimeter protection
☐ Repair/stabilize perimeter protection
☐ Install outlet for perimeter protection
☒ Stabilize exposed soils
☐ Repair eroded soils and stabilize
☒ Continue to monitor exposed soils

Additional Comments: Stabilize soils if they are to remain inactive.

Site Stabilization**Paved Area:**

- ☐ Paved area at subgrade
- ☐ Utility work underway
- ☐ Utility work complete
- ☒ Subbase installed
- ☒ Pavement installed

Green Spaces:

- ☒ Grading complete
- ☐ Landscaping complete
- ☐ Temporarily stabilized
- ☐ Permanently stabilized

Recommendations:

- ☐ Install perimeter protection
 - ☐ Repair/stabilize perimeter protection
 - ☐ Remove perimeter protection
 - ☐ Install inlet protection
 - ☐ Install subbase
 - ☒ Grade and stabilize green spaces
 - ☐ Repair eroded soils and stabilize
- Sediment Tracking:** ☐ Yes ☐ No
- ☐ Sweep pavement daily, as needed
 - ☐ Restrict traffic to paved areas

Additional Comments:**Construction Entrance:****Condition:**

- ☒ Properly maintained and effective
- ☒ Installed pursuant to standards and specifications
- ☒ Traffic restricted to entrance when leaving and reentering site
- ☒ Adequate drainage provided to prevent ponding

Recommendation(s):

- ☐ Install entrance
- ☐ Top dress entrance
- ☐ Repair stone entrance
- ☒ Continue maintenance, as needed
- ☐ Widen stone entrance
- ☐ Lengthen stone entrance
- ☐ Sweep adjacent pavement
- ☐ Regrade entrance

Additional Comments:**Perimeter Protection: Silt Fence****Condition:**

- ☒ Silt fence installed in accordance with NYSDEC specifications
- ☐ Silt fence in need of maintenance or repair
- ☐ Silt fence nearing or exceeding capacity

Recommendation(s):

- ☐ Continue inspection and maintenance, as needed
- ☐ Properly reinstall and maintain fencing
- ☐ Repair toppled sections and maintain fencing
- ☐ Remove excess sediment and maintain fencing
- ☐ Remove fencing and replace with perimeter berm
- ☒ Remove unnecessary fencing and stabilize disturbed soils

Additional Comments: Remove unnecessary silt fence.

Perimeter Protection: Berm**Condition:**

- ☒ Berm installed in accordance with NYSDEC specifications
☐ Berm in need of maintenance or repair
☐ Berm nearing or exceeding capacity

Recommendation(s):

- ☒ Continue inspection and maintenance, as needed
☐ Stabilize berm with acceptable mulch material
☐ Repair damaged sections of berm and stabilize
☐ Install stone outlet at low point in grade
☐ Enlarge berm to provide for additional capacity
☐ Remove unnecessary berm and stabilize disturbed soils

Additional Comments:

Perimeter Protection: Berm**Condition:**

- ☒ Berm installed in accordance with NYSDEC specifications
☐ Berm in need of maintenance or repair
☐ Berm nearing or exceeding capacity

Recommendation(s):

- ☒ Continue inspection and maintenance, as needed
☐ Stabilize berm with acceptable mulch material
☐ Repair damaged sections of berm and stabilize
☐ Install stone outlet at low point in grade
☐ Enlarge berm to provide for additional capacity
☐ Remove unnecessary berm and stabilize disturbed soils

Additional Comments:

Stockpile Area:**Condition:**

- ☒ Stockpile area active
☐ Soils stabilized
☒ Adequate perimeter protection
☒ Stabilized stone access installed

Recommendation(s):

- | | |
|---|--|
| <input type="checkbox"/> Grade stockpile area | <input type="checkbox"/> Install stone access |
| <input type="checkbox"/> Stabilize stockpile area | <input type="checkbox"/> Repair stone access |
| <input type="checkbox"/> Install perimeter protection | <input type="checkbox"/> Sweep adjacent pavement |
| <input type="checkbox"/> Repair perimeter protection | <input type="checkbox"/> |

Additional Comments:

Woodchip Stockpile Area:**Condition:**

- ☐ Stockpile area active
☒ Soils stabilized
☒ Adequate perimeter protection
☒ Stabilized stone access installed

Recommendation(s):

- ☐ Grade stockpile area
☐ Stabilize stockpile area
☐ Install perimeter protection
☐ Repair perimeter protection
☐ Install stone access
☐ Repair stone access
☐ Sweep adjacent pavement

Additional Comments:**Protected Area: Hudson River****Rate of Flow:**

- ☐ None
☒ Light
☐ Moderate/Heavy

Natural Turbidity:

- ☐ None
☒ Light
☐ Moderate/Heavy

Recommendations:

- ☐ Install protective fencing
☐ Stabilize upslope soils

Discharge to Sensitive Area:

- ☒ None
☐ Light
☐ Moderate
☐ Heavy

Turbidity in Discharge:

- ☐ None
☐ Light
☐ Moderate/Heavy
☒ N/A

Discharge in significant contrast:

- ☐ Yes ☐ No ☒ N/A

Additional Comments:**Modifications to the SWPPP:**

Modification	Reason for Modification
09/21/17 – The small section of silt fencing installed adjacent to the river will be removed and a perimeter berm/dike will be installed along the perimeter of the site in lieu of fencing.	Perimeter berms have proven to be much more durable and require much less maintenance than silt fencing. Given the time of year and the likelihood the perimeter protection will be left in place for an extended period of time, berms are more reliable than fencing. The berms and downslope areas will be stabilized with wood chips and stump grindings.
09/21/17 – The perimeter swale and outlets will not be installed at this time. Rather, the perimeter will be sloped toward the interior of the site with the intent to infiltrate runoff. Stone outlets will be installed, as needed, in the coming months.	Site soils are such that discharge may not be necessary at all. Rather than create a discharge point, it is desirable to keep all runoff onsite to the maximum extent possible. The swale and the discharge points can be installed later, if needed.

SE. SITE PLAN: BY NINE LAND SURVEYING: 20 JANUARY 31, 2017.
 N. NS ARE BASED ON
 FACE EVIDENCE AND RECORD MAPPING. BUTCHMAN ASSOCIATES DOES NOT
 TO THE ACQUISITION OF THEIR LOCATION AND/OR COMPLETENESS. IT
 ALL UNDERGROUND STRUCTURES AND UTILITIES PRIOR TO ANY DIGGING
 CONSTRUCTION ACTIVITIES IN THEIR VICINITY. THE CONTRACTOR SHALL
 ALL EXISTING UTILITIES FIELD STAKED BEFORE STARTING WORK BY
 1-800-962-7992.

WENT TRAP	DRAINAGE AREA (ACRES)	REQUIRED SEDIMENT TRAP VOLUME (C.F.)	PROPOSED SEDIMENT TRAP VOLUME (C.F.)
1	1.45	5,220	5,702
2	1.58	5,688	6,210
3	2.68	10,368	14,868

PHASE DATA CHART	
ASE	AREA (ACRES)
1	4.97
2	1.33

PHASE 1 SHALL BE STABILIZED PRIOR TO PHASE 2 DISTURBANCE

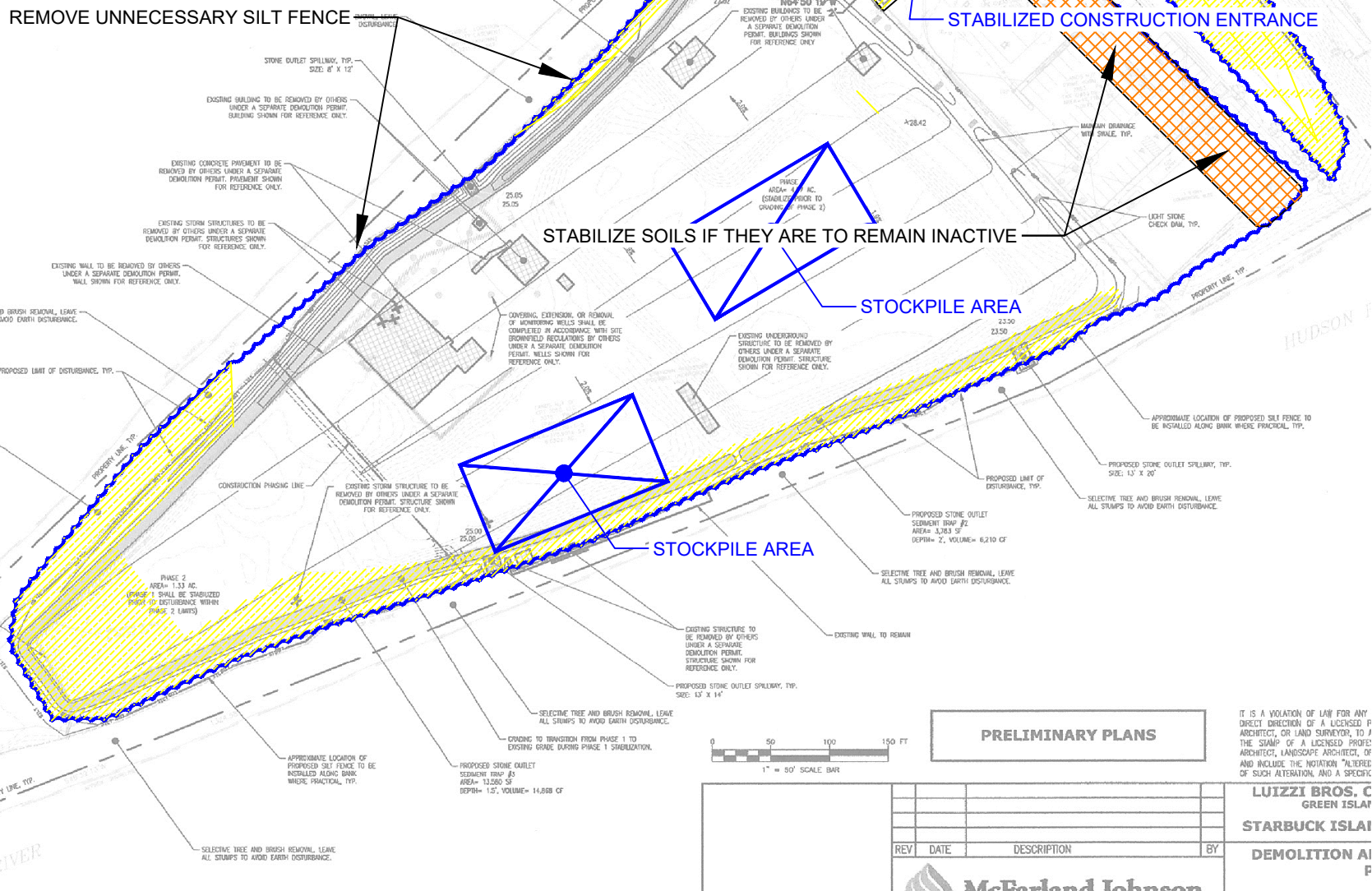

CONSTRUCTION DURATION INSPECTION REPORT





PROJECT INFORMATION: STARBUCK ISLAND (SPDES ID: NYR11D911)

JOB No.: 17-019 INSPECTOR: KPB DATE: 10/23/18 11:30 AM

PURPOSE OF INSPECTION: BI-WEEKLY INSPECTION

AMOUNT OF RAINFALL SINCE LAST INSPECTION: 0.08"

LEGEND:

-
-  LIMIT OF DISTURBANCE
 STABILIZED AREA (TEMPORARILY)
 STABILIZED AREA (PERMANENTLY)
 AREA THAT HAS NOT SEEN WORK IN 14 DAYS
 SILT FENCE



PO Box 454 - Nassau, New York 12123
Ph: (518) 322-3033 - Fax: (518) 766-0372
email: ken@barberpllc.com

SE. SITE PLAN: BY NINE LAND SURVEYING: 20 JANUARY 31, 2017.
 N. NS ARE BASED ON
 FACE EVIDENCE AND RECORD MAPPING. BUTCHMAN ASSOCIATES DOES NOT
 TO THE ACQUISITION OF THEIR LOCATION AND/OR COMPLETENESS. IT
 ALL UNDERGROUND STRUCTURES AND UTILITIES PRIOR TO ANY DIGGING
 CONSTRUCTION ACTIVITIES IN THEIR VICINITY. THE CONTRACTOR SHALL
 ALL EXISTING UTILITIES FIELD STAKED BEFORE STARTING WORK BY
 1-800-962-7992.

WENT TRAP	DRAINAGE AREA (ACRES)	REQUIRED SEDIMENT TRAP VOLUME (C.F.)	PROPOSED SEDIMENT TRAP VOLUME (C.F.)
1	1.45	5,220	5,702
2	1.58	5,688	6,210
3	2.88	10,368	14,868

PHASE DATA CHART	
PHASE	AREA (ACRES)
1	4.97
2	1.33

PHASE 1 SHALL BE STABILIZED PRIOR TO PHASE 2 DISTURBANCE.

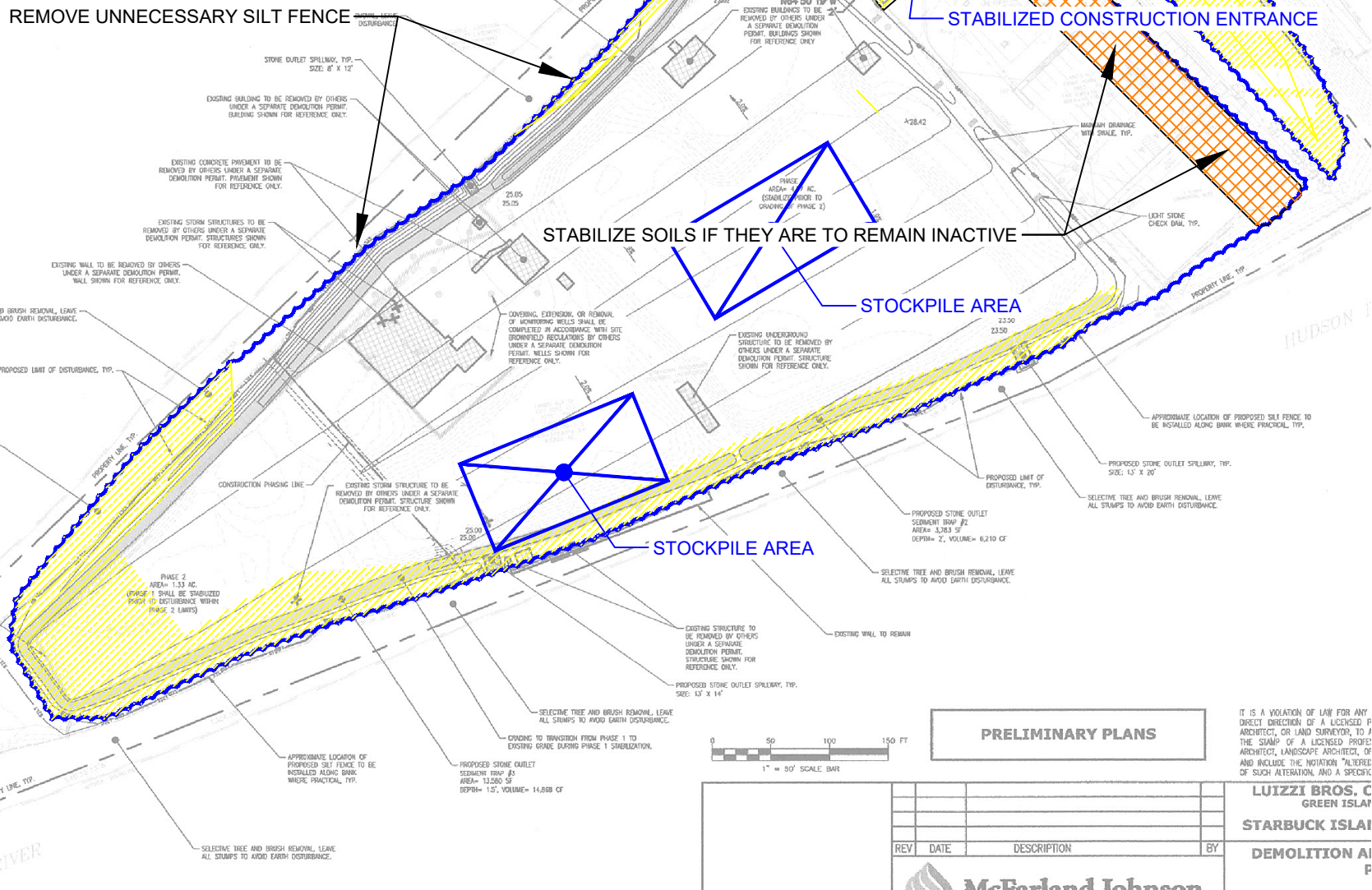

CONSTRUCTION DURATION INSPECTION REPORT





PROJECT INFORMATION: STARBUCK ISLAND (SPDES ID: NYR11D911)

JOB No.: 17-019 INSPECTOR: KPB DATE: 10/23/18 11:30 AM

PURPOSE OF INSPECTION: BI-WEEKLY INSPECTION

AMOUNT OF RAINFALL SINCE LAST INSPECTION: 0.08"

LEGEND:

-
-  LIMIT OF DISTURBANCE
 STABILIZED AREA (TEMPORARILY)
 STABILIZED AREA (PERMANENTLY)
 AREA THAT HAS NOT SEEN WORK IN 14 DAYS
 SILT FENCE



PO Box 454 - Nassau, New York 12123
Ph: (518) 322-3033 - Fax: (518) 766-0372
email: ken@barberpllc.com

Site Assessment and Inspection Report (SPDES GP-0-15-002, Part IV.C.4)



Name of Facility: Starbuck Island	Permit Number: NYR11D911
Location: Village of Green Island, New York	
Date of Inspection: October 27, 2018	Time of Inspection: 11:15 am
Weather: Rain - 39 Degrees	Rainfall Since Last Inspection: 0.00"
Purpose of Inspection: Bi-Weekly Inspection	Inspector: KPB

Report E-Mail Distribution List:

1.	Recipient: Owner's Representative	Josh Meppen	E-mail: jmeppen@luizziconstructionservices.com
2.	Recipient: Site Superintendent	Bill Jewett	E-mail: wjewett@luizziconstructionservices.com
3.	Recipient: Town Official	Maggie Alix	E-mail: maggie.alix@villageofgreenisland.com
4.	Recipient: Owner	Pete Luizzi	E-mail: pluizzi@luizzibros.com
5.	Recipient: Site Contractor	Mike Alix	E-mail: malix@luizzibros.com
6.	Recipient: NYSDEC	Mary Barrie	E-mail: mary.barrie@dec.ny.gov
7.	Recipient: NYSDEC	Michael Komoroske	E-mail: michael.komoroske@dec.ny.gov
8.	Recipient: NYSDEC	Alicia Barraza	E-mail: alicia.barraza@dec.ny.gov
9.	Recipient: Choose an item.	Gianna Aiezza	E-mail: gaiezza@envirospeceng.com
10.	Recipient: Choose an item.	Rachel Farnum	E-mail: rfarnum@envirospeceng.com

Kenneth P. Barber, PE
Qualified Professional

Site Conditions**Soil Conditions:**

- ☐ Dry
☐ Wet
☒ Saturated
☐ Frozen
☐ Snow Covered

Offsite Sediment Tracking:

- ☒ None
☐ Light
☐ Moderate
☐ Heavy

Discharge:

- ☒ None
☐ Light
☐ Moderate
☐ Heavy

Condition of Discharge:

- ☒ N/A
☐ Clean
☐ Evidence of Turbidity

Contrast to receiving water?

- ☐ Yes ☐ No ☒ N/A

Additional Comments: Contractor is maintaining existing pavement as additional buffer to prevent offsite sediment tracking. Continue sweeping of existing pavement.

General Clearing & Grading: 1**Clearing:**

- ☒ Vegetation cleared
☒ Soils disturbed

Grading:

- ☐ Exporting material
☐ Importing material
☐ Soils stockpiled

ESC Devices:

- ☒ Stabilized entrance
☒ Perimeter protection
☒ Temporary stabilization

Recommendations:

- ☐ Install stabilized entrance
☐ Repair/maintain stabilized entrance
☐ Enlarge stabilized entrance
☐ Restrict traffic to entrance
☐ Install perimeter protection
☐ Repair/stabilize perimeter protection
☐ Install outlet for perimeter protection
☐ Stabilize exposed soils
☐ Repair eroded soils and stabilize
☒ Continue to monitor exposed soils

Additional Comments: Monitor slope for erosion and repair, as needed.

General Clearing & Grading: 2**Clearing:**

- ☒ Vegetation cleared
☒ Soils disturbed

Grading:

- ☐ Exporting material
☐ Importing material
☐ Soils stockpiled

ESC Devices:

- ☒ Stabilized entrance
☐ Perimeter protection
☐ Temporary stabilization

Recommendations:

- ☐ Install stabilized entrance
☐ Repair/maintain stabilized entrance
☐ Enlarge stabilized entrance
☐ Restrict traffic to entrance
☐ Install perimeter protection
☐ Repair/stabilize perimeter protection
☐ Install outlet for perimeter protection
☒ Stabilize exposed soils
☐ Repair eroded soils and stabilize
☒ Continue to monitor exposed soils

Additional Comments: Stabilize soils if they are to remain inactive.

Site Stabilization**Paved Area:**

- ☐ Paved area at subgrade
- ☐ Utility work underway
- ☐ Utility work complete
- ☒ Subbase installed
- ☒ Pavement installed

Green Spaces:

- ☒ Grading complete
- ☐ Landscaping complete
- ☐ Temporarily stabilized
- ☐ Permanently stabilized

Recommendations:

- ☐ Install perimeter protection
 - ☐ Repair/stabilize perimeter protection
 - ☐ Remove perimeter protection
 - ☐ Install inlet protection
 - ☐ Install subbase
 - ☒ Grade and stabilize green spaces
 - ☐ Repair eroded soils and stabilize
- Sediment Tracking:** ☐ Yes ☐ No
- ☐ Sweep pavement daily, as needed
 - ☐ Restrict traffic to paved areas

Additional Comments:**Construction Entrance:****Condition:**

- ☒ Properly maintained and effective
- ☒ Installed pursuant to standards and specifications
- ☒ Traffic restricted to entrance when leaving and reentering site
- ☒ Adequate drainage provided to prevent ponding

Recommendation(s):

- ☐ Install entrance
- ☐ Top dress entrance
- ☐ Repair stone entrance
- ☒ Continue maintenance, as needed
- ☐ Widen stone entrance
- ☐ Lengthen stone entrance
- ☐ Sweep adjacent pavement
- ☐ Regrade entrance

Additional Comments:**Perimeter Protection: Silt Fence****Condition:**

- ☒ Silt fence installed in accordance with NYSDEC specifications
- ☐ Silt fence in need of maintenance or repair
- ☐ Silt fence nearing or exceeding capacity

Recommendation(s):

- ☐ Continue inspection and maintenance, as needed
- ☐ Properly reinstall and maintain fencing
- ☐ Repair toppled sections and maintain fencing
- ☐ Remove excess sediment and maintain fencing
- ☐ Remove fencing and replace with perimeter berm
- ☒ Remove unnecessary fencing and stabilize disturbed soils

Additional Comments: Remove unnecessary silt fence.

Perimeter Protection: Berm**Condition:**

- ☒ Berm installed in accordance with NYSDEC specifications
☐ Berm in need of maintenance or repair
☐ Berm nearing or exceeding capacity

Recommendation(s):

- ☒ Continue inspection and maintenance, as needed
☐ Stabilize berm with acceptable mulch material
☐ Repair damaged sections of berm and stabilize
☐ Install stone outlet at low point in grade
☐ Enlarge berm to provide for additional capacity
☐ Remove unnecessary berm and stabilize disturbed soils

Additional Comments:**Perimeter Protection: Berm****Condition:**

- ☒ Berm installed in accordance with NYSDEC specifications
☐ Berm in need of maintenance or repair
☐ Berm nearing or exceeding capacity

Recommendation(s):

- ☒ Continue inspection and maintenance, as needed
☐ Stabilize berm with acceptable mulch material
☐ Repair damaged sections of berm and stabilize
☐ Install stone outlet at low point in grade
☐ Enlarge berm to provide for additional capacity
☐ Remove unnecessary berm and stabilize disturbed soils

Additional Comments:**Stockpile Area:****Condition:**

- ☒ Stockpile area active
☐ Soils stabilized
☒ Adequate perimeter protection
☒ Stabilized stone access installed

Recommendation(s):

- | | |
|---|--|
| <input type="checkbox"/> Grade stockpile area | <input type="checkbox"/> Install stone access |
| <input type="checkbox"/> Stabilize stockpile area | <input type="checkbox"/> Repair stone access |
| <input type="checkbox"/> Install perimeter protection | <input type="checkbox"/> Sweep adjacent pavement |
| <input type="checkbox"/> Repair perimeter protection | <input type="checkbox"/> |

Additional Comments:

Woodchip Stockpile Area:**Condition:**

- ☐ Stockpile area active
☒ Soils stabilized
☒ Adequate perimeter protection
☒ Stabilized stone access installed

Recommendation(s):

- ☐ Grade stockpile area
☐ Stabilize stockpile area
☐ Install perimeter protection
☐ Repair perimeter protection
☐ Install stone access
☐ Repair stone access
☐ Sweep adjacent pavement

Additional Comments:**Protected Area: Hudson River****Rate of Flow:**

- ☐ None
☐ Light
☒ Moderate/Heavy

Natural Turbidity:

- ☐ None
☒ Light
☐ Moderate/Heavy

Recommendations:

- ☐ Install protective fencing
☐ Stabilize upslope soils

Discharge to Sensitive Area:

- ☒ None
☐ Light
☐ Moderate
☐ Heavy

Turbidity in Discharge:

- ☐ None
☐ Light
☒ Moderate/Heavy
☒ N/A

Discharge in significant contrast:

- ☐ Yes ☐ No ☒ N/A

- ☐ Install perimeter protection
☐ Repair perimeter protection

Additional Comments:**Modifications to the SWPPP:**

Modification	Reason for Modification
09/21/17 – The small section of silt fencing installed adjacent to the river will be removed and a perimeter berm/dike will be installed along the perimeter of the site in lieu of fencing.	Perimeter berms have proven to be much more durable and require much less maintenance than silt fencing. Given the time of year and the likelihood the perimeter protection will be left in place for an extended period of time, berms are more reliable than fencing. The berms and downslope areas will be stabilized with wood chips and stump grindings.
09/21/17 – The perimeter swale and outlets will not be installed at this time. Rather, the perimeter will be sloped toward the interior of the site with the intent to infiltrate runoff. Stone outlets will be installed, as needed, in the coming months.	Site soils are such that discharge may not be necessary at all. Rather than create a discharge point, it is desirable to keep all runoff onsite to the maximum extent possible. The swale and the discharge points can be installed later, if needed.

SITE PLAN: BY RHD LAND SURVEYING
20 JANUARY 31, 2017.
NO ARE BASED ON
FACE EVIDENCE AND RECORD MAPS. BROWMAN ASSOCIATES DOES NOT
TRY TO THE ACCURACY OF THEIR LOCATION AND/OR COMPLETENESS. IT
THE CONTRACTOR'S RESPONSIBILITY TO VERIFY THE LOCATION AND EXTENT
ALL UNDERGROUND STRUCTURES AND UTILITIES PRIOR TO ANY DIGGING
CONSTRUCTION ACTIVITIES IN THEIR VICINITY. THE CONTRACTOR SHALL
F. ALL EXISTING UTILITIES FIELD STAKED BEFORE STARTING WORK BY
LINE 1-800-962-7962.

TEMPORARY SEDIMENT TRAP CALCULATIONS				
MENT RAP	DISCHARGE AREA (ACRES)	REQUIRED TRAP VOLUME (C.F.)	PROPOSED TRAP VOLUME (C.F.)	
1	1.45	5,220	5,702	
2	1.58	5,688	6,210	
3	2.69	10,368	14,868	

PHASE DATA CHART	
ASE	AREA (ACRES)
1	4.97
2	1.33

1. PHASE 1 SHALL BE STABILIZED PRIOR TO PHASE 2 DISTURBANCE.

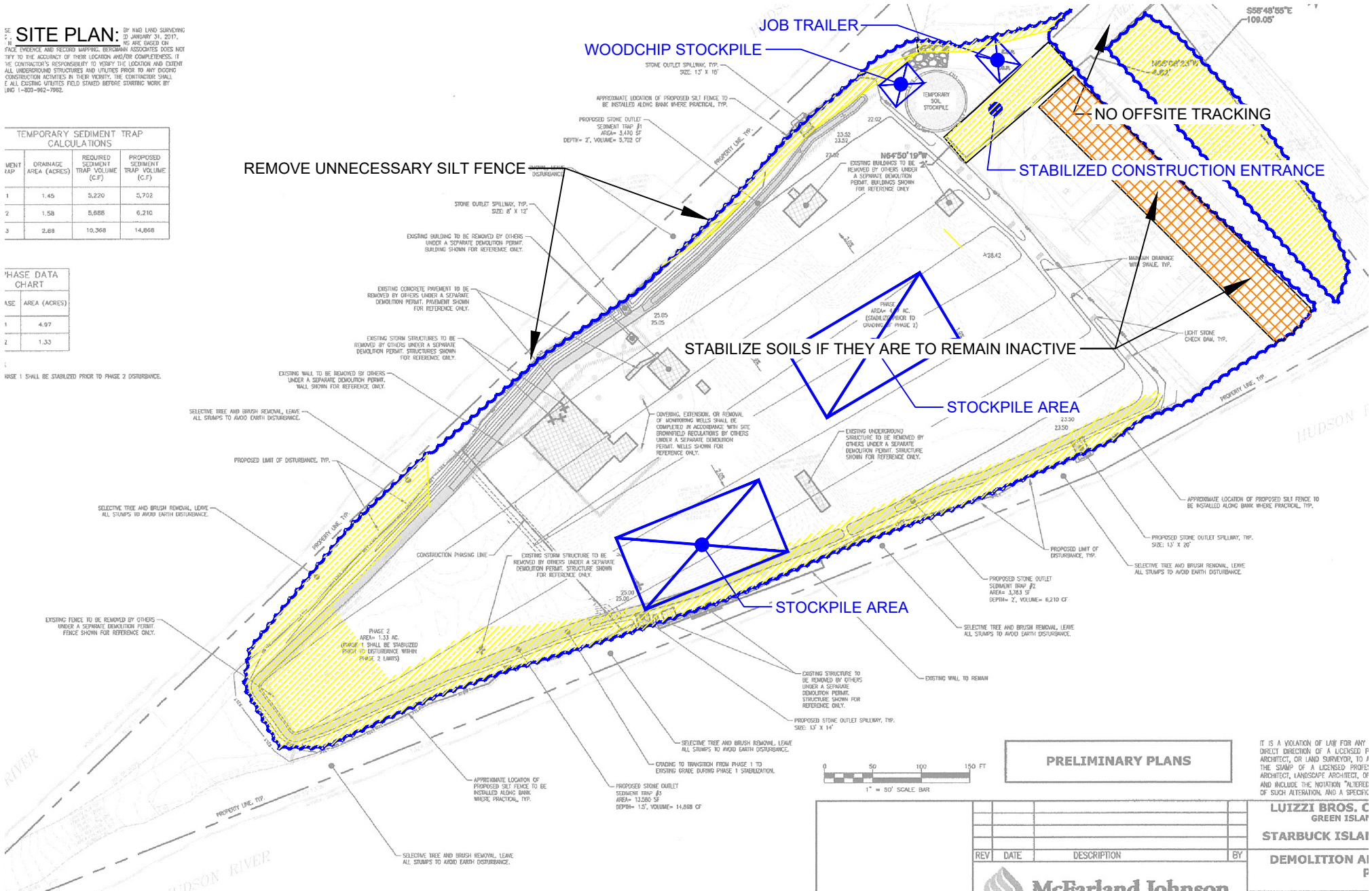

CONSTRUCTION DURATION INSPECTION REPORT

PROJECT INFORMATION: STARBUCK ISLAND (SPDES ID: NYR11D911)

JOB No.: 17-019 INSPECTOR: KPB DATE: 10/27/18 11:15 AM

PURPOSE OF INSPECTION: BI-WEEKLY INSPECTION

AMOUNT OF RAINFALL SINCE LAST INSPECTION: 0.00"

LEGEND:

- LIMIT OF DISTURBANCE
- STABILIZED AREA (TEMPORARILY)
- STABILIZED AREA (PERMANENTLY)
- AREA THAT HAS NOT SEEN WORK IN 14 DAYS
- SILT FENCE

Barber Engineering

PO Box 454 - Nassau, New York 12123
Ph: (518) 322-3033 - Fax: (518) 766-0372
email: ken@barberpllc.com

Site Assessment and Inspection Report (SPDES GP-0-15-002, Part IV.C.4)



Name of Facility: Starbuck Island	Permit Number: NYR11D911
Location: Village of Green Island, New York	
Date of Inspection: November 2, 2018	Time of Inspection: 12:00 pm
Weather: Cloudy - 60 Degrees	Rainfall Since Last Inspection: 0.27"
Purpose of Inspection: Bi-Weekly Inspection	Inspector: KMT

Report E-Mail Distribution List:

1.	Recipient: Owner's Representative	Josh Meppen	E-mail: jmeppen@luizziconstructionservices.com
2.	Recipient: Site Superintendent	Bill Jewett	E-mail: wjewett@luizziconstructionservices.com
3.	Recipient: Town Official	Maggie Alix	E-mail: maggie.alix@villageofgreenisland.com
4.	Recipient: Owner	Pete Luizzi	E-mail: pluizzi@luizzibros.com
5.	Recipient: Site Contractor	Mike Alix	E-mail: malix@luizzibros.com
6.	Recipient: NYSDEC	Mary Barrie	E-mail: mary.barrie@dec.ny.gov
7.	Recipient: NYSDEC	Michael Komoroske	E-mail: michael.komoroske@dec.ny.gov
8.	Recipient: NYSDEC	Alicia Barraza	E-mail: alicia.barraza@dec.ny.gov
9.	Recipient: Choose an item.	Gianna Aiezza	E-mail: gaiezza@envirospeceng.com
10.	Recipient: Choose an item.	Rachel Farnum	E-mail: rfarnum@envirospeceng.com

Kenneth P. Barber, PE
Qualified Professional

Site Conditions**Soil Conditions:**

- ☐ Dry
☐ Wet
☒ Saturated
☐ Frozen
☐ Snow Covered

Offsite Sediment Tracking:

- ☒ None
☐ Light
☐ Moderate
☐ Heavy

Discharge:

- ☒ None
☐ Light
☐ Moderate
☐ Heavy

Condition of Discharge:

- ☒ N/A
☐ Clean
☐ Evidence of Turbidity

Contrast to receiving water?

- ☐ Yes ☐ No ☒ N/A

Additional Comments: Contractor is maintaining existing pavement as additional buffer to prevent offsite sediment tracking. Continue sweeping of existing pavement.

General Clearing & Grading: 1**Clearing:**

- ☒ Vegetation cleared
☒ Soils disturbed

Grading:

- ☐ Exporting material
☐ Importing material
☐ Soils stockpiled

ESC Devices:

- ☒ Stabilized entrance
☒ Perimeter protection
☒ Temporary stabilization

Recommendations:

- ☐ Install stabilized entrance
☐ Repair/maintain stabilized entrance
☐ Enlarge stabilized entrance
☐ Restrict traffic to entrance
☐ Install perimeter protection
☐ Repair/stabilize perimeter protection
☐ Install outlet for perimeter protection
☐ Stabilize exposed soils
☐ Repair eroded soils and stabilize
☒ Continue to monitor exposed soils

Additional Comments: Monitor slope for erosion and repair, as needed.

General Clearing & Grading: 2**Clearing:**

- ☒ Vegetation cleared
☒ Soils disturbed

Grading:

- ☐ Exporting material
☐ Importing material
☐ Soils stockpiled

ESC Devices:

- ☒ Stabilized entrance
☐ Perimeter protection
☐ Temporary stabilization

Recommendations:

- ☐ Install stabilized entrance
☐ Repair/maintain stabilized entrance
☐ Enlarge stabilized entrance
☐ Restrict traffic to entrance
☐ Install perimeter protection
☐ Repair/stabilize perimeter protection
☐ Install outlet for perimeter protection
☒ Stabilize exposed soils
☐ Repair eroded soils and stabilize
☒ Continue to monitor exposed soils

Additional Comments: Stabilize soils if they are to remain inactive.

Site Stabilization**Paved Area:**

- ☐ Paved area at subgrade
- ☐ Utility work underway
- ☐ Utility work complete
- ☒ Subbase installed
- ☒ Pavement installed

Green Spaces:

- ☒ Grading complete
- ☐ Landscaping complete
- ☐ Temporarily stabilized
- ☐ Permanently stabilized

Recommendations:

- ☐ Install perimeter protection
 - ☐ Repair/stabilize perimeter protection
 - ☐ Remove perimeter protection
 - ☐ Install inlet protection
 - ☐ Install subbase
 - ☒ Grade and stabilize green spaces
 - ☐ Repair eroded soils and stabilize
- Sediment Tracking:** ☐ Yes ☐ No
- ☐ Sweep pavement daily, as needed
 - ☐ Restrict traffic to paved areas

Additional Comments:**Construction Entrance:****Condition:**

- ☒ Properly maintained and effective
- ☒ Installed pursuant to standards and specifications
- ☒ Traffic restricted to entrance when leaving and reentering site
- ☒ Adequate drainage provided to prevent ponding

Recommendation(s):

- ☐ Install entrance
- ☐ Top dress entrance
- ☐ Repair stone entrance
- ☒ Continue maintenance, as needed
- ☐ Widen stone entrance
- ☐ Lengthen stone entrance
- ☐ Sweep adjacent pavement
- ☐ Regrade entrance

Additional Comments:**Perimeter Protection: Silt Fence****Condition:**

- ☒ Silt fence installed in accordance with NYSDEC specifications
- ☐ Silt fence in need of maintenance or repair
- ☐ Silt fence nearing or exceeding capacity

Recommendation(s):

- ☐ Continue inspection and maintenance, as needed
- ☐ Properly reinstall and maintain fencing
- ☐ Repair toppled sections and maintain fencing
- ☐ Remove excess sediment and maintain fencing
- ☐ Remove fencing and replace with perimeter berm
- ☒ Remove unnecessary fencing and stabilize disturbed soils

Additional Comments: Remove unnecessary silt fence.

Perimeter Protection: Berm**Condition:**

- ☒ Berm installed in accordance with NYSDEC specifications
☐ Berm in need of maintenance or repair
☐ Berm nearing or exceeding capacity

Recommendation(s):

- ☒ Continue inspection and maintenance, as needed
☐ Stabilize berm with acceptable mulch material
☐ Repair damaged sections of berm and stabilize
☐ Install stone outlet at low point in grade
☐ Enlarge berm to provide for additional capacity
☐ Remove unnecessary berm and stabilize disturbed soils

Additional Comments:**Perimeter Protection: Berm****Condition:**

- ☒ Berm installed in accordance with NYSDEC specifications
☐ Berm in need of maintenance or repair
☐ Berm nearing or exceeding capacity

Recommendation(s):

- ☒ Continue inspection and maintenance, as needed
☐ Stabilize berm with acceptable mulch material
☐ Repair damaged sections of berm and stabilize
☐ Install stone outlet at low point in grade
☐ Enlarge berm to provide for additional capacity
☐ Remove unnecessary berm and stabilize disturbed soils

Additional Comments:**Stockpile Area:****Condition:**

- ☒ Stockpile area active
☐ Soils stabilized
☒ Adequate perimeter protection
☒ Stabilized stone access installed

Recommendation(s):

- | | |
|---|--|
| <input type="checkbox"/> Grade stockpile area | <input type="checkbox"/> Install stone access |
| <input type="checkbox"/> Stabilize stockpile area | <input type="checkbox"/> Repair stone access |
| <input type="checkbox"/> Install perimeter protection | <input type="checkbox"/> Sweep adjacent pavement |
| <input type="checkbox"/> Repair perimeter protection | <input type="checkbox"/> |

Additional Comments:

Woodchip Stockpile Area:**Condition:**

- ☐ Stockpile area active
☒ Soils stabilized
☒ Adequate perimeter protection
☒ Stabilized stone access installed

Recommendation(s):

- ☐ Grade stockpile area
☐ Stabilize stockpile area
☐ Install perimeter protection
☐ Repair perimeter protection
☐ Install stone access
☐ Repair stone access
☐ Sweep adjacent pavement

Additional Comments:**Protected Area: Hudson River****Rate of Flow:**

- ☐ None
☒ Light
☐ Moderate/Heavy

Natural Turbidity:

- ☐ None
☒ Light
☐ Moderate/Heavy

Recommendations:

- ☐ Install protective fencing
☐ Stabilize upslope soils

Discharge to Sensitive Area:

- ☒ None
☐ Light
☐ Moderate
☐ Heavy

Turbidity in Discharge:

- ☐ None
☐ Light
☐ Moderate/Heavy
☒ N/A

Discharge in significant contrast:

- ☐ Yes ☐ No ☒ N/A

- ☐ Install perimeter protection
☐ Repair perimeter protection

Additional Comments:**Modifications to the SWPPP:**

Modification	Reason for Modification
09/21/17 – The small section of silt fencing installed adjacent to the river will be removed and a perimeter berm/dike will be installed along the perimeter of the site in lieu of fencing.	Perimeter berms have proven to be much more durable and require much less maintenance than silt fencing. Given the time of year and the likelihood the perimeter protection will be left in place for an extended period of time, berms are more reliable than fencing. The berms and downslope areas will be stabilized with wood chips and stump grindings.
09/21/17 – The perimeter swale and outlets will not be installed at this time. Rather, the perimeter will be sloped toward the interior of the site with the intent to infiltrate runoff. Stone outlets will be installed, as needed, in the coming months.	Site soils are such that discharge may not be necessary at all. Rather than create a discharge point, it is desirable to keep all runoff onsite to the maximum extent possible. The swale and the discharge points can be installed later, if needed.

SITE PLAN: BY RHD LAND SURVEYING
20 JANUARY 31, 2017.
NO ARE BASED ON
FACE EVIDENCE AND RECORD MAPS. BROWMAN ASSOCIATES DOES NOT
TRY TO THE ACCURACY OF THEIR LOCATION AND/OR COMPLETENESS. IT
THE CONTRACTOR'S RESPONSIBILITY TO VERIFY THE LOCATION AND EXTENT
ALL UNDERGROUND STRUCTURES AND UTILITIES PRIOR TO ANY DIGGING
CONSTRUCTION ACTIVITIES IN THEIR VICINITY. THE CONTRACTOR SHALL
F. ALL EXISTING UTILITIES FIELD STAKED BEFORE STARTING WORK BY
LINE 1-800-962-7962.

TEMPORARY SEDIMENT TRAP CALCULATIONS				
MENT RAP	DISCHARGE AREA (ACRES)	REQUIRED TRAP VOLUME (C.F.)	PROPOSED TRAP VOLUME (C.F.)	
1	1.45	5,220	5,702	
2	1.58	5,688	6,210	
3	2.69	10,368	14,868	

PHASE DATA CHART	
ASE	AREA (ACRES)
1	4.97
2	1.33

1. PHASE 1 SHALL BE STABILIZED PRIOR TO PHASE 2 DISTURBANCE.

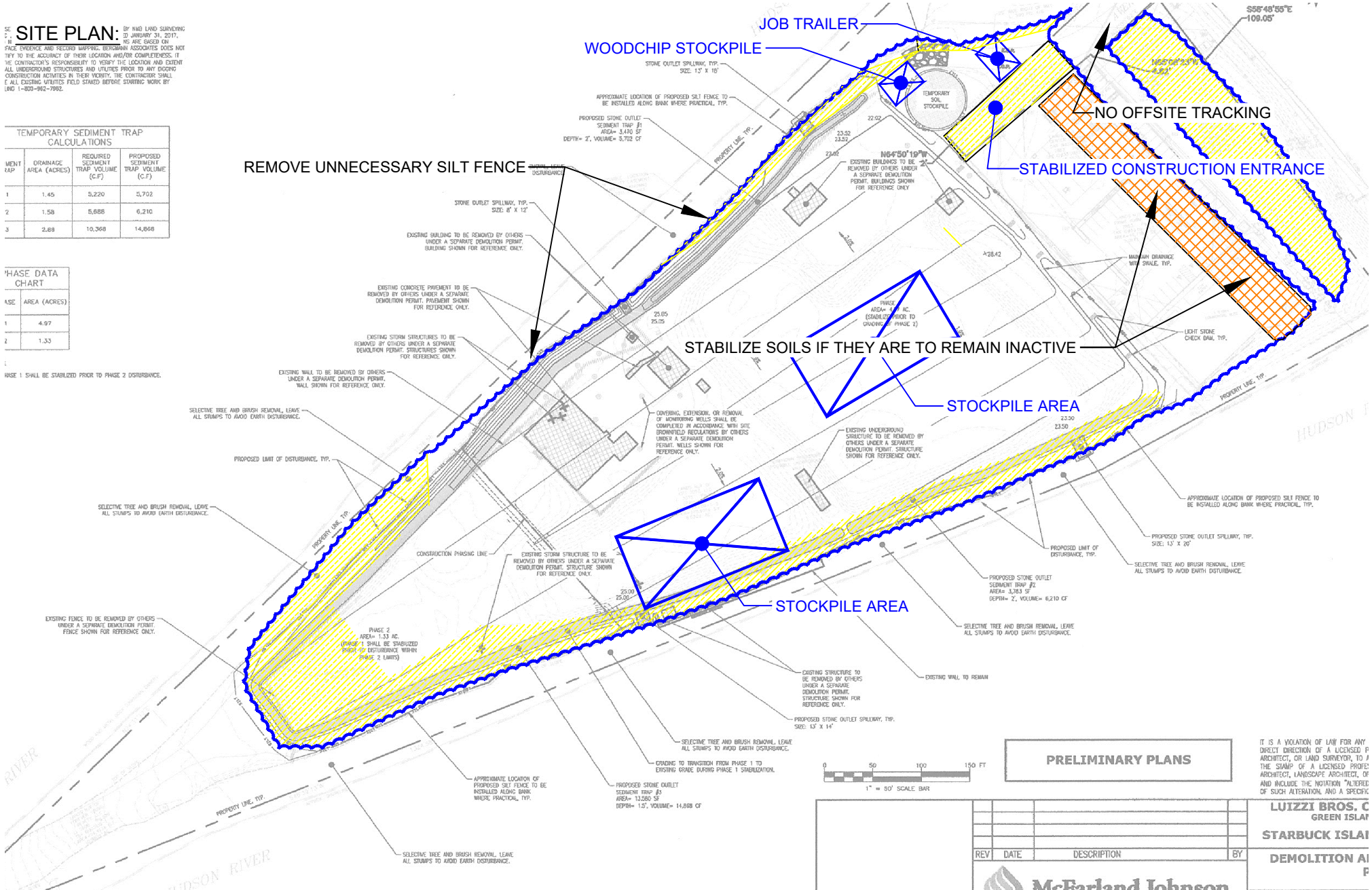

PRELIMINARY PLANS

IT IS A VIOLATION OF LAW FOR ANY
DIRECT OR INDIRECT OF A LICENSED P
ARCHITECT, OR LAND SURVEYOR, TO P
THE STAMP OF A LICENSED PROFES
ARCHITECT, LANDSCAPE ARCHITECT, OF
AND INCLUDE THE NOTATION "ALTERED
OF SUCH ALTERATION, AND A SPECIFIC

LUZZI BROS. C
GREEN ISLAND

STARBUCK ISLAND

DEMOLITION AND

REV	DATE	DESCRIPTION	BY

Barber Engineering

PO Box 454 - Nassau, New York 12123
Ph: (518) 322-3033 - Fax: (518) 766-0372
email: ken@barberpllc.com

CONSTRUCTION DURATION INSPECTION REPORT

PROJECT INFORMATION: STARBUCK ISLAND (SPDES ID: NYR11D911)

JOB No.: 17-019 INSPECTOR: KPB DATE: 11/02/18 12:00 PM

PURPOSE OF INSPECTION: BI-WEEKLY INSPECTION

AMOUNT OF RAINFALL SINCE LAST INSPECTION: 0.27"

LEGEND:

- LIMIT OF DISTURBANCE
- STABILIZED AREA (TEMPORARILY)
- STABILIZED AREA (PERMANENTLY)
- AREA THAT HAS NOT SEEN WORK IN 14 DAYS
- SILT FENCE

Site Assessment and Inspection Report (SPDES GP-0-15-002, Part IV.C.4)



Name of Facility: Starbuck Island	Permit Number: NYR11D911
Location: Village of Green Island, New York	
Date of Inspection: November 6, 2018	Time of Inspection: 9:00 am
Weather: Light Rain - 48 Degrees	Rainfall Since Last Inspection: 1.66"
Purpose of Inspection: Bi-Weekly Inspection	Inspector: KPB

Report E-Mail Distribution List:

1.	Recipient: Owner's Representative	Josh Meppen	E-mail: jmeppen@luizziconstructionservices.com
2.	Recipient: Site Superintendent	Bill Jewett	E-mail: wjewett@luizziconstructionservices.com
3.	Recipient: Town Official	Maggie Alix	E-mail: maggie.alix@villageofgreenisland.com
4.	Recipient: Owner	Pete Luizzi	E-mail: pluizzi@luizzibros.com
5.	Recipient: Site Contractor	Mike Alix	E-mail: malix@luizzibros.com
6.	Recipient: NYSDEC	Mary Barrie	E-mail: mary.barrie@dec.ny.gov
7.	Recipient: NYSDEC	Michael Komoroske	E-mail: michael.komoroske@dec.ny.gov
8.	Recipient: NYSDEC	Alicia Barraza	E-mail: alicia.barraza@dec.ny.gov
9.	Recipient: Choose an item.	Gianna Aiezza	E-mail: gaiezza@envirospeceng.com
10.	Recipient: Choose an item.	Rachel Farnum	E-mail: rfarnum@envirospeceng.com

Kenneth P. Barber, PE
Qualified Professional

Site Conditions**Soil Conditions:**

- ☐ Dry
☒ Wet
☐ Saturated
☐ Frozen
☐ Snow Covered

Offsite Sediment Tracking:

- ☒ None
☐ Light
☐ Moderate
☐ Heavy

Discharge:

- ☒ None
☐ Light
☐ Moderate
☐ Heavy

Condition of Discharge:

- ☒ N/A
☐ Clean
☐ Evidence of Turbidity

Contrast to receiving water?

- ☐ Yes ☐ No ☒ N/A

Additional Comments: Contractor is maintaining existing pavement as additional buffer to prevent offsite sediment tracking. Continue sweeping of existing pavement.

General Clearing & Grading: 1**Clearing:**

- ☒ Vegetation cleared
☒ Soils disturbed

Grading:

- ☐ Exporting material
☐ Importing material
☐ Soils stockpiled

ESC Devices:

- ☒ Stabilized entrance
☒ Perimeter protection
☒ Temporary stabilization

Recommendations:

- ☐ Install stabilized entrance
☐ Repair/maintain stabilized entrance
☐ Enlarge stabilized entrance
☐ Restrict traffic to entrance
☐ Install perimeter protection
☐ Repair/stabilize perimeter protection
☐ Install outlet for perimeter protection
☐ Stabilize exposed soils
☐ Repair eroded soils and stabilize
☒ Continue to monitor exposed soils

Additional Comments:

General Clearing & Grading: 2**Clearing:**

- ☒ Vegetation cleared
☒ Soils disturbed

Grading:

- ☒ Exporting material
☐ Importing material
☐ Soils stockpiled

ESC Devices:

- ☒ Stabilized entrance
☒ Perimeter protection
☐ Temporary stabilization

Recommendations:

- ☐ Install stabilized entrance
☐ Repair/maintain stabilized entrance
☐ Enlarge stabilized entrance
☐ Restrict traffic to entrance
☐ Install perimeter protection
☐ Repair/stabilize perimeter protection
☐ Install outlet for perimeter protection
☒ Stabilize exposed soils
☐ Repair eroded soils and stabilize
☒ Continue to monitor exposed soils

Additional Comments:

Site Stabilization**Paved Area:**

- ☐ Paved area at subgrade
- ☐ Utility work underway
- ☐ Utility work complete
- ☒ Subbase installed
- ☒ Pavement installed

Green Spaces:

- ☐ Grading complete
- ☐ Landscaping complete
- ☐ Temporarily stabilized
- ☐ Permanently stabilized

Recommendations:

- ☐ Install perimeter protection
 - ☐ Repair/stabilize perimeter protection
 - ☐ Remove perimeter protection
 - ☐ Install inlet protection
 - ☐ Install subbase
 - ☒ Grade and stabilize green spaces
 - ☐ Repair eroded soils and stabilize
- Sediment Tracking:** ☐ Yes ☐ No
- ☐ Sweep pavement daily, as needed
 - ☐ Restrict traffic to paved areas

Additional Comments: Contractor has resumed importing fill from stockpile area.

Construction Entrance:**Condition:**

- ☒ Properly maintained and effective
- ☒ Installed pursuant to standards and specifications
- ☒ Traffic restricted to entrance when leaving and reentering site
- ☒ Adequate drainage provided to prevent ponding

Recommendation(s):

- ☐ Install entrance
- ☐ Top dress entrance
- ☐ Repair stone entrance
- ☒ Continue maintenance, as needed
- ☐ Widen stone entrance
- ☐ Lengthen stone entrance
- ☐ Sweep adjacent pavement
- ☐ Regrade entrance

Additional Comments:

Perimeter Protection: Silt Fence**Condition:**

- ☒ Silt fence installed in accordance with NYSDEC specifications
- ☐ Silt fence in need of maintenance or repair
- ☐ Silt fence nearing or exceeding capacity

Recommendation(s):

- ☐ Continue inspection and maintenance, as needed
- ☐ Properly reinstall and maintain fencing
- ☐ Repair toppled sections and maintain fencing
- ☐ Remove excess sediment and maintain fencing
- ☐ Remove fencing and replace with perimeter berm
- ☒ Remove unnecessary fencing and stabilize disturbed soils

Additional Comments:

Perimeter Protection: Berm**Condition:**

- ☒ Berm installed in accordance with NYSDEC specifications
☐ Berm in need of maintenance or repair
☐ Berm nearing or exceeding capacity

Recommendation(s):

- ☒ Continue inspection and maintenance, as needed
☐ Stabilize berm with acceptable mulch material
☐ Repair damaged sections of berm and stabilize
☐ Install stone outlet at low point in grade
☐ Enlarge berm to provide for additional capacity
☐ Remove unnecessary berm and stabilize disturbed soils

Additional Comments:**Perimeter Protection: Berm****Condition:**

- ☒ Berm installed in accordance with NYSDEC specifications
☐ Berm in need of maintenance or repair
☐ Berm nearing or exceeding capacity

Recommendation(s):

- ☒ Continue inspection and maintenance, as needed
☐ Stabilize berm with acceptable mulch material
☐ Repair damaged sections of berm and stabilize
☐ Install stone outlet at low point in grade
☐ Enlarge berm to provide for additional capacity
☐ Remove unnecessary berm and stabilize disturbed soils

Additional Comments:**Stockpile Area:****Condition:**

- ☐ Stockpile area active
☐ Soils stabilized
☒ Adequate perimeter protection
☒ Stabilized stone access installed

Recommendation(s):

- | | |
|---|--|
| <input type="checkbox"/> Grade stockpile area | <input type="checkbox"/> Install stone access |
| <input type="checkbox"/> Stabilize stockpile area | <input type="checkbox"/> Repair stone access |
| <input type="checkbox"/> Install perimeter protection | <input type="checkbox"/> Sweep adjacent pavement |
| <input type="checkbox"/> Repair perimeter protection | <input type="checkbox"/> |

Additional Comments:

Woodchip Stockpile Area:**Condition:**

- ☐ Stockpile area active
☒ Soils stabilized
☒ Adequate perimeter protection
☒ Stabilized stone access installed

Recommendation(s):

- ☐ Grade stockpile area
☐ Stabilize stockpile area
☐ Install perimeter protection
☐ Repair perimeter protection
☐ Install stone access
☐ Repair stone access
☐ Sweep adjacent pavement

Additional Comments:**Protected Area: Hudson River****Rate of Flow:**

- ☐ None
☐ Light
☒ Moderate/Heavy

Natural Turbidity:

- ☐ None
☒ Light
☐ Moderate/Heavy

Recommendations:

- ☐ Install protective fencing
☐ Stabilize upslope soils

Discharge to Sensitive Area:

- ☒ None
☐ Light
☐ Moderate
☐ Heavy

Turbidity in Discharge:

- ☐ None
☐ Light
☒ Moderate/Heavy
☒ N/A

Discharge in significant contrast:

- ☐ Yes ☐ No ☒ N/A

- ☐ Install perimeter protection
☐ Repair perimeter protection

Additional Comments:**Modifications to the SWPPP:**

Modification	Reason for Modification
09/21/17 – The small section of silt fencing installed adjacent to the river will be removed and a perimeter berm/dike will be installed along the perimeter of the site in lieu of fencing.	Perimeter berms have proven to be much more durable and require much less maintenance than silt fencing. Given the time of year and the likelihood the perimeter protection will be left in place for an extended period of time, berms are more reliable than fencing. The berms and downslope areas will be stabilized with wood chips and stump grindings.
09/21/17 – The perimeter swale and outlets will not be installed at this time. Rather, the perimeter will be sloped toward the interior of the site with the intent to infiltrate runoff. Stone outlets will be installed, as needed, in the coming months.	Site soils are such that discharge may not be necessary at all. Rather than create a discharge point, it is desirable to keep all runoff onsite to the maximum extent possible. The swale and the discharge points can be installed later, if needed.

SITE PLAN: BY RHD LAND SURVEYING
 20 JANUARY 31, 2017.
 NO ARE BASED ON
 FACE EVIDENCE AND RECORD MAPS. BENDMAN ASSOCIATES DOES NOT
 TRY TO THE ACCURACY OF THEIR LOCATION AND/OR COMPLETION. IF
 THE CONTRACTOR'S RESPONSIBILITY TO VERIFY THE LOCATION AND EXTENT
 ALL UNDERGROUND STRUCTURES AND UTILITIES PRIOR TO ANY EXCAVATION
 CONSTRUCTION ACTIVITIES IN THEIR VICINITY. THE CONTRACTOR SHALL
 E ALL EXISTING UTILITIES FIELD STAKED BEFORE STARTING WORK BY
 LINE 1-800-962-7962.

TEMPORARY SEDIMENT TRAP CALCULATIONS			
MENT RAP	DISBURG AREA (ACRES)	REQUIRED TRAP VOLUME (C.F.)	PROPOSED TRAP VOLUME (C.F.)
1	1.45	5,220	5,702
2	1.58	5,688	6,210
3	2.69	10,368	14,868

PHASE DATA CHART	
ASE	AREA (ACRES)
1	4.97
2	1.33

1. PHASE 1 SHALL BE STABILIZED PRIOR TO PHASE 2 DISTURBANCE.

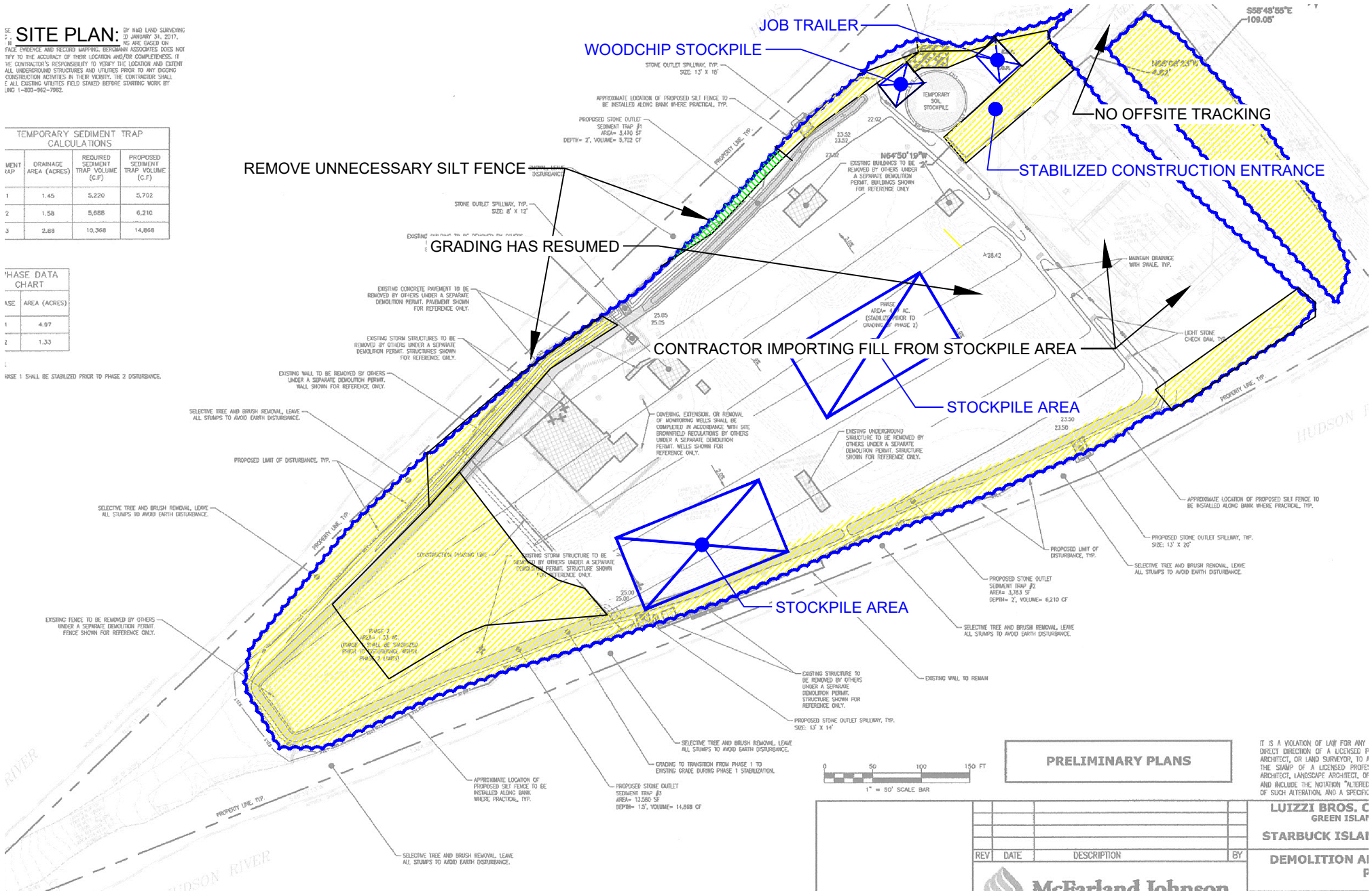

PRELIMINARY PLANS

IT IS A VIOLATION OF LAW FOR ANY
 DIRECT OR INDIRECT OF A LICENSED P
 ARCHITECT, OR LAND SURVEYOR, TO P
 THE STAMP OF A LICENSED PROFES
 ARCHITECT, LANDSCAPE ARCHITECT, OF
 AND INCLUDE THE NOTATION "ALTERED
 OF SUCH ALTERATION, AND A SPECIFIC

LUZZI BROS. C
GREEN ISLA

STARBUCK ISLA

DEMOLITION AI
F

REV	DATE	DESCRIPTION	BY

Barber Engineering

PO Box 454 - Nassau, New York 12123
 Ph: (518) 322-3033 - Fax: (518) 766-0372
 email: ken@barberpllc.com

CONSTRUCTION DURATION INSPECTION REPORT

PROJECT INFORMATION: STARBUCK ISLAND (SPDES ID: NYR11D911)

JOB No.: 17-019 INSPECTOR: KPB DATE: 11/06/18 9:00 AM

PURPOSE OF INSPECTION: BI-WEEKLY INSPECTION

AMOUNT OF RAINFALL SINCE LAST INSPECTION: 1.66"

LEGEND:

- LIMIT OF DISTURBANCE
- STABILIZED AREA (TEMPORARILY)
- STABILIZED AREA (PERMANENTLY)
- AREA THAT HAS NOT SEEN WORK IN 14 DAYS
- SILT FENCE

Site Assessment and Inspection Report (SPDES GP-0-15-002, Part IV.C.4)



Name of Facility: Starbuck Island	Permit Number: NYR11D911
Location: Village of Green Island, New York	
Date of Inspection: November 13, 2018	Time of Inspection: 11:00 am
Weather: Light Rain - 42 Degrees	Rainfall Since Last Inspection: 0.82"
Purpose of Inspection: Bi-Weekly Inspection	Inspector: KPB

Report E-Mail Distribution List:

1.	Recipient: Owner's Representative	Josh Meppen	E-mail: jmeppen@luizziconstructionservices.com
2.	Recipient: Site Superintendent	Bill Jewett	E-mail: wjewett@luizziconstructionservices.com
3.	Recipient: Town Official	Maggie Alix	E-mail: maggie.alix@villageofgreenisland.com
4.	Recipient: Owner	Pete Luizzi	E-mail: pluizzi@luizzibros.com
5.	Recipient: Site Contractor	Mike Alix	E-mail: malix@luizzibros.com
6.	Recipient: NYSDEC	Mary Barrie	E-mail: mary.barrie@dec.ny.gov
7.	Recipient: NYSDEC	Michael Komoroske	E-mail: michael.komoroske@dec.ny.gov
8.	Recipient: NYSDEC	Alicia Barraza	E-mail: alicia.barraza@dec.ny.gov
9.	Recipient: Choose an item.	Gianna Aiezza	E-mail: gaiezza@envirospeceng.com
10.	Recipient: Choose an item.	Rachel Farnum	E-mail: rfarnum@envirospeceng.com

Kenneth P. Barber, PE
Qualified Professional

Site Conditions**Soil Conditions:**

- ☐ Dry
☐ Wet
☒ Saturated
☐ Frozen
☐ Snow Covered

Offsite Sediment Tracking:

- ☒ None
☐ Light
☐ Moderate
☐ Heavy

Discharge:

- ☒ None
☐ Light
☐ Moderate
☐ Heavy

Condition of Discharge:

- ☒ N/A
☐ Clean
☐ Evidence of Turbidity

Contrast to receiving water?

- ☐ Yes ☐ No ☒ N/A

Additional Comments: Contractor is maintaining existing pavement as additional buffer to prevent offsite sediment tracking. Continue sweeping of existing pavement.

General Clearing & Grading: 1**Clearing:**

- ☒ Vegetation cleared
☒ Soils disturbed

Grading:

- ☐ Exporting material
☐ Importing material
☐ Soils stockpiled

ESC Devices:

- ☒ Stabilized entrance
☒ Perimeter protection
☒ Temporary stabilization

Recommendations:

- ☐ Install stabilized entrance
☐ Repair/maintain stabilized entrance
☐ Enlarge stabilized entrance
☐ Restrict traffic to entrance
☐ Install perimeter protection
☐ Repair/stabilize perimeter protection
☐ Install outlet for perimeter protection
☐ Stabilize exposed soils
☐ Repair eroded soils and stabilize
☒ Continue to monitor exposed soils

Additional Comments:

General Clearing & Grading: 2**Clearing:**

- ☒ Vegetation cleared
☒ Soils disturbed

Grading:

- ☒ Exporting material
☐ Importing material
☐ Soils stockpiled

ESC Devices:

- ☒ Stabilized entrance
☒ Perimeter protection
☐ Temporary stabilization

Recommendations:

- ☐ Install stabilized entrance
☐ Repair/maintain stabilized entrance
☐ Enlarge stabilized entrance
☐ Restrict traffic to entrance
☐ Install perimeter protection
☐ Repair/stabilize perimeter protection
☐ Install outlet for perimeter protection
☒ Stabilize exposed soils
☐ Repair eroded soils and stabilize
☒ Continue to monitor exposed soils

Additional Comments:

General Clearing & Grading: 3**Clearing:**

- ☒ Vegetation cleared
☒ Soils disturbed

Grading:

- ☒ Exporting material
☐ Importing material
☐ Soils stockpiled

ESC Devices:

- ☒ Stabilized entrance
☒ Perimeter protection
☐ Temporary stabilization

Recommendations:

- ☐ Install stabilized entrance
☐ Repair/maintain stabilized entrance
☐ Enlarge stabilized entrance
☐ Restrict traffic to entrance
☐ Install perimeter protection
☐ Repair/stabilize perimeter protection
☐ Install outlet for perimeter protection
☒ Stabilize exposed soils
☐ Repair eroded soils and stabilize
☒ Continue to monitor exposed soils

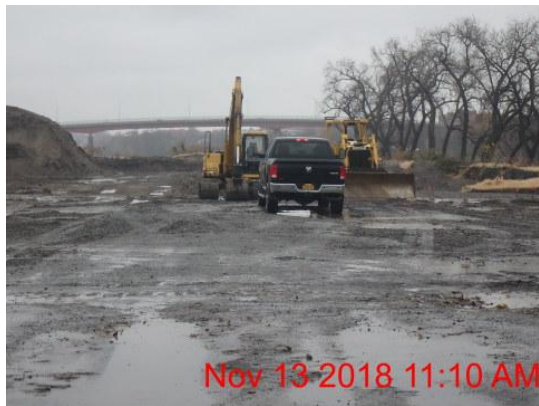
Additional Comments:**Construction Entrance:****Condition:**

- ☒ Properly maintained and effective
☒ Installed pursuant to standards and specifications
☒ Traffic restricted to entrance when leaving and reentering site
☒ Adequate drainage provided to prevent ponding

Recommendation(s):

- ☐ Install entrance
☐ Top dress entrance
☐ Repair stone entrance
☒ Continue maintenance, as needed
☐ Widen stone entrance
☐ Lengthen stone entrance
☐ Sweep adjacent pavement
☐ Regrade entrance

Additional Comments:**Perimeter Protection: Silt Fence****Condition:**

- ☒ Silt fence installed in accordance with NYSDEC specifications
☐ Silt fence in need of maintenance or repair
☐ Silt fence nearing or exceeding capacity

Recommendation(s):

- ☐ Continue inspection and maintenance, as needed
☐ Properly reinstall and maintain fencing
☐ Repair toppled sections and maintain fencing
☐ Remove excess sediment and maintain fencing
☐ Remove fencing and replace with perimeter berm
☒ Remove unnecessary fencing and stabilize disturbed soils

Additional Comments:

Perimeter Protection: Berm**Condition:**

- ☒ Berm installed in accordance with NYSDEC specifications
- ☐ Berm in need of maintenance or repair
- ☐ Berm nearing or exceeding capacity

Recommendation(s):

- ☒ Continue inspection and maintenance, as needed
- ☐ Stabilize berm with acceptable mulch material
- ☐ Repair damaged sections of berm and stabilize
- ☐ Install stone outlet at low point in grade
- ☐ Enlarge berm to provide for additional capacity
- ☐ Remove unnecessary berm and stabilize disturbed soils

Additional Comments:**Perimeter Protection: Berm****Condition:**

- ☒ Berm installed in accordance with NYSDEC specifications
- ☐ Berm in need of maintenance or repair
- ☐ Berm nearing or exceeding capacity

Recommendation(s):

- ☒ Continue inspection and maintenance, as needed
- ☐ Stabilize berm with acceptable mulch material
- ☐ Repair damaged sections of berm and stabilize
- ☐ Install stone outlet at low point in grade
- ☐ Enlarge berm to provide for additional capacity
- ☐ Remove unnecessary berm and stabilize disturbed soils

Additional Comments:**Perimeter Protection: Berm****Condition:**

- ☒ Berm installed in accordance with NYSDEC specifications
- ☐ Berm in need of maintenance or repair
- ☐ Berm nearing or exceeding capacity

Recommendation(s):

- ☒ Continue inspection and maintenance, as needed
- ☐ Stabilize berm with acceptable mulch material
- ☐ Repair damaged sections of berm and stabilize
- ☐ Install stone outlet at low point in grade
- ☐ Enlarge berm to provide for additional capacity
- ☐ Remove unnecessary berm and stabilize disturbed soils

Additional Comments:

Protected Area: Hudson River**Rate of Flow:**

- ☐ None
☐ Light
☒ Moderate/Heavy

Natural Turbidity:

- ☐ None
☒ Light
☐ Moderate/Heavy

Recommendations:

- ☐ Install protective fencing
☐ Stabilize upslope soils

Discharge to Sensitive Area:

- ☒ None ☐ Moderate
☐ Light ☐ Heavy

Turbidity in Discharge:

- ☐ None ☐ Moderate/Heavy
☐ Light ☒ N/A

Discharge in significant contrast:

- ☐ Yes ☐ No ☒ N/A

- ☐ Install perimeter protection
☐ Repair perimeter protection

Additional Comments:**Modifications to the SWPPP:**

Modification	Reason for Modification
09/21/17 – The small section of silt fencing installed adjacent to the river will be removed and a perimeter berm/dike will be installed along the perimeter of the site in lieu of fencing.	Perimeter berms have proven to be much more durable and require much less maintenance than silt fencing. Given the time of year and the likelihood the perimeter protection will be left in place for an extended period of time, berms are more reliable than fencing. The berms and downslope areas will be stabilized with wood chips and stump grindings.
09/21/17 – The perimeter swale and outlets will not be installed at this time. Rather, the perimeter will be sloped toward the interior of the site with the intent to infiltrate runoff. Stone outlets will be installed, as needed, in the coming months.	Site soils are such that discharge may not be necessary at all. Rather than create a discharge point, it is desirable to keep all runoff onsite to the maximum extent possible. The swale and the discharge points can be installed later, if needed.

SITE PLAN: OF NEW LAND SURVEYING
ON 20 JANUARY 31, 2017,
THE SITE WAS BASED ON
FACE EVIDENCE AND RECORD MAPPING. BROTHMAN ASSOCIATES DOES NOT
TRY TO THE ACCURACY OF THEIR LOCATION AND/OR COMPLETENESS. IT
IS THE CONTRACTOR'S RESPONSIBILITY TO VERIFY THE LOCATION AND EXTENT
ALL UNDERGROUND STRUCTURES AND UTILITIES PRIOR TO ANY DIGGING
CONSTRUCTION ACTIVITIES IN THEIR VICINITY. THE CONTRACTOR SHALL
FIND ALL EXISTING UTILITIES FIELD STAKED BEFORE STARTING WORK BY
1-800-962-7962.

WENT TRAP	DRAINAGE AREA (ACRES)	REQUIRED SEDIMENT TRAP VOLUME (C.F)	PROPOSED SEDIMENT TRAP VOLUME (C.F)
1	1.45	5,220	5,702
2	1.58	5,688	6,210
3	2.88	10,368	14,868

PHASE DATA CHART	
PHASE	AREA (ACRES)
1	4.97
2	1.33

HASE 1 SHALL BE STABILIZED PRIOR TO PHASE 2 DISTURBANCE.



CONTRACTOR HAS INSTALLED ADDITIONAL PERIMETER BERM

CONTRACTOR GRADING ADJACENT TO THE PROPERTY EDGE
INSTALL PERIMETER PROTECTION AS GRADING PROGRESSES

— STOCKPILE AREA

PRELIMINARY PLANS

IT IS A VIOLATION OF LAW FOR ANY DIRECTOR OF A LICENSED PROFESSIONAL ARCHITECT, OR LAND SURVEYOR, TO USE THE STAMP OF A LICENSED PROFESSIONAL ARCHITECT, LANDSCAPE ARCHITECT, OR LAND SURVEYOR, AND INCLUDE THE NOTATION "ALTERED" OF SUCH ALTERATION, AND A SPECIFIC

LUZZI BROS. C
GREEN ISLA
STARBUCK ISLA
DEMOLITION AI

CONSTRUCTION DURATION INSPECTION REPORT





PROJECT INFORMATION: STARBUCK ISLAND (SPDES ID: NYR11D911)

JOB No.: 17-019 INSPECTOR: KPB DATE: 11/13/18 11:00 AM

PURPOSE OF INSPECTION: BI-WEEKLY INSPECTION

AMOUNT OF RAINFALL SINCE LAST INSPECTION: 0.82"

LEGEND:

-
-  LIMIT OF DISTURBANCE
 STABILIZED AREA (TEMPORARILY)
 STABILIZED AREA (PERMANENTLY)
 AREA THAT HAS NOT SEEN WORK IN 14 DAYS
 SILT FENCE



PO Box 454 - Nassau, New York 12123
Ph: (518) 322-3033 - Fax: (518) 766-0372
email: ken@barberpllc.com

Site Assessment and Inspection Report (SPDES GP-0-15-002, Part IV.C.4)



Name of Facility: Starbuck Island	Permit Number: NYR11D911
Location: Village of Green Island, New York	
Date of Inspection: November 28, 2018	Time of Inspection: 10:30 am
Weather: Cloudy - 40 Degrees	Rainfall Since Last Inspection: 1.18"R - 1.1"S
Purpose of Inspection: Bi-Weekly Inspection	Inspector: KPB

Report E-Mail Distribution List:

1.	Recipient: Owner's Representative	Josh Meppen	E-mail: jmeppen@luizziconstructionservices.com
2.	Recipient: Site Superintendent	Bill Jewett	E-mail: wjewett@luizziconstructionservices.com
3.	Recipient: Town Official	Maggie Alix	E-mail: maggie.alix@villageofgreenisland.com
4.	Recipient: Owner	Pete Luizzi	E-mail: pluizzi@luizzibros.com
5.	Recipient: Site Contractor	Mike Alix	E-mail: malix@luizzibros.com
6.	Recipient: NYSDEC	Mary Barrie	E-mail: mary.barrie@dec.ny.gov
7.	Recipient: NYSDEC	Michael Komoroske	E-mail: michael.komoroske@dec.ny.gov
8.	Recipient: NYSDEC	Alicia Barraza	E-mail: alicia.barraza@dec.ny.gov
9.	Recipient: Choose an item.	Gianna Aiezza	E-mail: gaiezza@envirospeceng.com
10.	Recipient: Choose an item.	Rachel Farnum	E-mail: rfarnum@envirospeceng.com

Kenneth P. Barber, PE
Qualified Professional

Site Conditions**Soil Conditions:**

- ☐ Dry
☒ Wet
☐ Saturated
☐ Frozen
☒ Snow Covered

Offsite Sediment Tracking:

- ☒ None
☐ Light
☐ Moderate
☐ Heavy

Discharge:

- ☒ None
☐ Light
☐ Moderate
☐ Heavy

Condition of Discharge:

- ☒ N/A
☐ Clean
☐ Evidence of Turbidity

Contrast to receiving water?

- ☐ Yes ☐ No ☒ N/A

Additional Comments: Contractor is maintaining existing pavement as additional buffer to prevent offsite sediment tracking. Continue sweeping of existing pavement.

General Clearing & Grading: 1**Clearing:**

- ☒ Vegetation cleared
☒ Soils disturbed

Grading:

- ☐ Exporting material
☐ Importing material
☐ Soils stockpiled

ESC Devices:

- ☒ Stabilized entrance
☒ Perimeter protection
☒ Temporary stabilization

Recommendations:

- ☐ Install stabilized entrance
☐ Repair/maintain stabilized entrance
☐ Enlarge stabilized entrance
☐ Restrict traffic to entrance
☐ Install perimeter protection
☐ Repair/stabilize perimeter protection
☐ Install outlet for perimeter protection
☐ Stabilize exposed soils
☐ Repair eroded soils and stabilize
☐ Continue to monitor exposed soils

Additional Comments:

General Clearing & Grading: 2**Clearing:**

- ☒ Vegetation cleared
☒ Soils disturbed

Grading:

- ☒ Exporting material
☐ Importing material
☐ Soils stockpiled

ESC Devices:

- ☒ Stabilized entrance
☒ Perimeter protection
☐ Temporary stabilization

Recommendations:

- ☐ Install stabilized entrance
☐ Repair/maintain stabilized entrance
☐ Enlarge stabilized entrance
☐ Restrict traffic to entrance
☐ Install perimeter protection
☐ Repair/stabilize perimeter protection
☐ Install outlet for perimeter protection
☐ Stabilize exposed soils
☐ Repair eroded soils and stabilize
☐ Continue to monitor exposed soils

Additional Comments:

Construction Entrance:**Condition:**

- ☒ Properly maintained and effective
- ☒ Installed pursuant to standards and specifications
- ☒ Traffic restricted to entrance when leaving and reentering site
- ☒ Adequate drainage provided to prevent ponding

Recommendation(s):

- | | |
|---|--|
| <input type="checkbox"/> Install entrance | <input type="checkbox"/> Widen stone entrance |
| <input type="checkbox"/> Top dress entrance | <input type="checkbox"/> Lengthen stone entrance |
| <input type="checkbox"/> Repair stone entrance | <input type="checkbox"/> Sweep adjacent pavement |
| <input checked="" type="checkbox"/> Continue maintenance, as needed | <input type="checkbox"/> Regrade entrance |

Additional Comments: Contractor has extended entrance as recommended.

Building Area

- ☒ Soils cleared
- ☒ Foundation underway
- ☐ Foundation complete
- ☐ Building work underway
- ☐ Building work complete
- ☐ Temporarily stabilized
- ☐ Permanently stabilized
- ☐

ESC Devices:

- ☒ Stabilized entrance
- ☒ Perimeter protection

Recommendations:

- ☐ Install stabilized entrance
- ☐ Repair/maintain stabilized entrance
- ☐ Restrict traffic to entrance
- ☐ Install perimeter protection
- ☐ Repair/stabilize perimeter protection
- ☐ Install outlet for perimeter protection
- ☐ Stabilize exposed soils
- ☐ Remove lot controls and stabilize
- ☐ Repair eroded soils and stabilize
- ☐ Control roof runoff

Additional Comments:

Perimeter Protection: Silt Fence**Condition:**

- ☒ Silt fence installed in accordance with NYSDEC specifications
- ☐ Silt fence in need of maintenance or repair
- ☐ Silt fence nearing or exceeding capacity

Recommendation(s):

- ☐ Continue inspection and maintenance, as needed
- ☐ Properly reinstall and maintain fencing
- ☐ Repair toppled sections and maintain fencing
- ☐ Remove excess sediment and maintain fencing
- ☐ Remove fencing and replace with perimeter berm
- ☒ Remove unnecessary fencing and stabilize disturbed soils

Additional Comments:

Perimeter Protection: Silt Fence**Condition:**

- ☒ Silt fence installed in accordance with NYSDEC specifications
- ☐ Silt fence in need of maintenance or repair
- ☐ Silt fence nearing or exceeding capacity

Recommendation(s):

- ☒ Continue inspection and maintenance, as needed
- ☐ Properly reinstall and maintain fencing
- ☐ Repair toppled sections and maintain fencing
- ☐ Remove excess sediment and maintain fencing
- ☐ Remove fencing and replace with perimeter berm
- ☐ Remove unnecessary fencing and stabilize disturbed soils

Additional Comments:**Perimeter Protection: Berm****Condition:**

- ☒ Berm installed in accordance with NYSDEC specifications
- ☐ Berm in need of maintenance or repair
- ☐ Berm nearing or exceeding capacity

Recommendation(s):

- ☒ Continue inspection and maintenance, as needed
- ☐ Stabilize berm with acceptable mulch material
- ☐ Repair damaged sections of berm and stabilize
- ☐ Install stone outlet at low point in grade
- ☐ Enlarge berm to provide for additional capacity
- ☐ Remove unnecessary berm and stabilize disturbed soils

Additional Comments:**Perimeter Protection: Berm****Condition:**

- ☒ Berm installed in accordance with NYSDEC specifications
- ☐ Berm in need of maintenance or repair
- ☐ Berm nearing or exceeding capacity

Recommendation(s):

- ☒ Continue inspection and maintenance, as needed
- ☐ Stabilize berm with acceptable mulch material
- ☐ Repair damaged sections of berm and stabilize
- ☐ Install stone outlet at low point in grade
- ☐ Enlarge berm to provide for additional capacity
- ☐ Remove unnecessary berm and stabilize disturbed soils

Additional Comments:

Perimeter Protection: Berm**Condition:**

- ☒ Berm installed in accordance with NYSDEC specifications
☐ Berm in need of maintenance or repair
☐ Berm nearing or exceeding capacity

Recommendation(s):

- ☒ Continue inspection and maintenance, as needed
☐ Stabilize berm with acceptable mulch material
☐ Repair damaged sections of berm and stabilize
☐ Install stone outlet at low point in grade
☐ Enlarge berm to provide for additional capacity
☐ Remove unnecessary berm and stabilize disturbed soils

Additional Comments:**Stockpile Area****Condition:**

- ☒ Stockpile area active
☐ Soils stabilized
☒ Adequate perimeter protection
☒ Stabilized stone access installed

Recommendation(s):

- | | |
|---|--|
| <input type="checkbox"/> Grade stockpile area | <input type="checkbox"/> Install stone access |
| <input type="checkbox"/> Stabilize stockpile area | <input type="checkbox"/> Repair stone access |
| <input type="checkbox"/> Install perimeter protection | <input type="checkbox"/> Sweep adjacent pavement |
| <input type="checkbox"/> Repair perimeter protection | <input type="checkbox"/> |

Additional Comments:**Protected Area: Hudson River****Rate of Flow:**

- ☐ None
☐ Light
☒ Moderate/Heavy

Natural Turbidity:

- ☐ None
☒ Light
☐ Moderate/Heavy

Recommendations:

- ☐ Install protective fencing
☐ Stabilize upslope soils

Discharge to Sensitive Area:

- ☒ None ☐ Moderate
☐ Light ☐ Heavy

Turbidity in Discharge:

- ☐ None ☐ Moderate/Heavy
☐ Light ☒ N/A

Discharge in significant contrast:

- ☐ Yes ☐ No ☒ N/A

- ☐ Install perimeter protection
☐ Repair perimeter protection

Additional Comments:

Modifications to the SWPPP:	
Modification	Reason for Modification
09/21/17 – The small section of silt fencing installed adjacent to the river will be removed and a perimeter berm/dike will be installed along the perimeter of the site in lieu of fencing.	Perimeter berms have proven to be much more durable and require much less maintenance than silt fencing. Given the time of year and the likelihood the perimeter protection will be left in place for an extended period of time, berms are more reliable than fencing. The berms and downslope areas will be stabilized with wood chips and stump grindings.
09/21/17 – The perimeter swale and outlets will not be installed at this time. Rather, the perimeter will be sloped toward the interior of the site with the intent to infiltrate runoff. Stone outlets will be installed, as needed, in the coming months.	Site soils are such that discharge may not be necessary at all. Rather than create a discharge point, it is desirable to keep all runoff onsite to the maximum extent possible. The swale and the discharge points can be installed later, if needed.

SITE PLAN: BY RHD LAND SURVEYING
20 JANUARY 31, 2017.
NO ARE BASED ON
FACE EVIDENCE AND RECORD MAPS. BROWMAN ASSOCIATES DOES NOT
TRY TO THE ACCURACY OF THEIR LOCATION AND/OR COMPLETENESS. IT
THE CONTRACTOR'S RESPONSIBILITY TO VERIFY THE LOCATION AND EXTENT
ALL UNDERGROUND STRUCTURES AND UTILITIES PRIOR TO ANY DIGGING
CONSTRUCTION ACTIVITIES IN THEIR VICINITY. THE CONTRACTOR SHALL
F. ALL EXISTING UTILITIES FIELD STAKED BEFORE STARTING WORK BY
LAND 1-800-962-7962.

TEMPORARY SEDIMENT TRAP CALCULATIONS			
MENT RAP	DISBURGAGE AREA (ACRES)	REQUIRED SEDIMENT TRAP VOLUME (C.F.)	PROPOSED SEDIMENT TRAP VOLUME (C.F.)
1	1.45	5,220	5,702
2	1.58	5,688	6,210
3	2.69	10,368	14,868

PHASE DATA CHART	
ASE	AREA (ACRES)
1	4.97
2	1.33

1. PHASE 1 SHALL BE STABILIZED PRIOR TO PHASE 2 DISTURBANCE.

REMOVE UNNECESSARY SILT FENCE

CONTRACTOR PREPARING TO INSTALL PILES

EXCAVATION CONTINUES

JOB TRAILER

NO OFFSITE TRACKING

STABILIZED CONSTRUCTION ENTRANCE

STOCKPILE AREA

NOTE:

SITE SOILS PARTIALLY SNOW COVERED AT THE TIME OF THIS INSPECTION MAKING IT IMPRACTICAL
TO DETERMINE THE EXTENT OF SOIL DISTURBANCE AND SITE STABILIZATION.

PRELIMINARY PLANS

IT IS A VIOLATION OF LAW FOR ANY
DIRECT OR INDIRECT OF A LICENSED P
ARCHITECT, OR LAND SURVEYOR, TO P
THE STAMP OF A LICENSED PROFESSIONAL
ARCHITECT, LANDSCAPE ARCHITECT, OR
AND INCLUDE THE NOTATION "PRELIMINARY
OF SUCH ALTERATION, AND A SPECIFIC

LUZZI BROS. C
GREEN ISLAND
STARBUCK ISLAND
DEMOLITION AND
F

CONSTRUCTION DURATION INSPECTION REPORT

PROJECT INFORMATION: STARBUCK ISLAND (SPDES ID: NYR11D911)

JOB No.: 17-019 INSPECTOR: KPB DATE: 11/28/18 10:30 AM

PURPOSE OF INSPECTION: BI-WEEKLY INSPECTION

AMOUNT OF RAINFALL SINCE LAST INSPECTION: 1.18" RAIN - 1.1" SNOW

LEGEND:

- LIMIT OF DISTURBANCE
- STABILIZED AREA (TEMPORARILY)
- STABILIZED AREA (PERMANENTLY)
- AREA THAT HAS NOT SEEN WORK IN 14 DAYS
- SF — SF — SILT FENCE

Barber Engineering

PO Box 454 - Nassau, New York 12123
Ph: (518) 322-3033 - Fax: (518) 766-0372
email: ken@barberpllc.com

Site Assessment and Inspection Report (SPDES GP-0-15-002, Part IV.C.4)



Name of Facility: Starbuck Island	Permit Number: NYR11D911
Location: Village of Green Island, New York	
Date of Inspection: December 4, 2018	Time of Inspection: 10:30 am
Weather: Cloudy - 40 Degrees	Rainfall Since Last Inspection: 0.74"R - 0.3"S
Purpose of Inspection: Bi-Weekly Inspection	Inspector: KPB

Report E-Mail Distribution List:

1.	Recipient: Owner's Representative	Josh Meppen	E-mail: jmeppen@luizziconstructionservices.com
2.	Recipient: Site Superintendent	Bill Jewett	E-mail: wjewett@luizziconstructionservices.com
3.	Recipient: Town Official	Maggie Alix	E-mail: maggie.alix@villageofgreenisland.com
4.	Recipient: Owner	Pete Luizzi	E-mail: pluizzi@luizzibros.com
5.	Recipient: Site Contractor	Mike Alix	E-mail: malix@luizzibros.com
6.	Recipient: NYSDEC	Mary Barrie	E-mail: mary.barrie@dec.ny.gov
7.	Recipient: NYSDEC	Michael Komoroske	E-mail: michael.komoroske@dec.ny.gov
8.	Recipient: NYSDEC	Alicia Barraza	E-mail: alicia.barraza@dec.ny.gov
9.	Recipient: Choose an item.	Gianna Aiezza	E-mail: gaiezza@envirospeceng.com
10.	Recipient: Choose an item.	Rachel Farnum	E-mail: rfarnum@envirospeceng.com

Kenneth P. Barber, PE
Qualified Professional

Site Conditions**Soil Conditions:**

- ☐ Dry
☒ Wet
☐ Saturated
☐ Frozen
☐ Snow Covered

Offsite Sediment Tracking:

- ☒ None
☐ Light
☐ Moderate
☐ Heavy

Discharge:

- ☒ None
☐ Light
☐ Moderate
☐ Heavy

Condition of Discharge:

- ☒ N/A
☐ Clean
☐ Evidence of Turbidity

Contrast to receiving water?

- ☐ Yes ☐ No ☒ N/A

Additional Comments: Contractor is maintaining existing pavement as additional buffer to prevent offsite sediment tracking. Continue sweeping of existing pavement.

General Clearing & Grading: 1**Clearing:**

- ☒ Vegetation cleared
☒ Soils disturbed

Grading:

- ☐ Exporting material
☐ Importing material
☐ Soils stockpiled

ESC Devices:

- ☒ Stabilized entrance
☒ Perimeter protection
☒ Temporary stabilization

Recommendations:

- ☐ Install stabilized entrance
☐ Repair/maintain stabilized entrance
☐ Enlarge stabilized entrance
☐ Restrict traffic to entrance
☐ Install perimeter protection
☐ Repair/stabilize perimeter protection
☐ Install outlet for perimeter protection
☐ Stabilize exposed soils
☐ Repair eroded soils and stabilize
☐ Continue to monitor exposed soils

Additional Comments:

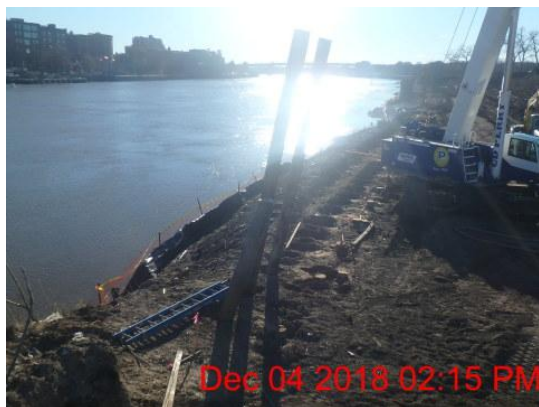
General Clearing & Grading: 2**Clearing:**

- ☒ Vegetation cleared
☒ Soils disturbed

Grading:

- ☒ Exporting material
☐ Importing material
☐ Soils stockpiled

ESC Devices:

- ☒ Stabilized entrance
☒ Perimeter protection
☐ Temporary stabilization

Recommendations:

- ☐ Install stabilized entrance
☐ Repair/maintain stabilized entrance
☐ Enlarge stabilized entrance
☐ Restrict traffic to entrance
☐ Install perimeter protection
☐ Repair/stabilize perimeter protection
☐ Install outlet for perimeter protection
☐ Stabilize exposed soils
☐ Repair eroded soils and stabilize
☐ Continue to monitor exposed soils

Additional Comments: Contractor driving piles for retaining wall.

Construction Entrance:**Condition:**

- ☒ Properly maintained and effective
- ☒ Installed pursuant to standards and specifications
- ☒ Traffic restricted to entrance when leaving and reentering site
- ☒ Adequate drainage provided to prevent ponding

Recommendation(s):

- | | |
|---|--|
| <input type="checkbox"/> Install entrance | <input type="checkbox"/> Widen stone entrance |
| <input type="checkbox"/> Top dress entrance | <input type="checkbox"/> Lengthen stone entrance |
| <input type="checkbox"/> Repair stone entrance | <input type="checkbox"/> Sweep adjacent pavement |
| <input checked="" type="checkbox"/> Continue maintenance, as needed | <input type="checkbox"/> Regrade entrance |

Additional Comments: Contractor has extended entrance as recommended.

Building Area

- ☒ Soils cleared
- ☒ Foundation underway
- ☐ Foundation complete
- ☐ Building work underway
- ☐ Building work complete
- ☐ Temporarily stabilized
- ☐ Permanently stabilized
- ☐

ESC Devices:

- ☒ Stabilized entrance
- ☒ Perimeter protection

Recommendations:

- ☐ Install stabilized entrance
- ☐ Repair/maintain stabilized entrance
- ☐ Restrict traffic to entrance
- ☐ Install perimeter protection
- ☐ Repair/stabilize perimeter protection
- ☐ Install outlet for perimeter protection
- ☐ Stabilize exposed soils
- ☐ Remove lot controls and stabilize
- ☐ Repair eroded soils and stabilize
- ☐ Control roof runoff

Additional Comments:

Perimeter Protection: Silt Fence**Condition:**

- ☒ Silt fence installed in accordance with NYSDEC specifications
- ☒ Silt fence in need of maintenance or repair
- ☐ Silt fence nearing or exceeding capacity

Recommendation(s):

- ☐ Continue inspection and maintenance, as needed
- ☐ Properly reinstall and maintain fencing
- ☐ Repair toppled sections and maintain fencing
- ☐ Remove excess sediment and maintain fencing
- ☐ Remove fencing and replace with perimeter berm
- ☒ Remove unnecessary fencing and stabilize disturbed soils

Additional Comments:

Perimeter Protection: Silt Fence**Condition:**

- ☒ Silt fence installed in accordance with NYSDEC specifications
- ☐ Silt fence in need of maintenance or repair
- ☐ Silt fence nearing or exceeding capacity

Recommendation(s):

- ☒ Continue inspection and maintenance, as needed
- ☐ Properly reinstall and maintain fencing
- ☐ Repair toppled sections and maintain fencing
- ☐ Remove excess sediment and maintain fencing
- ☐ Remove fencing and replace with perimeter berm
- ☐ Remove unnecessary fencing and stabilize disturbed soils

Additional Comments:**Perimeter Protection: Berm****Condition:**

- ☒ Berm installed in accordance with NYSDEC specifications
- ☐ Berm in need of maintenance or repair
- ☐ Berm nearing or exceeding capacity

Recommendation(s):

- ☒ Continue inspection and maintenance, as needed
- ☐ Stabilize berm with acceptable mulch material
- ☐ Repair damaged sections of berm and stabilize
- ☐ Install stone outlet at low point in grade
- ☐ Enlarge berm to provide for additional capacity
- ☐ Remove unnecessary berm and stabilize disturbed soils

Additional Comments:**Perimeter Protection: Berm****Condition:**

- ☒ Berm installed in accordance with NYSDEC specifications
- ☐ Berm in need of maintenance or repair
- ☐ Berm nearing or exceeding capacity

Recommendation(s):

- ☒ Continue inspection and maintenance, as needed
- ☐ Stabilize berm with acceptable mulch material
- ☐ Repair damaged sections of berm and stabilize
- ☐ Install stone outlet at low point in grade
- ☐ Enlarge berm to provide for additional capacity
- ☐ Remove unnecessary berm and stabilize disturbed soils

Additional Comments:

Perimeter Protection: Berm**Condition:**

- ☒ Berm installed in accordance with NYSDEC specifications
☐ Berm in need of maintenance or repair
☐ Berm nearing or exceeding capacity

Recommendation(s):

- ☒ Continue inspection and maintenance, as needed
☐ Stabilize berm with acceptable mulch material
☐ Repair damaged sections of berm and stabilize
☐ Install stone outlet at low point in grade
☐ Enlarge berm to provide for additional capacity
☐ Remove unnecessary berm and stabilize disturbed soils

Additional Comments:**Stockpile Area****Condition:**

- ☒ Stockpile area active
☐ Soils stabilized
☒ Adequate perimeter protection
☒ Stabilized stone access installed

Recommendation(s):

- | | |
|---|--|
| <input type="checkbox"/> Grade stockpile area | <input type="checkbox"/> Install stone access |
| <input type="checkbox"/> Stabilize stockpile area | <input type="checkbox"/> Repair stone access |
| <input type="checkbox"/> Install perimeter protection | <input type="checkbox"/> Sweep adjacent pavement |
| <input type="checkbox"/> Repair perimeter protection | <input type="checkbox"/> |

Additional Comments:**Protected Area: Hudson River****Rate of Flow:**

- ☐ None
☒ Light
☐ Moderate/Heavy

Natural Turbidity:

- ☐ None
☒ Light
☐ Moderate/Heavy

Recommendations:

- ☐ Install protective fencing
☐ Stabilize upslope soils

Discharge to Sensitive Area:

- | | |
|--|-----------------------------------|
| <input checked="" type="checkbox"/> None | <input type="checkbox"/> Moderate |
| <input type="checkbox"/> Light | <input type="checkbox"/> Heavy |

Turbidity in Discharge:

- | | |
|--------------------------------|---|
| <input type="checkbox"/> None | <input type="checkbox"/> Moderate/Heavy |
| <input type="checkbox"/> Light | <input checked="" type="checkbox"/> N/A |

Discharge in significant contrast:

- ☐ Yes ☐ No ☒ N/A

- ☐ Install perimeter protection
☐ Repair perimeter protection

Additional Comments:

Modifications to the SWPPP:	
Modification	Reason for Modification
09/21/17 – The small section of silt fencing installed adjacent to the river will be removed and a perimeter berm/dike will be installed along the perimeter of the site in lieu of fencing.	Perimeter berms have proven to be much more durable and require much less maintenance than silt fencing. Given the time of year and the likelihood the perimeter protection will be left in place for an extended period of time, berms are more reliable than fencing. The berms and downslope areas will be stabilized with wood chips and stump grindings.
09/21/17 – The perimeter swale and outlets will not be installed at this time. Rather, the perimeter will be sloped toward the interior of the site with the intent to infiltrate runoff. Stone outlets will be installed, as needed, in the coming months.	Site soils are such that discharge may not be necessary at all. Rather than create a discharge point, it is desirable to keep all runoff onsite to the maximum extent possible. The swale and the discharge points can be installed later, if needed.

SE. SITE PLAN: BY NINE LAND SURVEYING: 20 JANUARY 31, 2017.
 N. NS ARE BASED ON
 FACE EVIDENCE AND RECORD MAPPING. BUTCHMAN ASSOCIATES DOES NOT
 TO THE ACQUISITION OF THEIR LOCATION AND/OR COMPLETENESS. IT
 ALL UNDERGROUND STRUCTURES AND UTILITIES PRIOR TO ANY DIGGING
 CONSTRUCTION ACTIVITIES IN THEIR VICINITY. THE CONTRACTOR SHALL
 ALL EXISTING UTILITIES FIELD STAKED BEFORE STARTING WORK BY
 1-800-962-7992.

WENT TRAP	DRAINAGE AREA (ACRES)	REQUIRED SEDIMENT TRAP VOLUME (C.F.)	PROPOSED SEDIMENT TRAP VOLUME (C.F.)
1	1.45	5,220	5,702
2	1.58	5,688	6,210
3	2.88	10,368	14,068

PHASE DATA CHART	
PHASE	AREA (ACRES)
1	4.97
2	1.33

PHASE 1 SHALL BE STABILIZED PRIOR TO PHASE 2 DISTURBANCE



—NO OFFSITE TRACKING

—STABILIZED CONSTRUCTION ENTRANCE

CONTRACTOR INSTALLING PILES

STOCKPILE AREA

- EXCAVATION CONTINUES

PRELIMINARY PLANS

IT IS A VIOLATION OF LAW FOR ANY DIRECT OR INDIRECT USE OF A LICENSED PROFESSIONAL ARCHITECT, OR LAND SURVEYOR, TO AFFIX THE STAMP OF A LICENSED PROFESSIONAL ARCHITECT, LANDSCAPE ARCHITECT, OR LAND SURVEYOR TO ANY DRAWING OR SPECIFICATION, OR ANY OTHER DOCUMENT, AND INCLUDE THE NOTATION "ALTERED BY SUCH ALTERATION, AND A SPECIFIC

LUZZI BROS. C
GREEN ISLAND

STARBUCK ISLAND

DEMOLITION AND

CONSTRUCTION DURATION INSPECTION REPORT





PROJECT INFORMATION: STARBUCK ISLAND (SPDES ID: NYR11D911)

JOB No.: 17-019 INSPECTOR: KPB DATE: 12/04/18 10:30 AM

PURPOSE OF INSPECTION: BI-WEEKLY INSPECTION

AMOUNT OF RAINFALL SINCE LAST INSPECTION: 0.74" RAIN - 0.3" SNOW

LEGEND:

-
-  LIMIT OF DISTURBANCE
 STABILIZED AREA (TEMPORARILY)
 STABILIZED AREA (PERMANENTLY)
 AREA THAT HAS NOT SEEN WORK IN 14 DAYS
 —SF —SF— SILT FENCE



PO Box 454 - Nassau, New York 12123
Ph: (518) 322-3033 - Fax: (518) 766-0372
email: ken@barberpllc.com

Site Assessment and Inspection Report (SPDES GP-0-15-002, Part IV.C.4)



Name of Facility: Starbuck Island	Permit Number: NYR11D911
Location: Village of Green Island, New York	
Date of Inspection: December 7, 2018	Time of Inspection: 9:45 am
Weather: Partly Cloudy - 33 Degrees	Rainfall Since Last Inspection: 0.00"
Purpose of Inspection: Bi-Weekly Inspection	Inspector: KPB

Report E-Mail Distribution List:

1.	Recipient: Owner's Representative	Josh Meppen	E-mail: jmeppen@luizziconstructionservices.com
2.	Recipient: Site Superintendent	Chuck Pafundi	E-mail: cpafundi@luizzibros.com
3.	Recipient: Town Official	Maggie Alix	E-mail: maggie.alix@villageofgreenisland.com
4.	Recipient: Owner	Pete Luizzi	E-mail: pluizzi@luizzibros.com
5.	Recipient: Site Contractor	Mike Alix	E-mail: malix@luizzibros.com
6.	Recipient: NYSDEC	Mary Barrie	E-mail: mary.barrie@dec.ny.gov
7.	Recipient: NYSDEC	Michael Komoroske	E-mail: michael.komoroske@dec.ny.gov
8.	Recipient: NYSDEC	Alicia Barraza	E-mail: alicia.barraza@dec.ny.gov
9.	Recipient: Choose an item.	Gianna Aiezza	E-mail: gaiezza@envirospeceng.com
10.	Recipient: Choose an item.	Rachel Farnum	E-mail: rfarnum@envirospeceng.com

Kenneth P. Barber, PE
Qualified Professional

Site Conditions**Soil Conditions:**

- ☒ Dry
☐ Wet
☐ Saturated
☐ Frozen
☐ Snow Covered

Offsite Sediment Tracking:

- ☒ None
☐ Light
☐ Moderate
☐ Heavy

Discharge:

- ☒ None
☐ Light
☐ Moderate
☐ Heavy

Condition of Discharge:

- ☒ N/A
☐ Clean
☐ Evidence of Turbidity

Contrast to receiving water?

- ☐ Yes ☐ No ☒ N/A

Additional Comments: Contractor is maintaining existing pavement as additional buffer to prevent offsite sediment tracking. Continue sweeping of existing pavement.

General Clearing & Grading: 1**Clearing:**

- ☒ Vegetation cleared
☒ Soils disturbed

Grading:

- ☐ Exporting material
☐ Importing material
☐ Soils stockpiled

ESC Devices:

- ☒ Stabilized entrance
☒ Perimeter protection
☒ Temporary stabilization

Recommendations:

- ☐ Install stabilized entrance
☐ Repair/maintain stabilized entrance
☐ Enlarge stabilized entrance
☐ Restrict traffic to entrance
☐ Install perimeter protection
☐ Repair/stabilize perimeter protection
☐ Install outlet for perimeter protection
☐ Stabilize exposed soils
☐ Repair eroded soils and stabilize
☐ Continue to monitor exposed soils

Additional Comments:

General Clearing & Grading: 2**Clearing:**

- ☒ Vegetation cleared
☒ Soils disturbed

Grading:

- ☐ Exporting material
☐ Importing material
☐ Soils stockpiled

ESC Devices:

- ☒ Stabilized entrance
☒ Perimeter protection
☒ Temporary stabilization

Recommendations:

- ☐ Install stabilized entrance
☐ Repair/maintain stabilized entrance
☐ Enlarge stabilized entrance
☐ Restrict traffic to entrance
☐ Install perimeter protection
☐ Repair/stabilize perimeter protection
☐ Install outlet for perimeter protection
☐ Stabilize exposed soils
☐ Repair eroded soils and stabilize
☐ Continue to monitor exposed soils

Additional Comments:

General Clearing & Grading: 3**Clearing:**

- ☒ Vegetation cleared
☒ Soils disturbed

Grading:

- ☒ Exporting material
☐ Importing material
☐ Soils stockpiled

ESC Devices:

- ☒ Stabilized entrance
☒ Perimeter protection
☐ Temporary stabilization

Recommendations:

- ☐ Install stabilized entrance
☐ Repair/maintain stabilized entrance
☐ Enlarge stabilized entrance
☐ Restrict traffic to entrance
☐ Install perimeter protection
☐ Repair/stabilize perimeter protection
☐ Install outlet for perimeter protection
☐ Stabilize exposed soils
☐ Repair eroded soils and stabilize
☐ Continue to monitor exposed soils

Additional Comments: Contractor driving piles for retaining wall.

Construction Entrance:**Condition:**

- ☒ Properly maintained and effective
☒ Installed pursuant to standards and specifications
☒ Traffic restricted to entrance when leaving and reentering site
☒ Adequate drainage provided to prevent ponding

Recommendation(s):

- ☐ Install entrance
☐ Top dress entrance
☐ Repair stone entrance
☒ Continue maintenance, as needed
☐ Widen stone entrance
☐ Lengthen stone entrance
☐ Sweep adjacent pavement
☐ Regrade entrance

Additional Comments:

Building Area

- ☐ Soils cleared
☐ Foundation underway
☒ Foundation complete
☐ Building work underway
☐ Building work complete
☐ Temporarily stabilized
☐ Permanently stabilized
☐

ESC Devices:

- ☒ Stabilized entrance
☒ Perimeter protection

Recommendations:

- ☐ Install stabilized entrance
☐ Repair/maintain stabilized entrance
☐ Restrict traffic to entrance
☐ Install perimeter protection
☐ Repair/stabilize perimeter protection
☐ Install outlet for perimeter protection
☐ Stabilize exposed soils
☐ Remove lot controls and stabilize
☐ Repair eroded soils and stabilize
☐ Control roof runoff

Additional Comments:

Perimeter Protection: Silt Fence**Condition:**

- ☒ Silt fence installed in accordance with NYSDEC specifications
- ☒ Silt fence in need of maintenance or repair
- ☐ Silt fence nearing or exceeding capacity

Recommendation(s):

- ☐ Continue inspection and maintenance, as needed
- ☐ Properly reinstall and maintain fencing
- ☐ Repair toppled sections and maintain fencing
- ☐ Remove excess sediment and maintain fencing
- ☐ Remove fencing and replace with perimeter berm
- ☒ Remove unnecessary fencing and stabilize disturbed soils

Additional Comments:**Perimeter Protection: Silt Fence****Condition:**

- ☒ Silt fence installed in accordance with NYSDEC specifications
- ☐ Silt fence in need of maintenance or repair
- ☐ Silt fence nearing or exceeding capacity

Recommendation(s):

- ☒ Continue inspection and maintenance, as needed
- ☐ Properly reinstall and maintain fencing
- ☐ Repair toppled sections and maintain fencing
- ☐ Remove excess sediment and maintain fencing
- ☐ Remove fencing and replace with perimeter berm
- ☐ Remove unnecessary fencing and stabilize disturbed soils

Additional Comments:**Perimeter Protection: Berm****Condition:**

- ☒ Berm installed in accordance with NYSDEC specifications
- ☐ Berm in need of maintenance or repair
- ☐ Berm nearing or exceeding capacity

Recommendation(s):

- ☒ Continue inspection and maintenance, as needed
- ☐ Stabilize berm with acceptable mulch material
- ☐ Repair damaged sections of berm and stabilize
- ☐ Install stone outlet at low point in grade
- ☐ Enlarge berm to provide for additional capacity
- ☐ Remove unnecessary berm and stabilize disturbed soils

Additional Comments:

Perimeter Protection: Berm**Condition:**

- ☒ Berm installed in accordance with NYSDEC specifications
☐ Berm in need of maintenance or repair
☐ Berm nearing or exceeding capacity

Recommendation(s):

- ☒ Continue inspection and maintenance, as needed
☐ Stabilize berm with acceptable mulch material
☐ Repair damaged sections of berm and stabilize
☐ Install stone outlet at low point in grade
☐ Enlarge berm to provide for additional capacity
☐ Remove unnecessary berm and stabilize disturbed soils

Additional Comments:**Perimeter Protection: Berm****Condition:**

- ☒ Berm installed in accordance with NYSDEC specifications
☐ Berm in need of maintenance or repair
☐ Berm nearing or exceeding capacity

Recommendation(s):

- ☒ Continue inspection and maintenance, as needed
☐ Stabilize berm with acceptable mulch material
☐ Repair damaged sections of berm and stabilize
☐ Install stone outlet at low point in grade
☐ Enlarge berm to provide for additional capacity
☐ Remove unnecessary berm and stabilize disturbed soils

Additional Comments:**Stockpile Area****Condition:**

- ☒ Stockpile area active
☐ Soils stabilized
☒ Adequate perimeter protection
☒ Stabilized stone access installed

Recommendation(s):

- | | |
|---|--|
| <input type="checkbox"/> Grade stockpile area | <input type="checkbox"/> Install stone access |
| <input type="checkbox"/> Stabilize stockpile area | <input type="checkbox"/> Repair stone access |
| <input type="checkbox"/> Install perimeter protection | <input type="checkbox"/> Sweep adjacent pavement |
| <input type="checkbox"/> Repair perimeter protection | <input type="checkbox"/> |

Additional Comments:

Protected Area: Hudson River**Rate of Flow:**

- ☐ None
☒ Light
☐ Moderate/Heavy

Natural Turbidity:

- ☐ None
☒ Light
☐ Moderate/Heavy

Recommendations:

- ☐ Install protective fencing
☐ Stabilize upslope soils

Discharge to Sensitive Area:

- ☒ None ☐ Moderate
☐ Light ☐ Heavy

Turbidity in Discharge:

- ☐ None ☐ Moderate/Heavy
☐ Light ☒ N/A

Discharge in significant contrast:

- ☐ Yes ☐ No ☒ N/A

- ☐ Install perimeter protection
☐ Repair perimeter protection

Additional Comments:**Modifications to the SWPPP:**

Modification	Reason for Modification
09/21/17 – The small section of silt fencing installed adjacent to the river will be removed and a perimeter berm/dike will be installed along the perimeter of the site in lieu of fencing.	Perimeter berms have proven to be much more durable and require much less maintenance than silt fencing. Given the time of year and the likelihood the perimeter protection will be left in place for an extended period of time, berms are more reliable than fencing. The berms and downslope areas will be stabilized with wood chips and stump grindings.
09/21/17 – The perimeter swale and outlets will not be installed at this time. Rather, the perimeter will be sloped toward the interior of the site with the intent to infiltrate runoff. Stone outlets will be installed, as needed, in the coming months.	Site soils are such that discharge may not be necessary at all. Rather than create a discharge point, it is desirable to keep all runoff onsite to the maximum extent possible. The swale and the discharge points can be installed later, if needed.

SITE PLAN: BY RHD LAND SURVEYING
20 JANUARY 31, 2017.
NO ARE BASED ON
FACE EVIDENCE AND RECORD MAPS. BROWMAN ASSOCIATES DOES NOT
TRY TO THE ACCURACY OF THEIR LOCATION AND/OR COMPLETION. IF
THE CONTRACTOR'S RESPONSIBILITY TO VERIFY THE LOCATION AND EXTENT
ALL UNDERGROUND STRUCTURES AND UTILITIES PRIOR TO ANY DIGGING
CONSTRUCTION ACTIVITIES IN THEIR VICINITY. THE CONTRACTOR SHALL
FALL EXISTING UTILITIES FIELD STAKED BEFORE STARTING WORK BY
LINE 1-800-962-7962.

TEMPORARY SEDIMENT TRAP CALCULATIONS			
MENT RAP	DISBURGAGE AREA (ACRES)	REQUIRED TRAP VOLUME (C.F.)	PROPOSED TRAP VOLUME (C.F.)
1	1.45	5,220	5,702
2	1.58	5,688	6,210
3	2.69	10,368	14,868

PHASE DATA CHART	
ASE	AREA (ACRES)
1	4.97
2	1.33

1. PHASE 1 SHALL BE STABILIZED PRIOR TO PHASE 2 DISTURBANCE.

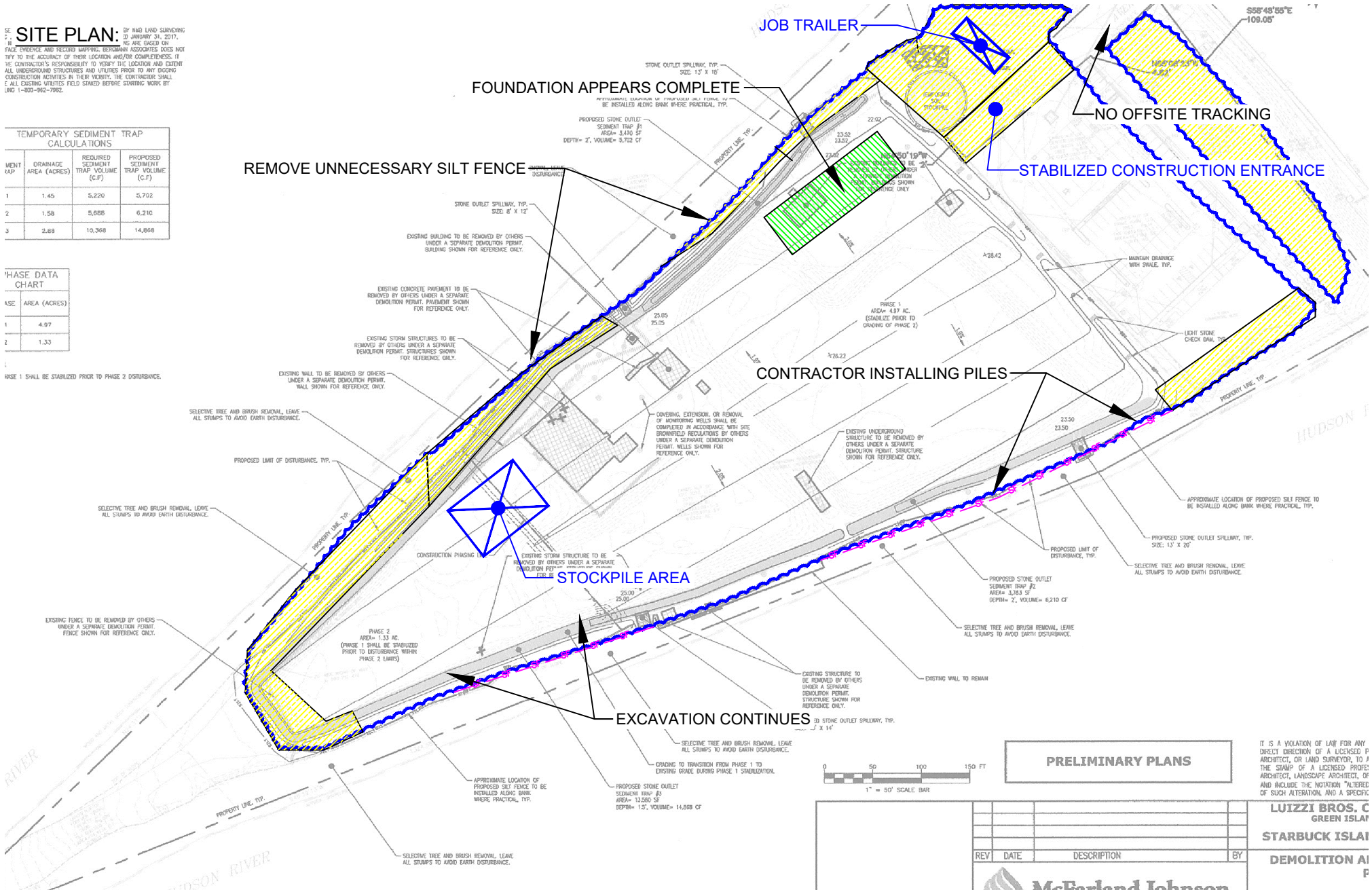

PRELIMINARY PLANS

IT IS A VIOLATION OF LAW FOR ANY
DIRECT OR INDIRECT OF A LICENSED P
ARCHITECT, OR LAND SURVEYOR, TO P
THE STAMP OF A LICENSED PROFESSIONAL
ARCHITECT, LANDSCAPE ARCHITECT, OR
AND INCLUDE THE NOTATION "PRELIMINARY
OF SUCH ALTERATION, AND A SPECIFIC

LUZZI BROS. C
GREEN ISLAND

STARBUCK ISLAND

DEMOLITION AND

REV	DATE	DESCRIPTION	BY

Barber Engineering

PO Box 454 - Nassau, New York 12123
Ph: (518) 322-3033 - Fax: (518) 766-0372
email: ken@barberpllc.com

CONSTRUCTION DURATION INSPECTION REPORT

PROJECT INFORMATION: STARBUCK ISLAND (SPDES ID: NYR11D911)

JOB No.: 17-019 INSPECTOR: KPB DATE: 12/07/18 9:45 AM

PURPOSE OF INSPECTION: BI-WEEKLY INSPECTION

AMOUNT OF RAINFALL SINCE LAST INSPECTION: 0.00"

LEGEND:

- LIMIT OF DISTURBANCE
- STABILIZED AREA (TEMPORARILY)
- STABILIZED AREA (PERMANENTLY)
- AREA THAT HAS NOT SEEN WORK IN 14 DAYS
- SILT FENCE

Site Assessment and Inspection Report (SPDES GP-0-15-002, Part IV.C.4)



Name of Facility: Starbuck Island	Permit Number: NYR11D911
Location: Village of Green Island, New York	
Date of Inspection: December 11, 2018	Time of Inspection: 10:15 am
Weather: Clear - 20 Degrees	Rainfall Since Last Inspection: 0.00"
Purpose of Inspection: Bi-Weekly Inspection	Inspector: KPB

Report E-Mail Distribution List:

1.	Recipient: Owner's Representative	Josh Meppen	E-mail: jmeppen@luizziconstructionservices.com
2.	Recipient: Site Superintendent	Chuck Pafundi	E-mail: cpafundi@luizzibros.com
3.	Recipient: Town Official	Maggie Alix	E-mail: maggie.alix@villageofgreenisland.com
4.	Recipient: Owner	Pete Luizzi	E-mail: pluizzi@luizzibros.com
5.	Recipient: Site Contractor	Mike Alix	E-mail: malix@luizzibros.com
6.	Recipient: NYSDEC	Mary Barrie	E-mail: mary.barrie@dec.ny.gov
7.	Recipient: NYSDEC	Michael Komoroske	E-mail: michael.komoroske@dec.ny.gov
8.	Recipient: NYSDEC	Alicia Barraza	E-mail: alicia.barraza@dec.ny.gov
9.	Recipient: Choose an item.	Gianna Aiezza	E-mail: gaiezza@envirospeceng.com
10.	Recipient: Choose an item.	Rachel Farnum	E-mail: rfarnum@envirospeceng.com

Kenneth P. Barber, PE
Qualified Professional

Site Conditions**Soil Conditions:**

- ☒ Dry
☐ Wet
☐ Saturated
☒ Frozen
☐ Snow Covered

Offsite Sediment Tracking:

- ☒ None
☐ Light
☐ Moderate
☐ Heavy

Discharge:

- ☒ None
☐ Light
☐ Moderate
☐ Heavy

Condition of Discharge:

- ☒ N/A
☐ Clean
☐ Evidence of Turbidity

Contrast to receiving water?

- ☐ Yes ☐ No ☒ N/A

Additional Comments: Contractor is maintaining existing pavement as additional buffer to prevent offsite sediment tracking. Continue sweeping of existing pavement.

General Clearing & Grading: 1**Clearing:**

- ☒ Vegetation cleared
☒ Soils disturbed

Grading:

- ☐ Exporting material
☐ Importing material
☐ Soils stockpiled

ESC Devices:

- ☒ Stabilized entrance
☒ Perimeter protection
☒ Temporary stabilization

Recommendations:

- ☐ Install stabilized entrance
☐ Repair/maintain stabilized entrance
☐ Enlarge stabilized entrance
☐ Restrict traffic to entrance
☐ Install perimeter protection
☐ Repair/stabilize perimeter protection
☐ Install outlet for perimeter protection
☐ Stabilize exposed soils
☐ Repair eroded soils and stabilize
☐ Continue to monitor exposed soils

Additional Comments:

General Clearing & Grading: 2**Clearing:**

- ☒ Vegetation cleared
☒ Soils disturbed

Grading:

- ☐ Exporting material
☐ Importing material
☐ Soils stockpiled

ESC Devices:

- ☒ Stabilized entrance
☒ Perimeter protection
☒ Temporary stabilization

Recommendations:

- ☐ Install stabilized entrance
☐ Repair/maintain stabilized entrance
☐ Enlarge stabilized entrance
☐ Restrict traffic to entrance
☐ Install perimeter protection
☐ Repair/stabilize perimeter protection
☐ Install outlet for perimeter protection
☐ Stabilize exposed soils
☐ Repair eroded soils and stabilize
☐ Continue to monitor exposed soils

Additional Comments:

General Clearing & Grading: 3**Clearing:**

- ☒ Vegetation cleared
☒ Soils disturbed

Grading:

- ☒ Exporting material
☐ Importing material
☐ Soils stockpiled

ESC Devices:

- ☒ Stabilized entrance
☒ Perimeter protection
☐ Temporary stabilization

Recommendations:

- ☐ Install stabilized entrance
☐ Repair/maintain stabilized entrance
☐ Enlarge stabilized entrance
☐ Restrict traffic to entrance
☐ Install perimeter protection
☐ Repair/stabilize perimeter protection
☐ Install outlet for perimeter protection
☐ Stabilize exposed soils
☐ Repair eroded soils and stabilize
☐ Continue to monitor exposed soils

Additional Comments: Contractor driving piles for retaining wall.

Construction Entrance:**Condition:**

- ☒ Properly maintained and effective
☒ Installed pursuant to standards and specifications
☒ Traffic restricted to entrance when leaving and reentering site
☒ Adequate drainage provided to prevent ponding

Recommendation(s):

- ☐ Install entrance
☐ Top dress entrance
☐ Repair stone entrance
☒ Continue maintenance, as needed
☐ Widen stone entrance
☐ Lengthen stone entrance
☐ Sweep adjacent pavement
☐ Regrade entrance

Additional Comments:

Building Area

- ☐ Soils cleared
☐ Foundation underway
☒ Foundation complete
☐ Building work underway
☐ Building work complete
☐ Temporarily stabilized
☐ Permanently stabilized
☐

ESC Devices:

- ☒ Stabilized entrance
☒ Perimeter protection

Recommendations:

- ☐ Install stabilized entrance
☐ Repair/maintain stabilized entrance
☐ Restrict traffic to entrance
☐ Install perimeter protection
☐ Repair/stabilize perimeter protection
☐ Install outlet for perimeter protection
☐ Stabilize exposed soils
☐ Remove lot controls and stabilize
☐ Repair eroded soils and stabilize
☐ Control roof runoff

Additional Comments:

Perimeter Protection: Silt Fence**Condition:**

- ☒ Silt fence installed in accordance with NYSDEC specifications
- ☒ Silt fence in need of maintenance or repair
- ☐ Silt fence nearing or exceeding capacity

Recommendation(s):

- ☐ Continue inspection and maintenance, as needed
- ☐ Properly reinstall and maintain fencing
- ☐ Repair toppled sections and maintain fencing
- ☐ Remove excess sediment and maintain fencing
- ☐ Remove fencing and replace with perimeter berm
- ☒ Remove unnecessary fencing and stabilize disturbed soils

Additional Comments:**Perimeter Protection: Silt Fence****Condition:**

- ☒ Silt fence installed in accordance with NYSDEC specifications
- ☐ Silt fence in need of maintenance or repair
- ☐ Silt fence nearing or exceeding capacity

Recommendation(s):

- ☒ Continue inspection and maintenance, as needed
- ☐ Properly reinstall and maintain fencing
- ☐ Repair toppled sections and maintain fencing
- ☐ Remove excess sediment and maintain fencing
- ☐ Remove fencing and replace with perimeter berm
- ☐ Remove unnecessary fencing and stabilize disturbed soils

Additional Comments:**Perimeter Protection: Berm****Condition:**

- ☒ Berm installed in accordance with NYSDEC specifications
- ☐ Berm in need of maintenance or repair
- ☐ Berm nearing or exceeding capacity

Recommendation(s):

- ☒ Continue inspection and maintenance, as needed
- ☐ Stabilize berm with acceptable mulch material
- ☐ Repair damaged sections of berm and stabilize
- ☐ Install stone outlet at low point in grade
- ☐ Enlarge berm to provide for additional capacity
- ☐ Remove unnecessary berm and stabilize disturbed soils

Additional Comments:

Perimeter Protection: Berm**Condition:**

- ☒ Berm installed in accordance with NYSDEC specifications
- ☐ Berm in need of maintenance or repair
- ☐ Berm nearing or exceeding capacity

Recommendation(s):

- ☒ Continue inspection and maintenance, as needed
- ☐ Stabilize berm with acceptable mulch material
- ☐ Repair damaged sections of berm and stabilize
- ☐ Install stone outlet at low point in grade
- ☐ Enlarge berm to provide for additional capacity
- ☐ Remove unnecessary berm and stabilize disturbed soils

Additional Comments:**Perimeter Protection: Berm****Condition:**

- ☒ Berm installed in accordance with NYSDEC specifications
- ☐ Berm in need of maintenance or repair
- ☐ Berm nearing or exceeding capacity

Recommendation(s):

- ☒ Continue inspection and maintenance, as needed
- ☐ Stabilize berm with acceptable mulch material
- ☐ Repair damaged sections of berm and stabilize
- ☐ Install stone outlet at low point in grade
- ☐ Enlarge berm to provide for additional capacity
- ☐ Remove unnecessary berm and stabilize disturbed soils

Additional Comments:**Stockpile Area****Condition:**

- ☒ Stockpile area active
- ☐ Soils stabilized
- ☒ Adequate perimeter protection
- ☒ Stabilized stone access installed

Recommendation(s):

- | | |
|---|--|
| <input type="checkbox"/> Grade stockpile area | <input type="checkbox"/> Install stone access |
| <input type="checkbox"/> Stabilize stockpile area | <input type="checkbox"/> Repair stone access |
| <input type="checkbox"/> Install perimeter protection | <input type="checkbox"/> Sweep adjacent pavement |
| <input type="checkbox"/> Repair perimeter protection | <input type="checkbox"/> |

Additional Comments:

Protected Area: Hudson River**Rate of Flow:**

- ☐ None
☒ Light
☐ Moderate/Heavy

Natural Turbidity:

- ☐ None
☒ Light
☐ Moderate/Heavy

Recommendations:

- ☐ Install protective fencing
☐ Stabilize upslope soils

Discharge to Sensitive Area:

- ☒ None ☐ Moderate
☐ Light ☐ Heavy

Turbidity in Discharge:

- ☐ None ☐ Moderate/Heavy
☐ Light ☒ N/A

Discharge in significant contrast:

- ☐ Yes ☐ No ☒ N/A

- ☐ Install perimeter protection
☐ Repair perimeter protection

Additional Comments:**Modifications to the SWPPP:**

Modification	Reason for Modification
09/21/17 – The small section of silt fencing installed adjacent to the river will be removed and a perimeter berm/dike will be installed along the perimeter of the site in lieu of fencing.	Perimeter berms have proven to be much more durable and require much less maintenance than silt fencing. Given the time of year and the likelihood the perimeter protection will be left in place for an extended period of time, berms are more reliable than fencing. The berms and downslope areas will be stabilized with wood chips and stump grindings.
09/21/17 – The perimeter swale and outlets will not be installed at this time. Rather, the perimeter will be sloped toward the interior of the site with the intent to infiltrate runoff. Stone outlets will be installed, as needed, in the coming months.	Site soils are such that discharge may not be necessary at all. Rather than create a discharge point, it is desirable to keep all runoff onsite to the maximum extent possible. The swale and the discharge points can be installed later, if needed.

SITE PLAN: BY RHD LAND SURVEYING
20 JANUARY 31, 2017.
NO ARE BASED ON
FACE EVIDENCE AND RECORD MAPS. BROWMAN ASSOCIATES DOES NOT
TRY TO THE ACCURACY OF THEIR LOCATION AND/OR COMPLETENESS. IF
THE CONTRACTOR'S RESPONSIBILITY TO VERIFY THE LOCATION AND EXISTENT
ALL UNDERGROUND STRUCTURES AND UTILITIES PRIOR TO ANY EXCAVATION
CONSTRUCTION ACTIVITIES IN THEIR VICINITY. THE CONTRACTOR SHALL
FALL EXISTING UTILITIES FIELD STAKED BEFORE STARTING WORK BY
LINE 1-800-962-7962.

TEMPORARY SEDIMENT TRAP CALCULATIONS			
MENT	DISCHARGE	REQUIRED	PROPOSED
RAP	AREA (ACRES)	TRAP VOLUME	TRAP VOLUME
		(C.F.)	(C.F.)
1	1.45	5,220	5,702
2	1.58	5,688	6,210
3	2.69	10,368	14,868

PHASE DATA CHART	
ASE	AREA (ACRES)
1	4.97
2	1.33

1. PHASE 1 SHALL BE STABILIZED PRIOR TO PHASE 2 DISTURBANCE.

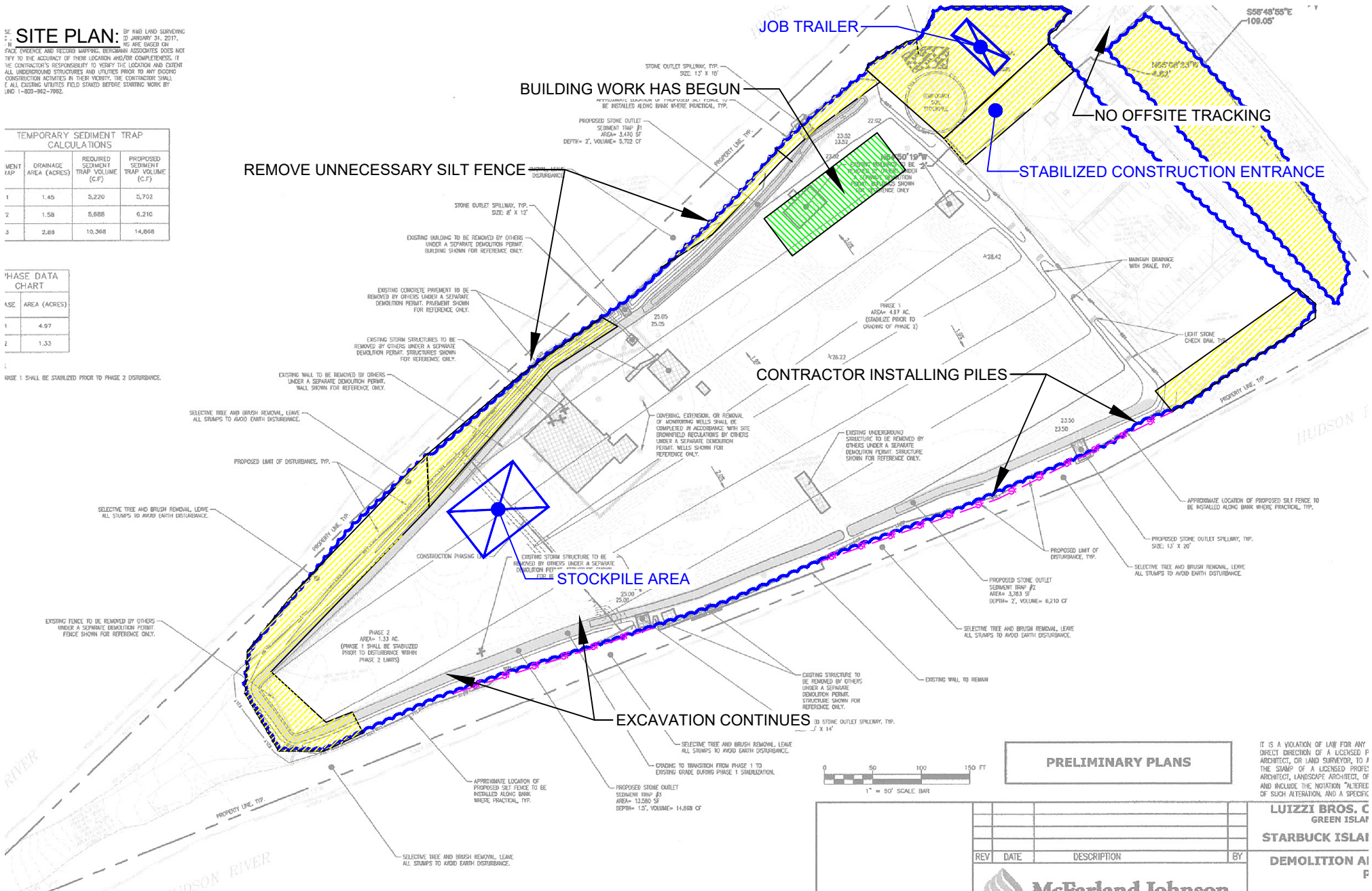

CONSTRUCTION DURATION INSPECTION REPORT

PROJECT INFORMATION: STARBUCK ISLAND (SPDES ID: NYR11D911)

JOB No.: 17-019 INSPECTOR: KPB DATE: 12/11/18 10:30 AM

PURPOSE OF INSPECTION: BI-WEEKLY INSPECTION

AMOUNT OF RAINFALL SINCE LAST INSPECTION: 0.00"

LEGEND:

- LIMIT OF DISTURBANCE
- STABILIZED AREA (TEMPORARILY)
- STABILIZED AREA (PERMANENTLY)
- AREA THAT HAS NOT SEEN WORK IN 14 DAYS
- SILT FENCE

Barber Engineering

PO Box 454 - Nassau, New York 12123
Ph: (518) 322-3033 - Fax: (518) 766-0372
email: ken@barberpllc.com

IT IS A VIOLATION OF LAW FOR ANY
DIRECT OR INDIRECT OF A LICENSED P
ARCHITECT, OR LAND SURVEYOR, TO P
THE STAMP OF A LICENSED PROFES
ARCHITECT, LANDSCAPE ARCHITECT, OF
AND INCLUDE THE NOTATION "ALTERED
OF SUCH ALTERATION, AND A SPECIFIC

LUZZI BROS. C
GREEN ISLAND

STARBUCK ISLAND

DEMOLITION AREA