

December 9, 2008

Ms. Charlotte Theobald
NY State Department of Environmental Conservation
Division of Environmental Remediation, Region 8
6274 East Avon-Lima Road
Avon, New York 14414-9519

Re: Site No. C849004
Seneca Market I, LLC Site
Watkins Glen, New York
Results of November 2008 Groundwater Monitoring

Dear Ms. Theobald:

On behalf of our client, Seneca Market I, LLC (Seneca Market), Benchmark Environmental Engineering & Science, PLLC (Benchmark) is herein transmitting the results from the November 2008 groundwater monitoring event at the Seneca Market Site in Watkins Glen, New York (Site; see Figure 1).

As we discussed prior to the groundwater sampling event, MW-1S and MW-3S were re-installed and designated MW-1SR and MW-3SR in their approximate previous locations. Due to MW-16S being damaged, MW-21S was installed on-Site as an up-gradient sample location relative to the historic drycleaner. Newly installed monitoring wells MW-1SR, MW-SR and MW-21SR were developed and existing monitoring wells MW-7S and MW-10S were redeveloped prior to groundwater sampling. This groundwater monitoring event included sampling and analysis of MW-1SR, MW-3SR, MW-7S, MW-10S and MW-21S.

Groundwater samples from each of the wells were analyzed for target compound list (TCL) volatile organic compounds (VOCs). The groundwater sample collected from MW-3SR was also analyzed for dissolved iron and manganese, nitrate, sulfate, sulfide, chloride, alkalinity, total organic carbon, metabolic acids and dissolved gases. Field parameters including pH, oxidation-reduction potential (ORP), dissolved oxygen (DO), temperature, turbidity, and specific conductance were also measured in each of the monitoring wells. Table 1 (attached) summarizes the analytical and field results from the November 2008 event as well as historic groundwater monitoring events completed by the NYSDEC in 1993 and 2000.

As shown on Table 1, chlorinated VOCs were not detected above NYSDEC Class GA groundwater quality standards (GWQS) as listed in NYSDEC Division of Water Technical

and Operational Guidance Series (TOGS) (1.1.1) in MW-7S, MW10S or MW-21S. Furthermore, concentrations of VOCs in MW-1SR and MW-3SR have significantly decreased over time. In particular, MW-3SR, located in the area of VOC source soil removal by Seneca Market, has decreased from 6,203 micrograms per liter (ug/L) total chlorinated VOCs in June 2000 to 48 ug/L total chlorinated VOCs in November 2008. The results of the November 2008 sampling event also confirm that biodegradation of VOCs in groundwater is occurring. This is evidenced by the presence of tetrachloroethene (PCE) breakdown products, including trichloroethene (TCE), 1,1-dichloroethene (1,1-DCE), cis-1,2-DCE, trans-1,2-DCE and vinyl chloride. In addition, the presence of end-product dissolved gases, include carbon dioxide, ethene and methane are indicative of biodegradation activity.

The first quarterly groundwater sampling event for 2009 is scheduled for the first week of March 2009. Please contact us with any questions or comments.

Sincerely,
Benchmark Environmental Engineering & Science, PLLC

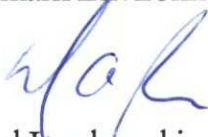

Michael Lesakowski
Project Manager

Att.

c: P. Sheedy (Seneca Market I, LLC)

TABLE



TABLE 1
SUMMARY OF GROUNDWATER MONITORING RESULTS

SENECA MARKET I, LLC SITE
WATKINS GLEN, NEW YORK

Parameter ¹	Sample Location																				GWQS ⁶
	MW-1S R			MW-3S R						MW-7S					MW-10S				MW-21S		
	1/1/93 ²	4/1/93 ²	11/21/08	1/1/93 ²	4/1/93 ²	3/16/00 ³	6/23/00 ⁴	10/20/00 ⁵	11/21/08	1/1/93 ²	4/1/93 ²	3/16/00 ³	6/23/00 ⁴	10/20/00 ⁵	11/21/08	1/1/93 ²	4/1/93 ²	11/21/08	11/21/08 Blind Duplicate	11/21/08	
TCL Volatile Organic Compounds (VOCs) - ug/L																					
Acetone	ND	ND	1.4 J	R	R	ND	24	ND	ND	R	ND	ND	ND	ND	ND	20	R	ND	ND	1.8 J	50
Benzene	ND	ND	ND	ND	R	ND	2	ND	ND	6 J	R	7	11	ND	4.7	ND	R	ND	ND	ND	1
Bromomethane (Methyl bromide)	ND	ND	ND	ND	ND	ND	ND	ND	ND	ND	ND	ND	ND	ND	0.2 BJ	ND	ND	0.33 BJ	ND	ND	5
2-Butanone (MEK)	ND	ND	ND	ND	ND	ND	ND	ND	ND	ND	ND	ND	ND	ND	ND	ND	10	ND	ND	ND	50
Carbon disulfide	ND	ND	0.2 J	ND	ND	ND	29	ND	ND	ND	ND	ND	ND	ND	ND	ND	ND	ND	ND	ND	--
Cyclohexane	ND	ND	ND	ND	ND	ND	ND	ND	ND	ND	ND	ND	ND	ND	8.8	ND	ND	ND	ND	ND	--
1,1-Dichloroethene	ND	ND	0.2 J	ND	ND	1	13	4	ND	ND	ND	ND	ND	ND	ND	ND	ND	ND	ND	ND	5
cis-1,2-Dichloroethene	NA	NA	91	NA	NA	NA	NA	NA	13	NA	NA	NA	NA	NA	4.1	NA	NA	ND	ND	0.21 J	5
trans-1,2-Dichloroethene	NA	NA	0.71 J	NA	NA	NA	NA	NA	0.24 J	NA	NA	NA	NA	NA	NA	ND	NA	NA	ND	ND	5
Total 1,2-Dichloroethene	43	40	NA	770	87	1900	5500	2200	NA	ND	3 J	6	36	6	NA	ND	ND	NA	NA	ND	5
Ethylbenzene	ND	ND	ND	ND	ND	ND	ND	ND	ND	ND	6 J	ND	ND	ND	ND	ND	ND	ND	ND	ND	5
Methylcyclohexane	ND	ND	ND	ND	ND	ND	ND	ND	ND	ND	ND	ND	ND	ND	1.4	ND	ND	ND	ND	ND	--
Methylene chloride	R	ND	ND	R	ND	ND	ND	ND	ND	R	R	ND	ND	ND	ND	ND	3 J	ND	ND	ND	5
4-methyl-2-pentanone (MBK)	9 J	ND	ND	ND	ND	ND	ND	ND	ND	20	ND	ND	ND	ND	ND	ND	ND	ND	ND	ND	--
Methyl tert butyl ether (MTBE)	ND	ND	1.8	ND	ND	ND	ND	ND	4.6	ND	ND	ND	ND	ND	4.5	ND	ND	ND	ND	0.55 J	10
Styrene	ND	ND	ND	ND	ND	ND	ND	ND	ND	ND	ND	ND	ND	ND	ND	ND	0.6 J	ND	ND	ND	930
1,1,2,2-Tetrachloroethane	ND	ND	ND	ND	ND	ND	ND	ND	ND	ND	ND	ND	ND	ND	ND	ND	4 J	ND	ND	ND	5
Tetrachloroethene	410	360	88	88	8	77	83	ND	24	ND	ND	ND	5	6	ND	6 J	R	3.2	3.2	ND	5
Toluene	ND	ND	ND	ND	ND	ND	ND	ND	ND	ND	ND	ND	2	ND	0.69 J	ND	0.8 J	ND	ND	ND	5
Trichloroethene	22 J	26	21	190	20	83	200	14	7.7	ND	ND	ND	4	2	ND	ND	ND	ND	ND	ND	5
Vinyl chloride	ND	ND	1.5	38 J	ND	17	420	390	2.6	ND	ND	1	3	ND	1.3	ND	ND	ND	ND	0.23 J	2
m+p Xylene	ND	ND	ND	ND	ND	ND	ND	ND	ND	ND	ND	ND	ND	ND	0.3 J	ND	ND	ND	ND	ND	5
Total Xylene	ND	ND	ND	ND	ND	ND	6	ND	ND	ND	2 J	ND	ND	ND	ND	2 J	ND	ND	ND	ND	5
Total VOCs	484	426	206	1086	115	2078	6277	2608	52	26	11	14	61	14	26	26	20	4	3	3	
Total Chlorinated VOCs	475	426	202	1086	115	2077	6203	2604	48	0	3	7	48	14	5	6	4	3	3	0	
Water Quality Parameters (mg/L)																					
Iron- Soluble	NA	NA	NA	NA	NA	NA	NA	NA	ND	NA	NA	NA	NA	NA	NA	NA	NA	NA	NA	NA	300
Manganese- Soluble	NA	NA	NA	NA	NA	NA	NA	NA	4.94	NA	NA	NA	NA	NA	NA	NA	NA	NA	NA	NA	300
Nitrate, mg/L-N	NA	NA	NA	NA	NA	NA	NA	NA	ND	NA	NA	NA	NA	NA	NA	NA	NA	NA	NA	NA	10
Sulfate	NA	NA	NA	NA	NA	NA	NA	NA	18.3	NA	NA	NA	NA	NA	NA	NA	NA	NA	NA	NA	250
Sulfide	NA	NA	NA	NA	NA	NA	NA	NA	ND	NA	NA	NA	NA	NA	NA	NA	NA	NA	NA	NA	50
Chloride	NA	NA	NA	NA	NA	NA	NA	NA	454	NA	NA	NA	NA	NA	NA	NA	NA	NA	NA	NA	2.50E+08
Carbon Dioxide	NA	NA	NA	NA	NA	NA	NA	NA	66	NA	NA	NA	NA	NA	NA	NA	NA	NA	NA	NA	--
Ethane	NA	NA	NA	NA	NA	NA	NA	NA	ND	NA	NA	NA	NA	NA	NA	NA	NA	NA	NA	NA	--
Ethylene	NA	NA	NA	NA	NA	NA	NA	NA	0.0008 J	NA	NA	NA	NA	NA	NA	NA	NA	NA	NA	NA	--
Methane	NA	NA	NA	NA	NA	NA	NA	NA	0.051	NA	NA	NA	NA	NA	NA	NA	NA	NA	NA	NA	--
Total Alkalinity	NA	NA	NA	NA	NA	NA	NA	NA	334	NA	NA	NA	NA	NA	NA	NA	NA	NA	NA	NA	--
Total Organic Carbon	NA	NA	NA	NA	NA	6	36.6	23.9	4.26	NA	NA	9.5	8	12.4	NA	NA	NA	NA	NA	NA	--
Field Measurements (units as indicated)																					
pH (units)			7.00						7.08						7.15			7.02		7.25	6.5 - 8.5
Temperature (°C)			11.4						11.7						11			11.5		11.9	--
Specific Conductance (uS)			2000						2016						2966			1538		1140	--
Turbidity (NTU)			214						9.04						100			88.1		5.35	--
ORP (mV)			58						41						-87			27		-99	--
DO (ppm)			1.53						1.38						1.47			1.35		1.04	--

Notes:

- Only those parameters detected at a minimum of one sample location are presented in this table; all other compounds were reported as non-detect.
- Results are from the 1993 RI/FS report prepared by URS.
- Pre-injection groundwater sampling results from the 2001 URS report "Evaluation of Site Remediation by In-Situ Oxidation."
- Between injection groundwater sampling results from the 2001 URS report "Evaluation of Site Remediation by In-Situ Oxidation."
- Post-injection groundwater sampling results from the 2001 URS report "Evaluation of Site Remediation by In-Situ Oxidation."
- Class "GA" Groundwater Quality Standards for NYSDEC Divisions of Water TOGS 1.1.1

Definitions:

- ND = Parameter not detected above laboratory detection limit.
- NA = Sample not analyzed for parameter.
- = No GWQS available.
- J = Estimated value; result is less than the sample quantitation limit but greater than zero.
- R = Data rejected.

FIGURES

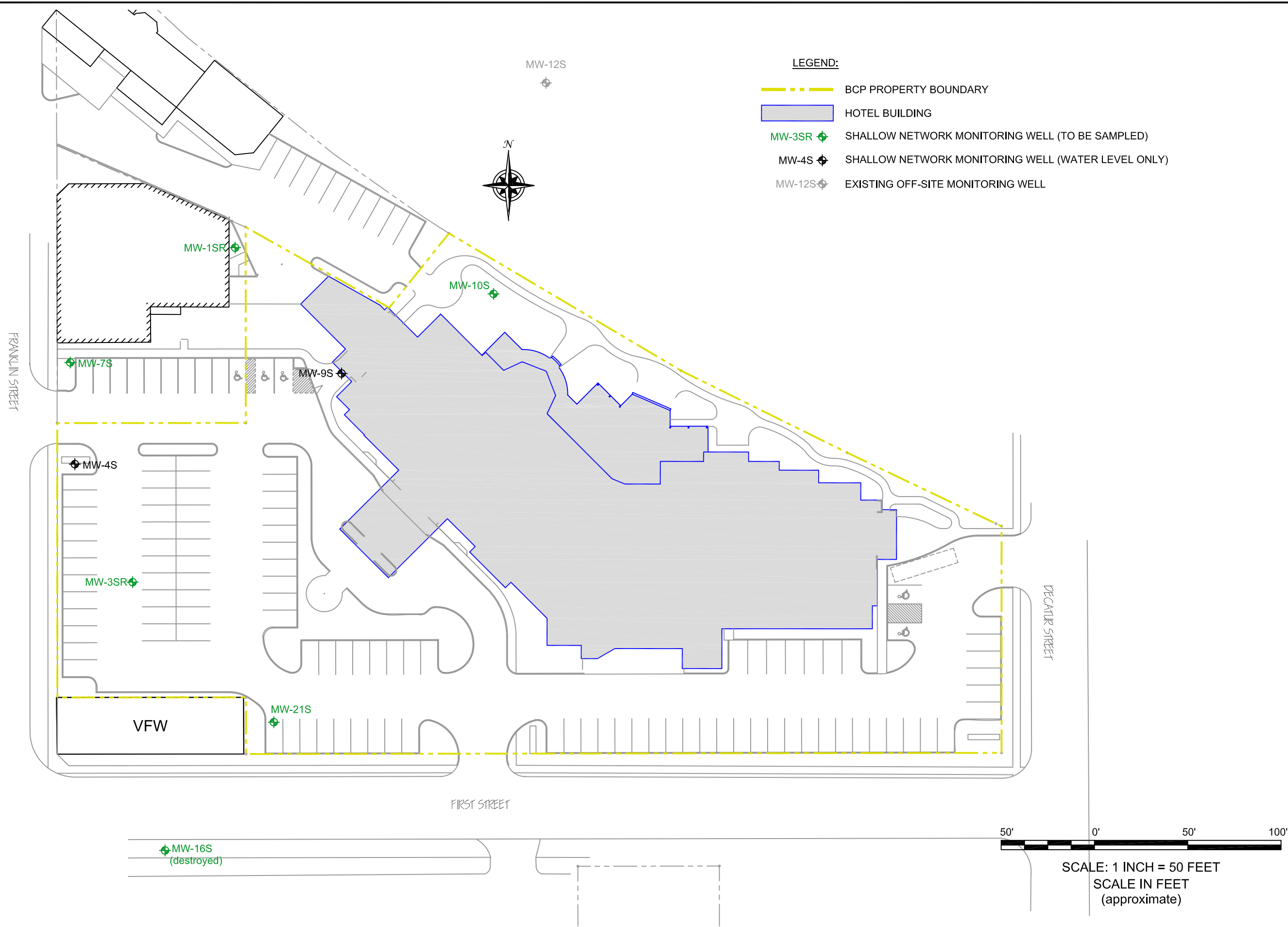

- LEGEND:**
- - - BCP PROPERTY BOUNDARY
 - HOTEL BUILDING
 - ◆ MW-3SR SHALLOW NETWORK MONITORING WELL (TO BE SAMPLED)
 - ◆ MW-4S SHALLOW NETWORK MONITORING WELL (WATER LEVEL ONLY)
 - ◆ MW-12S EXISTING OFF-SITE MONITORING WELL

LONG-TERM GROUNDWATER MONITORING NETWORK

LONG-TERM GROUNDWATER MONITORING PLAN

SENECA MARKET I, LLC SITE
WATKINS GLEN, NEW YORK
SITE NO. C849004

PREPARED FOR
SENECA MARKET I, LLC

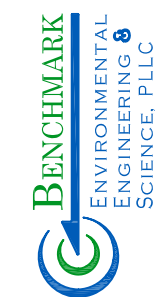

726 EXCHANGE STREET
SUITE 624
BUFFALO, NEW YORK 14210
(716) 856-0599

JOB NO.: 0092-002-200

FIGURE 1

ATTACHMENT 1

LABORATORY ANALYTICAL DATA (SUMMARY SHEETS)
NOVEMBER 2008 SAMPLING EVENT

COLUMBIA ANALYTICAL SERVICES

VOLATILE ORGANICS
 METHOD 8260B
 Reported: 12/05/08

Benchmark Environmental Eng.

Project Reference: SENECA MARKET PROJECT #0092-002-200

Client Sample ID : 1SR

Date Sampled : 11/21/08 10:25 Order #: 1156878 Sample Matrix: WATER
 Date Received: 11/21/08 Submission #: R2847383 Analytical Run 170924

ANALYTE	PQL	RESULT	UNITS
DATE ANALYZED	: 12/03/08		
ANALYTICAL DILUTION:	1.00		
ACETONE	10	1.4 J	UG/L
BENZENE	1.0	1.0 U	UG/L
BROMODICHLOROMETHANE	1.0	1.0 U	UG/L
BROMOFORM	1.0	1.0 U	UG/L
BROMOMETHANE	2.0	2.0 U	UG/L
2-BUTANONE (MEK)	5.0	5.0 U	UG/L
METHYL-TERT-BUTYL ETHER	1.0	1.8	UG/L
CARBON DISULFIDE	1.0	0.20 J	UG/L
CARBON TETRACHLORIDE	1.0	1.0 U	UG/L
CHLOROBENZENE	1.0	1.0 U	UG/L
CHLOROETHANE	2.0	2.0 U	UG/L
CHLOROFORM	1.0	1.0 U	UG/L
CHLOROMETHANE	2.0	2.0 U	UG/L
1,2-DIBROMO-3-CHLOROPROPANE	2.0	2.0 U	UG/L
CYCLOHEXANE	1.0	1.0 U	UG/L
DIBROMOCHLOROMETHANE	1.0	1.0 U	UG/L
1,2-DIBROMOETHANE	1.0	1.0 U	UG/L
1,3-DICHLOROBENZENE	1.0	1.0 U	UG/L
1,4-DICHLOROBENZENE	1.0	1.0 U	UG/L
1,2-DICHLOROBENZENE	1.0	1.0 U	UG/L
DICHLORODIFLUOROMETHANE	1.0	1.0 U	UG/L
1,1-DICHLOROETHANE	1.0	1.0 U	UG/L
1,2-DICHLOROETHANE	1.0	1.0 U	UG/L
1,1-DICHLOROETHENE	1.0	0.20 J	UG/L
CIS-1,2-DICHLOROETHENE	1.0	91	UG/L
TRANS-1,2-DICHLOROETHENE	1.0	0.71 J	UG/L
1,2-DICHLOROPROPANE	1.0	1.0 U	UG/L
CIS-1,3-DICHLOROPROPENE	1.0	1.0 U	UG/L
TRANS-1,3-DICHLOROPROPENE	1.0	1.0 U	UG/L
ETHYLBENZENE	1.0	1.0 U	UG/L
2-HEXANONE	5.0	5.0 U	UG/L
ISOPROPYLBENZENE	1.0	1.0 U	UG/L
METHYL ACETATE	10	10 U	UG/L
METHYLCYCLOHEXANE	1.0	1.0 U	UG/L
METHYLENE CHLORIDE	1.0	1.0 U	UG/L
4-METHYL-2-PENTANONE (MIBK)	5.0	5.0 U	UG/L
STYRENE	1.0	1.0 U	UG/L
1,1,2,2-TETRACHLOROETHANE	1.0	1.0 U	UG/L
TETRACHLOROETHENE	1.0	88	UG/L
TOLUENE	1.0	1.0 U	UG/L
1,2,4-TRICHLOROBENZENE	1.0	1.0 U	UG/L
1,1,1-TRICHLOROETHANE	1.0	1.0 U	UG/L
1,1,2-TRICHLOROETHANE	1.0	1.0 U	UG/L
TRICHLOROETHENE	1.0	21	UG/L

COLUMBIA ANALYTICAL SERVICES

VOLATILE ORGANICS
METHOD 8260B
Reported: 12/05/08

Benchmark Environmental Eng.
Project Reference: SENECA MARKET PROJECT #0092-002-200
Client Sample ID : 1SR

Date Sampled : 11/21/08 10:25 Order #: 1156878 Sample Matrix: WATER
Date Received: 11/21/08 Submission #: R2847383 Analytical Run 170924

ANALYTE	PQL	RESULT	UNITS
---------	-----	--------	-------

DATE ANALYZED : 12/03/08
ANALYTICAL DILUTION: 1.00

TRICHLOROFLUOROMETHANE	1.0	1.0 U	UG/L
1,1,2-TRICHLORO1,2,2-TRIFLUOROETHA	1.0	1.0 U	UG/L
VINYL CHLORIDE	1.0	1.5	UG/L
O-XYLENE	1.0	1.0 U	UG/L
M+P-XYLENE	1.0	1.0 U	UG/L

SURROGATE RECOVERIES

QC LIMITS

4-BROMOFLUOROBENZENE	(80 - 123 %)	101	%
TOLUENE-D8	(88 - 124 %)	96	%
DIBROMOFLUOROMETHANE	(89 - 115 %)	104	%

COLUMBIA ANALYTICAL SERVICES

VOLATILE ORGANICS
 METHOD 8260B
 Reported: 12/05/08

Benchmark Environmental Eng.

Project Reference: SENECA MARKET PROJECT #0092-002-200

Client Sample ID : 7S

Date Sampled : 11/21/08 11:15 Order #: 1156879 Sample Matrix: WATER
 Date Received: 11/21/08 Submission #: R2847383 Analytical Run 170924

ANALYTE	PQL	RESULT	UNITS
DATE ANALYZED		: 12/03/08	
ANALYTICAL DILUTION:		1.00	
ACETONE	10	10 U	UG/L
BENZENE	1.0	4.7	UG/L
BROMODICHLOROMETHANE	1.0	1.0 U	UG/L
BROMOFORM	1.0	1.0 U	UG/L
BROMOMETHANE	2.0	0.20 JB	UG/L
2-BUTANONE (MEK)	5.0	5.0 U	UG/L
METHYL-TERT-BUTYL ETHER	1.0	4.5	UG/L
CARBON DISULFIDE	1.0	1.0 U	UG/L
CARBON TETRACHLORIDE	1.0	1.0 U	UG/L
CHLOROBENZENE	1.0	1.0 U	UG/L
CHLOROETHANE	2.0	2.0 U	UG/L
CHLOROFORM	1.0	1.0 U	UG/L
CHLOROMETHANE	2.0	2.0 U	UG/L
1,2-DIBROMO-3-CHLOROPROPANE	2.0	2.0 U	UG/L
CYCLOHEXANE	1.0	8.8	UG/L
DIBROMOCHLOROMETHANE	1.0	1.0 U	UG/L
1,2-DIBROMOETHANE	1.0	1.0 U	UG/L
1,3-DICHLOROBENZENE	1.0	1.0 U	UG/L
1,4-DICHLOROBENZENE	1.0	1.0 U	UG/L
1,2-DICHLOROBENZENE	1.0	1.0 U	UG/L
DICHLORODIFLUOROMETHANE	1.0	1.0 U	UG/L
1,1-DICHLOROETHANE	1.0	1.0 U	UG/L
1,2-DICHLOROETHANE	1.0	1.0 U	UG/L
1,1-DICHLOROETHENE	1.0	1.0 U	UG/L
CIS-1,2-DICHLOROETHENE	1.0	4.1	UG/L
TRANS-1,2-DICHLOROETHENE	1.0	1.0 U	UG/L
1,2-DICHLOROPROPANE	1.0	1.0 U	UG/L
CIS-1,3-DICHLOROPROPENE	1.0	1.0 U	UG/L
TRANS-1,3-DICHLOROPROPENE	1.0	1.0 U	UG/L
ETHYLBENZENE	1.0	1.0 U	UG/L
2-HEXANONE	5.0	5.0 U	UG/L
ISOPROPYLBENZENE	1.0	1.0 U	UG/L
METHYL ACETATE	10	10 U	UG/L
METHYLCYCLOHEXANE	1.0	1.4	UG/L
METHYLENE CHLORIDE	1.0	1.0 U	UG/L
4-METHYL-2-PENTANONE (MIBK)	5.0	5.0 U	UG/L
STYRENE	1.0	1.0 U	UG/L
1,1,2,2-TETRACHLOROETHANE	1.0	1.0 U	UG/L
TETRACHLOROETHENE	1.0	1.0 U	UG/L
TOLUENE	1.0	0.69 J	UG/L
1,2,4-TRICHLOROBENZENE	1.0	1.0 U	UG/L
1,1,1-TRICHLOROETHANE	1.0	1.0 U	UG/L
1,1,2-TRICHLOROETHANE	1.0	1.0 U	UG/L
TRICHLOROETHENE	1.0	1.0 U	UG/L

COLUMBIA ANALYTICAL SERVICES

VOLATILE ORGANICS
METHOD 8260B
Reported: 12/05/08

Benchmark Environmental Eng.
Project Reference: SENECA MARKET PROJECT #0092-002-200
Client Sample ID : 7S

Date Sampled : 11/21/08 11:15 Order #: 1156879 Sample Matrix: WATER
Date Received: 11/21/08 Submission #: R2847383 Analytical Run 170924

ANALYTE	PQL	RESULT	UNITS
DATE ANALYZED		: 12/03/08	
ANALYTICAL DILUTION:		1.00	
TRICHLOROFLUOROMETHANE	1.0	1.0 U	UG/L
1,1,2-TRICHLORO1,2,2-TRIFLUOROETHA	1.0	1.0 U	UG/L
VINYL CHLORIDE	1.0	1.3	UG/L
O-XYLENE	1.0	1.0 U	UG/L
M+P-XYLENE	1.0	0.30 J	UG/L

SURROGATE RECOVERIES	QC LIMITS		
4-BROMOFLUOROBENZENE	(80 - 123 %)	102	%
TOLUENE-D8	(88 - 124 %)	96	%
DIBROMOFLUOROMETHANE	(89 - 115 %)	103	%

COLUMBIA ANALYTICAL SERVICES

VOLATILE ORGANICS
 METHOD 8260B
 Reported: 12/05/08

Benchmark Environmental Eng.
 Project Reference: SENECA MARKET PROJECT #0092-002-200
 Client Sample ID : 10S

Date Sampled : 11/21/08 10:12 Order #: 1156880 Sample Matrix: WATER
 Date Received: 11/21/08 Submission #: R2847383 Analytical Run 170924

ANALYTE	PQL	RESULT	UNITS
DATE ANALYZED	: 12/03/08		
ANALYTICAL DILUTION:	1.00		
ACETONE	10	10 U	UG/L
BENZENE	1.0	1.0 U	UG/L
BROMODICHLOROMETHANE	1.0	1.0 U	UG/L
BROMOFORM	1.0	1.0 U	UG/L
BROMOMETHANE	2.0	0.33 JB	UG/L
2-BUTANONE (MEK)	5.0	5.0 U	UG/L
METHYL-TERT-BUTYL ETHER	1.0	1.0 U	UG/L
CARBON DISULFIDE	1.0	1.0 U	UG/L
CARBON TETRACHLORIDE	1.0	1.0 U	UG/L
CHLOROBENZENE	1.0	1.0 U	UG/L
CHLOROETHANE	2.0	2.0 U	UG/L
CHLOROFORM	1.0	1.0 U	UG/L
CHLOROMETHANE	2.0	2.0 U	UG/L
1,2-DIBROMO-3-CHLOROPROPANE	2.0	2.0 U	UG/L
CYCLOHEXANE	1.0	1.0 U	UG/L
DIBROMOCHLOROMETHANE	1.0	1.0 U	UG/L
1,2-DIBROMOETHANE	1.0	1.0 U	UG/L
1,3-DICHLOROBENZENE	1.0	1.0 U	UG/L
1,4-DICHLOROBENZENE	1.0	1.0 U	UG/L
1,2-DICHLOROBENZENE	1.0	1.0 U	UG/L
DICHLORODIFLUOROMETHANE	1.0	1.0 U	UG/L
1,1-DICHLOROETHANE	1.0	1.0 U	UG/L
1,2-DICHLOROETHANE	1.0	1.0 U	UG/L
1,1-DICHLOROETHENE	1.0	1.0 U	UG/L
CIS-1,2-DICHLOROETHENE	1.0	1.0 U	UG/L
TRANS-1,2-DICHLOROETHENE	1.0	1.0 U	UG/L
1,2-DICHLOROPROPANE	1.0	1.0 U	UG/L
CIS-1,3-DICHLOROPROPENE	1.0	1.0 U	UG/L
TRANS-1,3-DICHLOROPROPENE	1.0	1.0 U	UG/L
ETHYLBENZENE	1.0	1.0 U	UG/L
2-HEXANONE	5.0	5.0 U	UG/L
ISOPROPYLBENZENE	1.0	1.0 U	UG/L
METHYL ACETATE	10	10 U	UG/L
METHYLCYCLOHEXANE	1.0	1.0 U	UG/L
METHYLENE CHLORIDE	1.0	1.0 U	UG/L
4-METHYL-2-PENTANONE (MIBK)	5.0	5.0 U	UG/L
STYRENE	1.0	1.0 U	UG/L
1,1,2,2-TETRACHLOROETHANE	1.0	1.0 U	UG/L
TETRACHLOROETHENE	1.0	3.2	UG/L
TOLUENE	1.0	1.0 U	UG/L
1,2,4-TRICHLOROBENZENE	1.0	1.0 U	UG/L
1,1,1-TRICHLOROETHANE	1.0	1.0 U	UG/L
1,1,2-TRICHLOROETHANE	1.0	1.0 U	UG/L
TRICHLOROETHENE	1.0	1.0 U	UG/L

COLUMBIA ANALYTICAL SERVICES

VOLATILE ORGANICS
METHOD 8260B
Reported: 12/05/08

Benchmark Environmental Eng.

Project Reference: SENECA MARKET PROJECT #0092-002-200

Client Sample ID : 10S

Date Sampled : 11/21/08 10:12 Order #: 1156880 Sample Matrix: WATER
Date Received: 11/21/08 Submission #: R2847383 Analytical Run 170924

ANALYTE	PQL	RESULT	UNITS
DATE ANALYZED	: 12/03/08		
ANALYTICAL DILUTION:	1.00		
TRICHLOROFLUOROMETHANE	1.0	1.0 U	UG/L
1,1,2-TRICHLORO1,2,2-TRIFLUOROETHA	1.0	1.0 U	UG/L
VINYL CHLORIDE	1.0	1.0 U	UG/L
O-XYLENE	1.0	1.0 U	UG/L
M+P-XYLENE	1.0	1.0 U	UG/L
<u>SURROGATE RECOVERIES</u>	<u>QC LIMITS</u>		
4-BROMOFLUOROBENZENE	(80 - 123 %)	97	%
TOLUENE-D8	(88 - 124 %)	93	%
DIBROMOFLUOROMETHANE	(89 - 115 %)	100	%

COLUMBIA ANALYTICAL SERVICES

VOLATILE ORGANICS
 METHOD 8260B
 Reported: 12/05/08

Benchmark Environmental Eng.

Project Reference: SENECA MARKET PROJECT #0092-002-200

Client Sample ID : 21S

Date Sampled : 11/21/08 11:45 Order #: 1156881 Sample Matrix: WATER
 Date Received: 11/21/08 Submission #: R2847383 Analytical Run 170924

ANALYTE	PQL	RESULT	UNITS
DATE ANALYZED	: 12/03/08		
ANALYTICAL DILUTION:	1.00		
ACETONE	10	1.8 J	UG/L
BENZENE	1.0	1.0 U	UG/L
BROMODICHLOROMETHANE	1.0	1.0 U	UG/L
BROMOFORM	1.0	1.0 U	UG/L
BROMOMETHANE	2.0	2.0 U	UG/L
2-BUTANONE (MEK)	5.0	5.0 U	UG/L
METHYL-TERT-BUTYL ETHER	1.0	0.55 J	UG/L
CARBON DISULFIDE	1.0	1.0 U	UG/L
CARBON TETRACHLORIDE	1.0	1.0 U	UG/L
CHLOROBENZENE	1.0	1.0 U	UG/L
CHLOROETHANE	2.0	2.0 U	UG/L
CHLOROFORM	1.0	1.0 U	UG/L
CHLOROMETHANE	2.0	2.0 U	UG/L
1,2-DIBROMO-3-CHLOROPROPANE	2.0	2.0 U	UG/L
CYCLOHEXANE	1.0	1.0 U	UG/L
DIBROMOCHLOROMETHANE	1.0	1.0 U	UG/L
1,2-DIBROMOETHANE	1.0	1.0 U	UG/L
1,3-DICHLOROBENZENE	1.0	1.0 U	UG/L
1,4-DICHLOROBENZENE	1.0	1.0 U	UG/L
1,2-DICHLOROBENZENE	1.0	1.0 U	UG/L
DICHLORODIFLUOROMETHANE	1.0	1.0 U	UG/L
1,1-DICHLOROETHANE	1.0	1.0 U	UG/L
1,2-DICHLOROETHANE	1.0	1.0 U	UG/L
1,1-DICHLOROETHENE	1.0	1.0 U	UG/L
CIS-1,2-DICHLOROETHENE	1.0	0.21 J	UG/L
TRANS-1,2-DICHLOROETHENE	1.0	1.0 U	UG/L
1,2-DICHLOROPROPANE	1.0	1.0 U	UG/L
CIS-1,3-DICHLOROPROPENE	1.0	1.0 U	UG/L
TRANS-1,3-DICHLOROPROPENE	1.0	1.0 U	UG/L
ETHYLBENZENE	1.0	1.0 U	UG/L
2-HEXANONE	5.0	5.0 U	UG/L
ISOPROPYLBENZENE	1.0	1.0 U	UG/L
METHYL ACETATE	10	10 U	UG/L
METHYLCYCLOHEXANE	1.0	1.0 U	UG/L
METHYLENE CHLORIDE	1.0	1.0 U	UG/L
4-METHYL-2-PENTANONE (MIBK)	5.0	5.0 U	UG/L
STYRENE	1.0	1.0 U	UG/L
1,1,2,2-TETRACHLOROETHANE	1.0	1.0 U	UG/L
TETRACHLOROETHENE	1.0	1.0 U	UG/L
TOLUENE	1.0	1.0 U	UG/L
1,2,4-TRICHLOROBENZENE	1.0	1.0 U	UG/L
1,1,1-TRICHLOROETHANE	1.0	1.0 U	UG/L
1,1,2-TRICHLOROETHANE	1.0	1.0 U	UG/L
TRICHLOROETHENE	1.0	1.0 U	UG/L

COLUMBIA ANALYTICAL SERVICES

VOLATILE ORGANICS
METHOD 8260B
Reported: 12/05/08

Benchmark Environmental Eng.
Project Reference: SENECA MARKET PROJECT #0092-002-200
Client Sample ID : 21S

Date Sampled : 11/21/08 11:45 Order #: 1156881 Sample Matrix: WATER
Date Received: 11/21/08 Submission #: R2847383 Analytical Run 170924

ANALYTE	PQL	RESULT	UNITS
DATE ANALYZED		: 12/03/08	
ANALYTICAL DILUTION:		1.00	
TRICHLOROFLUOROMETHANE	1.0	1.0 U	UG/L
1,1,2-TRICHLORO1,2,2-TRIFLUOROETHA	1.0	1.0 U	UG/L
VINYL CHLORIDE	1.0	0.23 J	UG/L
O-XYLENE	1.0	1.0 U	UG/L
M+P-XYLENE	1.0	1.0 U	UG/L

SURROGATE RECOVERIES	QC LIMITS		
4-BROMOFLUOROBENZENE	(80 - 123 %)	98	%
TOLUENE-D8	(88 - 124 %)	93	%
DIBROMOFLUOROMETHANE	(89 - 115 %)	103	%

COLUMBIA ANALYTICAL SERVICES

VOLATILE ORGANICS
 METHOD 8260B
 Reported: 12/05/08

Benchmark Environmental Eng.
 Project Reference: SENECA MARKET PROJECT #0092-002-200
 Client Sample ID : BLIND DUP

Date Sampled : 11/21/08 12:00 Order #: 1156882 Sample Matrix: WATER
 Date Received: 11/21/08 Submission #: R2847383 Analytical Run 170924

ANALYTE	PQL	RESULT	UNITS
DATE ANALYZED	: 12/03/08		
ANALYTICAL DILUTION:	1.00		
ACETONE	10	10 U	UG/L
BENZENE	1.0	1.0 U	UG/L
BROMODICHLOROMETHANE	1.0	1.0 U	UG/L
BROMOFORM	1.0	1.0 U	UG/L
BROMOMETHANE	2.0	2.0 U	UG/L
2-BUTANONE (MEK)	5.0	5.0 U	UG/L
METHYL-TERT-BUTYL ETHER	1.0	1.0 U	UG/L
CARBON DISULFIDE	1.0	1.0 U	UG/L
CARBON TETRACHLORIDE	1.0	1.0 U	UG/L
CHLOROBENZENE	1.0	1.0 U	UG/L
CHLOROETHANE	2.0	2.0 U	UG/L
CHLOROFORM	1.0	1.0 U	UG/L
CHLOROMETHANE	2.0	2.0 U	UG/L
1,2-DIBROMO-3-CHLOROPROPANE	2.0	2.0 U	UG/L
CYCLOHEXANE	1.0	1.0 U	UG/L
DIBROMOCHLOROMETHANE	1.0	1.0 U	UG/L
1,2-DIBROMOETHANE	1.0	1.0 U	UG/L
1,3-DICHLOROBENZENE	1.0	1.0 U	UG/L
1,4-DICHLOROBENZENE	1.0	1.0 U	UG/L
1,2-DICHLOROBENZENE	1.0	1.0 U	UG/L
DICHLORODIFLUOROMETHANE	1.0	1.0 U	UG/L
1,1-DICHLOROETHANE	1.0	1.0 U	UG/L
1,2-DICHLOROETHANE	1.0	1.0 U	UG/L
1,1-DICHLOROETHENE	1.0	1.0 U	UG/L
CIS-1,2-DICHLOROETHENE	1.0	1.0 U	UG/L
TRANS-1,2-DICHLOROETHENE	1.0	1.0 U	UG/L
1,2-DICHLOROPROPANE	1.0	1.0 U	UG/L
CIS-1,3-DICHLOROPROPENE	1.0	1.0 U	UG/L
TRANS-1,3-DICHLOROPROPENE	1.0	1.0 U	UG/L
ETHYLBENZENE	1.0	1.0 U	UG/L
2-HEXANONE	5.0	5.0 U	UG/L
ISOPROPYLBENZENE	1.0	1.0 U	UG/L
METHYL ACETATE	10	10 U	UG/L
METHYLCYCLOHEXANE	1.0	1.0 U	UG/L
METHYLENE CHLORIDE	1.0	1.0 U	UG/L
4-METHYL-2-PENTANONE (MIBK)	5.0	5.0 U	UG/L
STYRENE	1.0	1.0 U	UG/L
1,1,2,2-TETRACHLOROETHANE	1.0	1.0 U	UG/L
TETRACHLOROETHENE	1.0	3.2	UG/L
TOLUENE	1.0	1.0 U	UG/L
1,2,4-TRICHLOROBENZENE	1.0	1.0 U	UG/L
1,1,1-TRICHLOROETHANE	1.0	1.0 U	UG/L
1,1,2-TRICHLOROETHANE	1.0	1.0 U	UG/L
TRICHLOROETHENE	1.0	1.0 U	UG/L

COLUMBIA ANALYTICAL SERVICES

VOLATILE ORGANICS
METHOD 8260B
Reported: 12/05/08

Benchmark Environmental Eng.
Project Reference: SENECA MARKET PROJECT #0092-002-200
Client Sample ID : BLIND DUP

Date Sampled : 11/21/08 12:00 Order #: 1156882 Sample Matrix: WATER
Date Received: 11/21/08 Submission #: R2847383 Analytical Run 170924

ANALYTE	PQL	RESULT	UNITS
---------	-----	--------	-------

DATE ANALYZED : 12/03/08
ANALYTICAL DILUTION: 1.00

TRICHLOROFLUOROMETHANE	1.0	1.0 U	UG/L
1,1,2-TRICHLORO1,2,2-TRIFLUOROETHA	1.0	1.0 U	UG/L
VINYL CHLORIDE	1.0	1.0 U	UG/L
O-XYLENE	1.0	1.0 U	UG/L
M+P-XYLENE	1.0	1.0 U	UG/L

<u>SURROGATE RECOVERIES</u>	<u>QC LIMITS</u>		
4-BROMOFLUOROBENZENE	(80 - 123 %)	99	%
TOLUENE-D8	(88 - 124 %)	96	%
DIBROMOFLUOROMETHANE	(89 - 115 %)	102	%

COLUMBIA ANALYTICAL SERVICES

VOLATILE ORGANICS
 METHOD 8260B
 Reported: 12/05/08

Benchmark Environmental Eng.

Project Reference: SENECA MARKET PROJECT #0092-002-200

Client Sample ID : TRIP BLANK

Date Sampled : 11/21/08 Order #: 1156883 Sample Matrix: WATER
 Date Received: 11/21/08 Submission #: R2847383 Analytical Run 170924

ANALYTE	PQL	RESULT	UNITS
DATE ANALYZED	: 12/03/08		
ANALYTICAL DILUTION:	1.00		
ACETONE	10	10 U	UG/L
BENZENE	1.0	1.0 U	UG/L
BROMODICHLOROMETHANE	1.0	1.0 U	UG/L
BROMOFORM	1.0	1.0 U	UG/L
BROMOMETHANE	2.0	2.0 U	UG/L
2-BUTANONE (MEK)	5.0	5.0 U	UG/L
METHYL-TERT-BUTYL ETHER	1.0	1.0 U	UG/L
CARBON DISULFIDE	1.0	1.0 U	UG/L
CARBON TETRACHLORIDE	1.0	1.0 U	UG/L
CHLOROBENZENE	1.0	1.0 U	UG/L
CHLOROETHANE	2.0	2.0 U	UG/L
CHLOROFORM	1.0	1.0 U	UG/L
CHLOROMETHANE	2.0	2.0 U	UG/L
1,2-DIBROMO-3-CHLOROPROPANE	2.0	2.0 U	UG/L
CYCLOHEXANE	1.0	1.0 U	UG/L
DIBROMOCHLOROMETHANE	1.0	1.0 U	UG/L
1,2-DIBROMOETHANE	1.0	1.0 U	UG/L
1,3-DICHLOROBENZENE	1.0	1.0 U	UG/L
1,4-DICHLOROBENZENE	1.0	1.0 U	UG/L
1,2-DICHLOROBENZENE	1.0	1.0 U	UG/L
DICHLORODIFLUOROMETHANE	1.0	1.0 U	UG/L
1,1-DICHLOROETHANE	1.0	1.0 U	UG/L
1,2-DICHLOROETHANE	1.0	1.0 U	UG/L
1,1-DICHLOROETHENE	1.0	1.0 U	UG/L
CIS-1,2-DICHLOROETHENE	1.0	1.0 U	UG/L
TRANS-1,2-DICHLOROETHENE	1.0	1.0 U	UG/L
1,2-DICHLOROPROPANE	1.0	1.0 U	UG/L
CIS-1,3-DICHLOROPROPENE	1.0	1.0 U	UG/L
TRANS-1,3-DICHLOROPROPENE	1.0	1.0 U	UG/L
ETHYLBENZENE	1.0	1.0 U	UG/L
2-HEXANONE	5.0	5.0 U	UG/L
ISOPROPYLBENZENE	1.0	1.0 U	UG/L
METHYL ACETATE	10	10 U	UG/L
METHYLCYCLOHEXANE	1.0	1.0 U	UG/L
METHYLENE CHLORIDE	1.0	1.0 U	UG/L
4-METHYL-2-PENTANONE (MIBK)	5.0	5.0 U	UG/L
STYRENE	1.0	1.0 U	UG/L
1,1,2,2-TETRACHLOROETHANE	1.0	1.0 U	UG/L
TETRACHLOROETHENE	1.0	1.0 U	UG/L
TOLUENE	1.0	1.0 U	UG/L
1,2,4-TRICHLOROBENZENE	1.0	1.0 U	UG/L
1,1,1-TRICHLOROETHANE	1.0	1.0 U	UG/L
1,1,2-TRICHLOROETHANE	1.0	1.0 U	UG/L
TRICHLOROETHENE	1.0	1.0 U	UG/L

COLUMBIA ANALYTICAL SERVICES

VOLATILE ORGANICS
METHOD 8260B
Reported: 12/05/08

Benchmark Environmental Eng.
Project Reference: SENECA MARKET PROJECT #0092-002-200
Client Sample ID : TRIP BLANK

Date Sampled : 11/21/08 Order #: 1156883 Sample Matrix: WATER
Date Received: 11/21/08 Submission #: R2847383 Analytical Run 170924

ANALYTE	PQL	RESULT	UNITS
---------	-----	--------	-------

DATE ANALYZED : 12/03/08
ANALYTICAL DILUTION: 1.00

TRICHLOROFLUOROMETHANE	1.0	1.0 U	UG/L
1,1,2-TRICHLORO1,2,2-TRIFLUOROETHA	1.0	1.0 U	UG/L
VINYL CHLORIDE	1.0	1.0 U	UG/L
O-XYLENE	1.0	1.0 U	UG/L
M+P-XYLENE	1.0	1.0 U	UG/L

SURROGATE RECOVERIES

QC LIMITS

4-BROMOFLUOROBENZENE	(80 - 123 %)	99	%
TOLUENE-D8	(88 - 124 %)	95	%
DIBROMOFLUOROMETHANE	(89 - 115 %)	104	%

COLUMBIA ANALYTICAL SERVICES

VOLATILE ORGANICS
 METHOD 8260B
 Reported: 12/05/08

Benchmark Environmental Eng.

Project Reference: SENECA MARKET PROJECT #0092-002-200

Client Sample ID : 3SR

Date Sampled : 11/21/08 12:25 Order #: 1156888 Sample Matrix: WATER
 Date Received: 11/21/08 Submission #: R2847383 Analytical Run 170924

ANALYTE	PQL	RESULT	UNITS
DATE ANALYZED	: 12/03/08		
ANALYTICAL DILUTION:	1.00		
ACETONE	10	10 U	UG/L
BENZENE	1.0	1.0 U	UG/L
BROMODICHLOROMETHANE	1.0	1.0 U	UG/L
BROMOFORM	1.0	1.0 U	UG/L
BROMOMETHANE	2.0	2.0 U	UG/L
2-BUTANONE (MEK)	5.0	5.0 U	UG/L
METHYL-TERT-BUTYL ETHER	1.0	4.6	UG/L
CARBON DISULFIDE	1.0	1.0 U	UG/L
CARBON TETRACHLORIDE	1.0	1.0 U	UG/L
CHLOROBENZENE	1.0	1.0 U	UG/L
CHLOROETHANE	2.0	2.0 U	UG/L
CHLOROFORM	1.0	1.0 U	UG/L
CHLOROMETHANE	2.0	2.0 U	UG/L
1,2-DIBROMO-3-CHLOROPROPANE	2.0	2.0 U	UG/L
CYCLOHEXANE	1.0	1.0 U	UG/L
DIBROMOCHLOROMETHANE	1.0	1.0 U	UG/L
1,2-DIBROMOETHANE	1.0	1.0 U	UG/L
1,3-DICHLOROBENZENE	1.0	1.0 U	UG/L
1,4-DICHLOROBENZENE	1.0	1.0 U	UG/L
1,2-DICHLOROBENZENE	1.0	1.0 U	UG/L
DICHLORODIFLUOROMETHANE	1.0	1.0 U	UG/L
1,1-DICHLOROETHANE	1.0	1.0 U	UG/L
1,2-DICHLOROETHANE	1.0	1.0 U	UG/L
1,1-DICHLOROETHENE	1.0	1.0 U	UG/L
CIS-1,2-DICHLOROETHENE	1.0	13	UG/L
TRANS-1,2-DICHLOROETHENE	1.0	0.24 J	UG/L
1,2-DICHLOROPROPANE	1.0	1.0 U	UG/L
CIS-1,3-DICHLOROPROPENE	1.0	1.0 U	UG/L
TRANS-1,3-DICHLOROPROPENE	1.0	1.0 U	UG/L
ETHYLBENZENE	1.0	1.0 U	UG/L
2-HEXANONE	5.0	5.0 U	UG/L
ISOPROPYLBENZENE	1.0	1.0 U	UG/L
METHYL ACETATE	10	10 U	UG/L
METHYLCYCLOHEXANE	1.0	1.0 U	UG/L
METHYLENE CHLORIDE	1.0	1.0 U	UG/L
4-METHYL-2-PENTANONE (MIBK)	5.0	5.0 U	UG/L
STYRENE	1.0	1.0 U	UG/L
1,1,2,2-TETRACHLOROETHANE	1.0	1.0 U	UG/L
TETRACHLOROETHENE	1.0	24	UG/L
TOLUENE	1.0	1.0 U	UG/L
1,2,4-TRICHLOROBENZENE	1.0	1.0 U	UG/L
1,1,1-TRICHLOROETHANE	1.0	1.0 U	UG/L
1,1,2-TRICHLOROETHANE	1.0	1.0 U	UG/L
TRICHLOROETHENE	1.0	7.7	UG/L

COLUMBIA ANALYTICAL SERVICES

VOLATILE ORGANICS
METHOD 8260B
Reported: 12/05/08

Benchmark Environmental Eng.

Project Reference: SENECA MARKET PROJECT #0092-002-200

Client Sample ID : 3SR

Date Sampled : 11/21/08 12:25 Order #: 1156888 Sample Matrix: WATER
Date Received: 11/21/08 Submission #: R2847383 Analytical Run 170924

ANALYTE	PQL	RESULT	UNITS
DATE ANALYZED		: 12/03/08	
ANALYTICAL DILUTION:		1.00	
TRICHLOROFLUOROMETHANE	1.0	1.0 U	UG/L
1,1,2-TRICHLORO1,2,2-TRIFLUOROETHA	1.0	1.0 U	UG/L
VINYL CHLORIDE	1.0	2.6	UG/L
O-XYLENE	1.0	1.0 U	UG/L
M+P-XYLENE	1.0	1.0 U	UG/L

<u>SURROGATE RECOVERIES</u>	<u>QC LIMITS</u>		
4-BROMOFLUOROBENZENE	(80 - 123 %)	99	%
TOLUENE-D8	(88 - 124 %)	95	%
DIBROMOFLUOROMETHANE	(89 - 115 %)	103	%

COLUMBIA ANALYTICAL SERVICES, INC.

RESULTS OF ANALYSIS

Page 1 of 1

Client: CAS/Rochester
Client Project ID: Seneca Market

CAS Project ID: P0803959

Carbon Dioxide

Test Code: RSK 175
Instrument ID: HP5890A/GC10/TCD
Analyst: Wade Henton/Chris Cornett
Matrix: Water
Test Notes:

Date(s) Collected: 11/21/08
Date Received: 11/25/08
Date Analyzed: 11/25/08

Client Sample ID	CAS Sample ID	Injection Volume ml(s)	Result µg/L	MRL µg/L	Data Qualifier
35R	P0803959-001	0.10	66,000	1,000	
Method Control Sample	P081125-MB	0.10	ND	1,000	

ND = Compound was analyzed for, but not detected above the laboratory reporting limit.

MRL = Method Reporting Limit - The minimum quantity of a target analyte that can be confidently determined by the referenced method.

Verified By: _____ Date: _____

COLUMBIA ANALYTICAL SERVICES

Reported: 12/02/08

Benchmark Environmental Eng.
Project Reference: SENECA MARKET PROJECT #0092-002-200
Client Sample ID : 3SR

Date Sampled : 11/21/08 12:25 Order #: 1156888 Sample Matrix: WATER
Date Received: 11/21/08 Submission #: R2847383

ANALYTE	METHOD	PQL	RESULT	UNITS	DATE ANALYZED	TIME ANALYZED	DILUTION
<u>WET CHEMISTRY</u>							
CHLORIDE	9056	0.200	454	MG/L	11/24/08	16:49	100.0
NITRATE NITROGEN	9056	0.0500	0.500 U	MG/L	11/21/08	17:17	10.0
SULFATE	9056	0.200	18.3	MG/L	11/21/08	17:17	10.0
TOTAL ALKALINITY	310.1	2.00	334	MG/L	12/01/08	14:15	1.0
TOTAL ORGANIC CARBON	415.1	1.00	4.26	MG/L	11/24/08	19:34	1.0
TOTAL SULFIDE	376.1	1.00	1.00 U	MG/L	11/26/08	11:30	1.0

COLUMBIA ANALYTICAL SERVICES

VOLATILE ORGANICS
METHOD RSK-175 MODIFIED
Reported: 12/02/08

Benchmark Environmental Eng.
Project Reference: SENECA MARKET PROJECT #0092-002-200
Client Sample ID : 3SR

Date Sampled : 11/21/08 12:25 Order #: 1156888 Sample Matrix: WATER
Date Received: 11/21/08 Submission #: R2847383 Analytical Run 170564

ANALYTE	PQL	RESULT	UNITS
---------	-----	--------	-------

DATE ANALYZED : 11/25/08
ANALYTICAL DILUTION: 1.00

ETHANE	1.0	1.0 U	UG/L
ETHYLENE	1.0	0.82 J	UG/L
METHANE	2.0	51	UG/L

COLUMBIA ANALYTICAL SERVICES

Reported: 12/02/08

Benchmark Environmental Eng.
Project Reference: SENECA MARKET PROJECT #0092-002-200
Client Sample ID : 3SR DISSOLVED

Date Sampled : 11/21/08 12:25 Order #: 1156889 Sample Matrix: WATER
Date Received: 11/21/08 Submission #: R2847383

ANALYTE	METHOD	PQL	RESULT	UNITS	DATE ANALYZED	DILUTION
<u>METALS</u>						
IRON	6010B	0.100	0.100 U	MG/L	12/01/08	1.0
MANGANESE	6010B	0.0100	4.94	MG/L	12/01/08	1.0

COLUMBIA ANALYTICAL SERVICES

EXTRACTABLE ORGANICS
METHOD HPLC-METABOLIC ACIDS
Reported: 12/03/08

Benchmark Environmental Eng.
Project Reference: SENECA MARKET PROJECT #0092-002-200
Client Sample ID : 3SR

Date Sampled : 11/21/08 12:25 Order #: 1156888 Sample Matrix: WATER
Date Received: 11/21/08 Submission #: R2847383 Analytical Run 170821

ANALYTE	PQL	RESULT	UNITS
---------	-----	--------	-------

DATE ANALYZED : 12/03/08
ANALYTICAL DILUTION: 1.00

ACETIC ACID	1.0	1.0 U	MG/L
BUTYRIC ACID	2.0	2.0 U	MG/L
LACTIC ACID	1.0	1.0 U	MG/L
PROPIONIC ACID	1.0	1.0 U	MG/L
PYRUVIC ACID	0.50	0.50 U	MG/L
