

**ENVIRONMENTAL EASEMENT GRANTED PURSUANT TO ARTICLE 71, TITLE 36
OF THE NEW YORK STATE ENVIRONMENTAL CONSERVATION LAW**

THIS INDENTURE made this 9th day of November, 2013 between Owner, ExxonMobil Oil Corporation, having an office at 22777 Springwoods Village Parkway, Spring, Texas 77389, County of Harris, State of Texas (the "Grantor"), and The People of the State of New York (the "Grantee"), acting through their Commissioner of the Department of Environmental Conservation (the "Commissioner", or "NYSDEC" or "Department" as the context requires) with its headquarters located at 625 Broadway, Albany, New York 12233,

WHEREAS, the Legislature of the State of New York has declared that it is in the public interest to encourage the remediation of abandoned and likely contaminated properties ("sites") that threaten the health and vitality of the communities they burden while at the same time ensuring the protection of public health and the environment; and

WHEREAS, the Legislature of the State of New York has declared that it is in the public interest to establish within the Department a statutory environmental remediation program that includes the use of Environmental Easements as an enforceable means of ensuring the performance of operation, maintenance, and/or monitoring requirements and the restriction of future uses of the land, when an environmental remediation project leaves residual contamination at levels that have been determined to be safe for a specific use, but not all uses, or which includes engineered structures that must be maintained or protected against damage to perform properly and be effective, or which requires groundwater use or soil management restrictions; and

WHEREAS, the Legislature of the State of New York has declared that Environmental Easement shall mean an interest in real property, created under and subject to the provisions of Article 71, Title 36 of the New York State Environmental Conservation Law ("ECL") which contains a use restriction and/or a prohibition on the use of land in a manner inconsistent with engineering controls which are intended to ensure the long term effectiveness of a site remedial program or eliminate potential exposure pathways to hazardous waste or petroleum; and

WHEREAS, Grantor, is the owner of real property located at the address of 542 Elk Street in the City of Buffalo, County of Erie and State of New York, known and designated on the tax map of the County Clerk of Erie as tax map parcel numbers: Section 123.09 Block 1 Lot 27.1, being the same as that property conveyed to Grantor by the following deeds:

- 1) Deed dated April 19, 1957 and recorded in the Erie County Clerk's Office in Liber and Page 6179/148.
- 2) Deed dated May 8, 1963 and recorded in the Erie County Clerk's Office in Liber and Page 6883/206.
- 3) Deed dated June 18, 1963 and recorded in the Erie County Clerk's Office in Liber and Page 6901/367.
- 4) Deed dated October 25, 1963 and recorded in the Erie County Clerk's Office in Liber and Page 6944/55.

- 5) Deed dated October 25, 1963 and recorded in the Erie County Clerk's Office in Liber and Page 6944/117.
- 6) Deed dated June 14, 1972 and recorded in the Erie County Clerk's Office in Liber and Page 7925/481.
- 7) Deed dated July 1, 1974 and recorded in the Erie County Clerk's Office in Liber and Page 8182/245.
- 8) Deed dated February 19, 1975 and recorded in the Erie County Clerk's Office in Liber and Page 8256/37.
- 9) Deed dated July 13, 1976 and recorded in the Erie County Clerk's Office in Liber and Page 8412/297.
- 10) Deed dated July 14, 1976 and recorded in the Erie County Clerk's Office in Liber and Page 8413/537.
- 11) Deed dated August 3, 1976 and recorded in the Erie County Clerk's Office in Liber and Page 8419/191.
- 12) Deed dated May 17, 1977 and recorded in the Erie County Clerk's Office in Liber and Page 8509/515.

WHEREAS, the property subject to this Environmental Easement (the "Controlled Property") comprises approximately 1.480 +/- acres, and is hereinafter more fully described in the Land Title Survey dated May 25, 2017 prepared by William J. Tucker II, L.L.S. of Clear Creek Land Surveying, LLC, which will be attached to the Site Management Plan. The Controlled Property description is set forth in and attached hereto as Schedule A; and

WHEREAS, Grantor, is the owner of real property located at the address of 522 Elk Street in the City of Buffalo, County of Erie and State of New York, known and designated on the tax map of the County Clerk of Erie as tax map parcel numbers: Section 123.09 Block 1 Lot 10.1, being the same as that property conveyed to Grantor by the following deeds:

- 1) Deed dated July 23, 1976 and recorded in the Erie County Clerk's Office in Liber and Page 8414/397.
- 2) Deed dated September 22, 1976 and recorded in the Erie County Clerk's Office in Liber and Page 8436/201.

WHEREAS, the property subject to this Environmental Easement (the "Controlled Property") comprises approximately 0.280 +/- acres, and is hereinafter more fully described in the Land Title Survey dated May 25, 2017 prepared by William J. Tucker II, L.L.S. of Clear Creek Land Surveying, LLC, which will be attached to the Site Management Plan. The Controlled Property description is set forth in and attached hereto as Schedule B; and

WHEREAS, the Department accepts this Environmental Easement in order to ensure the protection of public health and the environment and to achieve the requirements for remediation established for the Controlled Property until such time as this Environmental Easement is extinguished pursuant to ECL Article 71, Title 36; and

NOW THEREFORE, in consideration of the mutual covenants contained herein and the terms and conditions of Brownfield Cleanup Agreement Index Number: B9-0706-05-10 as amended September 12, 2017, Grantor conveys to Grantee a permanent Environmental Easement

pursuant to ECL Article 71, Title 36 in, on, over, under, and upon the Controlled Property as more fully described herein ("Environmental Easement").

1. Purposes. Grantor and Grantee acknowledge that the Purposes of this Environmental Easement are: to convey to Grantee real property rights and interests that will run with the land in perpetuity in order to provide an effective and enforceable means of encouraging the reuse and redevelopment of this Controlled Property at a level that has been determined to be safe for a specific use while ensuring the performance of operation, maintenance, and/or monitoring requirements; and to ensure the restriction of future uses of the land that are inconsistent with the above-stated purpose.

2. Institutional and Engineering Controls. The controls and requirements listed in the Department approved Site Management Plan ("SMP") including any and all Department approved amendments to the SMP are incorporated into and made part of this Environmental Easement. These controls and requirements apply to the use of the Controlled Property, run with the land, are binding on the Grantor and the Grantor's successors and assigns, and are enforceable in law or equity against any owner of the Controlled Property, any lessees and any person using the Controlled Property.

A. (1) The Controlled Property may be used for:

Commercial as described in 6 NYCRR Part 375-1.8(g)(2)(iii) and Industrial as described in 6 NYCRR Part 375-1.8(g)(2)(iv)

(2) All Engineering Controls must be operated and maintained as specified in the Site Management Plan (SMP);

(3) All Engineering Controls must be inspected at a frequency and in a manner defined in the SMP;

(4) The use of groundwater underlying the property is prohibited without necessary water quality treatment as determined by the NYSDOH or the Erie County Department of Health to render it safe for use as drinking water or for industrial purposes, and the user must first notify and obtain written approval to do so from the Department;

(5) Groundwater and other environmental or public health monitoring must be performed as defined in the SMP;

(6) Data and information pertinent to Site Management of the Controlled Property must be reported at the frequency and in a manner defined in the SMP;

(7) All future activities on the property that will disturb remaining contaminated material must be conducted in accordance with the SMP;

(8) Monitoring to assess the performance and effectiveness of the remedy must be performed as defined in the SMP;

(9) Operation, maintenance, monitoring, inspection, and reporting of any mechanical or physical components of the remedy shall be performed as defined in the SMP;

(10) Access to the site must be provided to agents, employees or other representatives of the State of New York with reasonable prior notice to the property owner to assure compliance with the restrictions identified by this Environmental Easement.

B. The Controlled Property shall not be used for Residential or Restricted Residential purposes as defined in 6NYCRR 375-1.8(g)(2)(i) and (ii), and the above-stated engineering controls may not be discontinued without an amendment or extinguishment of this Environmental Easement.

C. The SMP describes obligations that the Grantor assumes on behalf of Grantor, its successors and assigns. The Grantor's assumption of the obligations contained in the SMP which may include sampling, monitoring, and/or operating a treatment system, and providing certified reports to the NYSDEC, is and remains a fundamental element of the Department's determination that the Controlled Property is safe for a specific use, but not all uses. The SMP may be modified in accordance with the Department's statutory and regulatory authority. The Grantor and all successors and assigns, assume the burden of complying with the SMP and obtaining an up-to-date version of the SMP from:

Site Control Section
Division of Environmental Remediation
NYSDEC
625 Broadway
Albany, New York 12233
Phone: (518) 402-9553

D. Grantor must provide all persons who acquire any interest in the Controlled Property a true and complete copy of the SMP that the Department approves for the Controlled Property and all Department-approved amendments to that SMP.

E. Grantor covenants and agrees that until such time as the Environmental Easement is extinguished in accordance with the requirements of ECL Article 71, Title 36 of the ECL, the property deed and all subsequent instruments of conveyance relating to the Controlled Property shall state in at least fifteen-point bold-faced type:

This property is subject to an Environmental Easement held by the New York State Department of Environmental Conservation pursuant to Title 36 of Article 71 of the Environmental Conservation Law.

F. Grantor covenants and agrees that this Environmental Easement shall be incorporated in full or by reference in any leases, licenses, or other instruments granting a right to use the Controlled Property.

G. Grantor covenants and agrees that it shall, at such time as NYSDEC may require, submit to NYSDEC a written statement by an expert the NYSDEC may find acceptable certifying under penalty of perjury, in such form and manner as the Department may require, that:

(1) the inspection of the site to confirm the effectiveness of the institutional and engineering controls required by the remedial program was performed under the direction of the individual set forth at 6 NYCRR Part 375-1.8(h)(3).

(2) the institutional controls and/or engineering controls employed at such site:
(i) are in-place;
(ii) are unchanged from the previous certification, or that any identified changes to the controls employed were approved by the NYSDEC and that all controls are in the Department-approved format; and

(iii) that nothing has occurred that would impair the ability of such control to protect the public health and environment;

(3) the owner will continue to allow access to such real property to evaluate the continued maintenance of such controls;

(4) nothing has occurred that would constitute a violation or failure to comply with any site management plan for such controls;

(5) the report and all attachments were prepared under the direction of, and reviewed by, the party making the certification;

(6) to the best of his/her knowledge and belief, the work and conclusions described in this certification are in accordance with the requirements of the site remedial program, and generally accepted engineering practices; and

(7) the information presented is accurate and complete.

3. Right to Enter and Inspect. Grantee, its agents, employees, or other representatives of the State may enter and inspect the Controlled Property in a reasonable manner and at reasonable times to assure compliance with the above-stated restrictions.

4. Reserved Grantor's Rights. Grantor reserves for itself, its assigns, representatives, and successors in interest with respect to the Property, all rights as fee owner of the Property, including:

A. Use of the Controlled Property for all purposes not inconsistent with, or limited by the terms of this Environmental Easement;

B. The right to give, sell, assign, or otherwise transfer part or all of the underlying fee interest to the Controlled Property, subject and subordinate to this Environmental Easement;

5. Enforcement

A. This Environmental Easement is enforceable in law or equity in perpetuity by Grantor, Grantee, or any affected local government, as defined in ECL Section 71-3603, against the owner of the Property, any lessees, and any person using the land. Enforcement shall not be defeated because of any subsequent adverse possession, laches, estoppel, or waiver. It is not a

defense in any action to enforce this Environmental Easement that: it is not appurtenant to an interest in real property; it is not of a character that has been recognized traditionally at common law; it imposes a negative burden; it imposes affirmative obligations upon the owner of any interest in the burdened property; the benefit does not touch or concern real property; there is no privity of estate or of contract; or it imposes an unreasonable restraint on alienation.

B. If any person violates this Environmental Easement, the Grantee may revoke the Certificate of Completion with respect to the Controlled Property.

C. Grantee shall notify Grantor of a breach or suspected breach of any of the terms of this Environmental Easement. Such notice shall set forth how Grantor can cure such breach or suspected breach and give Grantor a reasonable amount of time from the date of receipt of notice in which to cure. At the expiration of such period of time to cure, or any extensions granted by Grantee, the Grantee shall notify Grantor of any failure to adequately cure the breach or suspected breach, and Grantee may take any other appropriate action reasonably necessary to remedy any breach of this Environmental Easement, including the commencement of any proceedings in accordance with applicable law.

D. The failure of Grantee to enforce any of the terms contained herein shall not be deemed a waiver of any such term nor bar any enforcement rights.

6. Notice. Whenever notice to the Grantee (other than the annual certification) or approval from the Grantee is required, the Party providing such notice or seeking such approval shall identify the Controlled Property by referencing the following information:

County, NYSDEC Site Number, NYSDEC Brownfield Cleanup Agreement, State Assistance Contract or Order Number, and the County tax map number or the Liber and Page or computerized system identification number.

Parties shall address correspondence to: Site Number: C915201
Office of General Counsel
NYSDEC
625 Broadway
Albany New York 12233-5500

With a copy to: Site Control Section
Division of Environmental Remediation
NYSDEC
625 Broadway
Albany, NY 12233

All notices and correspondence shall be delivered by hand, by registered mail or by Certified mail and return receipt requested. The Parties may provide for other means of receiving and communicating notices and responses to requests for approval.

7. Recordation. Grantor shall record this instrument, within thirty (30) days of execution of this instrument by the Commissioner or her/his authorized representative in the office of the recording officer for the county or counties where the Property is situated in the manner prescribed

by Article 9 of the Real Property Law.

8. Amendment. Any amendment to this Environmental Easement may only be executed by the Commissioner of the New York State Department of Environmental Conservation or the Commissioner's Designee, and filed with the office of the recording officer for the county or counties where the Property is situated in the manner prescribed by Article 9 of the Real Property Law.

9. Extinguishment. This Environmental Easement may be extinguished only by a release by the Commissioner of the New York State Department of Environmental Conservation, or the Commissioner's Designee, and filed with the office of the recording officer for the county or counties where the Property is situated in the manner prescribed by Article 9 of the Real Property Law.

10. Joint Obligation. If there are two or more parties identified as Grantor herein, the obligations imposed by this instrument upon them shall be joint and several.

Remainder of Page Intentionally Left Blank

IN WITNESS WHEREOF, Grantor has caused this instrument to be signed in its name.

ExxonMobil Oil Corporation:

By: Robert W. Jackmore

Print Name: Robert W. Jackmore

Title: Agent and Attorney in Fact Date: 10/26/2017

Grantor's Acknowledgment

STATE OF NEW YORK)
) ss:
COUNTY OF)

On the 26th day of October, in the year 20 17, before me, the undersigned, personally appeared Robert Jackmore personally known to me or proved to me on the basis of satisfactory evidence to be the individual(s) whose name is (are) subscribed to the within instrument and acknowledged to me that he/she/they executed the same in his/her/their capacity(ies), and that by his/her/their signature(s) on the instrument, the individual(s), or the person upon behalf of which the individual(s) acted, executed the instrument.

Colette Ann Gorcica
Notary Public - State of New York

COLETTE ANN GORCICA
NOTARY PUBLIC-STATE OF NEW YORK
No. 01GO6032325
Qualified in Erie County
Commission Expires October 25, 2021

THIS ENVIRONMENTAL EASEMENT IS HEREBY ACCEPTED BY THE PEOPLE OF THE STATE OF NEW YORK, Acting By and Through the Department of Environmental Conservation as Designee of the Commissioner,

By: 
Robert W. Schick, Director
Division of Environmental Remediation

Grantee's Acknowledgment

STATE OF NEW YORK)
) ss:
COUNTY OF ALBANY)

On the 9th day of November in the year 2017 before me, the undersigned, personally appeared Robert W. Schick, personally known to me or proved to me on the basis of satisfactory evidence to be the individual(s) whose name is (are) subscribed to the within instrument and acknowledged to me that he/she/ executed the same in his/her/ capacity as Designee of the Commissioner of the State of New York Department of Environmental Conservation, and that by his/her/ signature on the instrument, the individual, or the person upon behalf of which the individual acted, executed the instrument.

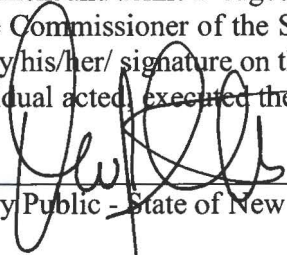

Notary Public - State of New York

David J. Chiusano
Notary Public, State of New York
No. 01CH5032146
Qualified in Schenectady County
Commission Expires August 22, 2018

SCHEDULE "A" PROPERTY DESCRIPTION

ENVIRONMENTAL EASEMENT DESCRIPTION FOR 542 ELK STREET

ALL THAT TRACT OR PARCEL OF LAND, SITUATE IN THE CITY OF BUFFALO, COUNTY OF ERIE AND STATE OF NEW YORK, BEING PART OF LOT NO. 75 TOWNSHIP 10 RANGE 8 OF THE BUFFALO CREEK RESERVATION, DESCRIBED AS FOLLOWS:

BEGINNING ON THE NORTHERLY LINE OF ELK STREET AND THE EASTERLY LINE OF WINONA STREET;

THENCE, NORTHERLY ON THE EASTERLY LINE OF WINONA STREET NORTH 13°56'42" EAST, A DISTANCE OF 295.00 FEET TO A POINT;

THENCE, PARALLEL TO THE NORTHERLY LINE OF ELK STREET SOUTH 76°03'18" EAST, A DISTANCE OF 104.00 FEET TO A POINT;

THENCE, NORTHERLY PARALLEL TO THE EASTERLY LINE OF WINONA STREET NORTH 13°56'42" EAST, A DISTANCE OF 30.00 FEET TO A POINT;

THENCE, EASTERLY ALONG A LINE PARALLEL TO THE NORTH LINE OF ELK STREET SOUTH 76°03'18" EAST, A DISTANCE OF 104.00 FEET TO A POINT ON THE WEST LINE OF BRADFORD STREET;

THENCE, SOUTHERLY ON THE WESTERLY LINE OF BRADFORD STREET SOUTH 13°56'42" WEST, A DISTANCE OF 325.00 FEET TO THE POINT OF INTERSECTION OF THE WEST LINE OF BRADFORD STREET WITH THE NORTH LINE OF ELK STREET;

THENCE, WESTERLY ALONG THE NORTHERLY LINE OF ELK STREET NORTH 76°03'18" WEST, A DISTANCE OF 208.00 FEET TO A POINT, THE POINT-OF-BEGINNING.

BEING 1.480 ACRES MORE OR LESS.

SCHEDULE "B" PROPERTY DESCRIPTION

ENVIRONMENTAL EASEMENT DESCRIPTION FOR 522 ELK STREET

ALL THAT TRACT OR PARCEL OF LAND, SITUATE IN THE CITY OF BUFFALO, COUNTY OF ERIE AND STATE OF NEW YORK, BEING PART OF LOTS NO. 75 AND 76 TOWNSHIP 10 RANGE 8 OF THE BUFFALO CREEK RESERVATION, DESCRIBED AS FOLLOWS:

BEGINNING ON THE NORTHERLY LINE OF ELK STREET AND THE WESTERLY LINE OF WINONA STREET;

THENCE, ALONG THE NORTHERLY LINE OF ELK STREET NORTH 76°03'18" WEST, A DISTANCE OF 106.00 FEET TO A POINT;

THENCE, PARALLEL TO THE WESTERLY LINE OF WINONA STREET NORTH 13°56'42" EAST, A DISTANCE OF 115.00 FEET TO A POINT;

THENCE, PARALLEL TO THE NORTHERLY LINE OF ELK STREET SOUTH 76°03'18" EAST, A DISTANCE OF 106.00 FEET TO A POINT;

THENCE, SOUTHERLY ALONG THE WESTERLY LINE OF WINONA STREET SOUTH 13°56'42" WEST, A DISTANCE OF 115.00 FEET TO A POINT, THE POINT-OF-BEGINNING.

BEING 0.280 ACRES MORE OR LESS

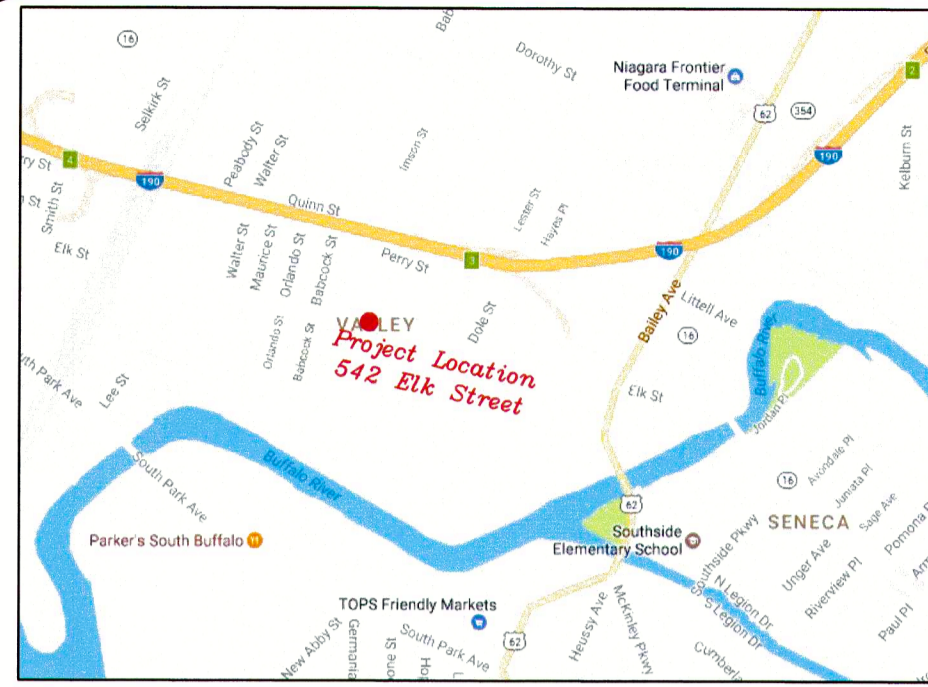

"This property is subject to an environmental easement held by the New York State Department of Environmental Conservation pursuant to Title 36 of Article 71 of the New York Environmental Conservation Law. The engineering and institutional controls for this Easement are set forth in the Site Management Plan (SMP). A copy of the SMP must be obtained by any party with an interest in the property. The SMP can be obtained from NYS Department of Environmental Conservation, Division of Environmental Remediation, Site Control Section, 625 Broadway, Albany, NY 12233 or at "derweb@dec.ny.gov."

RECORD LEGAL DESCRIPTION FOR 542 ELK STREET

Parcel III (For information Only: Section 123.9 Block 1 Lot 27.1):

Parcel A:
ALL THAT TRACT OR PARCEL OF LAND, situate in the City of Buffalo, County of Erie and State of New York, being part of Lot No. 75 Township 10, Range 8 of the Buffalo Creek Reservation, described as follows:
BEGINNING at the intersection of the Northerly line of Elk Street with the Westerly line of Bradford Street; Running THENCE, Northerly along said Westerly line of Bradford Street 115 feet; THENCE, Westerly and parallel with said Northerly line of Elk Street 84 feet; THENCE, Southerly parallel with said Westerly line of Bradford Street 115 feet, to the Northerly line of Elk Street; THENCE, Easterly along said Northerly line of Elk Street 84 feet, to the Place of Beginning.

Parcel B:
ALL THAT CERTAIN PLOT, PIECE OR PARCEL OF LAND, situate, lying and being in the City of Buffalo, County of Erie and State of New York, being part of Lot No. 75 Township 10, Range 8 of the Buffalo Creek Reservation, bounded and described as follows:
BEGINNING at a point in the Northerly line of Elk Street 84 feet Westerly from the intersection of the Northerly line of Elk Street with the Westerly line of Bradford Street; Running THENCE, Westerly along the Northerly line of Elk Street 29 feet; THENCE, Northerly parallel with Bradford Street 115 feet; THENCE, Easterly parallel with Elk Street 29 feet; THENCE, Southerly parallel with Bradford Street 115 feet, to the Place of Beginning.

Parcel C:
ALL THAT CERTAIN PLOT, PIECE OR PARCEL OF LAND, situate, lying and being in the City of Buffalo, County of Erie and State of New York, being part of Lot No. 75 Township 10, Range 8 of the Buffalo Creek Reservation, bounded and described as follows:
BEGINNING at a point in the Northerly line of Elk Street at a distance of 66 feet Easterly of the Easterly line of Winona Street and at the Southeastery corner of land now or formerly owned by E.H. Butler; Running THENCE, Easterly along Elk Street 29 feet; THENCE, Northerly parallel with Winona Street 115 feet; THENCE, Westerly parallel with Elk Street 29 feet; THENCE, Southerly along said Butler's land 115 feet, to the Place of Beginning.

Parcel D:
ALL THAT CERTAIN PLOT, PIECE OR PARCEL OF LAND, situate, lying and being in the City of Buffalo, County of Erie and State of New York, being part of Lot No. 75 Township 10, Range 8 of the Buffalo Creek Reservation, bounded and described as follows:
BEGINNING at a point in the Northerly line of Elk Street at the distance of 26 feet Easterly of the Easterly line of Winona Street and at the Southeastery corner of land now or formerly, owned by Ellen E. Mcauliffe; Running THENCE, Easterly along Elk Street 40 feet; THENCE, Northerly parallel with Winona Street 115 feet; THENCE, Westerly parallel with Elk Street 40 feet to the Easterly line of said Mcauliffe's land; THENCE, Southerly along said Mcauliffe's land 115 feet, to the Point of Beginning.

Parcel E:
ALL THAT TRACT OR PARCEL OF LAND, situate in the City of Buffalo, County of Erie and State of New York, being part of Lot No. 75 Township 10, Range 8 of the Buffalo Creek Reservation, bounded and described as follows:
BEGINNING at a point in the Northerly line of Elk Street 529 feet Easterly of the Easterly line of Babcock Street; Proceeding THENCE, Northerly parallel with Babcock Street 115 feet; THENCE, Easterly parallel with Elk Street 26 feet; THENCE, Southerly parallel with Babcock Street 115 feet, to the Northerly line of Elk Street; THENCE, Westerly along said line of Elk Street 26 feet, to the Point of Place of Beginning.

Parcel F:
ALL THAT CERTAIN PLOT, PIECE OR PARCEL OF LAND, situate, lying and being in the City of Buffalo, County of Erie and State of New York, being part of Lot No. 75 Township 10, Range 8 of the Buffalo Creek Reservation, bounded and described as follows:
BEGINNING at a point in the Westerly line of Bradford Street distant 115 feet North of the intersection of said Westerly line with the Northerly line of Elk Street; Running THENCE, Northerly along the Westerly line of Bradford Street 210 feet, to a point; THENCE, Westerly along a line parallel with the Northerly line of Elk Street 104 feet, to a point; THENCE, Southerly along a line parallel with the Westerly line of Bradford Street 180 feet, to a point; THENCE, Westerly along a line parallel with the Northerly line of Elk Street 104 feet, to a point in the Easterly line of Winona Street; THENCE, Southerly along the Easterly line of Winona Street 30 feet, to a point; THENCE, Easterly along a line parallel with the Northerly line of Elk Street 208 feet, to the Point of Beginning.

Parcel G:
ALL THAT CERTAIN PLOT, PIECE OR PARCEL OF LAND, situate, lying and being in the City of Buffalo, County of Erie and State of New York, being part of Lot No. 75 Township 10 Range 8 of the Buffalo Creek Reservation, bounded and described as follows:
BEGINNING at a point in the Easterly line of Winona Street at a distance of 145 feet, Northerly of the Northerly line of Elk Street; Running THENCE, Easterly parallel with Elk Street 104 feet; THENCE, Northerly parallel with Winona Street 30 feet; THENCE, Westerly parallel with Elk Street 104 feet, to the said line of Winona Street; THENCE, Southerly along the Easterly line of Winona Street 30 feet, to the Point of Beginning.

Parcel H:
ALL THAT TRACT OR PARCEL OF LAND, situate in the City of Buffalo, County of Erie and State of New York, being part of Lot No. 75 Township 10 Range 8 of the Buffalo Creek Reservation, bounded and described as follows:
BEGINNING at a point in the Easterly line of Winona Street a distance of 175 feet Northerly from the point of intersection of the Northerly line of Elk Street with the Easterly line of Winona Street; Running THENCE, Easterly parallel with Elk Street 104 feet; THENCE, Northerly parallel with Winona Street 30 feet; THENCE, Westerly parallel with Elk Street 104 feet, to the said line of Winona Street; THENCE, Southerly along the Easterly line of Winona Street 30 feet, to the Point of Beginning.

Parcel I:
ALL THAT CERTAIN PLOT, PIECE OR PARCEL OF LAND, situate, lying, and being in the City of Buffalo, County of Erie and State of New York, being part of Lot No. 75 Township 10 Range 8 of the Buffalo Creek Reservation, further described as follows:
BEGINNING at a point in the Easterly line of Winona Street at a distance of 205 feet Northerly of the point of intersection of the Northerly line of Elk Street with the Easterly line of Winona Street; Running THENCE, Easterly parallel with Elk Street 104 feet; THENCE, Northerly parallel with Winona Street 30 feet; THENCE, Westerly parallel with Elk Street 104 feet, to Winona Street; THENCE, Southerly along Winona Street 30 feet, to the Place of Beginning.

Parcel J:
ALL THAT TRACT OR PARCEL OF LAND, situate in the City of Buffalo, County of Erie and State of New York, being part of Lot No. 75 Township 10 Range 8 of the Buffalo Creek Reservation, bounded and described as follows:
BEGINNING at a point in the Easterly line of Winona Street a distance of 235 feet Northerly of the point of intersection of the Northerly line of Elk Street with the Easterly line of Winona Street; Running THENCE, Easterly parallel with Elk Street 104 feet; THENCE, Northerly parallel with Winona Street 30 feet; THENCE, Westerly parallel with Elk Street 104 feet, to Winona Street; THENCE, Southerly along Winona Street 30 feet, to the Place of Beginning.

Parcel K:
ALL THAT TRACT OR PARCEL OF LAND, situate in the City of Buffalo, County of Erie and State of New York, being part of Lot No. 75 Township 10 Range 8 of the Buffalo Creek Reservation, bounded and described as follows:
COMMENCING on the Easterly line of Winona Street at the distance of 265 feet Northerly of the point of intersection of the Northerly line of Elk Street with the Easterly line of Winona Street; Running THENCE, Easterly parallel with Elk Street 104 feet; THENCE, Northerly parallel with Winona Street 30 feet; THENCE, Westerly parallel with Elk Street 104 feet, to the East line of Winona Street; THENCE, Southerly along Winona Street 30 feet, to the Point of Beginning.

**ENVIRONMENTAL EASEMENT DESCRIPTION FOR 542 ELK STREET
BASED ON RECORD LEGAL DESCRIPTION**

ALL THAT TRACT OR PARCEL OF LAND, situate in the City of Buffalo, County of Erie and State of New York, being part of Lot No. 75 Township 10 Range 8 of the Buffalo Creek Reservation, described as follows:
BEGINNING on the Northerly line of Elk Street and the Easterly line of Winona Street; THENCE, Northerly on the Easterly line of Winona Street North 13°58'42" East, a distance of 295.00 feet to a point; THENCE, parallel to the Northerly line of Elk Street South 76°03'18" East, a distance of 104.00 feet to a point; THENCE, Northerly parallel to the Easterly line of Winona Street North 13°58'42" East, a distance of 30.00 feet to a point; THENCE, Easterly along a line parallel to the North line of Elk Street South 76°03'18" East, a distance of 104.00 feet to a point on the West line of Bradford Street; THENCE, Southerly on the Westerly line of Bradford Street South 13°56'42" West, a distance of 325.00 feet to the point of intersection of the West line of Bradford Street with the North line of Elk Street; THENCE, Westerly along the Northerly line of Elk Street North 76°03'18" West, a distance of 208.00 feet to a point, the Point-of-Beginning. Being 1.480 Acres more or Less.



General Notes

- Legend:**
- Existing Iron
 - Set Iron
 - D Deed
 - M Measured
 - Utility Pole
 - ✕ Chainlink Fence
 - ⊕ Water Valve
 - ⊕ Fire Hydrant
 - ⊕ Gas Marker
 - ⊕ Sanitary Manhole
 - ⊕ Catch Basin
 - ⊕ Round Catch Basin
 - ⊕ Valve
 - ⊕ Monitoring Well

Notes:
This survey was prepared for an Environmental Easement.
This map of survey dated May 25, 2017, was prepared from an instrument survey, with field work completed on May 23, 2017.
This survey was prepared for the parties and purpose indicated herein. Any extension of the use beyond the purpose agreed to, exceeds the scope of the engagement.
It is a violation of New York State Education Law for any person, unless acting under the direction of a licensed surveyor, to alter an item in any way.
Only copies of this survey marked with an original signature and an original embossed or ink seal are the product of the land surveyor.
This plan NOT valid with an Affidavit of No Change.
This survey was prepared without the benefit of an up to date abstract of title and is subject to any state of facts revealed by an examination of such.
Distances shown are measured, unless otherwise indicated.
Horizontal location referenced to New York State Plane Coordinate System: New York West NAD83(2011).
Elevations are referenced to NAVD88 by GPS Observation.
Symbols are graphical representations and not to scale.
Only visible utility services and/or encumbrances were located and shown.

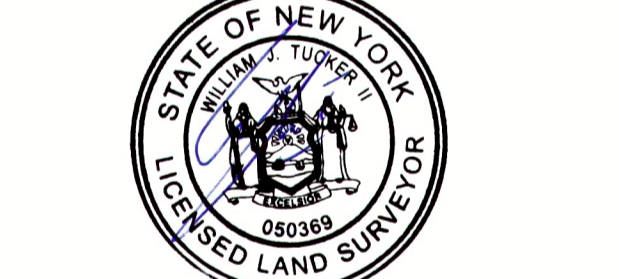

Project: **BUFFALO TERMINAL OU-1**
Date: **MAY 25, 2017**
Scale: **1"=20'**

Firm Name and Address:
Clear Creek Land Surveying, LLC
7449 Mill St.
Canadadea, NY 14717
ph. 716-592-5800
fax 716-592-5566

Project Name and Address:
**Lands Surveyed:
542 Elk St**
Part of Lots 75 Township 10,
Range 8 of the Buffalo Creek
Reservation
City of Buffalo
Erie County
State of New York

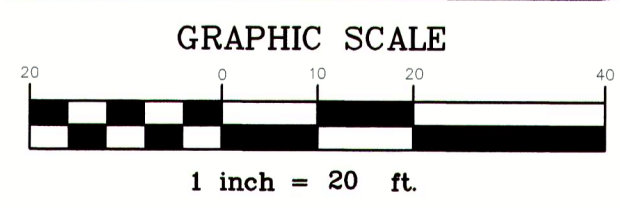

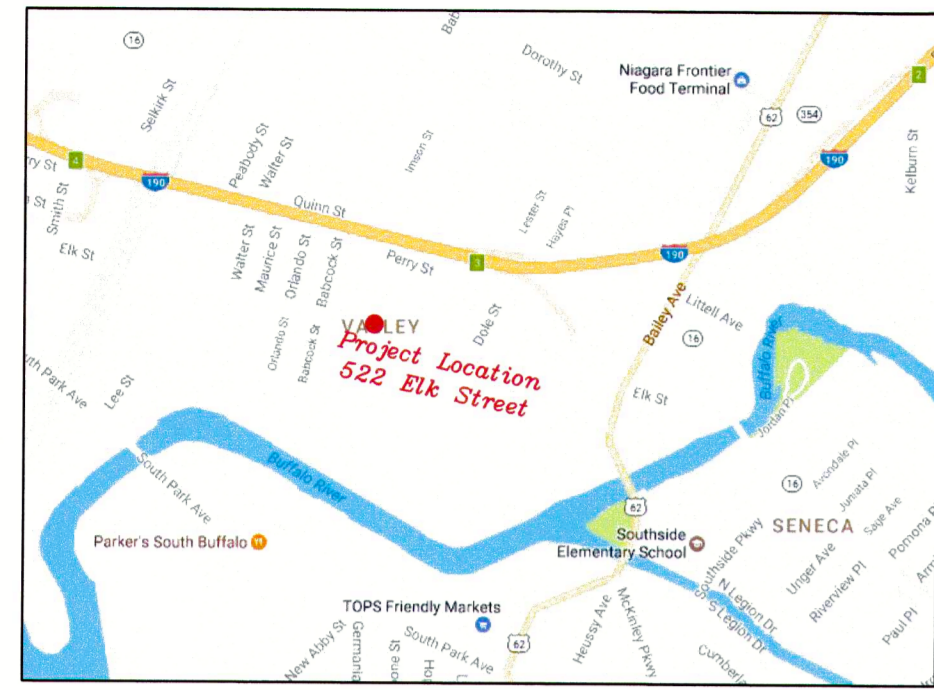

LOCATION MAP
Not to Scale

RECORD LEGAL DESCRIPTION FOR 522 ELK STREET

Parcel IV (For information Only: Section 123.9 Block 1 Lot 10.1):

Westerly Part of Premises:

ALL THAT TRACT OR PARCEL OF LAND, situate, lying and being in the City of Buffalo, County of Erie and State of New York, being part of Lot No. 75 Township 10, Range 8 of the Buffalo Creek Reservation, described as follows:

BEGINNING on the Northerly line of Elk Street at the distance of 402 feet East from Babcock Street, or 51.5 feet Westerly from Winona Street and being 25.5 feet front and rear by 115 feet in depth.

Also:

ALL THAT TRACT OR PARCEL OF LAND, situate in the City of Buffalo, County of Erie and State of New York, being part of Lot No. 76 Township 10, Range 8 of the Buffalo Creek Reservation, described as follows:

BEGINNING on the North side of Elk Street 106 feet West of the intersection of the West side of Winona Street with the North line of Elk Street; Running THENCE, at right angles Northerly and parallel with Winona Street 115 feet; THENCE, Easterly and parallel with Elk Street 29 feet; THENCE, Southerly and parallel with Winona Street 115 feet to the North line of Elk Street; THENCE, Westerly along said North line of Elk Street 29 feet to the Place of Beginning.

Easterly Part of Premises:

ALL THAT TRACT OR PARCEL OF LAND, situate, lying and being in the City of Buffalo, County of Erie and State of New York, being part of Lot No. 75 Township 10, Range 8 of the Buffalo Creek Reservation, bounded and described as follows:

BEGINNING at a point in the Northerly line of Elk Street, at the distance of 427.5 feet Easterly of the intersection of the Northerly line of Elk Street with the Easterly line of Babcock Street; Running THENCE Northerly parallel with Babcock Street 115 feet; THENCE, Easterly parallel with Elk Street 25.5 feet; THENCE, Southerly parallel with Babcock Street 115 feet to the said line of Elk Street; THENCE, Westerly along said line of Elk Street 25.5 feet to the Place of Beginning, be the same more or less.

Also:

ALL THAT TRACT OR PARCEL OF LAND, situate in the City of Buffalo, County of Erie and State of New York, being part of Lot No. 75 Township 10, Range 7 & 8 of the Buffalo Creek Reservation, bounded and described as follows:

BEGINNING at a point in the Northerly line of Elk Street at a distance of 453 feet Easterly of the point of intersection of the said Northerly line of Elk Street with the Easterly line of Babcock Street; Running THENCE, Easterly along said line of Elk Street 26 feet; THENCE, Northerly parallel with Babcock Street 115 feet; THENCE, Westerly parallel with Elk Street 26 feet; THENCE, Southerly parallel with Babcock Street 115 feet to the Place of Beginning, being the same more or less.

**ENVIRONMENTAL EASEMENT DESCRIPTION FOR 522 ELK STREET
BASED ON RECORD LEGAL DESCRIPTION**

ALL THAT TRACT OR PARCEL OF LAND, situate in the City of Buffalo, County of Erie and State of New York, being part of Lots No. 75 and 76 Township 10, Range 8 of the Buffalo Creek Reservation, described as follows:

BEGINNING on the Northerly line of Elk Street and the Westerly line of Winona Street; THENCE, along the Northerly line of Elk Street North 76°03'18" West, a distance of 106.00 feet to a point; THENCE, parallel to the Westerly line of Winona Street North 13°56'42" East, a distance of 115.00 feet to a point; THENCE, parallel to the Northerly line of Elk Street South 76°03'18" East, a distance of 106.00 feet to a point; THENCE, Southerly along the Westerly line of Winona Street South 13°56'42" West, a distance of 115.00 feet to a point, the Point-of-Beginning.

Being 0.280 Acres more or Less.

"This property is subject to an environmental easement held by the New York State Department of Environmental Conservation pursuant to Title 36 of Article 71 of the New York Environmental Conservation Law. The engineering and institutional controls for this Easement are set forth in the Site Management Plan (SMP). A copy of the SMP must be obtained by any party with an interest in the property. The SMP can be obtained from NYS Department of Environmental Conservation, Division of Environmental Remediation, Site Control Section, 625 Broadway, Albany, NY 12233 or at "denweb@dec.ny.gov."



General Notes

Legend:

- - Existing Iron
- - Set Iron
- D - Deed
- M - Measured
- - Utility Pole
- Chainlink Fence
- Water Valve
- Fire Hydrant
- - Gas Marker
- - Sanitary Manhole
- - Catch Basin
- - Round Catch Basin
- Valve
- - Monitoring Well

Notes:
 This survey was prepared for an Environmental Easement.
 This map of survey dated May 25, 2017 was prepared from an instrument survey, with field work completed on May 23, 2017.
 This survey was prepared for the parties and purpose indicated herein. Any extension of the use beyond the purpose agreed to exceeds the scope of the engagement.
 It is a violation of New York State Education Law for any person, unless acting under the direction of a licensed surveyor, to alter an item in any way.
 Only copies of this survey marked with an original signature and an original embossed or ink seal are the product of the land surveyor.
 This plan NOT valid with an Affidavit of No Change.
 This survey was prepared without the benefit of an up to date abstract of title and is subject to any state of facts revealed by an examination of such.
 Distance shown are measured, unless otherwise indicated.
 Horizontal location referenced to New York State Plane Coordinate System: New York West NAD83(2011)
 Elevations are referenced to NAVD88 by GPS Observation.
 Symbols are graphical representations and not to scale.
 Only visible utility services and/or encumbrances were located and shown.

Survey by William J Tucker, II PLS #50369
 Clear Creek Land Surveying, L.L.C.
 7449 Mill St. Canaan, NY 14717
 Phone 716-592-5800 Fax 716-592-5566



Project: **BUFFALO TERMINAL OU-1**
 Date: **MAY 25, 2017**
 Scale: **1"=20'**

Firm Name and Address:
Clear Creek Land Surveying, LLC
 7449 Mill St.
 Canaan, NY 14717
 ph. 716-592-5800
 fax 716-592-5566

Project Name and Address:
Lands Surveyed:
522 Elk St
Part of Lots 75 & 76 Township 10, Range 8 of the Buffalo Creek Reservation
City of Buffalo
Erie County
State of New York

