



FACT SHEET

Environmental Restoration Program

Receive Site Fact Sheets by *Email*. See "For More Information" to Learn How.

Site Name: Former Service Station

DEC Site #: E828143

Address: 8264 Ridge Road
Clarkson, NY 14430

Have questions?

See

"Who to Contact"

Below

NYSDEC Certifies Cleanup Requirements Achieved at Municipal Brownfield Site

The New York State Department of Environmental Conservation (NYSDEC) has determined that the cleanup requirements to address contamination related to the Former Service Station site ("site") located at 8264 Ridge Road, Clarkson, Monroe County under New York State's Environmental Restoration Program have been or will be met. Please see the map for the site location.

NYSDEC has issued a Certificate of Completion regarding the site. A copy of the Certificate of Completion is available at the location(s) identified below under "Where to Find Information."

The cleanup activities were performed with oversight provided by NYSDEC

Completion of Project

- Demolition and removal of two on-site structures.
- Removal and proper disposal of; the former pump island, a 55 gallon drum partially filled with the chemical Styrene, four (4) underground petroleum storage tanks and one (1) aboveground petroleum storage tank.
- The excavation and disposal of 368 tons of petroleum-impacted soil resulting during the removal of the underground storage tanks. Excavations were backfilled with soil that were tested to confirm that they were uncontaminated.
- The placement of cover material, including stone and soil, over surface soil and sediments where contaminant levels exceeded the soil cleanup objectives for the site. A demarcation layer and minimum of one foot of soil cover was placed over a portion of on-site soils. Cover soils were tested to confirm that they were uncontaminated.
- Maintenance of the site cover. The site cover that currently exists will be maintained to allow for commercial and industrial use of the site as a component of any site redevelopment.
- Imposition of institutional controls in the form of an environmental easement and site management plan that limits the use of the property and provides for the monitoring and management of remaining contamination.

The following institutional controls have been put in place on the site:

- Soil Management Plan
- Environmental Easement
- Institutional Control/Engineering Control Plan
- Groundwater Use Restriction
- Land Use Restriction
- Site Management Plan

The following engineering controls have been or will be put in place on the site:

- Soil Cover System

Background

Location:

The site is located in a suburban area on the north side of Ridge Road West (NYS Route 104) in the Town of Clarkson, Monroe County, New York. The property is 0.25 miles east of Lake Rd and 1.75 miles west of Sweden-Walker Rd (Rte 260).

Site Features:

The site consists of a 0.697-acre parcel that formerly contained two structures (a former body shop/garage and office/storage building), two storage trailers, and a paved parking area on the southern portion of the site. The northern portion of the site is wooded and is approximately 0.5 acres.

Current Zoning/Use:

The site is currently vacant and zoned for commercial use. Adjacent land use includes residential properties to the east and south, a commercial property to the west, and vacant land to the north.

Historical Use:

The Site was used as a retail gas station from approximately 1930 until the 1970s, and a vehicle service station from the 1930's to 2002. The previous use as a gas/service station including the underground storage of petroleum appears to have led to site contamination.

Site Geology and Hydrogeology:

The site grades slightly to the north. A drainage channel is located along the western boundary of the site which directs flow from up-gradient areas on the south side of Route 104 to the north. A tributary to Brockport Creek receives drainage from this site approximately 500 feet to the north. Groundwater flow is primarily to the north. Soils are low-permeability silty clay to a depth of approximately 4 to 10 ft below grade. The upper bedrock is assumed to be the Queenston Shale and Medina Sandstone at a depth of 4 to 10 feet below grade.

Additional site details, including environmental and health assessment summaries, are available on NYSDEC's website at:

<http://www.dec.ny.gov/cfm/external/derexternal/haz/details.cfm?pageid=3&progno=E828143>

Environmental Restoration Program: New York's Environmental Restoration Program (ERP) reimburses municipalities for their costs to investigate and clean up municipality owned contaminated properties. Once cleaned up, the properties may be redeveloped for commercial, industrial, residential or public use.

A brownfield is any real property that is difficult to reuse or redevelop because of the presence or potential presence of contamination.

For more information about the ERP, visit: <http://www.dec.ny.gov/chemical/8444.html>

FOR MORE INFORMATION

Where to Find Information

Project documents are available at the following location(s) to help the public stay informed.

BROCKPORT - SEYMOUR LIBRARY

Attn: LIBRARIAN

161 EAST AVENUE

BROCKPORT, NY 14420

phone: 585-637-1050

Who to Contact

Comments and questions are always welcome and should be directed as follows:

Project Related Questions

Matthew Gillette

Department of Environmental Conservation

Division of Environmental Remediation

6274 East Avon-Lima Road

Avon, NY 14414

585-226-5308

mpgillet@gw.dec.state.ny.us

Site-Related Health Questions

Julia Kenney

New York State Department of Health

Empire State Plaza - Corning Tower Room #1787

Albany, NY 12237

(518) 402-7860

BEEI@health.state.ny.us

We encourage you to share this fact sheet with neighbors and tenants, and/or post this fact sheet in a prominent area of your building for others to see.

Receive Site Fact Sheets by Email

Have site information such as this fact sheet sent right to your email inbox.

NYSDEC invites you to sign up with one or more contaminated sites

county email listservs available at the following web page:

<http://www.dec.ny.gov/chemical/61092.html>. It's quick, it's free,

and it will help keep you *better informed*.



As a listserv member, you will periodically receive site-related information/announcements for all contaminated sites in the county(ies) you select.

Note: Please disregard if you already have signed up and received this fact sheet electronically.

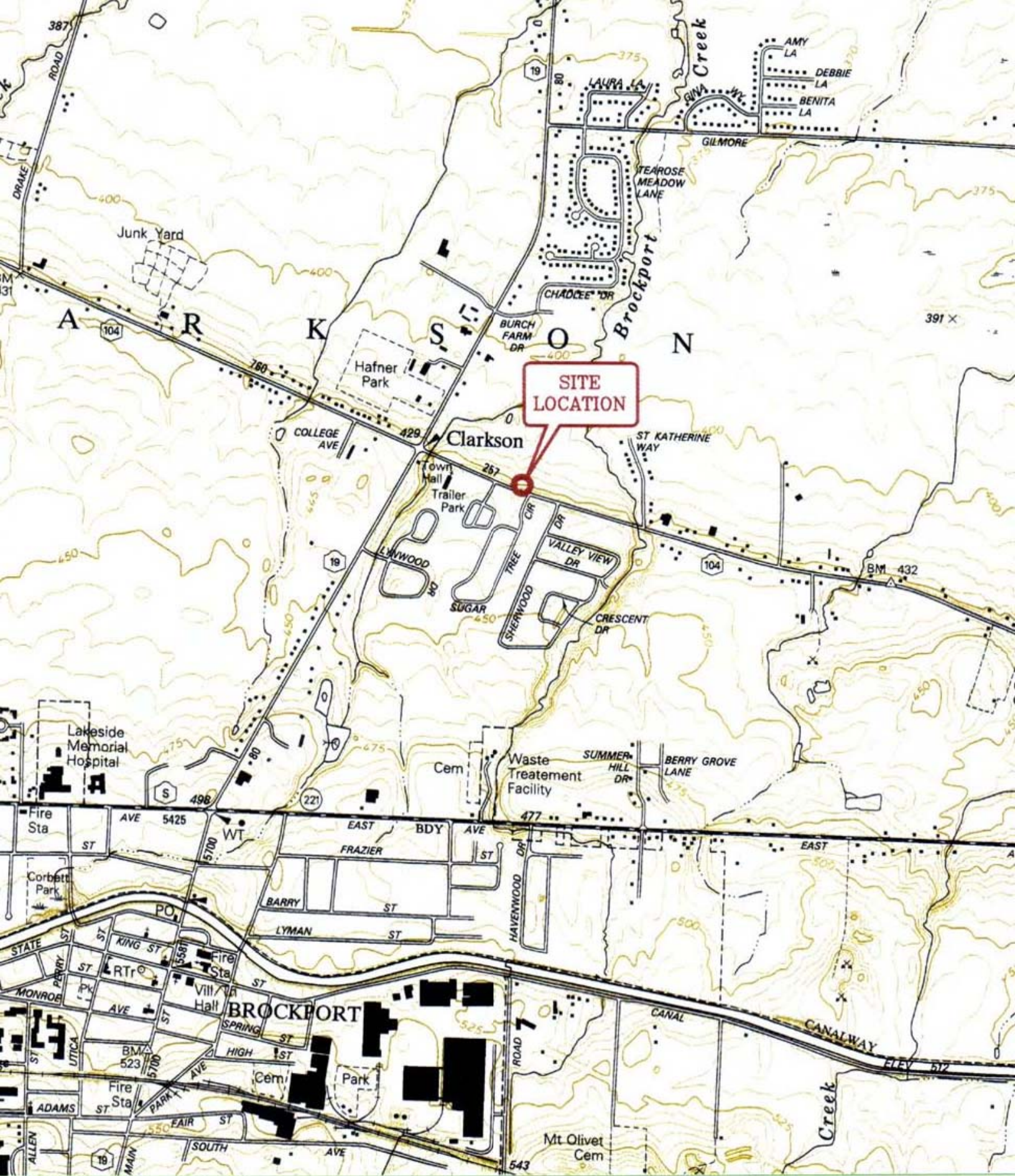

SCALE: 1" = 2000'

