

December 11, 2001

Mr. Scott Blake
Alaskan Oil, Inc
2020 LeMoyne Avenue
Syracuse, New York 13208

Re: Rte. 342 and Rte. 81 Property
File: 639.012

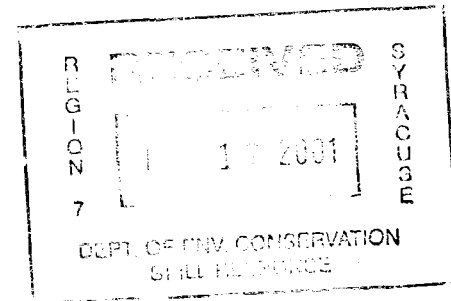

Dear Mr. Blake:

Between August 31 and September 28, 2001 Barton & Loguidice, P.C. (B&L) conducted oversight for the installation of ten (10) 1-inch temporary groundwater monitoring wells by Clemett and Co. Locations of the monitoring wells were determined by B&L personnel based on historical site data. The monitoring wells were installed in an attempt to define the horizontal limits of a MTBE plume originating from the site. The results of the investigation are summarized below.

Field Methods and Results (TW 1-TW 6)

Prior to the installation of the temporary monitoring wells, one geoprobe soil boring was installed. The purpose of the boring was to determine if field screening of site soils with a Photo Ionization Detector (PID) could detect the presence of MTBE contamination. The boring was installed in a known area of MTBE contamination (adjacent to MW-1). The boring was installed to 12 feet below grade, and the four-foot soil core intervals were scanned with the PID. PID readings less than 6 parts per million (ppm) were observed. The low level PID readings would not be beneficial to determine the limits of the MTBE plume and placement of temporary wells.

Six one-inch temporary wells (TW1-6) were installed between August 31 and September 7, 2001. The location of the wells is depicted on Figure 1. The temporary wells were set at a depth of 11 feet with 10 feet of 0.010-slot size screen. Following well installation, each well was developed in an attempt to remove fine sediments from the groundwater. Water was purged from each well until the well went dry. Following recovery, the wells were purged again until dry.

Groundwater samples were collected from the six temporary wells (TW1-6) and from monitoring wells MW-1, 4 and 5 on September 13, 2001. Prior to collecting groundwater samples on September 13, 2001 each temporary well was purged until it went dry. Three wells volumes were purged from monitoring wells MW1, 4 and 5. Groundwater samples obtained from each

S:\WPDATA\600\639 012\Correspondence\Letters\639012characterization121101.doc





Mr. Scott Blake
Rte. 342 and 81 Property
December 11, 2001
Page Two

well were analyzed for volatile petroleum hydrocarbons (EPA Method 8021 with MTBE) by a NYSDOH approved laboratory.

MTBE was detected above the NYSDEC Guidance Value of 10 ug/l in all of the samples collected on September 13, 2001 with exception to TW-6. The detections ranged from 16.7 to 1340 ug/l. The detection limit in TW-6 was 1 ug/l. No other compounds were detected (detection limit of 1 ug/l) in any of the locations sampled. The results, along with historical site data, are presented in Table 1.

Field Methods and Results (TW 7-TW 10)

The September 13, 2001 sampling results did not define the extent of the MTBE plume originating from the site. Four additional temporary wells were installed on September 28, 2001. TW-7 was installed north of Rte. 342, west of TW-4, and TW-8, 9, 10 were installed approximately 75 feet south of Rte. 342. The locations of the temporary wells are depicted on Figure 1.

The temporary wells were installed at a depth of 12 feet and were developed and sampled under the methods discussed above. Groundwater samples were collected from the additional four temporary wells (TW 7-10) and from monitoring well MW-6 on October 3, 2001. Groundwater samples obtained from each well were again analyzed for volatile petroleum hydrocarbons (EPA Method 8021 with MTBE) by a NYSDOH approved laboratory.

MTBE was detected above the NYSDEC Guidance Value of 10 ug/l in TW-7 (16.7 ug/l). MTBE was also detected in MW-6, but the concentration (7.5 ug/l) was below the NYSDEC Guidance Value. The detection limit in TW-8, 9, and 10 was 1 ug/l. No other compounds were detected (detection limit of 1 ug/l) in any of the locations sampled.

Well Installation Logs and Field Sampling Data Sheets are available upon request. The laboratory reports are attached in Appendix A

Conclusions and Recommendations

Based on the historical data a plume of MTBE is present on the site, and has migrated off-site. Approximately 400 tons of soil was removed from the site in November 2000 in association with the removal of underground storage tanks. Due to the high solubility of MTBE, the contaminant migrated off-site. No other compounds have been detected in the monitoring wells.



Mr. Scott Blake
Rte. 342 and 81 Property
December 11, 2001
Page Three

The October 3, 2001 sampling results collected from the perimeter temporary monitoring wells have defined the northerly and southern boundaries of the MTBE plume. The southwest downgradient boundary of the plume is not completely delineated. The data observed to date, however, suggests that the migration of the plume past TW-7 is limited. Since the site has a signed VCA agreement, a Risk-Based Corrective Action (RBCA) Report is required for site closure.

Based on the above it is recommended that a RBCA Report be prepared. Some additional site work (i.e. surveying, an additional round of static water levels, and an assessment of neighboring parcels) may be warranted in association with the RBCA Report. Please feel free to contact me with any questions regarding the Site Investigation or recommendations for site closure.

Very truly yours,



BARTON & LOGUIDICE, P.C.



A handwritten signature in black ink, appearing to read 'David R. Hanny', with a stylized flourish at the end.

David R. Hanny
Environmental Scientist

DRH/ges

LEGEND:

-  MW-1 GROUNDWATER MONITORING WELL
-  PZ-1 PIEZOMETER
-  TW-1 TEMPORARY 1" MONITORING WELL (INSTALLED WITH B&L)
- | |
|----------|
| 10/11/01 |
| 16.7 |

 DATE OF MOST RECENT SAMPLING EVENT
MTBE CONCENTRATION
-  MTBE PLUME
-  INFERRED MTBE PLUME

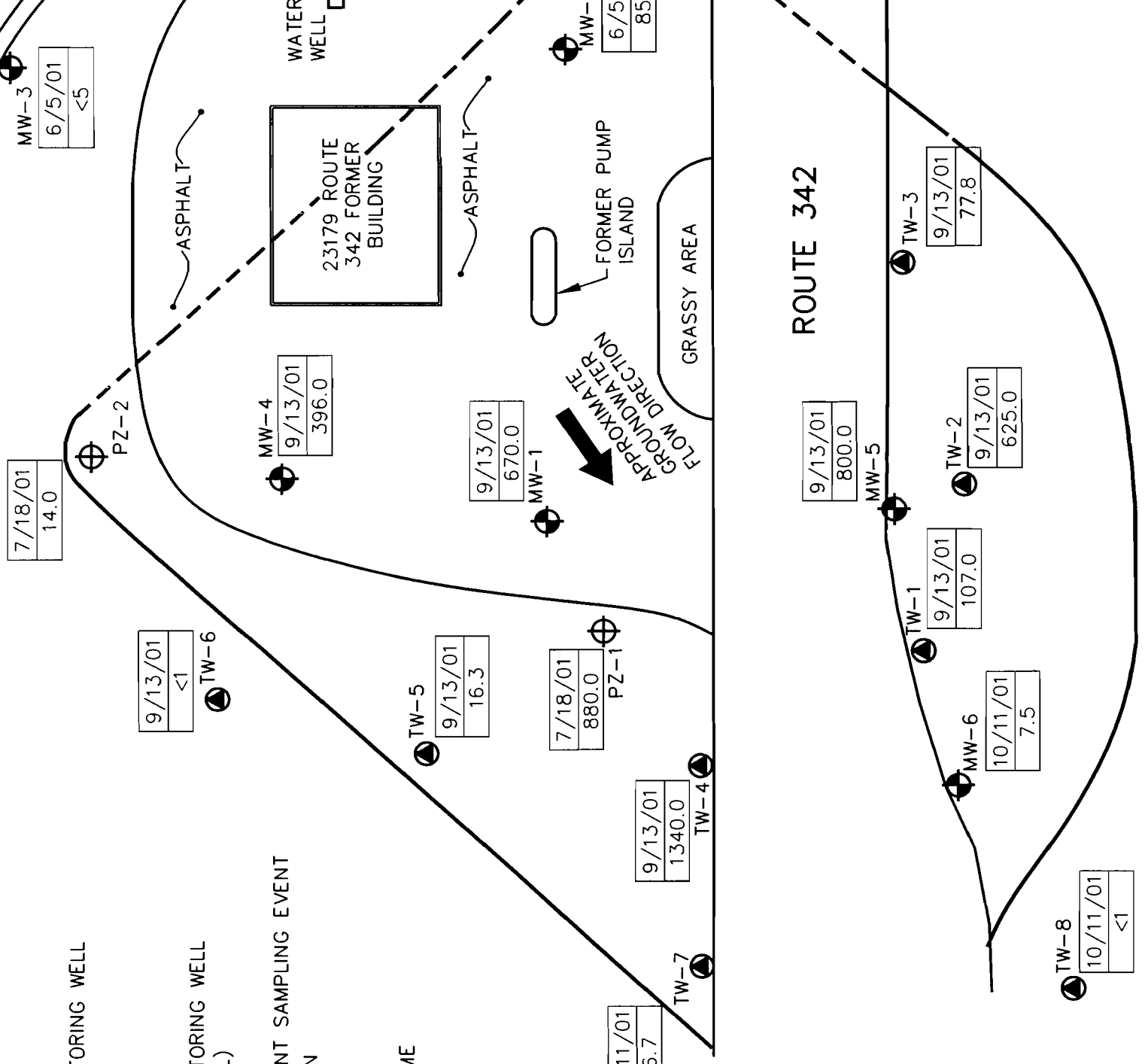

Table 1
ALASKAN OIL, INC.
 23179 NYS Rte. 342 and Rte. 81
 Watertown, New York
MTBE Concentrations

Date	MTBE Concentration (ug/l)							
	Location							
	MW-1	MW-2	MW-3	MW-4	MW-5	MW-6	PZ-1	PZ-2
8/6/97	1500	32	<5	740	--	--	--	--
11/24/97	1600	27	<5	530	--	--	--	--
2/9/98	2200	32	<5	690	--	--	--	--
5/13/98	1400	24	<5	530	--	--	--	--
8/5/98	1600	25	<5	114	--	--	--	--
11/19/98	1200	35	<5	545	--	--	--	--
2/11/99	1800	34	<5	770	--	--	--	--
6/5/01	960	85	<5	590	--	--	480	10
7/17/01	--	--	--	--	800	<5	--	--
7/18/01	--	--	--	--	--	--	880	14
7/19/01	--	--	--	--	620	<5	--	--
9/13/01	670	--	--	396	800	--	--	--
10/11/01	--	--	--	--	--	7.5	--	--

Date	MTBE Concentration (ug/l)									
	Locations Installed by B&L									
	TW-1	TW-2	TW-3	TW-4	TW-5	TW-6	TW-7	TW-8	TW-9	TW-10
09/13/01	107	625	77.8	1340	16.3	<1	--	--	--	--
10/11/01	--	--	--	--	--	--	16.7	<1	<1	<1

Notes:

ug/l = part per billion

--- = Value Above NYSDEC Standard (10 ug/l)

No other compounds under EPA Methods 8021 or 8270 were detected in any of the wells.

TW Series wells tested only for EPA 8021 + MTBE (no other compounds detected)

DRH: 639.012



Appendix A

**Environmental Laboratory Services
Report**

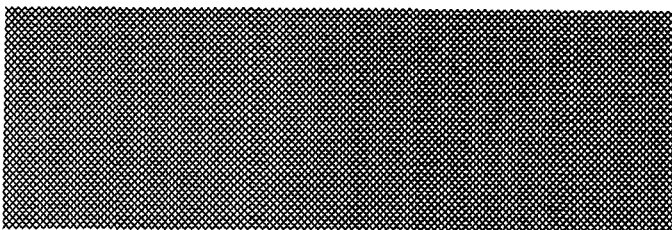

7280 Caswell Street, Hancock Air Park
North Syracuse, NY 13212
(315) 458-8033 FAX (315) 458-0249

"Your Full-Service Analytical Laboratory"

FAX TRANSMITTAL MEMO

To : Dave Hanny

From : ELS

Company : Barton & Loguidice

Date : 9/18/01 Time : 5:38:50 PM

Fax Number : 451-0052

Pages : 20

Subject : 997585

Notes :



Environmental
LABORATORY SERVICES

7280 Caswell Street, Hancock Air Park, North Syracuse, NY 13212
(315) 458-8033, FAX (315) 458-0249, (800) 842-4667

Certified in:
*Connecticut
*Delaware
*Maryland
*Massachusetts
*New Hampshire
*New Jersey
*New York
*Pennsylvania
*Rhode Island

FAX COPY

ALASKAN OIL INC.
2020 LEMOYNE STREET
P.O. BOX 69
SYRACUSE NY 13211-
ATTN: MR. SCOTT BLAKE

P.O. #
CLIENT JOB NUMBER: 639.013

PROJECT #: 997585
RECEIVED: 9/14/01

Rts 81/342
Watertown NY

TEST PERFORMED	RESULTS	UNITS	DATE PERFORMED	METHOD NUMBER	PERFORMED BY
SAMPLE #: 185575	CLIENT SAMPLE ID: TW-1			DATE SAMPLED: 9/13/01	
VOL. ORGANICS - EPA 8021 W/MTBE		UG/L	9/15/01	EPA 8021	SKW
BENZENE	<0.7				
BROMOBENZENE	<1.0				
BROMOCHLOROMETHANE	<1.0				
BROMODICHLOROMETHANE	<1.0				
BROMOFORM	<1.0				
BROMOMETHANE	<1.0				
N-BUTYLBENZENE	<1.0				
SEC-BUTYLBENZENE	<1.0				
TERT-BUTYLBENZENE	<1.0				
CARBON TETRACHLORIDE	<1.0				
CHLORO BENZENE	<1.0				
CHLOROETHANE	<1.0				
CHLOROFORM	<1.0				
CHLOROMETHANE	<1.0				
2-CHLOROTOLUENE	<1.0				
4-CHLOROTOLUENE	<1.0				
CUMENE (ISOPROPYLBENZENE)	<1.0				
CYMENE (4-ISOPROPYLTOLUENE)	<1.0				
CIS-1,3-DICHLOROPROPENE	<1.0				
DIBROMOCHLOROMETHANE	<1.0				
1,2-DIBROMO-3-CHLOROPROPANE	<1.0				
DIBROMOMETHANE	<1.0				
1,2-DICHLORO BENZENE	<1.0				
1,3-DICHLORO BENZENE	<1.0				
1,4-DICHLORO BENZENE	<1.0				
DICHLORODIFLUOROMETHANE	<1.0				

FAX COPY

ALASKAN OIL INC.
 2020 LEMOYNE STREET
 P.O. BOX 69
 SYRACUSE NY 13211-
 ATTN: MR. SCOTT BLAKE

 P.O. #
 CLIENT JOB NUMBER: 639.013

PROJECT #: 997585
 RECEIVED: 9/14/01

 Rts 81/342
 Watertown NY

TEST PERFORMED	RESULTS	UNITS	DATE PERFORMED	METHOD NUMBER	PERFORMED BY
SAMPLE #: 185575 CLIENT SAMPLE ID: TW-1				DATE SAMPLED: 9/13/01	
VOL. ORGANICS - EPA 8021 W/MTBE		UG/L	9/15/01	EPA 8021	SKW
1,2-DIBROMOETHANE	<1.0				
CIS-1,2-DICHLOROETHENE	<1.0				
1,1-DICHLOROETHANE	<1.0				
1,2-DICHLOROETHANE	<1.0				
1,1-DICHLOROETHENE	<1.0				
TRANS-1,2-DICHLOROETHENE	<1.0				
1,2-DICHLOROPROPANE	<1.0				
1,3-DICHLOROPROPANE	<1.0				
2,2-DICHLOROPROPANE *	<1.0				
1,1-DICHLOROPROPENE	<1.0				
TRANS-1,3-DICHLOROPROPENE	<1.0				
ETHYLBENZENE	<1.0				
HEXACHLOROBUTADIENE	<1.0				
METHYLENE CHLORIDE	<1.0				
MTBE	107				
NAPHTHALENE	<1.0				
N-PROPYLBENZENE	<1.0				
STYRENE	<1.0				
TOLUENE	<1.0				
TRICHLOROETHENE	<1.0				
TRICHLOROFLUOROMETHANE	<1.0				
1,1,1,2-TETRACHLOROETHANE	<1.0				
1,1,2,2-TETRACHLOROETHANE	<1.0				
TETRACHLOROETHENE	<1.0				
1,2,3-TRICHLOROBENZENE	<1.0				
1,2,4-TRICHLOROBENZENE	<1.0				
1,1,2-TRICHLOROETHANE	<1.0				
1,2,3-TRICHLOROPROPANE	<1.0				
1,2,4-TRIMETHYLBENZENE	<1.0				
1,3,5-TRIMETHYLBENZENE *	<1.0				
1,1,1-TRICHLOROETHANE	<1.0				
VINYL CHLORIDE	<1.0				
TOTAL XYLENES	<1.0				

* COMPOUND CO-ELUTES. RESULT IS CALCULATED AS A COMBINED STANDARD.



FAX COPY

ALASKAN OIL INC.
 2020 LEMOYNE STREET
 P.O. BOX 69
 SYRACUSE NY 13211-
 ATTN: MR. SCOTT BLAKE

 P.O. #
 CLIENT JOB NUMBER: 639.013

PROJECT #: 997585
 RECEIVED: 9/14/01

 Rts 81/342
 Watertown NY

TEST PERFORMED	RESULTS	UNITS	DATE PERFORMED	METHOD NUMBER	PERFORMED BY
SAMPLE #: 185576 CLIENT SAMPLE ID: TW-2			DATE SAMPLED: 9/13/01		
VOL. ORGANICS - EPA 8021 W/MTBE		UG/L	9/15/01	EPA 8021	SKW
BENZENE	<0.7				
BROMOBENZENE	<1.0				
BROMOCHLOROMETHANE	<1.0				
BROMODICHLOROMETHANE	<1.0				
BROMOFORM	<1.0				
BROMOMETHANE	<1.0				
N-BUTYLBENZENE	<1.0				
SEC-BUTYLBENZENE	<1.0				
TERT-BUTYLBENZENE	<1.0				
CARBON TETRACHLORIDE	<1.0				
CHLOROBENZENE	<1.0				
CHLOROETHANE	<1.0				
CHLOROFORM	<1.0				
CHLOROMETHANE	<1.0				
2-CHLOROTOLUENE	<1.0				
4-CHLOROTOLUENE	<1.0				
CUMENE (ISOPROPYLBENZENE)	<1.0				
CYMENE (4-ISOPROPYLTOLUENE)	<1.0				
CIS-1,3-DICHLOROPROPENE	<1.0				
DIBROMOCHLOROMETHANE	<1.0				
1,2-DIBROMO-3-CHLOROPROPANE	<1.0				
DIBROMOMETHANE	<1.0				
1,2-DICHLOROBENZENE	<1.0				
1,3-DICHLOROBENZENE	<1.0				
1,4-DICHLOROBENZENE	<1.0				
DICHLORODIFLUOROMETHANE	<1.0				
1,2-DIBROMOETHANE	<1.0				
CIS-1,2-DICHLOROETHENE	<1.0				
1,1-DICHLOROETHANE	<1.0				
1,2-DICHLOROETHANE	<1.0				
1,1-DICHLOROETHENE	<1.0				
TRANS-1,2-DICHLOROETHENE	<1.0				
1,2-DICHLOROPROPANE	<1.0				
1,3-DICHLOROPROPANE	<1.0				



FAX COPY

ALASKAN OIL INC.
 2020 LEMOYNE STREET
 P.O. BOX 69
 SYRACUSE NY 13211-
 ATTN: MR. SCOTT BLAKE
 P.O. #
 CLIENT JOB NUMBER: 639.013

PROJECT #: 997585
 RECEIVED: 9/14/01
 Rts 81/342
 Watertown NY

TEST PERFORMED	RESULTS	UNITS	DATE PERFORMED	METHOD NUMBER	PERFORMED BY
SAMPLE #: 185576	CLIENT SAMPLE ID: TW-2			DATE SAMPLED: 9/13/01	
VOL. ORGANICS - EPA 8021 W/MTBE		UG/L	9/15/01	EPA 8021	SKW
2,2-DICHLOROPROPANE *	<1.0				
1,1-DICHLOROPROPENE	<1.0				
TRANS-1,3-DICHLOROPROPENE	<1.0				
ETHYLBENZENE	<1.0				
HEXACHLOROBUTADIENE	<1.0				
METHYLENE CHLORIDE	<1.0				
MTBE	625				
NAPHTHALENE	<1.0				
N-PROPYLBENZENE	<1.0				
STYRENE	<1.0				
TOLUENE	<1.0				
TRICHLOROETHENE	<1.0				
TRICHLOROFLUOROMETHANE	<1.0				
1,1,1,2-TETRACHLOROETHANE	<1.0				
1,1,2,2-TETRACHLOROETHANE	<1.0				
TETRACHLOROETHENE	<1.0				
1,2,3-TRICHLOROBENZENE	<1.0				
1,2,4-TRICHLOROBENZENE	<1.0				
1,1,2-TRICHLOROETHANE	<1.0				
1,2,3-TRICHLOROPROPANE	<1.0				
1,2,4-TRIMETHYLBENZENE	<1.0				
1,3,5-TRIMETHYLBENZENE *	<1.0				
1,1,1-TRICHLOROETHANE	<1.0				
VINYL CHLORIDE	<1.0				
TOTAL XYLENES	<1.0				
* COMPOUND CO-ELUTES. RESULT IS CALCULATED AS A COMBINED STANDARD.					

SAMPLE #: 185577	CLIENT SAMPLE ID: TW-3			DATE SAMPLED: 9/13/01	
VOL. ORGANICS - EPA 8021 W/MTBE		UG/L	9/15/01	EPA 8021	SKW
BENZENE	<0.7				
BROMOBENZENE	<1.0				
BROMOCHLOROMETHANE	<1.0				
BROMODICHLOROMETHANE	<1.0				

PAGE 4 of 19



Environmental
 LABORATORY SERVICES

FAX COPY

ALASKAN OIL INC.
 2020 LEMOYNE STREET
 P.O. BOX 69
 SYRACUSE NY 13211-
 ATTN: MR. SCOTT BLAKE

 P.O. #
 CLIENT JOB NUMBER: 639.013

PROJECT #: 997585
 RECEIVED: 9/14/01

 Rts 81/342
 Watertown NY

TEST PERFORMED	RESULTS	UNITS	DATE PERFORMED	METHOD NUMBER	PERFORMED BY
SAMPLE #: 185577	CLIENT SAMPLE ID: TW-3			DATE SAMPLED: 9/13/01	
VOL. ORGANICS - EPA 8021 W/MTBE		UG/L	9/15/01	EPA 8021	SKW
BROMOFORM	<1.0				
BROMOMETHANE	<1.0				
N-BUTYLBENZENE	<1.0				
SEC-BUTYLBENZENE	<1.0				
TERT-BUTYLBENZENE	<1.0				
CARBON TETRACHLORIDE	<1.0				
CHLORO BENZENE	<1.0				
CHLOROETHANE	<1.0				
CHLOROFORM	<1.0				
CHLOROMETHANE	<1.0				
2-CHLOROTOLUENE	<1.0				
4-CHLOROTOLUENE	<1.0				
CUMENE (ISOPROPYLBENZENE)	<1.0				
CYMENE (4-ISOPROPYLTOLUENE)	<1.0				
CIS-1,3-DICHLOROPROPENE	<1.0				
DIBROMOCHLOROMETHANE	<1.0				
1,2-DIBROMO-3-CHLOROPROPANE	<1.0				
DIBROMOMETHANE	<1.0				
1,2-DICHLORO BENZENE	<1.0				
1,3-DICHLORO BENZENE	<1.0				
1,4-DICHLORO BENZENE	<1.0				
DICHLORODIFLUOROMETHANE	<1.0				
1,2-DIBROMOETHANE	<1.0				
CIS-1,2-DICHLOROETHENE	<1.0				
1,1-DICHLOROETHANE	<1.0				
1,2-DICHLOROETHANE	<1.0				
1,1-DICHLOROETHENE	<1.0				
TRANS-1,2-DICHLOROETHENE	<1.0				
1,2-DICHLOROPROPANE	<1.0				
1,3-DICHLOROPROPANE	<1.0				
2,2-DICHLOROPROPANE *	<1.0				
1,1-DICHLOROPROPENE	<1.0				
TRANS-1,3-DICHLOROPROPENE	<1.0				
ETHYLBENZENE	<1.0				
HEXACHLOROBUTADIENE	<1.0				



FAX COPY

ALASKAN OIL INC.
 2020 LEMOYNE STREET
 P.O. BOX 69
 SYRACUSE NY 13211-
 ATTN: MR. SCOTT BLAKE

 P.O. #
 CLIENT JOB NUMBER: 639.013

PROJECT #: 997585
 RECEIVED: 9/14/01

 Rts 81/342
 Watertown NY

TEST PERFORMED	RESULTS	UNITS	DATE PERFORMED	METHOD NUMBER	PERFORMED BY
SAMPLE #: 185577		CLIENT SAMPLE ID: TW-3		DATE SAMPLED: 9/13/01	
VOL. ORGANICS - EPA 8021 W/MTBE		UG/L	9/15/01	EPA 8021	SKW
METHYLENE CHLORIDE	<1.0				
MTBE	77.8				
NAPHTHALENE	<1.0				
N-PROPYLBENZENE	<1.0				
STYRENE	<1.0				
TOLUENE	<1.0				
TRICHLOROETHENE	<1.0				
TRICHLOROFLUOROMETHANE	<1.0				
1,1,1,2-TETRACHLOROETHANE	<1.0				
1,1,2,2-TETRACHLOROETHANE	<1.0				
TETRACHLOROETHENE	<1.0				
1,2,3-TRICHLOROBENZENE	<1.0				
1,2,4-TRICHLOROBENZENE	<1.0				
1,1,2-TRICHLOROETHANE	<1.0				
1,2,3-TRICHLOROPROPANE	<1.0				
1,2,4-TRIMETHYLBENZENE	<1.0				
1,3,5-TRIMETHYLBENZENE *	<1.0				
1,1,1-TRICHLOROETHANE	<1.0				
VINYL CHLORIDE	<1.0				
TOTAL XYLENES	<1.0				

* COMPOUND CO-ELUTES. RESULT IS CALCULATED AS A COMBINED STANDARD.

SAMPLE #: 185578		CLIENT SAMPLE ID: TW-4		DATE SAMPLED: 9/13/01	
VOL. ORGANICS - EPA 8021 W/MTBE		UG/L	9/16/01	EPA 8021	SKW
BENZENE	<0.7				
BROMOBENZENE	<1.0				
BROMOCHLOROMETHANE	<1.0				
BROMODICHLOROMETHANE	<1.0				
BROMOFORM	<1.0				
BROMOMETHANE	<1.0				
N-BUTYLBENZENE	<1.0				
SEC-BUTYLBENZENE	<1.0				
TERT-BUTYLBENZENE	<1.0				



FAX COPY

ALASKAN OIL INC.
 2020 LEMOYNE STREET
 P.O. BOX 69
 SYRACUSE NY 13211-
 ATTN: MR. SCOTT BLAKE
 P.O. #
 CLIENT JOB NUMBER: 639.013

PROJECT #: 997585
 RECEIVED: 9/14/01
 Rts 81/342
 Watertown NY

TEST PERFORMED	RESULTS	UNITS	DATE PERFORMED	METHOD NUMBER	PERFORMED BY
SAMPLE #: 185578	CLIENT SAMPLE ID: TW-4			DATE SAMPLED: 9/13/01	
VOL. ORGANICS - EPA 8021 W/MTBE		UG/L	9/16/01	EPA 8021	SKW
CARBON TETRACHLORIDE	<1.0				
CHLOROETHANE	<1.0				
CHLOROETHANE	<1.0				
CHLOROETHANE	<1.0				
CHLOROFORM	<1.0				
CHLOROMETHANE	<1.0				
2-CHLOROTOLUENE	<1.0				
4-CHLOROTOLUENE	<1.0				
CUMENE (ISOPROPYL BENZENE)	<1.0				
CYMENE (4-ISOPROPYL TOLUENE)	<1.0				
CIS-1,3-DICHLOROPROPENE	<1.0				
DIBROMOCHLOROMETHANE	<1.0				
1,2-DIBROMO-3-CHLOROPROPANE	<1.0				
DIBROMOMETHANE	<1.0				
1,2-DICHLOROETHANE	<1.0				
1,3-DICHLOROETHANE	<1.0				
1,4-DICHLOROETHANE	<1.0				
DICHLORODIFLUOROMETHANE	<1.0				
1,2-DIBROMOETHANE	<1.0				
CIS-1,2-DICHLOROETHENE	<1.0				
1,1-DICHLOROETHANE	<1.0				
1,2-DICHLOROETHANE	<1.0				
1,1-DICHLOROETHENE	<1.0				
TRANS-1,2-DICHLOROETHENE	<1.0				
1,2-DICHLOROPROPANE	<1.0				
1,3-DICHLOROPROPANE	<1.0				
2,2-DICHLOROPROPANE *	<1.0				
1,1-DICHLOROPROPENE	<1.0				
TRANS-1,3-DICHLOROPROPENE	<1.0				
ETHYLBENZENE	<1.0				
HEXACHLOROBUTADIENE	<1.0				
METHYLENE CHLORIDE	<1.0				
MTBE	1340				
NAPHTHALENE	<1.0				
N-PROPYLBENZENE	<1.0				
STYRENE	<1.0				

PAGE 7 of 19



Environmental
 LABORATORY SERVICES

FAX COPY

ALASKAN OIL INC.
 2020 LEMOYNE STREET
 P.O. BOX 69
 SYRACUSE NY 13211-
 ATTN: MR. SCOTT BLAKE

 P.O. #
 CLIENT JOB NUMBER: 639.013

PROJECT #: 997585
 RECEIVED: 9/14/01

 Rts 81/342
 Watertown NY

TEST PERFORMED	RESULTS	UNITS	DATE PERFORMED	METHOD NUMBER	PERFORMED BY
SAMPLE #: 185578		CLIENT SAMPLE ID: TW-4		DATE SAMPLED: 9/13/01	
VOL. ORGANICS - EPA 8021 W/MTBE		UG/L	9/16/01	EPA 8021	SKW
TOLUENE	<1.0				
TRICHLOROETHENE	<1.0				
TRICHLOROFLUOROMETHANE	<1.0				
1,1,1,2-TETRACHLOROETHANE	<1.0				
1,1,2,2-TETRACHLOROETHANE	<1.0				
TETRACHLOROETHENE	<1.0				
1,2,3-TRICHLOROBENZENE	<1.0				
1,2,4-TRICHLOROBENZENE	<1.0				
1,1,2-TRICHLOROETHANE	<1.0				
1,2,3-TRICHLOROPROPANE	<1.0				
1,2,4-TRIMETHYLBENZENE	<1.0				
1,3,5-TRIMETHYLBENZENE *	<1.0				
1,1,1-TRICHLOROETHANE	<1.0				
VINYL CHLORIDE	<1.0				
TOTAL XYLENES	<1.0				

* COMPOUND CO-ELUTES. RESULT IS CALCULATED AS A COMBINED STANDARD.

SAMPLE #: 185579		CLIENT SAMPLE ID: TW-5		DATE SAMPLED: 9/13/01	
VOL. ORGANICS - EPA 8021 W/MTBE		UG/L	9/15/01	EPA 8021	SKW
BENZENE	<0.7				
BROMOBENZENE	<1.0				
BROMOCHLOROMETHANE	<1.0				
BROMODICHLOROMETHANE	<1.0				
BROMOFORM	<1.0				
BROMOMETHANE	<1.0				
N-BUTYLBENZENE	<1.0				
SEC-BUTYLBENZENE	<1.0				
TERT-BUTYLBENZENE	<1.0				
CARBON TETRACHLORIDE	<1.0				
CHLOROBENZENE	<1.0				
CHLOROETHANE	<1.0				
CHLOROFORM	<1.0				
CHLOROMETHANE	<1.0				



FAX COPY

ALASKAN OIL INC.
 2020 LEMOYNE STREET
 P.O. BOX 69
 SYRACUSE NY 13211-
 ATTN: MR. SCOTT BLAKE
 P.O. #
 CLIENT JOB NUMBER: 639.013

PROJECT #: 997585
 RECEIVED: 9/14/01
 Rts 81/342
 Watertown NY

TEST PERFORMED	RESULTS	UNITS	DATE PERFORMED	METHOD NUMBER	PERFORMED BY
SAMPLE #: 185579	CLIENT SAMPLE ID: TW-5			DATE SAMPLED: 9/13/01	
VOL. ORGANICS - EPA 8021 W/MTBE		UG/L	9/15/01	EPA 8021	SKW
2-CHLOROTOLUENE	<1.0				
4-CHLOROTOLUENE	<1.0				
CUMENE (ISOPROPYLBENZENE)	<1.0				
CYMENE (4-ISOPROPYLTOLUENE)	<1.0				
CIS-1,3-DICHLOROPROPENE	<1.0				
DIBROMOCHLOROMETHANE	<1.0				
1,2-DIBROMO-3-CHLOROPROPANE	<1.0				
DIBROMOMETHANE	<1.0				
1,2-DICHLOROBENZENE	<1.0				
1,3-DICHLOROBENZENE	<1.0				
1,4-DICHLOROBENZENE	<1.0				
DICHLORODIFLUOROMETHANE	<1.0				
1,2-DIBROMOETHANE	<1.0				
CIS-1,2-DICHLOROETHENE	<1.0				
1,1-DICHLOROETHANE	<1.0				
1,2-DICHLOROETHANE	<1.0				
1,1-DICHLOROETHENE	<1.0				
TRANS-1,2-DICHLOROETHENE	<1.0				
1,2-DICHLOROPROPANE	<1.0				
1,3-DICHLOROPROPANE	<1.0				
2,2-DICHLOROPROPANE *	<1.0				
1,1-DICHLOROPROPENE	<1.0				
TRANS-1,3-DICHLOROPROPENE	<1.0				
ETHYLBENZENE	<1.0				
HEXACHLOROBUTADIENE	<1.0				
METHYLENE CHLORIDE	<1.0				
MTBE	16.3				
NAPHTHALENE	<1.0				
N-PROPYLBENZENE	<1.0				
STYRENE	<1.0				
TOLUENE	<1.0				
TRICHLOROETHENE	<1.0				
TRICHLOROFLUOROMETHANE	<1.0				
1,1,1,2-TETRACHLOROETHANE	<1.0				
1,1,2,2-TETRACHLOROETHANE	<1.0				

PAGE 9 of 19



Environmental
 LABORATORY SERVICES

FAX COPY

ALASKAN OIL INC.
 2020 LEMOYNE STREET
 P.O. BOX 69
 SYRACUSE NY 13211-
 ATTN: MR. SCOTT BLAKE
 P.O. #
 CLIENT JOB NUMBER: 639.013

PROJECT #: 997585
 RECEIVED: 9/14/01
 Rts 81/342
 Watertown NY

TEST PERFORMED	RESULTS	UNITS	DATE PERFORMED	METHOD NUMBER	PERFORMED BY
SAMPLE #: 185579	CLIENT SAMPLE ID: TW-5			DATE SAMPLED: 9/13/01	
VOL. ORGANICS - EPA 8021 W/MTBE		UG/L	9/15/01	EPA 8021	SKW
TETRACHLOROETHENE	<1.0				
1,2,3-TRICHLOROBENZENE	<1.0				
1,2,4-TRICHLOROBENZENE	<1.0				
1,1,2-TRICHLOROETHANE	<1.0				
1,2,3-TRICHLOROPROPANE	<1.0				
1,2,4-TRIMETHYLBENZENE	<1.0				
1,3,5-TRIMETHYLBENZENE *	<1.0				
1,1,1-TRICHLOROETHANE	<1.0				
VINYL CHLORIDE	<1.0				
TOTAL XYLENES	<1.0				

* COMPOUND CO-ELUTES. RESULT IS CALCULATED AS A COMBINED STANDARD.

SAMPLE #: 185580	CLIENT SAMPLE ID: TW-6			DATE SAMPLED: 9/13/01	
VOL. ORGANICS - EPA 8021 W/MTBE		UG/L	9/15/01	EPA 8021	SKW
BENZENE	<0.7				
BROMOBENZENE	<1.0				
BROMOCHLOROMETHANE	<1.0				
BROMODICHLOROMETHANE	<1.0				
BROMOFORM	<1.0				
BROMOMETHANE	<1.0				
N-BUTYLBENZENE	<1.0				
SEC-BUTYLBENZENE	<1.0				
TERT-BUTYLBENZENE	<1.0				
CARBON TETRACHLORIDE	<1.0				
CHLOROBENZENE	<1.0				
CHLOROETHANE	<1.0				
CHLOROFORM	<1.0				
CHLOROMETHANE	<1.0				
2-CHLOROTOLUENE	<1.0				
4-CHLOROTOLUENE	<1.0				
CUMENE (ISOPROPYLBENZENE)	<1.0				
CYMENE (4-ISOPROPYLTOLUENE)	<1.0				
CIS-1,3-DICHLOROPROPENE	<1.0				



FAX COPY

ALASKAN OIL INC.
 2020 LEMOYNE STREET
 P.O. BOX 69
 SYRACUSE NY 13211-
 ATTN: MR. SCOTT BLAKE

 P.O. #
 CLIENT JOB NUMBER: 639.013

PROJECT #: 997585
 RECEIVED: 9/14/01

 Rts 81/342
 Watertown NY

TEST PERFORMED	RESULTS	UNITS	DATE PERFORMED	METHOD NUMBER	PERFORMED BY
SAMPLE #: 185580 CLIENT SAMPLE ID: TW-6			DATE SAMPLED: 9/13/01		
VOL. ORGANICS - EPA 8021 W/MTBE		UG/L	9/15/01	EPA 8021	SKW
DIBROMOCHLOROMETHANE	<1.0				
1,2-DIBROMO-3-CHLOROPROPANE	<1.0				
DIBROMOMETHANE	<1.0				
1,2-DICHLOROBENZENE	<1.0				
1,3-DICHLOROBENZENE	<1.0				
1,4-DICHLOROBENZENE	<1.0				
DICHLORODIFLUOROMETHANE	<1.0				
1,2-DIBROMOETHANE	<1.0				
CIS-1,2-DICHLOROETHENE	<1.0				
1,1-DICHLOROETHANE	<1.0				
1,2-DICHLOROETHANE	<1.0				
1,1-DICHLOROETHENE	<1.0				
TRANS-1,2-DICHLOROETHENE	<1.0				
1,2-DICHLOROPROPANE	<1.0				
1,3-DICHLOROPROPANE	<1.0				
2,2-DICHLOROPROPANE *	<1.0				
1,1-DICHLOROPROPENE	<1.0				
TRANS-1,3-DICHLOROPROPENE	<1.0				
ETHYLBENZENE	<1.0				
HEXACHLOROBUTADIENE	<1.0				
METHYLENE CHLORIDE	<1.0				
MTBE	<1.0				
NAPHTHALENE	<1.0				
N-PROPYLBENZENE	<1.0				
STYRENE	<1.0				
TOLUENE	<1.0				
TRICHLOROETHENE	<1.0				
TRICHLOROFLUOROMETHANE	<1.0				
1,1,1,2-TETRACHLOROETHANE	<1.0				
1,1,2,2-TETRACHLOROETHANE	<1.0				
TETRACHLOROETHENE	<1.0				
1,2,3-TRICHLOROBENZENE	<1.0				
1,2,4-TRICHLOROBENZENE	<1.0				
1,1,2-TRICHLOROETHANE	<1.0				
1,2,3-TRICHLOROPROPANE	<1.0				



FAX COPY

ALASKAN OIL INC.
 2020 LEMOYNE STREET
 P.O. BOX 69
 SYRACUSE NY 13211-
 ATTN: MR. SCOTT BLAKE
 P.O. #
 CLIENT JOB NUMBER: 639.013

PROJECT #: 997585
 RECEIVED: 9/14/01
 Rts 81/342
 Watertown NY

TEST PERFORMED	RESULTS	UNITS	DATE PERFORMED	METHOD NUMBER	PERFORMED BY
SAMPLE #: 185580 CLIENT SAMPLE ID: TW-6				DATE SAMPLED: 9/13/01	
VOL. ORGANICS - EPA 8021 W/MTBE		UG/L	9/15/01	EPA 8021	SKW
1,2,4-TRIMETHYLBENZENE	<1.0				
1,3,5-TRIMETHYLBENZENE *	<1.0				
1,1,1-TRICHLOROETHANE	<1.0				
VINYL CHLORIDE	<1.0				
TOTAL XYLENES	<1.0				
* COMPOUND CO-ELUTES. RESULT IS CALCULATED AS A COMBINED STANDARD.					
SAMPLE #: 185581 CLIENT SAMPLE ID: MW-1				DATE SAMPLED: 9/13/01	
VOL. ORGANICS - EPA 8021 W/MTBE		UG/L	9/15/01	EPA 8021	SKW
BENZENE	<0.7				
BROMOBENZENE	<1.0				
BROMOCHLOROMETHANE	<1.0				
BROMODICHLOROMETHANE	<1.0				
BROMOFORM	<1.0				
BROMOMETHANE	<1.0				
N-BUTYLBENZENE	<1.0				
SEC-BUTYLBENZENE	<1.0				
TERT-BUTYLBENZENE	<1.0				
CARBON TETRACHLORIDE	<1.0				
CHLOROBENZENE	<1.0				
CHLOROETHANE	<1.0				
CHLOROFORM	<1.0				
CHLOROMETHANE	<1.0				
2-CHLOROTOLUENE	<1.0				
4-CHLOROTOLUENE	<1.0				
CUMENE (ISOPROPYLBENZENE)	<1.0				
CYMENE (4-ISOPROPYLTOLUENE)	<1.0				
CIS-1,3-DICHLOROPROPENE	<1.0				
DIBROMOCHLOROMETHANE	<1.0				
1,2-DIBROMO-3-CHLOROPROPANE	<1.0				
DIBROMOMETHANE	<1.0				
1,2-DICHLOROBENZENE	<1.0				
1,3-DICHLOROBENZENE	<1.0				



FAX COPY

ALASKAN OIL INC.
 2020 LEMOYNE STREET
 P.O. BOX 69
 SYRACUSE NY 13211-
 ATTN: MR. SCOTT BLAKE

PROJECT #: 997585
 RECEIVED: 9/14/01
 Rts 81/342
 Watertown NY

P.O. #
 CLIENT JOB NUMBER: 639.013

TEST PERFORMED	RESULTS	UNITS	DATE PERFORMED	METHOD NUMBER	PERFORMED BY
SAMPLE #: 185581	CLIENT SAMPLE ID: MW-1			DATE SAMPLED: 9/13/01	
VOL. ORGANICS - EPA 8021 W/MTBE		UG/L	9/15/01	EPA 8021	SKW
1,4-DICHLOROENZENE	<1.0				
DICHLORODIFLUOROMETHANE	<1.0				
1,2-DIBROMOETHANE	<1.0				
CIS-1,2-DICHLOROETHENE	<1.0				
1,1-DICHLOROETHANE	<1.0				
1,2-DICHLOROETHANE	<1.0				
1,1-DICHLOROETHENE	<1.0				
TRANS-1,2-DICHLOROETHENE	<1.0				
1,2-DICHLOROPROPANE	<1.0				
1,3-DICHLOROPROPANE	<1.0				
2,2-DICHLOROPROPANE *	<1.0				
1,1-DICHLOROPROPENE	<1.0				
TRANS-1,3-DICHLOROPROPENE	<1.0				
ETHYLBENZENE	<1.0				
HEXACHLOROBUTADIENE	<1.0				
METHYLENE CHLORIDE	<1.0				
MTBE	670				
NAPHTHALENE	<1.0				
N-PROPYLBENZENE	<1.0				
STYRENE	<1.0				
TOLUENE	<1.0				
TRICHLOROETHENE	<1.0				
TRICHLOROFUOROMETHANE	<1.0				
1,1,1,2-TETRACHLOROETHANE	<1.0				
1,1,2,2-TETRACHLOROETHANE	<1.0				
TETRACHLOROETHENE	<1.0				
1,2,3-TRICHLOROENZENE	<1.0				
1,2,4-TRICHLOROENZENE	<1.0				
1,1,2-TRICHLOROETHANE	<1.0				
1,2,3-TRICHLOROPROPANE	<1.0				
1,2,4-TRIMETHYLBENZENE	<1.0				
1,3,5-TRIMETHYLBENZENE *	<1.0				
1,1,1-TRICHLOROETHANE	<1.0				
VINYL CHLORIDE	<1.0				
TOTAL XYLENES	<1.0				



FAX COPY

ALASKAN OIL INC.
 2020 LEMOYNE STREET
 P.O. BOX 69
 SYRACUSE NY 13211-
 ATTN: MR. SCOTT BLAKE

 P.O. #
 CLIENT JOB NUMBER: 639.013

PROJECT #: 997585
 RECEIVED: 9/14/01

 Rts 81/342
 Watertown NY

TEST PERFORMED	RESULTS	UNITS	DATE PERFORMED	METHOD NUMBER	PERFORMED BY
SAMPLE #: 185581	CLIENT SAMPLE ID: MW-1			DATE SAMPLED: 9/13/01	
VOL. ORGANICS - EPA 8021 W/MTBE		UG/L	9/15/01	EPA 8021	SKW
* COMPOUND CO-ELUTES. RESULT IS CALCULATED AS A COMBINED STANDARD.					

TEST PERFORMED	RESULTS	UNITS	DATE PERFORMED	METHOD NUMBER	PERFORMED BY
SAMPLE #: 185582	CLIENT SAMPLE ID: MW-4			DATE SAMPLED: 9/13/01	
VOL. ORGANICS - EPA 8021 W/MTBE		UG/L	9/15/01	EPA 8021	SKW
BENZENE	<0.7				
BROMOBENZENE	<1.0				
BROMOCHLOROMETHANE	<1.0				
BROMODICHLOROMETHANE	<1.0				
BROMOFORM	<1.0				
BROMOMETHANE	<1.0				
N-BUTYLBENZENE	<1.0				
SEC-BUTYLBENZENE	<1.0				
TERT-BUTYLBENZENE	<1.0				
CARBON TETRACHLORIDE	<1.0				
CHLOROBENZENE	<1.0				
CHLOROETHANE	<1.0				
CHLOROFORM	<1.0				
CHLOROMETHANE	<1.0				
2-CHLOROTOLUENE	<1.0				
4-CHLOROTOLUENE	<1.0				
CUMENE (ISOPROPYLBENZENE)	<1.0				
CYMENE (4-ISOPROPYLTOLUENE)	<1.0				
CIS-1,3-DICHLOROPROPENE	<1.0				
DIBROMOCHLOROMETHANE	<1.0				
1,2-DIBROMO-3-CHLOROPROPANE	<1.0				
DIBROMOMETHANE	<1.0				
1,2-DICHLOROENZENE	<1.0				
1,3-DICHLOROENZENE	<1.0				
1,4-DICHLOROENZENE	<1.0				
DICHLORODIFLUOROMETHANE	<1.0				
1,2-DIBROMOETHANE	<1.0				
CIS-1,2-DICHLOROETHENE	<1.0				
1,1-DICHLOROETHANE	<1.0				



FAX COPY

ALASKAN OIL INC.
 2020 LEMOYNE STREET
 P.O. BOX 69
 SYRACUSE NY 13211-
 ATTN: MR. SCOTT BLAKE
 P.O. #
 CLIENT JOB NUMBER: 639.013

PROJECT #: 997585
 RECEIVED: 9/14/01
 Rts 81/342
 Watertown NY

TEST PERFORMED	RESULTS	UNITS	DATE PERFORMED	METHOD NUMBER	PERFORMED BY
SAMPLE #: 185582 CLIENT SAMPLE ID: MW-4			DATE SAMPLED: 9/13/01		
VOL. ORGANICS - EPA 8021 W/MTBE		UG/L	9/15/01	EPA 8021	SKW
1,2-DICHLOROETHANE	<1.0				
1,1-DICHLOROETHENE	<1.0				
TRANS-1,2-DICHLOROETHENE	<1.0				
1,2-DICHLOROPROPANE	<1.0				
1,3-DICHLOROPROPANE	<1.0				
2,2-DICHLOROPROPANE *	<1.0				
1,1-DICHLOROPROPENE	<1.0				
TRANS-1,3-DICHLOROPROPENE	<1.0				
ETHYLBENZENE	<1.0				
HEXACHLOROBUTADIENE	<1.0				
METHYLENE CHLORIDE	<1.0				
MTBE	396				
NAPHTHALENE	<1.0				
N-PROPYLBENZENE	<1.0				
STYRENE	<1.0				
TOLUENE	<1.0				
TRICHLOROETHENE	<1.0				
TRICHLOROFLUOROMETHANE	<1.0				
1,1,1,2-TETRACHLOROETHANE	<1.0				
1,1,2,2-TETRACHLOROETHANE	<1.0				
TETRACHLOROETHENE	<1.0				
1,2,3-TRICHLOROBENZENE	<1.0				
1,2,4-TRICHLOROBENZENE	<1.0				
1,1,2-TRICHLOROETHANE	<1.0				
1,2,3-TRICHLOROPROPANE	<1.0				
1,2,4-TRIMETHYLBENZENE	<1.0				
1,3,5-TRIMETHYLBENZENE *	<1.0				
1,1,1-TRICHLOROETHANE	<1.0				
VINYL CHLORIDE	<1.0				
TOTAL XYLENES	<1.0				

* COMPOUND CO-ELUTES. RESULT IS CALCULATED AS A COMBINED STANDARD.

SAMPLE #: 185583 CLIENT SAMPLE ID: MW-5

DATE SAMPLED: 9/13/01



FAX COPY

ALASKAN OIL INC.
 2020 LEMOYNE STREET
 P.O. BOX 69
 SYRACUSE NY 13211-
 ATTN: MR. SCOTT BLAKE

 P.O. #
 CLIENT JOB NUMBER: 639.013

PROJECT #: 997585
 RECEIVED: 9/14/01

 Rts 81/342
 Watertown NY

TEST PERFORMED	RESULTS	UNITS	DATE PERFORMED	METHOD NUMBER	PERFORMED BY
SAMPLE #: 185583 CLIENT SAMPLE ID: MW-5			DATE SAMPLED: 9/13/01		
VOL. ORGANICS - EPA 8021 W/MTBE		UG/L	9/15/01	EPA 8021	SKW
BENZENE	<0.7				
BROMOBENZENE	<1.0				
BROMOCHLOROMETHANE	<1.0				
BROMODICHLOROMETHANE	<1.0				
BROMOFORM	<1.0				
BROMOMETHANE	<1.0				
N-BUTYLBENZENE	<1.0				
SEC-BUTYLBENZENE	<1.0				
TERT-BUTYLBENZENE	<1.0				
CARBON TETRACHLORIDE	<1.0				
CHLORO BENZENE	<1.0				
CHLOROETHANE	<1.0				
CHLOROFORM	<1.0				
CHLOROMETHANE	<1.0				
2-CHLOROTOLUENE	<1.0				
4-CHLOROTOLUENE	<1.0				
CUMENE (ISOPROPYLBENZENE)	<1.0				
CYMENE (4-ISOPROPYLTOLUENE)	<1.0				
CIS-1,3-DICHLOROPROPENE	<1.0				
DIBROMOCHLOROMETHANE	<1.0				
1,2-DIBROMO-3-CHLOROPROPANE	<1.0				
DIBROMOMETHANE	<1.0				
1,2-DICHLORO BENZENE	<1.0				
1,3-DICHLORO BENZENE	<1.0				
1,4-DICHLORO BENZENE	<1.0				
DICHLORODIFLUOROMETHANE	<1.0				
1,2-DIBROMOETHANE	<1.0				
CIS-1,2-DICHLOROETHENE	<1.0				
1,1-DICHLOROETHANE	<1.0				
1,2-DICHLOROETHANE	<1.0				
1,1-DICHLOROETHENE	<1.0				
TRANS-1,2-DICHLOROETHENE	<1.0				
1,2-DICHLOROPROPANE	<1.0				
1,3-DICHLOROPROPANE	<1.0				
2,2-DICHLOROPROPANE *	<1.0				



FAX COPY

ALASKAN OIL INC.
 2020 LEMOYNE STREET
 P.O. BOX 69
 SYRACUSE NY 13211-
 ATTN: MR. SCOTT BLAKE

 P.O. #
 CLIENT JOB NUMBER: 639.013

PROJECT #: 997585
 RECEIVED: 9/14/01

 Rts 81/342
 Watertown NY

TEST PERFORMED	RESULTS	UNITS	DATE PERFORMED	METHOD NUMBER	PERFORMED BY
SAMPLE #: 185583		CLIENT SAMPLE ID: MW-5		DATE SAMPLED: 9/13/01	
VOL. ORGANICS - EPA 8021 W/MTBE		UG/L	9/15/01	EPA 8021	SKW
1,1-DICHLOROPROPENE	<1.0				
TRANS-1,3-DICHLOROPROPENE	<1.0				
ETHYLBENZENE	<1.0				
HEXACHLOROBUTADIENE	<1.0				
METHYLENE CHLORIDE	<1.0				
MTBE	800				
NAPHTHALENE	<1.0				
N-PROPYLBENZENE	<1.0				
STYRENE	<1.0				
TOLUENE	<1.0				
TRICHLOROETHENE	<1.0				
TRICHLOROFLUOROMETHANE	<1.0				
1,1,1,2-TETRACHLOROETHANE	<1.0				
1,1,2,2-TETRACHLOROETHANE	<1.0				
TETRACHLOROETHENE	<1.0				
1,2,3-TRICHLOROBENZENE	<1.0				
1,2,4-TRICHLOROBENZENE	<1.0				
1,1,2-TRICHLOROETHANE	<1.0				
1,2,3-TRICHLOROPROPANE	<1.0				
1,2,4-TRIMETHYLBENZENE	<1.0				
1,3,5-TRIMETHYLBENZENE *	<1.0				
1,1,1-TRICHLOROETHANE	<1.0				
VINYL CHLORIDE	<1.0				
TOTAL XYLENES	<1.0				

* COMPOUND CO-ELUTES. RESULT IS CALCULATED AS A COMBINED STANDARD.

SAMPLE #: 185584		CLIENT SAMPLE ID: TRIP BLANK		DATE SAMPLED:	
VOL. ORGANICS - EPA 8021 W/MTBE		UG/L	9/15/01	EPA 8021	SKW
BENZENE	<0.7				
BROMOBENZENE	<1.0				
BROMOCHLOROMETHANE	<1.0				
BROMODICHLOROMETHANE	<1.0				
BROMOFORM	<1.0				



FAX COPY

ALASKAN OIL INC.
 2020 LEMOYNE STREET
 P.O. BOX 69
 SYRACUSE NY 13211-
 ATTN: MR. SCOTT BLAKE

PROJECT #: 997585
 RECEIVED: 9/14/01
 Rts 81/342
 Watertown NY

P.O. #
 CLIENT JOB NUMBER: 639.013

TEST PERFORMED	RESULTS	UNITS	DATE PERFORMED	METHOD NUMBER	PERFORMED BY
SAMPLE #: 185584 CLIENT SAMPLE ID: TRIP BLANK			DATE SAMPLED:		
VOL. ORGANICS - EPA 8021 W/MTBE		UG/L	9/15/01	EPA 8021	SKW
BROMOMETHANE	<1.0				
N-BUTYLBENZENE	<1.0				
SEC-BUTYLBENZENE	<1.0				
TERT-BUTYLBENZENE	<1.0				
CARBON TETRACHLORIDE	<1.0				
CHLOROENZENE	<1.0				
CHLOROETHANE	<1.0				
CHLOROFORM	<1.0				
CHLOROMETHANE	<1.0				
2-CHLOROTOLUENE	<1.0				
4-CHLOROTOLUENE	<1.0				
CUMENE (ISOPROPYLBENZENE)	<1.0				
CYMENE (4-ISOPROPYLTOLUENE)	<1.0				
CIS-1,3-DICHLOROPROPENE	<1.0				
DIBROMOCHLOROMETHANE	<1.0				
1,2-DIBROMO-3-CHLOROPROPANE	<1.0				
DIBROMOMETHANE	<1.0				
1,2-DICHLOROBENZENE	<1.0				
1,3-DICHLOROBENZENE	<1.0				
1,4-DICHLOROBENZENE	<1.0				
DICHLORODIFLUOROMETHANE	<1.0				
1,2-DIBROMOETHANE	<1.0				
CIS-1,2-DICHLOROETHENE	<1.0				
1,1-DICHLOROETHANE	<1.0				
1,2-DICHLOROETHANE	<1.0				
1,1-DICHLOROETHENE	<1.0				
TRANS-1,2-DICHLOROETHENE	<1.0				
1,2-DICHLOROPROPANE	<1.0				
1,3-DICHLOROPROPANE	<1.0				
2,2-DICHLOROPROPANE *	<1.0				
1,1-DICHLOROPROPENE	<1.0				
TRANS-1,3-DICHLOROPROPENE	<1.0				
ETHYLBENZENE	<1.0				
HEXACHLOROBUTADIENE	<1.0				
METHYLENE CHLORIDE	<1.0				



FAX COPY

ALASKAN OIL INC.
 2020 LEMOYNE STREET
 P.O. BOX 69
 SYRACUSE NY 13211-
 ATTN: MR. SCOTT BLAKE

PROJECT #: 997585
 RECEIVED: 9/14/01
 Rts 81/342
 Watertown NY

P.O. #
 CLIENT JOB NUMBER: 639.013

TEST PERFORMED	RESULTS	UNITS	DATE PERFORMED	METHOD NUMBER	PERFORMED BY
SAMPLE #: 185584 CLIENT SAMPLE ID: TRIP BLANK			DATE SAMPLED:		
VOL. ORGANICS - EPA 8021 W/MTBE		UG/L	9/15/01	EPA 8021	SKW
MTBE	<1.0				
NAPHTHALENE	<1.0				
N-PROPYLBENZENE	<1.0				
STYRENE	<1.0				
TOLUENE	<1.0				
TRICHLOROETHENE	<1.0				
TRICHLOROFLUOROMETHANE	<1.0				
1,1,1,2-TETRACHLOROETHANE	<1.0				
1,1,2,2-TETRACHLOROETHANE	<1.0				
TETRACHLOROETHENE	<1.0				
1,2,3-TRICHLOROBENZENE	<1.0				
1,2,4-TRICHLOROBENZENE	<1.0				
1,1,2-TRICHLOROETHANE	<1.0				
1,2,3-TRICHLOROPROPANE	<1.0				
1,2,4-TRIMETHYLBENZENE	<1.0				
1,3,5-TRIMETHYLBENZENE *	<1.0				
1,1,1-TRICHLOROETHANE	<1.0				
VINYL CHLORIDE	<1.0				
TOTAL XYLENES	<1.0				

* COMPOUND CO-ELUTES. RESULT IS CALCULATED AS A COMBINED STANDARD.

Faxed Copy *
 Laboratory Director

09/18/2001
 Date

All tests performed under NYS ELAP laboratory certification # 11375 unless otherwise stated.

*





Environmental

LABORATORY SERVICES

7280 Carwell Street, Hancock Air Park, North Syracuse, NY 13212
 (315) 458-8033, FAX (315) 458-0249, (800) 842-4667

Certified in:
 * Connecticut
 * Delaware
 * Maryland
 * Massachusetts
 * New Hampshire
 * New Jersey
 * New York
 * Pennsylvania
 * Rhode Island

Attn: Dave Honey 451-0052

FAX COPY

ALASKAN OIL INC.
 2020 LEMOYNE STREET
 P.O. BOX 69
 SYRACUSE
 ATTN: MR. SCOTT BLAKE

PROJECT #: 997737
 RECEIVED: 10/4/01

NY 13211-

P.O. #

CLIENT JOB NUMBER: Watertown 342+81

TEST PERFORMED	RESULTS	UNITS	DATE PERFORMED	METHOD NUMBER	PERFORMED BY
SAMPLE #: 186924	CLIENT SAMPLE ID: MW-6			DATE SAMPLED: 10/03/01	
VOL. ORGANICS - EPA 8021 W/MTBE		UG/L	10/11/01	EPA 8021	SKW
1,1,1-TRICHLOROETHANE	<1.0				
1,3,5-TRIMETHYLBENZENE *	<1.0				
1,2,4-TRIMETHYLBENZENE	<1.0				
1,2,3-TRICHLOROPROPANE	<1.0				
1,1,2-TRICHLOROETHANE	<1.0				
1,2,4-TRICHLOROBENZENE	<1.0				
1,2,3-TRICHLOROBENZENE	<1.0				
TETRACHLOROETHENE	<1.0				
1,1,2,2-TETRACHLOROETHANE	<1.0				
1,1,1,2-TETRACHLOROETHANE	<1.0				
TRICHLOROFLUOROMETHANE	<1.0				
TRICHLOROETHENE	<1.0				
TOLUENE	<1.0				
STYRENE	<1.0				
N-PROPYLBENZENE	<1.0				
NAPHTHALENE	<1.0				
MTBE	7.5				
METHYLENE CHLORIDE	<1.0				
HEXACHLOROBUTADIENE	<1.0				
ETHYLBENZENE	<1.0				
TRANS-1,3-DICHLOROPROPENE	<1.0				
1,1-DICHLOROPROPENE	<1.0				
2,2-DICHLOROPROPANE *	<1.0				
1,3-DICHLOROPROPANE	<1.0				
1,2-DICHLOROPROPANE	<1.0				
TRANS-1,2-DICHLOROETHENE	<1.0				

PAGE 1 of 12

Your Full-Service Analytical Laboratory

FAX COPY

ALASKAN OIL INC.
2020 LEMOYNE STREET
P.O. BOX 69
SYRACUSE
ATTN: MR. SCOTT BLAKE

NY 13211-

PROJECT #: 997737

RECEIVED: 10/4/01

P.O. #

CLIENT JOB NUMBER:

TEST PERFORMED	RESULTS	UNITS	DATE PERFORMED	METHOD NUMBER	PERFORMED BY
SAMPLE # 186924	CLIENT SAMPLE ID: MW-6				DATE SAMPLED: 10/03/01
VOL. ORGANICS - EPA 8021 W/MTBE		UG/L	10/11/01	EPA 8021	SKW
1,1-DICHLOROETHENE	<1.0				
1,2-DICHLOROETHANE	<1.0				
1,1-DICHLOROETHANE	<1.0				
CIS-1,2-DICHLOROETHENE	<1.0				
1,2-DIBROMOETHANE	<1.0				
DICHLORODIFLUOROMETHANE	<1.0				
1,4-DICHLOROBENZENE	<1.0				
1,3-DICHLOROBENZENE	<1.0				
1,2-DICHLOROBENZENE	<1.0				
DIBROMOMETHANE	<1.0				
1,2-DIBROMO-3-CHLOROPROPANE	<1.0				
DIBROMOCHLOROMETHANE	<1.0				
CIS-1,3-DICHLOROPROPENE	<1.0				
CYMENE (4-ISOPROPYLTOLUENE)	<1.0				
CUMENE (ISOPROPYLBENZENE)	<1.0				
4-CHLOROTOLUENE	<1.0				
2-CHLOROTOLUENE	<1.0				
CHLOROMETHANE	<1.0				
CHLOROFORM	<1.0				
CHLOROETHANE	<1.0				
CHLOROBENZENE	<1.0				
CARBON TETRACHLORIDE	<1.0				
TERT-BUTYLBENZENE	<1.0				
SEC-BUTYLBENZENE	<1.0				
N-BUTYLBENZENE	<1.0				
BROMOMETHANE	<1.0				
BROMOFORM	<1.0				
BROMODICHLOROMETHANE	<1.0				
BROMOCHLOROMETHANE	<1.0				
BROMOBENZENE	<1.0				
BENZENE	<0.7				
VINYL CHLORIDE	<1.0				
TOTAL XYLENES	<1.0				

* COMPOUND CO-ELUTES. RESULT IS CALCULATED AS A COMBINED STANDARD.

PAGE 2 of 12



Environmental
LABORATORY SERVICES

FAX COPY

ALASKAN OIL INC.
2020 LEMOYNE STREET
P.O. BOX 69
SYRACUSE NY 13211-
ATTN: MR. SCOTT BLAKE

PROJECT #: 997737
RECEIVED: 10/4/01

P.O. #
CLIENT JOB NUMBER:

TEST PERFORMED	RESULTS	UNITS	DATE PERFORMED	METHOD NUMBER	PERFORMED BY
SAMPLE #: 186925		CLIENT SAMPLE ID: TW-7		DATE SAMPLED: 10/03/01	
VOL ORGANICS - EPA 8021 W/MTBE		UG/L	10/11/01	EPA 8021	SKW
BENZENE	<0.7				
BROMOBENZENE	<1.0				
BROMOCHLOROMETHANE	<1.0				
BROMODICHLOROMETHANE	<1.0				
BROMOFORM	<1.0				
BROMOMETHANE	<1.0				
N-BUTYLBENZENE	<1.0				
SEC-BUTYLBENZENE	<1.0				
TERT-BUTYLBENZENE	<1.0				
CARBON TETRACHLORIDE	<1.0				
CHLOROBENZENE	<1.0				
CHLOROETHANE	<1.0				
CHLOROFORM	<1.0				
CHLOROMETHANE	<1.0				
2-CHLOROTOLUENE	<1.0				
4-CHLOROTOLUENE	<1.0				
CUMENE (ISOPROPYLBENZENE)	<1.0				
CYMENE (4-ISOPROPYLTOLUENE)	<1.0				
CIS-1,3-DICHLOROPROPENE	<1.0				
DIBROMOCHLOROMETHANE	<1.0				
1,2-DIBROMO 3-CHLOROPROPANE	<1.0				
DIBROMOMETHANE	<1.0				
1,2-DICHLOROBENZENE	<1.0				
1,3-DICHLOROBENZENE	<1.0				
1,4-DICHLOROBENZENE	<1.0				
DICHLORODIFLUOROMETHANE	<1.0				
1,2-DIBROMOETHANE	<1.0				
CIS-1,2-DICHLOROETHENE	<1.0				
1,1-DICHLOROETHANE	<1.0				
1,2-DICHLOROETHANE	<1.0				
1,1-DICHLOROETHENE	<1.0				
TRANS-1,2-DICHLOROETHENE	<1.0				
1,2-DICHLOROPROPANE	<1.0				
1,3-DICHLOROPROPANE	<1.0				

PAGE 3 of 12



Environmental
LABORATORY SERVICES

FAX COPY

ALASKAN OIL INC.
2020 LEMOYNE STREET
P.O. BOX 69
SYRACUSE
ATTN: MR. SCOTT BLAKE

NY 13211-

PROJECT #: 997737
RECEIVED: 10/4/01

P.O. #
CLIENT JOB NUMBER:

TEST PERFORMED	RESULTS	UNITS	DATE PERFORMED	METHOD NUMBER	PERFORMED BY
SAMPLE #: 186926	CLIENT SAMPLE ID: TW-7			DATE SAMPLED: 10/03/01	
VOL. ORGANICS - EPA 8021 W/MTBE		UG/L	10/11/01	EPA 8021	SKW
2,2-DICHLOROPROPANE *	<1.0				
1,1-DICHLOROPROPENE	<1.0				
TRANS-1,3-DICHLOROPROPENE	<1.0				
ETHYLBENZENE	<1.0				
HEXACHLOROBUTADIENE	<1.0				
METHYLENE CHLORIDE	<1.0				
MTBE	16.7				
NAPHTHALENE	<1.0				
N-PROPYLBENZENE	<1.0				
STYRENE	<1.0				
TOLUENE	<1.0				
TRICHLOROETHENE	<1.0				
TRICHLOROFLUOROMETHANE	<1.0				
1,1,1,2-TETRACHLOROETHANE	<1.0				
1,1,2,2-TETRACHLOROETHANE	<1.0				
TETRACHLOROETHENE	<1.0				
1,2,3-TRICHLOROBENZENE	<1.0				
1,2,4-TRICHLOROBENZENE	<1.0				
1,1,2-TRICHLOROETHANE	<1.0				
1,2,3-TRICHLOROPROPANE	<1.0				
1,2,4-TRIMETHYLBENZENE	<1.0				
1,3,5-TRIMETHYLBENZENE *	<1.0				
1,1,1-TRICHLOROETHANE	<1.0				
VINYL CHLORIDE	<1.0				
TOTAL XYLENES	<1.0				

* COMPOUND CO-ELUTES. RESULT IS CALCULATED AS A COMBINED STANDARD.

SAMPLE #: 186926	CLIENT SAMPLE ID: TW-8			DATE SAMPLED: 10/03/01	
VOL. ORGANICS - EPA 8021 W/MTBE		UG/L	10/11/01	EPA 8021	SKW
BENZENE	<0.7				
BROMOBENZENE	<1.0				
BROMOCHLOROMETHANE	<1.0				
BROMODICHLOROMETHANE	<1.0				

PAGE 4 of 12



Environmental
LABORATORY SERVICES

FAX COPY

ALASKAN OIL INC.
2020 LEMOYNE STREET
P.O. BOX 69
SYRACUSE NY 13211-
ATTN: MR. SCOTT BLAKE
P.O. #
CLIENT JOB NUMBER:

PROJECT #: 997737
RECEIVED: 10/4/01

TEST PERFORMED	RESULTS	UNITS	DATE PERFORMED	METHOD NUMBER	PERFORMED BY
SAMPLE #: 188926	CLIENT SAMPLE ID: TW-8				DATE SAMPLED: 10/03/01
VOL. ORGANICS - EPA 8021 W/MTBE		UG/L	10/11/01	HPA 8021	SKW
BROMOFORM	<1.0				
BROMOMETHANE	<1.0				
N-BUTYLBENZENE	<1.0				
SEC-BUTYLBENZENE	<1.0				
TERT-BUTYLBENZENE	<1.0				
CARBON TETRACHLORIDE	<1.0				
CHLORO BENZENE	<1.0				
CHLOROETHANE	<1.0				
CHLOROFORM	<1.0				
CHLOROMETHANE	<1.0				
2-CHLOROTOLUENE	<1.0				
4-CHLOROTOLUENE	<1.0				
CUMENE (ISOPROPYLBENZENE)	<1.0				
CYMENE (4-ISOPROPYLTOLUENE)	<1.0				
CIS-1,3-DICHLOROPROPENE	<1.0				
DIBROMOCHLOROMETHANE	<1.0				
1,2-DIBROMO-3-CHLOROPROPANE	<1.0				
DIBROMOMETHANE	<1.0				
1,2-DICHLOROBENZENE	<1.0				
1,3-DICHLOROBENZENE	<1.0				
1,4-DICHLOROBENZENE	<1.0				
DICHLORODIFLUOROMETHANE	<1.0				
1,2-DIBROMOETHANE	<1.0				
CIS-1,2-DICHLOROETHENE	<1.0				
1,1-DICHLOROETHANE	<1.0				
1,2-DICHLOROETHANE	<1.0				
1,1-DICHLOROETHENE	<1.0				
TRANS-1,2-DICHLOROETHENE	<1.0				
1,2-DICHLOROPROPANE	<1.0				
1,3-DICHLOROPROPANE	<1.0				
1,2-DICHLOROPROPANE	<1.0				
1,1-DICHLOROPROPENE	<1.0				
TRANS-1,3-DICHLOROPROPENE	<1.0				
ETHYLBENZENE	<1.0				
HEXACHLOROBUTADIENE	<1.0				



FAX COPY

ALASKAN OIL INC.
2020 LEMOYNE STREET
P.O. BOX 69
SYRACUSE
ATTN: MR. SCOTT BLAKE

NY 13211-

PROJECT #: 997737
RECEIVED: 10/4/01

P.O. #
CLIENT JOB NUMBER:

TEST PERFORMED	RESULTS	UNITS	DATE PERFORMED	METHOD NUMBER	PERFORMED BY
SAMPLE #: 185926	CLIENT SAMPLE ID: TW-8			DATE SAMPLED: 10/03/01	
VOL. ORGANICS - EPA 8021 W/MTBE		UG/L	10/11/01	EPA 8021	SKW
METHYLENE CHLORIDE	<1.0				
MTBE	<1.0				
NAPHTHALENE	<1.0				
N-PROPYLBENZENE	<1.0				
STYRENE	<1.0				
TOLUENE	<1.0				
TRICHLOROETHENE	<1.0				
TRICHLOROFLUOROMETHANE	<1.0				
1,1,1,2-TETRACHLOROETHANE	<1.0				
1,1,2,2-TETRACHLOROETHANE	<1.0				
TETRACHLOROETHENE	<1.0				
1,2,3-TRICHLOROBENZENE	<1.0				
1,2,4-TRICHLOROBENZENE	<1.0				
1,1,2-TRICHLOROETHANE	<1.0				
1,2,3-TRICHLOROPROPANE	<1.0				
1,2,4-TRIMETHYLBENZENE	<1.0				
1,3,5-TRIMETHYLBENZENE *	<1.0				
1,1,1-TRICHLOROETHANE	<1.0				
VINYL CHLORIDE	<1.0				
TOTAL XYLENES	<1.0				

* COMPOUND CO-ELUTES. RESULT IS CALCULATED AS A COMBINED STANDARD.

TEST PERFORMED	RESULTS	UNITS	DATE PERFORMED	METHOD NUMBER	PERFORMED BY
SAMPLE #: 185927	CLIENT SAMPLE ID: TW-9			DATE SAMPLED: 10/03/01	
VOL. ORGANICS - EPA 8021 W/MTBE		UG/L	10/11/01	EPA 8021	SKW
BENZENE	<0.7				
BROMOBENZENE	<1.0				
BROMOCHLOROMETHANE	<1.0				
BROMODICHLOROMETHANE	<1.0				
BROMOFORM	<1.0				
BROMOMETHANE	<1.0				
N-BUTYLBENZENE	<1.0				
SEC-BUTYLBENZENE	<1.0				
TERT-BUTYLBENZENE	<1.0				

PAGE 6 of 12



Environmental
LABORATORY SERVICES

FAX COPY

ALASKAN OIL INC.
2020 LEMOYNE STREET
P.O. BOX 69
SYRACUSE
ATTN: MR. SCOTT BLAKE

NY 13211-

PROJECT #: 997737

RECEIVED: 10/4/01

P.O. #

CLIENT JOB NUMBER:

TEST PERFORMED	RESULTS	UNITS	DATE PERFORMED	METHOD NUMBER	PERFORMED BY
SAMPLE #: 188927	CLIENT SAMPLE ID: TW-9			DATE SAMPLED: 10/03/01	
VOL. ORGANICS - EPA 8021 W/MTBE		UG/L	10/11/01	EPA 8021	SKW
CARBON TETRACHLORIDE	<1.0				
CHLORO BENZENE	<1.0				
CHLOROETHANE	<1.0				
CHLOROFORM	<1.0				
CHLOROMETHANE	<1.0				
2-CHLOROTOLUENE	<1.0				
4-CHLOROTOLUENE	<1.0				
CUMENE (ISOPROPYLBENZENE)	<1.0				
CYMENE (4-ISOPROPYLTOLUENE)	<1.0				
CIS-1,3-DICHLOROPROPENE	<1.0				
DIBROMOCHLOROMETHANE	<1.0				
1,2-DIBROMO-3-CHLOROPROPANE	<1.0				
DIBROMOMETHANE	<1.0				
1,2-DICHLOROBENZENE	<1.0				
1,3-DICHLOROBENZENE	<1.0				
1,4-DICHLOROBENZENE	<1.0				
DICHLORODIFLUOROMETHANE	<1.0				
1,2-DIBROMOETHANE	<1.0				
CIS-1,2-DICHLOROETHENE	<1.0				
1,1-DICHLOROETHANE	<1.0				
1,2-DICHLOROETHANE	<1.0				
1,1-DICHLOROETHENE	<1.0				
TRANS-1,2-DICHLOROETHENE	<1.0				
1,2-DICHLOROPROPANE	<1.0				
1,3-DICHLOROPROPANE	<1.0				
2,2-DICHLOROPROPANE *	<1.0				
1,1-DICHLOROPROPENE	<1.0				
TRANS-1,3-DICHLOROPROPENE	<1.0				
BETHYLBENZENE	<1.0				
HEXACHLOROBUTADIENE	<1.0				
METHYLENE CHLORIDE	<1.0				
MTBE	<1.0				
NAPHTHALENE	<1.0				
N-PROPYLBENZENE	<1.0				
STYRENE	<1.0				

PAGE 7 of 12



Environmental
LABORATORY SERVICES

FAX COPY

ALASKAN OIL INC.
2020 LEMOYNE STREET
P.O. BOX 69
SYRACUSE
ATTN: MR. SCOTT BLAKE

NY 13211-

PROJECT #: 997737
RECEIVED: 10/4/01

P.O. #
CLIENT JOB NUMBER:

TEST PERFORMED	RESULTS	UNITS	DATE PERFORMED	METHOD NUMBER	PERFORMED BY
SAMPLE #: 185927	CLIENT SAMPLE ID: TW-9			DATE SAMPLED: 10/03/01	
VOL. ORGANICS - EPA 8021 W/MTBE		UG/L	10/11/01	EPA 8021	SKW
TOLUENE	<1.0				
TRICHLOROETHENE	<1.0				
TRICHLOROFLUOROMETHANE	<1.0				
1,1,1,2-TETRACHLOROETHANE	<1.0				
1,1,2,2-TETRACHLOROETHANE	<1.0				
TETRACHLOROETHENE	<1.0				
1,2,3-TRICHLOROBENZENE	<1.0				
1,2,4-TRICHLOROBENZENE	<1.0				
1,1,2-TRICHLOROETHANE	<1.0				
1,2,3-TRICHLOROPROPANE	<1.0				
1,2,4-TRIMETHYLBENZENE	<1.0				
1,3,5-TRIMETHYLBENZENE *	<1.0				
1,1,1-TRICHLOROETHANE	<1.0				
VINYL CHLORIDE	<1.0				
TOTAL XYLENES	<1.0				

* COMPOUND CO-ELUTES: RESULT IS CALCULATED AS A COMBINED STANDARD.

SAMPLE #: 185928	CLIENT SAMPLE ID: TW-10			DATE SAMPLED: 10/03/01	
VOL. ORGANICS - EPA 8021 W/MTBE		UG/L	10/11/01	EPA 8021	SKW
BENZENE	<1.7				
BROMOBENZENE	<1.0				
BROMOCHLOROMETHANE	<1.0				
BROMODICHLOROMETHANE	<1.0				
BROMOFORM	<1.0				
BROMOMETHANE	<1.0				
N-BUTYLBENZENE	<1.0				
SEC-BUTYLBENZENE	<1.0				
TERT-BUTYLBENZENE	<1.0				
CARBON TETRACHLORIDE	<1.0				
CHLOROBENZENE	<1.0				
CHLOROETHANE	<1.0				
CHLOROFORM	<1.0				
CHLOROMETHANE	<1.0				

PAGE 8 of 12



Environmental
LABORATORY SERVICES

FAX COPY

ALASKAN OIL INC.
2020 LEMOYNE STREET
P.O. BOX 69
SYRACUSE NY 13211-
ATTN: MR. SCOTT BLAKE

PROJECT #: 997737
RECEIVED: 10/4/01

P.O. #
CLIENT JOB NUMBER:

TEST PERFORMED	RESULTS	UNITS	DATE PERFORMED	METHOD NUMBER	PERFORMED BY
SAMPLE #: 188928	CLIENT SAMPLE ID: TW-10			DATE SAMPLED: 10/03/01	
VOL. ORGANICS - EPA 8021 W/MTBE		UG/L	10/11/01	EPA 8021	SKW
2-CHLOROTOLUENE	<1.0				
4-CHLOROTOLUENE	<1.0				
CUMENE (ISOPROPYLBENZENE)	<1.0				
CYMENE (4-ISOPROPYLTOLUENE)	<1.0				
CIS-1,3-DICHLOROPROPENE	<1.0				
DIBROMOCHLOROMETHANE	<1.0				
1,2-DIBROMO-3-CHLOROPROPANE	<1.0				
DIBROMOMETHANE	<1.0				
1,2-DICHLOROBENZENE	<1.0				
1,3-DICHLOROBENZENE	<1.0				
1,4-DICHLOROBENZENE	<1.0				
DICHLORODIFLUOROMETHANE	<1.0				
1,2-DIBROMOETHANE	<1.0				
CIS-1,2-DICHLOROETHENE	<1.0				
1,1-DICHLOROETHANE	<1.0				
1,2-DICHLOROETHANE	<1.0				
1,1-DICHLOROETHENE	<1.0				
TRANS-1,2-DICHLOROETHENE	<1.0				
1,2-DICHLOROPROPANE	<1.0				
1,3-DICHLOROPROPANE	<1.0				
2,2-DICHLOROPROPANE *	<1.0				
1,1-DICHLOROPROPENE	<1.0				
TRANS-1,3-DICHLOROPROPENE	<1.0				
ETHYLBENZENE	<1.0				
HEXACHLOROBTADIENE	<1.0				
METHYLENE CHLORIDE	<1.0				
MTBE	<1.0				
NAPHTHALENE	<1.0				
N-PROPYLBENZENE	<1.0				
STYRENE	<1.0				
TOLUENE	<1.0				
TRICHLOROETHENE	<1.0				
TRICHLOROFLUOROMETHANE	<1.0				
1,1,1,2-TETRACHLOROETHANE	<1.0				
1,1,2,2-TETRACHLOROETHANE	<1.0				



FAX COPY

ALASKAN OIL INC.
2020 LEMOYNE STREET
P.O. BOX 69
SYRACUSE
ATTN: MR. SCOTT BLAKE

NY 13211-

PROJECT #: 997737
RECEIVED: 10/4/01

P.O. #
CLIENT JOB NUMBER:

TEST PERFORMED	RESULTS	UNITS	DATE PERFORMED	METHOD NUMBER	PERFORMED BY
SAMPLE #: 188928	CLIENT SAMPLE ID: TW-10			DATE SAMPLED: 10/03/01	
VOL. ORGANICS - EPA 8021 W/MTBE		UG/L	10/11/01	EPA 8021	SKW
TETRACHLOROETHENE	<1.0				
1,2,3-TRICHLOROBENZENE	<1.0				
1,2,4-TRICHLOROBENZENE	<1.0				
1,1,2-TRICHLOROETHANE	<1.0				
1,2,3-TRICHLOROPROPANE	<1.0				
1,2,4-TRIMETHYLBENZENE	<1.0				
1,3,5-TRIMETHYLBENZENE *	<1.0				
1,1,1-TRICHLOROETHANE	<1.0				
VINYL CHLORIDE	<1.0				
TOTAL XYLENES	<1.0				

* COMPOUND CO-ELUTES. RESULT IS CALCULATED AS A COMBINED STANDARD.

SAMPLE #: 188929	CLIENT SAMPLE ID: TRIP BLANK			DATE SAMPLED: 10/03/01	
VOL. ORGANICS - EPA 8021 W/MTBE		UG/L	10/11/01	EPA 8021	SKW
BENZENE	<0.7				
BROMOBENZENE	<1.0				
BROMOCHLOROMETHANE	<1.0				
BROMODICHLOROMETHANE	<1.0				
BROMOFORM	<1.0				
BROMOMETHANE	<1.0				
N-BUTYLBENZENE	<1.0				
SEC-BUTYLBENZENE	<1.0				
TERT-BUTYLBENZENE	<1.0				
CARBON TETRACHLORIDE	<1.0				
CHLOROBENZENE	<1.0				
CHLOROETHANE	<1.0				
CHLOROFORM	<1.0				
CHLOROMETHANE	<1.0				
2-CHLOROTOLUENE	<1.0				
4-CHLOROTOLUENE	<1.0				
CUMENE (ISOPROPYLBENZENE)	<1.0				
CYMENE (4-ISOPROPYLTOLUENE)	<1.0				
CIS-1,3-DICHLOROPROPENE	<1.0				

PAGE 10 of 12



Environmental
LABORATORY SERVICES

FAX COPY

ALASKAN OIL INC.
2020 LEMOYNE STREET
P.O. BOX 69
SYRACUSE
ATTN: MR. SCOTT BLAKE

NY 13211-

PROJECT #: 997737
RECEIVED: 10/4/01

P.O. #
CLIENT JOB NUMBER:

TEST PERFORMED	RESULTS	UNITS	DATE PERFORMED	METHOD NUMBER	PERFORMED BY
SAMPLE #: 185929	CLIENT SAMPLE ID: TRIP BLANK				DATE SAMPLED: 10/03/01
VOL. ORGANICS - EPA 8021 W/MTBE		UG/L	10/11/01	EPA 8021	SKW
DIBROMOCHLOROMETHANE	<1.0				
1,2-DIBROMO-3-CHLOROPROPANE	<1.0				
DIBROMOMETHANE	<1.0				
1,2-DICHLOROBENZENE	<1.0				
1,3-DICHLOROBENZENE	<1.0				
1,4-DICHLOROBENZENE	<1.0				
DICHLORODIFLUOROMETHANE	<1.0				
1,2-DIBROMOETHANE	<1.0				
CIS-1,2-DICHLOROETHENE	<1.0				
1,1-DICHLOROETHANE	<1.0				
1,2-DICHLOROETHANE	<1.0				
1,1-DICHLOROETHENE	<1.0				
TRANS-1,2-DICHLOROETHENE	<1.0				
1,2-DICHLOROPROPANE	<1.0				
1,3-DICHLOROPROPANE	<1.0				
2,2-DICHLOROPROPANE *	<1.0				
1,1-DICHLOROPROPENE	<1.0				
TRANS-1,3-DICHLOROPROPENE	<1.0				
ETHYLBENZENE	<1.0				
HEXACHLOROBUTADIENE	<1.0				
METHYLENE CHLORIDE	<1.0				
MTBE	<1.0				
NAPHTHALENE	<1.0				
N-PROPYLBENZENE	<1.0				
STYRENE	<1.0				
TOLUENE	<1.0				
TRICHLOROETHENE	<1.0				
TRICHLOROFLUOROMETHANE	<1.0				
1,1,1,2-TETRACHLOROETHANE	<1.0				
1,1,2,2-TETRACHLOROETHANE	<1.0				
TETRACHLOROETHENE	<1.0				
1,2,3-TRICHLOROBENZENE	<1.0				
1,2,4-TRICHLOROBENZENE	<1.0				
1,1,2-TRICHLOROETHANE	<1.0				
1,2,3-TRICHLOROPROPANE	<1.0				



FAX COPY

ALASKAN OIL INC.
2020 LEMOYNE STREET
P.O. BOX 69
SYRACUSE
ATTN: MR. SCOTT BLAKE

NY 13211-

PROJECT #: 997737

RECEIVED: 10/4/01

P.O. #

CLIENT JOB NUMBER:

TEST PERFORMED	RESULTS	UNITS	DATE PERFORMED	METHOD NUMBER	PERFORMED BY
SAMPLE #: 185929	CLIENT SAMPLE ID: TRIP BLANK			DATE SAMPLED: 10/03/01	
VOL. ORGANICS - EPA 8021 W/MTBE		UG/L	10/11/01	EPA 8021	SKW
1,2,4-TRIMETHYLBENZENE	<1.0				
1,3,5-TRIMETHYLBENZENE *	<1.0				
1,1,1-TRICHLOROETHANE	<1.0				
VINYL CHLORIDE	<1.0				
TOTAL XYLENES	<1.0				

* COMPOUND CO-ELUTES. RESULT IS CALCULATED AS A COMBINED STANDARD.

Faxed Copy *_____
Laboratory Director

10/16/2001

Date

All tests performed under NYS ELAP laboratory certification # 11375 unless otherwise stated.

PAGE 12 of 12



Environmental
LABORATORY SERVICES