

Advanced Cleanup Technologies, Inc.

ENVIRONMENTAL CONSULTANTS

June 12, 1996

VIA TELECOPIER

Mr. Neal Terk
Terk Technologies
65 East Bethpage Road
Plainview, New York 11803

Re: Supplemental Phase II Assessment Proposal
161 Sweet Hollow Road, Old Bethpage, New York

Dear Mr. Terk:

Advanced Cleanup Technologies, Inc. (ACT) hereby submits specifications and estimates for the performance of a Supplemental Phase II Environmental Site Assessment at the above-referenced address. The scope of work is based upon recent site inspections of the property as well as the results of our June 11, 1996 Phase I/Phase II Environmental Site Assessment report. The purpose for the supplemental assessment is to determine whether certain areas of the site or an adjoining parcel are sources of ground water contamination beneath the subject property.

SCOPE OF WORK

Task #1: Public Agency of 310 Winding Road

The site inspections of the subject property identified potential Recognized Environmental Conditions at an adjacent property, 310 Winding Road. The files of local regulatory agencies pertaining to adjacent property will be reviewed and evaluated. The fee for this portion of the assessment will be \$315.

Task #2: Soil-Vapor Survey

The previous Phase I/Phase II Environmental Site Assessment of the property identified approximately 1.5 milligrams per liter of volatile organic compounds in ground water from a monitoring well located in an alleyway between the subject property and 310 Winding Road. A soil-vapor survey will be performed in the building on 161 Sweethollow Road and the adjoining alleyway in order to discount these locations as potential sources of this contamination.

Old Bethpage, NY
June 12, 1996
Page Two

A total of 8 soil vapor probes will be installed: 2 inside the building and 6 in the adjoining alleyway. Soil vapor samples will be obtained at 5 foot intervals from the ground surface to a depth of 20 feet. Each soil vapor sample will be screened for volatile organic compounds utilizing a portable gas chromatograph. The fee for this portion of the assessment will be \$2,800.

Task #3: Ground Water Investigation

Two additional ground water monitoring wells were identified at 310 Winding Road. ACT will sample and survey these 2 wells along with the monitoring well previously sampled. Each ground water sample will be screened utilizing the portable GC. The most contaminated sample will be analyzed for VOCs in accordance with EPA Method 624 plus library search. The fee for this portion of the assessment will be \$840.

The results of the supplemental assessment will be presented in the form of an addendum to the previous Phase I/Phase II Environmental Site Assessment Report. This addendum will provide a complete summary of the findings and conclusions of the supplemental assessment.

PROJECT COSTS AND SCHEDULING

The total fee for the performance of the supplemental assessment will be \$3,955. ACT is prepared to commence work on this project immediately upon its authorization. To authorize this project, please execute and return the attached Authorization Agreement. If you have any questions or would like to discuss this matter further, please contact us at your convenience. We look forward to working with you on this project.

Very truly yours,



Paul P. Stewart
Vice President

PPS/bv
Encl.

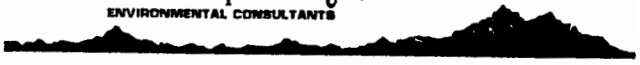

Old Bethpage, NY
June 12, 1996
Page Three

AUTHORIZATION AGREEMENT

Advanced Cleanup Technologies, Inc. hereby proposes to furnish material and labor in accordance with the above specifications for the sum of \$3,955.00, payable as follows: Fifty percent (\$1,977.50) payable upon authorization and the remaining balance (\$1,977.50) upon presentation of the addendum. Any outstanding balances over 30 days will be subject to a 1.5% surcharge.

Authorized
Signature

DATE June 12, 1996

Paul P. Stewart, Vice President
Advanced Cleanup Technologies, Inc.

The above estimates, specifications and conditions are satisfactory and are hereby accepted. ACT is authorized to do the work as specified. Payment will be made as indicated above.

Authorized
Signature

DATE _____

PHASE I ENVIRONMENTAL AUDIT
OF
ALUMINUM LOUVRE CORPORATION
OLD BETHPAGE, NEW YORK

eder associates
environmental scientists and engineers

NEW YORK JOB DEVELOPMENT AUTHORITY
NEW YORK, NEW YORK

PHASE I ENVIRONMENTAL AUDIT
OF
ALUMINUM LOUVRE CORPORATION
OLD BETHPAGE, NEW YORK

PROJECT #1187-1
APRIL 1994

Office Location:

EDER ASSOCIATES
480 Forest Avenue
Locust Valley, New York 11560

Office Contact:

Joseph M. Heaney, P.E.
David O'Sullivan
(516) 671-8440

Offices in New York, Wisconsin, Michigan, Georgia, Florida and New Jersey



eder associates
environmental scientists and engineers

OFFICES:
Locust Valley, NY
Madison, WI
Ann Arbor, MI
Augusta, GA
Jacksonville, FL
Trenton, NJ
Tampa, FL

April 18, 1994
File #1187-1

Mr. Bill Morris
New York Job Development Authority
605 Third Avenue
New York, New York 10158

Re: Phase I Environmental Audit Report
Aluminum Louvre Corp.
310 Winding Road
Old Bethpage, New York 11804

Dear Mr. Morris:

I am enclosing two copies of the Phase I Environmental Audit Report for the Aluminum Louvre Corporation property in Old Bethpage, New York.

Please call me with any comments or questions. We have not received FOIA information from the regulatory agencies. This material will be forwarded to you as soon as we have reviewed it.

Thank you for this opportunity to provide engineering services to the New York Job Development Authority.

Very truly yours,

EDER ASSOCIATES

Joseph M. Heaney III, P.E.
Project Manager

JMH/llv
Encl.

LLV3845

CONTENTS

	<u>Page</u>
LETTER OF TRANSMITTAL	
I. INTRODUCTION	1
II. AUDIT RESULTS	2
Site Description and Site History	2
Water Supply and Wastewater Disposal	3
Groundwater	3
Stormwater Disposal	3
Above and Underground Storage Tanks (ASTs & USTs)	4
Hazardous and Non-Hazardous Waste Storage and Disposal	4
Polychlorinated Biphenyls (PCBs)	5
Air Emissions	5
Asbestos	6
Lead Based Paints	6
Radon	6
III. REGULATORY REVIEW	7
Freedom of Information Act Requests	8
IV. CONCLUSIONS AND RECOMMENDATIONS	9
For Property at 161 Sweet Hollow Road	9
For Property at 310 Winding Road	9
For Entire Property	10
V. DISCLAIMER	11

FIGURES

<u>No.</u>	<u>Description</u>
1	Location Map
2	Site Plan

APPENDICES

APPENDIX A	-	VISTA NATIONAL RADIUS PROFILE
APPENDIX B	-	FREEDOM OF INFORMATION REQUEST LETTERS TO VARIOUS AGENCIES
APPENDIX C	-	SITE OPERATIONS DOCUMENTS

I. INTRODUCTION

Eder Associates, Inc. (Eder) was retained by the New York State Job Development Authority (JDA) to perform a Phase I environmental audit of the Aluminum Louvre Corporation (ALC) property. The property was inspected by Eder on March 1 and 2, 1994. Frank Marchhart, President of ALC, accompanied the inspector and was interviewed for information on the site history, current land use, general operations, chemical use and storage, waste generation and storage and overall housekeeping. Information calls and Freedom of Information Act requests (FOIA) were made to county, state and federal regulatory agencies. Aerial photos and regulatory compliance databases were reviewed for issues of concern and to establish the approximate date of construction. The site was partially covered with snow at the time of the audit and it was not possible to inspect all of the property.

II. AUDIT RESULTS

Site Description and Site History

The ALC site is located in a light industrial zoned area on approximately 2.5 acres in Old Bethpage, New York. The facility is bordered by the Hi Temco Division of the Barson Corp. and Old Bethpage Landfill on the north and west with Allside Supply Center and Central Island Glass, Inc. on the south and east. The property consists of two one story buildings totaling approximately 20,000 and 26,500 square feet and several parking lots and grassy lawn areas totaling 61,000 square feet. Building walls and floors are concrete block and slab. There are no basements. The buildings are heated with overhead gas fired space heat blowers. The site is located adjacent to the Old Bethpage Landfill, a NPL site which is under remediation, Figure 2. A site plan of the property (Figure 2) shows features that are referred to throughout this report. A trailer body parked behind the building at 310 Winding Road contained empty 5-gallon paint pails. Paint pails, derelict autos and painting equipment is also stored in this area.

Mr. Marchhart indicated that the facility operations have remained the same since ALC started business in 1984. Manufacturing operations involve stamping, cutting and shaping steel and aluminum coil stock, degreasing parts and painting.

The fixtures are washed in detergent, dried, electrostatically charged, coated with powder paint and baked in an oven to cure the paint. Less than 10% of the production is painted with oil based paint in a vented spray booth.

The mechanical parts washer associated with the powder paint line generates wastewater which contains detergents. The wastewater is pH adjusted on a batch basis and discharged to the sanitary sewer through a monitoring manhole. Mr. Marchhart reported that a septic tank and associated leaching field was used to dispose of wastewater prior to sewer hookups in 1986. A

vapor degreaser in the 310 Winding Road building uses 1,1,1-trichloroethane which replaced trichloroethylene.

Water Supply and Wastewater Disposal

Potable water is supplied by the Plainview Water District through separate services into 161 Sweet Hollow Road and 310 Winding Road. The facility generates small quantities of processed wastewaters from the wash and rinse system (reportedly 50 gallons/week at peak operation). This wastewater passes through a Nassau County monitoring station and discharges to the County Sewer on Sweet Hollow Road. There was no evidence of any permit violations in ALC's files and Mr. Marchhart indicated that there were no violations and no citations. A FOIA request was sent to NCDH. Wastewater is discharged to the Nassau County sewer under a permit. The wastewater was formerly discharged to an on-site septic system.

Groundwater

The approximate depth to groundwater in the ALC area is 50 feet below grade. Groundwater quality for the property is unknown. There is a current NPL Superfund investigation at the Old Bethpage Landfill located to the southwest of ALC. Groundwater flow in the area is generally to the southwest with a slight vertical downward component, placing ALC upgradient of the Landfill. This information can be confirmed by reviewing groundwater flow maps prepared from actual groundwater level elevation data. *reference.*

Stormwater Disposal

Stormwater runoff flows to catch basins on the site. Approximate locations of these catch basins are shown in Figure 2. There were no documents showing that the catch basins were cleaned or sampled. Pails of uncovered paint were observed in the rear parking lot of 310 Winding Road during the site inspection in an area where runoff would probably carry spilled paint into a drywell. The drywell interiors were full of snow at the time of the site inspection and it was not

possible to determine if there was any evidence of paint inside the drains. There was no chemical odor in the area of the drywells. There was no sign of paint on the drywell/drain grates.

Above and Underground Storage Tanks (ASTs & USTs)

A 275 gallon AST in the building on 310 Winding Road was empty at the time of the site inspection and is reportedly no longer in use. An UST vent and fill pipe was observed on the front lawn, west of the building on 161 Sweet Hollow Road. The tank reportedly contained heating oil and/or diesel fuel and was pumped empty prior to ALC occupancy. This could not be confirmed. A leak from a 2,000 gallon fuel oil tank located in the alley on ALC property between 310 Winding Road and 161 Sweet Hollow Road was reported on July 27, 1987. The tank was excavated and removed, and NCDH reportedly observed the work but no closure documents were available to verify a clean closure. Approximate locations of the three storage tanks are shown on Figure 2.

Hazardous and Non-Hazardous Waste Storage and Disposal

ALC is a RCRA small quantity hazardous waste generator with the EPA ID # NYD981488D26. ALC's operations generate spent degreasers and paint thinners. 1,1,1-Trichloroethane (TCA) was stored in the AST and is currently stored in 55 gallon drums. Drums containing TCA lacked proper labeling. Waste solvents, including TCA from the degreaser, are held on site in 55 gallon drums until hauled off-site by the Detrex Corp., a licensed hazardous waste hauler. The waste is hauled to Systech Environmental Corp., Green Castle, Indiana, a RCRA permitted treatment, storage and disposal facility. A copy of a typical hazardous waste shipping manifest is included in Appendix C. The AST and drums used to store TCA were in good condition with no obvious leaks or dents. Detrex Corp. also hauls waste cutting oil to Great Lakes Environmental for disposal at Research Oil Company, Cleveland, Ohio, a RCRA permitted waste disposal facility. Reportedly scrap steel, aluminum and general office waste are placed in on-site roll off containers for disposal. There was no evidence of chemical stains or oil on the concrete pavement where the roll offs are stored. There were no records indicating how waste paints were disposed of.

There was evidence of spilled paint on the pavement behind the building at 310 Winding Road adjacent to the trailer body.

Central Island Glass, Inc. (CIGI) discharges a white colored liquid onto ALC property. A CIGI representative, Warren Crotty indicated that this is process wastewater from glass cutting and grinding. CIGI was notified and asked to discontinue this disposal practice.

Polychlorinated Biphenyls (PCBs)

There is a LILCO transformer on a concrete pad on the west side of the building at 161 Sweet Hollow Road (approximate location shown on Figure 2). Telephone calls to LILCO could not establish the dielectric content of the transformer. Fluorescent light ballasts in both buildings may contain PCBs. Leaking ballasts must be disposed of in accord with TSCA regulations.

Air Emissions

Currently, ALC has eight New York State DEC air emission permits which must be retired when the facility ceases operation. The following table shows pertinent information regarding the ALC air permits:

Permit #	Source	Status	Location
EP00001 WI	High Solids Paints/ Polyester Powders	Inactive	161 Sweet Hollow Rd.
EP00002 WI	Phosphate Washer	Inactive	161 Sweet Hollow Rd.
EP00004 WI	High Solids Baked Enamel Paints	Inactive	161 Sweet Hollow Rd.
EP00005 WI	Gas Fired Oven	Inactive	161 Sweet Hollow Rd.
EP00006 WI	Gas Fired Oven	Active	310 Winding Rd.
EP00008 WI	High Solid Enamel Paint	Active	310 Winding Rd.
EP00009 WI	Methyl Chloroform Vapor Degreaser	Active	310 Winding Rd.
EP00010 WI	Methyl Chloroform Vapor Degreaser	Active	310 Winding Rd.

Asbestos

Floor tiles in bathrooms and offices in both buildings may contain asbestos. Access to the roof was not available at the time of the site investigation. Reportedly, the building roof at 161 Sweet Hollow Road is the original roof and the building roof at 310 Winding Road was reportedly installed around 1986.

Asbestos is generally not a regulatory issue if the material is intact. Asbestos material would have to be removed if it is likely to be disturbed during construction, renovation or demolition. Asbestos removal is covered by federal and state law. An asbestos survey would be required to confirm the presence of asbestos in the buildings.

Lead Based Paints

Paint on interior building surfaces was generally in good condition with no evidence of peeling or chipping in the major spaces in both buildings at the time of the audit. Sampling would be required to determine whether the paint contains lead.

Radon

The New York State Department of Health indicated that Radon is generally not a concern in Nassau County.

FIGURES
WINDING R

III. REGULATORY REVIEW

Vista Environmental Information, Inc. (Vista) was retained to provide a computerized database search of the project area within a one-mile radius. The database output was reviewed to determine if the property appears on the following lists:

Federal Lists

National Priorities List (Superfund)

Comprehensive Environmental Response Conservation & Liability Information System
(CERCLIS)

Resource Conservation and Recovery Act (RCRA) Treatment, Storage, and Disposal
Facilities

Emergency Response Notification System (ERNS)

RCRA Hazardous Waste Generators

RCRA Transporters

RCRA Administrative Action Tracing System (RAATS)

Consolidated Docket Enforcement System (CDES)

The property does not appear on any of the above Federal lists. There were two Superfund sites identified within a one-mile radius of the property. There are two CERCLIS sites, one large quantity generator, no small quantity generators, and no RCRA transporters, within one-quarter mile of the subject property.

State Lists

Inactive Hazardous Waste Disposal Site (SPL)

Leaking Underground Storage Tanks Database (LUST)

Solid Waste Landfill List (SWL)

Petroleum Bulk Storage Underground Storage Tank (UST)

The property did appear on the LUST list shown above. There are five LUST sites located between one-quarter mile and one-half mile from the subject property.

Detailed information concerning each list is provided with the Vista Report (Appendix A).

Freedom of Information Act Requests

FOIA requests were sent to the United States Environmental Protection Agency, Region II (EPA), the NYSDEC, the New York City Department of Environmental Protection (DEP), and the Nassau County Health Department (NCDH). Copies of the requests are included in Appendix B.

The regulatory agencies usually take six to eight weeks to process FOIA requests. Responses will be reviewed and forwarded to you upon receipt.

IV. CONCLUSIONS AND RECOMMENDATIONS

Based on conditions observed during the site visit and information concerning site issues, the following conclusions and recommendations can be made about present site conditions.

For Property at 161 Sweet Hollow Road

- The status and condition of an UST buried in the front lawn of 161 Sweet Hollow Road could not be confirmed. This UST should be tested for leaks and sealed if future use is anticipated. If no future use is expected, excavate and remove the UST according to state and county regulations.
- ✓ White colored residuals from wastewaters are released by CIGI onto ALC's 161 Sweet Hollow Road property. Sample residuals for RCRA metals.
- The site was connected to the Nassau County sewer system in 1986. Prior to this hookup, sanitary and process wastewaters were discharged to an on-site septic system which we were unable to locate.
- Retire wastewater discharge permit and all associated air permits.

For Property at 310 Winding Road

- One UST was apparently removed in 1987 and the closure status unconfirmed.
- The facility discharged sanitary and process wastewater to a septic system under the front parking lot at 310 Winding Road. The site was connected to the Nassau

County sewer system in 1986. Locate and sample the septic system and analyze the samples for RCRA metals and VOCs.

- Stormwater disposal dry wells may be contaminated from runoff in areas where paint spills were observed. The stored paint pails, the trailer body, and derelict autos and other miscellaneous equipment should be removed from the rear parking lot. Sample the sediment in the dry well located in the center of the rear parking lot and analyze the sediment for RCRA metals and VOCs.
- Retire all air permits associated with the property.

For Entire Property

- There may be asbestos in floor tiles in bathrooms, offices and building roofing materials. Conduct an asbestos survey to determine the presence of asbestos in the buildings.

V. DISCLAIMER

This audit report is based partially on information obtained from others and Eder makes no representation or warranty concerning the accuracy or completeness of this information in describing site operations or environmental conditions. The information contained in this report was developed from information available and conditions observed on the survey date. Some of the information presented in this report may be subject to interpretation and different conclusions are possible. Eder does not assume liability for financial or other losses or subsequent damage caused by or related to any use of this document.

FIGURES

ALUMINUM LOUVRE CORPORATION

BETHPAGE, NEW YORK

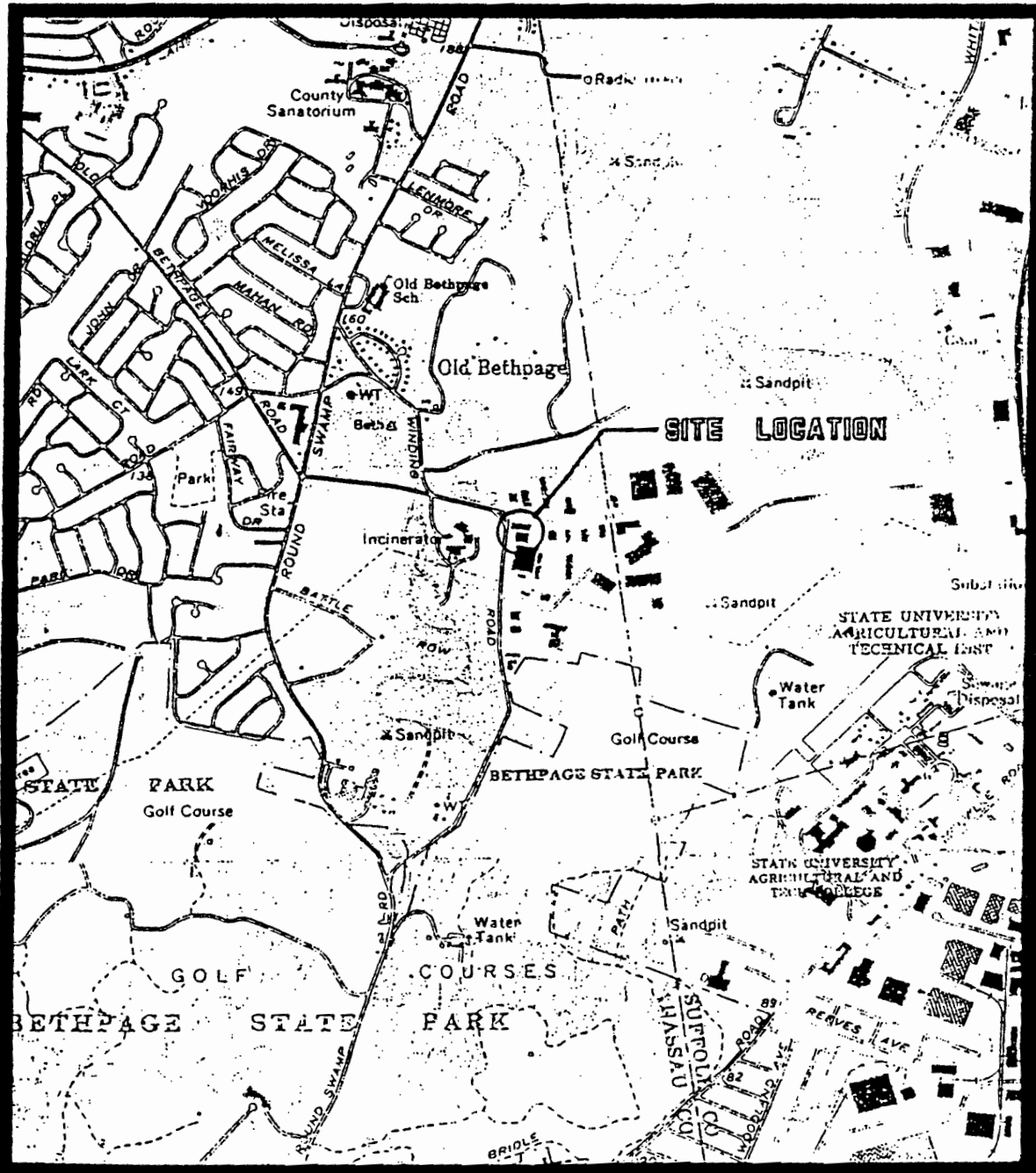

SCALE 1"=2000'

U.S.G.S. 7.5 MINUTE QUADRANGLE
HUNTINGTON, NEW YORK

LOCATION MAP

OLD BETHPAGE LANDFILL

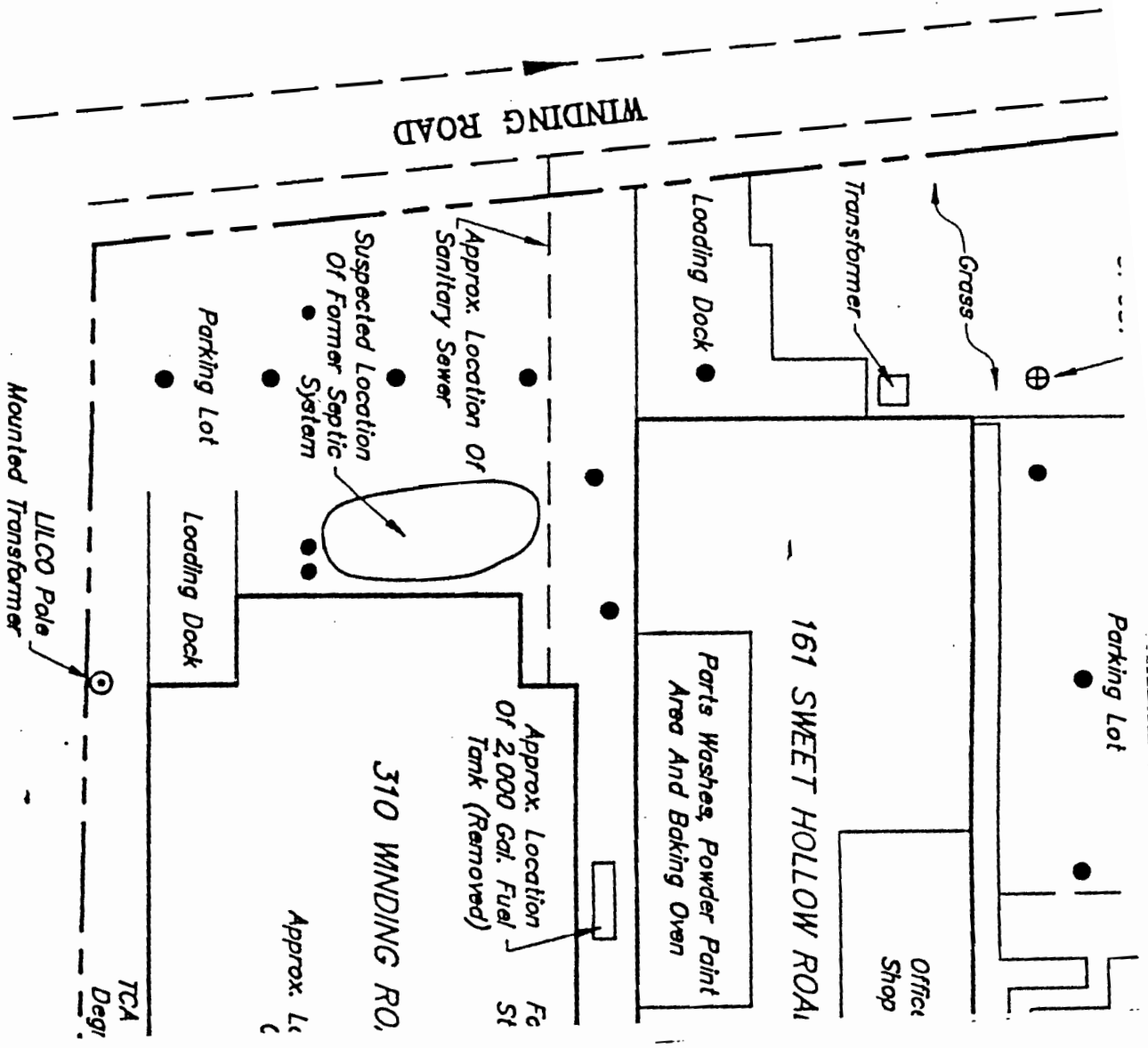

ALLSIDE :

VISTA NATIONAL RADIUS PROFILE

2/28/94

VISTA Report #: 5/037923-001

Page: 6

LUST

MAP REF #	EPA ID / AGENCY ID	SITE NAME AND ADDRESS
--------------	-----------------------	-----------------------

=====

WITHIN 1/4 TO 1/2 MILE

1	MEENAN OIL 30 HUB DRIVE	BETHPAGE 11714	Distance: .37 mi. Direction: E Vista ID: 2720776
8607347	Owner Name : MEENAN OIL Owner Address :		
	Discovery Date : 03/04/87 Substance : FUEL OIL Quantity : 40.00 GALLONS Leak Cause : UNDERGROUND TANK LEAK Leak Source : TRUCK/HIGHWAY VEHICLE Remediation : CASE CLOSED		

4	FRANKS NURSERY & CRAFT 303 WINDING ROAD	OLD BETHPAGE 11804	Distance: .34 mi. Direction: NW Vista ID: 1534129
9101516	Owner Name : FRANKS NURSERY & CRA Owner Address : 6501 EAST NEVADA STREET DETROIT, MI 48234		
	Discovery Date : 05/07/91 Substance : FUEL OIL Leak Cause : UNDERGROUND TANK LEAK Leak Source : COMMERCIAL INDUSTRY Remediation : CASE CLOSED		

4	G&S INVESTORS 303 WINDING ROAD	BETHPAGE 11714	Distance: .34 mi. Direction: NW Vista ID: 1534130
9008695	Owner Name : G&S INVESTORS Owner Address :		
	Discovery Date : 11/08/90 Substance : FUEL OIL Leak Cause : UNDERGROUND TANK LEAK Leak Source : COMMERCIAL INDUSTRY Remediation : CASE CLOSED		

VISTA NATIONAL RADIUS PROFILE

2/28/94

VISTA Report #: 5/037923-001

Page: 7

LUST

MAP REF #	EPA ID / AGENCY ID	SITE NAME AND ADDRESS
-----------	--------------------	-----------------------

WITHIN 1/4 TO 1/2 MILE

5	ALUMINUM LOUVRE CORP 161 SWEET HOLLOW RD	OLD BETHPAGE 11804	Distance: .36 mi. Direction: NW Vista ID: 15194
---	---	-----------------------	---

8703422	Owner Name : ALUMINUM LOUVER CORP Owner Address : 161 SWEET HOLLW RD. OLD BETHPAGE Discovery Date : 07/27/87 Substance : FUEL OIL Leak Cause : UNDERGROUND TANK LEAK Leak Source : COMMERCIAL INDUSTRY Remediation : CASE CLOSED
---------	---

5	DYNAFORCE CORP 195 SWEET HOLLOW RD	OLD BETHPAGE 11804	Distance: .36 mi. Direction: NW Vista ID: 130796
---	---------------------------------------	-----------------------	--

8710173	Owner Name : DYNAFIRE Owner Address : 195 SWEETHOLLOW ROAD OLD BETHPAGE,NY Discovery Date : 03/04/88 Substance : FUEL OIL Leak Cause : UNDERGROUND TANK LEAK Leak Source : COMMERCIAL INDUSTRY Remediation : CASE CLOSED Owner Name : DYNA FORCE Owner Address : 195 SWEET HOLLOW ROAD OLD BETHPAGE,NY Discovery Date : 11/20/87 Substance : FUEL OIL Leak Cause : UNDERGROUND TANK LEAK Leak Source : COMMERCIAL INDUSTRY Remediation : CASE CLOSED
---------	---

5	CONSOLIDATED FREIGHTWAYS 192 SWEET HOLLOW RD	OLD BETHPAGE 11804	Distance: .36 mi. Direction: NW Vista ID: 1337980
---	---	-----------------------	---

8709204	Owner Name : CONSOLIDATED FREIGHT Owner Address : Discovery Date : 01/28/88
---------	---

VISTA NATIONAL RADIUS PROFILE

2/28/94

VISTA Report #: 5/037923-001

Page: 8

LUST

MAP	EPA ID /	
REF #	AGENCY ID	SITE NAME AND ADDRESS

=====

WITHIN 1/4 TO 1/2 MILE

5	CONSOLIDATED FREIGHTWAYS 192 SWEET HOLLOW RD	OLD BETHPAGE 11804	Distance: .36 mi. Direction: NW Vista ID: 1337980
	Substance	: DIESEL	
	Leak Cause	: UNDERGROUND TANK LEAK	
	Leak Source	: COMMERCIAL INDUSTRY	
	Remediation	: CASE CLOSED	
	Discovery Date	: 04/24/91	
	Substance	: FUEL OIL	
	Leak Cause	: UNDERGROUND TANK LEAK	
	Leak Source	: COMMERCIAL INDUSTRY	
	Remediation	: CLEANUP IN PROGRESS/REQUIRED	

CUSTOMER USE LIMITATIONS - Customer proceeds at its own risk in choosing to rely upon VISTA services, in whole or part, prior to proceeding with any transaction. VISTA assumes no responsibility for the accuracy of government records, for errors occurring in conversion of data, or for customer's use of VISTA services. VISTA's obligation regarding data is solely limited to providing portions of data existing in government records as of the date of each government update received by VISTA.

VISTA NATIONAL RADIUS PROFILE

VISTA Report #: 5/037923-001

Date of Report: 2/28/94

UNMAPPABLE SITES

Unmappable sites are environmental risk sites that cannot be geocoded, but can be located by zip code or city name.

In general, a site cannot be geocoded because of inaccurate or missing locational information in the record provided by the agency. For many of these records, VISTA has corrected or added locational information by using U.S. Postal address validation files and proprietary programming that adds locational information from private industry address files. However, many site addresses cannot be corrected using these techniques and those sites cannot be mapped.

Of the sites that cannot be mapped, VISTA identifies those that have complete zip code or city name information. All ungeocoded sites that have a ZIP code in the radius are considered for inclusion. Ungeocoded sites that do not have a ZIP code but do have a street name are considered for inclusion if they have a city in the radius. An ungeocoded record may be excluded if it can be determined to be outside the relevant radius searched for a particular database.

VISTA NATIONAL RADIUS PROFILE

2/28/94

Report #: 5/037923-001

UNMAPPABLE SITES

Page: 1

RCRA-LgGen

NAME AND ADDRESS

VISTA ID

EPA ID /
AGENCY ID

WINDING RD, OLD BETHPAGE 11804

1534127

Generator Class :Generators who generate at least 1000 kg./month of non-acutely hazardous waste (or 1 kg./month of acutely hazardous waste).

NYD986893519

APPENDIX B

APPENDIX C

VISTA NATIONAL RADIUS PROFILE

2/28/94

VISTA Report #: 5/037923-001

UNMAPPABLE SITES

Page: 2

RCRA-SmGen:

SITE NAME AND ADDRESS	VISTA ID	EPA ID / AGENCY ID
BETHPAGE STATE PARK: BETHPAGE PARKWAY, FARMINGDALE 11735	46287	
Generator Class :Generators who generate 100 kg./month but less than 1000 kg./month of non-acutely hazardous waste		NYD981875362
FIRE SERVICE ACADEMY: WINDING ROAD, OLD BETHPAGE 11804	152354	
Generator Class :Generators who generate 100 kg./month but less than 1000 kg./month of non-acutely hazardous waste		NYD982531949
OYSTER BAY TOWN OF: BETHPAGE - SWEETHOLLOW RD, OLD BETHPAGE 11804	4115733	
Generator Class :Generators who generate 100 kg./month but less than 1000 kg./month of non-acutely hazardous waste		NYD987013059

VISTA NATIONAL RADIUS PROFILE

2/28/94

VISTA Report #: 5/037923-001

UNMAPPABLE SITES

Page: 3

SPL

SITE NAME AND ADDRESS	VISTA ID	EPA ID / AGENCY ID
=====	=====	=====
OLD BETHPAGE LANDFILL: BETHPAGE-SWEETHOLLOW ROAD, OLD BETHPAGE 11804	1263195	
Facility Type : LANDFILL		130001
Lead Agency : STATE		
State Status : IN PROGRESS		
Waste # 0 : UNKNOWN		
Waste # 1 : ALUMINUM		
STATE Detailed Site Description Available Call 1-800-877-3824 for Details.		
Facility Type : LANDFILL		
Lead Agency : STATE		
State Status : IN PROGRESS		
Waste # 0 : UNKNOWN		
Waste # 1 : UNKNOWN		
Waste # 2 : UNKNOWN		
STATE Detailed Site Description Available Call 1-800-877-3824 for Details.		
Facility Type : LANDFILL		
Lead Agency : STATE		
State Status : IN PROGRESS		
Waste # 0 : UNKNOWN		
Waste # 1 : TOULENE		
Waste # 2 : UNKNOWN		
STATE Detailed Site Description Available Call 1-800-877-3824 for Details.		

VISTA NATIONAL RADIUS PROFILE

2/28/94

VISTA Report #: 5/037923-001

UNMAPPABLE SITES

Page: 4

LUST

TE NAME AND ADDRESS	VISTA ID	EPA ID / AGENCY ID
BETHPAGE STATE PARK: BETHPAGE PARKWAY, BETHPAGE 11714 Discovery Date : 11/30/88 Substance : FUEL OIL Leak Cause : UNDERGROUND TANK LEAK Leak Source : NON-COMMERCIAL INDUSTRY Remediation : CLEANUP IN PROGRESS/REQUIRED	1328484	8807195
BETHPAGE STATE PARK, BETHPAGE 11714 Discovery Date : 07/28/88 Substance : FUEL OIL Leak Cause : UNDERGROUND TANK LEAK Leak Source : NON-COMMERCIAL INDUSTRY Remediation : CLEANUP IN PROGRESS/REQUIRED	2714162	8803698
PLAINVIEW WATER DISTRICT: HAYPATH ROAD, OLD BETHPAGE 11804 Owner Name : PLAINVIEW WATER DIST Owner Address : PLANT 5 HAYPATH ROAD OLD BETHPAGE,NY Discovery Date : 01/13/92 Substance : DIESEL Leak Cause : UNDERGROUND TANK LEAK Leak Source : COMMERCIAL INDUSTRY Remediation : CASE CLOSED	3857051	9211764
ROUND SWAMP ROAD, OLD BETHPAGE 11804 Owner Name : NCDPW Owner Address : 425 SALISBURY PARK DRIVE WESTBURY,NY Discovery Date : 05/08/92 Substance : FUEL OIL Leak Cause : UNDERGROUND TANK LEAK Leak Source : COMMERCIAL INDUSTRY Remediation : CASE CLOSED	3861224	9201593

VISTA NATIONAL RADIUS PROFILE

2/28/94

Report #: 5/037923-001

UNMAPPABLE SITES

Page: 5

LUST

NAME AND ADDRESS	VISTA ID	EPA ID / AGENCY ID
IAN AEROSPACE: BLDG 115, BETHPAGE 11714	4111072	
Owner Name : GRUMMAN AEROSPACE		8807239
Owner Address :		
Discovery Date : 12/01/88		
Substance : FUEL OIL		
Leak Cause : UNDERGROUND TANK LEAK		
Leak Source : COMMERCIAL INDUSTRY		
Remediation : CASE CLOSED		

PW: WINDING ROAD, BETHPAGE 11714	4258311	
Discovery Date : 06/28/93		9303993
Substance : WASTE OIL		
Leak Cause : UNDERGROUND TANK LEAK		
Leak Source : NON-COMMERCIAL INDUSTRY		
Remediation : CLEANUP IN PROGRESS/REQUIRED		

APPENDIX B

APPENDIX C

VISTA NATIONAL RADIUS PROFILE

2/28/94

VISTA Report #: 5/037923-001

UNMAPPABLE SITES

Page: 6

SWLF

SITE NAME AND ADDRESS

VISTA ID EPA ID /
 AGENCY ID

GARAFOLA CARTING TS: ,

2488976

Facility Type : TRANSFER STATION
Facility Status : ACTIVE
Waste Type 1 : HOUSEHOLD
Owner Name : GARAFOLA CARTING
Owner Address :

52T32

GENERAL ENERGY DEVELOP: ,

2488988

Facility Type : OTHER
Facility Status : ACTIVE
Owner Name : GENERAL ENERGY DEVEL
Owner Address : 300 NEW TOWN ROAD
 PLAINVIEW , NY 11803

52F14

HICKEY CARTING TS: ,

2488997

Facility Type : TRANSFER STATION
Facility Status : ACTIVE
Waste Type 1 : HOUSEHOLD
Owner Name : HICKEY CARTING
Owner Address :

52T27

PINELAWN CEMETRY: ,

2489047

Facility Type : RUBBLE FILL (DEMO,ETC)
Facility Status : ACTIVE
Waste Type 1 : LEAVES/CLIPPINGS

52Y12

PRODUCTIVE RECYCLING: ,

2489051

Facility Type : RUBBLE FILL (DEMO,ETC)
Facility Status : ACTIVE
Waste Type 1 : LEAVES/CLIPPINGS
Owner Name : PRODUCTIVE RECYCLING

52Y25

VISTA NATIONAL RADIUS PROFILE

2/28/94

Report #: 5/037923-001

UNMAPPABLE SITES

Page: 7

SWLF

NAME AND ADDRESS	VISTA ID	EPA ID / AGENCY ID

TIVE RECYCLING: ,	2489151	
-------------------	---------	--

Owner Address : 133 OLD NORTHPORT ROAD
KINGS PARK , NY 11754

SANITATION: ,	2489166	
---------------	---------	--

Facility Type : TRANSFER STATION		52T46
Facility Status : ACTIVE		
Waste Type 1 : COMMERCIAL		
Owner Name : UNIQUE SANITATION		
Owner Address : DALE STREET WEST BABYLON , NY		

DEMO: ,	2489170	
---------	---------	--

Facility Type : TRANSFER STATION		52T10
Facility Status : ACTIVE		
Waste Type 1 : HOUSEHOLD		
Owner Name : RAPID DEMO		
Owner Address : #		

LEAF COMPOST: ,	2489228	
-----------------	---------	--

Facility Type : RUBBLE FILL (DEMO,ETC)		30Y15
Facility Status : ACTIVE		
Waste Type 1 : LEAVES/CLIPPINGS		
Owner Name : (T) OYSTER BAY		
Owner Address : 150 MILLER PLACE SYOSSET , NY 11791		

BLE GOLF COURSE: ,	3502165	
--------------------	---------	--

Facility Type : CONSTRUCTION MATERIAL		52D43
Facility Status : ACTIVE		

VISTA NATIONAL RADIUS PROFILE

2/28/94

RA Report #: 5/037923-001

UNMAPPABLE SITES

Page: 8

SWLF

NAME AND ADDRESS	VISTA ID	EPA ID / AGENCY ID
<p>UBBISH REMOVAL: ,</p> <p>Facility Type : TRANSFER STATION</p> <p>Facility Status : ACTIVE</p>	3502233	52T51
<p>Y TACTICS OCEANSIDE: ,</p> <p>Facility Type : OTHER</p> <p>Facility Status : ACTIVE</p>	3502289	30F13
<p>Z TACTICS SMITHTOWN: ,</p> <p>Facility Type : OTHER</p> <p>Facility Status : ACTIVE</p>	3502290	52F13
<p>AS ISLAND T.S.: ,</p> <p>Facility Type : TRANSFER STATION</p> <p>Facility Status : ACTIVE</p>	3502308	52T84
<p>AMPOST (METSKI): ,</p> <p>Facility Type : OTHER</p> <p>Facility Status : ACTIVE</p> <p>Waste Type 1 : LEAVES/CLIPPINGS</p> <p>Owner Name : METSKI ENTERPRISES</p> <p>Owner Address : 181 FROWEIN RD EAST MORICHES , NY 11934</p>	3502397	52C19
<p>AO VICENT: ,</p> <p>Facility Type : TRANSFER STATION</p> <p>Facility Status : ACTIVE</p>	3502445	52T62

APPENDIX B

APPENDIX C

VISTA NATIONAL RADIUS PROFILE

2/28/94

VISTA Report #: 5/037923-001

UNMAPPABLE SITES

Page: 9

SLF

FACILITY NAME AND ADDRESS	VISTA ID	EPA ID / AGENCY ID

SOUTH SEASLAND:	3502467	
Facility Type : SANITARY LANDFILL Facility Status : ACTIVE Waste Type 1 : HOUSEHOLD Waste Type 2 : COMMERCIAL Owner Name : TOWN OF SOUTHAMPTON Owner Address : 116 HAMPTON ROAD SOUTHAMPTON , NY 11968		52S13

BETHPAGE:	3502496	
Facility Type : OTHER Facility Status : ACTIVE Owner Name : BETHPAGE LANDFILL EN Owner Address : P.O. BOX 7, 124 SILLS ROAD YAPHANK , NY 11980		30F07

CARTING (BROOKHAVEN):	3502508	
Facility Type : TRANSFER STATION Facility Status : ACTIVE		52T12

LIQUID WASTE REMOVAL:	3502535	
Facility Type : TRANSFER STATION Facility Status : ACTIVE		52T09

BUS ENTERPRISES:	3502559	
Facility Type : TRANSFER STATION Facility Status : ACTIVE		52T83

TOWN CLEANFILL:	3502567	
Facility Type : CONSTRUCTION MATERIAL Facility Status : ACTIVE		52D52

APPENDIX B

APPENDIX C

VISTA NATIONAL RADIUS PROFILE

2/28/94

VISTA Report #: 5/037923-001

UNMAPPABLE SITES

Page: 10

SWLF

APPENDIX B

APPENDIX C

FACILITY NAME AND ADDRESS	VISTA ID	EPA ID / AGENCY ID
CHARLES CEMETARY: ,	3502572	
Facility Type : CONSTRUCTION MATERIAL		52D48
Facility Status : ACTIVE		
LAN (YAPHANK LF): ,	3502649	
Facility Type : OTHER		52F06
Facility Status : ACTIVE		
Waste Type 1 : HOUSEHOLD		
WASTE CARTING (BAYSIDE): ,	3502666	
Facility Type : TRANSFER STATION		52T08
Facility Status : ACTIVE		
HEAD STOP: ,	3954914	
Facility Type : TRANSFER STATION		52T43
Facility Status : ACTIVE		
Waste Type 1 : HOUSEHOLD		
WATER ISLAND STOP: ,	3954917	
Facility Type : TRANSFER STATION		52T40
Facility Status : ACTIVE		
Waste Type 1 : HOUSEHOLD		
ROAD STOP: ,	3954924	
Facility Type : TRANSFER STATION		52T30
Facility Status : ACTIVE		
Waste Type 1 : HOUSEHOLD		
Owner Name : TOWN OF SOUTHOLD		
Owner Address :		

VISTA NATIONAL RADIUS PROFILE

2/28/94

VISTA Report #: 5/037923-001

UNMAPPABLE SITES

Page: 11

SWLF

SITE NAME AND ADDRESS	VISTA ID	EPA ID / AGENCY ID
-----------------------	----------	-----------------------

ET PAPERSTOCK: ,	3998564	
------------------	---------	--

Facility Type : RESOURCE RECOVERY (RECYCLING)

CUSTOMER USE LIMITATIONS - Customer proceeds at its own risk in choosing to rely upon VISTA services, in whole or in part, prior to proceeding with any transaction. VISTA assumes no responsibility for the accuracy of government records, for errors occurring in conversion of data, or for customer's use of VISTA services. VISTA's obligation regarding data is solely limited to providing portions of data existing in government records as of the date of each government update received by VISTA.

APPENDIX B

APPENDIX C

DESCRIPTION OF DATABASES SEARCHED

Below are general descriptions and search parameters of the federal and state databases that VISTA searches for the National Radius Report.

FEDERAL DATABASES

Please check the "Summary of Environmental Risks Found" matrix on the cover of this profile to determine the specific dates of the federal databases searched for this profile.

U.S. EPA: NPL

The National Priorities List (NPL) is the EPA's database of uncontrolled or abandoned hazardous waste sites identified for priority remedial action under the Superfund Program. A site, to be included on the NPL, must either meet or surpass a predetermined hazard ranking systems score, or be chosen as a state's top-priority site, or meet all three of the following criteria:

- 1) The US Department of Health and Human Services issues a health advisory recommending that people be removed from the site to avoid exposure.
- 2) The EPA determines that the site represents a significant threat.
- 3) The EPA determines that remedial action is more cost-effective than removal action.

U.S. EPA: CERCLIS

The CERCLIS List is a compilation by the EPA of the sites which the EPA has investigated or is currently investigating for a release or threatened release of hazardous substances pursuant to the Comprehensive Environmental Response, Compensation and Liability Act of 1980 (CERCLA or Superfund Act).

U.S. EPA: RCRA (RCRIS/HWDMS)

The EPA's Resource Conservation and Recovery Act (RCRA) Program identifies and tracks hazardous waste from the point of generation to the point of disposal. The RCRA Facilities database is a compilation by the EPA of reporting facilities that generate, transport, treat, store or dispose of hazardous waste.

U.S. EPA: ERNS

The Emergency Response Notification System (ERNS) is a national database used to collect information on reported accidental releases of oil and hazardous substances. The database contains information from spill reports made to federal authorities including the EPA, the US Coast Guard, the National Response Center and the Department of Transportation.

STATE DATABASES

Please check the "Databases Searched" to determine if the following type of databases are available from VISTA for the state in which the subject property of this report is located. Please note that if the Summary does not list one of the following databases, it is not currently available. You may also determine the specific names and dates of the databases searched for this profile in the summary.

STATE: SPL

The State Priority List is a generic name for databases maintained by many states that contain sites considered to be actually or potentially contaminated and presenting a possible threat to human health and the environment. These sites are generally listed by the state to warn the public or as a part of an investigation and cleanup program managed by the state.

STATE: LUST

This is a database maintained by state or local agencies of known or suspected leaking underground storage tanks.

STATE: UST

This is a database maintained by state or local agencies of registered underground storage tanks.

STATE: SWLF

This is a database maintained by state or local agencies of Solid Waste Landfills, Incinerators, and transfer stations.

VISTA ENVIRONMENTAL INFORMATION

FEDERAL REPORT			
Client Project/P.O. No.:	1187-01/NYSI	VISTA Report No.:	037923011
Client Reference Name:		Date of Report:	Feb. 28, 1994
Site Description			
Subject Property:	ALUMINUM LOUVER CORP		
Address:	310 WINDING RD		
City:	BETHPAGE		
State:	NY		
Zip:	11714		
County:	NASSAU		
Additional Search Criteria			
County Names:	1) SUFFOLK		

SITES FOUND

Agency/Database	Date of Data	# of Sites In Zip Code	# of Other Sites In the Area
US,EPA.DOCKETS	11/93	1	0
US,EPA.RAATS	11/93	0	0

VISTA ENVIRONMENTAL INFORMATION

Dockets Sites															
Client Project/P.O. No.: 1187-01/NYSI	VISTA Report No.: 037923011														
Client Reference Name:	Date of Report: Feb. 28, 1994														
<table style="width: 100%; border: none;"> <tr> <td style="width: 20%;"></td> <td style="text-align: center;">Site Description</td> </tr> <tr> <td style="padding-left: 20px;">Subject Property:</td> <td>ALUMINUM LOUVER CORP</td> </tr> <tr> <td style="padding-left: 20px;">Address:</td> <td>310 WINDING RD</td> </tr> <tr> <td style="padding-left: 20px;">City:</td> <td>BETHPAGE</td> </tr> <tr> <td style="padding-left: 20px;">State:</td> <td>NY</td> </tr> <tr> <td style="padding-left: 20px;">Zip:</td> <td>11714</td> </tr> <tr> <td style="padding-left: 20px;">County:</td> <td>NASSAU</td> </tr> </table>			Site Description	Subject Property:	ALUMINUM LOUVER CORP	Address:	310 WINDING RD	City:	BETHPAGE	State:	NY	Zip:	11714	County:	NASSAU
	Site Description														
Subject Property:	ALUMINUM LOUVER CORP														
Address:	310 WINDING RD														
City:	BETHPAGE														
State:	NY														
Zip:	11714														
County:	NASSAU														
<table style="width: 100%; border: none;"> <tr> <td style="width: 20%;"></td> <td style="text-align: center;">Additional Search Criteria</td> </tr> <tr> <td style="padding-left: 20px;">County Names:</td> <td>1) SUFFOLK</td> </tr> </table>			Additional Search Criteria	County Names:	1) SUFFOLK										
	Additional Search Criteria														
County Names:	1) SUFFOLK														

The Consolidated Docket Enforcement System is a compilation of civil judicial enforcement actions filed by the Department of Justice on behalf of EPA against violators of Federal Environmental Statutes.

A search of the 11/93 DOCKETS database revealed the following sites within the zip code area of the subject property.

SITES IN ZIP CODE

Facility Name	: GRUMMAN AEROSPACE CORPORATION	EPA ID #:	NYD00204
Facility Address	: S OYSTER BAY RD	Docket Number:	02-84-0012
Facility City	: BETHPAGE	VISTA Number:	181977
Facility State	: NY 11714		
Case Name	: GRUMMAN AEROSPACE CORP		
Defendant(s)	: GRUMMAN AEROSPACE CORP		
Court Docket Number	: 85-2351-CV		
Judicial District	: EDNY		
Date Filed	: 06/26/85		
Date Concluded	: 12/07/88		
Federal Penalty	: \$		

VISTA ENVIRONMENTAL INFORMATION

RAATS Sites	
Client Project/P.O. No.: 1187-01/NYSI	VISTA Report No.: 037923011
Client Reference Name:	Date of Report: Feb. 28, 1994
Site Description	
Subject Property: ALUMINUM LOUVER CORP	
Address: 310 WINDING RD	
City: BETHPAGE	
State: NY	
Zip: 11714	
County: NASSAU	
Additional Search Criteria	
County Names: 1) SUFFOLK	

The Resource Conservation and Recovery Act Administrative Actions Tracking System (RAATS) tracks and records RCRA Section 3008 Compliance Orders and Orders on Consent for the Office of Waste Programs Enforcement U.S. Environmental Protection Agency.

A search of the 11/93 RAATS database revealed the following sites within the zip code area of the subject property.

SITES IN ZIP CODE

0 site(s) found in the zip code area(s)

GLOSSARY

Description of Report:

This report is a compilation of federal environmental data which identifies environmental problem sites and activities from the records of the United States Environmental Protection Agency(US EPA). The data contained in this report are the result of a search of VISTA's proprietary database.

The VISTA database search is designed to identify all sites known to be located within the specified zip code(s). Because not all government records have complete and accurate addresses, VISTA uses Post Office verification software to assign or to correct zip codes where necessary. For those records which cannot be assigned a zip code, VISTA uses the specified city name(s) to identify any sites which may be located in the zip code area. If no city name is reported, the county name is used.

Limitations Of Information

All information contained in this report was obtained from US EPA records. VISTA does not warrant the accuracy, timeliness, merchantability, completeness or usefulness of any information furnished, and the subscriber accepts any and all risks resulting from decisions made solely or in part on VISTA information.

APPENDIX B

~~APPENDIX C~~

APPENDIX B

FREEDOM OF INFORMATION REQUEST LETTERS TO VARIOUS AGENCIES



eder associates
environmental scientists and engineers

OFFICES:
Locust Valley, NY
Madison, WI
Ann Arbor, MI
Augusta, GA
Jacksonville, FL
Trenton, NJ
Tampa, FL

February 25, 1994
File #1187-1

Ms. Wanda Vasquez
Freedom of Information Officer
US EPA, Region II
26 Federal Plaza
New York, New York 10278

Re: Freedom of Information Request

Dear Ms. Vasquez:

Eder Associates requests copies of environmental files, records, and memoranda concerning:

Aluminum Louver Corp.
310 Winding Road
Bethpage, New York 11714

This information should include: 1) past and present underground storage tank registration 2) reported spills or releases of hazardous substances; 3) generation, storage, treatment, or disposal of hazardous substances; 4) past and present groundwater, surface water, and soil investigations; and 5) environmental permits/violations.

We will reimburse your file search and copying costs.

Please let us know if you can accommodate this request in an expedient manner. If this is not possible, we would like to schedule an appointment to copy the files/records.

Please call me if you have any questions.

Very truly yours,

EDER ASSOCIATES

David O'Sullivan
Environmental Engineer
BP/bl

BL0305



eder associates
environmental scientists and engineers

OFFICES:
Locust Valley, NY
Madison, WI
Ann Arbor, MI
Augusta, GA
Jacksonville, FL
Trenton, NJ
Tampa, FL

February 25, 1994
File #1187-1

Ms. Sandra Boxenbaum
Regional Records Access Officer
NYSDEC, Region I
Building 40
SUNY Stony Brook
Stony Brook, New York 11790-2356

Re: Freedom of Information Request

Dear Ms. Boxenbaum:

Eder Associates requests copies of environmental files, records, and memoranda concerning:

Aluminum Louver Corp.
310 Winding Road
Bethpage, New York 11714

This information should include: 1) past and present underground storage tank registration 2) reported spills or releases of hazardous substances; 3) generation, storage, treatment, or disposal of hazardous substances; 4) past and present groundwater, surface water, and soil investigations; and 5) environmental permits/violations.

We will reimburse your file search and copying costs.

Please let us know if you can accommodate this request in an expedient manner. If this is not possible, we would like to schedule an appointment to copy the files/records.

Please call me if you have any questions.

Very truly yours,

EDER ASSOCIATES

David O'Sullivan
Environmental Engineer

DS/bl
BL0305

APPENDIX C

TO: Records Access Officer
Nassau County Department of Health
240 Old Country Road
Mineola, New York 11501
Fax: (516) 571-1475

Date of Request: 2/28/94

I David C. Sullivan
Print your name

David C. Sullivan
signature

REPRESENTING Firm EOER ASSOCIATES Client NYSDA

Your Mailing Address 480 Forest Ave Locust Valley, N.Y. 11560

Phone Number (516) 671-8440 Fax Number (516) 671-3349

HEREBY APPLY TO INSPECT RECORDS FOR THE FOLLOWING ESTABLISHMENT:
Complete One Application For Each Form

Name Aluminium Laver Corp. Previous Name _____

Address 310 Winding Road Bethpage, New York 11714
No., Street, Community

Is the Establishment still in business? Yes ___ or No ___.
If no, enter year closes _____. (This is necessary to retrieve the file.)

CONCERNING (List the type of information needed, e.g. UST - Underground Storage Tank -, site contamination, air emissions, drinking water quality, food related concerns.)

1) Past and present UST registrations 2) reported spills or releases of hazardous

substances 3) Generation storage treatment or disposal of hazardous substances

4) Past & present groundwater, surface water, soil investigations 5) environmental permits/licenses

PLEASE CHECK THE BUREAUS WHOSE FILES YOU REQUEST TO BE SEARCHED.

Bureau of Environmental Management has files concerning:
Underground Tanks; Chemical/Oil Bulk Storage; Spills and Leaks;
Environmental Impact Statements; Medical Waste; Solid Waste;
Air Emission Sources; Air Contaminant Emissions; Smoking Violations;
Air Complaint Investigation.

Bureau of Environmental Engineering has files concerning:
Underground Tanks; Petroleum & Chemical Bulk Storage; Spill Sites;
Air Emission Sources; Road Salt Storage.

Bureau of Water Supply Protection has files concerning:
Drinking Water; Private Wells; Ground Water Quality; Backflow
Prevention Devices; Bottled Water; Realty Subdivision; Private Sewage
Disposal; Sewer Extensions.

Bureau of Environmental Sanitation has files concerning:
Food Protection; Temporary Residences; Housing; Rodent Control;
General Nuisance; Bathing Facilities; Radiological Health.

___ Approved FOR HEALTH DEPARTMENT USE ONLY		___ Denied
Signature	Title	Date

APPENDIX C

1187-1

THOMAS S. GULOTTA
COUNTY EXECUTIVE

JOHN R. SPECHT
FIRE MARSHAL



NASSAU COUNTY FIRE COMMISSION
OFFICE OF FIRE MARSHAL

899 JERUSALEM AVENUE
P.O. BOX 128
UNIONDALE, NEW YORK 11553
516-566-5200

APPLICATION FOR PUBLIC ACCESS TO RECORDS

TO: Records Access Officer

DATE: 2/25/94

I hereby apply to inspect the following record: (Exact address including Number & Street)

Aluminium Louver Corp.
310 Winding Rd. Bethpage, NY 11714

Reason for inspection: (Be specific)

Environmental Assessment

David O'Sullivan
Name (Please Print)

David O'Sullivan
Signature

EOER ASSOCIATES
Representing (Business Name)

Mailing Address: 480 Forest Ave.
Locust Valley, N.Y. 11560

Phone No.: (516) 671-8440

Pending Litigation YES NO

New York State Job Development
Person or Firm your office represents Authority

605 Third Avenue, N.Y. N.Y. 10158
Address

FOR FIRE MARSHAL USE ONLY

- | | |
|--|--|
| <input type="checkbox"/> Approved | <input type="checkbox"/> Record of which this Agency is Legal Custodian, cannot be found |
| <input type="checkbox"/> Denied for reason(s) checked | <input type="checkbox"/> Record is not Maintained by this Agency |
| <input type="checkbox"/> Confidential Disclosure - Part of Investigatory Files | <input type="checkbox"/> Exempted by Statute other than Freedom of Information Act |
| <input type="checkbox"/> Unwarranted Invasion of Personal Privacy | <input type="checkbox"/> Other _____ |

Signature _____ Title _____ Date _____

NOTICE: You have a right to appeal denial of this application to the head of this agency, the Fire Marshal, 899 Jerusalem Avenue, PO Box 128, Uniondale, NY 11553, who must fully explain his reasons for such denial in writing within seven days of receipt of an appeal.

I hereby Appeal: _____
Signature _____ Date _____

FMACCESS(011491)

APPENDIX C

APPENDIX C

APPENDIX C

SITE OPERATIONS DOCUMENTS

New York State Department of Environmental Conservation
50 Wolf Road, Albany, New York 12233-0001



Thomas C. Jorling
Commissioner

ALUMINUM LOUVRE CORPORATION
161 SWEET HOLLOW ROAD
OLD BETHPAGE, NY 11804

FEBRUARY 01, 1994

EPA ID NUMBER : NYD981488026
REFERENCE CODE NO.: 1

RE: MANIFEST DOCUMENT NUMBER INA0686440
SHIPPED TO SYSTECH/LONE STAR INDUSTRIES
SHIPPED ON 12/29/93

DEAR HAZARDOUS WASTE COORDINATOR:

OUR RECORDS INDICATE THAT WE HAVE NOT RECEIVED A COPY OF THE ABOVE REFERENCED MANIFEST SIGNED BY THE DISPOSAL FACILITY CONFIRMING DELIVERY OF THE HAZARDOUS WASTE SHIPMENT.

IF YOU, THE GENERATOR, HAVE NOT RECEIVED A COPY CONFIRMING DELIVERY, IMMEDIATELY FORWARD AN EXCEPTION REPORT TO THE DEPARTMENT EXPLAINING THE CURRENT DISPOSITION OF THIS HAZARDOUS WASTE SHIPMENT.

IF YOU HAVE RECEIVED YOUR CONFIRMATION COPY SIGNED BY THE DISPOSAL FACILITY, PLEASE FORWARD A LEGIBLE PHOTOCOPY, ALONG WITH A COPY OF THIS LETTER, TO THE ADDRESS LISTED BELOW.

TO AVOID FUTURE PROBLEMS IN THIS REGARD; PLEASE REQUEST THAT THE DISPOSAL FACILITY FORWARD THE APPROPRIATE COPY TO NEW YORK STATE DIRECTLY.

NYS DEC - Division of Hazardous Substances Regulation
Manifest Section
P.O. Box 12820
Albany, N.Y. 12212

Sincerely,

INDIANA DEPARTMENT OF ENVIRONMENTAL MANAGEMENT
 OFFICE OF SOLID AND HAZARDOUS WASTE MANAGEMENT
 P.O. Box 7035
 Indianapolis, IN 46207-7035

PLEASE PRINT OR TYPE

(Form designed for use on elite (12-pitch typewriter)

Form Approved. OMB No. 2050-0039 Expires 9-30-94

UNIFORM HAZARDOUS
 WASTE MANIFEST

1. Generator's US EPA No.

N.Y.D.9.8.1.4.8.8.0.2.6

2. Page 1

1 of 1

Information in the shaded area is not required by Federal law, but items D, F, H, I and K are required by State law.

3. Generator's Name and Mailing Address

ALUMINUM LOUVRE CORP.
 161 STREET HOLLOW ROAD, OLD BETHPAGE, NY 11804

A. State Manifest Document Number

INA 0686440

B. State Generator's ID

SAME

4. Generator's Phone (516)

756-1850

C. State Transporter's ID JA-125

5. Transporter 1 Company Name

Detrex corporation

6. US EPA ID Number

NJ.D.0.4.7.3.1.8.0.4.3

D. Transporter's Phone 609-786-8686

7. Transporter 2 Company Name

8. US EPA ID Number

E. State Transporter's ID

F. Transporter's Phone

9. Designated Facility Name and Site Address

SYSTECH ENVIRONMENTAL CORP.
 LIMEDALE ROAD, GREEN CASTLE, IN 46135

10. US EPA ID Number

I.N.D.0.0.6.4.1.9.2.1.2

G. State Facility's ID

H. Facility's Phone 317-653-2606

11. US DOT Description (Including Proper Shipping Name, Hazard Class, and ID Number)

RC, WASTE FLAMMABLE LIQUIDS, n.o.s.,
 (TOLUENE, XYLENE)
 3, UN1993, PGII

12. Containers		13. Total Quantity	14. Total Wt/Vol.	I. Waste No
No.	Type			
016	D.H.	00800G		F003
.
.
.

Additional Information (Including DOT Hazard Labels)

Special Handling Codes for Wastes Listed Above

a) F005, D001

T-16

5. Special Handling Instructions and Additional Information

code; a) AA46762

DECAL: 56604
 56608

ERG427(ATTACHED) EMERGENCY CONTACT 313-358-5800

7.001112

6. GENERATOR'S CERTIFICATION: I hereby declare that the contents of this consignment are fully and accurately described above by proper shipping name and are properly packed, marked, and labeled, and are in all respects in proper condition for transport by highway according to applicable international and national government regulations.

If I am a large quantity generator, I certify that I have a program in place to reduce the volume and toxicity of waste generated to the degree I have determined to be economically practicable and that I have selected the practicable method of treatment, storage, or disposal currently available to me which minimizes the present and future threat to human health and the environment. OR, if I am a small quantity generator, I have made a good faith effort to minimize my waste generation and select the best waste management method that is available to me and that I can afford.

Printed Type Name

LEE POA

Signature

Lee Poa

Date

12/29/93

7. Transporter 1 Acknowledgement of Receipt of Materials

Printed Type Name

John PARKER

Signature

John Parker

Date

12/29/93

8. Transporter 2 Acknowledgement of Receipt of Materials

Printed Type Name

Signature

Month Day Year

9. Discrepancy (Include Date)

INA 0686440

SYSTECH ENVIRONMENTAL CORPORATION
245 North Valley Road
Xenia, Ohio 45385
(513)372-8077

CERTIFICATE OF DESTRUCTION

is hereby certifies that waste as defined on Hazardous Waste
Manifest No. INA0686440/86440 from ALUMINUM LOUVRE CORPORATION,
Manifest Identification # NYD981488026, was received by
Systech Environmental Corp., EPA RCRA Permit Identification #
D006419212.

The waste material, was received on: 01/06/94

This waste is to be re-used in accordance with Federal
(40 CFR 260 thru 270) and corresponding State hazardous waste
regulations.

Disposal method: Hazardous Waste burned for energy recovery in
Cement Kiln.

Destruction Commenced on or about the following date*:

01/13/94

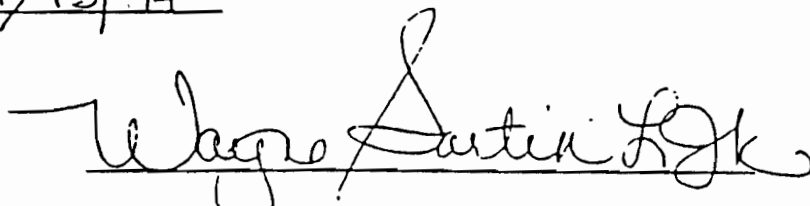

Wayne Sartin
Facility Manager

ALUMINUM LOUVRE CORPORATION

100 West Hollow Road - Old Bethpage, New York 11804
Phone Area Code 516 - 756-1850



↓
LOUVRES FOR LIGHTING
LOUVRES FOR DECORATING
LOUVRES FOR BUILDING
LOUVRES FOR CONDITIONING

February 25, 1994

N.Y.S. Department of Environmental Conservation
Nassau County Department of Health
240 Old Country Road
Mineola, NY 11501

Re: Location: 282400
Fac: 5692
EP : 00001 W I
00002 W I
00004 W I
00005 W I

Gentlemen:

The above EP numbers covering the following units are no longer being used by Aluminum Louvre Corporation:

- EP: 00001 - 1. ConveyORIZED Bake Oven for Curing high solids paint
2. and Polyester Powders previously sprayed on
3. aluminum strips.
- EP: 00002 1. Entrance vestibule for a 3 stage phosphate washer
- EP: 00004 1. Spray booth to apply high solids bake enamel to
2. cleaned aluminum strips
- EP: 00005 1. Spray booth to apply high solids bake enamel to
2. cleaned aluminum strips

Since we are not going to use these units we will not have to renew the permits necessary for operation.

If you have any questions, please contact the undersigned.

Very truly yours,

APPENDIX A

APPENDIX B

APPENDIX C

APPENDIX A

VISTA NATIONAL RADIUS PROFILE

VISTA NATIONAL RADIUS PROFILE

VISTA Report #: 5/037923-001

Date of Report: 2/28/94

Ref/Loan #: ALUMINUM LOUVER CORP
 Client: DAVID O'SULLIVAN, EDER ASSOCIATES-LOCUST VALLEY
 480 FOREST AVE, LOCUST VALLEY, NY 11560
 Subject
 Property: 310 WINDING RD
 BETHPAGE, NY 11714

SUMMARY OF FEDERAL RECORDS FOUND

Database & Date	Agency and Type of Records	0 to 1/8 mi	1/8 to 1/4 mi	1/4 to 1/2 mi	1/2 to 1 mi	TOTAL
NPL 01/94	US EPA Superfund Sites	1	0	0	0	1
CERCLIS 11/93	US EPA Potential Superfund Sites	1	0	0	--	1
RCRA-LgGen 07/93	US EPA RCRA Large Quantity Generators	1	1	--	--	2
RCRA-SmGen 07/93	US EPA RCRA Small and Very Small Quantity Generators	0	0	--	--	0
RCRA-TSD 07/93	US EPA RCRA Treatment, Storage, and/or Disposal Sites	0	0	0	0	0
RCRA-Transp 07/93	US EPA RCRA Transporters	0	0	--	--	0
ERNS 09/93	US EPA	0	--	--	--	0
FEDERAL RECORDS Sub-total:		3	1	0	0	4

Note: 1) A dash (--) indicates the list is not searched at that distance.
 2) Sites often have a record in more than one database.

VISTA NATIONAL RADIUS PROFILE

VISTA Report #: 5/037923-001

Date of Report: 2/28/94

Ref/Loan #: ALUMINUM LOUVER CORP
 Client: DAVID O'SULLIVAN, EDER ASSOCIATES-LOCUST VALLEY
 480 FOREST AVE, LOCUST VALLEY, NY 11560
 Subject
 Property: 310 WINDING RD
 BETHPAGE, NY 11714

SUMMARY OF STATE RECORDS FOUND

Database & Date	Agency and Type of Records	0 to 1/8 mi	1/8 to 1/4 mi	1/4 to 1/2 mi	1/2 to 1 mi	TOTAL
SPL 05/93	Department of Environmental Conservation, Bureau of Hazardous Site Control Inactive Hazardous Waste Disposal Sites	1	0	0	1	2
LUST 10/93	Department of Environmental Conservation LUST (Tank Test Failures) Database	0	0	6	--	6
SWLF 01/93	Department of Environmental Conservation, Bureau of Waste Management Incinerators-Resource Recovery Projects	0	0	0	--	0
SWLF 04/93	Department of Environmental Conservation, Bureau of Municipal Waste Recycler's Listing	0	0	0	--	0
SWLF 04/93	Department of Environmental Conservation, Division of Municipal Waste Active Solid Waste Disposal Sites	0	0	0	--	0
UST's 01/93	Suffolk County Department of Health Suffolk County Petroleum Bulk Storage Database	0	0	--	--	0
UST's 06/93	Cortland County Health Department, Division of Environmental Health Cortland County Petroleum Bulk Storage Database	0	0	--	--	0
UST's 10/93	Dept. of Env. Conservation, Petroleum Bulk Storage Underground Storage Tank Database	0	0	--	--	0
UST's 10/93	Rockland County Department of Health Rockland County Petroleum Bulk Storage Database	0	0	--	--	0
STATE RECORDS Sub-total:		1	0	6	1	8
TOTAL:		4	1	6	1	12

Note: 1) A dash (--) indicates the list is not searched at that distance.
 2) Sites often have a record in more than one database.

VISTA NATIONAL RADIUS PROFILE

- ★ Subject Property
- Agency Records
- ⋯ Railroads and Water Features

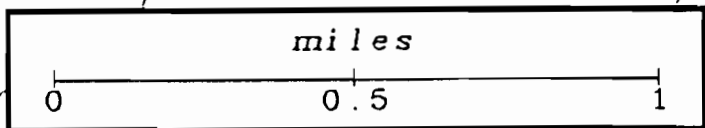
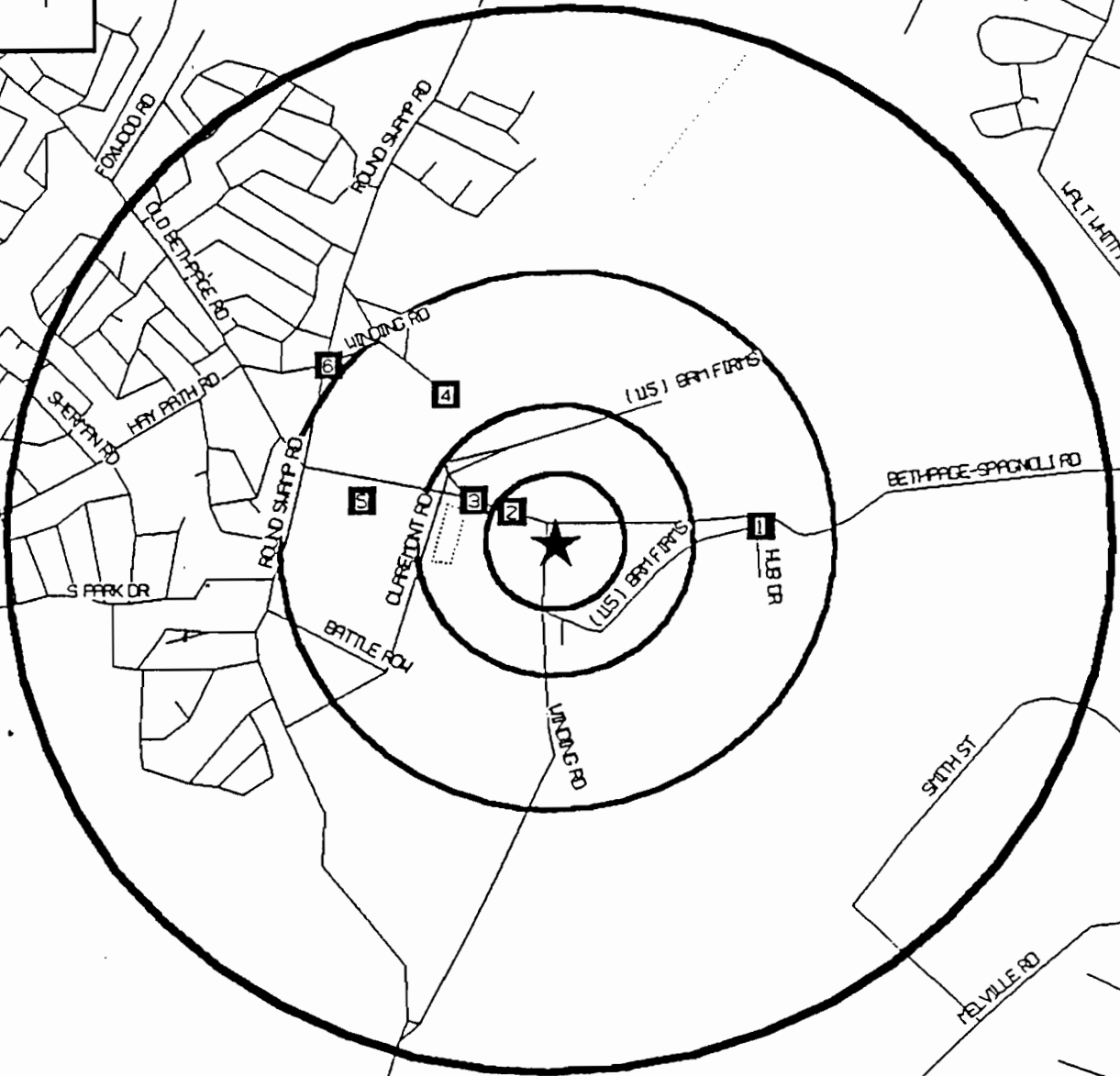
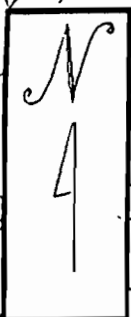

5/037923-001 (ALUMINUM LOUVER CORP)

VISTA NATIONAL RADIUS PROFILE

2/28/94

VISTA Report #: 5/037923-001

Page: 1

NPL

MAP	EPA ID /	
REF #	AGENCY ID	SITE NAME AND ADDRESS

=====

WITHIN 1/8 MILE

2	CLAREMONT POLYCHEMICAL CORP 501 WINDING RD	OLD BETHPAGE 11804	Distance: .10 mi. Direction: NW Vista ID: 85911
NYD002044584	Status : CURRENTLY ON FINAL NPL Site Ownership : PRIVATE/NON-GOVERNMENTAL		

VISTA NATIONAL RADIUS PROFILE

2/28/94

VISTA Report #: 5/037923-001

Page: 2

CERCLIS

MAP REF #	EPA ID / AGENCY ID	SITE NAME AND ADDRESS
--------------	-----------------------	-----------------------

=====

WITHIN 1/8 MILE

2	CLAREMONT POLYCHEMICAL CORP 501 WINDING RD	OLD BETHPAGE 11804	Distance: .10 mi. Direction: NW Vista ID: 85911
---	---	-----------------------	---

NYD002044584	Status	: CURRENTLY ON FINAL NPL
	Site Ownership	: PRIVATE/NON-GOVERNMENTAL
	Lead Agency	: FUND LEAD
	Site Events	:
	Event Type	: DISCOVERY
	Lead Agency	: FUND LEAD
	Lead Agency	: FUND LEAD
	Event Type	: PROPOSED FOR NPL
	Lead Agency	: FUND LEAD
	Event Type	: PRELIMINARY ASSESSMENT
	Lead Agency	: FUND LEAD
	Event Type	: REMOVAL ACTION
	Lead Agency	: FUND LEAD
	Event Type	: SCREENING SITE INSPECTION
	Lead Agency	: FUND LEAD

VISTA NATIONAL RADIUS PROFILE

2/28/94

VISTA Report #: 5/037923-001

Page: 3

RCRA-LgGen

MAP REF #	EPA ID / AGENCY ID	SITE NAME AND ADDRESS
--------------	-----------------------	-----------------------

=====

WITHIN 1/8 MILE

2	CLAREMONT POLYCHEMICAL CORP USEPA RE 501 WINDING RD	OLD BETHPAGE 11804	Distance: .10 mi. Direction: NW Vista ID: 85911
---	--	-----------------------	---

NYD002044584 Generator Class :Generators who generate at least 1000 kg./month of non-acutely hazardous waste (or 1 kg./month of acutely hazardous waste).

WITHIN 1/8 TO 1/4 MILE

3	CAPTREE CHEMICALS CORP 445 WINDING ROAD	OLD BETHPAGE 11804	Distance: .17 mi. Direction: NW Vista ID: 69377
---	--	-----------------------	---

NYD980753776 Generator Class :Generators who generate at least 1000 kg./month of non-acutely hazardous waste (or 1 kg./month of acutely hazardous waste).

VISTA NATIONAL RADIUS PROFILE

2/28/94

VISTA Report #: 5/037923-001

Page: 4

SPL:

MAP REF #	EPA ID / AGENCY ID	SITE NAME AND ADDRESS	
--------------	-----------------------	-----------------------	--

WITHIN 1/8 MILE

2	CLAREMONT POLYCHEMICAL CORP 501 WINDING RD	OLD BETHPAGE 11804	Distance: .10 mi. Direction: NW Vista ID: 85911
130015	Facility Type : OPEN DUMP Lead Agency : FUND LEAD State Status : UNDER DESIGN Waste # 0 : METHYL/ETHYL STATE Detailed Site Description Available Call 1-800-877-3824 for Details. Facility Type : OPEN DUMP Lead Agency : FUND LEAD State Status : UNDER DESIGN Waste # 0 : TOULENE Waste # 1 : METHYL/ETHYL Waste # 2 : UNKNOWN STATE Detailed Site Description Available Call 1-800-877-3824 for Details.		

WITHIN 1/2 TO 1 MILE

6	NASSAU COUNTY FIRE TRAINING CENTER WINDING ROAD	OLD BETHPAGE	Distance: .53 mi. Direction: NW Vista ID: 1263211
130042	Lead Agency : STATE State Status : UNDER DESIGN Waste # 0 : METHYL/ETHYL Waste # 1 : METHYL/ETHYL STATE Detailed Site Description Available Call 1-800-877-3824 for Details. Lead Agency : STATE State Status : UNDER DESIGN Waste # 0 : METHYL/ETHYL Waste # 1 : UNKNOWN Waste # 2 : METHYL/ETHYL STATE Detailed Site Description Available Call 1-800-877-3824 for Details. Lead Agency : STATE State Status : UNDER DESIGN Waste # 0 : SOLVENTS		

VISTA NATIONAL RADIUS PROFILE

2/28/94

VISTA Report #: 5/037923-001

Page: 5

SPL.

MAP REF #	EPA ID / AGENCY ID	SITE NAME AND ADDRESS
--------------	-----------------------	-----------------------

=====

WITHIN 1/2 TO 1 MILE

6	NASSUA COUNTY FIRE TRAINING CE WINDING ROAD	OLD BETHPAGE 11804	Distance: .53 mi. Direction: NW Vista ID: 1263211
---	--	-----------------------	---

Waste # 1 : UNKNOWN
Waste # 2 : TOULENE

STATE Detailed Site Description Available
Call 1-800-877-3824 for Details.
