

FPM Group, Ltd.
FPM Engineering Group, P.C.
formerly Fanning, Phillips and Molnar

CORPORATE HEADQUARTERS
909 Marconi Avenue
Ronkonkoma, NY 11779
631/737-6200
Fax 631/737-2410

VIA EMAIL

January 17, 2017

Mr. Jeffrey Dyber, P.E.
Environmental Engineer
Division of Environmental Remediation
New York State Department of Environmental Conservation
625 Broadway
Albany, NY 12233-7016

Re: **Soil Vapor Intrusion Sampling Work Plan
Win Holt Equipment Corp. Site #V00243-1
Garden City, NY
FPM File No. 562-17-20 (01)**

Dear Mr. Dyber:

This letter work plan has been prepared by FPM Group (FPM) to conduct a soil vapor Intrusion (SVI) investigation at 582 Brook Street to evaluate if continued sub-slab depressurization is needed. Active remedial efforts have been completed and subsurface conditions onsite have improved since implementation of the remedy as document in the February 2015 – March 2016 Period Review Report. The remedial system situated at 562 Brook Street was modified to provide sub-slab-depressurization for 582 Brook Street in October 2010 to address SVI concerns in accordance with the NYSDEC requirements and remains in continuous operation. Monitoring of the emissions from sub-slab depressurization efforts utilizing a PID have shown no responses above 0 parts per million and available laboratory analytical (See Table 1) suggest that volatile organic compounds no longer pose a concern for SVI at the adjoining 582 Brook Street building. Therefore, based upon this information FPM is requesting NYSDEC approval to shut down the SVE system to perform an SVI investigation.

Please note that performance of this work is contingent on obtaining an access agreement with the adjoining property owner. We understand that access is conditionally approved pending completion of an access agreement.

The sampling procedures will be in accordance with the procedures in the NYSDEC-approved Remedial Action Work Plan (RAWP) for this site and are incorporated into this work plan by reference. A site plan (Figure 1) showing the location of the sub-slab and indoor air sampling points and pertinent site features is attached for your reference. The primary sampling will include a sub-slab soil vapor sample and co-located indoor air sample. An ambient air sample will also be collected.

The proposed scope of work is as follows:

- The SVE system shall be shut down for two weeks prior to sampling and will be restarted following the completion of sampling;
- Collection of a sub-slab soil vapor and collocated indoor air sample at 582 Brook Street will be performed;
- All samples will be collected in accordance with the procedures in the RAWP and associated documents. Quality assurance/quality control (QA/QC) samples (duplicate and trip blank), Category B lab reports, data usability summary reports (DUSRs), and NYSDEC electronic data deliverables (EDDs) will be provided. All samples will be analyzed by laboratories certified by the New York State Department of Health; and
- Following the receipt of the SVI data, FPM will prepare a data transmittal documenting the investigation results and provide the data to the NYSDEC together with our recommendation for the SVE system. The laboratory data EDDs will also be prepared and submitted to the NYSDEC.

Please confirm that the above-described scope of work is acceptable. If you have any questions, please do not hesitate to email or call me at (631) 737-6200, ext. 209.

Very truly yours,



Ben T. Cancemi
Senior Hydrogeologist
Department Manager

BTC:btc
Attachment

S:\Win-Holt\SVI WP.Docx

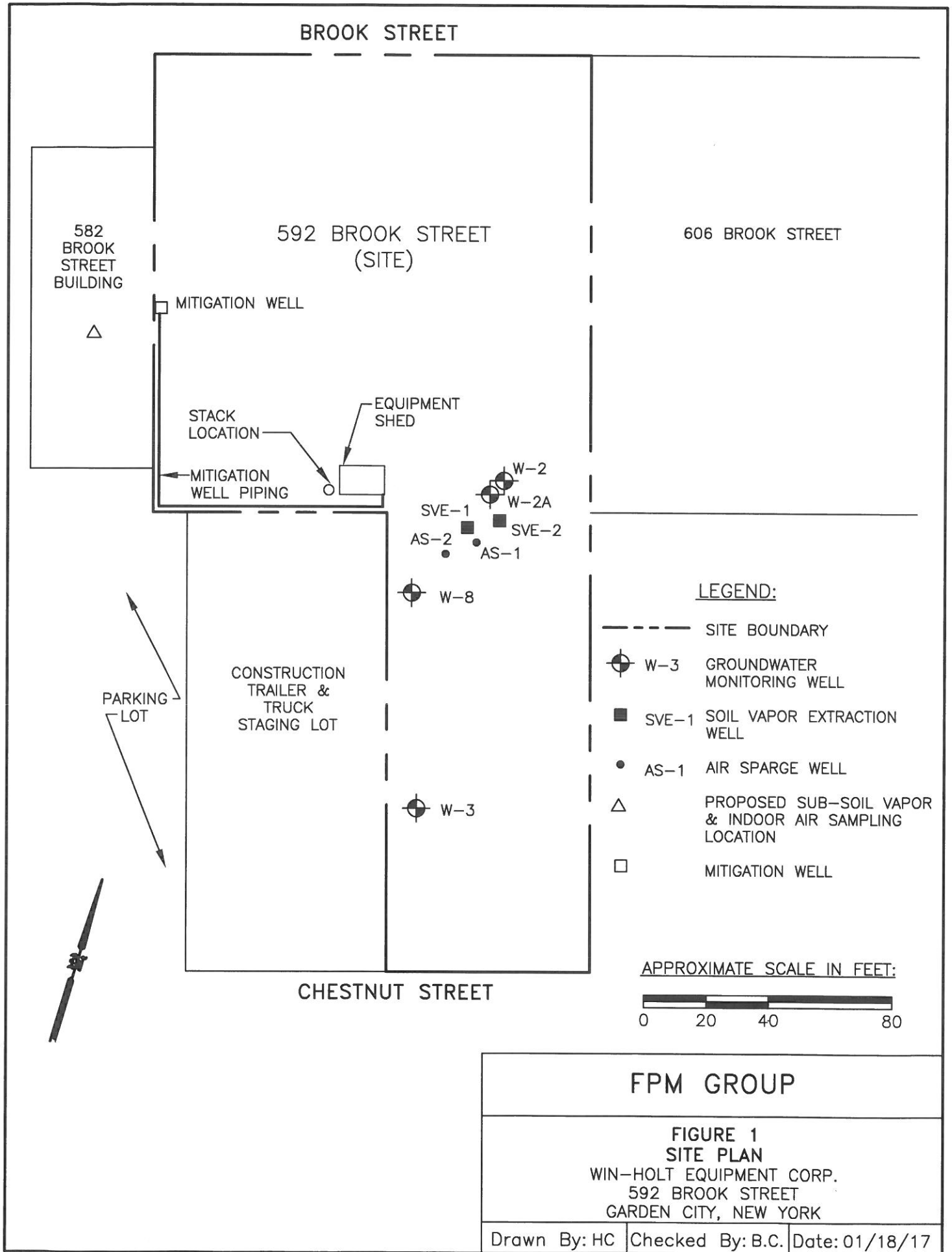

TABLE 1
EFFLUENT CHEMICAL ANALYTICAL DATA
WIN-HOLT EQUIPMENT CORPORATION
GARDEN CITY, NEW YORK

Compound	6/18/2015*	6/15/2016**
1,1,1-Trichloroethane	ND	8.2
Tetrachloroethylene	29.9	4.0
Trichloroethylene	14.5	4.4
cis 1,2-Dichloroethylene	8.7	ND

Concentrations in micrograms per cubic meter

Detected NYSDOH Matrix 1 & 2 compounds listed.

* Remedial SVE and sub-slab depressurization wells online

** Sub-slab depressurization well online only