

**WHITE PLAINS
FORMER MGP SITE**

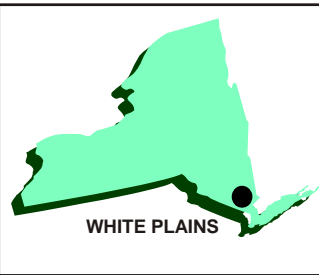

WHITE PLAINS

New York
Quadrangle

LATITUDE: N42° 02' 00"
LONGITUDE: W73° 46' 16"



SOURCE: DeLORME 3-D
TOPOQUAD PROGRAM

FIGURE 1.1

CONSOLIDATED EDISON
WHITE PLAINS FORMER MGP SITE
WHITE PLAINS, NEW YORK

SITE LOCATION MAP

PARSONS

301 PLAINFIELD ROAD, SUITE 350, SYRACUSE, NY 13212 PHONE: (315) 451-9560

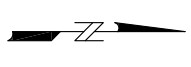
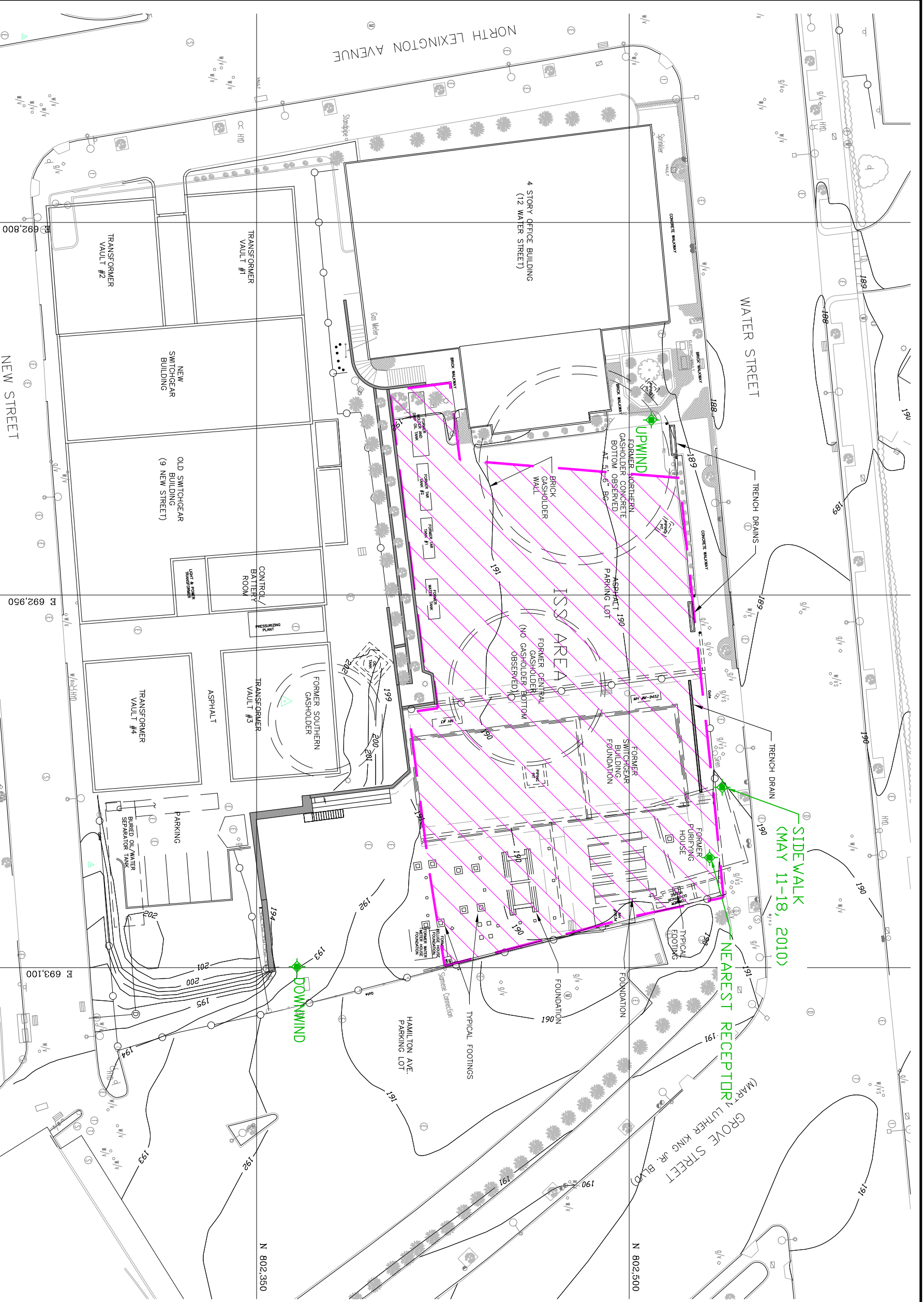

- LEGEND**
- FORMER MGP STRUCTURES
 - RETAINING WALLS
 - CONTOURS
 - TREES/SHRUBS
 - CHAINLINK FENCE
 - HANDRAILS
 - ISS AREA
 - BOLLARDS
 - CATCH BASIN
 - DRAIN INLET
 - LIGHT POSTS
 - TRAFFIC BOXES
 - STORM SEWER MANHOLE
 - SANITARY SEWER MANHOLE
 - ELECTRIC MANHOLE
 - WATER MANHOLE
 - TELECOMMUNICATION MANHOLE
 - MANHOLE
 - TRAFIC MANHOLE
 - HYDRANT
 - PEDESTRIAN WALK SIGNAL
 - PARKING METER
 - AIR MONITORING STATION

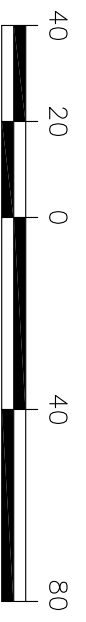

FILE NAME: P:\CONED\446107 - WHITE PLAINS\CA\2010 RECORD DWGS\FIGURES\Fig 4-1-REC.DWG
 PLOT DATE: 11/19/2010 12:36 PM PLOTTED BY: RUSSO, JILL

PARSONS
 301 PLAINFIELD ROAD
 SUITE 350
 SYRACUSE, N.Y. 13212
 PHONE: (315) 451-9560
 FAX: (315) 451-9570

Con Edison

WHITE PLAINS FORMER MGP SITE
WHITE PLAINS, NEW YORK
 AIR MONITORING STATION LOCATIONS

FIGURE NO.
4.1

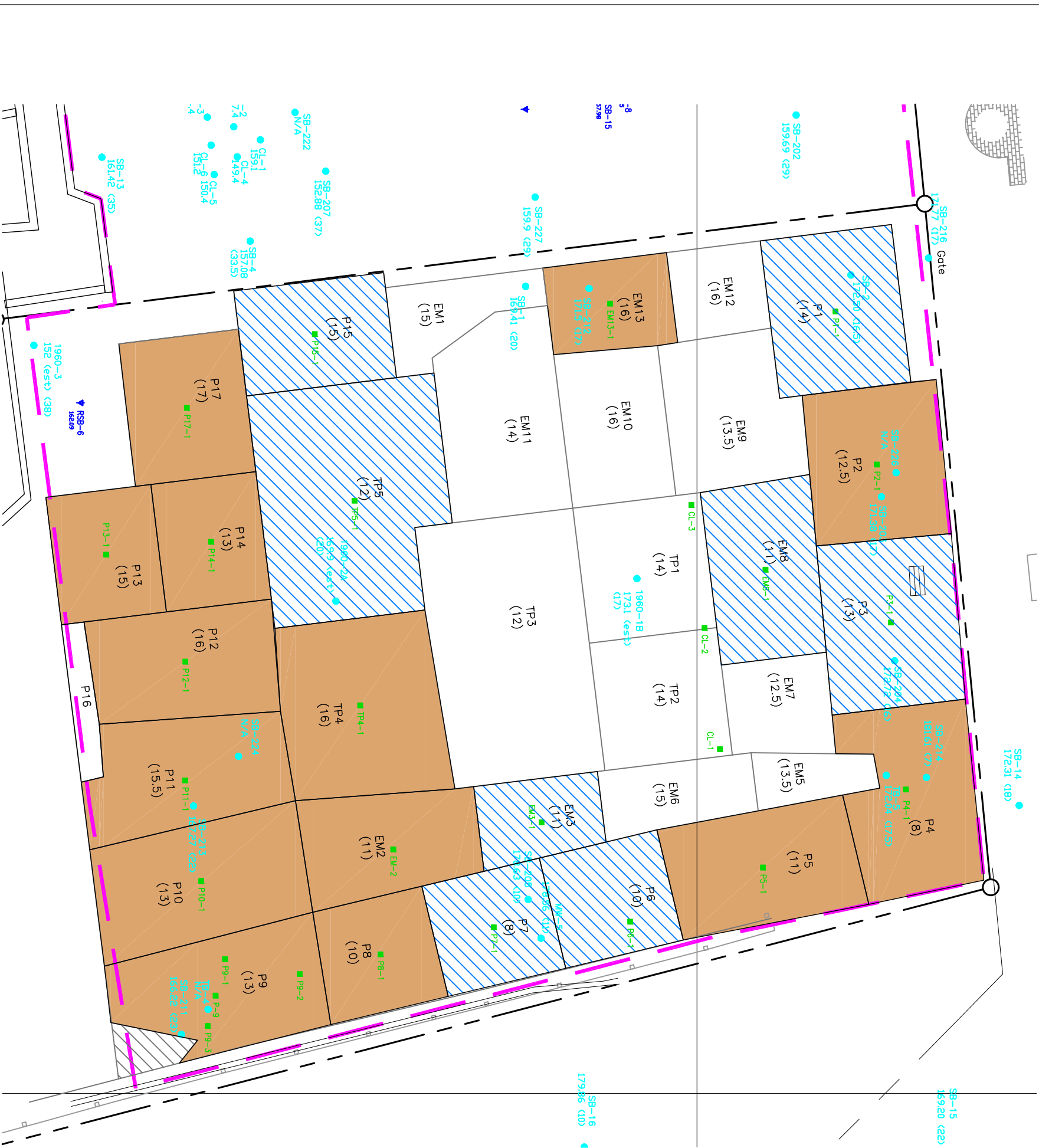
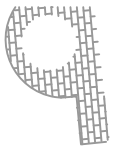

- LEGEND:**
- ROTOSONIC BORING LOCATION (WITH BEDROCK ELEVATION)
 - COMPLETED CORE LOCATION (APPROXIMATE LOCATION-NOT SURVEYED)
 - HISTORICAL BORING LOCATION
 - BEDROCK ELEVATION
 - ANTICIPATED DEPTH TO BEDROCK
 - EXCAVATOR BASED ISS CELL
 - APPROXIMATE DEPTH OF ISS TREATED SOIL FROM WORKING GRADE
 - CELLS WITH UNTREATED SOIL
 - CELLS WITH 0-12" OF UNTREATED SOIL

NOTE:
 BASE MAP DRAWING PROVIDED BY
 TERRY BERGENDRFF COLLINS
 SURVEYING DN 3/19/09.

PARSONS

301 PLAINFIELD ROAD
 SUITE 350
 SYRACUSE, N.Y. 13212
 PHONE: (315) 451-9560
 FAX: (315) 451-9570

Cor Edison

WHITE PLAINS FORMER MGP SITE
 WHITE PLAINS, NEW YORK
 EXCAVATOR-ISS CELL LOCATION PLAN

FIGURE NO.

4.2

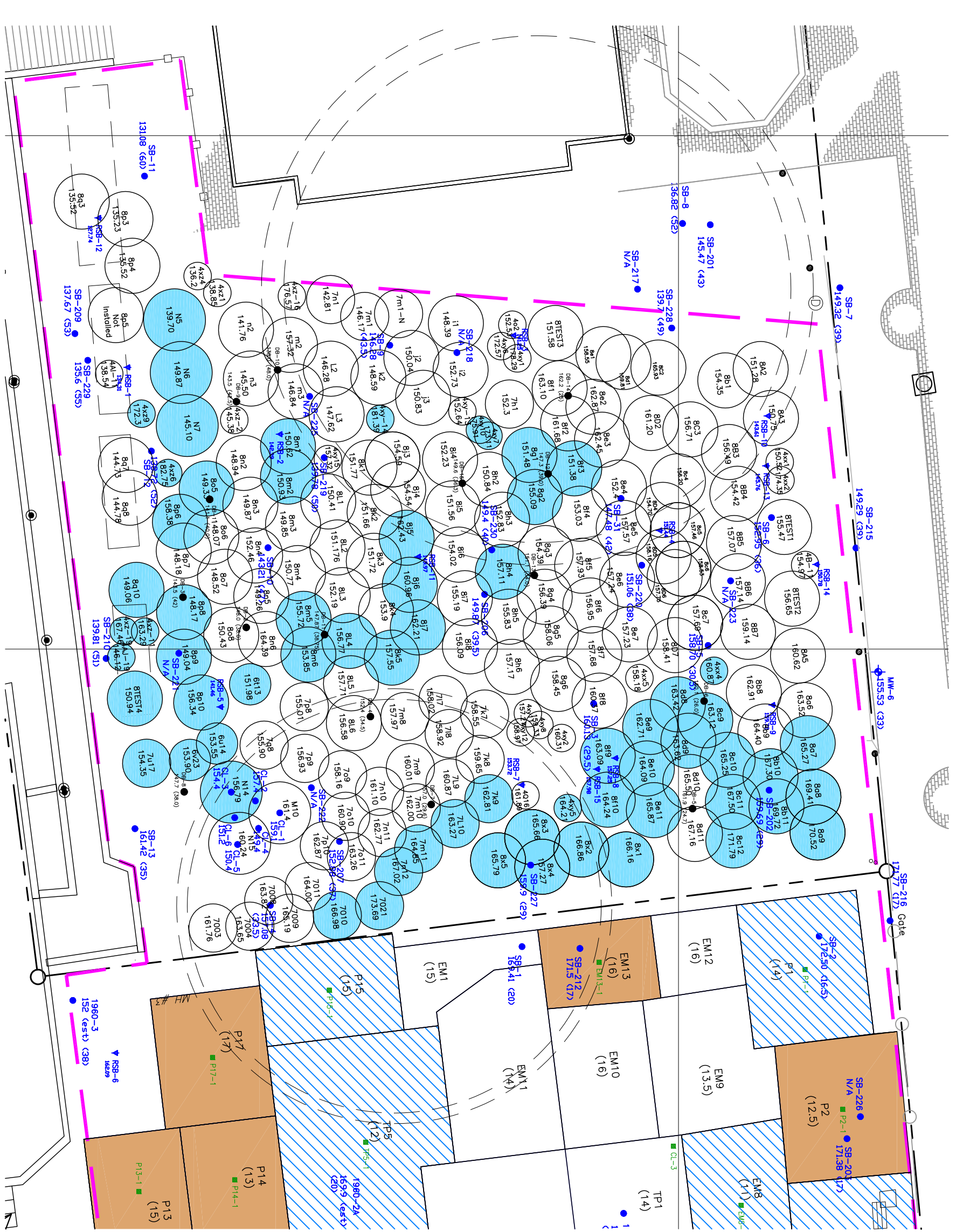

- LEGEND:**
- ▼ ROTASONIC BORING LOCATION (WITH BEDROCK ELEVATION)
 - COMPLETED CORE LOCATION (APPROXIMATE LOCATION-NOT SURVEYED)
 - HISTORICAL BORING LOCATION
 - DELINEATION BORING FOR HOT SPOT ISS COLUMNS
 - 16727 BEDROCK ELEVATION
 - ⟨22⟩ ANTICIPATED DEPTH TO BEDROCK
 - P11 EXCAVATOR-ISS CELL
 - (15.5) APPROXIMATE DEPTH OF ISS TREATED SOIL FROM WORKING GRADE
 - CELLS WITH UNTREATED SOIL
 - ▨ CELLS WITH 0-12" OF UNTREATED SOIL
 - NS AUGER-ISS COLUMN NUMBER AND BOTTOM ELEVATION
 - NS 139.70 AUGER-ISS HOT SPOT COLUMNS TO BEDROCK

NOTE: BASE MAP DRAWING PROVIDED BY TERRY BERGENDORFF COLLINS SURVEYING ON 8/3/09.

PARSONS
 301 PLAINFIELD ROAD
 SUITE 350
 SYRACUSE, N.Y. 13212
 PHONE: (315) 451-9560
 FAX: (315) 451-9570

Con Edison

WHITE PLAINS FORMER MGP SITE
 WHITE PLAINS, NEW YORK
 AUGER-ISS COLUMN LOCATION PLAN

FIGURE NO.
 4.3

WATER STREET

GATE

ELEC. CONDUIT AND CONC. OBSTRUCTION





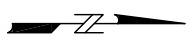

APPROX. LOCATION OF ELEC. CONDUIT PER CONSTRUCTION DWG

P3 UNDERGROUND DRAINAGE PIPE TYP. (FOUND AND SEALED)

CAPPED WIRES FOUND (POSSIBLE DUCT BANK)

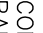

LEGEND:

-  COMPLETED JET GROUT COLUMN
-  JET GROUT HOT-SPOT COLUMN
-  PERIMETER JET GROUT COLUMN
-  COMPLETED JET GROUT WALL
-  AUGER-ISS COLUMN
-  DRILLED JET GROUT LOCATION COMPLETELY THROUGH ISS-NO JETTING DONE
-  COMPLETED 180° JET GROUT COLUMN
-  COMPLETED JET GROUT WALL PANEL LOCATION

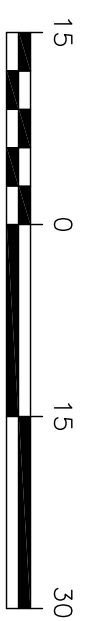

SCALE: 1" = 15'

NOTE: BASE MAP PROVIDED BY TERRY BERGENDORFF COLLINS SURVEYING ON 4/18/10.

FILE NAME: S:\448107 - WHITE PLAINS\GD\2010 RECORD DWGS\FIGURES\FIG 4-4-REC.DWG
PLOT DATE: 5/6/2011 8:44 AM PLOTTED BY: MCFARLANE, TAMESHA

PARSONS

301 PLAINFIELD ROAD
SUITE 350
SYRACUSE, N.Y. 13212
PHONE: (315) 451-9560
FAX: (315) 451-9570

Con Edison

WHITE PLAINS FORMER MGP SITE
WHITE PLAINS, NEW YORK
JET GROUT COLUMN LOCATION PLAN

FIGURE NO.
4.4

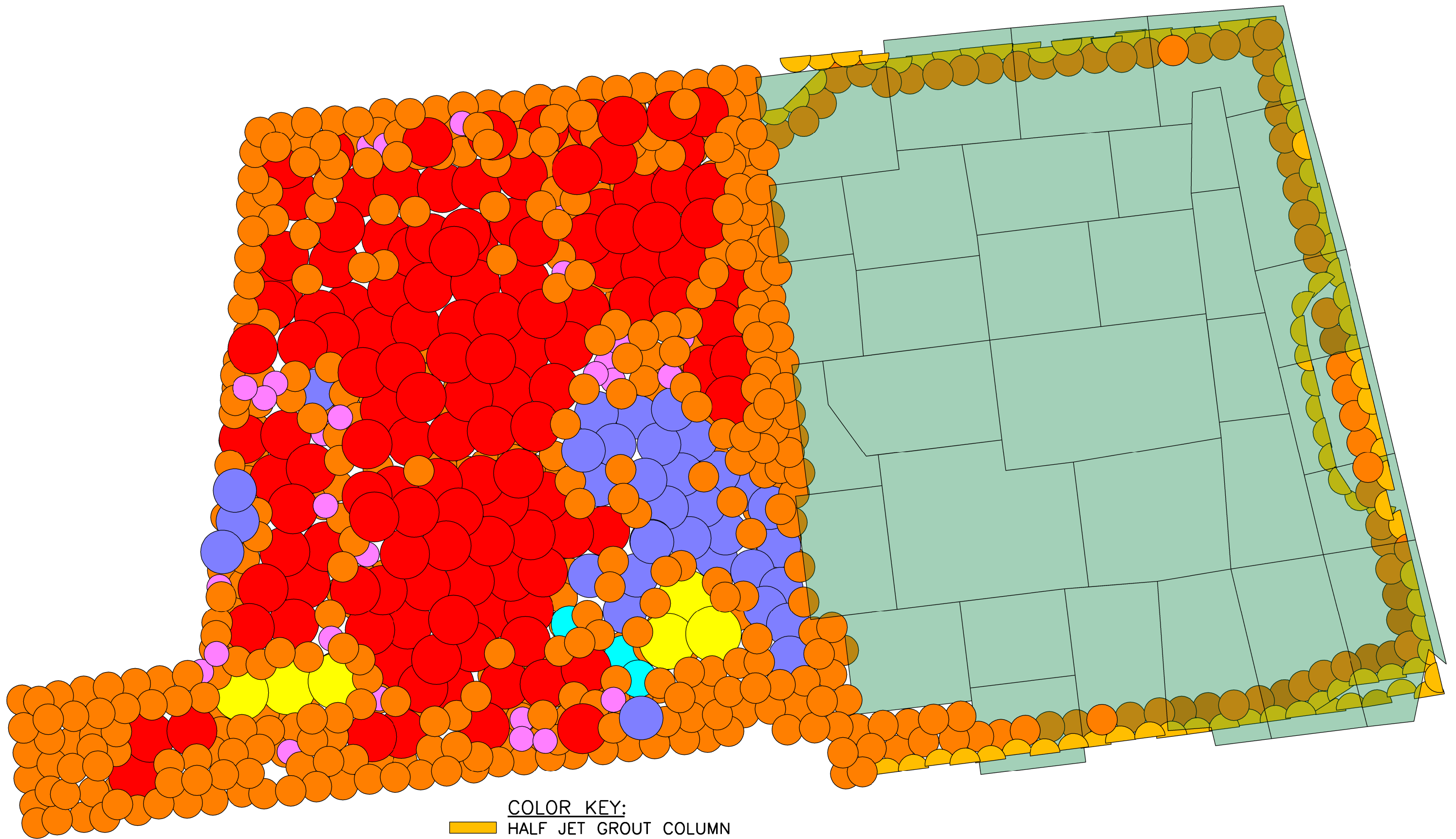

COLOR KEY:

- HALF JET GROUT COLUMN
- FULL JET GROUT COLUMN
- 9-FT DIAMETER AUGER COLUMN
- 8-FT DIAMETER AUGER COLUMN
- 7-FT DIAMETER AUGER COLUMN
- 6-FT DIAMETER AUGER COLUMN
- 4-FT DIAMETER AUGER COLUMN
- EXCAVATOR ISS

PARSONS
 301 PLAINFIELD ROAD
 SUITE 350
 SYRACUSE, N.Y. 13212
 PHONE: (315) 451-9560
 FAX: (315) 451-9570

Con Edison

WHITE PLAINS FORMER MGP SITE
 WHITE PLAINS, NEW YORK

ISS PLAN VIEW

FIGURE NO.

4.5

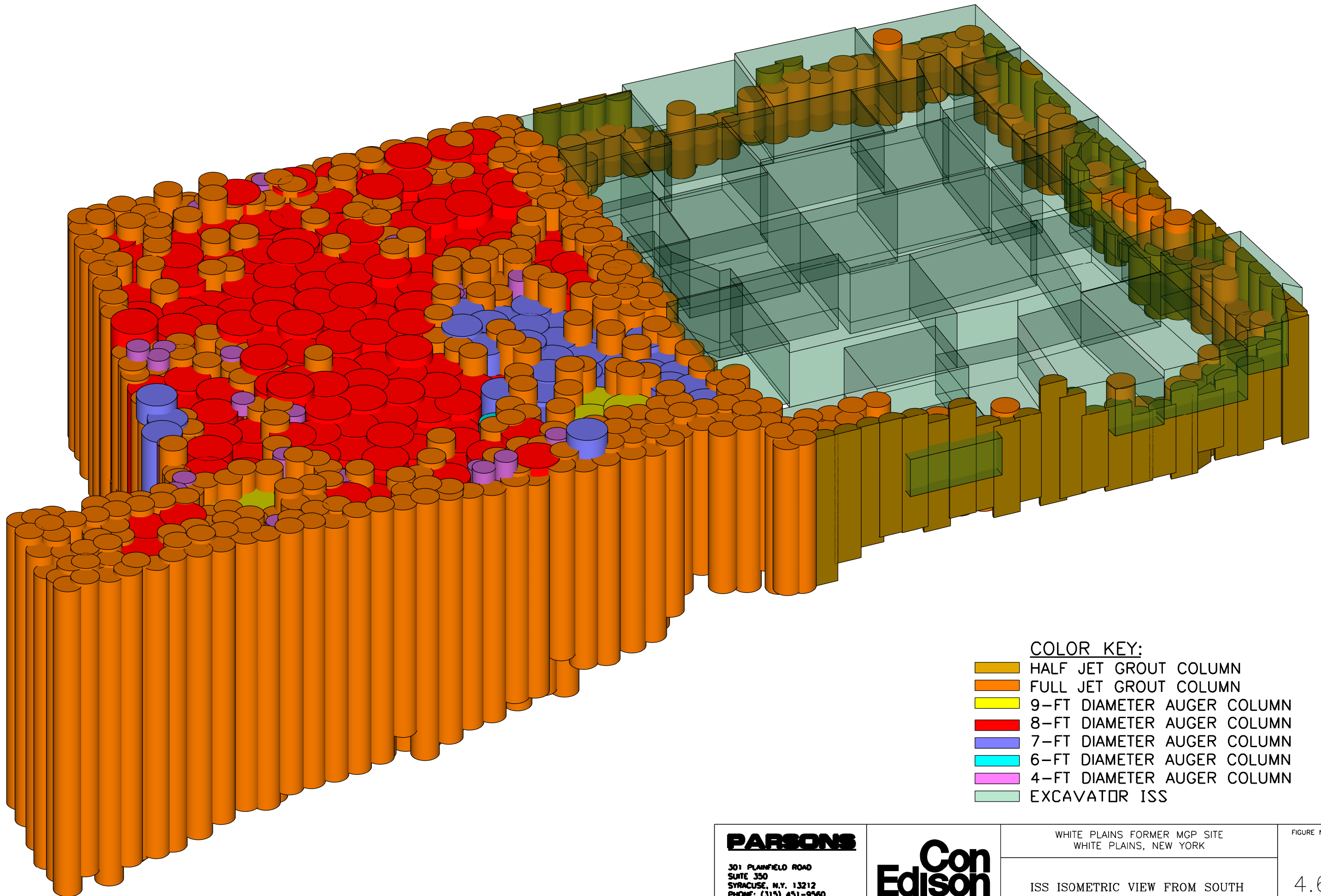

COLOR KEY:

- HALF JET GROUT COLUMN
- FULL JET GROUT COLUMN
- 9-FT DIAMETER AUGER COLUMN
- 8-FT DIAMETER AUGER COLUMN
- 7-FT DIAMETER AUGER COLUMN
- 6-FT DIAMETER AUGER COLUMN
- 4-FT DIAMETER AUGER COLUMN
- EXCAVATOR ISS

PARSONS

301 PLAINFIELD ROAD
SUITE 350
SYRACUSE, N.Y. 13212
PHONE: (315) 451-9560
FAX: (315) 451-9570

Con Edison

WHITE PLAINS FORMER MGP SITE
WHITE PLAINS, NEW YORK

ISS ISOMETRIC VIEW FROM SOUTH

FIGURE NO.

4.6

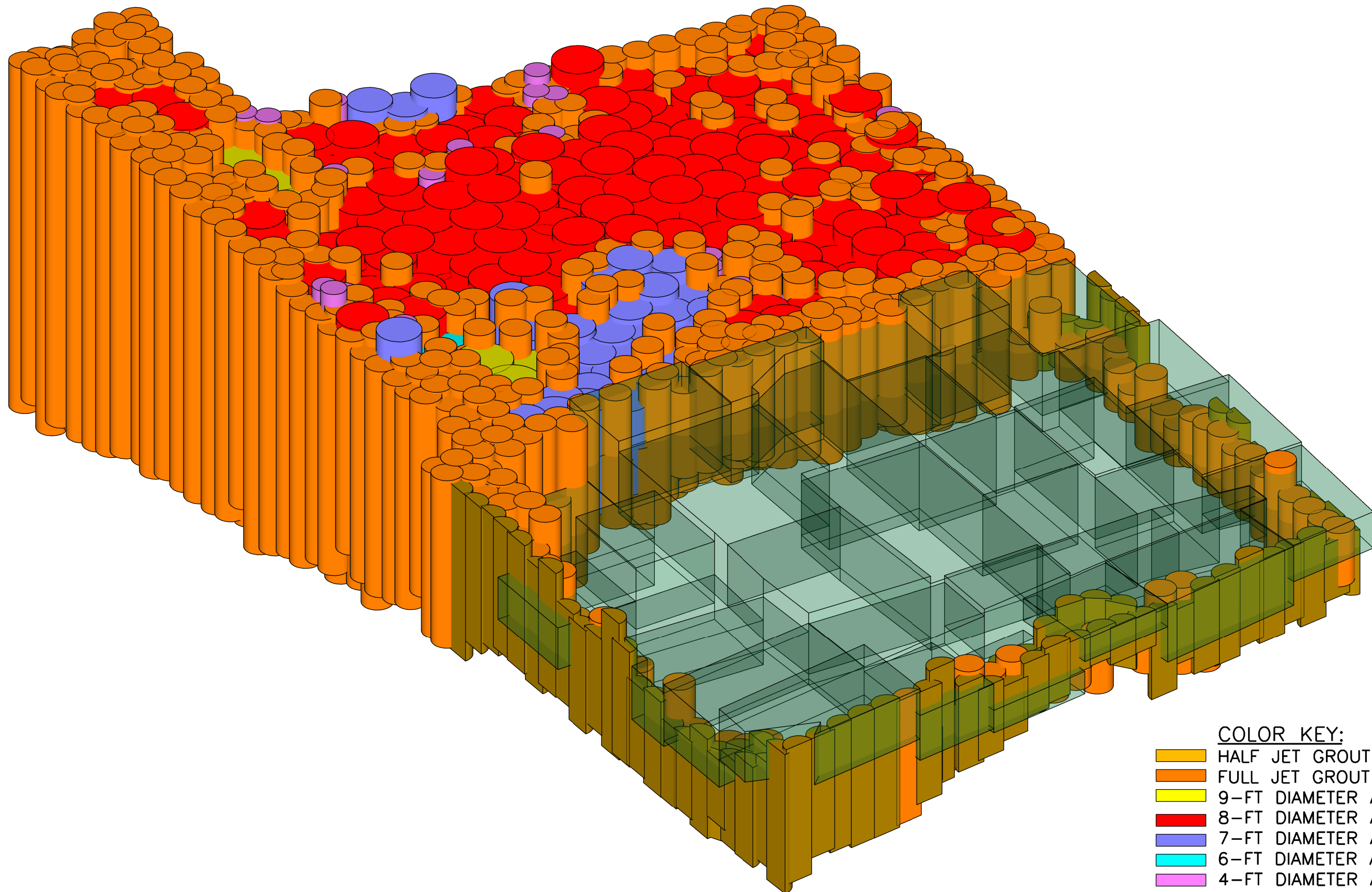

COLOR KEY:

- HALF JET GROUT COLUMN
- FULL JET GROUT COLUMN
- 9-FT DIAMETER AUGER COLUMN
- 8-FT DIAMETER AUGER COLUMN
- 7-FT DIAMETER AUGER COLUMN
- 6-FT DIAMETER AUGER COLUMN
- 4-FT DIAMETER AUGER COLUMN
- EXCAVATOR ISS

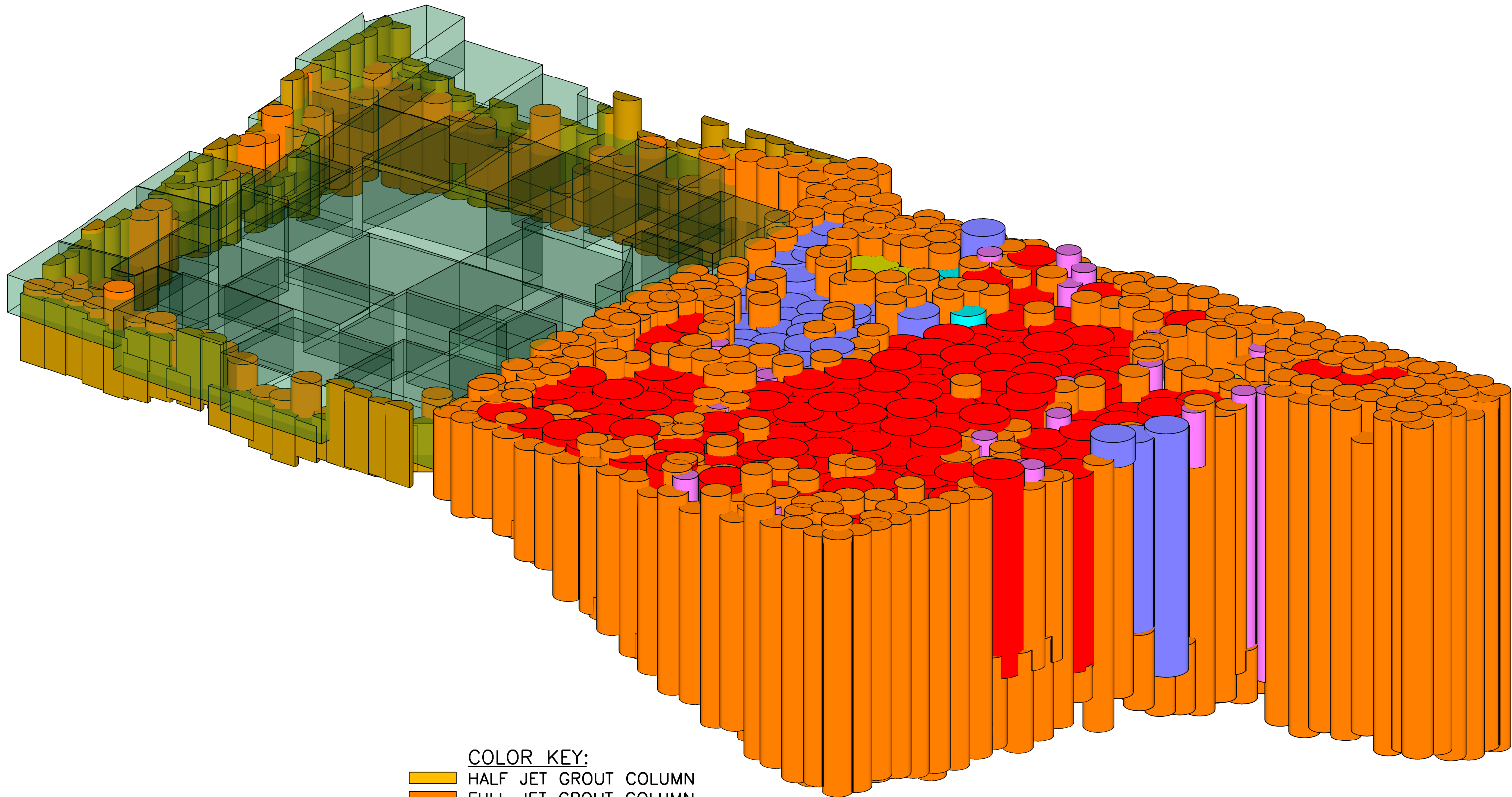

COLOR KEY:

- HALF JET GROUT COLUMN
- FULL JET GROUT COLUMN
- 9-FT DIAMETER AUGER COLUMN
- 8-FT DIAMETER AUGER COLUMN
- 7-FT DIAMETER AUGER COLUMN
- 6-FT DIAMETER AUGER COLUMN
- 4-FT DIAMETER AUGER COLUMN
- EXCAVATOR ISS

<p>PARSONS</p> <p>301 PLAINFIELD ROAD SUITE 350 SYRACUSE, N.Y. 13212 PHONE: (315) 451-9560 FAX: (315) 451-9570</p>		<p>WHITE PLAINS FORMER MGP SITE WHITE PLAINS, NEW YORK</p>	<p>FIGURE NO.</p> <p style="font-size: 24pt;">4.8</p>
<p>ISS ISOMETRIC VIEW FROM NORTHWEST</p>			