



Consolidated Edison Company of New York
31-01 20th Avenue
Long Island City, NY 11105-2048
www.conEd.com

March 28, 2014

Mr. Gardiner W. Cross
New York State Department of Environmental Conservation
625 Broadway
Remedial Bureau C, 11th Floor
Albany, New York 12233-7014

**Subject: December 2013 Groundwater Monitoring Report
White Plains Former Manufactured Gas Plant Site
White Plains, New York
NYSDEC Site #V00438-3**

Dear Mr. Cross:

This Groundwater Monitoring Report (GMR) serves to summarize the December 2013 semi-annual groundwater sampling activities, performed in support of the New York State Department of Environmental Conservation (NYSDEC) approved March 2011 Site Management Plan (SMP) for the White Plains Former Manufactured Gas Plant (MGP) Site Operable Unit Nos. 1 and 2 located in White Plains, New York (the Site). A Site Location Plan is included as [Figure 1](#) and a Monitoring Well Location Plan is included as [Figure 2](#).

This GMR documents the semi-annual groundwater sampling activities performed from December 9 through December 12, 2013. Descriptions of groundwater sampling activities and discussions of sampling results are provided below.

SEMI-ANNUAL GROUNDWATER SAMPLING

Groundwater sampling was conducted in accordance with the January 19, 2010 *USEPA Region 1 Low Stress (Low Flow) Purging and Sampling Procedure for the Collection of Groundwater Samples from Monitoring Wells*. Groundwater samples were collected from nineteen (19) monitoring wells (MW-6 through MW-10, MW-11A, MW-11B, MW-11C, MW-12A, MW-12B, MW-13 through MW-20, and MW-101). A groundwater sample was not collected from monitoring well MW-12C due to the presence of dense non-aqueous phase liquid (DNAPL) during gauging. An oil/water level interface probe was utilized to measure the depths to the water table and thickness of any non-aqueous phase liquid (NAPL) in the water column if present (accurate to 0.01 foot).

Prior to sampling, each well was purged utilizing low-flow purging and sampling techniques in accordance with the aforementioned USEPA protocol. Purging continued until stabilization of water quality parameters (including temperature, conductivity, pH, dissolved oxygen, oxidation-reduction potential, and turbidity) was achieved to allow for the collection of a representative groundwater sample. Water quality parameters were recorded approximately every five minutes and immediately prior to sample collection. After the water quality parameters stabilized, groundwater samples were collected utilizing a decontaminated monsoon pump and dedicated

tubing. Water quality parameter measurements and observations recorded during sampling are documented on the Groundwater Sampling Records provided in [Attachment 1](#).

Groundwater samples were analyzed for Target Compound List (TCL) Volatile Organic Compounds (VOCs) and TCL Semi-Volatile Organic Compounds (SVOCs) as per the SMP and the results are depicted in [Figures 3 and 4](#), respectively. QA/QC procedures were implemented as described in the NYSDEC approved OU-1 RAWP (*Parsons 2007*). Laboratory analyses of groundwater samples were conducted by Chemtech of Mountainside, New Jersey, a New York State Department of Health Environmental Laboratory Analysis Program (ELAP) approved laboratory certified for analyses using Analytical Services Protocol (ASP). Laboratory analyses were conducted in accordance with USEPA SW-846 methods and standard deliverable format including initial and continuing instrument calibrations, standard compound spikes, surrogate compound spikes, and analysis of other samples (blanks, laboratory control samples, matrix spikes/matrix spike duplicates, etc.).

Groundwater Level Measurements

Prior to sampling activities, groundwater levels at the Site's twenty (20) installed monitoring well locations were measured utilizing an oil/water interface probe on December 9, 2013. In addition, the Site's four (4) piezometers and seven (7) recovery wells were also gauged during this event but not sampled. Groundwater was encountered in the monitoring wells at elevations ranging from 176.22 (MW-18) to 181.72 (MW-6) feet above Mean Sea Level (MSL). The groundwater levels and corresponding elevations are summarized in [Tables 1A and 1B](#) and were used to produce a Site groundwater contour map ([Figure 5](#)). The groundwater monitoring data indicates that the groundwater flow on the Site remains consistent from northeast towards southwest.

Waste Management

Generated fluids were placed in United States Department of Transportation (USDOT) approved drums with closed tops. The drums generated during groundwater sampling were staged in a secure area on the Site as approved by St. John's Church property representatives prior to proper disposal. The drums were transported and disposed of by Parsons Subcontractor, Clean Earth of South Kearny, New Jersey (a RCRA Part B permitted Transfer, Storage and Disposal Facility (TSDF)).

December 2013 Groundwater Sampling - Field Observations

No NAPL was observed within the monitoring wells sampled during the December 2013 groundwater sampling event with the exception of MW-12C which exhibited 0.05 feet of NAPL (see [Tables 1A and 1B](#)). NAPL was also detected coating the interface probe during gauging of recovery well RW-3 within the OU-2 portion of the Site. Hydrocarbon odors were noted during the purging of MW-8, MW-11C, MW-14, MW-15, MW-16, and MW-101. No sheens were observed during purging of any wells sampled during this event. Purge water observations recorded during sampling are documented on the Groundwater Sampling Records provided in [Attachment 1](#).

ANALYTICAL RESULTS

Groundwater Sampling Results

Laboratory analytical results for constituents detected in the groundwater samples are summarized in [Table 2](#). For evaluation purposes, analytical results were compared with Ambient Water Quality Standards and Guidance Values (AWQSGVs) for Class GA groundwater contained in New York State Department of Environmental Conservation (NYSDEC) Technical and Operational Guidance Series 1.1.1 (TOGS 1.1.1) (NYSDEC, 1998). These standards and guidance values are protective of groundwater quality assuming that groundwater is used as a source of drinking water. That assumption is not applicable to the Site because groundwater is not anticipated to be used as a source of drinking water. Thus, the use of Class GA standards and guidance values for comparison to Site groundwater is conservative. [Figures 3 and 4](#) present a summary of total BTEX, total VOC, total PAH, and total SVOC concentrations detected in groundwater samples collected during the December 2013 semi-annual groundwater sampling event. Field measurements and observations as well as analytical results from the groundwater investigation are summarized below.

VOCs

A total of eighteen (18) VOCs were detected at least once in the groundwater samples collected during the semi-annual groundwater sampling event. Of these, ten (10) VOCs (1,2-dichloroethane, isopropylbenzene, styrene, tert-butyl methyl ether, tetrachloroethylene, benzene, ethylbenzene, toluene, o-xylene, and m/p-xylene) were detected at concentrations exceeding their AWQSGVs. Isopropylbenzene was detected above its AWQSGV in four (4) monitoring wells (MW-8, MW-11C, MW-14 and MW-16). Styrene was detected above its AWQSGV in four (4) monitoring wells (MW-11C, MW-14, MW-15, and MW-16). Tert-butyl methyl ether was detected above its AWQSGV in four (4) monitoring wells (MW-13, MW-14, MW-15 and MW-18). Tetrachloroethylene was detected above its AWQSGV in monitoring well MW-11C. Benzene was detected above its AWQSGV in seven (7) monitoring wells (MW-6, MW-11C, MW-14, MW-15, MW-16, MW-18, and MW-101). Ethylbenzene was detected above its AWQSGV in four (4) monitoring wells (MW-11C, MW-14, MW-15, and MW-16). Toluene was detected above its AWQSGV in five (5) monitoring wells (MW-9, MW-14, MW-15, MW-16 and MW-18). O-xylene was detected above its AWQSGV in seven (7) monitoring wells (MW-9, MW-11C, MW-14, MW-15, MW-16, MW-18, and MW-101). M/P-xylene was detected above its AWQSGV in seven (7) monitoring wells (MW-8, MW-9, MW-11C, MW-14, MW-15, MW-16, and MW-18). CVOC 1,2-dichloroethane was detected above its AWQSGV in four (4) monitoring wells (MW-9, MW-13, MW-15, and MW-18). CVOCs are not MGP-related compounds and are not associated with operations of the former manufactured gas plant site.

No other VOCs were detected above their AWQSGVs in any of the sampled monitoring wells. No VOCs were detected above AWQSGVs in nine (9) monitoring wells (MW-7, MW-10, MW-11A, MW-11B, MW-12A, MW-12B, MW-17, MW-19, and MW-20). Groundwater VOC analytical results are summarized in [Table 2](#) and on [Figure 3](#).

SVOCs

A total of four (4) SVOCs and seven (7) PAHs were detected at least once in the groundwater samples collected during the semi-annual groundwater sampling event. Of these, three (3) SVOCs (biphenyl (diphenyl), acenaphthene, and naphthalene) were

detected at concentrations exceeding their AWQSGVs. Biphenyl (diphenyl) was detected above its AWQSGV in three (3) monitoring wells (MW-11C, MW-14, and MW-16). Acenaphthene was detected above its AWQSGV in monitoring well MW-101. Naphthalene was detected above its AWQSGV in eight (8) monitoring wells (MW-8, MW-9, MW-11C, MW-14, MW-15, MW-16, MW-18 and MW-101).

No other SVOCs were detected above the AWQSGVs in any of the monitoring wells. No SVOCs were detected above AWQSGVs in twelve (12) monitoring wells (MW-6, MW-7, MW-10, MW-11A, MW-11B, MW-12A, MW-12B, MW-13, MW-17, MW-18, MW-19, and MW-20). Groundwater SVOC analytical results are summarized in [Table 2](#) and on [Figure 4](#).

DATA VALIDATION AND REPORTING

Data validation was performed in accordance with the USEPA Region II standard operating procedures (SOPs) for organic and inorganic data review. These validation guidelines are regional modifications to the National Functional Guidelines for organic and inorganic data review (USEPA, 1999 and 2004). Validation included the following:

- Verification of 100% of all quality control (QC) sample results (both qualitative and quantitative);
- Verification of the identification of 100% of all sample results (both positive hits and non-detects);
- Recalculation of 10% of all investigative sample results; and
- Preparation of a Data Usability Summary Report (DUSR).

The quality of the data has been assessed and is documented in the DUSR provided in [Attachment 2](#). In summary, the results of the data usability assessment show that the collected analytical data for groundwater are valid for the intended purposes of the semi-annual groundwater sampling.

CONCLUSIONS AND RECOMMENDATIONS

The results of the groundwater sampling activities conducted at the Site in December 2013 generally indicate consistency with data obtained during previous groundwater sampling events conducted at the Site. BTEX continues to be present in the groundwater with the exception of monitoring wells MW-7, MW-10, MW-11A, MW-11B, MW-12A, MW-12B, MW-13, MW-17, MW-19, and MW-20. An increase in BTEX concentrations has been exhibited in monitoring well MW-6, MW-8, MW-9, MW-11C, MW-14, MW-16, MW-18, and MW-101. Monitoring well MW-15 exhibited a reduction in BTEX concentrations.

SVOCs continue to be present in the groundwater with the exception of monitoring wells MW-10, MW-11A, MW-11B, MW-12B, MW-13, MW-17, and MW-19. Total PAHs and total SVOCs concentrations have increased in monitoring wells MW-7 (SVOCs only), MW-8, MW-9, MW-11C, MW-12A (SVOCs only), MW-14, MW-16, MW-18, and MW-101. Monitoring wells MW-15, MW-20 and MW-101 exhibited a reduction in Total PAHs and SVOC concentrations.

Mr. Gardiner Cross
New York State Department of Environmental Conservation
March 28, 2014
Page 5 of 6

NAPL continues to be observed within monitoring well MW-12C, however, at a generally consistent thickness (i.e. 0.05 feet in December 2013, 0.2 feet in May 2013, 0.55 feet in December 2012 and 0.05 feet in May 2012).

Based on the results of this groundwater sampling event, the layer of clean groundwater beneath the St. John's Church property portion of the Site continues to be present. The upper aquifer analytical results from the December 2013 groundwater sampling event is supportive of the selected remedy for the St. John's Church property portion of the Site as outlined in the approved RAWP. Semi-annual groundwater sampling will continue for another six (6) rounds through the end of 2016 to conclude that the layer of clean groundwater beneath the St. John's Church property portion of the Site continues to be present.

If you have any questions or comments concerning the results documented herein, please contact me at (718) 204-4205.

Sincerely,



Yelena Skorobogatov
Technical Specialist
MGP Remediation
Environment, Health and Safety

Enclosures (figures/tables)
Attachments

cc:

Anthony Perretta, NYSDOH – 1 copy
Dena Putnick, Esq., NYSDEC Albany – w/o enc.
Edward Moore, NYSDEC, Region 3 – w/o enc.
David S. Brown, Archdiocese of New York – 1 copy
Kimberlea Shaw Rea, Bosworth, Gray & Fuller – 1 copy
Rev. Msgr. Neil Graham, St. John's Church – 1 copy
Kenneth Kaiser, Con Edison – 1 copy

TABLES

Table 1A
OU-2 Gauging Results
White Plains Former MGP Site
Consolidated Edison Company of New York

Well ID	TOC Elevation	DTW	DTW Elevation	DTP	Screen Interval	DTB
MW-2	190.54	No longer exists				
MW-4	194.92	Unable to locate				
MW-5	189.12	No longer exists				
MW-6	187.82	6.10	181.72	ND	5 - 15	16.05
MW-7	189.51	9.35	180.16	ND	7 - 17	15.98
MW-8	202.08	23.79	178.29	ND	20 - 40	39.50
SB-1	189.10	No longer exists				
TB-5	189.50	No longer exists				
RW-1	204.60	25.85	178.75	ND	16 - 51	49.75
RW-2	200.05	24.30	175.75	ND	18 - 48	44.45
RW-3	203.60	25.32	178.28	Probe is NAPL coated	20 - 50	51.00
RW-4	200.90	23.94	176.96	ND	17 - 57	55.30
RW-5	200.04	23.00	177.04	ND	14 - 54	51.00
RW-6	203.55	25.16	178.90	ND	19 - 49	49.00
RW-7	203.97	24.26	179.71	ND	17.5 - 47.5	45.60
PZ-1	203.63	25.05	178.58	ND	15 - 35	36.50
PZ-2	203.59	24.96	178.63	ND	15 - 35	35.45
PZ-3	200.21	24.17	176.04	ND	15 - 35	33.85
PZ-4	200.14	24.20	175.94	ND	15 - 35	34.65
MW-101	203.07	25.92	177.15	ND	NA	61.05

Table 1B
OU-1 Monitoring Well Gauging Results
White Plains Former MGP Site
Consolidated Edison Company of New York

Well ID	TOC Elevation	DTW	DTW Elevation	DTP	Screen Interval	DTB
MW-10	198.45	21.45	177.00	ND	52 - 62	49.85
MW-11A	201.82	24.79	177.03	ND	40 - 50	26.75
MW-11B	201.97	25.00	176.97	ND	22 - 27	35.95
MW-11C	201.74	24.85	176.89	ND	31 - 36	49.80
MW-12A	205.13	28.07	177.06	ND	40 - 50	30.55
MW-12B	204.96	28.05	176.91	ND	21 - 36	44.48
MW-12C	205.14	28.35	176.79	60.00	38 - 45	60.05
MW-13	204.84	28.16	176.68	ND	50 - 60	58.6
MW-14	205.00	28.45	176.55	ND	55 - 65	64.50
MW-15	207.60	31.19	176.41	ND	55 - 65	66.60
MW-16	205.96	29.34	176.62	ND	57 - 67	64.45
MW-17	204.95	28.30	176.65	ND	55 - 65	49.90
MW-9	207.34	30.85	176.49	ND	38 - 50	62.15
MW-18	208.9	32.68	176.22	ND	60 - 70	71.8
MW-19	188.24	9.38	178.86	ND	5 - 20	20.11
MW-20	191.58	15.07	176.51	ND	5 - 20	20.06

Table 2
Summary of Laboratory Groundwater Analytical Results
December 2013 Semi-Annual - White Plains Former MGP Site
Consolidated Edison Company of New York

Con Ed - White Plains Validated Groundwater Analytical Data Detected Compound Summary December 2013		NYSDEC Class GA Groundwater Standards/Guidance Values ⁽¹⁾	Location ID: Sample ID: Lab Sample ID: Source: SDG: Matrix: Sampled: Validated:	MW-6 MW-6-20131210 E4747-09 CTECH E4747 WATER 12/10/2013 11:50 1/30/2014	MW-7 MW-7-20131210 E4747-08 CTECH E4747 WATER 12/10/2013 9:40 1/30/2014	MW-8 MW-8-20131210 E4747-12 CTECH E4747 WATER 12/10/2013 15:35 1/30/2014	MW-9 MW-9-20131212 E4794-06 CTECH E4794 WATER 12/12/2013 9:50 1/30/2014	MW-10 MW-10-20131210 E4747-10 CTECH E4747 WATER 12/10/2013 13:15 1/30/2014	MW-11A MW-11A-20131209 E4747-05 CTECH E4747 WATER 12/9/2013 15:20 1/30/2014	MW-11B MW-11B-20131209 E4747-06 CTECH E4747 WATER 12/9/2013 16:10 1/30/2014	MW-11C MW-110-20131212 E4794-10 CTECH E4794 WATER 12/12/2013 13:40 1/30/2014
CAS NO.	COMPOUND		UNITS:								
VOLATILES											
75-15-0	CARBON DISULFIDE	--	ug/l	ND	ND	ND	ND	ND	ND	ND	ND
67-66-3	CHLOROFORM	7	ug/l	ND	ND	ND	0.38 J	0.62 J	ND	ND	ND
110-82-7	CYCLOHEXANE	--	ug/l	ND	ND	ND	ND	ND	ND	ND	61.6
98-82-8	ISOPROPYLBENZENE (CUMENE)	5	ug/l	1.7 J	ND	14.1	0.59 J	ND	ND	ND	21 J
108-87-2	METHYLCYCLOHEXANE	--	ug/l	ND	ND	7.3	ND	ND	ND	ND	99.2
75-09-2	METHYLENE CHLORIDE	5	ug/l	ND	1.4 J	3 J	ND	1.5 J	2.2 J	1.3 J	ND
100-42-5	STYRENE	5	ug/l	ND	ND	ND	4 J	ND	ND	ND	600
1634-04-4	TERT-BUTYL METHYL ETHER	10	ug/l	ND	ND	ND	1.2 J	ND	ND	ND	ND
BTEX											
71-43-2	BENZENE	1	ug/l	4.2 J	ND	ND	0.9 J	ND	ND	ND	1.4 J
100-41-4	ETHYLBENZENE	5	ug/l	3.6 J	ND	2.8 J	2.5 J	ND	ND	ND	220 J
108-88-3	TOLUENE	5	ug/l	0.66 J	ND	ND	11.2	ND	ND	ND	3.7 J
95-47-6	O-XYLENE (1,2-DIMETHYLBENZENE)	5	ug/l	1.2 J	ND	2.1 J	13.4	ND	ND	ND	910
XYLMP	M,P-XYLENE (SUM OF ISOMERS)	5	ug/l	ND	ND	6.2 J	8.3 J	ND	ND	ND	2700
TOTAL BTEX				9.66	ND	11.1	36.3	ND	ND	ND	3835.1
CVOCs											
107-06-2	1,2-DICHLOROETHANE	0.6	ug/l	ND	ND	ND	1.5 J	ND	ND	ND	ND
156-59-2	CIS-1,2-DICHLOROETHYLENE	5	ug/l	ND	ND	ND	ND	ND	ND	ND	ND
156-60-5	TRANS-1,2-DICHLOROETHENE	5	ug/l	0.88 J	ND	ND	ND	ND	ND	ND	ND
79-01-6	TRICHLOROETHYLENE (TCE)	5	ug/l	ND	ND	ND	0.67 J	ND	ND	ND	1.1 J
127-18-4	TETRACHLOROETHYLENE(PCE)	5	ug/l	ND	ND	ND	ND	ND	0.4 J	ND	12.8
TOTAL VOCs				12.24	1.4	24.4	44.64	2.12	2.6	1.3	4630.8
SEMI-VOLATILES											
92-52-4	BIPHENYL (DIPHENYL)	5	ug/l	ND	ND	3.6 J	ND	ND	ND	ND	48.9
86-74-8	CARBAZOLE	--	ug/l	ND	ND	ND	ND	ND	ND	ND	6.8 J
132-64-9	DIBENZOFURAN	--	ug/l	ND	ND	ND	ND	ND	ND	ND	2.8 J
131-11-3	DIMETHYL PHTHALATE	50 (G)	ug/l	ND	2.8 J	ND	ND	ND	ND	ND	ND
PAHs											
83-32-9	ACENAPHTHENE	20 (G)	ug/l	3.5 J	ND	9.1 J	ND	ND	ND	ND	14.1
208-96-8	ACENAPHTHYLENE	--	ug/l	ND	ND	ND	7.1 J	ND	ND	ND	66.8
120-12-7	ANTHRACENE	50 (G)	ug/l	ND	ND	ND	ND	ND	ND	ND	3.5 J
86-73-7	FLUORENE	50 (G)	ug/l	ND	ND	ND	ND	ND	ND	ND	36.6
91-57-6	2-METHYLNAPHTHALENE	--	ug/l	ND	ND	21	ND	ND	ND	ND	770
91-20-3	NAPHTHALENE	10 (G)	ug/l	ND	ND	720	20.3	ND	ND	ND	11900
85-01-8	PHENANTHRENE	50 (G)	ug/l	ND	ND	ND	ND	ND	ND	ND	29.5
Total PAHs			ug/l	3.5	ND	750.1	27.4	ND	ND	ND	12820.5
Total SVOCs			ug/l	3.5	2.8	753.7	27.4	ND	ND	ND	12879

Notes:
 Indicates concentration exceeds standard or guidance value.
 (G) Indicates guidance value.
 NS No standard or guidance value available.
 ND Indicates compound was not detected.
 J Indicates an estimated concentration.
 ug/L Micrograms per liter

Table 2
 Summary of Laboratory Groundwater Analytical Results
 December 2013 Semi-Annual - White Plains Former MGP Site
 Consolidated Edison Company of New York

											Dup of MW-17-20131209
Con Ed - White Plains Validated Groundwater Analytical Data Detected Compound Summary December 2013		NYSDEC Class GA Groundwater Standards/Guidance Values ⁽¹⁾	Location ID: Sample ID: Lab Sample ID: Source: SDG: Matrix: Sampled: Validated:	MW-12A MW-12A-20131211 E4794-01 CTECH E4794 WATER 12/11/2013 12:10 1/30/2014	MW-12B MW-12B-20131211 E4794-02 CTECH E4794 WATER 12/11/2013 13:15 1/30/2014	MW-13 MW-13-20131211 E4794-03 CTECH E4794 WATER 12/11/2013 14:30 1/30/2014	MW-14 MW-14-20131212 E4794-07 CTECH E4794 WATER 12/12/2013 11:45 1/30/2014	MW-15 MW-15-20131212 E4794-09 CTECH E4794 WATER 12/12/2013 13:25 1/30/2014	MW-16 MW-16-20131212 E4794-08 CTECH E4794 WATER 12/12/2013 11:10 1/30/2014	MW-17 MW-17-20131209 E4747-01 CTECH E4747 WATER 12/9/2013 12:45 1/30/2014	MW-17 MW-17-20131209 E4747-04 CTECH E4747 WATER 12/9/2013 12:55 1/30/2014
CAS NO.	COMPOUND		UNITS:								
VOLATILES											
75-15-0	CARBON DISULFIDE	--	ug/l	ND	ND	ND	ND	ND	ND	ND	ND
67-66-3	CHLOROFORM	7	ug/l	ND	3.8 J	ND	ND	ND	0.72 J	ND	ND
110-82-7	CYCLOHEXANE	--	ug/l	ND	ND	ND	30.3	ND	27.4	ND	ND
98-82-8	ISOPROPYLBENZENE (CUMENE)	5	ug/l	ND	ND	ND	6.9 J	0.57 J	11.7 J	ND	ND
108-87-2	METHYLCYCLOHEXANE	--	ug/l	ND	ND	ND	46.5	1.2 J	44.2	ND	ND
75-09-2	METHYLENE CHLORIDE	5	ug/l	ND	2.2 J	2.3 J	ND	2.3 J	ND	1.4 J	1.5 J
100-42-5	STYRENE	5	ug/l	ND	ND	ND	2200	29.8	850	ND	ND
1634-04-4	TERT-BUTYL METHYL ETHER	10	ug/l	ND	ND	520	13.9	190	ND	ND	ND
BTEX											
71-43-2	BENZENE	1	ug/l	ND	ND	ND	12.3	1.2 J	180 J	ND	ND
100-41-4	ETHYLBENZENE	5	ug/l	ND	ND	ND	240 J	10	190 J	ND	ND
108-88-3	TOLUENE	5	ug/l	ND	ND	ND	1900	40.5	1500	ND	ND
95-47-6	O-XYLENE (1,2-DIMETHYLBENZENE)	5	ug/l	ND	ND	ND	660	16.9	660	ND	ND
XYLMP	M,P-XYLENE (SUM OF ISOMERS)	5	ug/l	ND	ND	ND	1700	31.9	1000	ND	ND
TOTAL BTEX				ND	ND	ND	4512.3	100.5	3530	ND	ND
CVOCs											
107-06-2	1,2-DICHLOROETHANE	0.6	ug/l	ND	ND	4.6 J	ND	7.9	ND	ND	ND
156-59-2	CIS-1,2-DICHLOROETHYLENE	5	ug/l	ND	ND	ND	ND	ND	ND	ND	ND
156-60-5	TRANS-1,2-DICHLOROETHENE	5	ug/l	ND	0.48 J	0.91 J	0.52 J	ND	ND	ND	ND
79-01-6	TRICHLOROETHYLENE (TCE)	5	ug/l	ND	ND	ND	ND	ND	1.6 J	ND	ND
127-18-4	TETRACHLOROETHYLENE(PCE)	5	ug/l	ND	0.56 J	ND	0.58 J	ND	3.1 J	ND	ND
TOTAL VOCs				ND	7.04	527.81	6811	332.27	4468.72	1.4	1.5
SEMIVOLATILES											
92-52-4	BIPHENYL (DIPHENYL)	5	ug/l	ND	ND	ND	37.7	ND	42.3	ND	ND
86-74-8	CARBAZOLE	--	ug/l	ND	ND	ND	2.9 J	ND	3.9 J	ND	ND
132-64-9	DIBENZOFURAN	--	ug/l	ND	ND	ND	ND	ND	ND	ND	ND
131-11-3	DIMETHYL PHTHALATE	50 (G)	ug/l	2.6 J	ND	ND	ND	ND	2.9 J	ND	ND
PAHs											
83-32-9	ACENAPHTHENE	20 (G)	ug/l	ND	ND	ND	11.9	ND	13.1	ND	ND
208-96-8	ACENAPHTHYLENE	--	ug/l	ND	ND	ND	260	4.2 J	90.7	ND	ND
120-12-7	ANTHRACENE	50 (G)	ug/l	ND	ND	ND	4 J	ND	3.3 J	ND	ND
86-73-7	FLUORENE	50 (G)	ug/l	ND	ND	ND	26.5	ND	3.6 J	ND	ND
91-57-6	2-METHYLNAPHTHALENE	--	ug/l	ND	ND	ND	430	ND	310	ND	ND
91-20-3	NAPHTHALENE	10 (G)	ug/l	ND	ND	ND	6200	110	8400	ND	ND
85-01-8	PHENANTHRENE	50 (G)	ug/l	ND	ND	ND	31	ND	31.4	ND	ND
Total PAHs			ug/l	ND	ND	ND	6963.4	114.2	8852.1	ND	ND
Total SVOCs			ug/l	2.6	ND	ND	7004	114.2	8901.2	ND	ND

Notes:
 Indicates concentration exceeds standard or guidance value.
 (G) Indicates guidance value.
 NS No standard or guidance value available.
 ND Indicates compound was not detected.
 J Indicates an estimated concentration.
 ug/L Micrograms per liter

Table 2
 Summary of Laboratory Groundwater Analytical Results
 December 2013 Semi-Annual - White Plains Former MGP Site
 Consolidated Edison Company of New York

Con Ed - White Plains Validated Groundwater Analytical Data Detected Compound Summary December 2013		NYSDEC Class GA Groundwater Standards/Guidance Values ⁽¹⁾	Location ID: Sample ID: Lab Sample ID: Source: SDG: Matrix: Sampled: Validated: UNITS:	MW-18 MW-18-20131211 E4794-04 CTECH E4794 WATER 12/11/2013 17:00 1/30/2014	MW-19 MW-19-20131210 E4747-07 CTECH E4747 WATER 12/10/2013 8:35 1/30/2014	MW-20 MW-20-20131210 E4747-11 CTECH E4747 WATER 12/10/2013 14:35 1/30/2014	MW-101 MW-101-20131212 E4794-05 CTECH E4794 WATER 12/12/2013 9:25 1/30/2014
CAS NO.	COMPOUND						
	VOLATILES						
75-15-0	CARBON DISULFIDE	--	ug/l	ND	ND	ND	0.77 J
67-66-3	CHLOROFORM	7	ug/l	0.66 J	ND	ND	ND
110-82-7	CYCLOHEXANE	--	ug/l	0.7 J	ND	ND	3.6 J
98-82-8	ISOPROPYLBENZENE (CUMENE)	5	ug/l	2.7 J	ND	ND	3.3 J
108-87-2	METHYLCYCLOHEXANE	--	ug/l	1.6 J	ND	ND	2.4 J
75-09-2	METHYLENE CHLORIDE	5	ug/l	1.7 J	1.2 J	1.4 J	1.7 J
100-42-5	STYRENE	5	ug/l	ND	ND	ND	ND
1634-04-4	TERT-BUTYL METHYL ETHER	10	ug/l	6.5	ND	ND	ND
	BTEX						
71-43-2	BENZENE	1	ug/l	35.9	ND	ND	130
100-41-4	ETHYLBENZENE	5	ug/l	2.3 J	ND	ND	4 J
108-88-3	TOLUENE	5	ug/l	11.6	ND	ND	1 J
95-47-6	O-XYLENE (1,2-DIMETHYLBENZENE)	5	ug/l	57.8	ND	ND	10.1
XYLMP	M,P-XYLENE (SUM OF ISOMERS)	5	ug/l	18.3	ND	ND	2 J
	TOTAL BTEX			125.9	ND	ND	147.1
	CVOCs						
107-06-2	1,2-DICHLOROETHANE	0.6	ug/l	0.96 J	ND	ND	ND
156-59-2	CIS-1,2-DICHLOROETHYLENE	5	ug/l	0.36 J	ND	ND	ND
156-60-5	TRANS-1,2-DICHLOROETHENE	5	ug/l	ND	ND	ND	0.74 J
79-01-6	TRICHLOROETHYLENE (TCE)	5	ug/l	1.1 J	ND	ND	ND
127-18-4	TETRACHLOROETHYLENE(PCE)	5	ug/l	1.2 J	ND	ND	ND
	TOTAL VOCs			143.38	1.2	1.4	159.61
	SEMIVOLATILES						
92-52-4	BIPHENYL (DIPHENYL)	5	ug/l	ND	ND	ND	ND
86-74-8	CARBAZOLE	--	ug/l	ND	ND	ND	3 J
132-64-9	DIBENZOFURAN	--	ug/l	ND	ND	ND	ND
131-11-3	DIMETHYL PHTHALATE	50 (G)	ug/l	ND	ND	5.8 J	ND
	PAHs						
83-32-9	ACENAPHTHENE	20 (G)	ug/l	3.9 J	ND	ND	24.3
208-96-8	ACENAPHTHYLENE	--	ug/l	21	ND	ND	ND
120-12-7	ANTHRACENE	50 (G)	ug/l	ND	ND	ND	ND
86-73-7	FLUORENE	50 (G)	ug/l	ND	ND	ND	4.1 J
91-57-6	2-METHYLNAPHTHALENE	--	ug/l	ND	ND	ND	ND
91-20-3	NAPHTHALENE	10 (G)	ug/l	180	ND	ND	48.3
85-01-8	PHENANTHRENE	50 (G)	ug/l	ND	ND	ND	ND
	Total PAHs		ug/l	204.9	ND	ND	76.7
	Total SVOCs		ug/l	204.9	ND	5.8	79.7

Notes:
 Indicates concentration exceeds standard or guidance value.
 (G) Indicates guidance value.
 NS No standard or guidance value available.
 ND Indicates compound was not detected.
 J Indicates an estimated concentration.
 ug/L Micrograms per liter

FIGURES

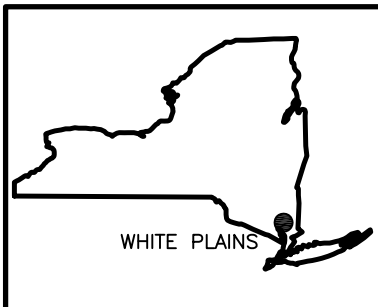
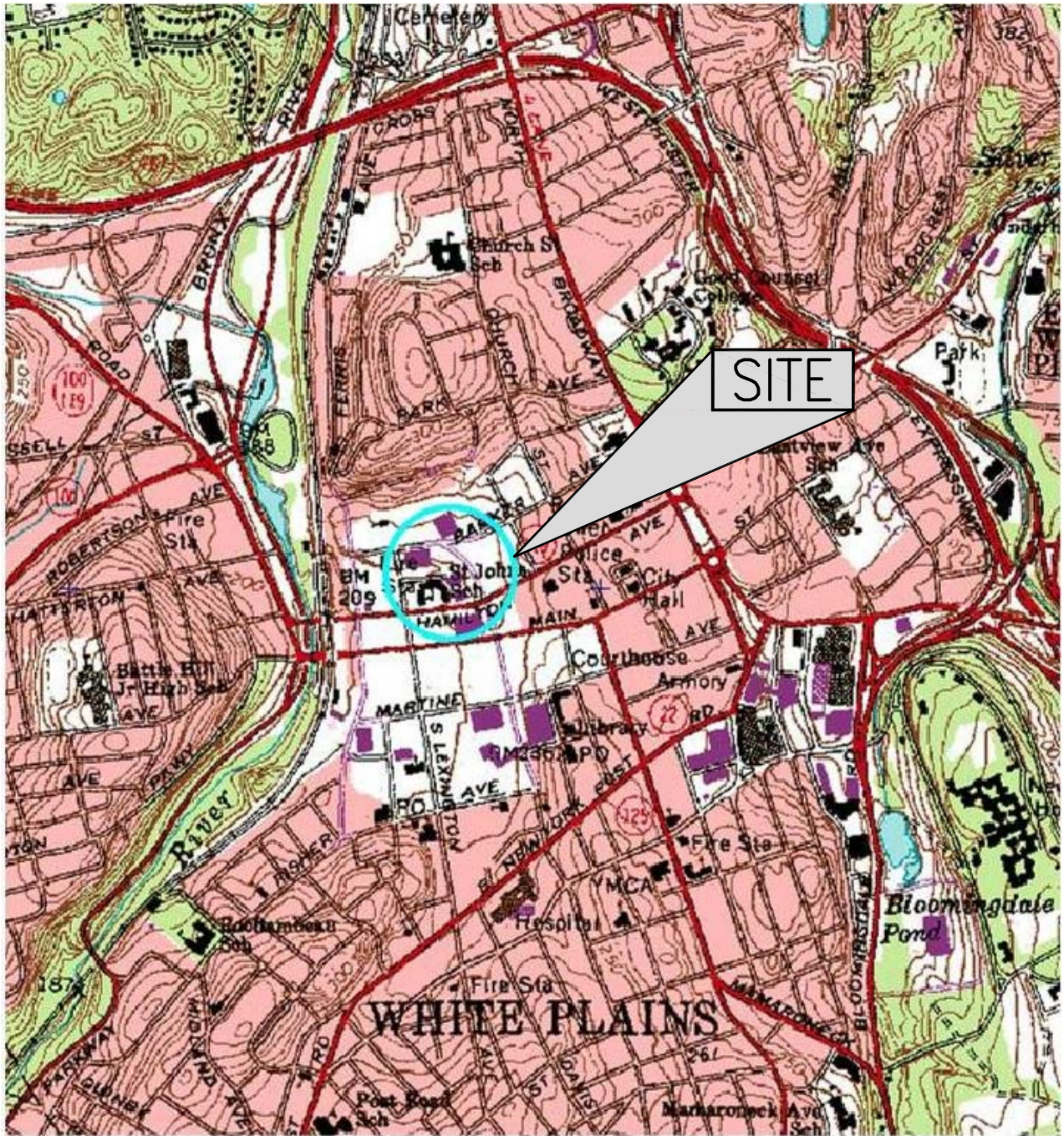

WHITE PLAINS

QUADRANGLE LOCATION
NEW YORK



LATITUDE: N42° 02' 00"
LONGITUDE: W73° 46' 16"

FIGURE 1

**CONSOLIDATED EDISON
WHITE PLAINS FORMER MGP SITE
WHITE PLAINS, NEW YORK**



SITE LOCATION MAP

PARSONS

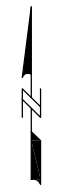
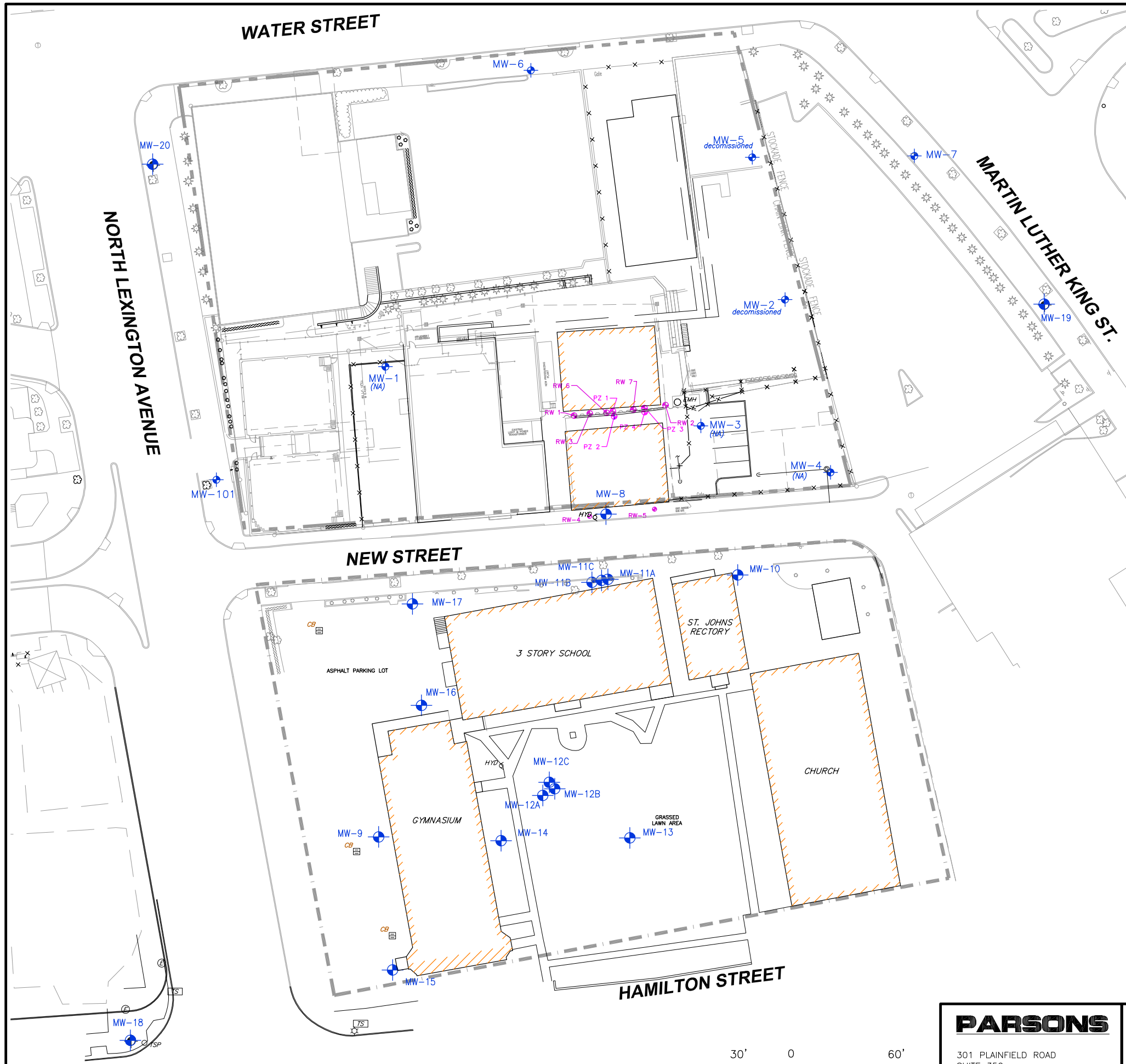
301 PLAINFIELD ROAD, SUITE 350, SYRACUSE, N.Y. 13212, PHONE: 315-451-9560



LEGEND:

-  MONITORING WELL
-  (NA) NO LONGER ACCESSIBLE

NOTE:
 MAP SOURCE:
 CHAZEN ENGINEERING , LAND SURVEYING & LANDSCAPING
 ARCHITECTURE CO., P.C. DATED 6/6/11.



PARSONS
 301 PLAINFIELD ROAD
 SUITE 350
 SYRACUSE, N.Y. 13212
 PHONE: (315) 451-9560
 FAX: (315) 451-9570



**WHITE PLAINS FORMER MGP SITE
 WHITE PLAINS, NEW YORK**

MONITORING WELL LOCATION MAP

FIGURE NO.
 2

MW-6	7/01	5/11	11/11	5/12	12/12	5/13	12/13
Total BTEX	353.6	ND	ND	ND	ND	ND	9.66
Total VOCs	402.1	ND	ND	ND	ND	ND	12.24

MW-7	7/01	5/11	11/11	5/12	12/12	12/12 Dup	5/13	12/13
Total BTEX	ND	ND	ND	ND	ND	ND	ND	ND
Total VOCs	28.69	ND	ND	ND	ND	ND	ND	1.4

MW-20	5/11	11/11	5/12	12/12	5/13	12/13
Total BTEX	ND	ND	ND	ND	ND	ND
Total VOCs	ND	ND	ND	ND	ND	1.4

MW-101	5/11	11/11	11/11 DUP	5/12	12/12	5/13	12/13
Total BTEX	428	687	452	710	139.18	128.8	147.1
Total VOCs	454	687	452	1488	144.78	133.6	159.61

MW-17	11/09	5/11	5/11 DUP	11/11	5/12	12/12	5/13	12/13	12/13 DUP
Total BTEX	ND	ND	ND	ND	ND	ND	ND	ND	ND
Total VOCs	2.4	0.8	0.9	ND	ND	ND	ND	1.4	1.5

MW-16	11/09	11/09 DUP	5/11	11/1	5/12	12/12	5/13	12/13
Total BTEX	2640.0	6160.0	3810	3020	1780	4910	2470	3530
Total VOCs	3401.7	7953.9	4850.9	3980	4028.7	6146.97	3077.74	4468.72

MW-12C	11/09	5/11	11/11	5/12	12/12
Total BTEX	826.7	951.5	1171	1174.3	3194.4
Total VOCs	1269.0	1610.07	1761	2918.7	4921.9

MW-12A	11/09	5/11	11/11	5/12	12/12	5/13	12/13
Total BTEX	ND	23.2	ND	ND	ND	ND	ND
Total VOCs	ND	31.7	ND	ND	ND	ND	ND

MW-9	11/09	5/11	11/11	5/12	12/12	5/13	12/13
Total BTEX	2305	374	664	172.9	53.4	34.51	36.3
Total VOCs	2987.3	509.64	824	383.72	186.27	42.21	44.64

MW-14	11/09	5/11	11/11	5/12	12/12	5/13	12/13
Total BTEX	3146.0	3618.6	2990	3678.4	5223	4240	4512.3
Total VOCs	4692.9	5689.3	4590	9250.6	8196.4	6340	6811

MW-15	11/09	5/11	11/11	5/12	12/12	5/13	12/13
Total BTEX	379.8	366.2	46	399.8	163	150.3	100.5
Total VOCs	600.3	688.89	285	1156.3	414.63	321.03	332.27

MW-18	5/11	11/11	5/12	12/12	5/13	12/13
Total BTEX	37.2	2.6	8.2	30.2	31.11	125.9
Total VOCs	48.09	13.2	31.47	40.09	41.54	143.38

MW-19	5/11	11/11	5/12	12/12	5/13	12/13
Total BTEX	ND	ND	ND	ND	ND	ND
Total VOCs	ND	ND	ND	ND	ND	1.2

MW-8	7/01	7/01 DUP	5/11	11/11	5/12	5/12 DUP	12/12	5/13	12/13
Total BTEX	3.4	ND	2.86	2	13.5	15.1	10.3	1.61	11.1
Total VOCs	28.93	25.98	7.09	2	41.48	45.83	23.17	8.91	35.5

MW-10	11/09	5/11	11/11	5/12	12/12	5/13	12/13
Total BTEX	ND	ND	ND	ND	ND	ND	ND
Total VOCs	5.1	0.61	ND	0.62	0.84	ND	2.12

MW-11A	11/09	5/11	11/11	5/12	12/12	5/13	12/13
Total BTEX	ND	ND	ND	0.41	ND	ND	ND
Total VOCs	2.9	ND	ND	0.82	ND	ND	2.6

MW-11B	11/09	5/11	11/11	5/12	12/12	5/13	12/13
Total BTEX	ND	ND	ND	ND	ND	ND	ND
Total VOCs	2.9	ND	ND	ND	ND	ND	1.3

MW-11C	11/09	5/11	11/11	5/12	12/12	5/13	12/13
Total BTEX	5711.3	4051.8	3160	4751.4	5201.6	2861.55	3835.1
Total VOCs	7294.3	5095.8	3900	10668.8	6373.6	3473.15	4630.8

MW-12B	11/09	5/11	11/11	5/12	12/12	5/13	12/13
Total BTEX	2.7	ND	ND	ND	ND	ND	ND
Total VOCs	43.0	41.34	16	16	16	4.4	7.04

MW-13	11/09	5/11	11/11	5/12	12/12	5/13	12/13
Total BTEX	ND	ND	ND	ND	ND	ND	ND
Total VOCs	188.5	444.1	340	414.4	820	353.6	527.81

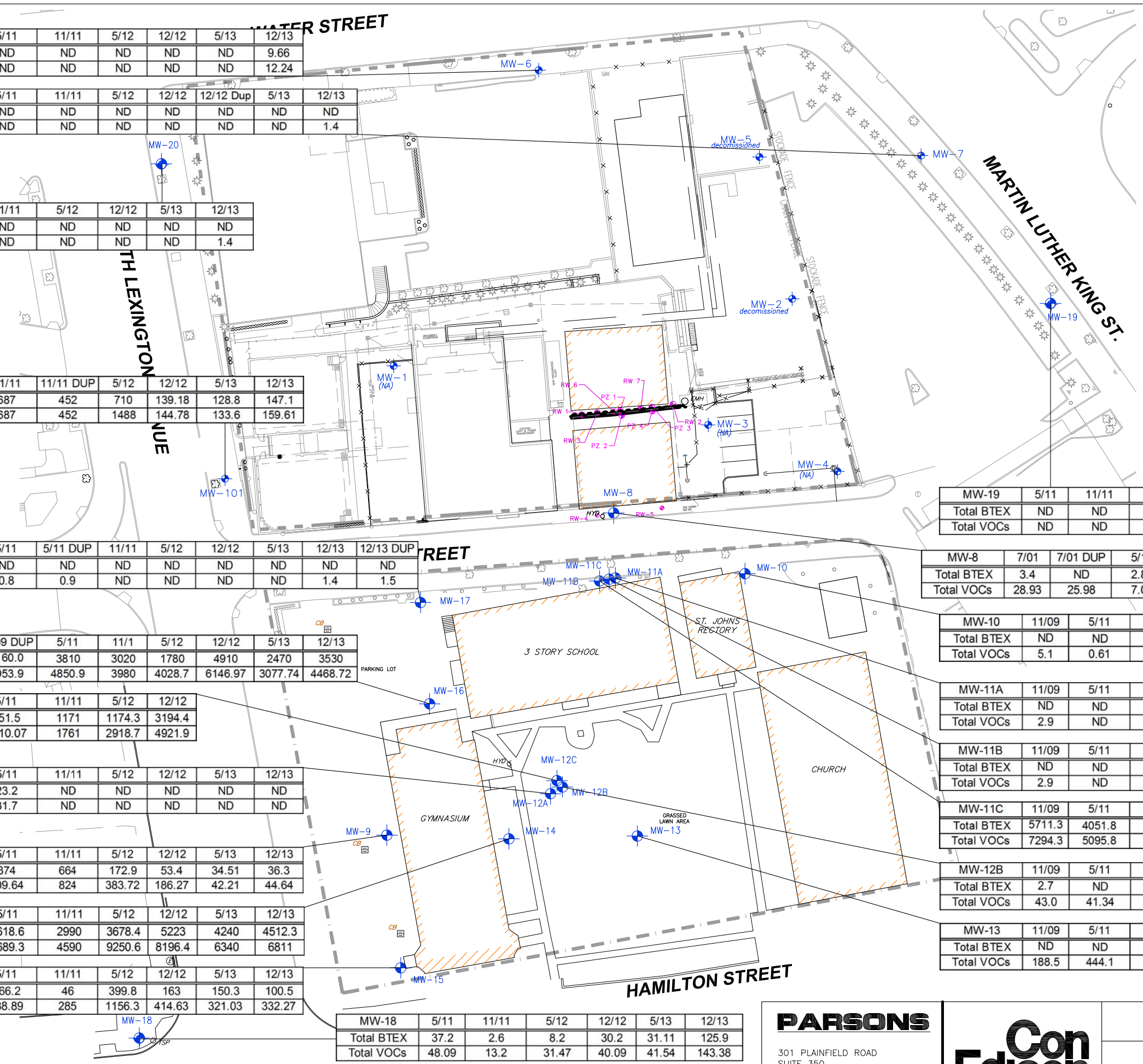

LEGEND:
 MONITORING WELL
 (NA) NO LONGER ACCESSIBLE

SAMPLE ID	SAMPLE DATE
TOTAL BENZENE, TOLUENE, ETHYLBENZENE, AND XYLENES	RESULTS IN ug/L
TOTAL VOLATILE ORGANIC COMPOUNDS	RESULTS IN ug/L

NOTE:
 MAP SOURCE:
 CHAZEN ENGINEERING, LAND SURVEYING & LANDSCAPING ARCHITECTURE CO., P.C. DATED 6/6/11.

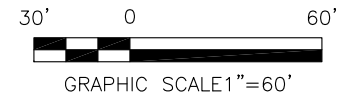

MW-6	7/01	5/11	11/11	5/12	12/12	5/13	12/13
Total PAHs	1094.34	ND	ND	ND	ND	ND	3.5
Total SVOCs	1129.05	ND	ND	ND	ND	15.4	3.5

MW-7	7/01	5/11	11/11	5/12	12/12	12/12 Dup	5/13	12/13
Total PAHs	0.22	ND	ND	ND	ND	ND	ND	ND
Total SVOCs	27.22	ND	ND	ND	ND	ND	ND	2.8

MW-20	5/11	11/11	5/12	12/12	5/13	12/13
Total PAHs	ND	ND	ND	ND	1.61	ND
Total SVOCs	ND	ND	ND	ND	8.91	5.8

MW-8	7/01	7/01 DUP	5/11	11/11	5/12	5/12 DUP	12/12	5/13	12/13
Total PAHs	0.2	89.73	ND	40	769.9	686.1	766.3	416.6	750.1
Total SVOCs	26.85	117.45	ND	85.7	769.9	686.1	766.3	416.6	753.7

MW-101	5/11	11/11	11/11 DUP	5/12	12/12	5/13	12/13
Total PAHs	283.6	245	300	614.6	85.2	107.2	76.7
Total SVOCs	304.4	490	600	621.4	91	113.1	79.7

MW-17	11/09	5/11	5/11 DUP	11/11	5/12	12/12	5/13	12/13	12/13 DUP
Total PAHs	ND	ND	ND	ND	ND	ND	ND	ND	ND
Total SVOCs	ND	ND	ND	ND	ND	ND	ND	ND	ND

MW-16	11/09	11/09 DUP	5/11	11/11	5/12	12/12	5/13	12/13
Total PAHs	8439.7	8059.4	7160.2	1999	186.3	6458.7	5959.1	8852.1
Total SVOCs	8503.0	8125.3	7230.1	4036	207.3	6487.4	5703.6	8901.2

MW-12C	11/09	5/11	11/11	5/12	12/12
Total PAHs	3801.7	2307.3	2554	3142.5	17986.2
Total SVOCs	3837.6	2331.7	5178	3165.5	18237.7

MW-12A	11/09	5/11	11/11	5/12	12/12	5/13	12/13
Total PAHs	ND	1.9	ND	ND	ND	ND	ND
Total SVOCs	ND	1.9	ND	ND	ND	ND	2.6

MW-9	11/09	5/11	11/11	5/12	12/12	5/13	12/13
Total PAHs	1275.4	49.8	400	189.4	21.2	14.3	27.4
Total SVOCs	1287	49.8	800	189.4	21.2	14.3	27.4

MW-14	11/09	5/11	11/11	5/12	12/12	5/13	12/13
Total PAHs	3321.2	8044.3	2317	6312	6585.4	6946	6963.4
Total SVOCs	3351.3	8099.4	4673	6344	6636.6	6998.3	7004

MW-15	11/09	5/11	11/11	5/12	12/12	5/13	12/13
Total PAHs	612.9	489.2	77.1	481.5	175.2	258	114.2
Total SVOCs	620.7	492.3	154.2	486.1	175.2	258	114.2

MW-18	5/11	11/11	5/12	12/12	5/13	12/13
Total PAHs	10.5	ND	6.5	5.9	43.1	204.9
Total SVOCs	10.5	ND	6.5	5.9	43.1	204.9

MW-19	5/11	11/11	5/12	12/12	5/13	12/13
Total PAHs	ND	ND	ND	ND	ND	ND
Total SVOCs	ND	ND	ND	ND	ND	ND

MW-10	11/09	5/11	11/11	5/12	12/12	5/13	12/13
Total PAHs	ND	ND	ND	ND	ND	ND	ND
Total SVOCs	4.4	ND	ND	ND	ND	ND	ND

MW-11A	11/09	5/11	11/11	5/12	12/12	5/13	12/13
Total PAHs	ND	ND	ND	ND	ND	ND	ND
Total SVOCs	ND	ND	ND	ND	ND	ND	ND

MW-11C	11/09	5/11	11/11	5/12	12/12	5/13	12/13
Total PAHs	16130.2	7605.9	6380	16139.4	13636.3	11759.9	12820.5
Total SVOCs	16209.9	7664	12760	16206.1	13711.9	11831.7	12879

MW-11B	11/09	5/11	11/11	5/12	12/12	5/13	12/13
Total PAHs	5.7	ND	ND	ND	ND	ND	ND
Total SVOCs	5.7	ND	ND	ND	ND	ND	ND

MW-12B	11/09	5/11	11/11	5/12	12/12	5/13	12/13
Total PAHs	5.4	1.6	ND	ND	ND	ND	ND
Total SVOCs	5.4	1.6	ND	ND	ND	ND	ND

MW-13	11/09	5/11	11/11	5/12	12/12	5/13	12/13
Total PAHs	2.4	ND	ND	ND	ND	ND	ND
Total SVOCs	5.1	ND	ND	ND	ND	ND	ND

LEGEND:
 MONITORING WELL
 (NA) NO LONGER ACCESSIBLE

SAMPLE ID	SAMPLE DATE
TOTAL POLYCYCLIC AROMATIC HYDROCARBONS	RESULTS IN ug/L
TOTAL SEMI-VOLATILE ORGANIC COMPOUNDS	RESULTS IN ug/L

NOTE:
 MAP SOURCE:
 CHAZEN ENGINEERING, LAND SURVEYING & LANDSCAPING ARCHITECTURE CO., P.C. DATED 6/6/11.

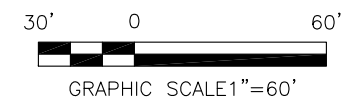

PARSONS 301 PLAINFIELD ROAD SUITE 350 SYRACUSE, N.Y. 13212 PHONE: (315) 451-9560 FAX: (315) 451-9570		WHITE PLAINS FORMER MGP SITE WHITE PLAINS, NEW YORK	FIGURE NO.
		SEMI-VOLATILE ORGANIC COMPOUND (SVOCs) SAMPLE RESULTS MAP	4

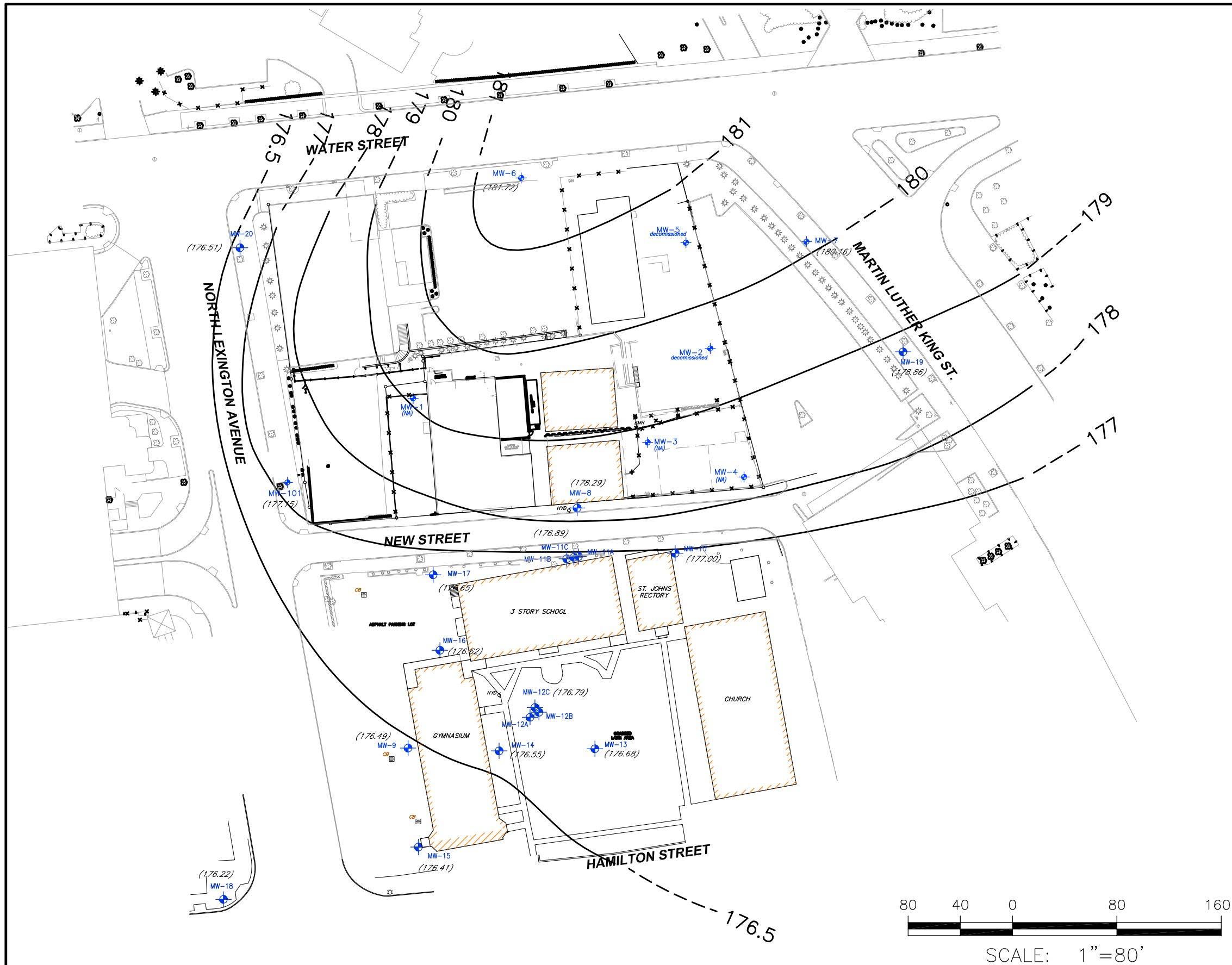

- LEGEND:**
- GROUNDWATER ELEVATION CONTOUR
 - - - INFERRED GROUNDWATER ELEVATION CONTOUR
 - ⊕ MONITORING WELL
 - (NA) NO LONGER ACCESSIBLE
 - (176.22) GROUNDWATER ELEVATIONS

- NOTES:**
1. MONITORING WELL GAUGING WAS PERFORMED BY PARSONS, INC. ON DECEMBER 9, 2013.
 2. GROUNDWATER ELEVATIONS FOR MONITORING/RECOVERY WELLS AND PIEZOMETERS WERE NOT INCLUDED IN THE CONTOUR MAPPING: RW-1 THROUGH RW-6, PZ-1 THROUGH PZ-4, MW-11A, MW-11B, MW-12A, AND MW-12B.
 3. MONITORING WELLS WERE FIELD SURVEYED BY CHAZEN ENGINEERING ON NOVEMBER 30, 2009 AND MAY 16, 2011.
 4. MAP SOURCE FROM FIG 5-2 OF THE RETEC GROUP, INC. REMEDIAL INVESTIGATION REPORT, ST. JOHN THE EVANGELIST R.C. CHURCH AND ELEMENTARY SCHOOL (NOVEMBER 2005)

<p>PARSONS</p> <p>301 PLAINFIELD ROAD SUITE 350 SYRACUSE, N.Y. 13212 PHONE: (315) 451-9560 FAX: (315) 451-9570</p>		<p>WHITE PLAINS FORMER MGP SITE WHITE PLAINS, NEW YORK</p> <p>GROUNDWATER ELEVATION CONTOUR MAP DECEMBER 2013</p>	<p>FIGURE NO.</p> <p style="font-size: 24pt; font-weight: bold;">5</p>
---	--	---	--

ATTACHMENTS

Attachment 1

Groundwater Sampling Records

PARSONS

GROUNDWATER SAMPLING RECORD

SITE NAME: Con Edison (White Plains - OU-1/OU-2 Semi-Annual Sampling)
PROJECT NUMBER: 446107-09000
Purge Date: 12-10-13
Sampling Date: 12-10-13
Samplers: Zohar Lavy of Parsons / Somerset, NJ
SAMPLE ID: MW-6
Sampling Method: Low flow purge (Monsoon Pump)

WELL PURGING

Static Water Level (TOC): 5.90
 Depth to Well Bottom (TOC): 16.05
CALCULATIONS: Ft. of Water in Well _____ X (GAL / FT) = _____ Gallons
2-inch Casing: Ft. of Water in Well 10.15 x 0.16 = 1.62 Gallons
 3-inch Casing: Ft. of Water in Well _____ x 0.32 = _____ Gallons
 4-inch Casing: Ft. of Water in Well _____ x 0.64 = _____ Gallons
 Method: Low Flow Pump

SAMPLE DESCRIPTION

Odor : No Odor
 Other : Clear

FIELD TESTS

	PURGE	PURGE	PURGE	PURGE	PURGE	PURGE	PURGE	SAMPLE
Time	1115	1120	1125	1130	1135	1140	1145	1150
Depth To Water (TOC) (ft)	6.31	6.45	6.88	7.39	7.72	8.45	8.97	9.67
Depth To Pump (TOC) (ft)	15.00	15.00	15.00	15.00	15.00	15.00	15.00	15.00
Flow Rate (ml/min)	~350	~250	~300	~200	~200	~300	~250	~300
Volume of Water Purged	~0.5	~1	~1.5	~1.75	~2.0	~2.5	~3	~3.5
pH (s.u.)	6.76	6.73	6.74	6.75	6.76	6.73	6.74	6.75
Conductivity (mS/cm)	1.47	1.46	1.4	1.34	1.36	1.4	1.42	1.44
Turbidity (NTUs)	64.3	57.3	28.6	11.3	8.4	8.1	7.3	6.7
Dissolved Oxygen (mg/L)	4.27	1.95	1.82	1.61	1.47	1.41	1.36	1.30
Temperature (Degrees C)	15.38	14.27	14.29	14.31	14.32	14.15	14.03	14.13
ORP (mV)	100	93	95	96	79	73	65	61
Salinity (%)	0.7	0.7	0.7	0.7	0.7	0.7	0.7	0.7
TDS (g/L)	0.944	0.93	0.87	0.84	0.85	0.86	0.858	0.86

SAMPLE ANALYSIS / LABORATORY

Analyze For: TCL VOCs, TCL SVOCs
 Shipped Via: Chemtech, Mountainside, NJ
 Laboratory: _____
 Other Notes: Sample collected at 1150; purged approximately 3.5 gallons

PARSONS

GROUNDWATER SAMPLING RECORD

SITE NAME: Con Edison (White Plains - OU-1/OU-2 Semi-Annual Sampling)
PROJECT NUMBER: 446107-09000
Purge Date: 12-10-13
Sampling Date: 12-10-13
Samplers: Zohar Lavy of Parsons / Somerset, NJ
SAMPLE ID: MW-7
Sampling Method: Low flow purge (Monsoon Pump)

WELL PURGING

Static Water Level (TOC): 9.46
 Depth to Well Bottom (TOC): 15.98
CALCULATIONS: Ft. of Water in Well _____ X (GAL / FT) = _____ Gallons
2-inch Casing: Ft. of Water in Well 6.52 x 0.16 = 1.04 Gallons
 3-inch Casing: Ft. of Water in Well _____ x 0.32 = _____ Gallons
 4-inch Casing: Ft. of Water in Well _____ x 0.64 = _____ Gallons
 Method: Low Flow Pump

SAMPLE DESCRIPTION

Odor : No Odor
 Other : Clear

FIELD TESTS

	PURGE	PURGE	PURGE	PURGE	PURGE	PURGE	PURGE	SAMPLE
Time	0905	0910	0915	0920	0925	0930	0935	0940
Depth To Water (TOC) (ft)	9.95	10.32	10.58	10.70	10.81	10.95	11.53	11.42
Depth To Pump (TOC) (ft)	14.95	14.95	14.95	14.95	14.95	14.95	14.95	14.95
Flow Rate (ml/min)	~400	~350	~250	~300	~300	~300	~350	~300
Volume of Water Purged	~0.75	~1.5	~2	~2.5	~3	~3.5	~4	~4.5
pH (s.u.)	7.17	7.13	7.14	7.14	7.16	7.15	7.14	7.14
Conductivity (mS/cm)	2.17	2.24	2.21	2.42	2.43	2.47	2.49	2.52
Turbidity (NTUs)	585	472	318	132	97.1	49.5	32.5	18.6
Dissolved Oxygen (mg/L)	2.56	2.24	1.19	0.63	0.65	0.64	0.65	0.65
Temperature (Degrees C)	14.11	14.47	14.41	14.45	14.38	14.13	14.22	14.31
ORP (mV)	-59	-100	-108	-120	-123	-127	-130	-132
Salinity (%)	1.1	1.1	1.1	1.1	1.1	1.1	1.1	1.1
TDS (g/L)	1.38	1.43	1.45	1.49	1.55	1.57	1.59	1.59

SAMPLE ANALYSIS / LABORATORY

Analyze For: TCL VOCs, TCL SVOCs
 Shipped Via: Chemtech, Mountainside, NJ
 Laboratory: _____
 Other Notes: Sample collected at 0940; purged approximately 4.5 gallons

PARSONS

GROUNDWATER SAMPLING RECORD

SITE NAME: Con Edison (White Plains - OU-1/OU-2 Semi-Annual Sampling)
PROJECT NUMBER: 446107-09000
Purge Date: 12-10-13
Sampling Date: 12-10-13
Samplers: Zohar Lavy of Parsons / Somerset, NJ
SAMPLE ID: MW-8
Sampling Method: Low flow purge (Monsoon Pump)

WELL PURGING

Static Water Level (TOC): 23.81
 Depth to Well Bottom (TOC): 39.50
CALCULATIONS: Ft. of Water in Well _____ X (GAL / FT) = _____ Gallons
2-inch Casing: Ft. of Water in Well _____ x 0.16 = _____ Gallons
3-inch Casing: Ft. of Water in Well _____ x 0.32 = _____ Gallons
4-inch Casing: Ft. of Water in Well _____ x 0.64 = _____ Gallons
 Method: Low Flow Pump

SAMPLE DESCRIPTION

Odor : Slight Hydrocarbon Odor
 Other : Clear

FIELD TESTS

	PURGE	PURGE	PURGE	PURGE	PURGE	SAMPLE
Time	1510	1515	1520	1525	1530	1535
Depth To Water (TOC) (ft)	23.83	23.87	23.89	23.90	23.90	23.91
Depth To Pump (TOC) (ft)	38.5	38.5	38.5	38.5	38.5	38.5
Flow Rate (ml/min)	~300	~300	~300	~300	~300	~300
Volume of Water Purged	~0.5	~1	~1.5	~2	~2.5	~3
pH (s.u.)	6.87	6.90	6.93	6.97	6.98	6.98
Conductivity (mS/cm)	4.1	4.01	3.16	2.47	2.40	2.42
Turbidity (NTUs)	99.3	66.2	46.2	25.7	13.3	9.6
Dissolved Oxygen (mg/L)	3.67	0.97	1.66	2.36	2.45	2.48
Temperature (Degrees C)	14.16	14.26	14.31	14.35	14.52	14.41
ORP (mV)	-101	-112	-83	-72	-70	-68
Salinity (%)	2.2	2.1	2.1	2.1	2.1	2.1
TDS (g/L)	2.65	2.58	2.5	2.5	2.49	2.47

SAMPLE ANALYSIS / LABORATORY

Analyze For: TCL VOCs, TCL SVOCs
 Shipped Via: Chemtech, Mountainside, NJ
 Laboratory:
 Other Notes: Sample collected at 1535; purged approximately 3 gallons

PARSONS

GROUNDWATER SAMPLING RECORD

SITE NAME: Con Edison (White Plains - OU-1/OU-2 Semi-Annual Sampling)
PROJECT NUMBER: 446107-09000
Purge Date: 12-12-13
Sampling Date: 12-12-13
Samplers: Allison Jordan, Zohar Lavy of Parsons / Somerset, NJ
SAMPLE ID: MW-9
Sampling Method: Low flow purge (Monsoon Pump)

WELL PURGING

Static Water Level (TOC): 30.91
 Depth to Well Bottom (TOC): 62.15
CALCULATIONS: Ft. of Water in Well _____ X (GAL / FT) = _____ Gallons
2-inch Casing: Ft. of Water in Well _____ x 0.16 = _____ Gallons
 3-inch Casing: Ft. of Water in Well _____ x 0.32 = _____ Gallons
 4-inch Casing: Ft. of Water in Well _____ x 0.64 = _____ Gallons
 Method: Low Flow Pump

SAMPLE DESCRIPTION

Odor : No Odor
 Other : Clear

FIELD TESTS

	PURGE	PURGE	PURGE	PURGE	PURGE	PURGE	PURGE	SAMPLE
Time	0915	0920	0925	0930	0935	0940	0945	0950
Depth To Water (TOC) (ft)	31.05	31.05	31.05	31.05	31.05	31.05	31.05	31.05
Depth To Pump (TOC) (ft)	61.15	61.15	61.15	61.15	61.15	61.15	61.15	61.15
Flow Rate (ml/min)	~500	~500	~500	~500	~500	~500	~500	~500
Volume of Water Purged	~0.5	~0.75	~1	~1.25	~1.75	~2	~2.5	~3
pH (s.u.)	7.29	7.31	7.31	7.31	7.31	7.31	7.31	7.31
Conductivity (mS/cm)	2.65	2.65	2.66	2.63	2.62	2.64	2.64	2.65
Turbidity (NTUs)	546	386	346	306	234	145	101	64.4
Dissolved Oxygen (mg/L)	5.83	3.86	3.31	2.74	2.55	2.31	2.20	2.07
Temperature (Degrees C)	13.81	13.13	13.46	14.00	13.90	14.09	14.04	13.85
ORP (mV)	-86	-93	-96	-102	-104	-107	-110	-112
Salinity (%)	1.4	1.4	1.4	1.3	1.3	1.4	1.4	1.4
TDS (g/L)	1.7	1.7	1.7	1.69	1.68	1.69	1.69	1.70

SAMPLE ANALYSIS / LABORATORY

Analyze For: TCL VOCs, TCL SVOCs
 Shipped Via: Chemtech, Mountainside, NJ
 Laboratory: _____
 Other Notes: Sample collected at 0950; purged approximately 3 gallons

PARSONS

GROUNDWATER SAMPLING RECORD

SITE NAME: Con Edison (White Plains - OU-1/OU-2 Semi-Annual Sampling)
PROJECT NUMBER: 446107-09000
Purge Date: 12-10-13
Sampling Date: 12-10-13
Samplers: Zohar Lavy of Parsons / Somerset, NJ
SAMPLE ID: MW-10
Sampling Method: Low flow purge (Monsoon Pump)

WELL PURGING

Static Water Level (TOC): 21.45
 Depth to Well Bottom (TOC): 49.85
CALCULATIONS: Ft. of Water in Well _____ X (GAL / FT) = _____ Gallons
2-inch Casing: Ft. of Water in Well _____ x 0.16 = _____ Gallons
 3-inch Casing: Ft. of Water in Well _____ x 0.32 = _____ Gallons
 4-inch Casing: Ft. of Water in Well _____ x 0.64 = _____ Gallons
 Method: Low Flow Pump

SAMPLE DESCRIPTION

Odor : No Odor
 Other : Clear

FIELD TESTS

	PURGE	PURGE	PURGE	PURGE	PURGE	PURGE	PURGE	SAMPLE
Time	1240	1245	1250	1255	1300	1305	1310	1315
Depth To Water (TOC) (ft)	21.46	21.46	21.47	21.47	21.48	21.49	21.50	21.50
Depth To Pump (TOC) (ft)	48.85	48.85	48.85	48.85	48.85	48.85	48.85	48.85
Flow Rate (ml/min)	~350	~350	~300	~300	~250	~250	~200	~200
Volume of Water Purged	~0.75	~1.5	~2	~2.5	~2.75	~3.25	~3.75	~4
pH (s.u.)	6.99	7.0	7.01	7.03	7.03	7.02	7.03	7.02
Conductivity (mS/cm)	7.34	7.21	7.16	7.12	7.13	7.13	7.14	7.14
Turbidity (NTUs)	271	133	67.3	20.1	12.6	5.7	2.3	0
Dissolved Oxygen (mg/L)	23.94	16.38	12.50	10.75	10.62	10.53	10.48	10.45
Temperature (Degrees C)	12.23	13.82	14.25	14.39	14.33	14.10	14.22	14.18
ORP (mV)	63	91	116	127	125	123	123	122
Salinity (%)	4	3.9	3.9	3.9	3.9	3.9	3.9	3.9
TDS (g/L)	4.67	4.59	4.54	4.49	4.49	4.5	4.5	4.5

SAMPLE ANALYSIS / LABORATORY

Analyze For: TCL VOCs, TCL SVOCs
 Shipped Via: Chemtech, Mountainside, NJ
 Laboratory: _____
 Other Notes: Sample collected at 1315; purged approximately 4 gallons

PARSONS

GROUNDWATER SAMPLING RECORD

SITE NAME: Con Edison (White Plains - OU-1/OU-2 Semi-Annual Sampling)
PROJECT NUMBER: 446107-09000
Purge Date: 12-9-13
Sampling Date: 12-9-13
Samplers: Zohar Lavy of Parsons / Somerset, NJ
SAMPLE ID: MW-11A
Sampling Method: Low flow purge (Monsoon Pump)

WELL PURGING

Static Water Level (TOC): 24.79
 Depth to Well Bottom (TOC): 26.75
CALCULATIONS: Ft. of Water in Well _____ X (GAL / FT) = _____ Gallons
2-inch Casing: Ft. of Water in Well _____ x 0.16 = _____ Gallons
 3-inch Casing: Ft. of Water in Well _____ x 0.32 = _____ Gallons
 4-inch Casing: Ft. of Water in Well _____ x 0.64 = _____ Gallons
 Method: Low Flow Pump

SAMPLE DESCRIPTION

Odor : No Odor
 Other : Clear

FIELD TESTS

	PURGE	PURGE	PURGE	PURGE	PURGE	PURGE	PURGE	SAMPLE
Time	1445	1450	1455	1500	1505	1510	1515	1520
Depth To Water (TOC) (ft)	25.3	25.3	25.3	25.3	25.4	25.4	25.4	25.4
Depth To Pump (TOC) (ft)	25.75	25.75	25.75	25.75	25.75	25.75	25.75	25.75
Flow Rate (ml/min)	~300	~350	~350	~300	~350	~350	~350	~350
Volume of Water Purged	~0.75	~1.5	~2	~2.5	~3	~3.5	~4	~4.5
pH (s.u.)	7.2	7.25	7.25	7.26	7.26	7.25	7.25	7.25
Conductivity (mS/cm)	5.3	5.03	5.03	5.05	5.05	5.06	5.06	5.07
Turbidity (NTUs)	117	62.1	40.7	23.2	16.8	14.2	12.1	11.4
Dissolved Oxygen (mg/L)	8.99	7.27	6.99	6.97	6.94	6.92	6.9	6.9
Temperature (Degrees C)	17.49	17.57	17.60	17.63	17.69	17.73	17.74	17.79
ORP (mV)	140	143	143	144	144	145	145	145
Salinity (%)	2.8	2.7	2.7	2.7	2.7	2.7	2.7	2.7
TDS (g/L)	3.29	3.17	3.19	3.19	3.19	3.2	3.2	3.2

SAMPLE ANALYSIS / LABORATORY

Analyze For: TCL VOCs, TCL SVOCs
 Shipped Via: Chemtech, Mountainside, NJ
 Laboratory: _____
 Other Notes: Sample collected at 1520; purged approximately 4.5 gallons

PARSONS

GROUNDWATER SAMPLING RECORD

SITE NAME: Con Edison (White Plains - OU-1/OU-2 Semi-Annual Sampling)
PROJECT NUMBER: 446107-09000
Purge Date: 12-9-13
Sampling Date: 12-9-13
Samplers: Zohar Lavy of Parsons / Somerset, NJ
SAMPLE ID: MW-11B
Sampling Method: Low flow purge (Monsoon Pump)

WELL PURGING

Static Water Level (TOC): 25.00
 Depth to Well Bottom (TOC): 35.95
CALCULATIONS: Ft. of Water in Well _____ X (GAL / FT) = _____ Gallons
2-inch Casing: Ft. of Water in Well _____ x 0.16 = _____ Gallons
3-inch Casing: Ft. of Water in Well _____ x 0.32 = _____ Gallons
4-inch Casing: Ft. of Water in Well _____ x 0.64 = _____ Gallons
 Method: Low Flow Pump

SAMPLE DESCRIPTION

Odor : No Odor
 Other : Clear

FIELD TESTS

	PURGE	PURGE	PURGE	PURGE	PURGE	PURGE	PURGE	SAMPLE
Time	1535	1540	1545	1550	1555	1600	1605	1610
Depth To Water (TOC) (ft)	25.17	25.17	25.17	25.17	25.18	25.18	25.17	25.18
Depth To Pump (TOC) (ft)	34.95	34.95	34.95	34.95	34.95	34.95	34.95	34.95
Flow Rate (ml/min)	~300	~200	~250	~250	~250	~250	~300	~300
Volume of Water Purged	~0.5	~0.75	~1.25	~1.75	~2.25	~2.75	~3.25	~3.75
pH (s.u.)	7.31	7.32	7.32	7.31	7.31	7.31	7.32	7.31
Conductivity (mS/cm)	4.5	4.53	4.52	4.51	4.51	4.5	4.5	4.5
Turbidity (NTUs)	90.2	32.5	20.1	15.6	13.4	9.7	7.8	6.2
Dissolved Oxygen (mg/L)	17.9	11.42	11.03	10.62	10.41	10.35	10.29	10.23
Temperature (Degrees C)	16.41	16.4	16.57	16.92	17.4	17.43	17.41	17.42
ORP (mV)	160	166	162	156	150	147	145	143
Salinity (%)	2.4	2.4	2.4	2.4	2.4	2.4	2.4	2.4
TDS (g/L)	2.89	2.9	2.9	2.89	2.89	2.89	2.89	2.89

SAMPLE ANALYSIS / LABORATORY

Analyze For: TCL VOCs, TCL SVOCs
 Shipped Via: Chemtech, Mountainside, NJ
 Laboratory: _____
 Other Notes: Sample collected at 1610; purged approximately 3.75 gallons

PARSONS

GROUNDWATER SAMPLING RECORD

SITE NAME: Con Edison (White Plains - OU-1/OU-2 Semi-Annual Sampling)
PROJECT NUMBER: 446107-09000
Purge Date: 12-12-13
Sampling Date: 12-12-13
Samplers: Zohar Lavy of Parsons / Somerset, NJ
SAMPLE ID: MW-11C
Sampling Method: Low flow purge (Monsoon Pump)

WELL PURGING

Static Water Level (TOC): 24.88
 Depth to Well Bottom (TOC): 49.80
CALCULATIONS: Ft. of Water in Well _____ X (GAL / FT) = _____ Gallons
2-inch Casing: Ft. of Water in Well 24.92 x 0.16 = 3.99 Gallons
 3-inch Casing: Ft. of Water in Well _____ x 0.32 = _____ Gallons
 4-inch Casing: Ft. of Water in Well _____ x 0.64 = _____ Gallons
 Method: Low Flow Pump

SAMPLE DESCRIPTION

Odor : Strong Hydrocarbon Odor
 Other : Clear

FIELD TESTS

	PURGE	PURGE	PURGE	PURGE	PURGE	PURGE	PURGE	SAMPLE
Time	1305	1310	1315	1320	1325	1330	1335	1340
Depth To Water (TOC) (ft)	24.97	24.99	24.99	24.99	24.99	25.00	25.00	25.00
Depth To Pump (TOC) (ft)	48.80	48.80	48.80	48.80	48.80	48.80	48.80	48.80
Flow Rate (ml/min)	~350	~350	~350	~350	~350	~350	~350	~350
Volume of Water Purged	~0.5	~1.0	~1.5	~2	~2.5	~3	~3.5	~4
pH (s.u.)	7.33	7.35	7.36	7.38	7.38	7.38	7.38	7.38
Conductivity (mS/cm)	3.24	3.29	3.34	3.39	3.4	3.41	3.41	3.41
Turbidity (NTUs)	316	228	113	64.8	53.7	47.6	20.2	3.4
Dissolved Oxygen (mg/L)	12.6	7.89	2.65	0.63	0.6	0.59	0.59	0.58
Temperature (Degrees C)	13.77	13.82	14.19	14.72	14.13	14.27	14.29	14.40
ORP (mV)	-33	-36	-40	-42	-41	-41	-40	-40
Salinity (%)	1.7	1.7	1.8	1.8	1.8	1.8	1.8	1.8
TDS (g/L)	2.08	2.11	2.13	2.16	2.16	2.17	2.18	2.18

SAMPLE ANALYSIS / LABORATORY

Analyze For: TCL VOCs, TCL SVOCs
 Shipped Via: Chemtech, Mountainside, NJ
 Laboratory: _____
 Other Notes: Sample collected at 1340; purged approximately 4 gallons

PARSONS

GROUNDWATER SAMPLING RECORD

SITE NAME: Con Edison (White Plains - OU-1/OU-2 Semi-Annual Sampling)
PROJECT NUMBER: 446107-09000
Purge Date: 12-11-13
Sampling Date: 12-11-13
Samplers: Zohar Lavy of Parsons / Somerset, NJ
SAMPLE ID: MW-12A
Sampling Method: Low flow purge (Monsoon Pump)

WELL PURGING

Static Water Level (TOC): 28.08
 Depth to Well Bottom (TOC): 30.55
CALCULATIONS: Ft. of Water in Well _____ X (GAL / FT) = _____ Gallons
2-inch Casing: Ft. of Water in Well _____ x 0.16 = _____ Gallons
 3-inch Casing: Ft. of Water in Well _____ x 0.32 = _____ Gallons
 4-inch Casing: Ft. of Water in Well _____ x 0.64 = _____ Gallons
 Method: Low Flow Pump

SAMPLE DESCRIPTION

Odor : No Odor
 Other : Clear

FIELD TESTS

	PURGE	PURGE	PURGE	PURGE	PURGE	PURGE	SAMPLE
Time	1140	1145	1150	1155	1200	1205	1210
Depth To Water (TOC) (ft)	28.20	28.25	28.28	28.29	28.30	28.31	28.33
Depth To Pump (TOC) (ft)	29.55	29.55	29.55	29.55	29.55	29.55	29.55
Flow Rate (ml/min)	~350	~300	~300	~300	~300	~300	~300
Volume of Water Purged	~0.75	~1.25	~1.75	~2.5	~3.0	~3.5	~4.0
pH (s.u.)	7.63	7.59	7.56	7.56	7.56	7.57	7.57
Conductivity (mS/cm)	0.585	0.579	0.576	0.575	0.573	0.573	0.572
Turbidity (NTUs)	208	55.1	41.1	35	21.6	13.7	9.2
Dissolved Oxygen (mg/L)	8.83	9.2	9.05	9.03	8.92	8.85	8.78
Temperature (Degrees C)	13.18	13.74	14.23	14.35	14.28	14.26	14.31
ORP (mV)	118	128	141	140	140	139	138
Salinity (%)	0.3	0.3	0.3	0.3	0.3	0.3	0.3
TDS (g/L)	0.371	0.371	0.368	0.368	0.367	0.367	0.367

SAMPLE ANALYSIS / LABORATORY

Analyze For: TCL VOCs, TCL SVOCs
 Shipped Via: Chemtech, Mountainside, NJ
 Laboratory: _____
 Other Notes: Sample collected at 1210; purged approximately 4 gallons

PARSONS

GROUNDWATER SAMPLING RECORD

SITE NAME: Con Edison (White Plains - OU-1/OU-2 Semi-Annual Sampling)
PROJECT NUMBER: 446107-09000
Purge Date: 12-11-13
Sampling Date: 12-11-13
Samplers: Zohar Lavy of Parsons / Somerset, NJ
SAMPLE ID: MW-12B
Sampling Method: Low flow purge (Monsoon Pump)

WELL PURGING

Static Water Level (TOC): 28.06
 Depth to Well Bottom (TOC): 44.48
CALCULATIONS: Ft. of Water in Well _____ X (GAL / FT) = _____ Gallons
2-inch Casing: Ft. of Water in Well _____ x 0.16 = _____ Gallons
 3-inch Casing: Ft. of Water in Well _____ x 0.32 = _____ Gallons
 4-inch Casing: Ft. of Water in Well _____ x 0.64 = _____ Gallons
 Method: Low Flow Pump

SAMPLE DESCRIPTION

Odor : No Odor
 Other : Clear

FIELD TESTS

	PURGE	PURGE	PURGE	PURGE	PURGE	PURGE	SAMPLE
Time	1245	1250	1255	1300	1305	1310	1315
Depth To Water (TOC) (ft)	28.58	28.38	28.38	28.43	28.40	28.40	28.43
Depth To Pump (TOC) (ft)	43.48	43.48	43.48	43.48	43.48	43.48	43.48
Flow Rate (ml/min)	~350	~300	~300	~250	~250	~250	~250
Volume of Water Purged	~0.75	~1.5	~2.0	~2.5	~3.0	~3.5	~4.0
pH (s.u.)	7.38	7.36	7.37	7.37	7.36	7.36	7.36
Conductivity (mS/cm)	1.84	1.96	1.97	1.97	1.97	1.97	1.97
Turbidity (NTUs)	175	28.7	18.1	9.6	5.2	0	0
Dissolved Oxygen (mg/L)	12.45	1.49	1.21	0.95	0.78	0.73	0.71
Temperature (Degrees C)	13.89	13.60	13.85	14.11	14.19	14.25	14.40
ORP (mV)	55	21	20	23	26	27	29
Salinity (%)	0.9	1.0	1.0	1.0	1.0	1.0	1.0
TDS (g/L)	1.2	1.25	1.26	1.26	1.26	1.26	1.26

SAMPLE ANALYSIS / LABORATORY

Analyze For: TCL VOCs, TCL SVOCs
 Shipped Via: Chemtech, Mountainside, NJ
 Laboratory: _____
 Other Notes: Sample collected at 1315; purged approximately 4 gallons

PARSONS

GROUNDWATER SAMPLING RECORD

SITE NAME: Con Edison (White Plains - OU-1/OU-2 Semi-Annual Sampling)
PROJECT NUMBER: 446107-09000
Purge Date: 12-11-13
Sampling Date: 12-11-13
Samplers: Zohar Lavy of Parsons / Somerset, NJ
SAMPLE ID: MW-13
Sampling Method: Low flow purge (Monsoon Pump)

WELL PURGING

Static Water Level (TOC): 28.17
 Depth to Well Bottom (TOC): 58.60
CALCULATIONS: Ft. of Water in Well _____ X (GAL / FT) = _____ Gallons
2-inch Casing: Ft. of Water in Well _____ x 0.16 = _____ Gallons
3-inch Casing: Ft. of Water in Well _____ x 0.32 = _____ Gallons
4-inch Casing: Ft. of Water in Well _____ x 0.64 = _____ Gallons
 Method: Low Flow Pump

SAMPLE DESCRIPTION

Odor : No Odor
 Other : Clear

FIELD TESTS

	PURGE	PURGE	PURGE	PURGE	PURGE	PURGE	PURGE	SAMPLE
Time	1355	1400	1405	1410	1415	1420	1425	1430
Depth To Water (TOC) (ft)	28.24	28.27	28.29	28.29	28.28	28.30	28.30	28.30
Depth To Pump (TOC) (ft)	57.6	57.6	57.6	57.6	57.6	57.6	57.6	57.6
Flow Rate (ml/min)	~350	~350	~350	~350	~300	~300	~300	~300
Volume of Water Purged	~0.75	~1.5	~2.25	~2.75	~3.25	~3.75	~4.25	~4.75
pH (s.u.)	6.81	6.81	6.80	6.80	6.80	6.79	6.78	6.78
Conductivity (mS/cm)	3.19	3.19	3.16	3.17	3.18	3.18	3.18	3.19
Turbidity (NTUs)	695	465	177	109	72.5	59.3	52.6	43.7
Dissolved Oxygen (mg/L)	1.06	0.82	0.65	0.78	0.83	0.86	0.87	0.87
Temperature (Degrees C)	13.12	13.76	13.95	13.71	13.61	13.55	13.63	13.51
ORP (mV)	-81	-82	-81	-78	-75	-73	-72	-71
Salinity (%)	1.7	1.6	1.6	1.6	1.6	1.6	1.6	1.6
TDS (g/L)	2.04	2.03	2.02	2.02	2.02	2.02	2.02	2.02

SAMPLE ANALYSIS / LABORATORY

Analyze For: TCL VOCs, TCL SVOCs
 Shipped Via: Chemtech, Mountainside, NJ
 Laboratory: _____
 Other Notes: Sample collected at 1430; purged approximately 4.75 gallons

PARSONS

GROUNDWATER SAMPLING RECORD

SITE NAME: Con Edison (White Plains - OU-1/OU-2 Semi-Annual Sampling)
PROJECT NUMBER: 446107-09000
Purge Date: 12-12-13
Sampling Date: 12-12-13
Samplers: Zohar Lavy of Parsons / Somerset, NJ
SAMPLE ID: MW-14
Sampling Method: Low flow purge (Monsoon Pump)

WELL PURGING

Static Water Level (TOC): 28.51
 Depth to Well Bottom (TOC): 64.50
CALCULATIONS: Ft. of Water in Well _____ X (GAL / FT) = _____ Gallons
2-inch Casing: Ft. of Water in Well 35.99 x 0.16 = 5.76 Gallons
 3-inch Casing: Ft. of Water in Well _____ x 0.32 = _____ Gallons
 4-inch Casing: Ft. of Water in Well _____ x 0.64 = _____ Gallons
 Method: Low Flow Pump

SAMPLE DESCRIPTION

Odor : Strong Hydrocarbon Odor
 Other : Clear

FIELD TESTS

	PURGE	PURGE	PURGE	PURGE	PURGE	PURGE	PURGE
Time	1045	1050	1055	1100	1105	1110	1115
Depth To Water (TOC) (ft)	28.65	28.65	28.66	28.65	28.65	28.66	28.65
Depth To Pump (TOC) (ft)	63.5	63.5	63.5	63.5	63.5	63.5	63.5
Flow Rate (ml/min)	~400	~350	~400	~350	~350	~350	~350
Volume of Water Purged	~1	~1.75	~2.5	~3.25	~4	~4.5	~5.5
pH (s.u.)	6.99	6.99	6.98	6.97	6.98	6.98	6.98
Conductivity (mS/cm)	2.35	2.30	2.32	2.32	2.32	2.32	2.43
Turbidity (NTUs)	Error	Error	Error	270	246	263	211
Dissolved Oxygen (mg/L)	1.72	0.84	0.74	0.66	0.62	0.62	0.64
Temperature (Degrees C)	13.55	14.29	14.03	13.68	13.99	13.91	14.13
ORP (mV)	-69	-75	-77	-80	-82	-82	-83
Salinity (%)	1.2	1.2	1.2	1.2	1.2	1.2	1.2
TDS (g/L)	1.51	1.48	1.48	1.48	1.48	1.48	1.49

SAMPLE ANALYSIS / LABORATORY

Analyze For: TCL VOCs, TCL SVOCs
 Shipped Via: Chemtech, Mountainside, NJ
 Laboratory: _____
 Other Notes: Sample collected at 1145; purged approximately 8 gallons

PARSONS

GROUNDWATER SAMPLING RECORD

SITE NAME: Con Edison (White Plains - OU-1/OU-2 Semi-Annual Sampling)
PROJECT NUMBER: 446107-09000
Purge Date: 12-12-13
Sampling Date: 12-12-13
Samplers: Zohar Lavy of Parsons / Somerset, NJ
SAMPLE ID: MW-14
Sampling Method: Low flow purge (Monsoon Pump)

WELL PURGING

Static Water Level (TOC): 28.51
 Depth to Well Bottom (TOC): 64.50
CALCULATIONS: Ft. of Water in Well _____ X (GAL / FT) = _____ Gallons
2-inch Casing: Ft. of Water in Well 35.99 x 0.16 = 5.76 Gallons
 3-inch Casing: Ft. of Water in Well _____ x 0.32 = _____ Gallons
 4-inch Casing: Ft. of Water in Well _____ x 0.64 = _____ Gallons
 Method: Low Flow Pump

SAMPLE DESCRIPTION

Odor : Strong Hydrocarbon Odor
 Other : Clear

FIELD TESTS

	PURGE	PURGE	PURGE	PURGE	SAMPLE
Time	1125	1130	1135	1140	1145
Depth To Water (TOC) (ft)	28.65	28.66	28.66	28.65	28.66
Depth To Pump (TOC) (ft)	63.5	63.5	63.5	63.5	63.5
Flow Rate (ml/min)	~350	~300	~300	~300	~300
Volume of Water Purged	~6	~6.5	~7	~7.5	~8
pH (s.u.)	6.96	6.96	6.96	6.96	6.97
Conductivity (mS/cm)	2.33	2.33	2.32	2.33	2.33
Turbidity (NTUs)	86.2	65.3	53.6	48.2	46.1
Dissolved Oxygen (mg/L)	0.53	0.51	0.5	0.5	0.49
Temperature (Degrees C)	13.91	13.95	13.94	13.95	13.89
ORP (mV)	-86	-86	-87	-88	-89
Salinity (%)	1.2	1.2	1.2	1.2	1.2
TDS (g/L)	1.49	1.49	1.49	1.49	1.49

SAMPLE ANALYSIS / LABORATORY

Analyze For: TCL VOCs, TCL SVOCs
 Shipped Via: Chemtech, Mountainside, NJ
 Laboratory: _____
 Other Notes: Sample collected at 1145; purged approximately 8 gallons

PARSONS

GROUNDWATER SAMPLING RECORD

SITE NAME: Con Edison (White Plains - OU-1/OU-2 Semi-Annual Sampling)
PROJECT NUMBER: 446107-09000
Purge Date: 12-12-13
Sampling Date: 12-12-13
Samplers: Allison Jordan, Zohar Lavy of Parsons / Somerset, NJ
SAMPLE ID: MW-15
Sampling Method: Low flow purge (Monsoon Pump)

WELL PURGING

Static Water Level (TOC): 31.29
 Depth to Well Bottom (TOC): 66.60
CALCULATIONS: Ft. of Water in Well _____ X (GAL / FT) = _____ Gallons
2-inch Casing: Ft. of Water in Well _____ x 0.16 = _____ Gallons
 3-inch Casing: Ft. of Water in Well _____ x 0.32 = _____ Gallons
 4-inch Casing: Ft. of Water in Well _____ x 0.64 = _____ Gallons
 Method: Low Flow Pump

SAMPLE DESCRIPTION

Odor : Slight Hydrocarbon Odor
 Other : Clear

FIELD TESTS

	PURGE	PURGE	PURGE	PURGE	PURGE	PURGE	PURGE	SAMPLE
Time	1250	1255	1300	1305	1310	1315	1320	1325
Depth To Water (TOC) (ft)	31.30	31.40	31.42	31.40	31.32	31.36	31.37	31.40
Depth To Pump (TOC) (ft)	65.60	65.60	65.60	65.60	65.60	65.60	65.60	65.60
Flow Rate (ml/min)	~500	~500	~500	~500	~500	~500	~500	~500
Volume of Water Purged	0	~0.5	~1.0	~1.5	~2.0	~2.5	~3.0	~3.5
pH (s.u.)	7.14	7.12	7.10	7.10	7.10	7.10	7.10	7.10
Conductivity (mS/cm)	3.88	3.93	3.96	3.95	3.94	3.92	3.91	3.89
Turbidity (NTUs)	960	774	359	159	104	71.9	57.7	49.5
Dissolved Oxygen (mg/L)	9.58	6.53	3.21	2.48	2.20	2.03	1.90	1.78
Temperature (Degrees C)	13.39	13.65	13.87	13.84	13.64	13.42	13.45	13.57
ORP (mV)	-97	-97	-98	-98	-97	-96	-98	-95
Salinity (%)	2.0	2.1	2.1	2.1	2.1	2.1	2.0	2.0
TDS (g/L)	2.48	2.51	2.54	2.53	2.52	2.51	2.50	2.49

SAMPLE ANALYSIS / LABORATORY

Analyze For: TCL VOCs, TCL SVOCs
 Shipped Via: Chemtech, Mountainside, NJ
 Laboratory: _____
 Other Notes: Sample collected at 1325; purged approximately 3.5 gallons

PARSONS

GROUNDWATER SAMPLING RECORD

SITE NAME: Con Edison (White Plains - OU-1/OU-2 Semi-Annual Sampling)
PROJECT NUMBER: 446107-09000
Purge Date: 12-12-13
Sampling Date: 12-12-13
Samplers: Allison Jordan, Zohar Lavy of Parsons / Somerset, NJ
SAMPLE ID: MW-16
Sampling Method: Low flow purge (Monsoon Pump)

WELL PURGING

Static Water Level (TOC): 29.45
 Depth to Well Bottom (TOC): 64.45
CALCULATIONS: Ft. of Water in Well _____ X (GAL / FT) = _____ Gallons
2-inch Casing: Ft. of Water in Well _____ x 0.16 = _____ Gallons
 3-inch Casing: Ft. of Water in Well _____ x 0.32 = _____ Gallons
 4-inch Casing: Ft. of Water in Well _____ x 0.64 = _____ Gallons
 Method: Low Flow Pump

SAMPLE DESCRIPTION

Odor : Moderate Hydrocarbon Odor
 Other : Clear

FIELD TESTS

	PURGE	PURGE	PURGE	PURGE	PURGE	PURGE	PURGE	SAMPLE
Time	1035	1040	1045	1050	1055	1100	1105	1110
Depth To Water (TOC) (ft)	29.50	29.50	29.50	29.50	29.50	29.50	29.50	29.50
Depth To Pump (TOC) (ft)	63.45	63.45	63.45	63.45	63.45	63.45	63.45	63.45
Flow Rate (ml/min)	~500	~500	~500	~500	~500	~500	~500	~500
Volume of Water Purged	~0.25	~0.75	~1.0	~1.5	~2.0	~2.5	~3.0	~3.5
pH (s.u.)	7.24	7.25	7.26	7.26	7.28	7.29	7.29	7.28
Conductivity (mS/cm)	3.63	3.50	3.37	3.34	3.26	3.29	3.39	3.42
Turbidity (NTUs)	160	115	70.0	51.8	22.3	12.0	9.8	9.1
Dissolved Oxygen (mg/L)	12.15	8.22	2.97	2.33	2.09	1.99	1.95	1.83
Temperature (Degrees C)	14.83	15.10	15.46	15.08	13.48	11.90	11.92	12.86
ORP (mV)	-137	-143	-155	-159	-159	-156	-154	-150
Salinity (%)	1.9	1.8	1.7	1.8	1.7	1.8	1.8	1.7
TDS (g/L)	2.32	2.24	2.16	2.14	2.09	2.10	2.17	2.19

SAMPLE ANALYSIS / LABORATORY

Analyze For: TCL VOCs, TCL SVOCs
 Shipped Via: Chemtech, Mountainside, NJ
 Laboratory: _____
 Other Notes: Sample collected at 1110; purged approximately 3.5 gallons

PARSONS

GROUNDWATER SAMPLING RECORD

SITE NAME: Con Edison (White Plains - OU-1/OU-2 Semi-Annual Sampling)
PROJECT NUMBER: 446107-09000
Purge Date: 12-9-13
Sampling Date: 12-9-13
Samplers: Zohar Lavy of Parsons / Somerset, NJ
SAMPLE ID: MW-17, MW-17MS, MW-17 MSD, MW-17A (dup)
Sampling Method: Low flow purge (Monsoon Pump)

WELL PURGING

Static Water Level (TOC): 28.30
 Depth to Well Bottom (TOC): 49.90
CALCULATIONS: Ft. of Water in Well _____ X (GAL / FT) = _____ Gallons
2-inch Casing: Ft. of Water in Well _____ x 0.16 = _____ Gallons
3-inch Casing: Ft. of Water in Well _____ x 0.32 = _____ Gallons
4-inch Casing: Ft. of Water in Well _____ x 0.64 = _____ Gallons
 Method: Low Flow Pump

SAMPLE DESCRIPTION

Odor : No Odor
 Other : Clear

FIELD TESTS

	PURGE	PURGE	PURGE	PURGE	PURGE	PURGE	PURGE	SAMPLE
Time	1210	1215	1220	1225	1230	1235	1240	1245
Depth To Water (TOC) (ft)	28.35	28.35	28.35	28.35	28.35	28.35	28.35	28.35
Depth To Pump (TOC) (ft)	48.9	48.9	48.9	48.9	48.9	48.9	48.9	48.9
Flow Rate (ml/min)	~250	~300	~300	~350	~350	~350	~350	~350
Volume of Water Purged	~0.5	~1	~1.75	~2.5	~3.25	~4	~4.75	~5.5
pH (s.u.)	7.3	7.45	7.48	7.53	7.57	7.57	7.56	7.57
Conductivity (mS/cm)	1.28	1.34	1.34	1.35	1.35	1.35	1.36	1.36
Turbidity (NTUs)	146	68.4	52.3	30.7	7.5	5.2	0	0
Dissolved Oxygen (mg/L)	21.22	7.56	7.42	7.38	7.34	7.31	7.27	7.25
Temperature (Degrees C)	15.85	16.59	16.87	16.88	17.05	16.93	16.82	16.91
ORP (mV)	236	217	212	209	206	203	200	198
Salinity (%)	0.6	0.7	0.7	0.7	0.7	0.7	0.7	0.7
TDS (g/L)	0.83	0.863	0.864	0.864	0.865	0.865	0.865	0.865

SAMPLE ANALYSIS / LABORATORY

Analyze For: TCL VOCs, TCL SVOCs
 Shipped Via: Chemtech, Mountainside, NJ
 Laboratory: _____
 Other Notes: Sample collected at 1245; purged approximately 5.5 gallons

PARSONS

GROUNDWATER SAMPLING RECORD

SITE NAME: Con Edison (White Plains - OU-1/OU-2 Semi-Annual Sampling)
PROJECT NUMBER: 446107-09000
Purge Date: 12-11-13
Sampling Date: 12-11-13
Samplers: Zohar Lavy of Parsons / Somerset, NJ
SAMPLE ID: MW-18
Sampling Method: Low flow purge (Monsoon Pump)

WELL PURGING

Static Water Level (TOC): 32.70
 Depth to Well Bottom (TOC): 71.80
CALCULATIONS: Ft. of Water in Well _____ X (GAL / FT) = _____ Gallons
2-inch Casing: Ft. of Water in Well _____ x 0.16 = _____ Gallons
3-inch Casing: Ft. of Water in Well _____ x 0.32 = _____ Gallons
4-inch Casing: Ft. of Water in Well _____ x 0.64 = _____ Gallons
 Method: Low Flow Pump

SAMPLE DESCRIPTION

Odor : No Odor
 Other : Clear

FIELD TESTS

	PURGE	PURGE	PURGE	PURGE	PURGE	PURGE	SAMPLE
Time	1630	1635	1640	1645	1650	1655	1700
Depth To Water (TOC) (ft)	32.80	32.75	32.70	32.72	32.72	32.72	32.73
Depth To Pump (TOC) (ft)	70.8	70.8	70.8	70.8	70.8	70.8	70.8
Flow Rate (ml/min)	~350	~350	~300	~300	~300	~300	~300
Volume of Water Purged	~0.75	~1.5	~2.25	~3.0	~3.5	~4.0	~4.5
pH (s.u.)	7.09	7.07	7.05	7.07	7.08	7.08	7.08
Conductivity (mS/cm)	2.88	2.97	3.08	3.13	3.12	3.12	3.11
Turbidity (NTUs)	763	315	126	70.5	34.9	20.5	11.6
Dissolved Oxygen (mg/L)	2.54	1.10	0.81	0.68	0.64	0.63	0.62
Temperature (Degrees C)	13.37	12.84	13.60	13.54	13.60	13.59	13.43
ORP (mV)	-84	-92	-98	-98	-100	-101	-103
Salinity (%)	1.5	1.6	1.6	1.6	1.6	1.6	1.6
TDS (g/L)	1.85	1.92	1.97	2.0	2.0	2.0	2.0

SAMPLE ANALYSIS / LABORATORY

Analyze For: TCL VOCs, TCL SVOCs
 Shipped Via: Chemtech, Mountainside, NJ
 Laboratory: _____
 Other Notes: Sample collected at 1700; purged approximately 4.5 gallons

PARSONS

GROUNDWATER SAMPLING RECORD

SITE NAME: Con Edison (White Plains - OU-1/OU-2 Semi-Annual Sampling)
PROJECT NUMBER: 446107-09000
Purge Date: 12-10-13
Sampling Date: 12-10-13
Samplers: Zohar Lavy of Parsons / Somerset, NJ
SAMPLE ID: MW-19
Sampling Method: Low flow purge (Monsoon Pump)

WELL PURGING

Static Water Level (TOC): 9.36
 Depth to Well Bottom (TOC): 20.10
CALCULATIONS: Ft. of Water in Well _____ X (GAL / FT) = _____ Gallons
2-inch Casing: Ft. of Water in Well _____ x 0.16 = _____ Gallons
3-inch Casing: Ft. of Water in Well _____ x 0.32 = _____ Gallons
4-inch Casing: Ft. of Water in Well _____ x 0.64 = _____ Gallons
 Method: Low Flow Pump

SAMPLE DESCRIPTION

Odor : No Odor
 Other : Clear

FIELD TESTS

	PURGE	PURGE	PURGE	PURGE	PURGE	PURGE	PURGE	SAMPLE
Time	0755	0800	0810	0815	0820	0825	0830	0835
Depth To Water (TOC) (ft)	11.71	12.43	13.09	13.31	13.46	13.61	13.68	13.79
Depth To Pump (TOC) (ft)	19.0	19.0	19.0	19.0	19.0	19.0	19.0	19.0
Flow Rate (ml/min)	~350	~350	~250	~250	~250	~300	~300	~250
Volume of Water Purged	~0.75	~1.5	~2.25	~2.75	~3.25	~3.75	~4.25	~4.75
pH (s.u.)	6.99	7.0	7.02	7.02	7.03	7.03	7.02	7.02
Conductivity (mS/cm)	5.04	5.06	5.20	5.26	5.31	5.31	5.30	5.30
Turbidity (NTUs)	293	284	386	260	121	103	68.7	47.6
Dissolved Oxygen (mg/L)	5.0	1.24	0.8	0.68	0.68	0.67	0.67	0.66
Temperature (Degrees C)	14.26	14.43	14.49	14.95	14.93	14.75	14.92	14.83
ORP (mV)	-90	-90	-100	-106	-109	-110	-110	-111
Salinity (%)	2.7	2.7	2.7	2.8	2.9	2.9	2.9	2.9
TDS (g/L)	3.17	3.19	3.28	3.3	3.3	3.3	3.3	3.3

SAMPLE ANALYSIS / LABORATORY

Analyze For: TCL VOCs, TCL SVOCs
 Shipped Via: Chemtech, Mountainside, NJ
 Laboratory: _____
 Other Notes: Sample collected at 0835; purged approximately 4.75 gallons

PARSONS

GROUNDWATER SAMPLING RECORD

SITE NAME: Con Edison (White Plains - OU-1/OU-2 Semi-Annual Sampling)
PROJECT NUMBER: 446107-09000
Purge Date: 12-10-13
Sampling Date: 12-10-13
Samplers: Zohar Lavy of Parsons / Somerset, NJ
SAMPLE ID: MW-20
Sampling Method: Low flow purge (Monsoon Pump)

WELL PURGING

Static Water Level (TOC): 15.06
 Depth to Well Bottom (TOC): 20.06
CALCULATIONS: Ft. of Water in Well _____ X (GAL / FT) = _____ Gallons
2-inch Casing: Ft. of Water in Well _____ x 0.16 = _____ Gallons
 3-inch Casing: Ft. of Water in Well _____ x 0.32 = _____ Gallons
 4-inch Casing: Ft. of Water in Well _____ x 0.64 = _____ Gallons
 Method: Low Flow Pump

SAMPLE DESCRIPTION

Odor : No Odor
 Other : Clear

FIELD TESTS

	PURGE	PURGE	PURGE	PURGE	PURGE	PURGE	PURGE	SAMPLE
Time	1400	1405	1410	1415	1420	1425	1430	1435
Depth To Water (TOC) (ft)	15.45	15.46	15.46	15.47	15.47	15.47	15.47	15.47
Depth To Pump (TOC) (ft)	19.06	19.06	19.06	19.06	19.06	19.06	19.06	19.06
Flow Rate (ml/min)	~350	~250	~250	~300	~300	~300	~300	~300
Volume of Water Purged	~0.75	~1.25	~1.75	~2.25	~2.75	~3.25	~3.75	~4.25
pH (s.u.)	6.92	6.91	6.91	6.91	6.9	6.9	6.9	6.9
Conductivity (mS/cm)	7.99	8.11	8.0	7.83	7.77	7.72	7.67	7.63
Turbidity (NTUs)	382	42.1	25.2	13.7	10.2	2.8	0	0
Dissolved Oxygen (mg/L)	4.85	0.81	0.73	0.68	0.65	0.62	0.62	0.61
Temperature (Degrees C)	15.51	15.74	15.85	15.21	15.07	14.90	14.82	14.92
ORP (mV)	-35	-53	-47	-45	-43	-42	-40	-39
Salinity (%)	4.4	4.5	4.5	4.5	4.4	4.4	4.3	4.3
TDS (g/L)	5.04	5.11	5.03	5.0	4.99	4.98	4.98	4.97

SAMPLE ANALYSIS / LABORATORY

Analyze For: TCL VOCs, TCL SVOCs
 Shipped Via: Chemtech, Mountainside, NJ
 Laboratory: _____
 Other Notes: Sample collected at 1435; purged approximately 4.25 gallons

PARSONS

GROUNDWATER SAMPLING RECORD

SITE NAME: Con Edison (White Plains - OU-1/OU-2 Semi-Annual Sampling)
PROJECT NUMBER: 446107-09000
Purge Date: 12-12-13
Sampling Date: 12-12-13
Samplers: Zohar Lavy of Parsons / Somerset, NJ
SAMPLE ID: MW-101
Sampling Method: Low flow purge (Monsoon Pump)

WELL PURGING

Static Water Level (TOC): 25.96
 Depth to Well Bottom (TOC): 61.05
CALCULATIONS: Ft. of Water in Well _____ X (GAL / FT) = _____ Gallons
2-inch Casing: Ft. of Water in Well _____ x 0.16 = _____ Gallons
3-inch Casing: Ft. of Water in Well _____ x 0.32 = _____ Gallons
4-inch Casing: Ft. of Water in Well _____ x 0.64 = _____ Gallons
 Method: Low Flow Pump

SAMPLE DESCRIPTION

Odor : Slight Hydrocarbon Odor
 Other : Clear

FIELD TESTS

	PURGE	PURGE	PURGE	PURGE	PURGE	PURGE	PURGE	SAMPLE
Time	0850	0855	0900	0905	0910	0915	0920	0925
Depth To Water (TOC) (ft)	25.98	25.97	25.97	25.97	25.97	25.97	25.97	25.97
Depth To Pump (TOC) (ft)	60.0	60.0	60.0	60.0	60.0	60.0	60.0	60.0
Flow Rate (ml/min)	~400	~350	~350	~350	~350	~350	~350	~350
Volume of Water Purged	~1	~1.75	~2.5	~3.25	~4	~4.5	~5	~5.5
pH (s.u.)	6.93	6.97	6.94	6.95	6.95	6.95	6.96	6.98
Conductivity (mS/cm)	4.25	4.29	3.87	3.87	3.88	3.87	3.87	3.86
Turbidity (NTUs)	383	289	270	231	174	92.3	67.1	43.0
Dissolved Oxygen (mg/L)	2.62	0.94	0.82	0.81	0.80	0.75	0.74	0.72
Temperature (Degrees C)	15.40	14.64	14.02	13.33	12.95	12.87	12.72	12.86
ORP (mV)	-113	-111	-111	-110	-109	-109	-108	-108
Salinity (%)	2.2	2.3	2.0	2.0	2.0	2.0	2.0	2.0
TDS (g/L)	2.72	2.75	2.74	2.59	2.49	2.49	2.48	2.48

SAMPLE ANALYSIS / LABORATORY

Analyze For: TCL VOCs, TCL SVOCs
 Shipped Via: Chemtech, Mountainside, NJ
 Laboratory: _____
 Other Notes: Sample collected at 0925; purged approximately 5.5 gallons

Attachment 2
Data Usability Summary Report

DATA USABILITY SUMMARY REPORT

WHITE PLAINS

Prepared For:



CONSOLIDATED EDISON COMPANY OF NEW YORK, INC.

**31-01 20th Avenue
Long Island City, NY 11105**

Prepared By:

PARSONS

301 Plainfield Road, Suite 350
Syracuse, New York 13212
Phone: (315) 451-9560
Fax: (315) 451-9570

FEBRUARY 2014

TABLE OF CONTENTS

	<u>Page</u>
SECTION 1 DATA USABILITY SUMMARY.....	1-1
1.1 LABORATORY DATA PACKAGES.....	1-1
1.2 SAMPLING AND CHAIN-OF-CUSTODY	1-1
1.3 LABORATORY ANALYTICAL METHODS	1-1
1.3.1 Volatile Organic Analysis.....	1-2
1.3.2 Semivolatile Organic Analysis	1-2
SECTION 2 DATA VALIDATION REPORT.....	2-1
2.1 GROUNDWATER.....	2-1
2.1.1 Volatiles.....	2-1
2.1.2 Semivolatiles	2-2

LIST OF ATTACHMENTS

ATTACHMENT A VALIDATED LABORATORY DATA

SECTION 1

DATA USABILITY SUMMARY

Groundwater samples were collected from the Consolidated Edison White Plains site on December 9, 2013 through December 12, 2013. Analytical results from these samples were validated and reviewed by Parsons for usability with respect to the following requirements:

- Work Plan,
- NYSDEC Analytical Services Protocol (ASP), and
- USEPA Region II Standard Operating Procedures (SOPs).

The analytical laboratory for this project was Chemtech. This laboratory is certified to perform project analyses by the New York State Department of Health (NYSDOH) Environmental Laboratory Approval Program (ELAP).

1.1 LABORATORY DATA PACKAGES

The laboratory data package turnaround time, defined as the time from sample receipt by the laboratory to receipt of the analytical data packages by Parsons, was 17 days for the project samples.

The data packages received from Chemtech were paginated, complete, and overall were of good quality. Comments on specific quality control (QC) and other requirements are discussed in detail in the attached data validation report which is summarized by media in Section 2.

1.2 SAMPLING AND CHAIN-OF-CUSTODY

The samples were collected, properly preserved, shipped under a chain-of-custody (COC) record, and received at Chemtech within one day of sampling. All samples were received intact and in good condition at the laboratory.

1.3 LABORATORY ANALYTICAL METHODS

The groundwater samples that were collected from the site were analyzed for volatile organic compounds (VOCs) and semivolatile organic compounds (SVOCs). Summaries of issues concerning these laboratory analyses are presented in Subsections 1.3.1 through 1.3.2. The data qualifications resulting from the data validation review and statements on the laboratory analytical precision, accuracy, representativeness, completeness, and comparability (PARCC) are discussed for each analytical method by media in Section 2. The laboratory data were reviewed and may be qualified with the following validation flags:

- "U" - not detected at the value given,
- "UJ" - estimated and not detected at the value given,
- "J" - estimated at the value given,
- "N" - presumptive evidence at the value given, and

"R" - unusable value.

The validated laboratory data were tabulated and are presented in Attachment A.

1.3.1 Volatile Organic Analysis

Groundwater samples were analyzed for VOCs using the USEPA SW-846 8260C analytical method. Certain reported results for the VOC samples were qualified as estimated based upon instrument calibrations. The reported VOC analytical results were 100% complete (i.e., usable) for the groundwater data. PARCC requirements were met.

1.3.2 Semivolatile Organic Analysis

Groundwater samples were analyzed for SVOCs using the USEPA SW-846 8270D analytical method. Certain reported results for the SVOC samples were qualified as estimated based upon instrument calibrations. The reported SVOC analytical results were 100% complete (i.e., usable) for the groundwater data. PARCC requirements were met.

SECTION 2

DATA VALIDATION REPORT

2.1 GROUNDWATER

Data review has been completed for data packages generated by Chemtech containing analytical results from groundwater samples collected from the site. All of these samples were properly preserved, shipped under a COC record, and received intact by the analytical laboratory. Analytical data were submitted in sample delivery groups (SDGs) E4747 and E4794.

Data validation was performed for all samples in accordance with the most current editions of the USEPA Region II SOPs for organic data review. This data validation and usability report is presented by analysis type. The validated laboratory data are presented in Attachment A.

2.1.1 Volatiles

The following items were reviewed for compliancy in the volatile analysis:

- Custody documentation
- Holding times
- Surrogate recoveries
- Matrix spike/matrix spike duplicate (MS/MSD) precision and accuracy
- Laboratory control sample (LCS) recoveries
- Laboratory method blank and trip/equipment blank contamination
- GC/MS instrument performance
- Initial and continuing calibrations
- Internal standard area counts and retention times
- Field duplicate precision
- Sample result verification and identification
- Quantitation limits
- Data completeness

These items were considered compliant and acceptable in accordance with the validation protocols with the exception of LCS recoveries and initial and continuing calibrations as discussed below.

LCS Recoveries

All LCS recoveries were considered acceptable and within QC limits with the exception of the high LCS recoveries for chloromethane (134%R; QC limit 40-125%R) and vinyl chloride (148%R; QC limit 50-145%R) associated with samples TB120913, FB121013, MW-17A and MW-11A; the high LCS recovery for vinyl chloride (140%R; QC limit 50-145%R) associated

with all samples in SDG E4747 except TB120913, FB121013, MW-17A and MW-11A; the high LCS recoveries for bromochloromethane (140%R, 136%R; QC limit 65-130%R) associated with sample TB121213; and the high LCS recoveries for carbon disulfide (145%R; QC limit 63-138%R), dibromochloromethane (137%R; QC limit 74-131%R), chlorobenzene (124%R; QC limit 76-123%R), bromoform (151%R; QC limit 66-130%R), and isopropylbenzene (129%R; QC limit 70-127%R) associated with all the diluted samples in SDG E4794. Validation qualification of these samples was not required since these compounds were not detected.

Initial and Continuing Calibrations

All initial calibration compounds were compliant with a minimum average relative response factor (RRF) of 0.05 and a maximum percent relative standard deviation (%RSD) of 20% with the exception of bromomethane (34.3%RSD), carbon disulfide (21.9%RSD), cyclohexane (28.8%RSD) in the initial calibration associated with all samples in SDG E4747; cyclohexane (34.9%RSD) in the initial calibration associated with sample TB121213; and chloromethane (23.8%RSD), bromomethane (33.8%RSD), and chloroethane (20.1%RSD) in the initial calibration associated with samples in SDG E4794 except TB121213. Therefore, the results for these compounds were considered estimated with positive results qualified "J" and nondetected results qualified "UJ" for the affected samples.

All continuing calibration compounds were compliant with a minimum relative response factor (RRF) of 0.05 and a maximum percent difference (%D) within $\pm 20\%$ with the exception of chloromethane (52.8%D), vinyl chloride (76.85%D), bromomethane (40.25%D), 1,2-dibromo-3-chloropropane (-25.13%D) in the continuing calibration associated with samples TB120913, FB121013, MW-17A, and MW-11A; chloromethane (42.27%D), vinyl chloride (60.74%D), bromomethane (61.41%D), trichlorofluoromethane (22%D), and 1,1,1-trichloroethane (20.87%D) in the continuing calibration associated with samples in SDG E4747 except TB120913, FB121013, MW-17A, and MW-11A; dichlorodifluoromethane (20.8%D) and acetone (-34.84%D) in the continuing calibration associated with sample TB121213; and isopropylbenzene (30.2%D), 1,2,4-trichlorobenzene (36.89%D), and 1,2,3-trichlorobenzene (38.8%D) in the continuing calibration associated with all samples in SDG E4794 except TB121213. Therefore, the sample results for these compounds were considered estimated with positive results qualified "J" and nondetected results qualified "UJ" for the affected samples.

Usability

All volatile sample results were considered usable following data validation.

Summary

The quality assurance objectives for measurement data included considerations for precision, accuracy, representativeness, completeness, and comparability. The volatile groundwater data presented by Chemtech were 100% complete (i.e., usable). The validated volatile laboratory data are tabulated and presented in Attachment A.

2.1.2 Semivolatiles

The following items were reviewed for compliancy in the semivolatile analysis:

- Custody documentation

- Holding times
- Surrogate recoveries
- MS/MSD precision and accuracy
- LCS recoveries
- Laboratory method blank and equipment blank contamination
- GC/MS instrument performance
- Initial and continuing calibrations
- Internal standard area counts and retention times
- Field duplicate precision
- Sample result verification and identification
- Quantitation limits
- Data completeness

These items were considered compliant and acceptable in accordance with the validation protocols with the exception of surrogate recoveries, MS/MSD precision and accuracy, LCS recoveries, and initial and continuing calibrations as discussed below.

Surrogate Recoveries

All sample surrogate recoveries were considered acceptable and within QC limits with the exception of the high recovery for the surrogate nitrobenzene-d5 (QC limit 36-131%R) in sample MW-11C (138%R). Validation qualification of this sample was not required since only one base-neutral surrogate exceeded the QC limit.

MS/MSD Precision and Accuracy

All precision (relative percent difference; RPD) and accuracy (percent recovery; %R) measurements were considered acceptable and within QC limits during the spiked analyses of sample MW-17 with the exception of the precision results for 4-chloroaniline (69%RPD; QC limit 0-20%RPD) and 3,3'-dichlorobenzidine (34%RPD; QC limit 0-20%RPD); and the high MS/MSD accuracy results for hexachlorocyclopentadiene (155%R/173%R; QC limit 20-153%R). Validation qualification of the parent sample was not required for these compounds.

LCS Recoveries

All LCS recoveries were considered acceptable and within QC limits with the exception of the high LCS recoveries for 2-methylphenol (98%R, 101%R; QC limit 32-94%R), 2,2-oxybis(1-chloropropane) (125%R, 128%R; QC limit 60-113%R), 3+4-methylphenols (99%R, 104%R; QC limit 24-91%R), N-nitroso-di-n-propylamine (117%R, 104%R; QC limit 61-115%R), and hexachlorocyclopentadiene (160%R, 160%R; QC limit 42-121%R) associated with all samples. Validation qualification of these samples was not required since these compounds were not detected.

Initial and Continuing Calibration

All initial calibration compounds were compliant with a minimum average relative response factor (RRF) of 0.05 and a maximum percent relative standard deviation (%RSD) of 20% with the exception of 2,4-dinitrophenol (29.7%RSD) in the initial calibration associated with all samples. Therefore, the results for this compound which were nondetects were considered estimated and qualified "UJ" for the affected samples.

All continuing calibration compounds were compliant with percent differences (%Ds) within $\pm 20\%$ and relative response factors (RRFs) greater than 0.05 with the exception of 2,2-oxybis(1-chloropropane) (28.6%D), hexachlorocyclopentadiene (27.7%D), diethylphthalate (21.3%D), butylbenzylphthalate (20.4%D), bis(2-ethylhexyl)phthalate (28.5%D), and di-n-octylphthalate (30%D) in the continuing calibration associated with samples in SDG E4747; and 2,2-oxybis(1-chloropropane) (27.8%D), N-nitroso-di-n-propylamine (35.2%D), nitrobenzene (26%D), isophorone (30.1%D), 2-nitrophenol (21.7%D), 4-chloro-3-methylphenol (22.7%D), and di-n-octylphthalate (20.4%D) in the continuing calibration associated with samples in SDG E4794. The results for these compounds which were nondetects were considered estimated and qualified "UJ" for the affected samples.

Usability

All semivolatile sample results were considered usable following data validation.

Summary

The quality assurance objectives for measurement data included considerations for precision, accuracy, representativeness, completeness, and comparability. The groundwater semivolatile data presented by Chemtech were 100% complete (i.e., usable). The validated semivolatile laboratory data are tabulated and presented in Attachment A.

ATTACHMENT A
VALIDATED LABORATORY DATA

Con Ed - White Plains Validated Groundwater Analytical Data December 2013 SDG: E4747 & E4794		Location ID: Sample ID: Lab Sample ID: Source: SDG: Matrix: Sampled: Validated:	MW-6 MW-6-20131210 E4747-09 CTECH E4747 WATER 12/10/2013 11:50 1/30/2014	MW-7 MW-7-20131210 E4747-08 CTECH E4747 WATER 12/10/2013 9:40 1/30/2014	MW-8 MW-8-20131210 E4747-12 CTECH E4747 WATER 12/10/2013 15:35 1/30/2014	MW-9 MW-9-20131212 E4794-06 CTECH E4794 WATER 12/12/2013 9:50 1/30/2014	MW-10 MW-10-20131210 E4747-10 CTECH E4747 WATER 12/10/2013 13:15 1/30/2014
CAS NO.	COMPOUND	UNITS:					
	VOLATILES						
71-55-6	1,1,1-TRICHLOROETHANE	ug/l	0.4 UJ	0.4 UJ	0.4 UJ	0.4 U	0.4 UJ
79-34-5	1,1,2,2-TETRACHLOROETHANE	ug/l	0.31 U	0.31 U	0.31 U	0.31 U	0.31 U
76-13-1	1,1,2-TRICHLORO-1,2,2-TRIFLUOROETHANE	ug/l	0.45 U	0.45 U	0.45 U	0.45 U	0.45 U
79-00-5	1,1,2-TRICHLOROETHANE	ug/l	0.38 U	0.38 U	0.38 U	0.38 U	0.38 U
75-34-3	1,1-DICHLOROETHANE	ug/l	0.36 U	0.36 U	0.36 U	0.36 U	0.36 U
75-35-4	1,1-DICHLOROETHENE	ug/l	0.47 U	0.47 U	0.47 U	0.47 U	0.47 U
87-61-6	1,2,3-TRICHLOROBENZENE	ug/l	0.2 U	0.2 U	0.2 U	0.2 UJ	0.2 U
120-82-1	1,2,4-TRICHLOROBENZENE	ug/l	0.2 U	0.2 U	0.2 U	0.2 UJ	0.2 U
96-12-8	1,2-DIBROMO-3-CHLOROPROPANE	ug/l	0.46 U	0.46 U	0.46 U	0.46 U	0.46 U
106-93-4	1,2-DIBROMOETHANE	ug/l	0.41 U	0.41 U	0.41 U	0.41 U	0.41 U
95-50-1	1,2-DICHLOROBENZENE	ug/l	0.45 U	0.45 U	0.45 U	0.45 U	0.45 U
107-06-2	1,2-DICHLOROETHANE	ug/l	0.48 U	0.48 U	0.48 U	1.5 J	0.48 U
78-87-5	1,2-DICHLOROPROPANE	ug/l	0.46 U	0.46 U	0.46 U	0.46 U	0.46 U
541-73-1	1,3-DICHLOROBENZENE	ug/l	0.43 U	0.43 U	0.43 U	0.43 U	0.43 U
106-46-7	1,4-DICHLOROBENZENE	ug/l	0.32 U	0.32 U	0.32 U	0.32 U	0.32 U
123-91-1	1,4-DIOXANE (P-DIOXANE)	ug/l	50 U	50 U	50 U	50 U	50 U
591-78-6	2-HEXANONE	ug/l	1.9 U	1.9 U	1.9 U	1.9 U	1.9 U
67-64-1	ACETONE	ug/l	0.5 U	0.5 U	0.5 U	0.5 U	0.5 U
71-43-2	BENZENE	ug/l	4.2 J	0.32 U	0.32 U	0.9 J	0.32 U
74-97-5	BROMOCHLOROMETHANE	ug/l	0.2 U	0.2 U	0.2 U	0.2 U	0.2 U
75-27-4	BROMODICHLOROMETHANE	ug/l	0.36 U	0.36 U	0.36 U	0.36 U	0.36 U
75-25-2	BROMOFORM	ug/l	0.47 U	0.47 U	0.47 U	0.47 U	0.47 U
74-83-9	BROMOMETHANE	ug/l	0.2 UJ	0.2 UJ	0.2 UJ	0.2 UJ	0.2 UJ
75-15-0	CARBON DISULFIDE	ug/l	0.2 UJ	0.2 UJ	0.2 UJ	0.2 U	0.2 UJ
56-23-5	CARBON TETRACHLORIDE	ug/l	0.2 U	0.2 U	0.2 U	0.2 U	0.2 U
108-90-7	CHLOROBENZENE	ug/l	0.49 U	0.49 U	0.49 U	0.49 U	0.49 U
75-00-3	CHLOROETHANE	ug/l	0.2 U	0.2 U	0.2 U	0.2 UJ	0.2 U
67-66-3	CHLOROFORM	ug/l	0.34 U	0.34 U	0.34 U	0.38 J	0.62 J
74-87-3	CHLOROMETHANE	ug/l	0.2 UJ	0.2 UJ	0.2 UJ	0.2 UJ	0.2 UJ
156-59-2	CIS-1,2-DICHLOROETHYLENE	ug/l	0.35 U	0.35 U	0.35 U	0.35 U	0.35 U
10061-01-5	CIS-1,3-DICHLOROPROPENE	ug/l	0.31 U	0.31 U	0.31 U	0.31 U	0.31 U
110-82-7	CYCLOHEXANE	ug/l	0.2 UJ	0.2 UJ	0.2 UJ	0.2 U	0.2 UJ
124-48-1	DIBROMOCHLOROMETHANE	ug/l	0.2 U	0.2 U	0.2 U	0.2 U	0.2 U
75-71-8	DICHLORODIFLUOROMETHANE	ug/l	0.2 U	0.2 U	0.2 U	0.2 U	0.2 U
100-41-4	ETHYLBENZENE	ug/l	3.6 J	0.2 U	2.8 J	2.5 J	0.2 U
98-82-8	ISOPROPYLBENZENE (CUMENE)	ug/l	1.7 J	0.45 U	14.1	0.59 J	0.45 U
79-20-9	METHYL ACETATE	ug/l	0.2 U	0.2 U	0.2 U	0.2 U	0.2 U
78-93-3	METHYL ETHYL KETONE (2-BUTANONE)	ug/l	1.3 U	1.3 U	1.3 U	1.3 U	1.3 U
108-10-1	METHYL ISOBUTYL KETONE	ug/l	2.1 U	2.1 U	2.1 U	2.1 U	2.1 U
108-87-2	METHYLCYCLOHEXANE	ug/l	0.2 U	0.2 U	7.3	0.2 U	0.2 U
75-09-2	METHYLENE CHLORIDE	ug/l	0.41 U	1.4 J	3 J	0.41 U	1.5 J
95-47-6	O-XYLENE (1,2-DIMETHYLBENZENE)	ug/l	1.2 J	0.43 U	2.1 J	13.4	0.43 U
100-42-5	STYRENE	ug/l	0.36 U	0.36 U	0.36 U	4 J	0.36 U
1634-04-4	TERT-BUTYL METHYL ETHER	ug/l	0.35 U	0.35 U	0.35 U	1.2 J	0.35 U
127-18-4	TETRACHLOROETHYLENE(PCE)	ug/l	0.27 U	0.27 U	0.27 U	0.27 U	0.27 U
108-88-3	TOLUENE	ug/l	0.66 J	0.37 U	0.37 U	11.2	0.37 U
156-60-5	TRANS-1,2-DICHLOROETHENE	ug/l	0.88 J	0.41 U	0.41 U	0.41 U	0.41 U
10061-02-6	TRANS-1,3-DICHLOROPROPENE	ug/l	0.29 U	0.29 U	0.29 U	0.29 U	0.29 U
79-01-6	TRICHLOROETHYLENE (TCE)	ug/l	0.28 U	0.28 U	0.28 U	0.67 J	0.28 U
75-69-4	TRICHLOROFLUOROMETHANE	ug/l	0.35 UJ	0.35 UJ	0.35 UJ	0.35 U	0.35 UJ
75-01-4	VINYL CHLORIDE	ug/l	0.34 UJ	0.34 UJ	0.34 UJ	0.34 U	0.34 UJ
XYLMP	M,P-XYLENE (SUM OF ISOMERS)	ug/l	0.95 U	0.95 U	6.2 J	8.3 J	0.95 U

Con Ed - White Plains Validated Groundwater Analytical Data December 2013 SDG: E4747 & E4794		Location ID: Sample ID: Lab Sample ID: Source: SDG: Matrix: Sampled: Validated:	MW-6 MW-6-20131210 E4747-09 CTECH E4747 WATER 12/10/2013 11:50 1/30/2014	MW-7 MW-7-20131210 E4747-08 CTECH E4747 WATER 12/10/2013 9:40 1/30/2014	MW-8 MW-8-20131210 E4747-12 CTECH E4747 WATER 12/10/2013 15:35 1/30/2014	MW-9 MW-9-20131212 E4794-06 CTECH E4794 WATER 12/12/2013 9:50 1/30/2014	MW-10 MW-10-20131210 E4747-10 CTECH E4747 WATER 12/10/2013 13:15 1/30/2014
CAS NO.	COMPOUND	UNITS:					
	SEMIVOLATILES						
95-94-3	1,2,4,5-TETRACHLOROENZENE	ug/l	0.23 U	0.21 U	0.23 U	0.24 U	0.22 U
58-90-2	2,3,4,6-TETRACHLOROPHENOL	ug/l	0.23 U	0.21 U	0.23 U	0.24 U	0.22 U
95-95-4	2,4,5-TRICHLOROPHENOL	ug/l	0.46 U	0.43 U	0.45 U	0.49 U	0.43 U
88-06-2	2,4,6-TRICHLOROPHENOL	ug/l	0.64 U	0.6 U	0.64 U	0.68 U	0.6 U
120-83-2	2,4-DICHLOROPHENOL	ug/l	0.76 U	0.7 U	0.75 U	0.8 U	0.71 U
105-67-9	2,4-DIMETHYLPHENOL	ug/l	0.82 U	0.76 U	0.81 U	0.87 U	0.76 U
51-28-5	2,4-DINITROPHENOL	ug/l	2.4 UJ	2.2 UJ	2.4 UJ	2.6 UJ	2.3 UJ
121-14-2	2,4-DINITROTOLUENE	ug/l	1.1 U	1.1 U	1.1 U	1.2 U	1.1 U
606-20-2	2,6-DINITROTOLUENE	ug/l	0.37 U	0.34 U	0.36 U	0.39 U	0.34 U
91-58-7	2-CHLORONAPHTHALENE	ug/l	0.18 U	0.17 U	0.18 U	0.2 U	0.17 U
95-57-8	2-CHLOROPHENOL	ug/l	0.62 U	0.57 U	0.61 U	0.66 U	0.58 U
91-57-6	2-METHYLNAPHTHALENE	ug/l	0.37 U	0.34 U	21	0.39 U	0.34 U
95-48-7	2-METHYLPHENOL (O-CRESOL)	ug/l	0.28 U	0.26 U	0.27 U	0.29 U	0.26 U
88-74-4	2-NITROANILINE	ug/l	0.56 U	0.52 U	0.56 U	0.6 U	0.53 U
88-75-5	2-NITROPHENOL	ug/l	0.6 U	0.55 U	0.59 U	0.63 UJ	0.56 U
91-94-1	3,3'-DICHLOROENZIDINE	ug/l	1.1 U	1.1 U	1.1 U	1.2 U	1.1 U
MEPH3MEPH	3- AND 4- METHYLPHENOL (TOTAL)	ug/l	0.44 U	0.4 U	0.43 U	0.46 U	0.41 U
99-09-2	3-NITROANILINE	ug/l	1.1 U	1.1 U	1.1 U	1.2 U	1.1 U
534-52-1	4,6-DINITRO-2-METHYLPHENOL	ug/l	0.85 U	0.79 U	0.84 U	0.9 U	0.8 U
101-55-3	4-BROMOPHENYL PHENYL ETHER	ug/l	0.26 U	0.24 U	0.26 U	0.28 U	0.25 U
59-50-7	4-CHLORO-3-METHYLPHENOL	ug/l	0.46 U	0.43 U	0.45 U	0.49 UJ	0.43 U
106-47-8	4-CHLOROANILINE	ug/l	1.1 U	1.1 U	1.1 U	1.2 U	1.1 U
7005-72-3	4-CHLOROPHENYL PHENYL ETHER	ug/l	0.24 U	0.22 U	0.24 U	0.26 U	0.23 U
100-01-6	4-NITROANILINE	ug/l	1.6 U	1.4 U	1.5 U	1.7 U	1.5 U
100-02-7	4-NITROPHENOL	ug/l	2.3 U	2.1 U	2.3 U	2.4 U	2.2 U
83-32-9	ACENAPHTHENE	ug/l	3.5 J	0.22 U	9.1 J	0.26 U	0.23 U
208-96-8	ACENAPHTHYLENE	ug/l	0.8 U	0.74 U	0.8 U	7.1 J	0.75 U
98-86-2	ACETOPHENONE	ug/l	0.16 U	0.15 U	0.16 U	0.17 U	0.15 U
120-12-7	ANTHRACENE	ug/l	0.18 U	0.17 U	0.18 U	0.2 U	0.17 U
1912-24-9	ATRAZINE	ug/l	0.46 U	0.43 U	0.45 U	0.49 U	0.43 U
100-52-7	BENZALDEHYDE	ug/l	0.89 U	0.82 U	0.88 U	0.94 U	0.83 U
56-55-3	BENZO(A)ANTHRACENE	ug/l	0.18 U	0.17 U	0.18 U	0.2 U	0.17 U
50-32-8	BENZO(A)PYRENE	ug/l	0.16 U	0.15 U	0.16 U	0.17 U	0.15 U
205-99-2	BENZO(B)FLUORANTHENE	ug/l	0.33 U	0.31 U	0.33 U	0.35 U	0.31 U
191-24-2	BENZO(G,H)PERYLENE	ug/l	0.33 U	0.31 U	0.33 U	0.35 U	0.31 U
207-08-9	BENZO(K)FLUORANTHENE	ug/l	0.21 U	0.19 U	0.2 U	0.22 U	0.19 U
85-68-7	BENZYL BUTYL PHTHALATE	ug/l	0.22 UJ	0.2 UJ	0.22 UJ	0.23 U	0.2 UJ
92-52-4	BIPHENYL (DIPHENYL)	ug/l	0.17 U	0.16 U	3.6 J	0.18 U	0.16 U
111-91-1	BIS(2-CHLOROETHOXY) METHANE	ug/l	0.63 U	0.59 U	0.63 U	0.67 U	0.59 U
111-44-4	BIS(2-CHLOROETHYL) ETHER	ug/l	0.63 U	0.59 U	0.63 U	0.67 U	0.59 U
108-60-1	BIS(2-CHLOROISOPROPYL) ETHER	ug/l	0.2 U	0.18 U	0.19 U	0.21 UJ	0.18 U
117-81-7	BIS(2-ETHYLHEXYL) PHTHALATE	ug/l	0.18 UJ	0.17 UJ	0.18 UJ	0.2 U	0.17 UJ
105-60-2	CAPROLACTAM	ug/l	1.1 U	1.1 U	1.1 U	1.2 U	1.1 U
86-74-8	CARBAZOLE	ug/l	0.25 U	0.23 U	0.25 U	0.27 U	0.24 U
218-01-9	CHRYSENE	ug/l	0.21 U	0.19 U	0.2 U	0.22 U	0.19 U
53-70-3	DIBENZ(A,H)ANTHRACENE	ug/l	0.48 U	0.45 U	0.48 U	0.51 U	0.45 U
132-64-9	DIBENZOFURAN	ug/l	0.28 U	0.26 U	0.27 U	0.29 U	0.26 U
84-66-2	DIETHYL PHTHALATE	ug/l	0.44 UJ	0.4 UJ	0.43 UJ	0.46 U	0.41 UJ
131-11-3	DIMETHYL PHTHALATE	ug/l	0.25 U	2.8 J	0.25 U	0.27 U	0.24 U
84-74-2	DI-N-BUTYL PHTHALATE	ug/l	1.1 U	1.1 U	1.1 U	1.2 U	1.1 U
117-84-0	DI-N-OCTYLPHTHALATE	ug/l	0.59 UJ	0.54 UJ	0.58 UJ	0.62 UJ	0.55 UJ
206-44-0	FLUORANTHENE	ug/l	0.46 U	0.43 U	0.45 U	0.49 U	0.43 U
86-73-7	FLUORENE	ug/l	0.36 U	0.33 U	0.35 U	0.38 U	0.33 U
118-74-1	HEXACHLOROENZENE	ug/l	0.21 U	0.19 U	0.2 U	0.22 U	0.19 U
87-68-3	HEXACHLOROBTADIENE	ug/l	0.29 U	0.27 U	0.28 U	0.3 U	0.27 U
77-47-4	HEXACHLOROCYCLOPENTADIENE	ug/l	0.28 U	0.26 U	0.27 U	0.29 U	0.26 U
67-72-1	HEXACHLOROETHANE	ug/l	0.29 U	0.27 U	0.28 U	0.3 U	0.27 U
193-39-5	INDENO(1,2,3-C,D)PYRENE	ug/l	0.17 U	0.16 U	0.17 U	0.18 U	0.16 U
78-59-1	ISOPHORONE	ug/l	0.34 U	0.32 U	0.34 U	0.37 UJ	0.32 U
91-20-3	NAPHTHALENE	ug/l	0.14 U	0.13 U	720	20.3	0.13 U
98-95-3	NITROBENZENE	ug/l	0.78 U	0.72 U	0.77 U	0.83 UJ	0.73 U
621-64-7	N-NITROSODI-N-PROPYLAMINE	ug/l	0.23 U	0.21 U	0.23 U	0.24 UJ	0.22 U
86-30-6	N-NITROSODIPHENYLAMINE	ug/l	0.69 U	0.64 U	0.68 U	0.73 U	0.65 U
87-86-5	PENTACHLOROPHENOL	ug/l	1.1 U	1.1 U	1.1 U	1.2 U	1.1 U
85-01-8	PHENANTHRENE	ug/l	0.3 U	0.28 U	0.3 U	0.32 U	0.28 U
108-95-2	PHENOL	ug/l	0.24 U	0.22 U	0.24 U	0.26 U	0.23 U
129-00-0	PYRENE	ug/l	0.23 U	0.21 U	0.23 U	0.24 U	0.22 U

Con Ed - White Plains Validated Groundwater Analytical Data December 2013 SDG: E4747 & E4794		Location ID: Sample ID: Lab Sample ID: Source: SDG: Matrix: Sampled: Validated:	MW-11A MW-11A-20131209 E4747-05 CTECH E4747 WATER 12/9/2013 15:20 1/30/2014	MW-11B MW-11B-20131209 E4747-06 CTECH E4747 WATER 12/9/2013 16:10 1/30/2014	MW-11C MW-110-20131212 E4794-10 CTECH E4794 WATER 12/12/2013 13:40 1/30/2014	MW-12A MW-12A-20131211 E4794-01 CTECH E4794 WATER 12/11/2013 12:10 1/30/2014	MW-12B MW-12B-20131211 E4794-02 CTECH E4794 WATER 12/11/2013 13:15 1/30/2014
CAS NO.	COMPOUND	UNITS:					
	VOLATILES						
71-55-6	1,1,1-TRICHLOROETHANE	ug/l	0.4 U	0.4 UJ	0.4 U	0.4 U	0.4 U
79-34-5	1,1,2,2-TETRACHLOROETHANE	ug/l	0.31 U	0.31 U	0.31 U	0.31 U	0.31 U
76-13-1	1,1,2-TRICHLORO-1,2,2-TRIFLUOROETHANE	ug/l	0.45 U	0.45 U	0.45 U	0.45 U	0.45 U
79-00-5	1,1,2-TRICHLOROETHANE	ug/l	0.38 U	0.38 U	0.38 U	0.38 U	0.38 U
75-34-3	1,1-DICHLOROETHANE	ug/l	0.36 U	0.36 U	0.36 U	0.36 U	0.36 U
75-35-4	1,1-DICHLOROETHENE	ug/l	0.47 U	0.47 U	0.47 U	0.47 U	0.47 U
87-61-6	1,2,3-TRICHLOROBENZENE	ug/l	0.2 U	0.2 U	0.2 UJ	0.2 UJ	0.2 UJ
120-82-1	1,2,4-TRICHLOROBENZENE	ug/l	0.2 U	0.2 U	0.2 UJ	0.2 UJ	0.2 UJ
96-12-8	1,2-DIBROMO-3-CHLOROPROPANE	ug/l	0.46 UJ	0.46 U	0.46 U	0.46 U	0.46 U
106-93-4	1,2-DIBROMOETHANE	ug/l	0.41 U	0.41 U	0.41 U	0.41 U	0.41 U
95-50-1	1,2-DICHLOROBENZENE	ug/l	0.45 U	0.45 U	0.45 U	0.45 U	0.45 U
107-06-2	1,2-DICHLOROETHANE	ug/l	0.48 U	0.48 U	0.48 U	0.48 U	0.48 U
78-87-5	1,2-DICHLOROPROPANE	ug/l	0.46 U	0.46 U	0.46 U	0.46 U	0.46 U
541-73-1	1,3-DICHLOROBENZENE	ug/l	0.43 U	0.43 U	0.43 U	0.43 U	0.43 U
106-46-7	1,4-DICHLOROBENZENE	ug/l	0.32 U	0.32 U	0.32 U	0.32 U	0.32 U
123-91-1	1,4-DIOXANE (P-DIOXANE)	ug/l	50 U	50 U	50 U	50 U	50 U
591-78-6	2-HEXANONE	ug/l	1.9 U	1.9 U	1.9 U	1.9 U	1.9 U
67-64-1	ACETONE	ug/l	0.5 U	0.5 U	0.5 U	0.5 U	0.5 U
71-43-2	BENZENE	ug/l	0.32 U	0.32 U	1.4 J	0.32 U	0.32 U
74-97-5	BROMOCHLOROMETHANE	ug/l	0.2 U	0.2 U	0.2 U	0.2 U	0.2 U
75-27-4	BROMODICHLOROMETHANE	ug/l	0.36 U	0.36 U	0.36 U	0.36 U	0.36 U
75-25-2	BROMOFORM	ug/l	0.47 U	0.47 U	0.47 U	0.47 U	0.47 U
74-83-9	BROMOMETHANE	ug/l	0.2 UJ	0.2 UJ	0.2 UJ	0.2 UJ	0.2 UJ
75-15-0	CARBON DISULFIDE	ug/l	0.2 UJ	0.2 UJ	0.2 U	0.2 U	0.2 U
56-23-5	CARBON TETRACHLORIDE	ug/l	0.2 U	0.2 U	0.2 U	0.2 U	0.2 U
108-90-7	CHLOROBENZENE	ug/l	0.49 U	0.49 U	0.49 U	0.49 U	0.49 U
75-00-3	CHLOROETHANE	ug/l	0.2 U	0.2 U	0.2 UJ	0.2 UJ	0.2 UJ
67-66-3	CHLOROFORM	ug/l	0.34 U	0.34 U	0.34 U	0.34 U	3.8 J
74-87-3	CHLOROMETHANE	ug/l	0.2 UJ	0.2 UJ	0.2 UJ	0.2 UJ	0.2 UJ
156-59-2	CIS-1,2-DICHLOROETHYLENE	ug/l	0.35 U	0.35 U	0.35 U	0.35 U	0.35 U
10061-01-5	CIS-1,3-DICHLOROPROPENE	ug/l	0.31 U	0.31 U	0.31 U	0.31 U	0.31 U
110-82-7	CYCLOHEXANE	ug/l	0.2 UJ	0.2 UJ	61.6	0.2 U	0.2 U
124-48-1	DIBROMOCHLOROMETHANE	ug/l	0.2 U	0.2 U	0.2 U	0.2 U	0.2 U
75-71-8	DICHLORODIFLUOROMETHANE	ug/l	0.2 U	0.2 U	0.2 U	0.2 U	0.2 U
100-41-4	ETHYLBENZENE	ug/l	0.2 U	0.2 U	220 J	0.2 U	0.2 U
98-82-8	ISOPROPYLBENZENE (CUMENE)	ug/l	0.45 U	0.45 U	21 J	0.45 UJ	0.45 UJ
79-20-9	METHYL ACETATE	ug/l	0.2 U	0.2 U	0.2 U	0.2 U	0.2 U
78-93-3	METHYL ETHYL KETONE (2-BUTANONE)	ug/l	1.3 U	1.3 U	1.3 U	1.3 U	1.3 U
108-10-1	METHYL ISOBUTYL KETONE	ug/l	2.1 U	2.1 U	2.1 U	2.1 U	2.1 U
108-87-2	METHYLCYCLOHEXANE	ug/l	0.2 U	0.2 U	99.2	0.2 U	0.2 U
75-09-2	METHYLENE CHLORIDE	ug/l	2.2 J	1.3 J	0.41 U	0.41 U	2.2 J
95-47-6	O-XYLENE (1,2-DIMETHYLBENZENE)	ug/l	0.43 U	0.43 U	910	0.43 U	0.43 U
100-42-5	STYRENE	ug/l	0.36 U	0.36 U	600	0.36 U	0.36 U
1634-04-4	TERT-BUTYL METHYL ETHER	ug/l	0.35 U	0.35 U	0.35 U	0.35 U	0.35 U
127-18-4	TETRACHLOROETHYLENE(PCE)	ug/l	0.4 J	0.27 U	12.8	0.27 U	0.56 J
108-88-3	TOLUENE	ug/l	0.37 U	0.37 U	3.7 J	0.37 U	0.37 U
156-60-5	TRANS-1,2-DICHLOROETHENE	ug/l	0.41 U	0.41 U	0.41 U	0.41 U	0.48 J
10061-02-6	TRANS-1,3-DICHLOROPROPENE	ug/l	0.29 U	0.29 U	0.29 U	0.29 U	0.29 U
79-01-6	TRICHLOROETHYLENE (TCE)	ug/l	0.28 U	0.28 U	1.1 J	0.28 U	0.28 U
75-69-4	TRICHLOROFLUOROMETHANE	ug/l	0.35 U	0.35 UJ	0.35 U	0.35 U	0.35 U
75-01-4	VINYL CHLORIDE	ug/l	0.34 UJ	0.34 UJ	0.34 U	0.34 U	0.34 U
XYLMP	M,P-XYLENE (SUM OF ISOMERS)	ug/l	0.95 U	0.95 U	2700	0.95 U	0.95 U

Con Ed - White Plains Validated Groundwater Analytical Data December 2013 SDG: E4747 & E4794		Location ID: Sample ID: Lab Sample ID: Source: SDG: Matrix: Sampled: Validated:	MW-11A MW-11A-20131209 E4747-05 CTECH E4747 WATER 12/9/2013 15:20 1/30/2014	MW-11B MW-11B-20131209 E4747-06 CTECH E4747 WATER 12/9/2013 16:10 1/30/2014	MW-11C MW-110-20131212 E4794-10 CTECH E4794 WATER 12/12/2013 13:40 1/30/2014	MW-12A MW-12A-20131211 E4794-01 CTECH E4794 WATER 12/11/2013 12:10 1/30/2014	MW-12B MW-12B-20131211 E4794-02 CTECH E4794 WATER 12/11/2013 13:15 1/30/2014
CAS NO.	COMPOUND	UNITS:					
	SEMIVOLATILES						
95-94-3	1,2,4,5-TETRACHLOROENZENE	ug/l	0.22 U	0.22 U	0.24 U	0.21 U	0.22 U
58-90-2	2,3,4,6-TETRACHLOROPHENOL	ug/l	0.22 U	0.22 U	0.24 U	0.21 U	0.22 U
95-95-4	2,4,5-TRICHLOROPHENOL	ug/l	0.43 U	0.43 U	0.48 U	0.42 U	0.44 U
88-06-2	2,4,6-TRICHLOROPHENOL	ug/l	0.61 U	0.6 U	0.67 U	0.58 U	0.62 U
120-83-2	2,4-DICHLOROPHENOL	ug/l	0.72 U	0.71 U	0.79 U	0.69 U	0.73 U
105-67-9	2,4-DIMETHYLPHENOL	ug/l	0.77 U	0.76 U	0.85 U	0.74 U	0.79 U
51-28-5	2,4-DINITROPHENOL	ug/l	2.3 UJ	2.3 UJ	2.5 UJ	2.2 UJ	2.3 UJ
121-14-2	2,4-DINITROTOLUENE	ug/l	1.1 U	1.1 U	1.2 U	1 U	1.1 U
606-20-2	2,6-DINITROTOLUENE	ug/l	0.35 U	0.34 U	0.38 U	0.33 U	0.36 U
91-58-7	2-CHLORONAPHTHALENE	ug/l	0.17 U	0.17 U	0.19 U	0.17 U	0.18 U
95-57-8	2-CHLOROPHENOL	ug/l	0.59 U	0.58 U	0.64 U	0.56 U	0.6 U
91-57-6	2-METHYLNAPHTHALENE	ug/l	0.35 U	0.34 U	0.38 U	0.33 U	0.36 U
95-48-7	2-METHYLPHENOL (O-CRESOL)	ug/l	0.26 U	0.26 U	0.29 U	0.25 U	0.27 U
88-74-4	2-NITROANILINE	ug/l	0.53 U	0.53 U	0.58 U	0.51 U	0.54 U
88-75-5	2-NITROPHENOL	ug/l	0.57 U	0.56 U	0.62 UJ	0.54 UJ	0.58 UJ
91-94-1	3,3'-DICHLOROENZIDINE	ug/l	1.1 U	1.1 U	1.2 U	1 U	1.1 U
MEPH3MEPH	3- AND 4- METHYLPHENOL (TOTAL)	ug/l	0.41 U	0.41 U	0.45 U	0.4 U	0.42 U
99-09-2	3-NITROANILINE	ug/l	1.1 U	1.1 U	1.2 U	1 U	1.1 U
534-52-1	4,6-DINITRO-2-METHYLPHENOL	ug/l	0.8 U	0.8 U	0.88 U	0.77 U	0.82 U
101-55-3	4-BROMOPHENYL PHENYL ETHER	ug/l	0.25 U	0.25 U	0.27 U	0.24 U	0.26 U
59-50-7	4-CHLORO-3-METHYLPHENOL	ug/l	0.43 U	0.43 U	0.48 UJ	0.42 UJ	0.44 UJ
106-47-8	4-CHLOROANILINE	ug/l	1.1 U	1.1 U	1.2 U	1 U	1.1 U
7005-72-3	4-CHLOROPHENYL PHENYL ETHER	ug/l	0.23 U	0.23 U	0.25 U	0.22 U	0.23 U
100-01-6	4-NITROANILINE	ug/l	1.5 U	1.5 U	1.6 U	1.4 U	1.5 U
100-02-7	4-NITROPHENOL	ug/l	2.2 U	2.2 U	2.4 U	2.1 U	2.2 U
83-32-9	ACENAPHTHENE	ug/l	0.23 U	0.23 U	14.1	0.22 U	0.23 U
208-96-8	ACENAPHTHYLENE	ug/l	0.76 U	0.75 U	66.8	0.73 U	0.78 U
98-86-2	ACETOPHENONE	ug/l	0.15 U	0.15 U	0.17 U	0.15 U	0.16 U
120-12-7	ANTHRACENE	ug/l	0.17 U	0.17 U	3.5 J	0.17 U	0.18 U
1912-24-9	ATRAZINE	ug/l	0.43 U	0.43 U	0.48 U	0.42 U	0.44 U
100-52-7	BENZALDEHYDE	ug/l	0.84 U	0.83 U	0.92 U	0.8 U	0.86 U
56-55-3	BENZO(A)ANTHRACENE	ug/l	0.17 U	0.17 U	0.19 U	0.17 U	0.18 U
50-32-8	BENZO(A)PYRENE	ug/l	0.15 U	0.15 U	0.17 U	0.15 U	0.16 U
205-99-2	BENZO(B)FLUORANTHENE	ug/l	0.32 U	0.31 U	0.35 U	0.3 U	0.32 U
191-24-2	BENZO(G,H)PERYLENE	ug/l	0.32 U	0.31 U	0.35 U	0.3 U	0.32 U
207-08-9	BENZO(K)FLUORANTHENE	ug/l	0.2 U	0.19 U	0.21 U	0.19 U	0.2 U
85-68-7	BENZYL BUTYL PHTHALATE	ug/l	0.21 UJ	0.2 UJ	0.23 U	0.2 U	0.21 U
92-52-4	BIPHENYL (DIPHENYL)	ug/l	0.16 U	0.16 U	48.9	0.16 U	0.17 U
111-91-1	BIS(2-CHLOROETHOXY) METHANE	ug/l	0.6 U	0.59 U	0.65 U	0.57 U	0.61 U
111-44-4	BIS(2-CHLOROETHYL) ETHER	ug/l	0.6 U	0.59 U	0.65 U	0.57 U	0.61 U
108-60-1	BIS(2-CHLOROISOPROPYL) ETHER	ug/l	0.18 U	0.18 U	0.2 UJ	0.18 UJ	0.19 UJ
117-81-7	BIS(2-ETHYLHEXYL) PHTHALATE	ug/l	0.17 UJ	0.17 UJ	0.19 U	0.17 U	0.18 U
105-60-2	CAPROLACTAM	ug/l	1.1 U	1.1 U	1.2 U	1 U	1.1 U
86-74-8	CARBAZOLE	ug/l	0.24 U	0.24 U	6.8 J	0.23 U	0.24 U
218-01-9	CHRYSENE	ug/l	0.2 U	0.19 U	0.21 U	0.19 U	0.2 U
53-70-3	DIBENZ(A,H)ANTHRACENE	ug/l	0.46 U	0.45 U	0.5 U	0.44 U	0.47 U
132-64-9	DIBENZOFURAN	ug/l	0.26 U	0.26 U	2.8 J	0.25 U	0.27 U
84-66-2	DIETHYL PHTHALATE	ug/l	0.41 UJ	0.41 UJ	0.45 U	0.4 U	0.42 U
131-11-3	DIMETHYL PHTHALATE	ug/l	0.24 U	0.24 U	0.26 U	2.6 J	0.24 U
84-74-2	DI-N-BUTYL PHTHALATE	ug/l	1.1 U	1.1 U	1.2 U	1 U	1.1 U
117-84-0	DI-N-OCTYLPHTHALATE	ug/l	0.55 UJ	0.55 UJ	0.61 UJ	0.53 UJ	0.57 UJ
206-44-0	FLUORANTHENE	ug/l	0.43 U	0.43 U	0.48 U	0.42 U	0.44 U
86-73-7	FLUORENE	ug/l	0.34 U	0.33 U	36.6	0.32 U	0.34 U
118-74-1	HEXACHLOROENZENE	ug/l	0.2 U	0.19 U	0.21 U	0.19 U	0.2 U
87-68-3	HEXACHLOROBTADIENE	ug/l	0.27 U	0.27 U	0.3 U	0.26 U	0.28 U
77-47-4	HEXACHLOROCYCLOPENTADIENE	ug/l	0.26 U	0.26 U	0.29 U	0.25 U	0.27 U
67-72-1	HEXACHLOROETHANE	ug/l	0.27 U	0.27 U	0.3 U	0.26 U	0.28 U
193-39-5	INDENO(1,2,3-C,D)PYRENE	ug/l	0.16 U	0.16 U	0.18 U	0.16 U	0.17 U
78-59-1	ISOPHORONE	ug/l	0.33 U	0.32 U	0.36 UJ	0.31 UJ	0.33 UJ
91-20-3	NAPHTHALENE	ug/l	0.13 U	0.13 U	11900	0.13 U	0.13 U
98-95-3	NITROBENZENE	ug/l	0.74 U	0.73 U	0.81 UJ	0.71 UJ	0.76 UJ
621-64-7	N-NITROSODI-N-PROPYLAMINE	ug/l	0.22 U	0.22 U	0.24 UJ	0.21 UJ	0.22 UJ
86-30-6	N-NITROSODIPHENYLAMINE	ug/l	0.65 U	0.65 U	0.71 U	0.63 U	0.67 U
87-86-5	PENTACHLOROPHENOL	ug/l	1.1 U	1.1 U	1.2 U	1 U	1.1 U
85-01-8	PHENANTHRENE	ug/l	0.28 U	0.28 U	29.5	0.27 U	0.29 U
108-95-2	PHENOL	ug/l	0.23 U	0.23 U	0.25 U	0.22 U	0.23 U
129-00-0	PYRENE	ug/l	0.22 U	0.22 U	0.24 U	0.21 U	0.22 U

Con Ed - White Plains Validated Groundwater Analytical Data December 2013 SDG: E4747 & E4794		Location ID: Sample ID: Lab Sample ID: Source: SDG: Matrix: Sampled: Validated:	MW-13 MW-13-20131211 E4794-03 CTECH E4794 WATER 12/11/2013 14:30 1/30/2014	MW-14 MW-14-20131212 E4794-07 CTECH E4794 WATER 12/12/2013 11:45 1/30/2014	MW-15 MW-15-20131212 E4794-09 CTECH E4794 WATER 12/12/2013 13:25 1/30/2014	MW-16 MW-16-20131212 E4794-08 CTECH E4794 WATER 12/12/2013 11:10 1/30/2014	MW-17 MW-17-20131209 E4747-01 CTECH E4747 WATER 12/9/2013 12:45 1/30/2014
CAS NO.	COMPOUND	UNITS:					
	VOLATILES						
71-55-6	1,1,1-TRICHLOROETHANE	ug/l	0.4 U	0.4 U	0.4 U	0.4 U	0.4 UJ
79-34-5	1,1,2,2-TETRACHLOROETHANE	ug/l	0.31 U	0.31 U	0.31 U	0.31 U	0.31 U
76-13-1	1,1,2-TRICHLORO-1,2,2-TRIFLUOROETHANE	ug/l	0.45 U	0.45 U	0.45 U	0.45 U	0.45 U
79-00-5	1,1,2-TRICHLOROETHANE	ug/l	0.38 U	0.38 U	0.38 U	0.38 U	0.38 U
75-34-3	1,1-DICHLOROETHANE	ug/l	0.36 U	0.36 U	0.36 U	0.36 U	0.36 U
75-35-4	1,1-DICHLOROETHENE	ug/l	0.47 U	0.47 U	0.47 U	0.47 U	0.47 U
87-61-6	1,2,3-TRICHLOROBENZENE	ug/l	0.2 UJ	0.2 UJ	0.2 UJ	0.2 UJ	0.2 U
120-82-1	1,2,4-TRICHLOROBENZENE	ug/l	0.2 UJ	0.2 UJ	0.2 UJ	0.2 UJ	0.2 U
96-12-8	1,2-DIBROMO-3-CHLOROPROPANE	ug/l	0.46 U	0.46 U	0.46 U	0.46 U	0.46 U
106-93-4	1,2-DIBROMOETHANE	ug/l	0.41 U	0.41 U	0.41 U	0.41 U	0.41 U
95-50-1	1,2-DICHLOROBENZENE	ug/l	0.45 U	0.45 U	0.45 U	0.45 U	0.45 U
107-06-2	1,2-DICHLOROETHANE	ug/l	4.6 J	0.48 U	7.9	0.48 U	0.48 U
78-87-5	1,2-DICHLOROPROPANE	ug/l	0.46 U	0.46 U	0.46 U	0.46 U	0.46 U
541-73-1	1,3-DICHLOROBENZENE	ug/l	0.43 U	0.43 U	0.43 U	0.43 U	0.43 U
106-46-7	1,4-DICHLOROBENZENE	ug/l	0.32 U	0.32 U	0.32 U	0.32 U	0.32 U
123-91-1	1,4-DIOXANE (P-DIOXANE)	ug/l	50 U	50 U	50 U	50 U	50 U
591-78-6	2-HEXANONE	ug/l	1.9 U	1.9 U	1.9 U	1.9 U	1.9 U
67-64-1	ACETONE	ug/l	0.5 U	0.5 U	0.5 U	0.5 U	0.5 U
71-43-2	BENZENE	ug/l	0.32 U	12.3	1.2 J	180 J	0.32 U
74-97-5	BROMOCHLOROMETHANE	ug/l	0.2 U	0.2 U	0.2 U	0.2 U	0.2 U
75-27-4	BROMODICHLOROMETHANE	ug/l	0.36 U	0.36 U	0.36 U	0.36 U	0.36 U
75-25-2	BROMOFORM	ug/l	0.47 U	0.47 U	0.47 U	0.47 U	0.47 U
74-83-9	BROMOMETHANE	ug/l	0.2 UJ	0.2 UJ	0.2 UJ	0.2 UJ	0.2 UJ
75-15-0	CARBON DISULFIDE	ug/l	0.2 U	0.2 U	0.2 U	0.2 U	0.2 UJ
56-23-5	CARBON TETRACHLORIDE	ug/l	0.2 U	0.2 U	0.2 U	0.2 U	0.2 U
108-90-7	CHLOROBENZENE	ug/l	0.49 U	0.49 U	0.49 U	0.49 U	0.49 U
75-00-3	CHLOROETHANE	ug/l	0.2 UJ	0.2 UJ	0.2 UJ	0.2 UJ	0.2 U
67-66-3	CHLOROFORM	ug/l	0.34 U	0.34 U	0.34 U	0.72 J	0.34 U
74-87-3	CHLOROMETHANE	ug/l	0.2 UJ	0.2 UJ	0.2 UJ	0.2 UJ	0.2 UJ
156-59-2	CIS-1,2-DICHLOROETHYLENE	ug/l	0.35 U	0.35 U	0.35 U	0.35 U	0.35 U
10061-01-5	CIS-1,3-DICHLOROPROPENE	ug/l	0.31 U	0.31 U	0.31 U	0.31 U	0.31 U
110-82-7	CYCLOHEXANE	ug/l	0.2 U	30.3	0.2 U	27.4	0.2 UJ
124-48-1	DIBROMOCHLOROMETHANE	ug/l	0.2 U	0.2 U	0.2 U	0.2 U	0.2 U
75-71-8	DICHLORODIFLUOROMETHANE	ug/l	0.2 U	0.2 U	0.2 U	0.2 U	0.2 U
100-41-4	ETHYLBENZENE	ug/l	0.2 U	240 J	10	190 J	0.2 U
98-82-8	ISOPROPYLBENZENE (CUMENE)	ug/l	0.45 UJ	6.9 J	0.57 J	11.7 J	0.45 U
79-20-9	METHYL ACETATE	ug/l	0.2 U	0.2 U	0.2 U	0.2 U	0.2 U
78-93-3	METHYL ETHYL KETONE (2-BUTANONE)	ug/l	1.3 U	1.3 U	1.3 U	1.3 U	1.3 U
108-10-1	METHYL ISOBUTYL KETONE	ug/l	2.1 U	2.1 U	2.1 U	2.1 U	2.1 U
108-87-2	METHYLCYCLOHEXANE	ug/l	0.2 U	46.5	1.2 J	44.2	0.2 U
75-09-2	METHYLENE CHLORIDE	ug/l	2.3 J	0.41 U	2.3 J	0.41 U	1.4 J
95-47-6	O-XYLENE (1,2-DIMETHYLBENZENE)	ug/l	0.43 U	660	16.9	660	0.43 U
100-42-5	STYRENE	ug/l	0.36 U	2200	29.8	850	0.36 U
1634-04-4	TERT-BUTYL METHYL ETHER	ug/l	520	13.9	190	0.35 U	0.35 U
127-18-4	TETRACHLOROETHYLENE(PCE)	ug/l	0.27 U	0.58 J	0.27 U	3.1 J	0.27 U
108-88-3	TOLUENE	ug/l	0.37 U	1900	40.5	1500	0.37 U
156-60-5	TRANS-1,2-DICHLOROETHENE	ug/l	0.91 J	0.52 J	0.41 U	0.41 U	0.41 U
10061-02-6	TRANS-1,3-DICHLOROPROPENE	ug/l	0.29 U	0.29 U	0.29 U	0.29 U	0.29 U
79-01-6	TRICHLOROETHYLENE (TCE)	ug/l	0.28 U	0.28 U	0.28 U	1.6 J	0.28 U
75-69-4	TRICHLOROFLUOROMETHANE	ug/l	0.35 U	0.35 U	0.35 U	0.35 U	0.35 UJ
75-01-4	VINYL CHLORIDE	ug/l	0.34 U	0.34 U	0.34 U	0.34 U	0.34 UJ
XYLMP	M,P-XYLENE (SUM OF ISOMERS)	ug/l	0.95 U	1700	31.9	1000	0.95 U

Con Ed - White Plains Validated Groundwater Analytical Data December 2013 SDG: E4747 & E4794		Location ID: Sample ID: Lab Sample ID: Source: SDG: Matrix: Sampled: Validated:	MW-13 MW-13-20131211 E4794-03 CTECH E4794 WATER 12/11/2013 14:30 1/30/2014	MW-14 MW-14-20131212 E4794-07 CTECH E4794 WATER 12/12/2013 11:45 1/30/2014	MW-15 MW-15-20131212 E4794-09 CTECH E4794 WATER 12/12/2013 13:25 1/30/2014	MW-16 MW-16-20131212 E4794-08 CTECH E4794 WATER 12/12/2013 11:10 1/30/2014	MW-17 MW-17-20131209 E4747-01 CTECH E4747 WATER 12/9/2013 12:45 1/30/2014
CAS NO.	COMPOUND	UNITS:					
	SEMIVOLATILES						
95-94-3	1,2,4,5-TETRACHLORO BENZENE	ug/l	0.22 U	0.24 U	0.24 U	0.25 U	0.22 U
58-90-2	2,3,4,6-TETRACHLOROPHENOL	ug/l	0.22 U	0.24 U	0.24 U	0.25 U	0.22 U
95-95-4	2,4,5-TRICHLOROPHENOL	ug/l	0.43 U	0.48 U	0.49 U	0.5 U	0.43 U
88-06-2	2,4,6-TRICHLOROPHENOL	ug/l	0.61 U	0.67 U	0.68 U	0.7 U	0.6 U
120-83-2	2,4-DICHLOROPHENOL	ug/l	0.72 U	0.79 U	0.8 U	0.83 U	0.71 U
105-67-9	2,4-DIMETHYLPHENOL	ug/l	0.77 U	0.85 U	0.87 U	0.89 U	0.76 U
51-28-5	2,4-DINITROPHENOL	ug/l	2.3 UJ	2.5 UJ	2.6 UJ	2.6 UJ	2.3 UJ
121-14-2	2,4-DINITROTOLUENE	ug/l	1.1 U	1.2 U	1.2 U	1.3 U	1.1 U
606-20-2	2,6-DINITROTOLUENE	ug/l	0.35 U	0.38 U	0.39 U	0.4 U	0.34 U
91-58-7	2-CHLORONAPHTHALENE	ug/l	0.17 U	0.19 U	0.2 U	0.2 U	0.17 U
95-57-8	2-CHLOROPHENOL	ug/l	0.59 U	0.64 U	0.66 U	0.68 U	0.58 U
91-57-6	2-METHYLNAPHTHALENE	ug/l	0.35 U	430	0.39 U	310	0.34 U
95-48-7	2-METHYLPHENOL (O-CRESOL)	ug/l	0.26 U	0.29 U	0.29 U	0.3 U	0.26 U
88-74-4	2-NITROANILINE	ug/l	0.53 U	0.58 U	0.6 U	0.61 U	0.53 U
88-75-5	2-NITROPHENOL	ug/l	0.57 UJ	0.62 UJ	0.63 UJ	0.65 UJ	0.56 U
91-94-1	3,3'-DICHLORO BENZIDINE	ug/l	1.1 U	1.2 U	1.2 U	1.3 U	1.1 U
MEPH3MEPH	3- AND 4- METHYLPHENOL (TOTAL)	ug/l	0.41 U	0.45 U	0.46 U	0.48 U	0.41 U
99-09-2	3-NITROANILINE	ug/l	1.1 U	1.2 U	1.2 U	1.3 U	1.1 U
534-52-1	4,6-DINITRO-2-METHYLPHENOL	ug/l	0.8 U	0.88 U	0.9 U	0.93 U	0.8 U
101-55-3	4-BROMOPHENYL PHENYL ETHER	ug/l	0.25 U	0.27 U	0.28 U	0.29 U	0.25 U
59-50-7	4-CHLORO-3-METHYLPHENOL	ug/l	0.43 UJ	0.48 UJ	0.49 UJ	0.5 UJ	0.43 U
106-47-8	4-CHLOROANILINE	ug/l	1.1 U	1.2 U	1.2 U	1.3 U	1.1 U
7005-72-3	4-CHLOROPHENYL PHENYL ETHER	ug/l	0.23 U	0.25 U	0.26 U	0.26 U	0.23 U
100-01-6	4-NITROANILINE	ug/l	1.5 U	1.6 U	1.7 U	1.7 U	1.5 U
100-02-7	4-NITROPHENOL	ug/l	2.2 U	2.4 U	2.4 U	2.5 U	2.2 U
83-32-9	ACENAPHTHENE	ug/l	0.23 U	11.9	0.26 U	13.1	0.23 U
208-96-8	ACENAPHTHYLENE	ug/l	0.76 U	260	4.2 J	90.7	0.75 U
98-86-2	ACETOPHENONE	ug/l	0.15 U	0.17 U	0.17 U	0.18 U	0.15 U
120-12-7	ANTHRACENE	ug/l	0.17 U	4 J	0.2 U	3.3 J	0.17 U
1912-24-9	ATRAZINE	ug/l	0.43 U	0.48 U	0.49 U	0.5 U	0.43 U
100-52-7	BENZALDEHYDE	ug/l	0.84 U	0.92 U	0.94 U	0.96 U	0.83 U
56-55-3	BENZO(A)ANTHRACENE	ug/l	0.17 U	0.19 U	0.2 U	0.2 U	0.17 U
50-32-8	BENZO(A)PYRENE	ug/l	0.15 U	0.17 U	0.17 U	0.18 U	0.15 U
205-99-2	BENZO(B)FLUORANTHENE	ug/l	0.32 U	0.35 U	0.35 U	0.36 U	0.31 U
191-24-2	BENZO(G,H)PERYLENE	ug/l	0.32 U	0.35 U	0.35 U	0.36 U	0.31 U
207-08-9	BENZO(K)FLUORANTHENE	ug/l	0.2 U	0.21 U	0.22 U	0.23 U	0.19 U
85-68-7	BENZYL BUTYL PHTHALATE	ug/l	0.21 U	0.23 U	0.23 U	0.24 U	0.2 UJ
92-52-4	BIPHENYL (DIPHENYL)	ug/l	0.16 U	37.7	0.18 U	42.3	0.16 U
111-91-1	BIS(2-CHLOROETHOXY) METHANE	ug/l	0.6 U	0.65 U	0.67 U	0.69 U	0.59 U
111-44-4	BIS(2-CHLOROETHYL) ETHER	ug/l	0.6 U	0.65 U	0.67 U	0.69 U	0.59 U
108-60-1	BIS(2-CHLOROISOPROPYL) ETHER	ug/l	0.18 UJ	0.2 UJ	0.21 UJ	0.21 UJ	0.18 U
117-81-7	BIS(2-ETHYLHEXYL) PHTHALATE	ug/l	0.17 U	0.19 U	0.2 U	0.2 U	0.17 UJ
105-60-2	CAPROLACTAM	ug/l	1.1 U	1.2 U	1.2 U	1.3 U	1.1 U
86-74-8	CARBAZOLE	ug/l	0.24 U	2.9 J	0.27 U	3.9 J	0.24 U
218-01-9	CHRYSENE	ug/l	0.2 U	0.21 U	0.22 U	0.23 U	0.19 U
53-70-3	DIBENZ(A,H)ANTHRACENE	ug/l	0.46 U	0.5 U	0.51 U	0.53 U	0.45 U
132-64-9	DIBENZOFURAN	ug/l	0.26 U	0.29 U	0.29 U	0.3 U	0.26 U
84-66-2	DIETHYL PHTHALATE	ug/l	0.41 U	0.45 U	0.46 U	0.48 U	0.41 UJ
131-11-3	DIMETHYL PHTHALATE	ug/l	0.24 U	0.26 U	0.27 U	2.9 J	0.24 U
84-74-2	DI-N-BUTYL PHTHALATE	ug/l	1.1 U	1.2 U	1.2 U	1.3 U	1.1 U
117-84-0	DI-N-OCTYLPHTHALATE	ug/l	0.55 UJ	0.61 UJ	0.62 UJ	0.64 UJ	0.55 UJ
206-44-0	FLUORANTHENE	ug/l	0.43 U	0.48 U	0.49 U	0.5 U	0.43 U
86-73-7	FLUORENE	ug/l	0.34 U	26.5	0.38 U	3.6 J	0.33 U
118-74-1	HEXACHLORO BENZENE	ug/l	0.2 U	0.21 U	0.22 U	0.23 U	0.19 U
87-68-3	HEXACHLOROBUTADIENE	ug/l	0.27 U	0.3 U	0.3 U	0.31 U	0.27 U
77-47-4	HEXACHLOROCYCLOPENTADIENE	ug/l	0.26 U	0.29 U	0.29 U	0.3 U	0.26 U
67-72-1	HEXACHLOROETHANE	ug/l	0.27 U	0.3 U	0.3 U	0.31 U	0.27 U
193-39-5	INDENO(1,2,3-C,D)PYRENE	ug/l	0.16 U	0.18 U	0.18 U	0.19 U	0.16 U
78-59-1	ISOPHORONE	ug/l	0.33 UJ	0.36 UJ	0.37 UJ	0.38 UJ	0.32 U
91-20-3	NAPHTHALENE	ug/l	0.13 U	6200	110	8400	0.13 U
98-95-3	NITROBENZENE	ug/l	0.74 UJ	0.81 UJ	0.83 UJ	0.85 UJ	0.73 U
621-64-7	N-NITROSODI-N-PROPYLAMINE	ug/l	0.22 UJ	0.24 UJ	0.24 UJ	0.25 UJ	0.22 U
86-30-6	N-NITROSODIPHENYLAMINE	ug/l	0.65 U	0.71 U	0.73 U	0.75 U	0.65 U
87-86-5	PENTACHLOROPHENOL	ug/l	1.1 U	1.2 U	1.2 U	1.3 U	1.1 U
85-01-8	PHENANTHRENE	ug/l	0.28 U	31	0.32 U	31.4	0.28 U
108-95-2	PHENOL	ug/l	0.23 U	0.25 U	0.26 U	0.26 U	0.23 U
129-00-0	PYRENE	ug/l	0.22 U	0.24 U	0.24 U	0.25 U	0.22 U

Con Ed - White Plains Validated Groundwater Analytical Data December 2013 SDG: E4747 & E4794		Location ID: Sample ID: Lab Sample ID: Source: SDG: Matrix: Sampled: Validated:	Dup of MW-17-20131209 MW-17 MW-17A-20131209 E4747-04 CTECH E4747 WATER 12/9/2013 12:55 1/30/2014	MW-18 MW-18-20131211 E4794-04 CTECH E4794 WATER 12/11/2013 17:00 1/30/2014	MW-19 MW-19-20131210 E4747-07 CTECH E4747 WATER 12/10/2013 8:35 1/30/2014	MW-20 MW-20-20131210 E4747-11 CTECH E4747 WATER 12/10/2013 14:35 1/30/2014	MW-101 MW-101-20131212 E4794-05 CTECH E4794 WATER 12/12/2013 9:25 1/30/2014
CAS NO.	COMPOUND	UNITS:					
	VOLATILES						
71-55-6	1,1,1-TRICHLOROETHANE	ug/l	0.4 U	0.4 U	0.4 UJ	0.4 UJ	0.4 U
79-34-5	1,1,2,2-TETRACHLOROETHANE	ug/l	0.31 U	0.31 U	0.31 U	0.31 U	0.31 U
76-13-1	1,1,2-TRICHLORO-1,2,2-TRIFLUOROETHANE	ug/l	0.45 U	0.45 U	0.45 U	0.45 U	0.45 U
79-00-5	1,1,2-TRICHLOROETHANE	ug/l	0.38 U	0.38 U	0.38 U	0.38 U	0.38 U
75-34-3	1,1-DICHLOROETHANE	ug/l	0.36 U	0.36 U	0.36 U	0.36 U	0.36 U
75-35-4	1,1-DICHLOROETHENE	ug/l	0.47 U	0.47 U	0.47 U	0.47 U	0.47 U
87-61-6	1,2,3-TRICHLOROBENZENE	ug/l	0.2 U	0.2 UJ	0.2 U	0.2 U	0.2 UJ
120-82-1	1,2,4-TRICHLOROBENZENE	ug/l	0.2 U	0.2 UJ	0.2 U	0.2 U	0.2 UJ
96-12-8	1,2-DIBROMO-3-CHLOROPROPANE	ug/l	0.46 UJ	0.46 U	0.46 U	0.46 U	0.46 U
106-93-4	1,2-DIBROMOETHANE	ug/l	0.41 U	0.41 U	0.41 U	0.41 U	0.41 U
95-50-1	1,2-DICHLOROBENZENE	ug/l	0.45 U	0.45 U	0.45 U	0.45 U	0.45 U
107-06-2	1,2-DICHLOROETHANE	ug/l	0.48 U	0.96 J	0.48 U	0.48 U	0.48 U
78-87-5	1,2-DICHLOROPROPANE	ug/l	0.46 U	0.46 U	0.46 U	0.46 U	0.46 U
541-73-1	1,3-DICHLOROBENZENE	ug/l	0.43 U	0.43 U	0.43 U	0.43 U	0.43 U
106-46-7	1,4-DICHLOROBENZENE	ug/l	0.32 U	0.32 U	0.32 U	0.32 U	0.32 U
123-91-1	1,4-DIOXANE (P-DIOXANE)	ug/l	50 U	50 U	50 U	50 U	50 U
591-78-6	2-HEXANONE	ug/l	1.9 U	1.9 U	1.9 U	1.9 U	1.9 U
67-64-1	ACETONE	ug/l	0.5 U	0.5 U	0.5 U	0.5 U	0.5 U
71-43-2	BENZENE	ug/l	0.32 U	35.9	0.32 U	0.32 U	130
74-97-5	BROMOCHLOROMETHANE	ug/l	0.2 U	0.2 U	0.2 U	0.2 U	0.2 U
75-27-4	BROMODICHLOROMETHANE	ug/l	0.36 U	0.36 U	0.36 U	0.36 U	0.36 U
75-25-2	BROMOFORM	ug/l	0.47 U	0.47 U	0.47 U	0.47 U	0.47 U
74-83-9	BROMOMETHANE	ug/l	0.2 UJ	0.2 UJ	0.2 UJ	0.2 UJ	0.2 UJ
75-15-0	CARBON DISULFIDE	ug/l	0.2 UJ	0.2 U	0.2 UJ	0.2 UJ	0.77 J
56-23-5	CARBON TETRACHLORIDE	ug/l	0.2 U	0.2 U	0.2 U	0.2 U	0.2 U
108-90-7	CHLOROBENZENE	ug/l	0.49 U	0.49 U	0.49 U	0.49 U	0.49 U
75-00-3	CHLOROETHANE	ug/l	0.2 U	0.2 UJ	0.2 U	0.2 U	0.2 UJ
67-66-3	CHLOROFORM	ug/l	0.34 U	0.66 J	0.34 U	0.34 U	0.34 U
74-87-3	CHLOROMETHANE	ug/l	0.2 UJ	0.2 UJ	0.2 UJ	0.2 UJ	0.2 UJ
156-59-2	CIS-1,2-DICHLOROETHYLENE	ug/l	0.35 U	0.36 J	0.35 U	0.35 U	0.35 U
10061-01-5	CIS-1,3-DICHLOROPROPENE	ug/l	0.31 U	0.31 U	0.31 U	0.31 U	0.31 U
110-82-7	CYCLOHEXANE	ug/l	0.2 UJ	0.7 J	0.2 UJ	0.2 UJ	3.6 J
124-48-1	DIBROMOCHLOROMETHANE	ug/l	0.2 U	0.2 U	0.2 U	0.2 U	0.2 U
75-71-8	DICHLORODIFLUOROMETHANE	ug/l	0.2 U	0.2 U	0.2 U	0.2 U	0.2 U
100-41-4	ETHYLBENZENE	ug/l	0.2 U	2.3 J	0.2 U	0.2 U	4 J
98-82-8	ISOPROPYLBENZENE (CUMENE)	ug/l	0.45 U	2.7 J	0.45 U	0.45 U	3.3 J
79-20-9	METHYL ACETATE	ug/l	0.2 U	0.2 U	0.2 U	0.2 U	0.2 U
78-93-3	METHYL ETHYL KETONE (2-BUTANONE)	ug/l	1.3 U	1.3 U	1.3 U	1.3 U	1.3 U
108-10-1	METHYL ISOBUTYL KETONE	ug/l	2.1 U	2.1 U	2.1 U	2.1 U	2.1 U
108-87-2	METHYLCYCLOHEXANE	ug/l	0.2 U	1.6 J	0.2 U	0.2 U	2.4 J
75-09-2	METHYLENE CHLORIDE	ug/l	1.5 J	1.7 J	1.2 J	1.4 J	1.7 J
95-47-6	O-XYLENE (1,2-DIMETHYLBENZENE)	ug/l	0.43 U	57.8	0.43 U	0.43 U	10.1
100-42-5	STYRENE	ug/l	0.36 U	0.36 U	0.36 U	0.36 U	0.36 U
1634-04-4	TERT-BUTYL METHYL ETHER	ug/l	0.35 U	6.5	0.35 U	0.35 U	0.35 U
127-18-4	TETRACHLOROETHYLENE(PCE)	ug/l	0.27 U	1.2 J	0.27 U	0.27 U	0.27 U
108-88-3	TOLUENE	ug/l	0.37 U	11.6	0.37 U	0.37 U	1 J
156-60-5	TRANS-1,2-DICHLOROETHENE	ug/l	0.41 U	0.41 U	0.41 U	0.41 U	0.74 J
10061-02-6	TRANS-1,3-DICHLOROPROPENE	ug/l	0.29 U	0.29 U	0.29 U	0.29 U	0.29 U
79-01-6	TRICHLOROETHYLENE (TCE)	ug/l	0.28 U	1.1 J	0.28 U	0.28 U	0.28 U
75-69-4	TRICHLOROFLUOROMETHANE	ug/l	0.35 U	0.35 U	0.35 UJ	0.35 UJ	0.35 U
75-01-4	VINYL CHLORIDE	ug/l	0.34 UJ	0.34 U	0.34 UJ	0.34 UJ	0.34 U
XYLMP	M,P-XYLENE (SUM OF ISOMERS)	ug/l	0.95 U	18.3	0.95 U	0.95 U	2 J

Con Ed - White Plains Validated Groundwater Analytical Data December 2013 SDG: E4747 & E4794		Location ID: Sample ID: Lab Sample ID: Source: SDG: Matrix: Sampled: Validated:	Dup of MW-17-20131209 MW-17 MW-17A-20131209 E4747-04 CTECH E4747 WATER 12/9/2013 12:55 1/30/2014	MW-18 MW-18-20131211 E4794-04 CTECH E4794 WATER 12/11/2013 17:00 1/30/2014	MW-19 MW-19-20131210 E4747-07 CTECH E4747 WATER 12/10/2013 8:35 1/30/2014	MW-20 MW-20-20131210 E4747-11 CTECH E4747 WATER 12/10/2013 14:35 1/30/2014	MW-101 MW-101-20131212 E4794-05 CTECH E4794 WATER 12/12/2013 9:25 1/30/2014
CAS NO.	COMPOUND	UNITS:					
	SEMIVOLATILES						
95-94-3	1,2,4,5-TETRACHLOROENZENE	ug/l	0.22 U	0.22 U	0.22 U	0.22 U	0.23 U
58-90-2	2,3,4,6-TETRACHLOROPHENOL	ug/l	0.22 U	0.22 U	0.22 U	0.22 U	0.23 U
95-95-4	2,4,5-TRICHLOROPHENOL	ug/l	0.43 U	0.44 U	0.45 U	0.43 U	0.45 U
88-06-2	2,4,6-TRICHLOROPHENOL	ug/l	0.61 U	0.62 U	0.63 U	0.61 U	0.64 U
120-83-2	2,4-DICHLOROPHENOL	ug/l	0.72 U	0.73 U	0.74 U	0.72 U	0.75 U
105-67-9	2,4-DIMETHYLPHENOL	ug/l	0.77 U	0.79 U	0.8 U	0.77 U	0.81 U
51-28-5	2,4-DINITROPHENOL	ug/l	2.3 UJ	2.3 UJ	2.4 UJ	2.3 UJ	2.4 UJ
121-14-2	2,4-DINITROTOLUENE	ug/l	1.1 U	1.1 U	1.1 U	1.1 U	1.1 U
606-20-2	2,6-DINITROTOLUENE	ug/l	0.35 U	0.36 U	0.36 U	0.35 U	0.36 U
91-58-7	2-CHLORONAPHTHALENE	ug/l	0.17 U	0.18 U	0.18 U	0.17 U	0.18 U
95-57-8	2-CHLOROPHENOL	ug/l	0.59 U	0.6 U	0.61 U	0.59 U	0.61 U
91-57-6	2-METHYLNAPHTHALENE	ug/l	0.35 U	0.36 U	0.36 U	0.35 U	0.36 U
95-48-7	2-METHYLPHENOL (O-CRESOL)	ug/l	0.26 U	0.27 U	0.27 U	0.26 U	0.27 U
88-74-4	2-NITROANILINE	ug/l	0.53 U	0.54 U	0.55 U	0.53 U	0.56 U
88-75-5	2-NITROPHENOL	ug/l	0.57 U	0.58 UJ	0.58 U	0.57 U	0.59 UJ
91-94-1	3,3'-DICHLOROENZIDINE	ug/l	1.1 U	1.1 U	1.1 U	1.1 U	1.1 U
MEPH3MEPH	3- AND 4- METHYLPHENOL (TOTAL)	ug/l	0.41 U	0.42 U	0.43 U	0.41 U	0.43 U
99-09-2	3-NITROANILINE	ug/l	1.1 U	1.1 U	1.1 U	1.1 U	1.1 U
534-52-1	4,6-DINITRO-2-METHYLPHENOL	ug/l	0.8 U	0.82 U	0.83 U	0.8 U	0.84 U
101-55-3	4-BROMOPHENYL PHENYL ETHER	ug/l	0.25 U	0.26 U	0.26 U	0.25 U	0.26 U
59-50-7	4-CHLORO-3-METHYLPHENOL	ug/l	0.43 U	0.44 UJ	0.45 U	0.43 U	0.45 UJ
106-47-8	4-CHLOROANILINE	ug/l	1.1 U	1.1 U	1.1 U	1.1 U	1.1 U
7005-72-3	4-CHLOROPHENYL PHENYL ETHER	ug/l	0.23 U	0.23 U	0.24 U	0.23 U	0.24 U
100-01-6	4-NITROANILINE	ug/l	1.5 U	1.5 U	1.5 U	1.5 U	1.5 U
100-02-7	4-NITROPHENOL	ug/l	2.2 U	2.2 U	2.2 U	2.2 U	2.3 U
83-32-9	ACENAPHTHENE	ug/l	0.23 U	3.9 J	0.24 U	0.23 U	24.3
208-96-8	ACENAPHTHYLENE	ug/l	0.76 U	21	0.79 U	0.76 U	0.8 U
98-86-2	ACETOPHENONE	ug/l	0.15 U	0.16 U	0.16 U	0.15 U	0.16 U
120-12-7	ANTHRACENE	ug/l	0.17 U	0.18 U	0.18 U	0.17 U	0.18 U
1912-24-9	ATRAZINE	ug/l	0.43 U	0.44 U	0.45 U	0.43 U	0.45 U
100-52-7	BENZALDEHYDE	ug/l	0.84 U	0.86 U	0.87 U	0.84 U	0.88 U
56-55-3	BENZO(A)ANTHRACENE	ug/l	0.17 U	0.18 U	0.18 U	0.17 U	0.18 U
50-32-8	BENZO(A)PYRENE	ug/l	0.15 U	0.16 U	0.16 U	0.15 U	0.16 U
205-99-2	BENZO(B)FLUORANTHENE	ug/l	0.32 U	0.32 U	0.33 U	0.32 U	0.33 U
191-24-2	BENZO(G,H)PERYLENE	ug/l	0.32 U	0.32 U	0.33 U	0.32 U	0.33 U
207-08-9	BENZO(K)FLUORANTHENE	ug/l	0.2 U	0.2 U	0.2 U	0.2 U	0.2 U
85-68-7	BENZYL BUTYL PHTHALATE	ug/l	0.21 UJ	0.21 U	0.21 UJ	0.21 UJ	0.22 U
92-52-4	BIPHENYL (DIPHENYL)	ug/l	0.16 U	0.17 U	0.17 U	0.16 U	0.17 U
111-91-1	BIS(2-CHLOROETHOXY) METHANE	ug/l	0.6 U	0.61 U	0.62 U	0.6 U	0.63 U
111-44-4	BIS(2-CHLOROETHYL) ETHER	ug/l	0.6 U	0.61 U	0.62 U	0.6 U	0.63 U
108-60-1	BIS(2-CHLOROISOPROPYL) ETHER	ug/l	0.18 U	0.19 UJ	0.19 U	0.18 U	0.19 UJ
117-81-7	BIS(2-ETHYLHEXYL) PHTHALATE	ug/l	0.17 UJ	0.18 U	0.18 UJ	0.17 UJ	0.18 U
105-60-2	CAPROLACTAM	ug/l	1.1 U	1.1 U	1.1 U	1.1 U	1.1 U
86-74-8	CARBAZOLE	ug/l	0.24 U	0.24 U	0.25 U	0.24 U	3 J
218-01-9	CHRYSENE	ug/l	0.2 U	0.2 U	0.2 U	0.2 U	0.2 U
53-70-3	DIBENZ(A,H)ANTHRACENE	ug/l	0.46 U	0.47 U	0.47 U	0.46 U	0.48 U
132-64-9	DIBENZOFURAN	ug/l	0.26 U	0.27 U	0.27 U	0.26 U	0.27 U
84-66-2	DIETHYL PHTHALATE	ug/l	0.41 UJ	0.42 U	0.43 UJ	0.41 UJ	0.43 U
131-11-3	DIMETHYL PHTHALATE	ug/l	0.24 U	0.24 U	0.25 U	5.8 J	0.25 U
84-74-2	DI-N-BUTYL PHTHALATE	ug/l	1.1 U	1.1 U	1.1 U	1.1 U	1.1 U
117-84-0	DI-N-OCTYLPHTHALATE	ug/l	0.55 UJ	0.57 UJ	0.57 UJ	0.55 UJ	0.58 UJ
206-44-0	FLUORANTHENE	ug/l	0.43 U	0.44 U	0.45 U	0.43 U	0.45 U
86-73-7	FLUORENE	ug/l	0.34 U	0.34 U	0.35 U	0.34 U	4.1 J
118-74-1	HEXACHLOROENZENE	ug/l	0.2 U	0.2 U	0.2 U	0.2 U	0.2 U
87-68-3	HEXACHLOROBUTADIENE	ug/l	0.27 U	0.28 U	0.28 U	0.27 U	0.28 U
77-47-4	HEXACHLOROCYCLOPENTADIENE	ug/l	0.26 U	0.27 U	0.27 U	0.26 U	0.27 U
67-72-1	HEXACHLOROETHANE	ug/l	0.27 U	0.28 U	0.28 U	0.27 U	0.28 U
193-39-5	INDENO(1,2,3-C,D)PYRENE	ug/l	0.16 U	0.17 U	0.17 U	0.16 U	0.17 U
78-59-1	ISOPHORONE	ug/l	0.33 U	0.33 UJ	0.34 U	0.33 U	0.34 UJ
91-20-3	NAPHTHALENE	ug/l	0.13 U	180	0.13 U	0.13 U	48.3
98-95-3	NITROBENZENE	ug/l	0.74 U	0.76 UJ	0.76 U	0.74 U	0.77 UJ
621-64-7	N-NITROSODI-N-PROPYLAMINE	ug/l	0.22 U	0.22 UJ	0.22 U	0.22 U	0.23 UJ
86-30-6	N-NITROSODIPHENYLAMINE	ug/l	0.65 U	0.67 U	0.67 U	0.65 U	0.68 U
87-86-5	PENTACHLOROPHENOL	ug/l	1.1 U	1.1 U	1.1 U	1.1 U	1.1 U
85-01-8	PHENANTHRENE	ug/l	0.28 U	0.29 U	0.29 U	0.28 U	0.3 U
108-95-2	PHENOL	ug/l	0.23 U	0.23 U	0.24 U	0.23 U	0.24 U
129-00-0	PYRENE	ug/l	0.22 U	0.22 U	0.22 U	0.22 U	0.23 U

Con Ed - White Plains Validated Groundwater Analytical Data December 2013 SDG: E4747 & E4794		Location ID: Sample ID: Lab Sample Id: Source: SDG: Matrix: Sampled: Validated:	FIELDQC FB121013-20131210 E4747-13 CTECH E4747 WATER 12/10/2013 16:00 1/30/2014	FIELDQC TB120913-20131209 E4747-14 CTECH E4747 WATER 12/9/2013 11:00 1/30/2014	FIELDQC TRIPBLANK-20131211 E4794-11 CTECH E4794 WATER 12/12/2013 10:00 1/30/2014
CAS NO.	COMPOUND	UNITS:			
	VOLATILES				
71-55-6	1,1,1-TRICHLOROETHANE	ug/l	0.4 U	0.4 U	0.4 U
79-34-5	1,1,2,2-TETRACHLOROETHANE	ug/l	0.31 U	0.31 U	0.31 U
76-13-1	1,1,2-TRICHLORO-1,2,2-TRIFLUOROETHANE	ug/l	0.45 U	0.45 U	0.45 U
79-00-5	1,1,2-TRICHLOROETHANE	ug/l	0.38 U	0.38 U	0.38 U
75-34-3	1,1-DICHLOROETHANE	ug/l	0.36 U	0.36 U	0.36 U
75-35-4	1,1-DICHLOROETHENE	ug/l	0.47 U	0.47 U	0.47 U
87-61-6	1,2,3-TRICHLOROBENZENE	ug/l	0.2 U	0.2 U	0.2 U
120-82-1	1,2,4-TRICHLOROBENZENE	ug/l	0.2 U	0.2 U	0.2 U
96-12-8	1,2-DIBROMO-3-CHLOROPROPANE	ug/l	0.46 UJ	0.46 UJ	0.46 U
106-93-4	1,2-DIBROMOETHANE	ug/l	0.41 U	0.41 U	0.41 U
95-50-1	1,2-DICHLOROBENZENE	ug/l	0.45 U	0.45 U	0.45 UJ
107-06-2	1,2-DICHLOROETHANE	ug/l	0.48 U	0.48 U	0.48 U
78-87-5	1,2-DICHLOROPROPANE	ug/l	0.46 U	0.46 U	0.46 U
541-73-1	1,3-DICHLOROBENZENE	ug/l	0.43 U	0.43 U	0.43 U
106-46-7	1,4-DICHLOROBENZENE	ug/l	0.32 U	0.32 U	0.32 U
123-91-1	1,4-DIOXANE (P-DIOXANE)	ug/l	50 U	50 U	50 U
591-78-6	2-HEXANONE	ug/l	1.9 U	1.9 U	1.9 U
67-64-1	ACETONE	ug/l	0.5 U	0.5 U	0.5 UJ
71-43-2	BENZENE	ug/l	0.32 U	0.32 U	0.32 U
74-97-5	BROMOCHLOROMETHANE	ug/l	0.2 U	0.2 U	0.2 U
75-27-4	BROMODICHLOROMETHANE	ug/l	0.36 U	0.36 U	0.36 U
75-25-2	BROMOFORM	ug/l	0.47 U	0.47 U	0.47 U
74-83-9	BROMOMETHANE	ug/l	0.2 UJ	0.2 UJ	0.2 U
75-15-0	CARBON DISULFIDE	ug/l	0.2 UJ	0.2 UJ	0.2 U
56-23-5	CARBON TETRACHLORIDE	ug/l	0.2 U	0.2 U	0.2 U
108-90-7	CHLOROBENZENE	ug/l	0.49 U	0.49 U	0.49 U
75-00-3	CHLOROETHANE	ug/l	0.2 U	0.2 U	0.2 U
67-66-3	CHLOROFORM	ug/l	0.34 U	0.34 U	0.34 U
74-87-3	CHLOROMETHANE	ug/l	0.2 UJ	0.2 UJ	0.2 U
156-59-2	CIS-1,2-DICHLOROETHYLENE	ug/l	0.35 U	0.35 U	0.35 U
10061-01-5	CIS-1,3-DICHLOROPROPENE	ug/l	0.31 U	0.31 U	0.31 U
110-82-7	CYCLOHEXANE	ug/l	0.2 UJ	0.2 UJ	0.2 UJ
124-48-1	DIBROMOCHLOROMETHANE	ug/l	0.2 U	0.2 U	0.2 U
75-71-8	DICHLORODIFLUOROMETHANE	ug/l	0.2 U	0.2 U	0.2 UJ
100-41-4	ETHYLBENZENE	ug/l	0.2 U	0.2 U	0.2 U
98-82-8	ISOPROPYLBENZENE (CUMENE)	ug/l	0.45 U	0.45 U	0.45 U
79-20-9	METHYL ACETATE	ug/l	0.2 U	0.2 U	0.2 U
78-93-3	METHYL ETHYL KETONE (2-BUTANONE)	ug/l	1.3 U	1.3 U	1.3 U
108-10-1	METHYL ISOBUTYL KETONE	ug/l	2.1 U	2.1 U	2.1 U
108-87-2	METHYLCYCLOHEXANE	ug/l	0.2 U	0.2 U	0.2 U
75-09-2	METHYLENE CHLORIDE	ug/l	0.41 U	0.41 U	0.41 U
95-47-6	O-XYLENE (1,2-DIMETHYLBENZENE)	ug/l	0.43 U	0.43 U	0.43 U
100-42-5	STYRENE	ug/l	0.36 U	0.36 U	0.36 U
1634-04-4	TERT-BUTYL METHYL ETHER	ug/l	0.35 U	0.35 U	0.35 U
127-18-4	TETRACHLOROETHYLENE(PCE)	ug/l	0.27 U	0.27 U	0.27 U
108-88-3	TOLUENE	ug/l	0.37 U	0.37 U	0.37 U
156-60-5	TRANS-1,2-DICHLOROETHENE	ug/l	0.41 U	0.41 U	0.41 U
10061-02-6	TRANS-1,3-DICHLOROPROPENE	ug/l	0.29 U	0.29 U	0.29 U
79-01-6	TRICHLOROETHYLENE (TCE)	ug/l	0.28 U	0.28 U	0.28 U
75-69-4	TRICHLOROFUOROMETHANE	ug/l	0.35 U	0.35 U	0.35 U
75-01-4	VINYL CHLORIDE	ug/l	0.34 UJ	0.34 UJ	0.34 U
XYLMP	M,P-XYLENE (SUM OF ISOMERS)	ug/l	0.95 U	0.95 U	0.95 U

Con Ed - White Plains Validated Groundwater Analytical Data December 2013 SDG: E4747 & E4794		Location ID: Sample ID: Lab Sample Id: Source: SDG: Matrix: Sampled: Validated:	FIELDQC FB121013-20131210 E4747-13 CTECH E4747 WATER 12/10/2013 16:00 1/30/2014	FIELDQC TB120913-20131209 E4747-14 CTECH E4747 WATER 12/9/2013 11:00 1/30/2014	FIELDQC TRIPBLANK-20131211 E4794-11 CTECH E4794 WATER 12/12/2013 10:00 1/30/2014
CAS NO.	COMPOUND	UNITS:			
	SEMIVOLATILES				
95-94-3	1,2,4,5-TETRACHLOROBENZENE	ug/l	0.22 U		
58-90-2	2,3,4,6-TETRACHLOROPHENOL	ug/l	0.22 U		
95-95-4	2,4,5-TRICHLOROPHENOL	ug/l	0.44 U		
88-06-2	2,4,6-TRICHLOROPHENOL	ug/l	0.62 U		
120-83-2	2,4-DICHLOROPHENOL	ug/l	0.73 U		
105-67-9	2,4-DIMETHYLPHENOL	ug/l	0.79 U		
51-28-5	2,4-DINITROPHENOL	ug/l	2.3 UJ		
121-14-2	2,4-DINITROTOLUENE	ug/l	1.1 U		
606-20-2	2,6-DINITROTOLUENE	ug/l	0.36 U		
91-58-7	2-CHLORONAPHTHALENE	ug/l	0.18 U		
95-57-8	2-CHLOROPHENOL	ug/l	0.6 U		
91-57-6	2-METHYLNAPHTHALENE	ug/l	0.36 U		
95-48-7	2-METHYLPHENOL (O-CRESOL)	ug/l	0.27 U		
88-74-4	2-NITROANILINE	ug/l	0.54 U		
88-75-5	2-NITROPHENOL	ug/l	0.58 U		
91-94-1	3,3'-DICHLOROBENZIDINE	ug/l	1.1 U		
MEPH3MEPH	3- AND 4- METHYLPHENOL (TOTAL)	ug/l	0.42 U		
99-09-2	3-NITROANILINE	ug/l	1.1 U		
534-52-1	4,6-DINITRO-2-METHYLPHENOL	ug/l	0.82 U		
101-55-3	4-BROMOPHENYL PHENYL ETHER	ug/l	0.26 U		
59-50-7	4-CHLORO-3-METHYLPHENOL	ug/l	0.44 U		
106-47-8	4-CHLOROANILINE	ug/l	1.1 U		
7005-72-3	4-CHLOROPHENYL PHENYL ETHER	ug/l	0.23 U		
100-01-6	4-NITROANILINE	ug/l	1.5 U		
100-02-7	4-NITROPHENOL	ug/l	2.2 U		
83-32-9	ACENAPHTHENE	ug/l	0.23 U		
208-96-8	ACENAPHTHYLENE	ug/l	0.78 U		
98-86-2	ACETOPHENONE	ug/l	0.16 U		
120-12-7	ANTHRACENE	ug/l	0.18 U		
1912-24-9	ATRAZINE	ug/l	0.44 U		
100-52-7	BENZALDEHYDE	ug/l	0.86 U		
56-55-3	BENZO(A)ANTHRACENE	ug/l	0.18 U		
50-32-8	BENZO(A)PYRENE	ug/l	0.16 U		
205-99-2	BENZO(B)FLUORANTHENE	ug/l	0.32 U		
191-24-2	BENZO(G,H,I)PERYLENE	ug/l	0.32 U		
207-08-9	BENZO(K)FLUORANTHENE	ug/l	0.2 U		
85-68-7	BENZYL BUTYL PHTHALATE	ug/l	0.21 UJ		
92-52-4	BIPHENYL (DIPHENYL)	ug/l	0.17 U		
111-91-1	BIS(2-CHLOROETHOXY) METHANE	ug/l	0.61 U		
111-44-4	BIS(2-CHLOROETHYL) ETHER	ug/l	0.61 U		
108-60-1	BIS(2-CHLOROISOPROPYL) ETHER	ug/l	0.19 U		
117-81-7	BIS(2-ETHYLHEXYL) PHTHALATE	ug/l	0.18 UJ		
105-60-2	CAPROLACTAM	ug/l	1.1 U		
86-74-8	CARBAZOLE	ug/l	0.24 U		
218-01-9	CHRYSENE	ug/l	0.2 U		
53-70-3	DIBENZ(A,H)ANTHRACENE	ug/l	0.47 U		
132-64-9	DIBENZOFURAN	ug/l	0.27 U		
84-66-2	DIETHYL PHTHALATE	ug/l	0.42 UJ		
131-11-3	DIMETHYL PHTHALATE	ug/l	0.24 U		
84-74-2	DI-N-BUTYL PHTHALATE	ug/l	1.1 U		
117-84-0	DI-N-OCTYLPHTHALATE	ug/l	0.57 UJ		
206-44-0	FLUORANTHENE	ug/l	0.44 U		
86-73-7	FLUORENE	ug/l	0.34 U		
118-74-1	HEXACHLOROBENZENE	ug/l	0.2 U		
87-68-3	HEXACHLOROBUTADIENE	ug/l	0.28 U		
77-47-4	HEXACHLOROCYCLOPENTADIENE	ug/l	0.27 U		
67-72-1	HEXACHLOROETHANE	ug/l	0.28 U		
193-39-5	INDENO(1,2,3-C,D)PYRENE	ug/l	0.17 U		
78-59-1	ISOPHORONE	ug/l	0.33 U		
91-20-3	NAPHTHALENE	ug/l	0.13 U		
98-95-3	NITROBENZENE	ug/l	0.76 U		
621-64-7	N-NITROSODI-N-PROPYLAMINE	ug/l	0.22 U		
86-30-6	N-NITROSODIPHENYLAMINE	ug/l	0.67 U		
87-86-5	PENTACHLOROPHENOL	ug/l	1.1 U		
85-01-8	PHENANTHRENE	ug/l	0.29 U		
108-95-2	PHENOL	ug/l	0.23 U		
129-00-0	PYRENE	ug/l	0.22 U		