

MID-HUDSON GEOSCIENCES
1003 Route 44/55
P.O. Box 32
Clintondale, NY 12515-0032
Phone & FAX (845) 883-5726

rockdoctor@optonline.net
May 22, 2017

Parag B. Amin P.E.
NYSDEC, DER
Remedial Bureau C
Section B
625 Broadway
Albany, NY, 12233-7014

VIA EMAIL

**RE: Amendments for Work Plan for Downgradient Monitoring Wells for
Scanlon's American Cleaners, Kingston, NY;
NYSDEC Site Number V-00601-01
Existing Work Plan: RIWP Off-Site Monitoring Wells rev. July 7, 2011**

Dear Parag,

For the purpose of locating the end of the PCE contaminant plume from the American Cleaners site at 734 Ulster Avenue, additional monitoring wells are planned to be installed on the west side of Lincoln Park Place and east of the drop off where the target water-bearing beds we have been monitoring are eroded away. The Ulster Avenue/Lincoln Park Place neighborhood is at approximately 285 feet above sea level and the Esopus Floodplain is about 160 feet above sea level.

We are planning to install two well couplets, that is two pairs of wells about 5 feet apart with screens at depths of 11 to 16 feet and 20 to 25 feet respectively. The wells will be installed with Geoprobe and 1-inch inner diameter PVC materials will be used. The screen will have 0.010-inch slotting. We will attempt to install compatible sand in the annular space around the slotting and up to two feet above the top of screen. However, if overlying sand beds collapse into the well, it will not be a reason to abandon the well. We will have a core of the overlying sediments and we can do a grain-size analysis to confirm well usability. A 3-foot bentonite seal will be installed above the sand in the annular space. The small 8-inch diameter manholes will be installed in concrete at ground level, probably in an 18 by 18-inch wood frame and level with the top of ground surface, so mowing will not be impeded in grassy areas.

Finding cooperative sites in the Lincoln Park Place neighborhood is not too easy, but we are persisting at visiting the homeowners. We are close to having agreement with homeowners at 70 Stahlman Place and 761 Lincoln Park Place. As soon as we have agreement, I will notify you and the driller and we will schedule a drilling date.

We are aiming for a tentative date for drilling in the first week in June. The driller is Core Down Drilling, the company, which purchased Todd Syska's Geoprobe rig and he trained them on the use of it. The driller's name is Andrew Bellucci and phone number is (845) 625 3401.

The four wells can probably be installed in one day, with two days the maximum time required. The wells will be developed after the bentonite seal has had ample time to expand and cure. Purge water will be brought back to SACK and evaporated. Every attempt will be made of limit

the amount of fine material in the pumped water. The wells at the Spa showed that the deeper wells have more fine material than the shallower wells. However, slow pumping does work best to get a clean sample.

The wells will be sampled at least 24 hours after development is completed. A surveyor will be hired to measure the elevation of the well covers for all wells on the east side of Ulster Avenue, on the west side of Ulster Avenue, and at the 4 new wells on the west side of Lincoln Park Place. Also we will have the surveyor provide GPS coordinates for each of the wells. Once we have the coordinates and elevations, a complete set of depth to water measurements can be converted to elevations relative to sea level and a contour map of the hydraulic gradient can be constructed.

We look forward to you input and we are committed to completion of the wells for the monitoring system.

Yours truly,

A handwritten signature in dark ink, reading "Katherine J. Beinkafner". The signature is fluid and cursive, with the first name "Katherine" being more prominent than the last name "Beinkafner".

Katherine J. Beinkafner, Ph.D.
Certified Professional Geologist #6611

cc: Erez Halevah, Dave Crosby, Kristin Kulow, NYSDOH via email
Jolanda G. Jansen, P.E.

Ulster County Parcel Viewer

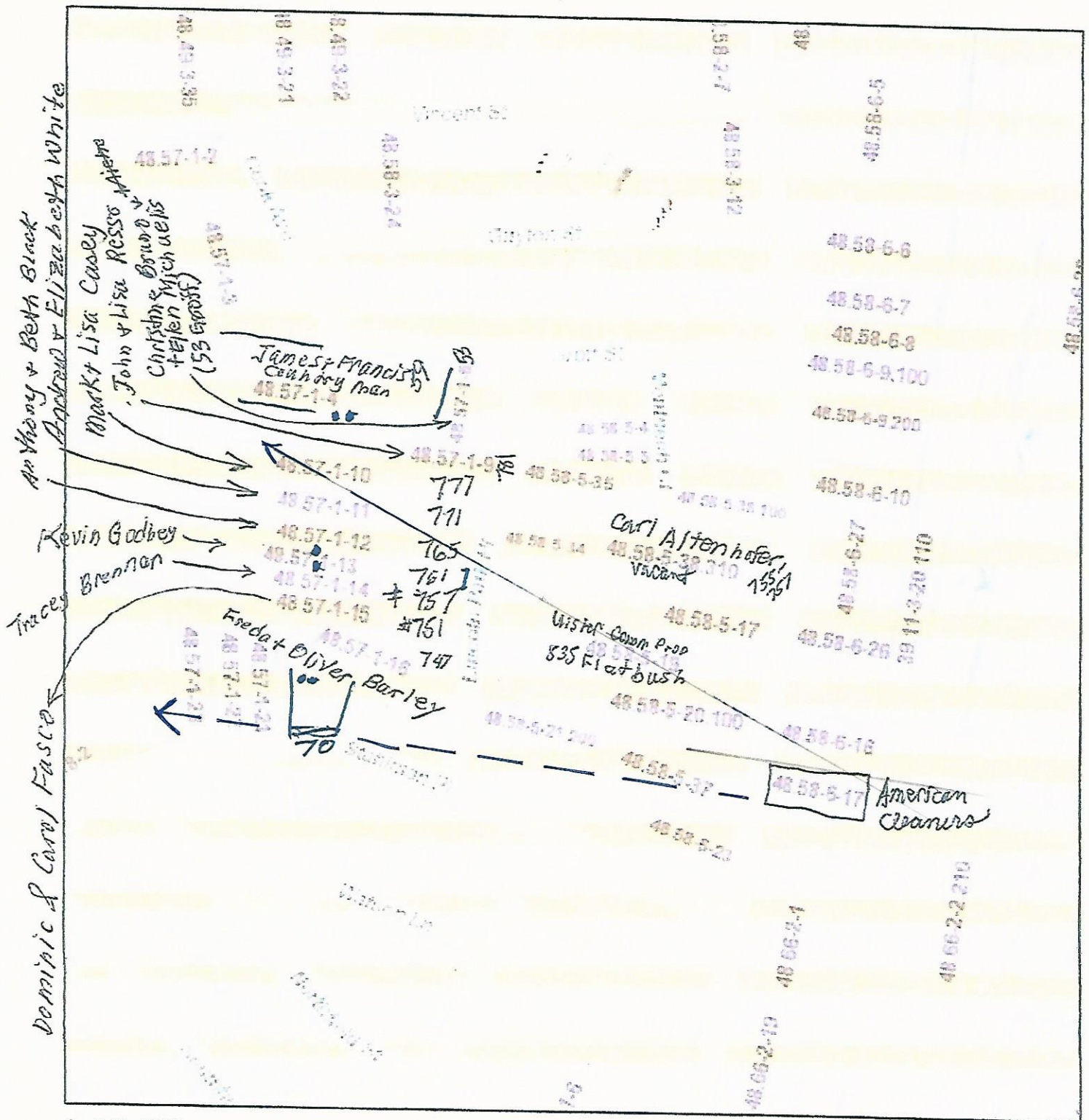

April 18, 2017

•• Approximate Well locations

50 Groff St
761 Lincoln Park Place
70 Stahlman Place

