

**New York State Department of Environmental Conservation  
Division of Environmental Remediation**

625 Broadway, 12th Floor, Albany, New York 12233-7011

Phone: (518) 402-9706 • FAX: (518) 402-9020

Website: [www.dec.state.ny.us](http://www.dec.state.ny.us)

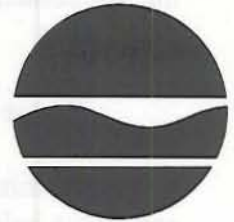

Alexander B. Grannis  
Commissioner

**CERTIFIED MAIL\ RETURN RECEIPT REQUESTED**

**JUL 16 2010**

Mr. Randolph S. Price  
Vice President  
Environment, Health & Safety  
Consolidated Edison Company of New York, Inc.  
4 Irving Place – Room 802  
New York, NY 10003

Re: Con Edison Multi-site VCA, Amendment #2  
Kent Avenue Station Site (the "Site"), Brooklyn, Kings County, Site No. V00732-2  
VCA No. D2-0003-02-08 (the "VCA" or "Agreement")

Dear Mr. Price:

This letter is in response to your letter to the Commissioner dated June 21, 2010, wherein the Volunteer under the Voluntary Cleanup Program, Consolidated Edison Company of New York, Inc. ("Volunteer"), requested an Amendment of the above referenced VCA between the Volunteer and the New York State Department of Environmental Conservation (the "Department").

In reliance upon, and in furtherance of the letter and previous discussions of this matter between the Department's staff and the VCP applicant's representatives to date, the VCA Amendment requested is hereby granted and incorporated into and is enforceable pursuant to the subject Agreement, effective immediately upon receipt of this letter.

Specifically, the following Site is hereby added to the Volunteer's Multi-site VCA: property known as the Kent Avenue Station and further identified currently as Block 2023, Lot 10 on the Tax Map of the City of New York for the Borough of Brooklyn/County of Kings. A map of the Kent Avenue Station Site and a metes and bounds description is included as an Addendum to Exhibit "A".

In addition, paragraph I.B. "Existing Contamination" is modified for the Kent Avenue Station Site to include a subparagraph 3, as follows:

3) if disposed at the Kent Avenue Station Site, is hazardous waste or petroleum as defined by 6 NYCRR 375-1.2 (w) or (ah).

This Amendment is made in accordance with and subject to all of the VCA and all applicable guidance, regulations and state laws applicable thereto. All other substantive and procedural terms of

the Agreement will remain unchanged and in full force and effect regarding the parties to the Agreement.

Please keep this letter as proof of the VCA Amendment #2.

Nothing contained herein constitutes a waiver by the Department or the State of New York of any rights held in accordance with the Agreement or any applicable state and/or federal law or a release for any party from any obligations held under the Agreement or those same laws.

Please contact me if this you have any questions in this regard. Thank you for your assistance in this matter.

Sincerely,



Dale A. Desnoyers

Director

Division of Environmental Remediation

Enc.

ec: R. Price, conEdison ([pricer@coned.com](mailto:pricer@coned.com))  
M. Wilken, conEdison ([WILCKENM@coned.com](mailto:WILCKENM@coned.com))  
E. Louie, conEdison ([louiee@coned.com](mailto:louiee@coned.com))  
B. Cohen, conEdison ([COHENBA@coned.com](mailto:COHENBA@coned.com))  
J. Crua, NYSDOH ([jpc04@health.state.ny.us](mailto:jpc04@health.state.ny.us))  
D. Desnoyers  
B. Conlon  
M. Lesser  
R. Schick  
G. Cross  
D. MacNeal  
D. Weigel  
E. Armater  
Joe O'Connell  
Jane O'Connell



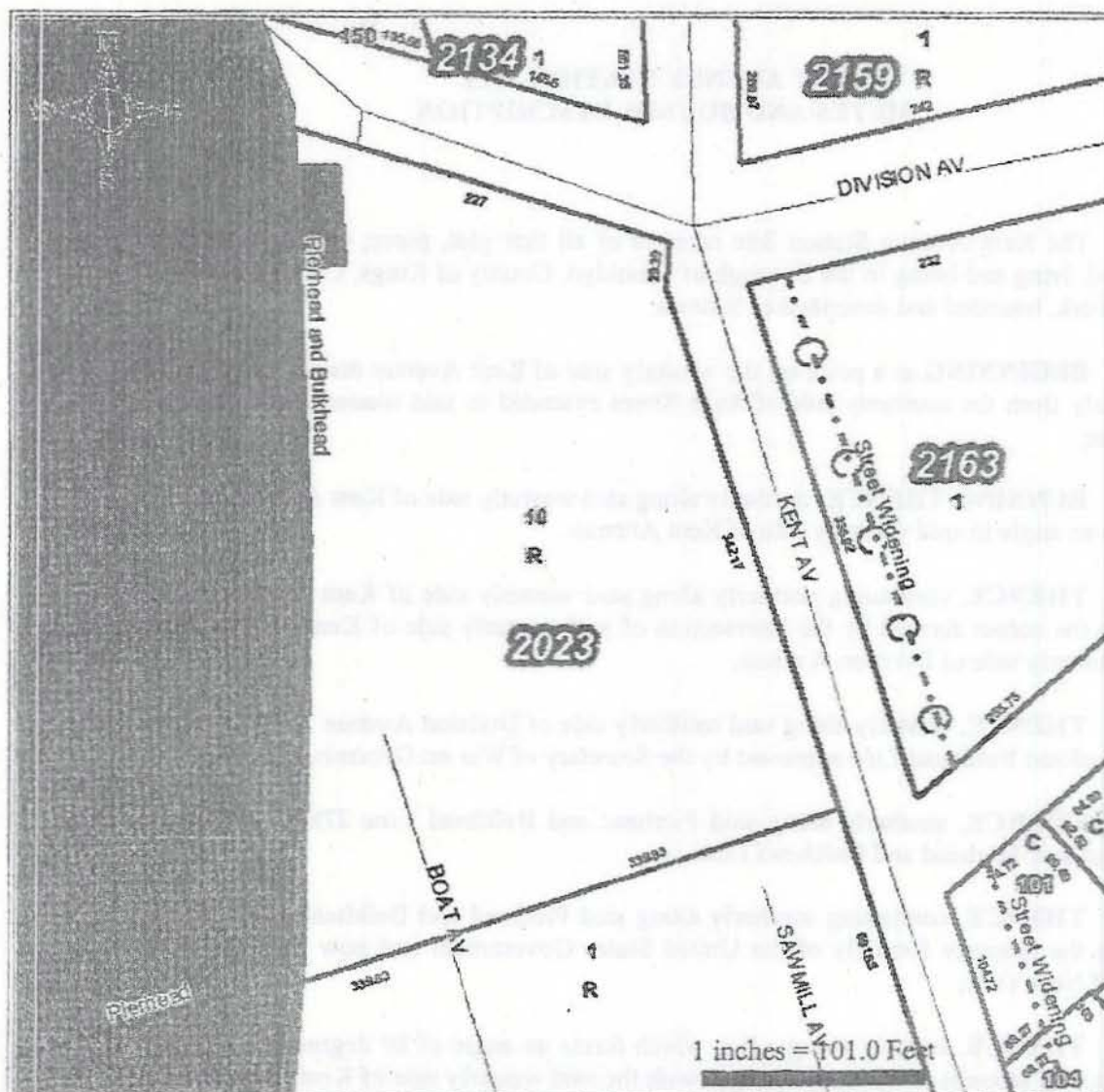

Kent Avenue Station Site - Block 2023 Lot 10



6/18/2010

- Boroughs ☐
- Tax Blocks ☐
- Tax Lots ☐
- Boundary Lines ☐
- Streets ☐
- Hydrography ☐

Addendum to Exhibit "A"

**KENT AVENUE STATION SITE  
METES AND BOUNDS DESCRIPTION**

The Kent Avenue Station Site consists of all that plot, piece, or parcel of land situated, lying and being in the Borough of Brooklyn, County of Kings, City and State of New York, bounded and described as follows:

**BEGINNING** at a point on the westerly side of Kent Avenue distant 103.52 feet northerly from the southerly side of Rush Street extended to said westerly side of Kent Avenue;

**RUNNING THENCE**, northerly along said westerly side of Kent Avenue 342.17 feet to an angle in said westerly side of Kent Avenue;

**THENCE**, continuing northerly along said westerly side of Kent Avenue 29.39 feet to the corner formed by the intersection of said westerly side of Kent Avenue with the southerly side of Division Avenue;

**THENCE**, westerly along said southerly side of Division Avenue 227 feet to the Pierhead and Bulkhead Line approved by the Secretary of War on December 19, 1901;

**THENCE**, southerly along said Pierhead and Bulkhead Line 278.67 feet to an angle in said Pierhead and Bulkhead Line;

**THENCE**, continuing southerly along said Pierhead and Bulkhead Line 248.96 feet to the property formerly of the United States Government and now owned by the City of New York;

**THENCE**, easterly along a line which forms an angle of 89 degrees 47 minutes and no (00) seconds on its northerly side with the said westerly side of Kent Avenue, and along said land formerly of the United States Government and now owned by the City of New York 339.83 feet to said westerly side of Kent Avenue at the point or place of the **BEGINNING**.

Being the same plot, piece, or parcel of land conveyed to Consolidated Edison Company of New York, Inc. by the City of New York by deed dated August 1, 1962, and recorded in the Office of the City Register, Kings County on August 2, 1960, in Liber 9038 of Conveyances, Pages 265 to 272.