

LEGEND:

- PROPERTY LINE
- - - FENCE
- ⊕ PREVIOUS SOIL PROBE LOCATION (ADVANCED TO A DEPTH OF 8 FEET BELOW GRADE - MARCH 2002)
- ⊕ PREVIOUS EXPOSURE POINT SAMPLING LOCATION (COLLECTED FROM THE 0-2" DEPTH INTERVAL - MARCH 2002 (EP-1 THROUGH EP-19) OR MAY 2002 (EP-20 THROUGH EP-27))
- SOIL BORING LOCATION
- ⊕ MONITORING WELL LOCATION

- NOTES:**
- ALL VOC AND SVOC ANALYTICAL RESULTS REPORTED IN UNITS OF UG/KG (PPB). ALL METAL AND PCB ANALYTICAL RESULTS REPORTED IN UNITS OF MG/KG (PPM).
 - ONLY ANALYTICAL RESULTS IN EXCESS OF THE SOIL SCREENING LEVELS ARE PRESENTED.
 - COLORS:
 - PCB EXCEEDANCE
 - CHROMIUM EXCEEDANCE
 - ROHM METAL EXCEEDANCE (OTHER THAN CHROMIUM)
 - VOC OR SVOC EXCEEDANCE
 - DEPTH INTERVALS DENOTED IN BLUE INDICATE SOIL SAMPLES ANALYZED FOR VOCs AND SVOCs.

- ABBREVIATIONS:**
- Ac - Acetone
 - As - Arsenic
 - Ba - Barium
 - Cd - Cadmium
 - Cr - Chromium
 - Cu - Copper
 - Da - Lead
 - Mg - Magnesium
 - Mer - Mercury
 - Ni - Nickel
 - Se - Selenium
 - Zn - Zinc
 - Ac - Acetone
 - 1,1-D - 1,1-Dichloroethane
 - To - Toluene
 - Xy - Xylene
 - Ba - Benzo(a)anthracene
 - Be - Benzo(a)pyrene
 - Fl - Benzo(b)fluoranthene
 - Fl - Benzo(k)fluoranthene
 - Ch - Chrysene
 - Di - Dibenzo(a,h)anthracene
 - Me - Methylphenol
 - Pe - Phenol

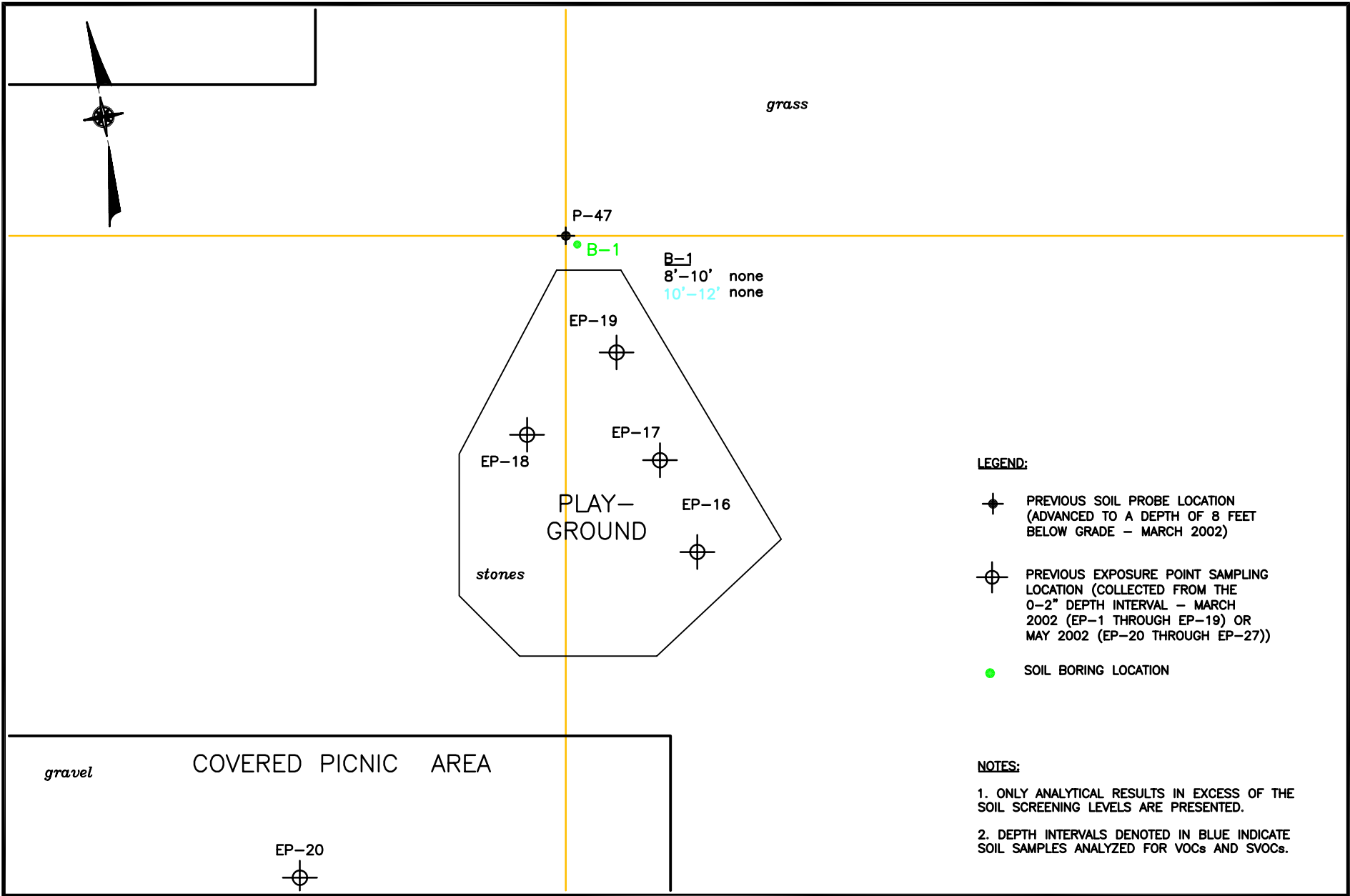

TOWN OF OYSTER BAY
 BETHPAGE COMMUNITY PARK
 BETHPAGE, NEW YORK

SCALE: 1" = 15'

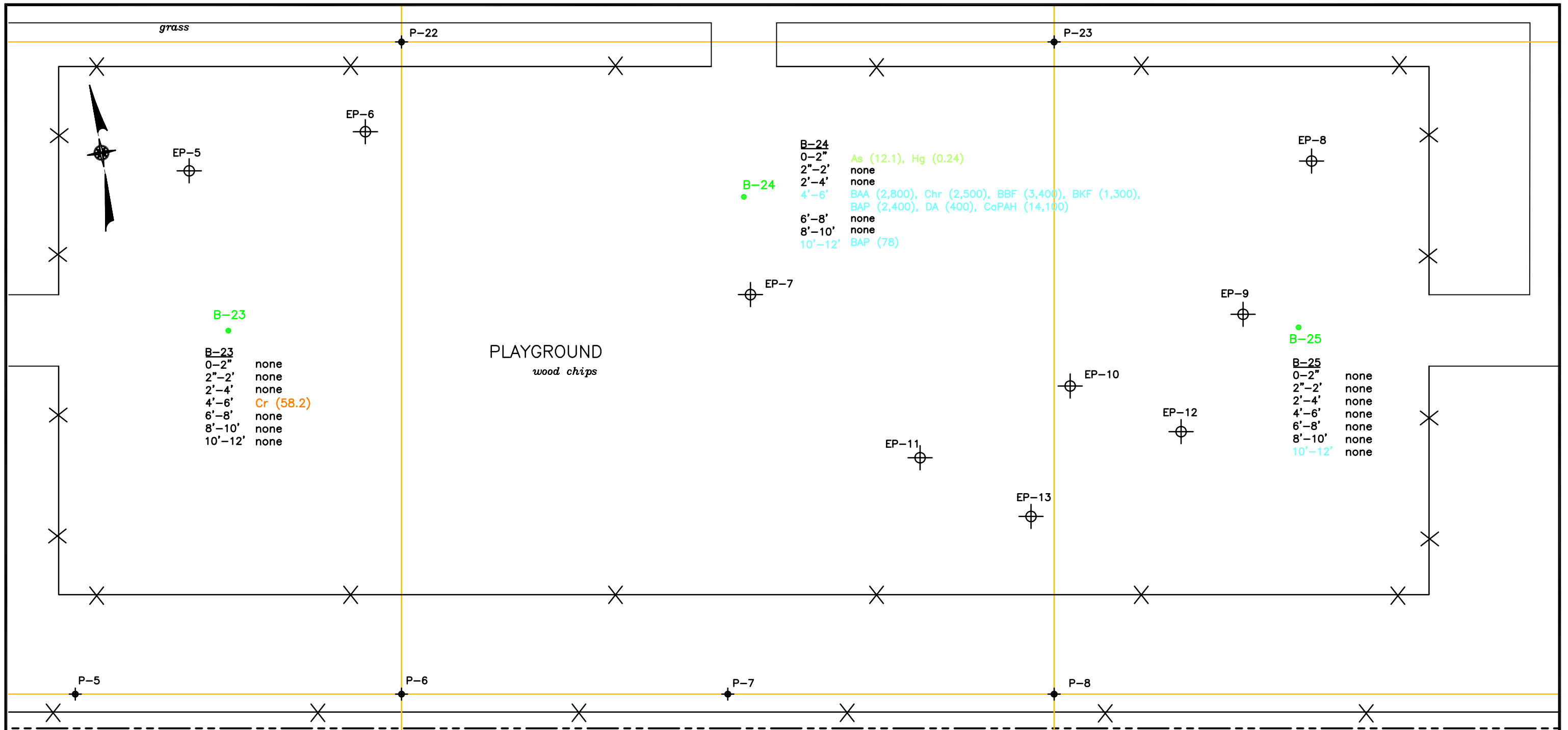

B-23
 0-2" none
 2"-2' none
 2'-4' none
 4'-6' **Cr (58.2)**
 6'-8' none
 8'-10' none
 10'-12' none

B-24
 0-2" **As (12.1), Hg (0.24)**
 2"-2' none
 2'-4' none
 4'-6' **BAA (2,800), Chr (2,500), BBF (3,400), BKF (1,300), BAP (2,400), DA (400), CoPAH (14,100)**
 6'-8' none
 8'-10' none
 10'-12' **BAP (78)**

B-25
 0-2" none
 2"-2' none
 2'-4' none
 4'-6' none
 6'-8' none
 8'-10' none
 10'-12' none

LEGEND:

ABBREVIATIONS:
 As - Arsenic
 Cr - Chromium
 Hg - Mercury
 BAA - Benzo(a)anthracene
 BAP - Benzo(a)pyrene
 BBF - Benzo(b)fluoranthene
 BKF - Benzo(k)fluoranthene
 Chr - Chrysene
 DA - Dibenzo(a,h)anthracene

- PROPERTY LINE
- X-X- FENCE
- ⊕ PREVIOUS SOIL PROBE LOCATION (ADVANCED TO A DEPTH OF 8 FEET BELOW GRADE - MARCH 2002)
- ⊕ PREVIOUS EXPOSURE POINT SAMPLING LOCATION (COLLECTED FROM THE 0-2" DEPTH INTERVAL - MARCH 2002 (EP-1 THROUGH EP-19) OR MAY 2002 (EP-20 THROUGH EP-27))
- SOIL BORING LOCATION

NOTES:

1. ALL VOC AND SVOC ANALYTICAL RESULTS REPORTED IN UNITS OF UG/KG (PPB). ALL METAL AND PCB ANALYTICAL RESULTS REPORTED IN UNITS OF MG/KG (PPM).
2. ONLY ANALYTICAL RESULTS IN EXCESS OF THE SOIL SCREENING LEVELS ARE PRESENTED.
3. COLORS:
 ORANGE - CHROMIUM EXCEEDANCE
 GREEN - RCRA METAL EXCEEDANCE (OTHER THAN CHROMIUM)
 BLUE - VOC OR SVOC EXCEEDANCE
4. DEPTH INTERVALS DENOTED IN BLUE INDICATE SOIL SAMPLES ANALYZED FOR VOCs AND SVOCs.



TOWN OF OYSTER BAY
 BETHPAGE COMMUNITY PARK
 BETHPAGE, NEW YORK

**SOUTH PLAYGROUND AREA
 SUMMARY OF EXCEEDANCES**

SCALE: 1" = 15'

FIGURE 4-3

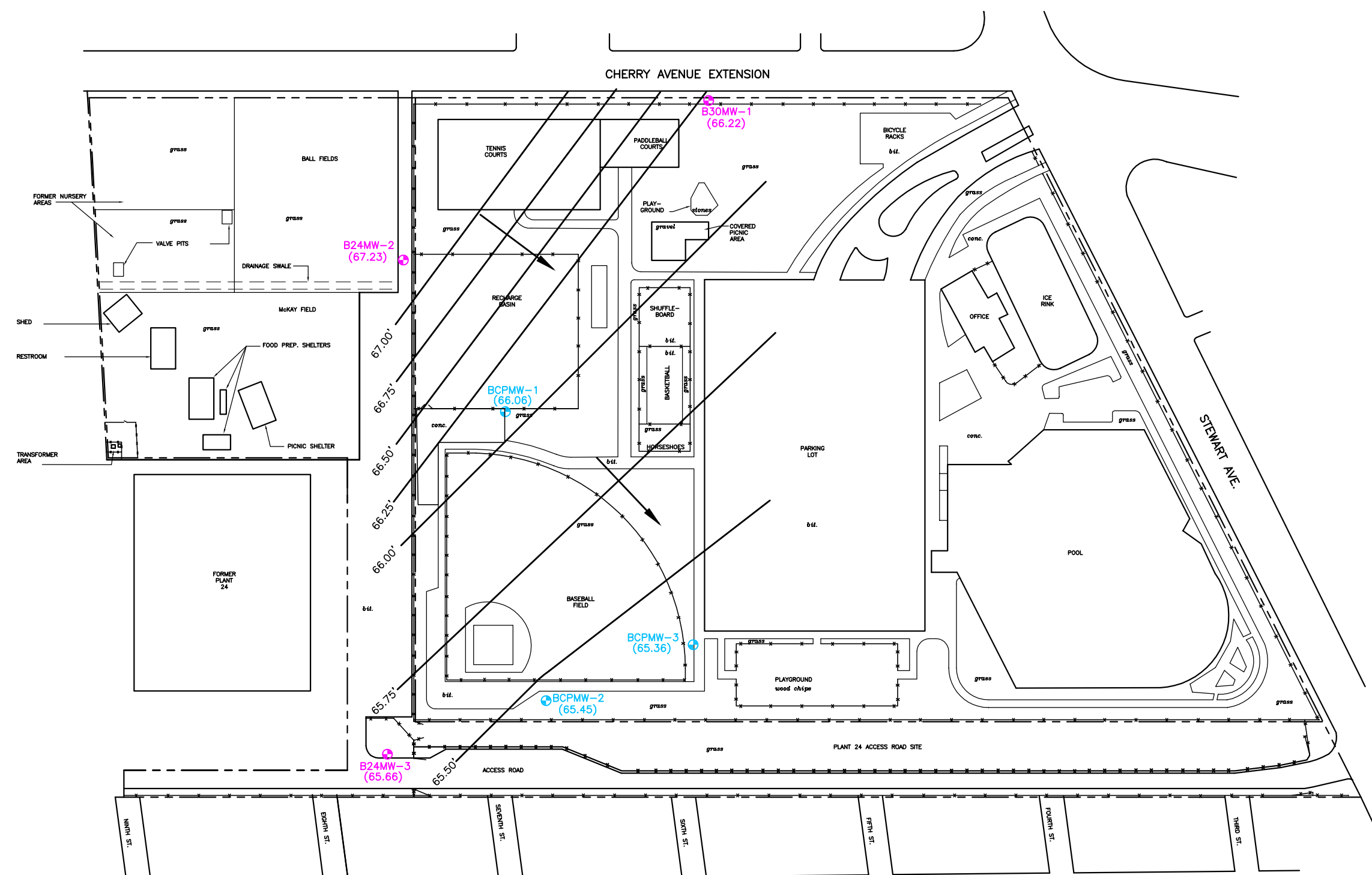

NOTES:

1. PARK FEATURES AND STRUCTURES DIGITIZED FROM A MARCH 14, 1974 AERIAL PHOTOGRAPH.
2. THE APPROXIMATE LOCATIONS AND DIMENSIONS OF THE PARK FEATURES AND STRUCTURES HAVE BEEN FIELD VERIFIED.

- LEGEND:**
- PROPERTY LINE
 - x-x- FENCE
 - x-x- TEMPORARY FENCE
 - ⊕ MONITORING WELL LOCATION
 - ⊕ OFF-SITE MONITORING WELL LOCATION
 - 66.50' LINE OF EQUAL GROUNDWATER ELEVATION
 - APPROXIMATE DIRECTION OF GROUNDWATER FLOW
 - (65.45) GROUNDWATER ELEVATION IN FEET ABOVE MEAN SEA LEVEL (msl)

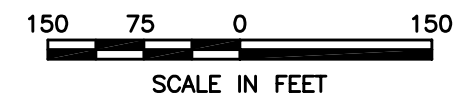

TOWN OF OYSTER BAY
 BETHPAGE COMMUNITY PARK
 BETHPAGE, NEW YORK
GROUNDWATER CONTOUR MAP
 JUNE 19, 2003



0-2 none
 2-4 none
 4-6 none
 6-8 none

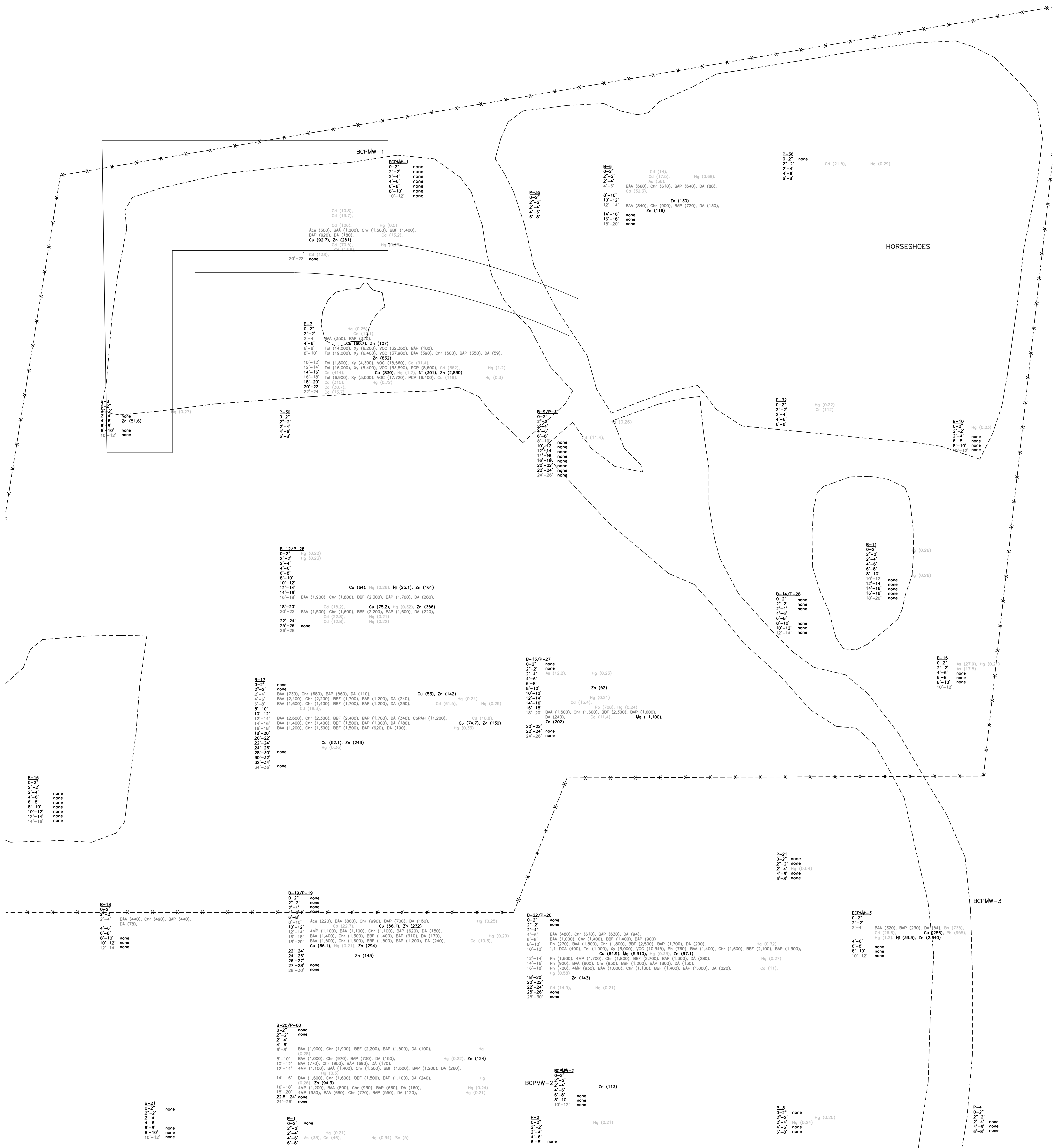

LEGEND:

- PROPERTY LINE
- X-X- FENCE
- - - - - FEATURES FROM APRIL 10, 1962 AERIAL PHOTOGRAPH
- X-X-X- FORMER FENCELINE FROM APRIL 10, 1962 AERIAL PHOTOGRAPH
- + PREVIOUS SOIL PROBE LOCATION (ADVANCED TO A DEPTH OF 8 FEET BELOW GRADE - MARCH 2002)
- ⊕ PREVIOUS EXPOSURE POINT SAMPLING LOCATION (COLLECTED FROM THE 0-2" DEPTH INTERVAL - MARCH 2002 (EP-1 THROUGH EP-19) OR MAY 2002 (EP-20 THROUGH EP-27))
- SOIL BORING LOCATION
- ⊙ MONITORING WELL LOCATION

ABBREVIATIONS:

- Ac - Acetone
- 1,1-DCM - 1,1-Dichloroethane
- Tol - Toluene
- Ba - Barium
- BAA - Benzo(a)anthracene
- Cd - Cadmium
- BAP - Benzo(a)pyrene
- Cu - Copper
- Pb - Lead
- BBF - Benzo(b)fluoranthene
- BrF - Benzo(f)fluoranthene
- Mg - Magnesium
- Chv - Chrysene
- DA - Dibenzo(a,h)anthracene
- Hg - Mercury
- 4MP - 4-Methylphenol
- PCP - Pentachlorophenol
- Ph - Phenol
- Ni - Nickel
- Se - Selenium
- Zn - Zinc

- NOTES:**
- ALL VOC AND SVOC ANALYTICAL RESULTS REPORTED IN UNITS OF UG/KG (PPB). ALL METAL AND PCB ANALYTICAL RESULTS REPORTED IN UNITS OF MG/KG (PPM).
 - ONLY ANALYTICAL RESULTS IN EXCESS OF THE SOIL SCREENING LEVELS ARE PRESENTED.
 - COLORS:
 - GREEN - PCB EXCEEDANCE
 - RED - CHROMIUM EXCEEDANCE
 - BLUE - OTHER METAL EXCEEDANCE (OTHER THAN CHROMIUM)
 - BLUE - VOC OR SVOC EXCEEDANCE
 - DEPTH INTERVALS DENOTED IN BLUE INDICATE SOIL SAMPLES ANALYZED FOR VOCs AND SVOCs.

**TOWN OF OYSTER BAY
 BETHPAGE COMMUNITY PARK
 BETHPAGE, NEW YORK
 BASEBALL FIELD
 COMPREHENSIVE SUMMARY OF EXCEEDANCES**

SCALE: 1" = 15'

