



ARCADE FLOOD DAMAGE REDUCTION PROJECT



*Department of
Environmental Conservation*

Operated and Maintained by: The Village of Arcade

Region 9 Counties: Allegany, Chautauqua, Cattaraugus, Erie, Niagara, Wyoming

PROJECT LOCATION

The project site is located in the Village of Arcade, Wyoming County, New York about 36 miles southeast of the City of Buffalo. It is along a 35-foot high left bank of Cattaraugus Creek, at a point where the creek makes a 90 degree turn north.

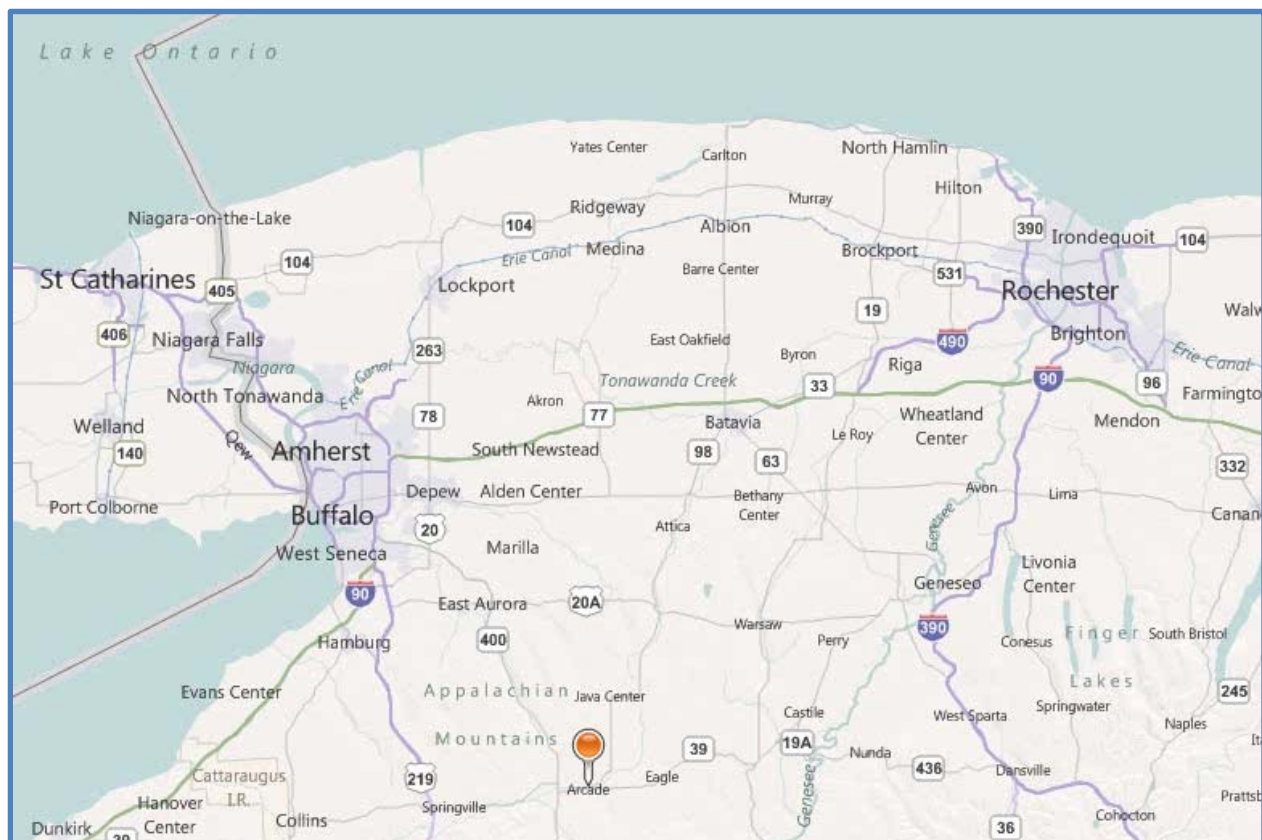
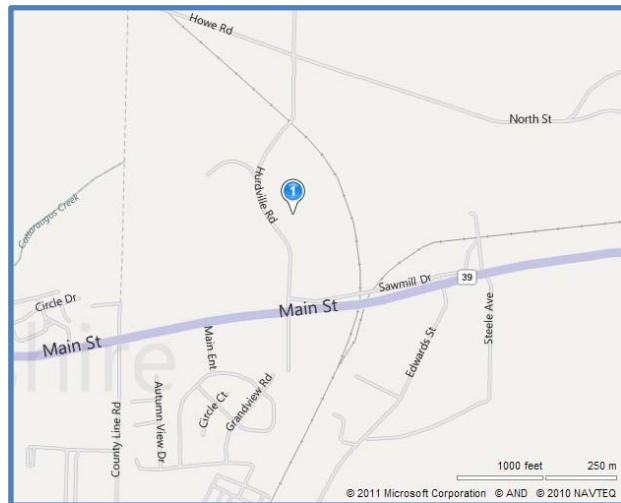

PROJECT DESCRIPTION

The project consists of the following work:

- Riprap erosion protection along approximately 600 feet of streambank along the left bank of Cattaraugus Creek.
- Streambank protection consists of geotextile fabric installed at the sloped segment over the entire length of the project along with a 36-inch layer of riprap on a 2H on 1V slope which was placed over a 12-inch layer of bedding stone. On-site fill material was utilized prior to the placement of the geotextile for required section shape.
- The toe of the streambank protection consists of the placement of 36-inch riprap.
- Granular fill was placed on a 55-foot long area, from top of the built protection to the top of the existing bank to further protect the utility lines near the top of bank at this critical section.

AUTHORIZATION

The Streambank Erosion Control Project at Cattaraugus Creek, Arcade, New York, was authorized by Section 14 of the 1946 Flood Control Act (Public Law 79-526, 24 July 1946) as amended.

PROTECTION PROVIDED

The project was designed to halt the continuing slope failures that were threatening the community owned sanitary sewer lines, water mains, electric utilities, and Hurdville Road. The approximately 600-foot long rubble mound stone revetment provides the streambank protection needed.

CONSTRUCTION

Construction was initiated by contract in September 1993, and was completed in April 1994. Prime contractor was Rayford Enterprises, Inc., of Buffalo, New York. The work was accomplished under the direction of the Buffalo District Corps of Engineers, under Construction Contract, date September 8th 1993, at a total construction cost of \$252,989.

ARCADE - GENERAL PLAN

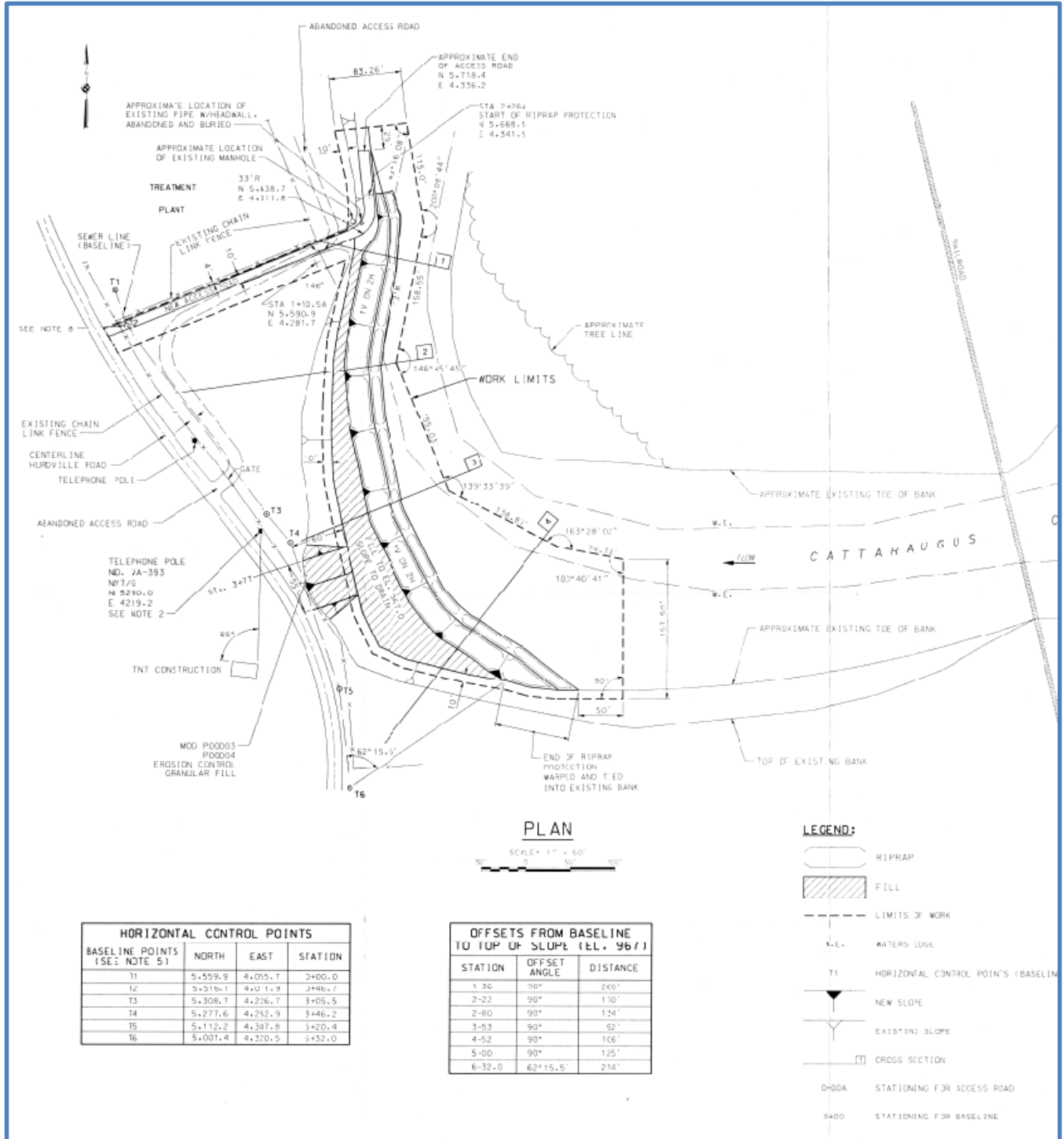

HORIZONTAL CONTROL POINTS			
BASLINE POINTS (SEE NOTE 5)	NORTH	EAST	STATION
T1	5+559.9	4+055.1	3+00.0
T2	5+576.1	4+071.9	3+46.7
T3	5+308.7	4+226.7	3+05.5
T4	5+277.6	4+252.9	3+46.2
T5	5+112.2	4+397.8	3+20.4
T6	5+001.4	4+320.5	3+32.0

OFFSETS FROM BASELINE TO TOP OF SLOPE (EL. 96.1)		
STATION	OFFSET ANGLE	DISTANCE
1-30	90°	240'
2-22	90°	130'
2-80	90°	134'
3-53	90°	52'
4-52	90°	106'
5-00	90°	125'
6-32.0	62°15.5'	214'

ARCADE – BIRD’S EYE VIEW



ARCADE – GENERAL PLAN AND AERIAL MAP OVERLAY

