



Department of
Environmental
Conservation

State Pollutant Discharge Elimination System (SPDES) DISCHARGE PERMIT

SIC Code:	4952	NAICS Code:	221320	SPDES Number:	NY0037117
Discharge Class (CL):	07	DEC Number:	3-1356-00070/00002		
Toxic Class (TX):	N	Effective Date (EDP):			
Major-Sub Drainage Basin:	13- 05	Expiration Date (ExDP):			
Water Index Number:	H -101-2a	Item No.:	857 - 14	Modification Dates (EDPM):	
Compact Area:	-				

This SPDES permit is issued in compliance with Title 8 of Article 17 of the Environmental Conservation Law of New York State and in compliance with the Clean Water Act, as amended, (33 U.S.C. '1251 et.seq.)

PERMITTEE NAME AND ADDRESS							
Name:	Town of Wappinger			Attention:	Supervisor and Town Board		
Street:	20 Middlebush Road						
City:	Wappingers Falls			State:	NY	Zip Code:	12590
Email:				Phone:			

is authorized to discharge from the facility described below:

FACILITY NAME, ADDRESS, AND PRIMARY OUTFALL										
Name:	Wildwood Sewer District (L&A)									
Address / Location:	New Hackensack Road						County:	Dutchess		
City:	Wappingers Falls				State:	NY	Zip Code:	12590		
Facility Location:	Latitude:	41 °	36 '	42.4 " N	& Longitude:	73 °	54 '	12.5 " W		
Primary Outfall No.:	001	Latitude:	41 °	36 '	42.5 " N	& Longitude:	73 °	54 '	12.8 " W	
Outfall Description:	Treated Sanitary	Receiving Water:	Unnamed Trib of Wappinger Creek			Class:	C	Standard:	C	

in accordance with: effluent limitations; monitoring and reporting requirements; other provisions and conditions set forth in this permit; and 6 NYCRR Part 750-1 and 750-2.

This permit and the authorization to discharge shall expire on midnight of the expiration date shown above and the permittee shall not discharge after the expiration date unless this permit has been renewed or extended pursuant to law. To be authorized to discharge beyond the expiration date, the permittee shall apply for permit renewal not less than 180 days prior to the expiration date shown above.

DISTRIBUTION:

- BWP Permit Coordinator (permit.coordinator@dec.ny.gov)
- BWP Permit Writer
- RWE
- RPA
- EPA Region II (Region2_NPDES@epa.gov)
- NYSEFC (Nancy.myers@efc.ny.gov)

Permit Administrator:		
Address:		
Signature	Date	

Contents

DEFINITIONS.....	3
INTERIM PERMIT LIMITS, LEVELS AND MONITORING	4
FINAL PERMIT LIMITS, LEVELS AND MONITORING.....	5
DISCHARGE NOTIFICATION REQUIREMENTS.....	6
SCHEDULE OF COMPLIANCE.....	7
MONITORING LOCATIONS.....	9
GENERAL REQUIREMENTS.....	10
RECORDING, REPORTING AND ADDITIONAL MONITORING REQUIREMENTS.....	12

DRAFT

DEFINITIONS

TERM	DEFINITION
7-Day Geo Mean	The highest allowable geometric mean of daily discharges over a calendar week.
7-Day Average	The average of all daily discharges for each 7-days in the monitoring period. The sample measurement is the highest of the 7-day averages calculated for the monitoring period.
12-Month Rolling Average (12 MRA)	The current monthly value of a parameter, plus the sum of the monthly values over the previous 11 months for that parameter, divided by the number of months for which samples were collected in the 12-month period.
30-Day Geometric Mean	The highest allowable geometric mean of daily discharges over a calendar month, calculated as the antilog of: the sum of the log of each of the daily discharges measured during a calendar month divided by the number of daily discharges measured during that month.
Action Level	Action level means a monitoring requirement characterized by a numerical value that, when exceeded, triggers additional permittee actions and department review to determine if numerical effluent limitations should be imposed.
Compliance Level / Minimum Level	A compliance level is an effluent limitation. A compliance level is given when the water quality evaluation specifies a Water Quality Based Effluent Limit (WQBEL) below the Minimum Level. The compliance level shall be set at the Minimum Level (ML) for the most sensitive analytical method as given in 40 CFR Part 136, or otherwise accepted by the Department.
Daily Discharge	The discharge of a pollutant measured during a calendar day or any 24-hour period that reasonably represents the calendar day for the purposes of sampling. For pollutants expressed in units of mass, the 'daily discharge' is calculated as the total mass of the pollutant discharged over the day. For pollutants with limitations expressed in other units of measurement, the 'daily discharge' is calculated as the average measurement of the pollutant over the day.
Daily Maximum	The highest allowable Daily Discharge.
Daily Minimum	The lowest allowable Daily Discharge.
Effective Date of Permit (EDP or EDPM)	The date this permit is in effect.
Effluent Limitations	Effluent limitation means any restriction on quantities, quality, rates and concentrations of chemical, physical, biological, and other constituents of effluents that are discharged into waters of the state.
Expiration Date of Permit (ExDP)	The date this permit is no longer in effect.
Instantaneous Maximum	The maximum level that may not be exceeded at any instant in time.
Instantaneous Minimum	The minimum level that must be maintained at all instants in time.
Monthly Average	The highest allowable average of daily discharges over a calendar month, calculated as the sum of each of the daily discharges measured during a calendar month divided by the number of daily discharges measured during that month.
Outfall	The terminus of a sewer system, or the point of emergence of any waterborne sewage, industrial waste or other wastes or the effluent therefrom, into the waters of the State.
Range	The minimum and maximum instantaneous measurements for the reporting period must remain between the two values shown.
Receiving Water	The classified waters of the state to which the listed outfall discharges.
Sample Frequency / Sample Type / Units	See NYSDEC's "DMR Manual for Completing the Discharge Monitoring Report for the SPDES" for information on sample frequency, type and units.

INTERIM PERMIT LIMITS, LEVELS AND MONITORING

OUTFALL	LIMITATIONS APPLY	RECEIVING WATER	EFFECTIVE	EXPIRING
001	All Year unless otherwise noted	Unnamed Trib of Wappinger Creek	EDP	FN (2)

PARAMETER	EFFLUENT LIMITATION					MONITORING REQUIREMENTS				FN
	Type	Limit	Units	Limit	Units	Sample Frequency	Sample Type	Location		
								Inf.	Eff.	
Flow	Monthly Average	0.1	MGD			Continuous	Recorder	X		
pH	Daily Minimum	6.0	SU			1/ day	Grab	X	X	
	Daily Maximum	9.0	SU							
Temperature	Daily Maximum	Monitor	°F			1/ day	Grab	X	X	
BOD ₅	Monthly Average	30	mg/L	25	lbs/d	1/ month	6-hr. Comp.	X	X	(1)
BOD ₅	7-Day Average	45	mg/L	37.5	lbs/d	1/ month	6-hr. Comp.	X	X	(1)
Total Suspended Solids (TSS)	Monthly Average	30	mg/L	25	lbs/d	1/ month	6-hr. Comp.	X	X	(1)
Total Suspended Solids (TSS)	7-Day Average	45	mg/L	37.5	lbs/d	1/ month	6-hr. Comp.	X	X	(1)
Settleable Solids	Daily Maximum	0.3	mL/L			1/ day	Grab	X	X	
EFFLUENT DISINFECTION		Limit	Units	Limit	Units	Sample Frequency	Sample Type	Inf.	Eff.	FN
Required All Year										
Coliform, Fecal	30-Day Geometric Mean	200	No./ 100 mL				Grab		X	
Coliform, Fecal	7-Day Geometric Mean	400	No./ 100 mL				Grab		X	
Chlorine, Total Residual	Daily Maximum	2.0	mg/L				Grab		X	

FOOTNOTES:

1. Effluent shall not exceed 15% and 15% of influent concentration values for BOD₅ & TSS respectively.
2. The interim limits will last until the completion of the compliance schedule.

FINAL PERMIT LIMITS, LEVELS AND MONITORING

OUTFALL	LIMITATIONS APPLY	RECEIVING WATER	EFFECTIVE	EXPIRING
001	All Year unless otherwise noted	Unnamed Trib of Wappinger Creek	FN (2)	

PARAMETER	EFFLUENT LIMITATION					MONITORING REQUIREMENTS				FN
	Type	Limit	Units	Limit	Units	Sample Frequency	Sample Type	Location		
								Inf.	Eff.	
Flow	Monthly Average	0.1	MGD			Continuous	Recorder	X	X	
pH	Daily Minimum	6.5	SU			1/ day	Grab		X	
	Daily Maximum	8.5	SU							
Temperature	Daily Maximum	Monitor	°F			1/ day	Grab		X	
CBOD ₅	Daily Maximum	15	mg/L			1/ month	6-hr. Comp.	X	X	(1)
Total Suspended Solids (TSS)	Daily Maximum	30	mg/L			1/ month	6-hr. Comp.	X	X	(1)
Settleable Solids	Daily Maximum	0.3	mL/L			1/ day	Grab		X	
Nitrogen, Ammonia (as NH ₃) June 1 – Oct 31	Monthly Average	1.5	mg/L			1/ month	6-hr. Comp.		X	(2)
Nitrogen, Ammonia (as NH ₃) Nov 1 – May 31	Monthly Average	2.2	mg/L			1/ month	6-hr. Comp.		X	(2)
Dissolved Oxygen	Daily Minimum	5.0	mg/L			1/ day	Grab		X	(2)
EFFLUENT DISINFECTION Required All Year		Limit	Units	Limit	Units	Sample Frequency	Sample Type	Inf.	Eff.	FN
Coliform, Fecal	30-Day Geometric Mean	200	No./ 100 mL			1/ month	Grab		X	
Coliform, Fecal	7-Day Geometric Mean	400	No./ 100 mL			1/ month	Grab		X	
Chlorine, Total Residual	Daily Maximum	0.1	mg/L			1/ day	Grab		X	(2)

FOOTNOTES:

1. Effluent shall not exceed 15% and 15% of influent concentration values for BOD₅ & TSS respectively.
2. The final limits will be applicable upon the completion of the compliance schedule.

DISCHARGE NOTIFICATION REQUIREMENTS

- (a) The permittee shall install and maintain identification signs at all outfalls to surface waters listed in this permit, unless the Permittee has obtained a waiver in accordance with the Discharge Notification Act (DNA). Such signs shall be installed before initiation of any new discharge location.
- (b) Subsequent modifications to or renewal of this permit does not reset or revise the deadline set forth in (a) above, unless a new deadline is set explicitly by such permit modification or renewal.
- (c) The Discharge Notification Requirements described herein do not apply to outfalls from which the discharge is composed exclusively of storm water, or discharges to ground water.
- (d) The sign(s) shall be conspicuous, legible and in as close proximity to the point of discharge as is reasonably possible while ensuring the maximum visibility from the surface water and shore. The signs shall be installed in such a manner to pose minimal hazard to navigation, bathing or other water related activities. If the public has access to the water from the land in the vicinity of the outfall, an identical sign shall be posted to be visible from the direction approaching the surface water.

The signs shall have **minimum** dimensions of eighteen inches by twenty-four inches (18" x 24") and shall have white letters on a green background and contain the following information:

<p>N.Y.S. PERMITTED DISCHARGE POINT</p> <p>SPDES PERMIT No.: NY_____</p> <p>OUTFALL No. : _____</p> <p>For information about this permitted discharge contact:</p> <p>Permittee Name: _____</p> <p>Permittee Contact: _____</p> <p>Permittee Phone: () - ### - ####</p> <p>OR:</p> <p>NYSDEC Division of Water Regional Office Address:</p> <p>NYSDEC Division of Water Regional Phone: () - ### - ####</p>
--

- (e) Upon request, the permittee shall make available electronic or hard copies of the sampling data to the public. In accordance with the RECORDING, REPORTING AND ADDITIONAL MONITORING REQUIREMENTS page of your permit, each DMR shall be maintained (either electronically or as a hard copy) on record for a period of five years.
- (f) The permittee shall periodically inspect the outfall identification sign(s) in order to ensure they are maintained, are still visible, and contain information that is current and factually correct. Signs that are damaged or incorrect shall be replaced within 3 months of inspection.

SCHEDULE OF COMPLIANCE

a) The permittee shall comply with the following schedule:

Outfall(s)	Parameter(s) Affected	Interim Effluent Limit(s)	Compliance Action	Due Date	
001	Ammonia (as NH ₃)	Monitor	The permittee shall submit to the Department for approval an Engineering Report, Plans and Specifications which identifies the facilities necessary to achieve compliance with the water quality based effluent limit for Nitrogen, Ammonia (as NH ₃) of 1.5 mg/l from June 1 – October 31 and 2.2 mg/l from November 1 to May 31.	EDPM + 6 months	
			The permittee shall complete construction in accordance with the approved Engineering Report, Plans and Specifications as per the above.	04/30/2025	
	Total Residual Chlorine	2.0 mg/l	The permittee shall submit to the Department for approval an Engineering Report, Plans and Specifications which identifies the facilities necessary to achieve compliance with the water quality based effluent limit for total residual chlorine of 0.1 mg/l.	EDPM + 6 months	
			The permittee shall complete construction in accordance with the approved Engineering Report, Plans and Specifications as per the above.	04/30/2025	
	Flow		<u>OR</u>	The permittee shall submit to the Department for approval an Engineering Report, Plans and Specifications discussing the various alternatives for the treatment of the wastewater.	EDPM + 6 months
			If the permittee decides to decommission the existing Wildwood WWTP, a Closure Plans shall be submitted in accordance with the 6NYCRR 750-2.11 for the decommissioning of the existing Wildwood WWTP.		
		The permittee shall complete construction in accordance with the approved Engineering Report, Plans and Specifications as per the above.	04/30/2025		

The above compliance actions are one time requirements. The permittee shall comply with the above compliance actions to the Department's satisfaction once. When this permit is administratively renewed by NYSDEC letter entitled "SPDES NOTICE/RENEWAL APPLICATION/PERMIT," the permittee is not required to repeat the submission(s) noted above. The above due dates are independent from the effective date of the permit stated in the "SPDES NOTICE/RENEWAL APPLICATION/PERMIT" letter.

- b) The permittee shall comply with the following schedule:
- c) The permittee shall submit a notice of non-compliance with each of the above schedule dates no later than 14 days following each elapsed date, unless conditions require more immediate notice as prescribed in 6 NYCRR Part 750-1.2(a) and 750-2. All notifications shall be sent to the locations listed under the section of this permit entitled RECORDING, REPORTING AND ADDITIONAL MONITORING REQUIREMENTS. Each notice of non-compliance shall include the following information:
1. A short description of the non-compliance;
 2. A description of any actions taken or proposed by the permittee to comply with the elapsed schedule requirements without further delay and to limit environmental impact associated with the non-compliance;
 3. Any details which tend to explain or mitigate an instance of non-compliance; and
 4. An estimate of the date the permittee will comply with the elapsed schedule requirement and an assessment of the probability that the permittee will meet the next scheduled requirement on time.
- d) The permittee shall submit copies of any document required by the above schedule of compliance to the NYSDEC Regional Water Engineer and to the Bureau of Water Permits.

DRAFT

MONITORING LOCATIONS

The permittee shall take samples and measurements, to comply with the monitoring requirements specified in this permit, at the locations(s) specified below:

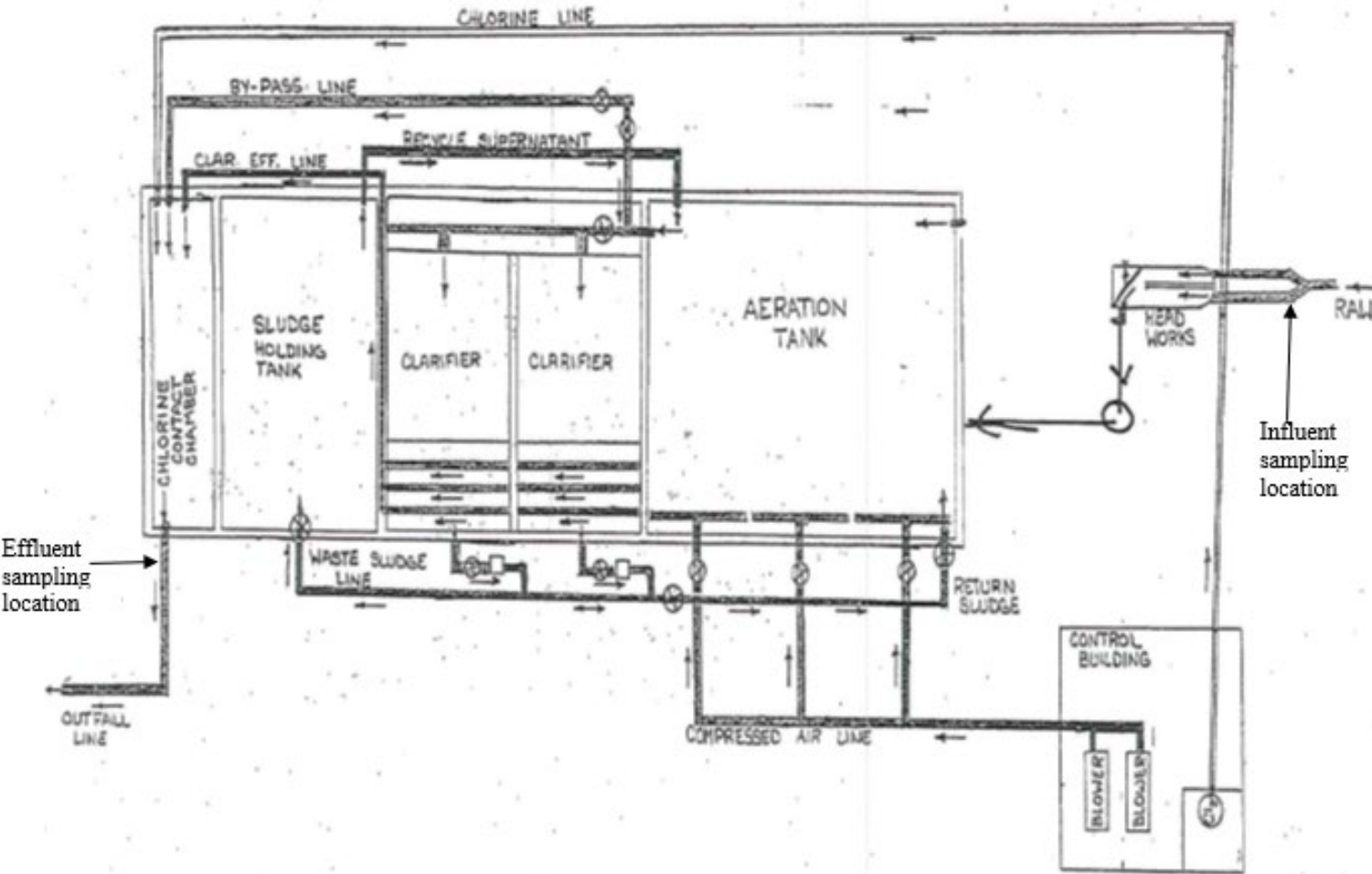

GENERAL REQUIREMENTS

- A. The regulations in 6 NYCRR Part 750 are hereby incorporated by reference and the conditions are enforceable requirements under this permit. The permittee shall comply with all requirements set forth in this permit and with all the applicable requirements of 6 NYCRR Part 750 incorporated into this permit by reference, including but not limited to the regulations in paragraphs B through I as follows:
- B. General Conditions
- | | |
|--|---|
| 1. Duty to comply | 6 NYCRR 750-2.1(e) & 2.4 |
| 2. Duty to reapply | 6 NYCRR 750-1.16(a) |
| 3. Need to halt or reduce activity not a defense | 6 NYCRR 750-2.1(g) |
| 4. Duty to mitigate | 6 NYCRR 750-2.7(f) |
| 5. Permit actions | 6 NYCRR 750-1.1(c), 1.18, 1.20 & 2.1(h) |
| 6. Property rights | 6 NYCRR 750-2.2(b) |
| 7. Duty to provide information | 6 NYCRR 750-2.1(i) |
| 8. Inspection and entry | 6 NYCRR 750-2.1(a) & 2.3 |
- C. Operation and Maintenance
- | | |
|-----------------------------------|--------------------------------------|
| 1. Proper Operation & Maintenance | 6 NYCRR 750-2.8 |
| 2. Bypass | 6 NYCRR 750-1.2(a)(17), 2.8(b) & 2.7 |
| 3. Upset | 6 NYCRR 750-1.2(a)(94) & 2.8(c) |
- D. Monitoring and Records
- | | |
|---------------------------|--|
| 1. Monitoring and records | 6 NYCRR 750-2.5(a)(2), 2.5(a)(6), 2.5(c)(1), 2.5(c)(2), & 2.5(d) |
| 2. Signatory requirements | 6 NYCRR 750-1.8 & 2.5(b) |
- E. Reporting Requirements
- | | |
|---|-----------------------------|
| 1. Reporting requirements | 6 NYCRR 750-2.5, 2.7 & 1.17 |
| 2. Anticipated noncompliance | 6 NYCRR 750-2.7(a) |
| 3. Transfers | 6 NYCRR 750-1.17 |
| 4. Monitoring reports | 6 NYCRR 750-2.5(e) |
| 5. Compliance schedules | 6 NYCRR 750-1.14(d) |
| 6. 24-hour reporting | 6 NYCRR 750-2.7(c) & (d) |
| 7. Other noncompliance | 6 NYCRR 750-2.7(e) |
| 8. Other information | 6 NYCRR 750-2.1(f) |
| 9. Additional conditions applicable to a POTW | 6 NYCRR 750-2.9 |
- F. Planned Changes
- The permittee shall give notice to the Department as soon as possible of planned physical alterations or additions to the permitted facility when:
 - The alteration or addition to the permitted facility may meet any of the criteria for determining whether facility is a new source in 40 CFR §122.29(b); or
 - The alteration or addition could significantly change the nature or increase the quantity of pollutants discharged. This notification applies to pollutants which are subject either to effluent limitations in the permit, or to notification requirements under 40 CFR §122.42(a)(1); or
 - The alteration or addition results in a significant change in the permittee's sludge use or disposal practices, and such alteration, addition, or change may justify the application of permit conditions that are different from or absent in the existing permit, including notification of additional use or disposal sites not reported during the permit application process or not reported pursuant to an approved land application plan.

In addition to the Department, the permittee shall submit a copy of this notice to the United States Environmental Protection Agency at the following address: U.S. EPA Region 2, Clean Water Regulatory Branch, 290 Broadway, 24th Floor, New York, NY 10007-1866.

GENERAL REQUIREMENTS (continued)

2. Notification Requirement for POTWs

All POTWs shall provide adequate notice to the Department and the USEPA of the following:

- a. Any new introduction of pollutants into the POTW from an indirect discharger which would be subject to section 301 or 306 of CWA if it were directly discharging those pollutants; or
- b. Any substantial change in the volume or character of pollutants being introduced into that POTW by a source introducing pollutants into the POTW at the time of issuance of the permit.
- c. For the purposes of this paragraph, adequate notice shall include information on:
 - i. the quality and quantity of effluent introduced into the POTW, and
 - ii. any anticipated impact of the change on the quantity or quality of effluent to be discharged from the POTW.

POTWs shall submit a copy of this notice to the United States Environmental Protection Agency, at the following address:

U.S. EPA Region 2, Clean Water Regulatory Branch, 290 Broadway, 24th Floor, New York, NY 10007-1866

G. Sludge Management

The permittee shall comply with all applicable requirements of 6 NYCRR Part 360.

H. SPDES Permit Program Fee

The permittee shall pay to the Department an annual SPDES permit program fee within 30 days of the date of the first invoice, unless otherwise directed by the Department, and shall comply with all applicable requirements of ECL 72-0602 and 6 NYCRR Parts 480, 481 and 485. Note that if there is inconsistency between the fees specified in ECL 72-0602 and 6 NYCRR Part 485, the ECL 72-0602 fees govern.

I. Water Treatment Chemicals (WTCs)

New or increased use and discharge of a WTC requires prior Department review and authorization. At a minimum, the permittee must notify the Department in writing of its intent to change WTC use by submitting a completed *WTC Notification Form* for each proposed WTC. The Department will review that submittal and determine if a SPDES permit modification is necessary or whether WTC review and authorization may proceed outside of the formal permit administrative process. The majority of WTC authorizations do not require SPDES permit modification. In any event, use and discharge of a WTC shall not proceed without prior authorization from the Department. Examples of WTCs include biocides, coagulants, conditioners, corrosion inhibitors, defoamers, deposit control agents, flocculants, scale inhibitors, sequestrants, and settling aids.

1. WTC use shall not exceed the rate explicitly authorized by this permit or otherwise authorized in writing by the Department.
2. The permittee shall maintain a logbook of all WTC use, noting for each WTC the date, time, exact location, and amount of each dosage, and, the name of the individual applying or measuring the chemical. The logbook must also document that adequate process controls are in place to ensure that excessive levels of WTCs are not used.
3. The permittee shall submit a completed WTC Annual Report Form each year that they use and discharge WTCs. This form shall be submitted in electronic format and attached to either the December DMR or the annual monitoring report required below. The *WTC Notification Form and WTC Annual Report Form* are available from the Department's website at: <http://www.dec.ny.gov/permits/93245.html>

RECORDING, REPORTING AND ADDITIONAL MONITORING REQUIREMENTS

- A. The monitoring information required by this permit shall be retained for a period of at least five years from the date of the sampling for subsequent inspection by the Department or its designated agent.
- B. Discharge Monitoring Reports (DMRs): Completed DMR forms shall be submitted for each 1 month reporting period in accordance with the DMR Manual available on Department's website.

DMRs must be submitted electronically using the electronic reporting tool (NetDMR) specified by NYSDEC. Instructions on the use of NetDMR can be found at <https://www.dec.ny.gov/chemical/8461.html>. **Hardcopy paper DMRs will only be accepted if a waiver from the electronic submittal requirements has been granted by DEC to the facility.**

Attach the monthly "Wastewater Facility Operation Report" (form 92-15-7) and any required DMR attachments electronically to the DMR or with the hardcopy submittal.

The first monitoring period begins on the effective date of this permit, and, unless otherwise required, the reports are due no later than the 28th day of the month following the end of each monitoring period.

- C. Additional information required to be submitted by this permit shall be summarized and reported to the Regional Water Engineer and Bureau of Water Permits at the following addresses:

Department of Environmental Conservation
Division of Water, Bureau of Water Permits
625 Broadway, Albany, New York 12233-3505 Phone: (518) 402-8111

Department of Environmental Conservation
Regional Water Engineer, Region 3
21 South Putt Corners Road, New Paltz, New York, 12561-1696 Phone: (845) 256-3000

Dutchess County Department of Behavioral & Community Health
85 Civic Center Plaza, Suite 106
Poughkeepsie, NY 12601 Phone: (845) 486-3404

- D. Bypass and Sewage Pollutant Right to Know Reporting: In accordance with the Sewage Pollutant Right to Know Act (ECL § 17-0826-a), Publicly Owned Treatment Works (POTWs) are required to notify DEC and Department of Health within two hours of discovery of an untreated or partially treated sewage discharge and to notify the public and adjoining municipalities within four hours of discovery. Information regarding reporting and other requirements of this program may be found on the Department's website. In addition, POTWs are required to provide a five-day incident report and supplemental information to the DEC in accordance with Part 750-2.7(d) by utilizing the Division of Water Report of Noncompliance Event form unless waived by DEC on a case-by-case basis.
- E. Monitoring and analysis shall be conducted using sufficiently sensitive test procedures approved under 40 CFR Part 136, unless other test procedures have been specified in this permit.
- F. More frequent monitoring of the discharge(s), monitoring point(s), or waters of the State than required by the permit, where analysis is performed by a certified laboratory or where such analysis is not required to be performed by a certified laboratory, shall be included in the calculations and recording of the data on the corresponding DMRs.
- G. Calculations which require averaging of measurements shall utilize an arithmetic mean unless otherwise specified in this permit.
- H. Unless otherwise specified, all information recorded on the DMRs shall be based upon measurements and sampling carried out during the most recently completed reporting period.

- I. Any laboratory test or sample analysis required by this permit for which the State Commissioner of Health issues certificates of approval pursuant to section 502 of the Public Health Law shall be conducted by a laboratory which has been issued a certificate of approval. Inquiries regarding laboratory certification should be directed to the New York State Department of Health, Environmental Laboratory Accreditation Program.

DRAFT

SPDES Permit Statement of Basis – Surface Water Discharges

Permittee: Town of Wappinger
Facility: Wildwood Sewer District STP
SPDES No: NY0037117

Date: August 28, 2023
Permit Writer: Vijay Gandhi

I. SUMMARY OF PROPOSED PERMIT CHANGES

A State Pollutant Discharge Elimination System (SPDES) permit PIM (Permittee Initiated Modification) is proposed. This modification is undertaken pursuant to 6 NYCRR Part 750. Following is a summary of the proposed changes in the draft permit as compared to the currently effective permit, the details of these changes are specified below and in the draft permit:

- The permit is being modified to include the updated Schedule of Compliance as per permittee request, June 6, 2023. The end date to comply with the schedule is April 30, 2025. Also, the Inflow & Infiltration requirement has been removed from the Schedule of Compliance.
- Updated permit pages and conditions reflect current permit language, Department guidance, format and nomenclature.
- Permit pages and conditions have been renumbered and reordered.
- The industrial code has been updated to the municipal code 4952.
- The Water Index Number has been updated to H-101-2a.
- The receiving water has been upgraded from Class D to Class C and is considered an intermittent stream.
- The latitude and longitude of outfall 001 was incorrect and has been updated to 41°, 36', 42.5" and 73°, 54', 12.8", respectively.
- For a Class C receiving water, the water quality standard for pH is updated to a range of 6.5 – 8.5.
- Sample type for flow has been updated to a recorder.
- Influent sampling for pH, settleable solids, and temperature has been removed. The permittee may continue to perform this sampling for process control purposes.
- A Water Quality Based Effluent Limit review was done which resulted in a daily maximum CBOD₅ limit of 15 mg/l, with a respective Dissolved Oxygen (DO) limit of 5.0 mg/l, a daily maximum TSS limit of 30 mg/l. These limits are protective of water quality in the receiving water. The monitoring frequency and sample type for DO is based on TOGS 1.3.3.
- A Water Quality Based Effluent Limit review was done which resulted in a summer ammonia limit of 1.5 mg/l and a winter ammonia limit of 2.2 mg/l. These limits are protective of water quality in the receiving water. A technology based effluent limit of "Monitor" will be in effect as an interim limit while upgrades to the treatment plant are completed in accordance with the schedule of compliance section of the draft permit. The monitoring frequency and sample type for ammonia is based on TOGS 1.3.3.
- A total residual chlorine effluent limit has been included of 0.1 mg/l. This is based upon a more stringent water quality standard for total residual chlorine. A technology based effluent limit of 2.0 mg/l will be in effect as an interim limit while upgrades to the disinfection system are completed in accordance with the schedule of compliance section of the draft permit.
- Mercury was detected in the effluent at a level of 2.19 ng/l, which exceeds the water quality goal of 0.7 ng/l. However, mercury is believed to be present in this discharge solely due to one or more of the following factors: presence in rainfall; water supply; and/or low-level societal use of mercury. Considering the very low levels detected in this POTW effluent and their likely source, it has been determined that only modest reductions may be achievable by this permittee. Therefore, a low priority mercury minimization program has been included in the permit.
- A monitoring location page has been included in the permit.

- Since the facility has previously exceeded 95% of the flow limit on an annual average basis in 2018 and over the last three years, there have been exceedances of the permitted monthly average flow of 0.1 MGD, it is recommended to include an item in the schedule of compliance requiring a collection system monitoring and maintenance plan.
- A schedule of compliance has been included on page 7 of the permit to meet the final permit limits on page 4 **or** to submit the Engineering Report, Plans, and Specifications that discusses the various alternatives for the treatment of the wastewater and, if necessary, to submit to the Department the Closure Plans in accordance with the 6 NYCRR Part 750-2.11 for the decommissioning of the existing Wildwood WWTP.

Permit History

- Original permit issued – 8/7/1987
- The Department issued a Request for Information 2/11/2014, to modify and renew the SPDES permit under the EBPS. The EBPS permit was issued, 6/14/2016, along with the schedule of compliance to achieve the stringent effluent limits.
- Per permittee’s request, a meeting was held, 8/16/2016, to discuss the EBPS permit and the various alternatives for the facility to achieve compliance with the issued permit. Based on the application by the permittee, 01/19/2017, a modified permit was drafted for the relocation of the existing outfall directly to the Wappinger Creek to continue with the original permit limits.
- Based on the proposal, the Department staff drafted the permit for the relocation of the outfall to Wappinger Creek, 7/18/2017.
- The permittee did not apply for renewal of the permit and it expired, 08/31/2017.
- The Notice of Complete Application (NOCA) for the reissuance and modification was issued, 11/26/2018.
- Based on the Department’s inspection, 6/26/2019, an NOV was issued for continuous flow violations, and the permittee was asked to submit the Corrective Action Plan (CAP) to address the violations. The permittee submitted the CAP, 2/19/2020, that recommended the wastewater flow connection to the Tri-Municipal WWTP and the decommissioning of the Wildwood WWTP. Based on this recommendation, the previously draft permit has been re-modified with the option to meet the final stringent limits as per the EBPS permit or to submit the Engineering Report, plans, and Specifications that discusses the various alternatives for the treatment of the wastewater.
- An Affidavit of Publication for the 2018 public notice was submitted, 11/6/2020.
- Withdrawal of the application to relocate the outfall was received.

II. BACKGROUND INFORMATION

As noted throughout this document, SPDES permits are based on both federal and state requirements including laws, regulations, policies, and guidance. These references can generally be found on the internet. Current locations include: Clean Water Act (CWA) www.epa.gov/lawsregs/laws/index.html#env; Environmental Conservation Law (ECL) www.dec.ny.gov/regulations/40195.html; federal regulations www.gpo.gov/fdsys/browse/collectionCfr.action?collectionCode=CFR; state environmental regulations www.dec.ny.gov/regulations/regulations.html; NYSDEC water policy www.dec.ny.gov/regulations/2654.html.

III. PROPOSED PERMIT REQUIREMENTS

The Department evaluates discharges with respect to the relevant sections of the CWA, ECL, federal/state regulations, policy, and guidance to determine which conditions to include in the draft permit.

The Department determines the **technology-based effluent limits (TBELs)** that must be incorporated into the permit. A TBEL requires a minimum level of treatment. For industrial point sources, TBELs are typically based on federal effluent guidelines and/or best professional judgment (BPJ). BPJ considers currently available treatment technologies and appropriate Best Management Practices (BMPs). For municipal POTWs and private sewage treatment plants, TBELs are typically based on secondary treatment requirements and, if applicable, CSO control policy.

The Department then evaluates the water quality expected to result from technology controls to determine if any exceedances of water quality criteria in the receiving water might result. If so, **water quality-based effluent limits (WQBELs)** must be included in the permit. A WQBEL is designed to ensure that the water quality standards of receiving waters are being met. In general, effluent limits for a particular pollutant are the more stringent of either the TBEL or WQBEL.

For existing permittees, the previous permit typically forms the basis for the next permit. Permit revisions are implemented where justified due to changed conditions at the facility and/or in response to updated regulatory requirements. Regulatory anti-backsliding requirements prohibit the relaxation of effluent limits in reissued permits unless one of the specified exceptions applies, as detailed in TOGS 1.2.1.

Applicable law and regulation requires that monitoring be included in permits to determine compliance with effluent limitations. Additional effluent monitoring may also be required to gather data to determine if effluent limitations may be required. The permittee is responsible for conducting the monitoring and, when required, for reporting results on DMRs. The permit contains the monitoring requirements for the facility. Monitoring frequency is based on the minimum sampling necessary to adequately monitor the facility's performance and TOGS 1.2.1 and TOGS 1.3.3. Mercury-related requirements, if included, conform to TOGS 1.3.10.

OUTFALL, RECEIVING WATER & POLLUTANT SUMMARY TABLES

Outfall Number	Latitude	Longitude	Receiving Water Name	Water Class	Water Index Number	Major/Sub Basin
001	41°36'42.5"N	73°54'12.8"W	Unnamed tributary of the Wappinger Creek	C	H-101-2a	13/05
Source(s) of Wastewater:			Sewage			
Existing Wastewater Treatment Facilities:			Manual Bar Screen, Extended Aeration, Secondary Clarifiers, Disinfection with Sodium Hypochlorite, Sludge Holding Tank			

POLLUTANT SUMMARY TABLE(S)

Effluent Parameter <small>(concentration in ug/l and mass in lbs/day unless otherwise specified)</small>	Existing Effluent Quality				TBELs				Water Quality Data & WQBELs					Permit Basis <small>(T or WQ or NA)</small>
	concentration		mass					PQL	Ambient Criteria	Ambient Background	WQBEL			
	Avg/Max	95%/99%	Avg/Max	95%/99%	conc.	mass	Type	conc.	conc.	conc.	conc.	mass	Type	
Flow Rate, units = MGD	Average	0.1	Maximum	0.217	0.1			NA	7Q10 = 0.1 cfs, 30Q10 = , Dilution/Mixing =					T
pH (su)	Minimum	7	Maximum	8.5	6.0 – 9.0		Range				6.5 – 8.5			WQ
Temperature (F)	64.4/80.6				Monitor						NA			T
BOD ₅ (mg/l)	2.4/ 5				30/45		MA/WA		See DO		15			WQ
BOD ₅ % removal	98.5 / 99				85% min	-	MA		NA					T
TSS (mg/l)	5.2 / 15				30/45		MA/WA		Narrative		30			WQ
TSS % removal	97 / 100				85% min		MA		NA					T
Settleable Solids (ml/l)	0.1 / 1				0.3		DM		Narrative		0.1			T
Fecal Coliform (MPN/100 ml)	2 / 6				200/400		MA/WA				200/400			WQ
Total Residual Chlorine (mg/l)	2 / 2				2.0		DM				0.1			WQ

